

SOLEA[®]

Under Mount Basin Installation

To ensure this product is installed properly, please read these instructions carefully before you begin. (Certain installations may require professional help.) Also be sure your installation conforms to local codes.

CAUTION: Handle with care. Vitreous Chinaware fragile with sharp edges if broken.

NOTE: Pictures may not exactly define contour of china and components. Hardware not shown to actual size.

Hardware Included

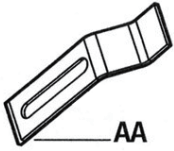

AA

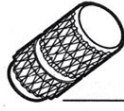

BB



CC



DD

Part	Description	Quantity
AA	Undermount clips	4
BB	Threaded knurl	4

Part	Description	Quantity
CC	Machine screw	4
DD	Washer	4

Installation

Step 1 : Installing the anchors

NOTE: It is recommended this be done by a professional.

- (1) Using the template (B) as a guide, mark the four hole locations for the mounting hardware on the countertop.
- (2) Using a 5/16 in. diamond bit, drill a 1/2 in. deep hole in each location.
- (3) Clean the holes and apply quick set epoxy.
- (4) Place one threaded knurl (BB) into each hole, and allow to cure for the amount of time required according to the epoxy manufacturer's directions.

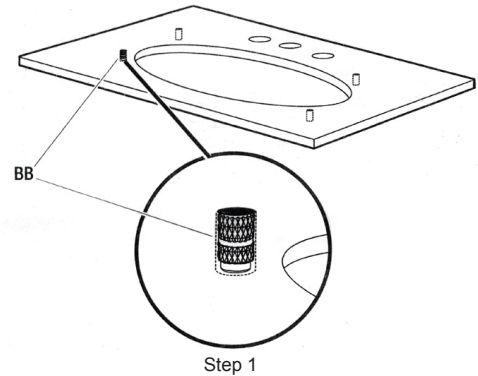

Step 2 : Applying the sealant

NOTE: It is recommended to practice the proper positioning two or three times before applying sealant.

- (1) Make sure the surface to be sealed is clean, dry, soap free, oil free, and grease free.
- (2) Apply a continuous bead of quality sealant around the top side of the sink (A) rim near the edge.

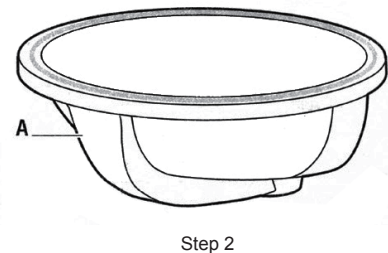

Step 3 : Mounting the sink

- (1) With the countertop positioned upside-down, center the sink (A) over the cutout.
- (2) Firmly press the sink (A) onto the countertop, and immediately wipe off excess sealant.
- (3) Attach the undermount clips (AA) to the threaded knurl (BB) in the countertop using the machine screws (CC) and washers (DD) to hold sink (A) in place.
- (4) Allow the sealant to set for 30 minutes before proceeding.
- (5) Flip the countertop right-side up, and install it onto the cabinet.

