

# Pm mi anhua

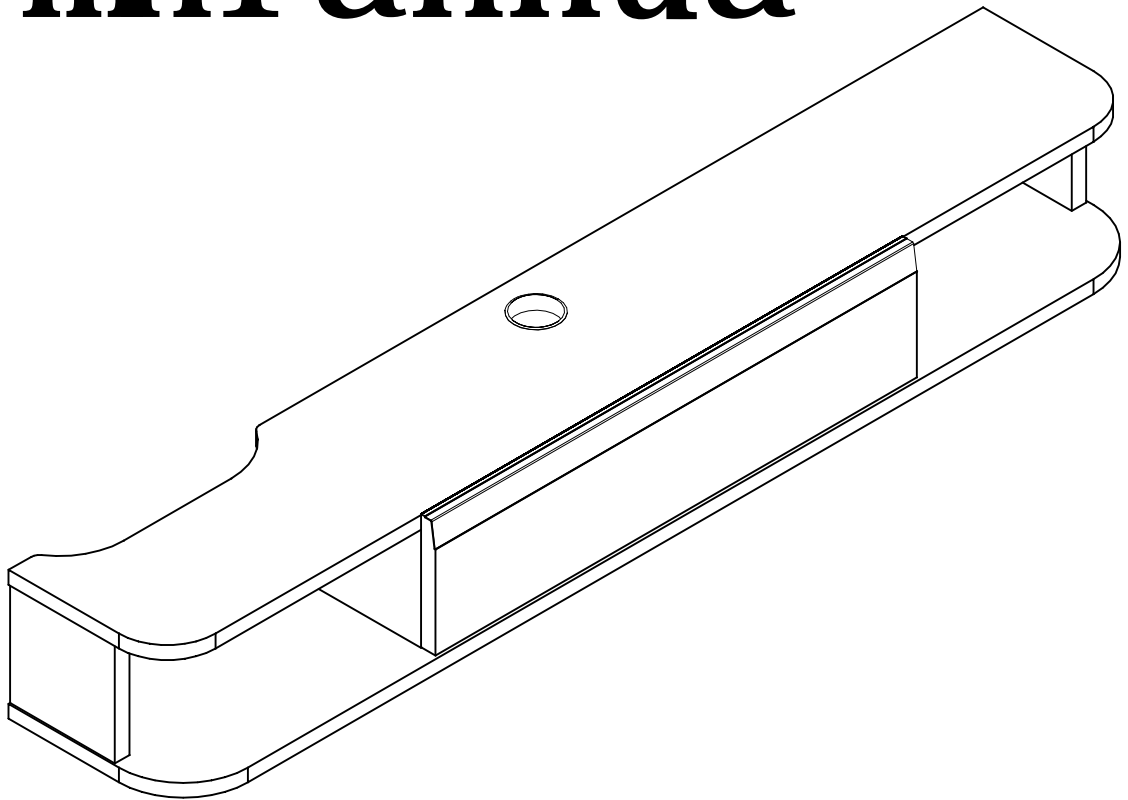

## Installation wall requirements

Solid brick wall, load-bearing wall, fired hollow brick wall, wood board wall thickened insulation wall! It is not recommended to install gypsum board walls and thin plywood walls...!

1. For solid brick walls, load-bearing walls, and fired hollow brick walls, we are equipped with 10mm wall fittings

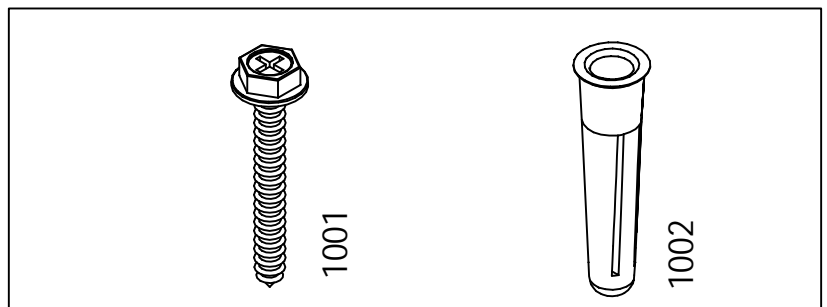

2. If it is a wooden wall (the thickness of the board needs to be at least 15 mm), please use spare screws.

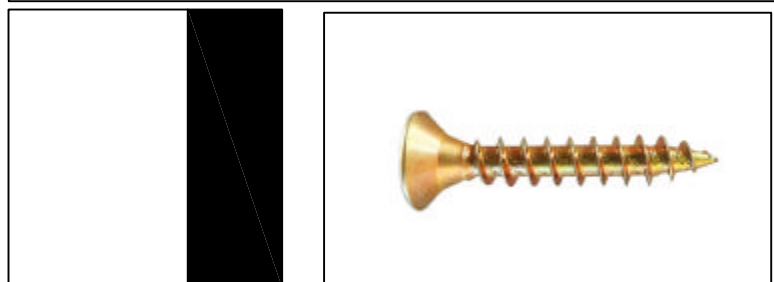

15mm

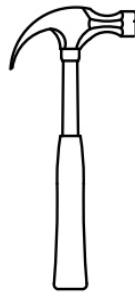
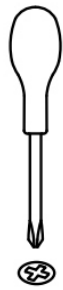

10mm 10mm

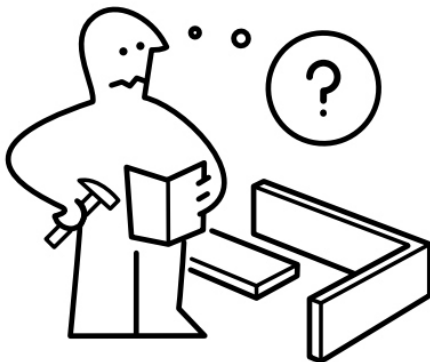
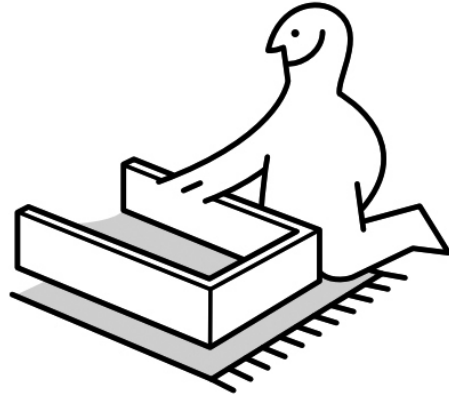
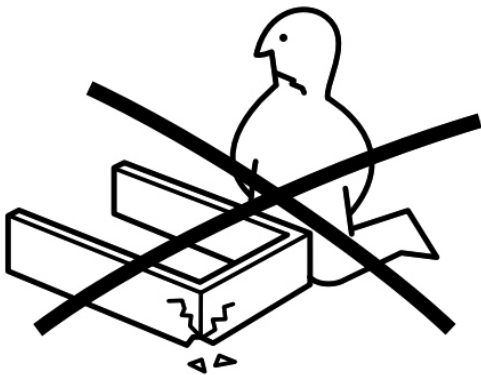
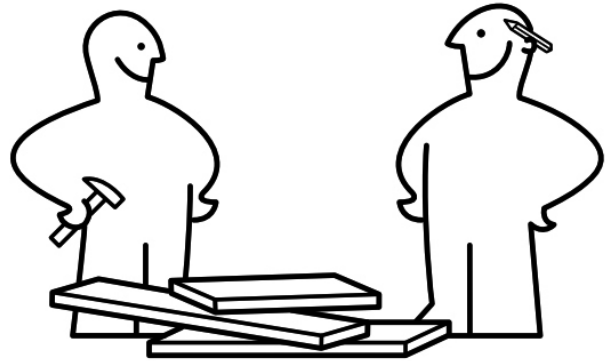

Adjust left

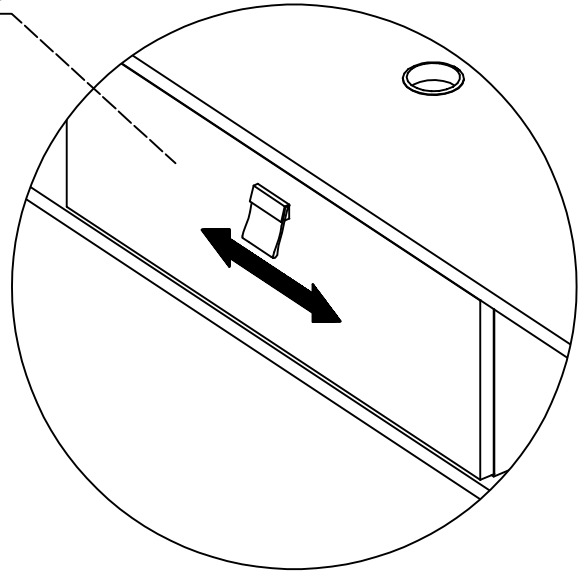
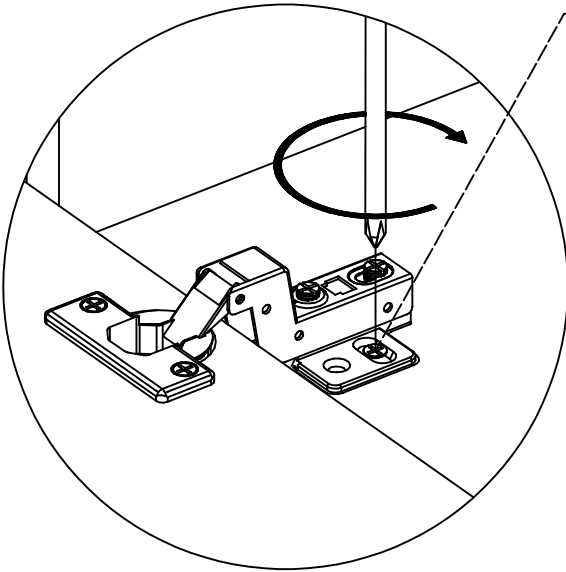

Adjust Height

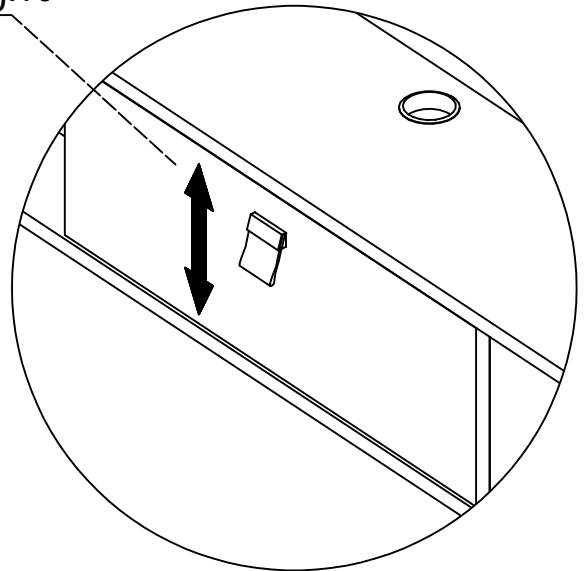
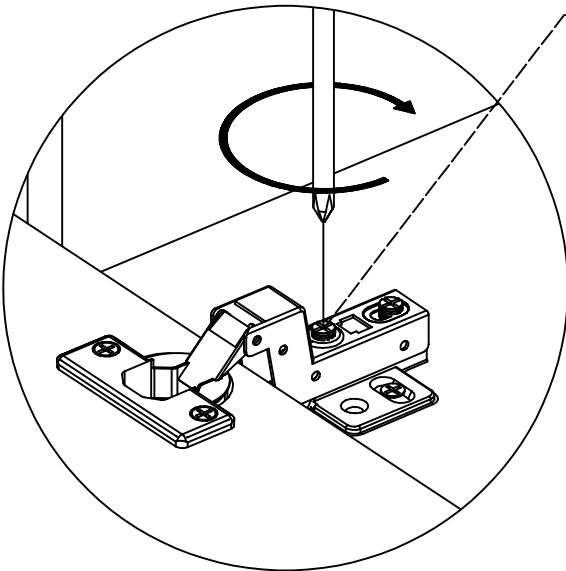

Adjust front

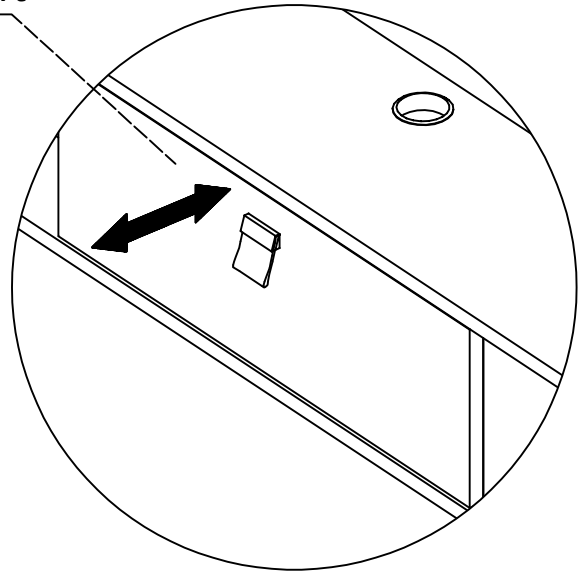
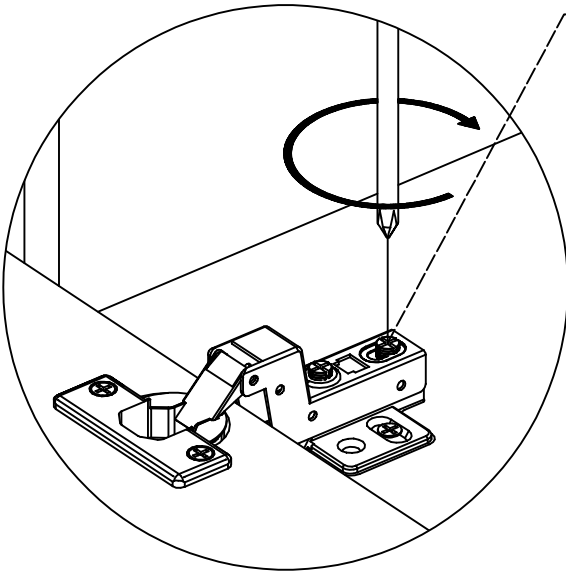

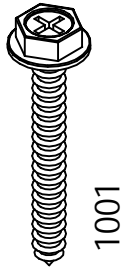

1001

3x

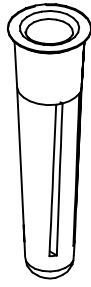

1002

3x

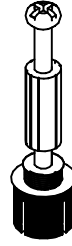

1003

10x

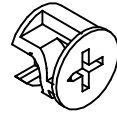

1004

10x



1007

28x

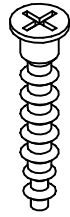

1008

8x

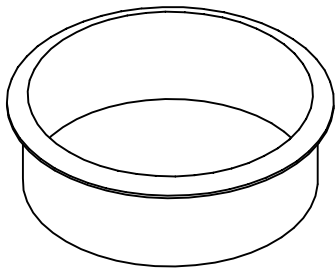

1009

1x

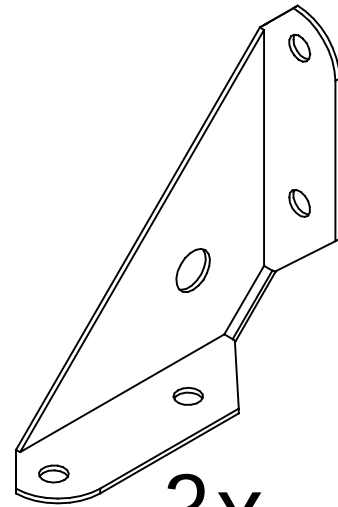

1019

3x

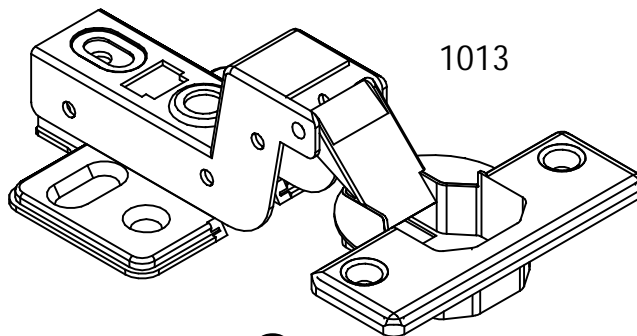

1013

2x

1

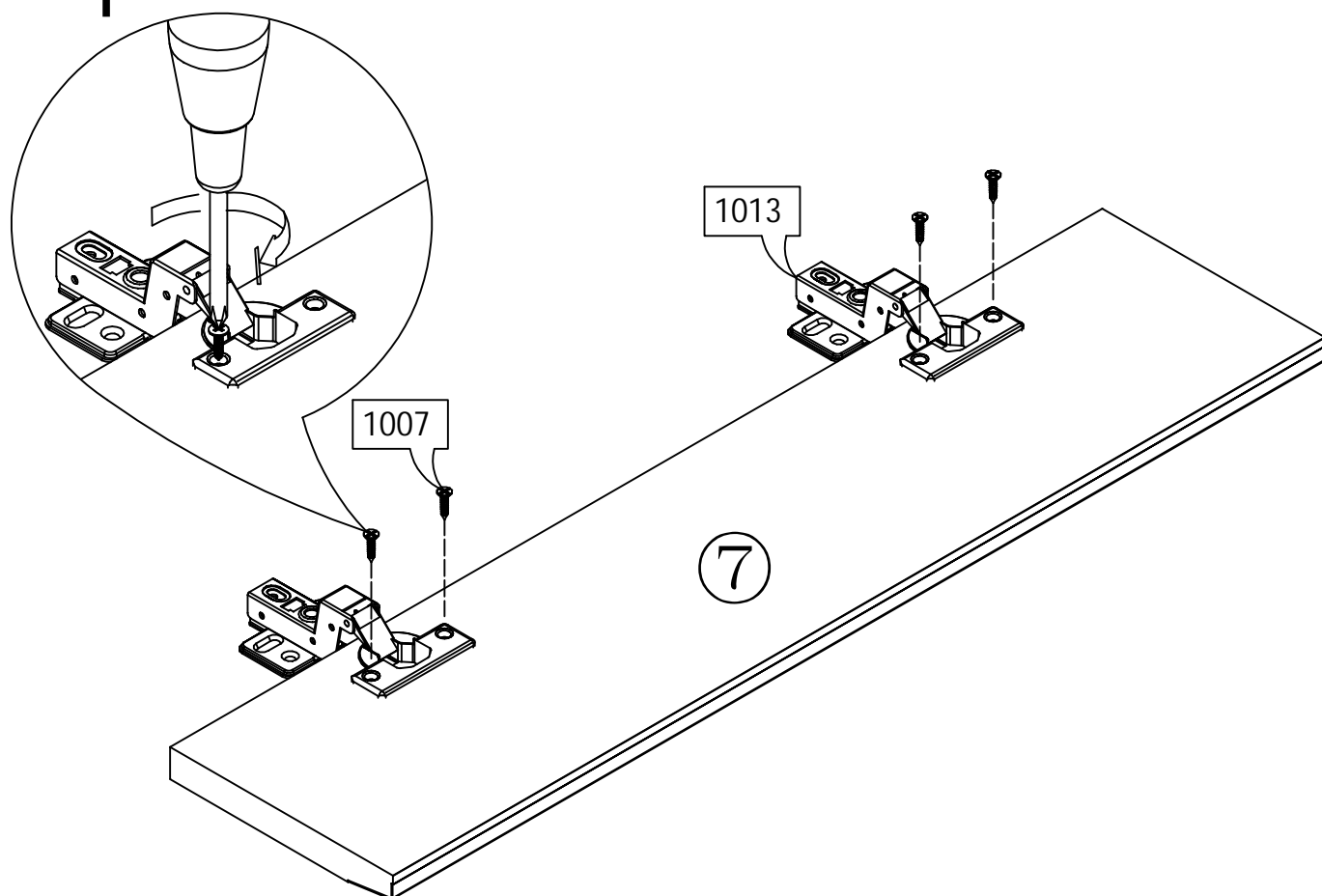

2

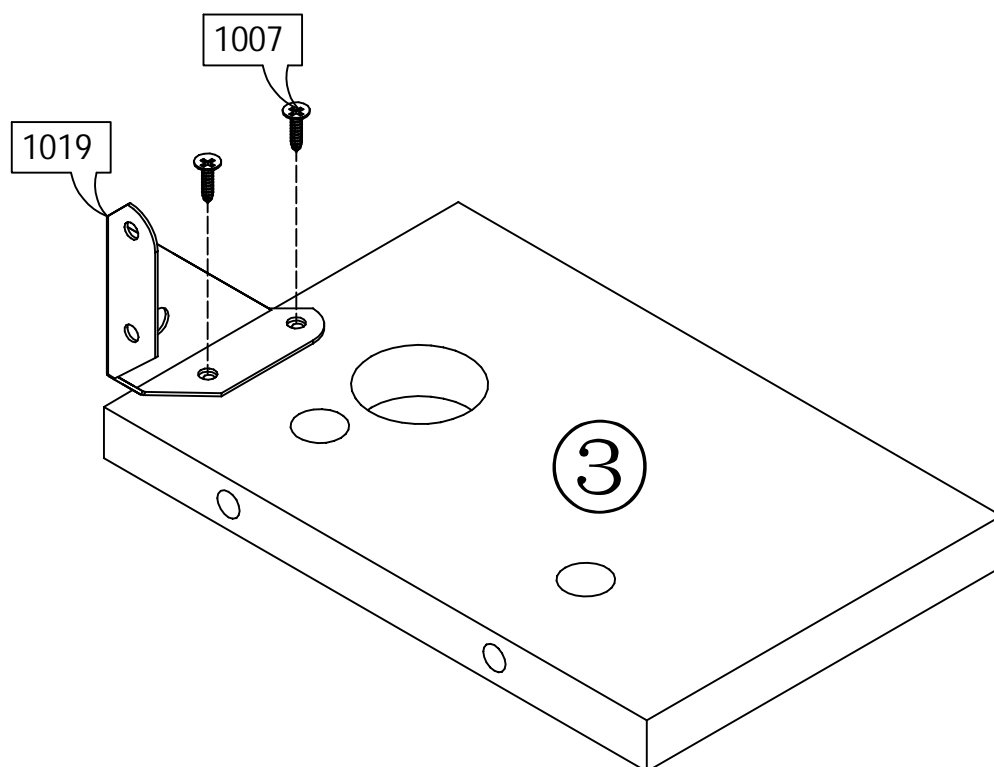

3

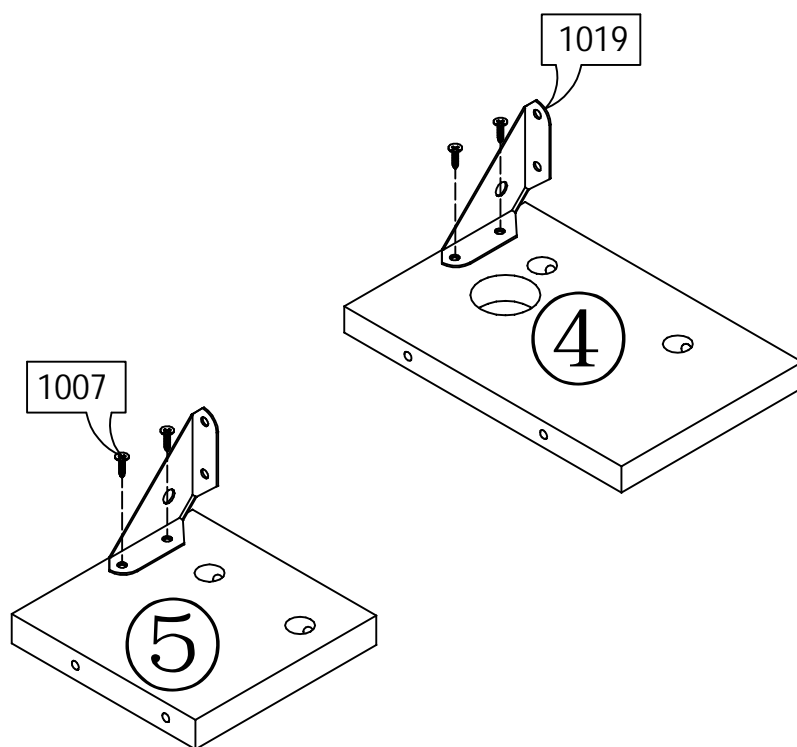

4

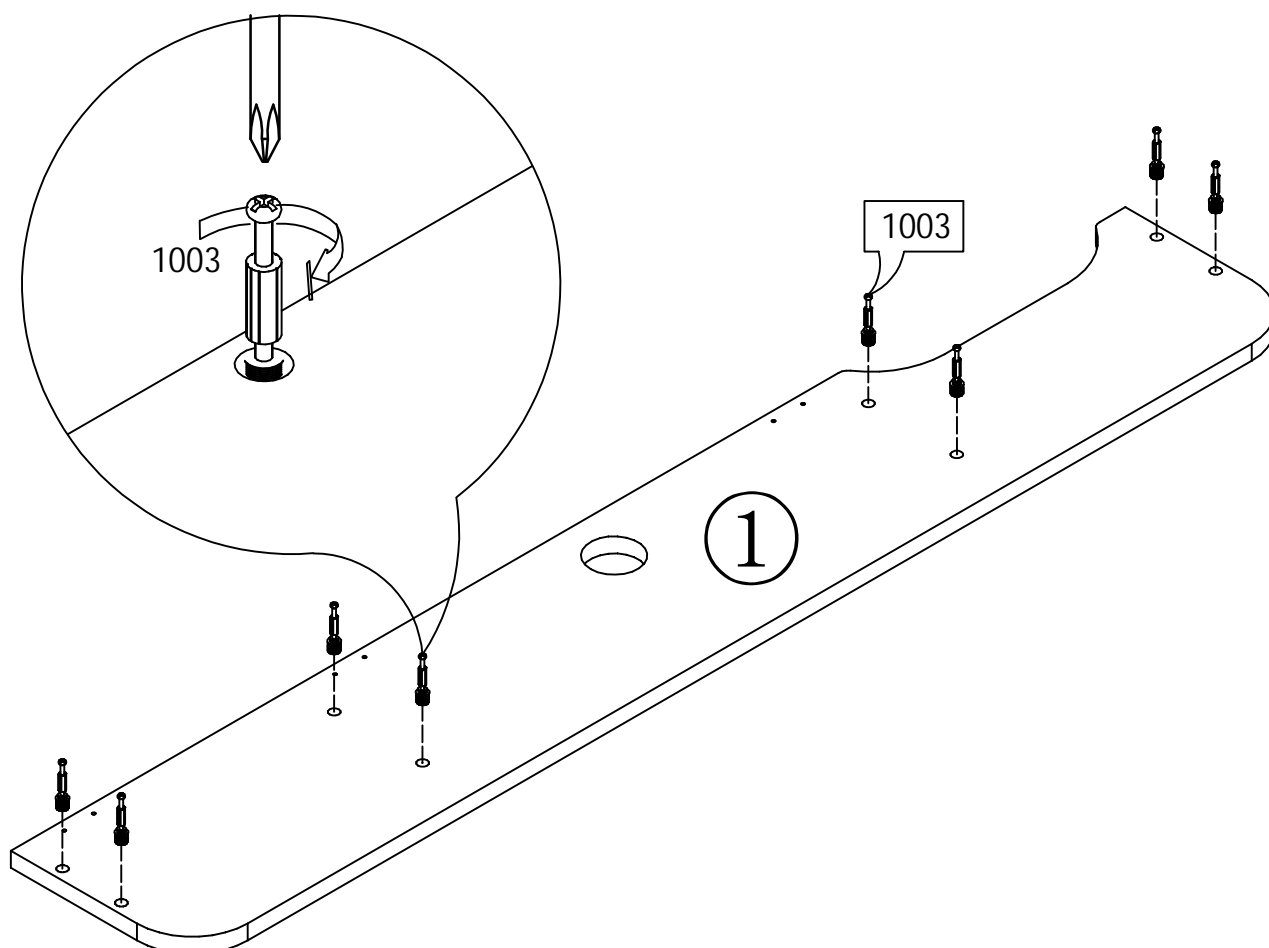

# 3

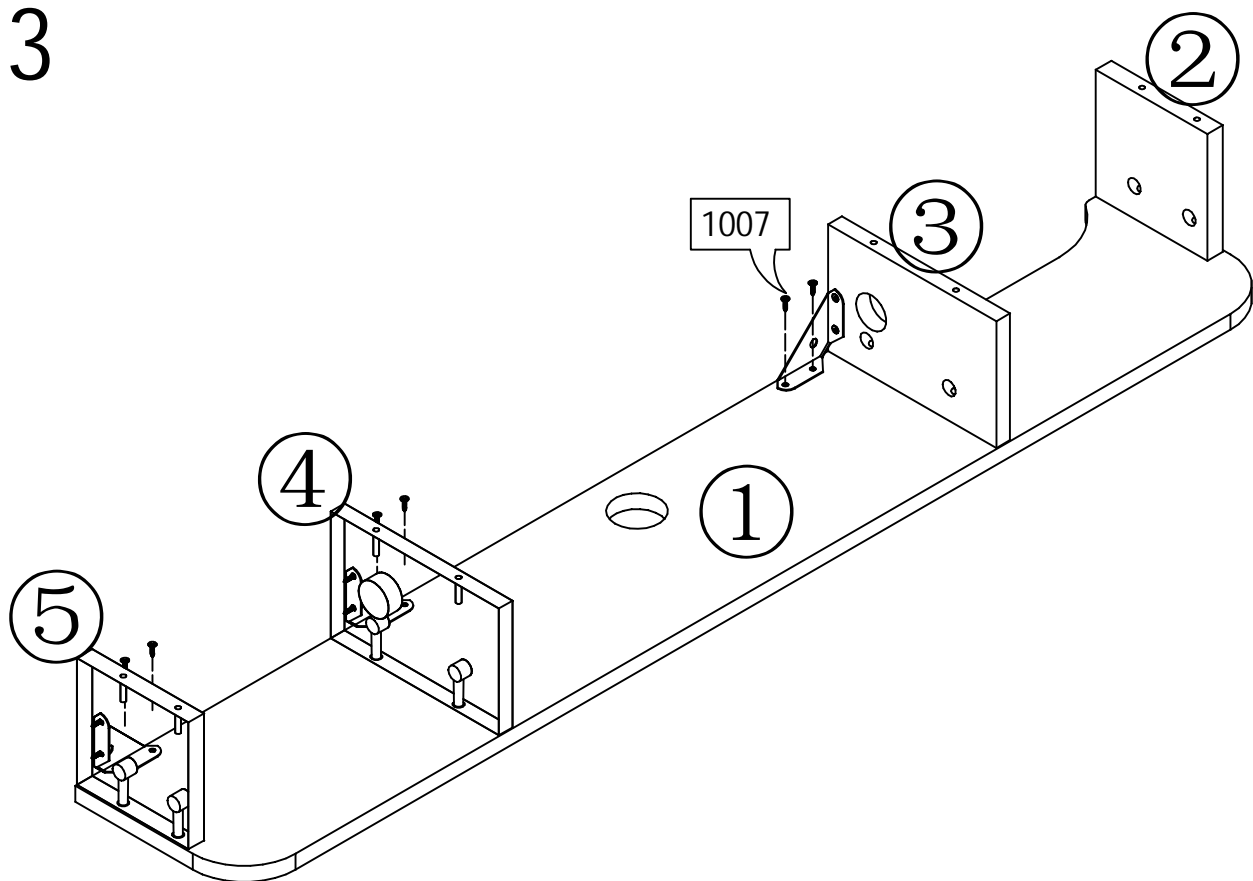

# 4

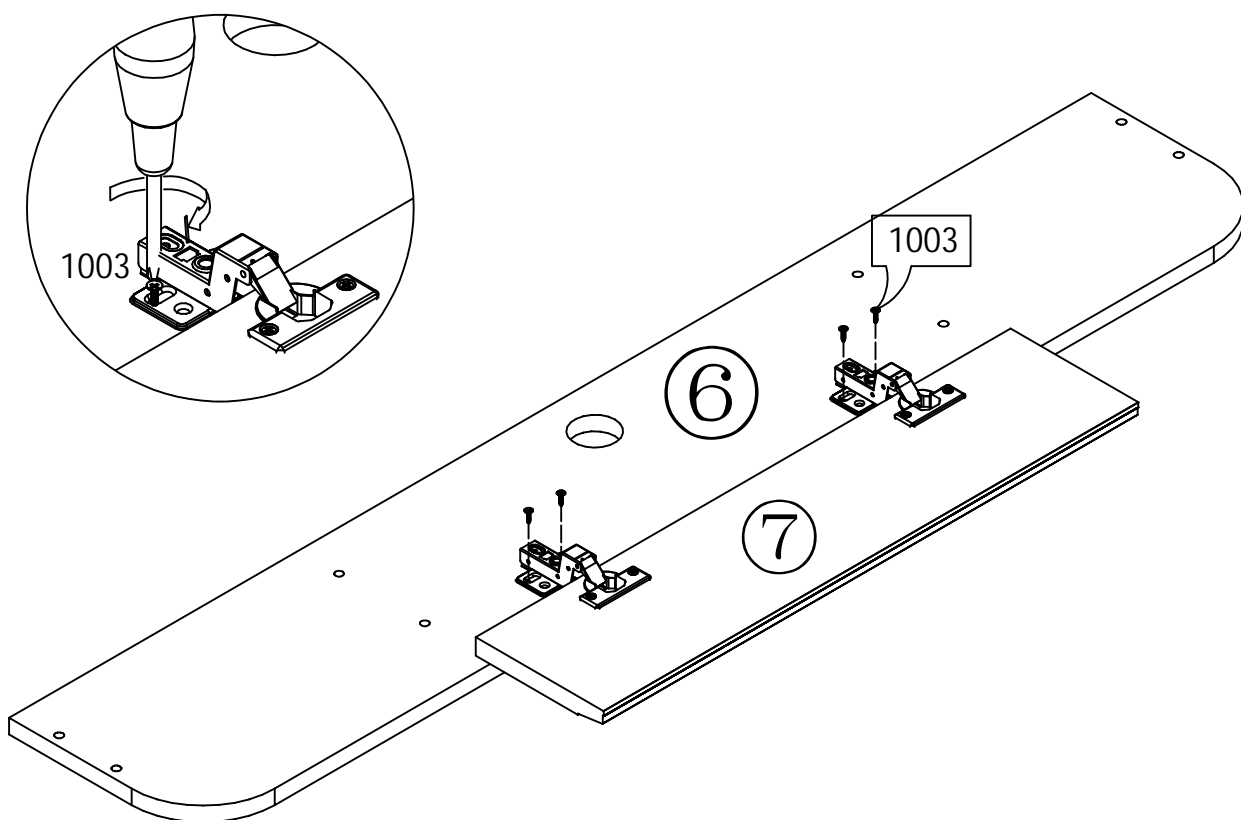

5

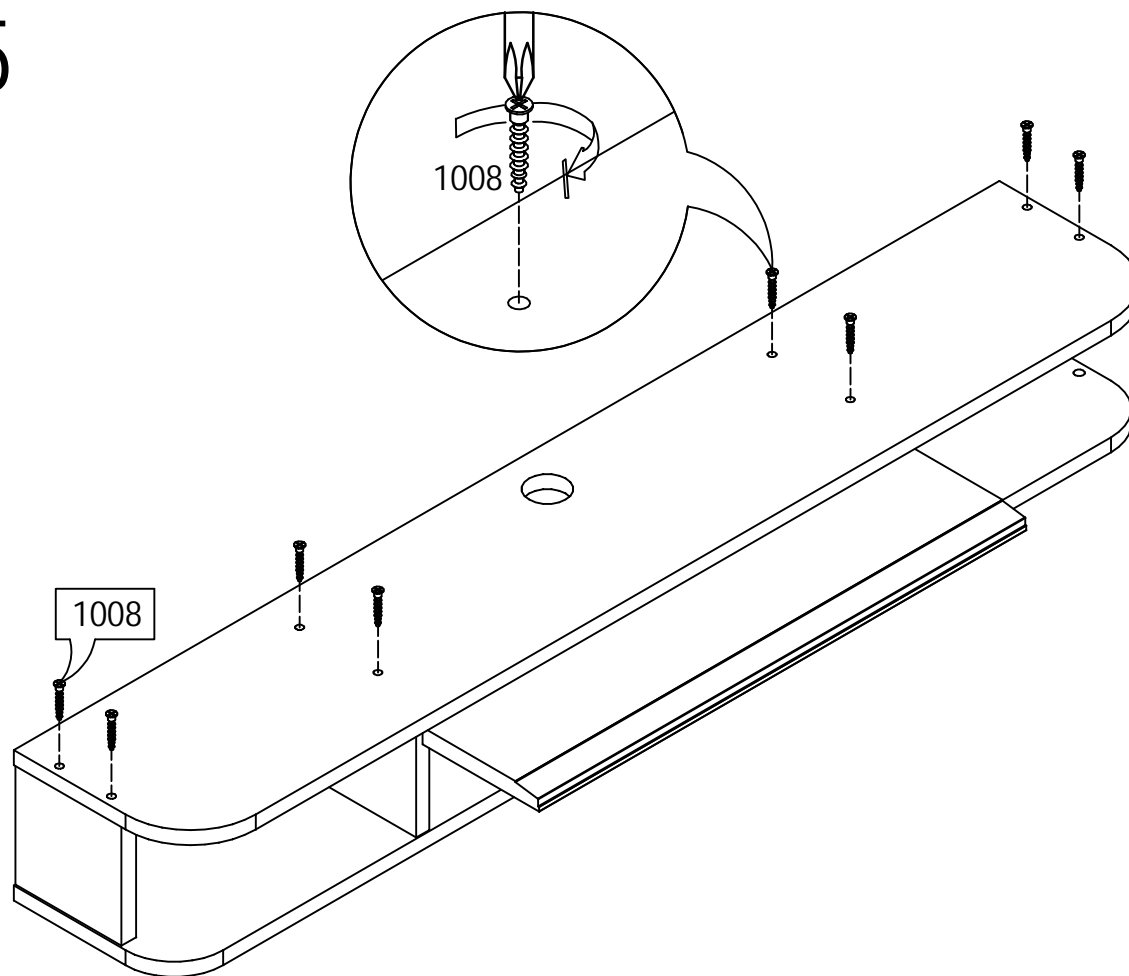

6

This screw adjusts the left and right gap of the door to ensure that the left and right gap of the door is even.

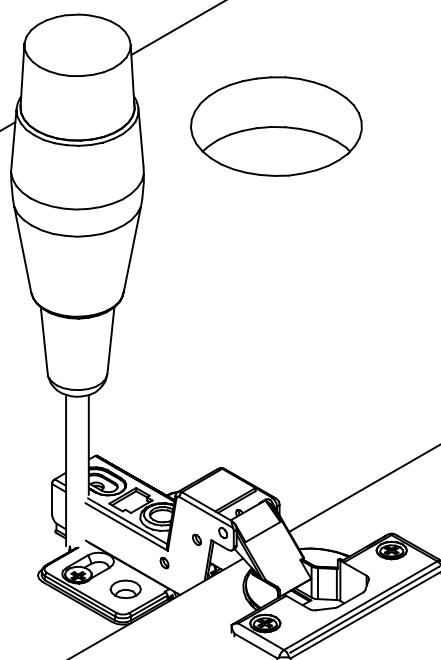



7

The screw in this position can adjust the upper and lower gap of the door to ensure that the upper and lower gap of the door is even.

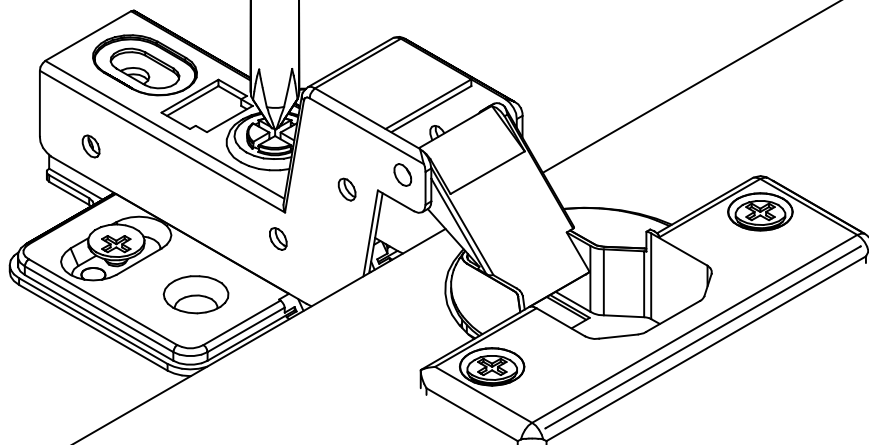

8

This screw adjusts the front and back gap of the door to ensure smooth opening and closing of the door.

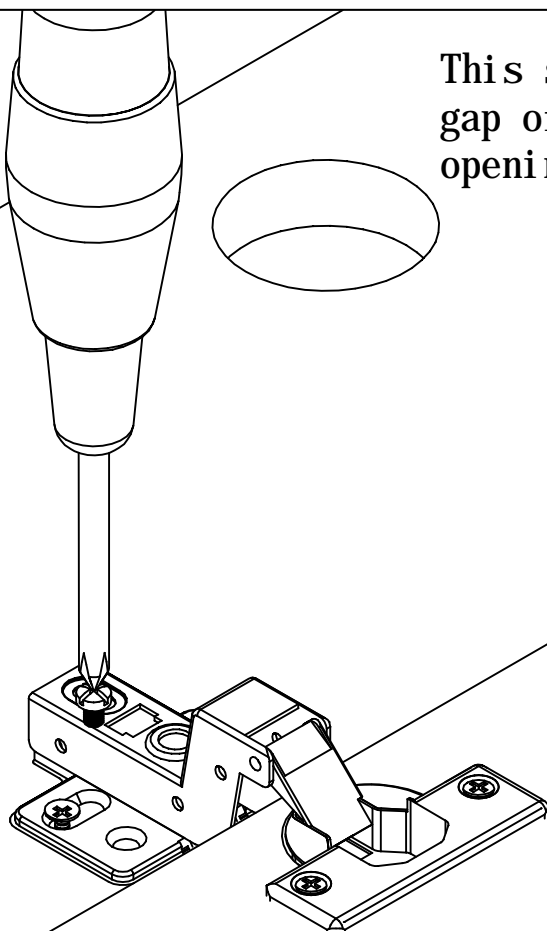

# 9

Locate the hole on the wall of the furniture according to the position of the spirit level

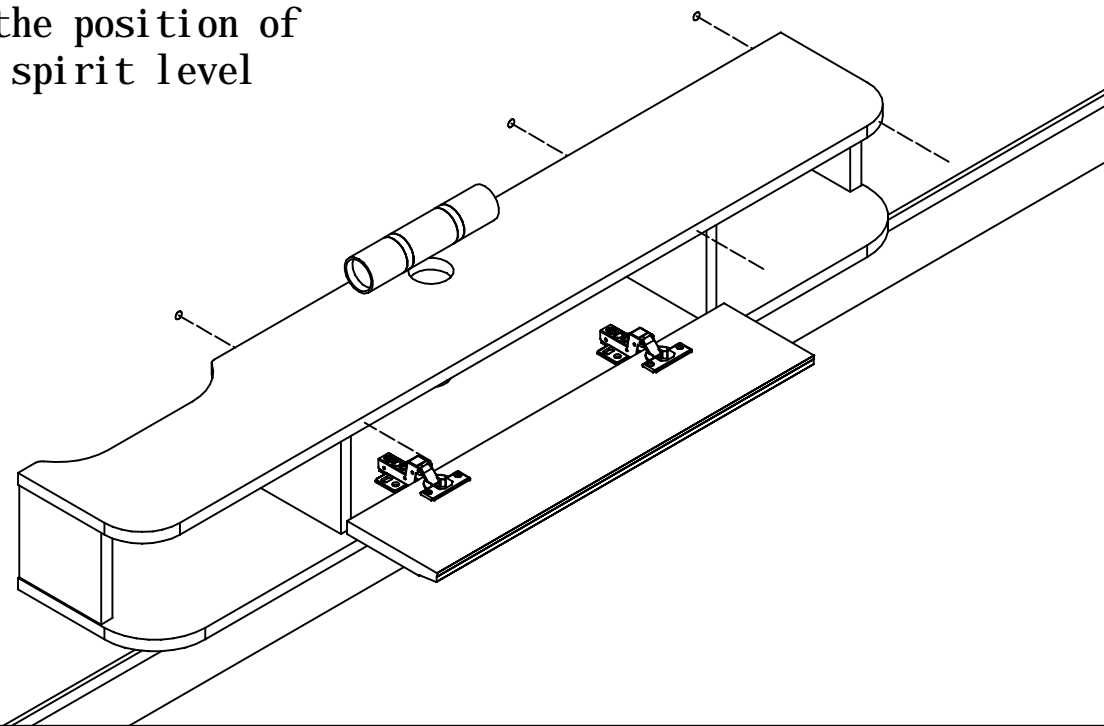

# 10

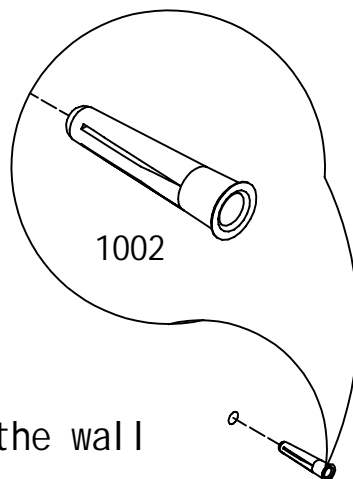

Make 10mm expansion holes on the wall

11

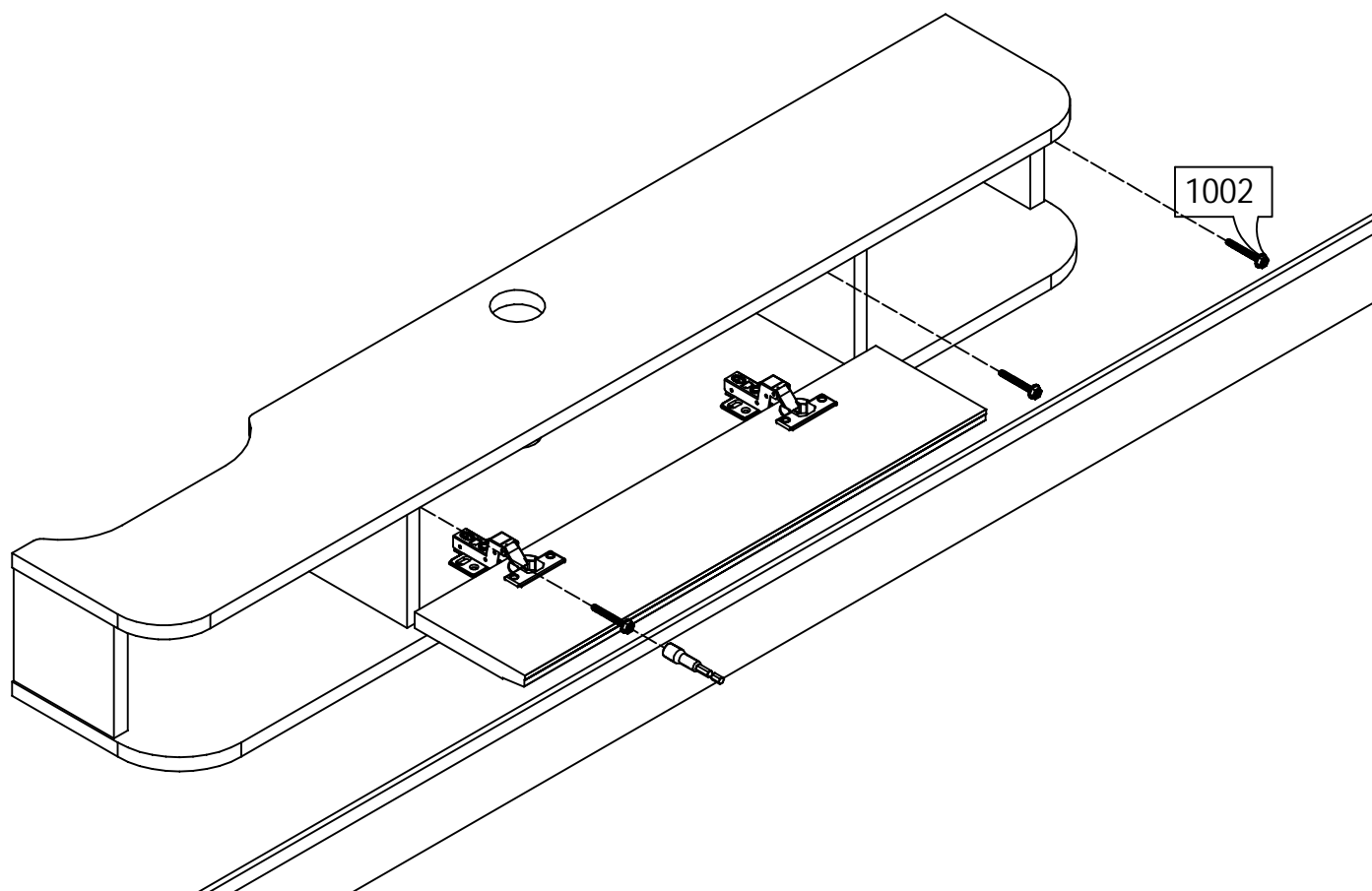

12

