

Tall 6-drawer Chest

Commode haute 6 tiroirs

Cómoda alta de 6 cajones

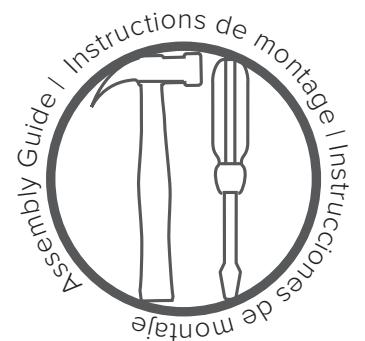
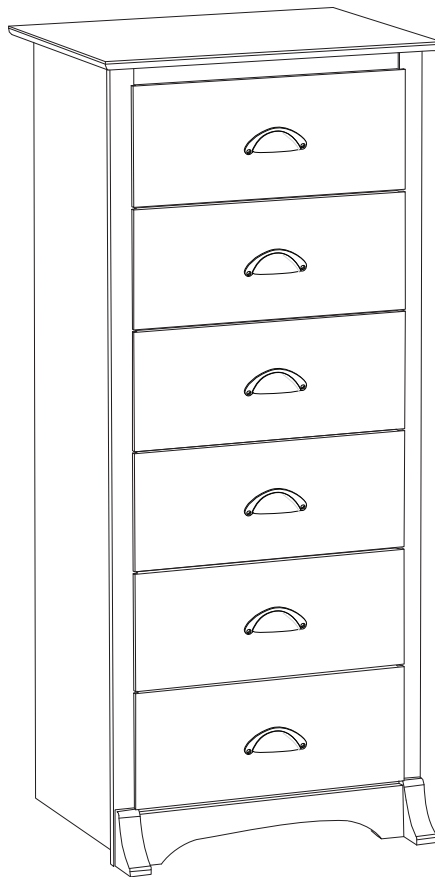
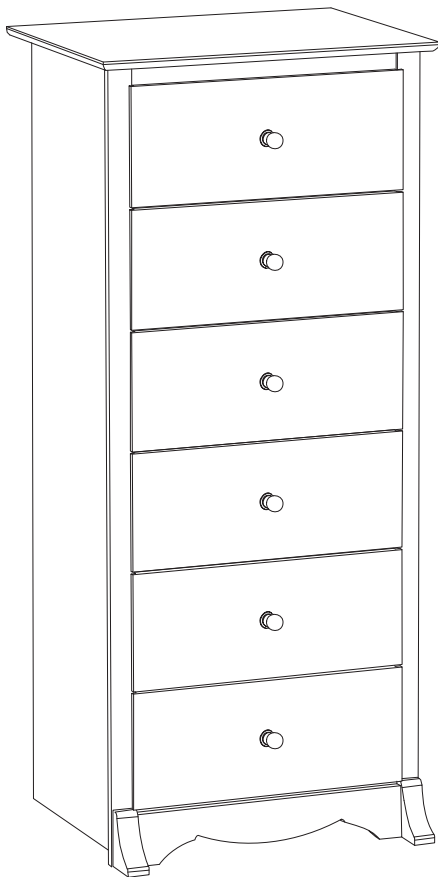

Tools

Vous aurez besoin / Necesitarás

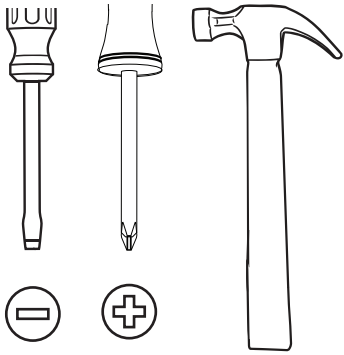

2 person recommended

2 personnes recommandées /

2 personas recomendadas

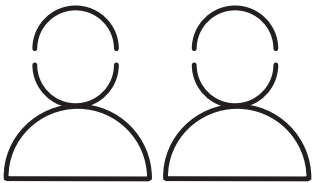

You will need

1. Model Number

uméro de modèlè /
Número de modelo



2. Order Number + Ship-to-Name

Numéro de commande + Expédier au nom
Número de pedido + Envío a nombre

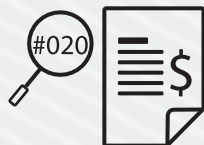

3. Part Number with color code*

Numéro de pièce avec code couleur*
Número de pieza con código de color*

DS-10003-**B**

*Adding colour code to part number

*Ajout d'un code couleur au numéro de pièce

*Adición de código de color al número de pieza



Part Number

Numéro de pièce /
Número de pieza

Color Code

Code couleur /
Código de color

Colour Code Lookup

Recherche de code couleur / Búsqueda de código de color

B for Black
pour Noir /
para Negro

W for White
pour Blanc /
para Blanco

D for Drifted Gray
pour Gris vieilli /
para Gris madera

CN for Cherry
pour Cerise /
para Cereza

O for Natural Oak
pour Chêne naturel /
para Roble Natural

A for Washed White
pour Blanc lavé /
para Blanco lavado

E for Espresso
pour Espresso /
para Espresso

H for Washed Black
pour Noir délavé /
para Lavado negro

Parts

Pièces

Piezas

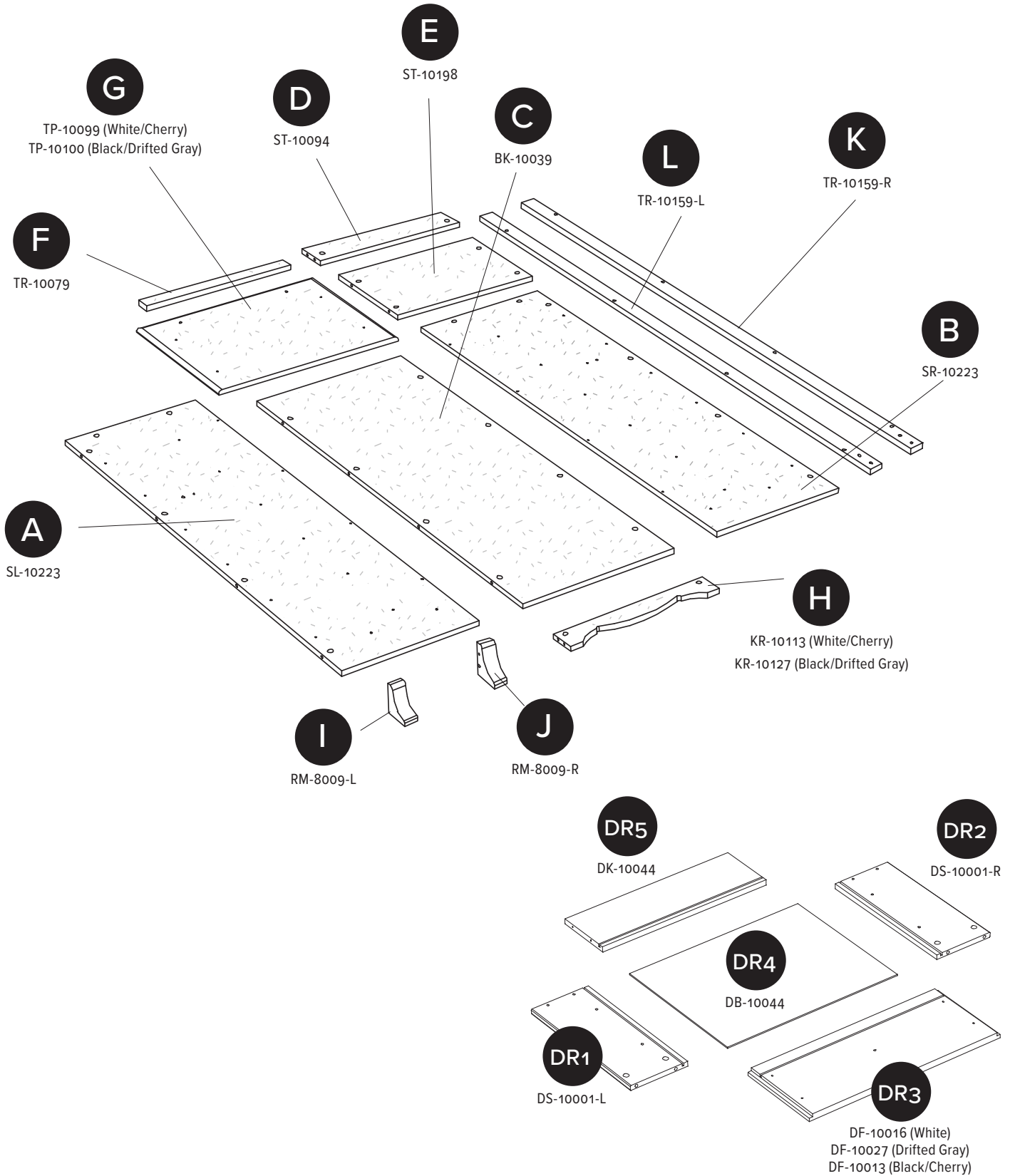

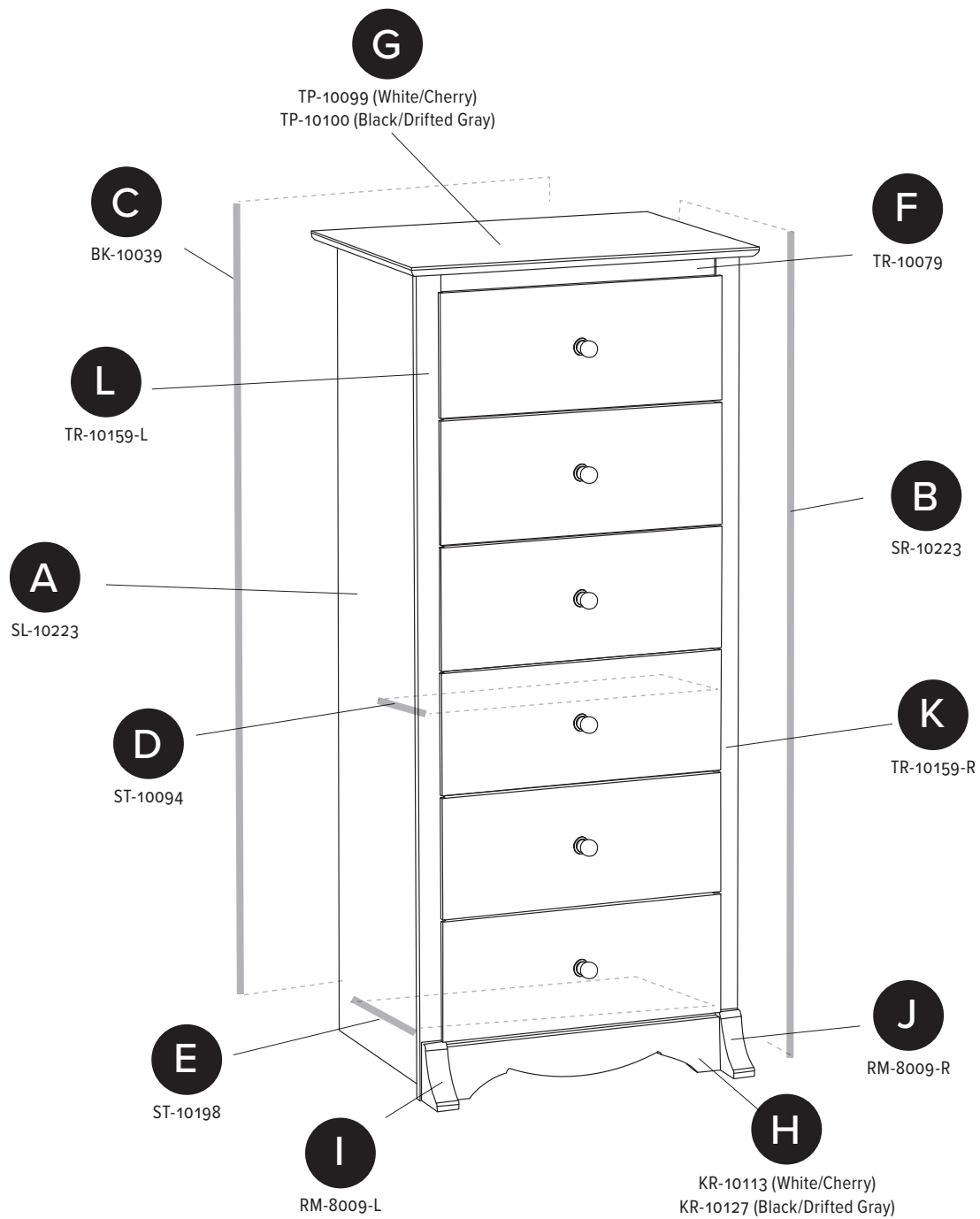

Calling us for parts?

We will need the part number with colour code added

Si vous devez commander des pièces chez nous, ajoutez un code de couleur au numéro de pièce /
Si necesita pedirnos piezas, añada el código de color al número de pieza

DS-10003 - B

Part Number
Numéro de pièce /
Número de pieza

Color Code
Code couleur/
Código de color

Colour Code Lookup

Recherche de code couleur / Búsqueda de código de color

B for Black
pour Noir /
para Negro

W for White
pour Blanc /
para Blanco

D for Drifted Gray
pour Gris vieilli /
para Gris madera

CN for Cherry
pour Cerise /
para Cereza

O for Natural Oak
pour Chêne naturel /
para Roble Natural

A for Washed White
pour Blanc lavé /
para Blanco lavado

E for Espresso
pour Espresso /
para Espresso

H for Washed Black
pour Noir délavé /
para Lavado negro

Hardware

Quincaillerie

Piezas de Conexión

28 X



RM-0103

2 X

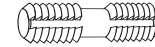

RM-0072

20 X

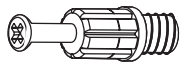

RM-0501
GREEN

48 X



RM-0074

8 X

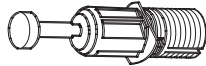

RM-0583
BLUE

6 X



RM-0069

2 X



RM-0001

24 X

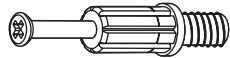

RM-0500
BLACK

24 X



RM-0715

6 X

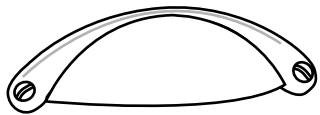

RM-0847
for Drifted Gray

OR
ou / o

6 X

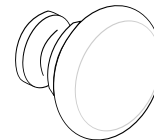

RM-0464 for Black
RM-0625 for Cherry & White

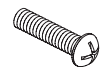

RM-0465

24 X



RM-0504

6X

**Drawer Slides Set
(Blue Wheels)**

Ensemble de glissières de tiroir (roues bleues)

Juego de guías para cajones (ruedas azules)

RM-0469-G

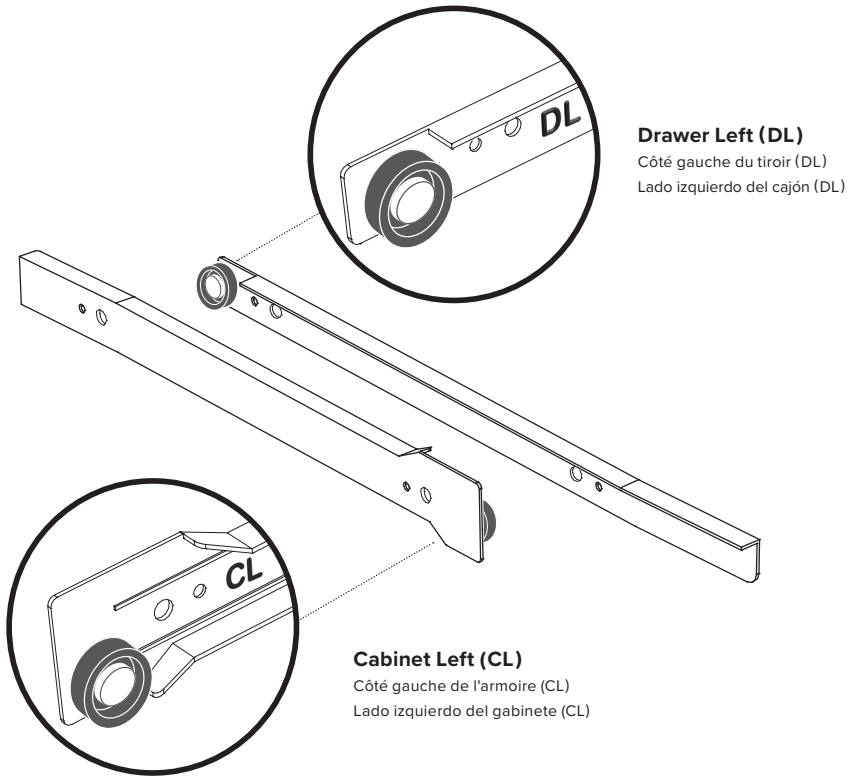

6X

**Drawer Slides Set
(Red Wheels)**

Ensemble de glissières de tiroir (roues rouges)

Juego de guías para cajones (ruedas rojas)

RM-0469-G

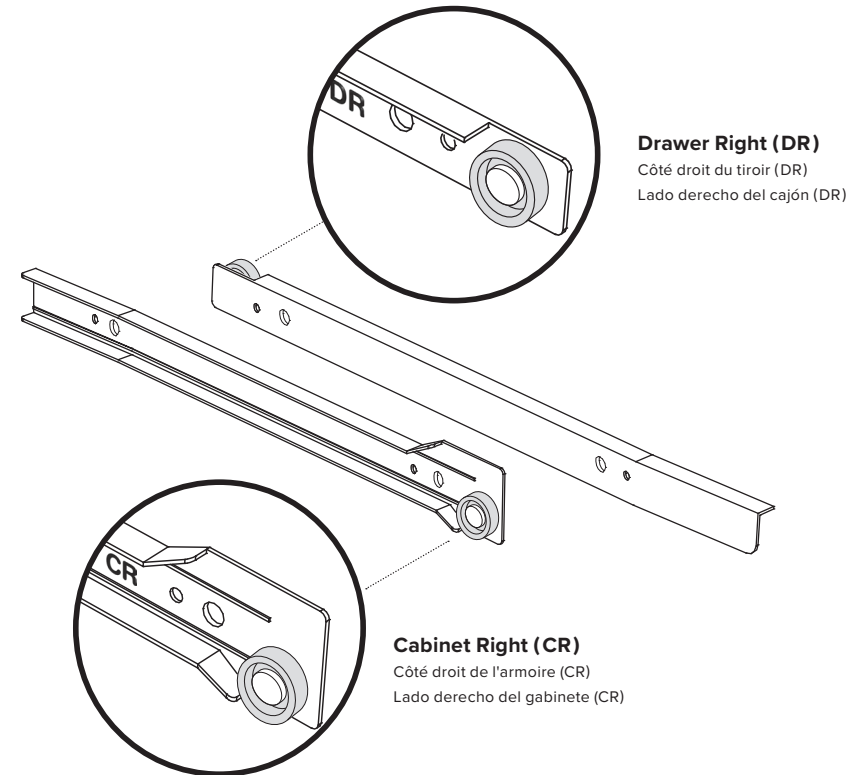

1X

Tipover Restraint Kit

Kit anti-basculament

Kit de sujeción contra volcaduras

HP-1088-LB

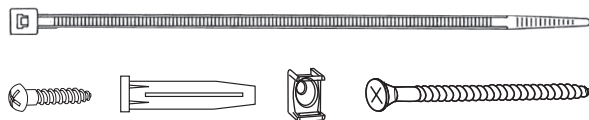

Assemble in 22 steps

Assemblage en 22 étapes

Montar en 22 pasos



**Let's
start!**

Commençons!

¡Comencemos!

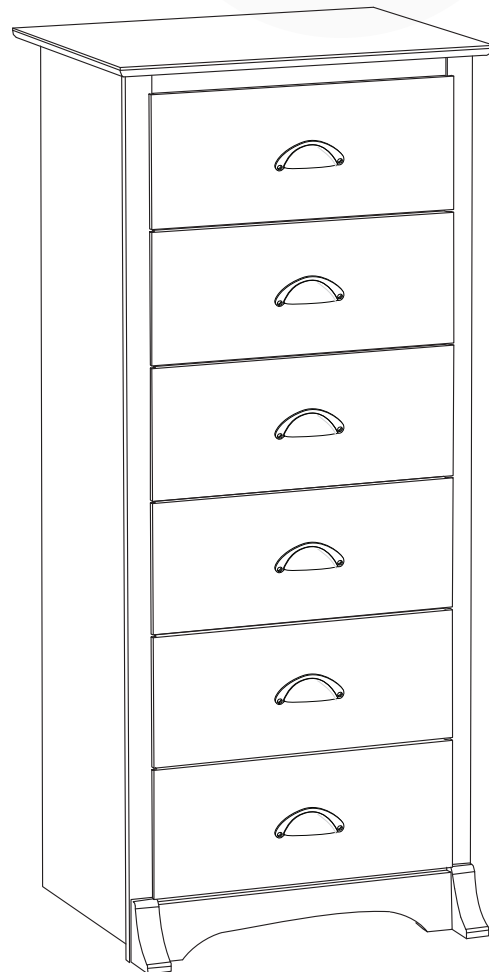
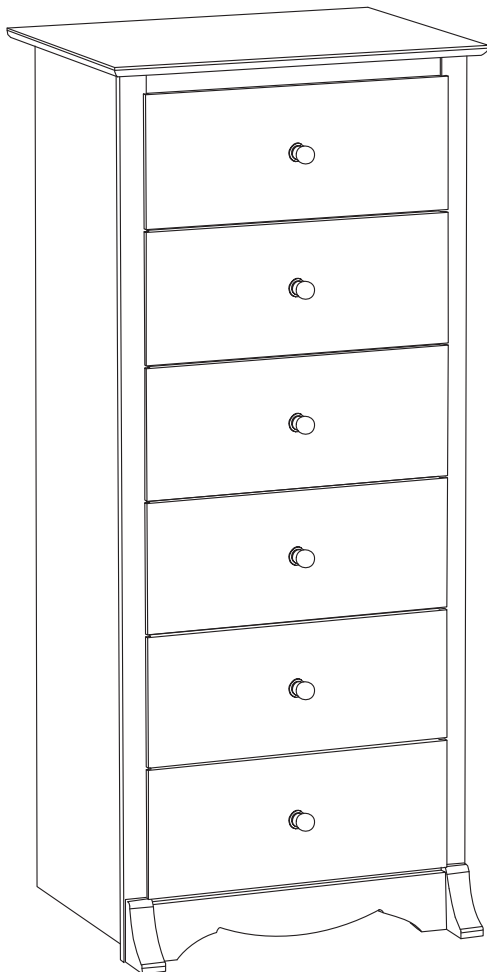

1

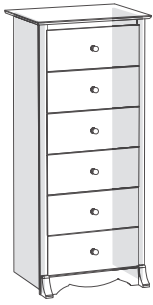

RM-0103



12X

RM-0501
GREEN

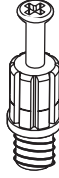

14X

RM-0069



2X

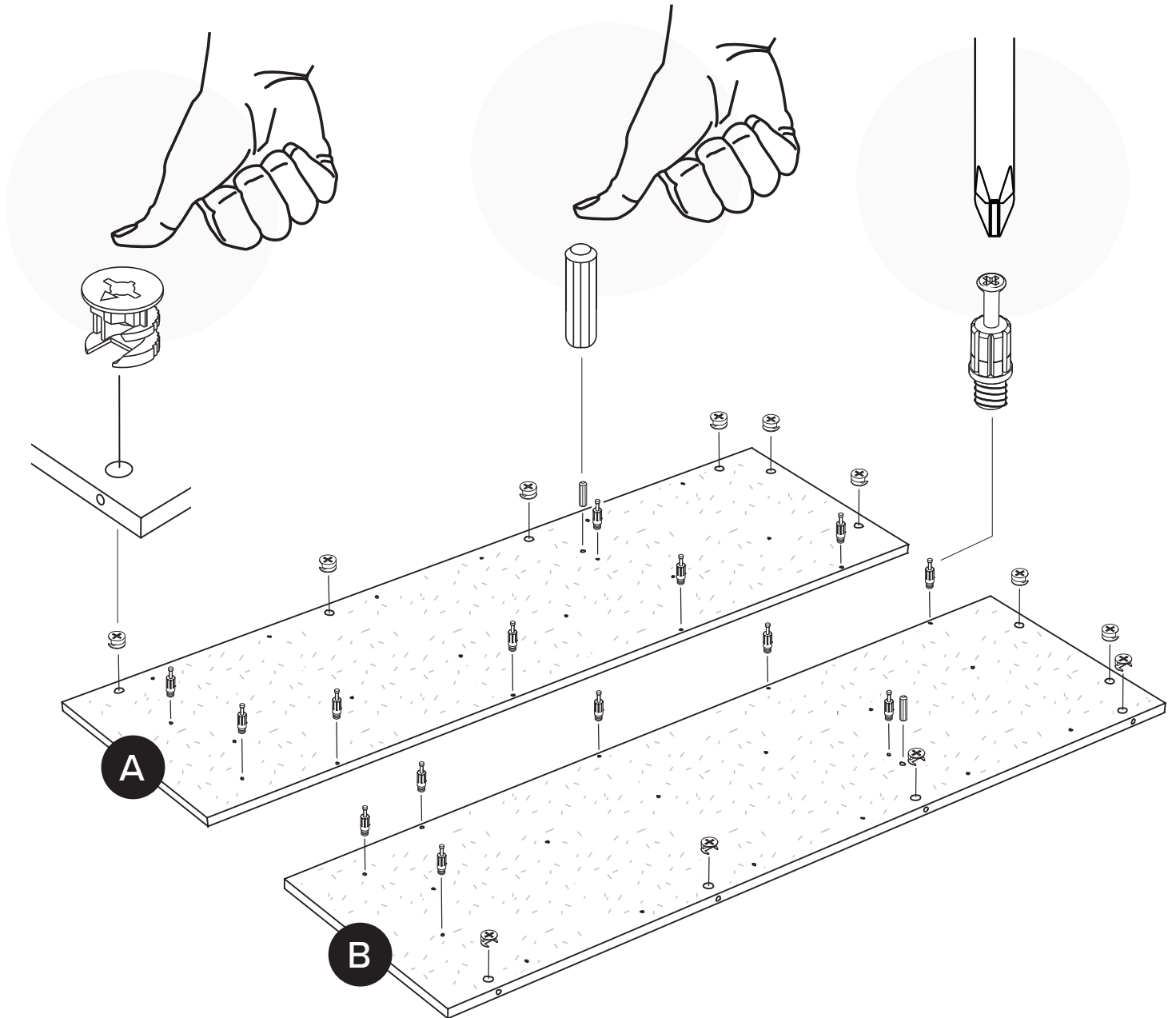

2

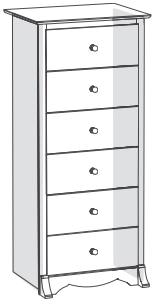

24X



RM-0074

6X

Blue Wheel Slider Cabinet Left (CL)

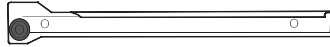

6X

Red Wheel Slider Cabinet Right (CR)

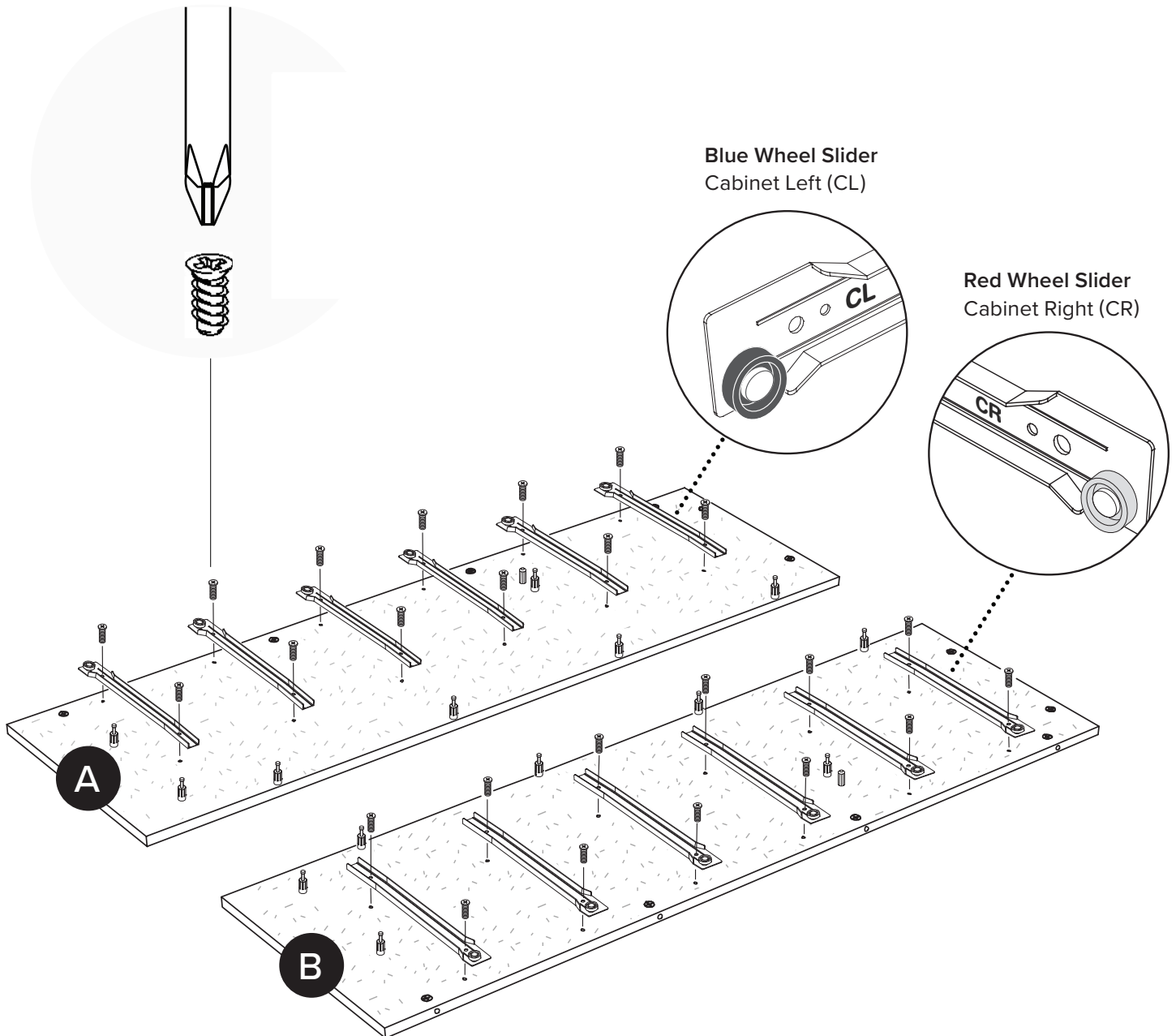
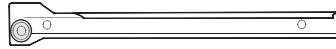

3



RM-0103



8X

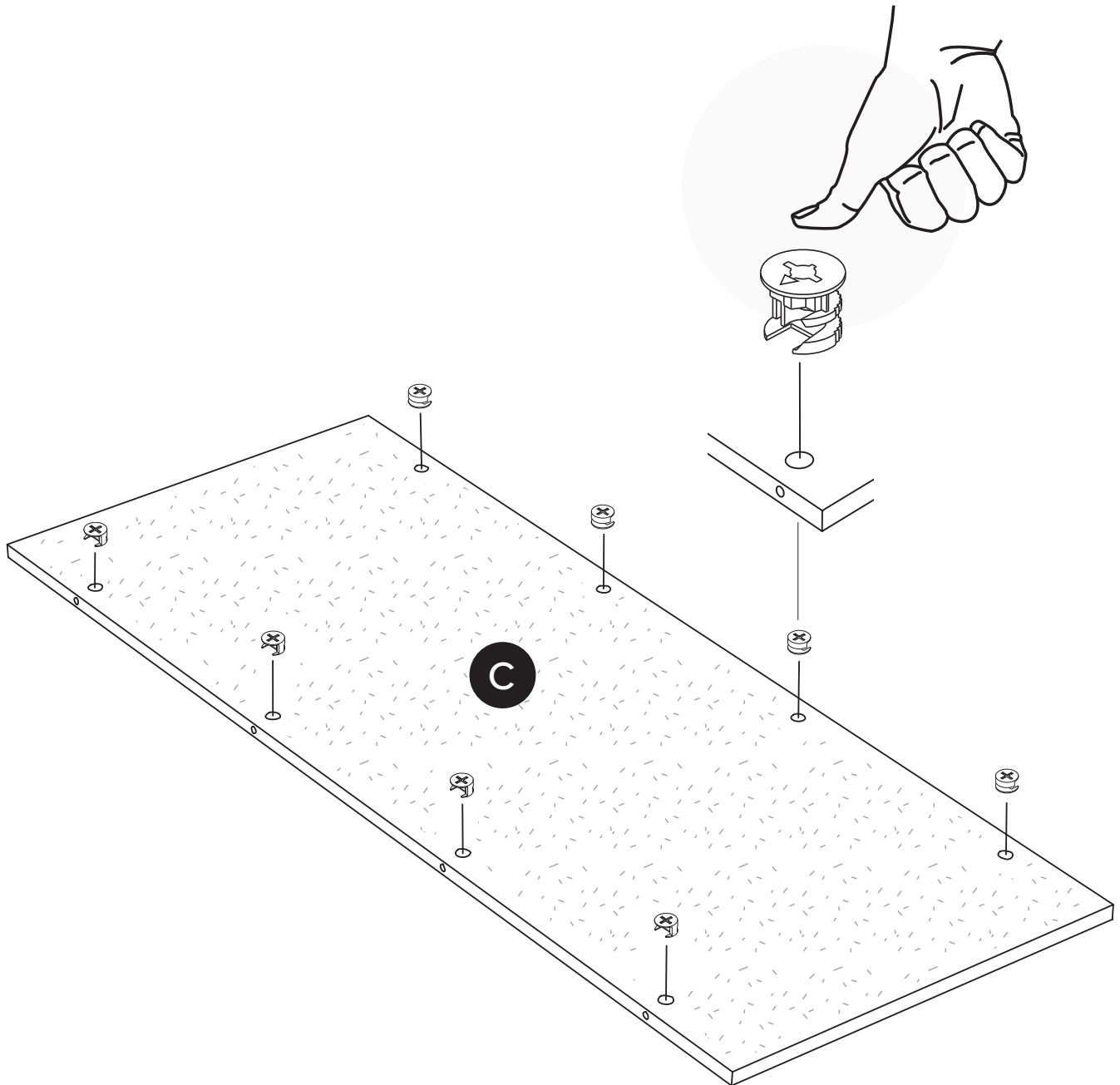

4

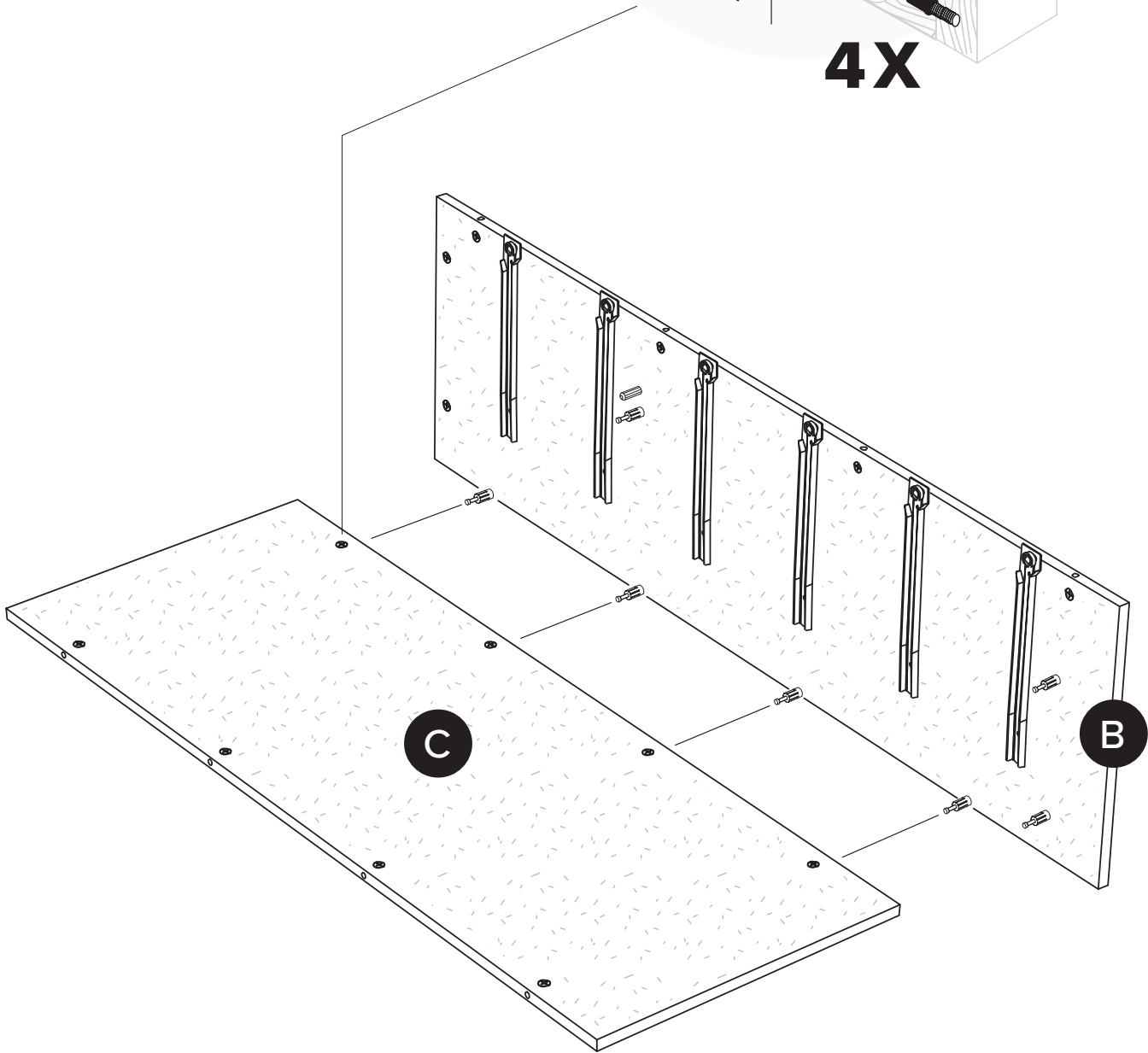
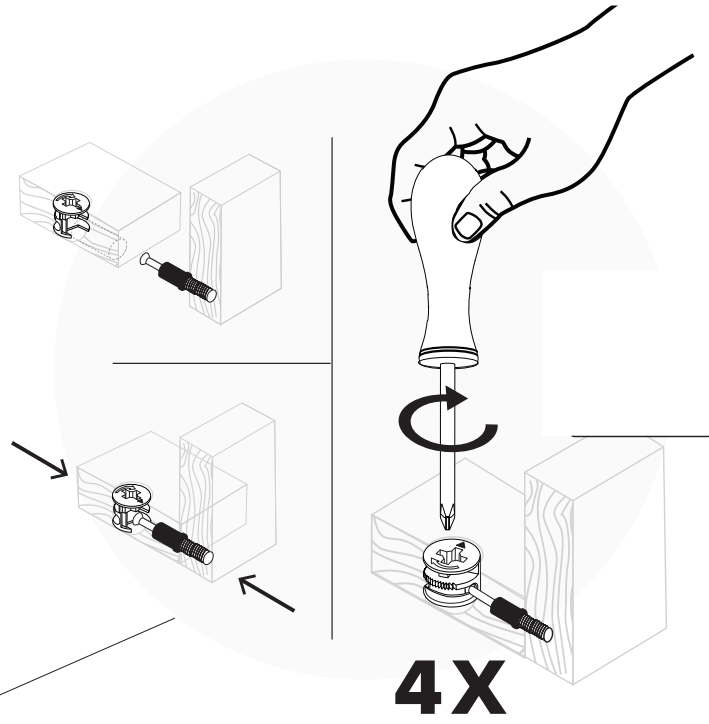

5

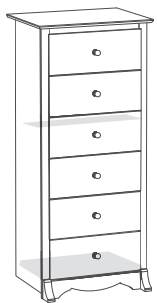

RM-0103



6X

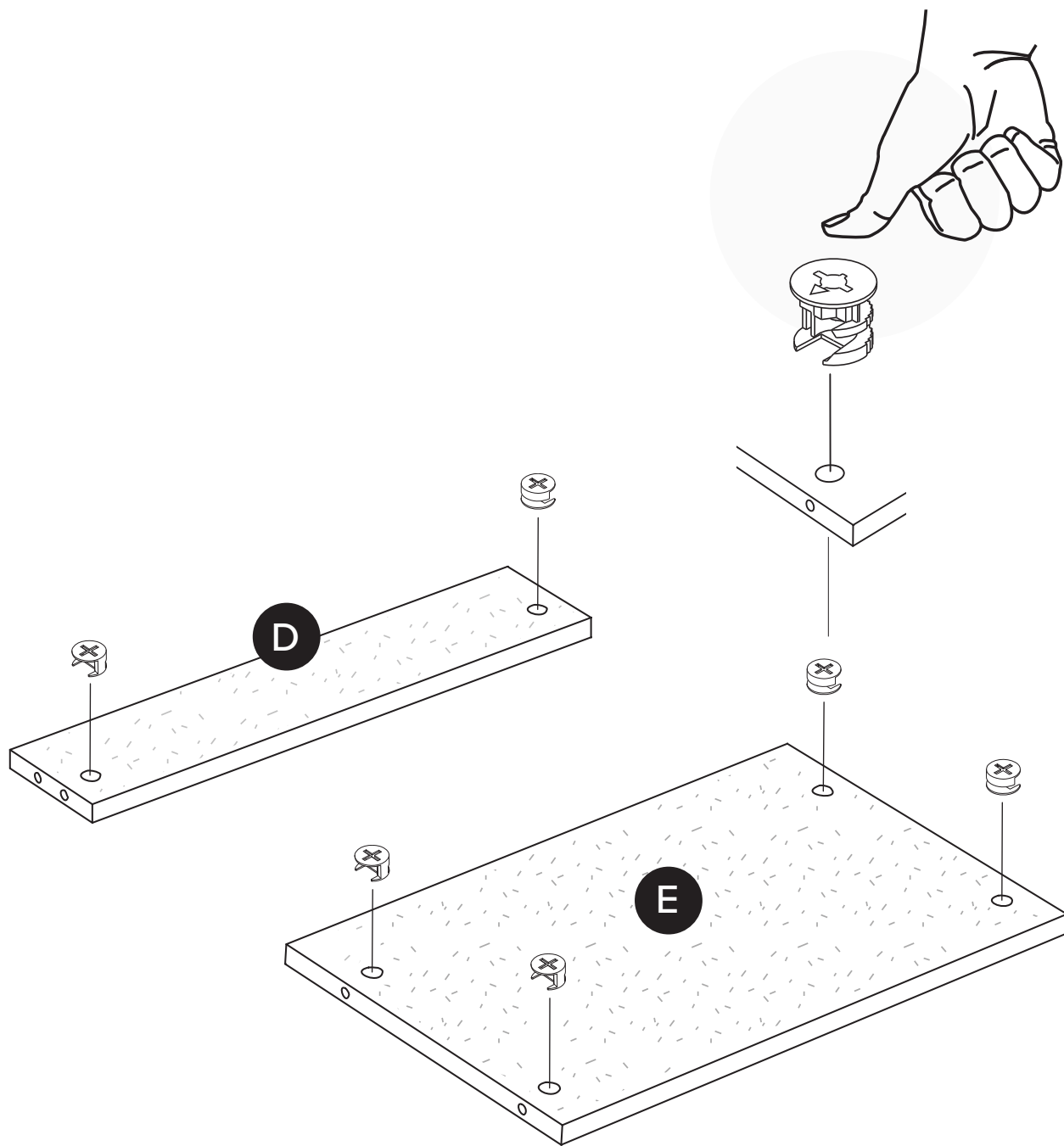

6

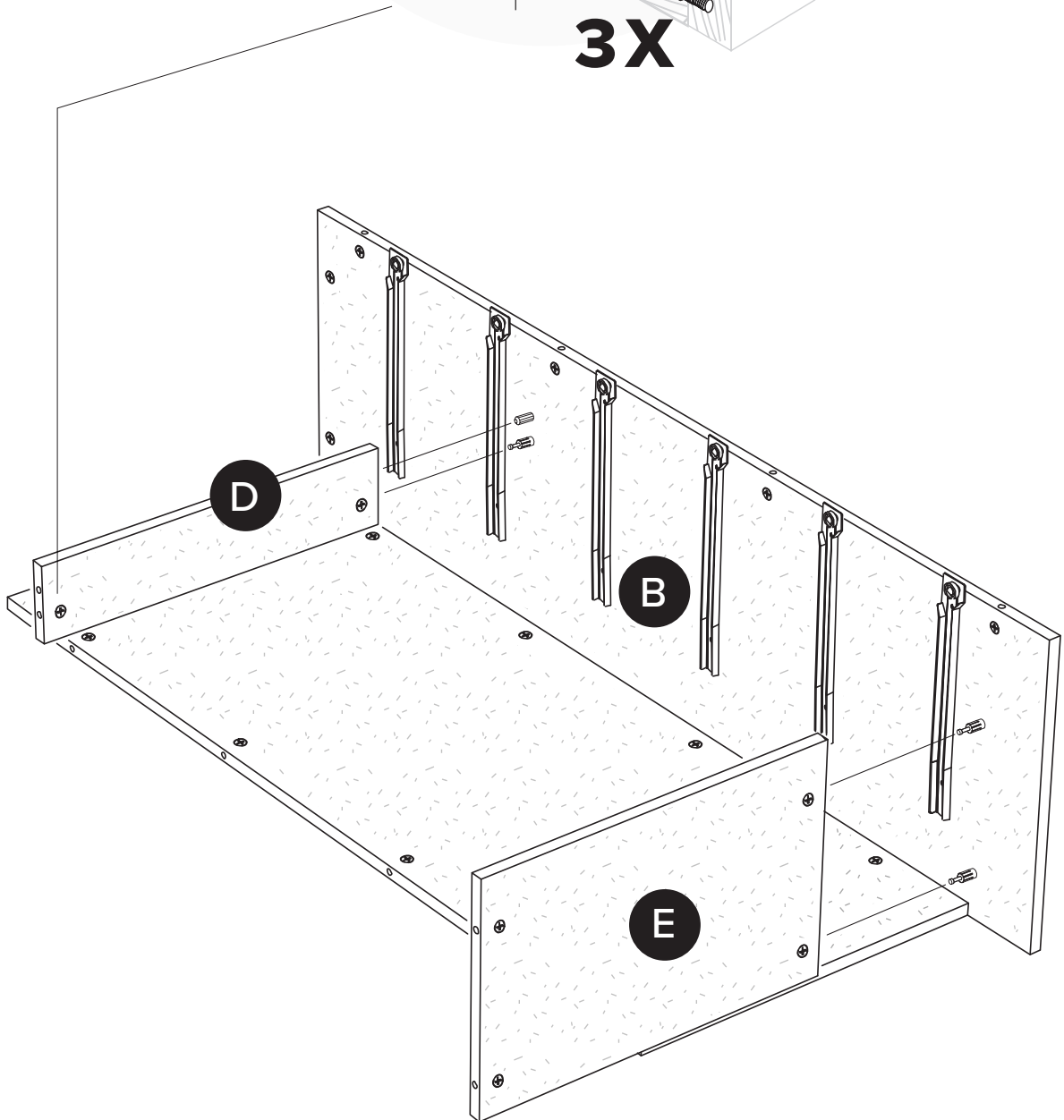
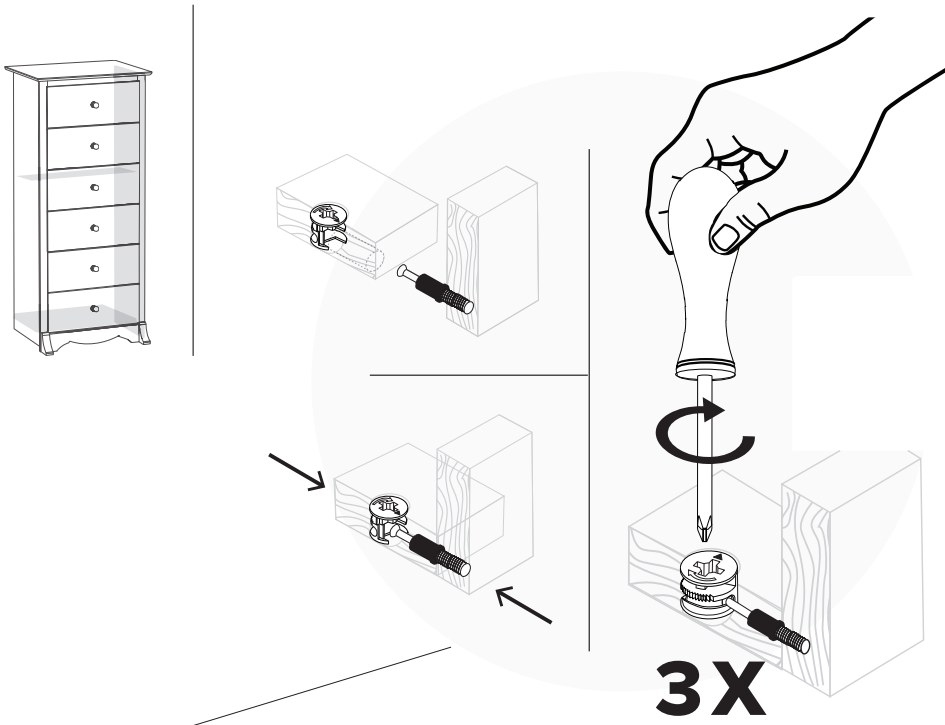

7

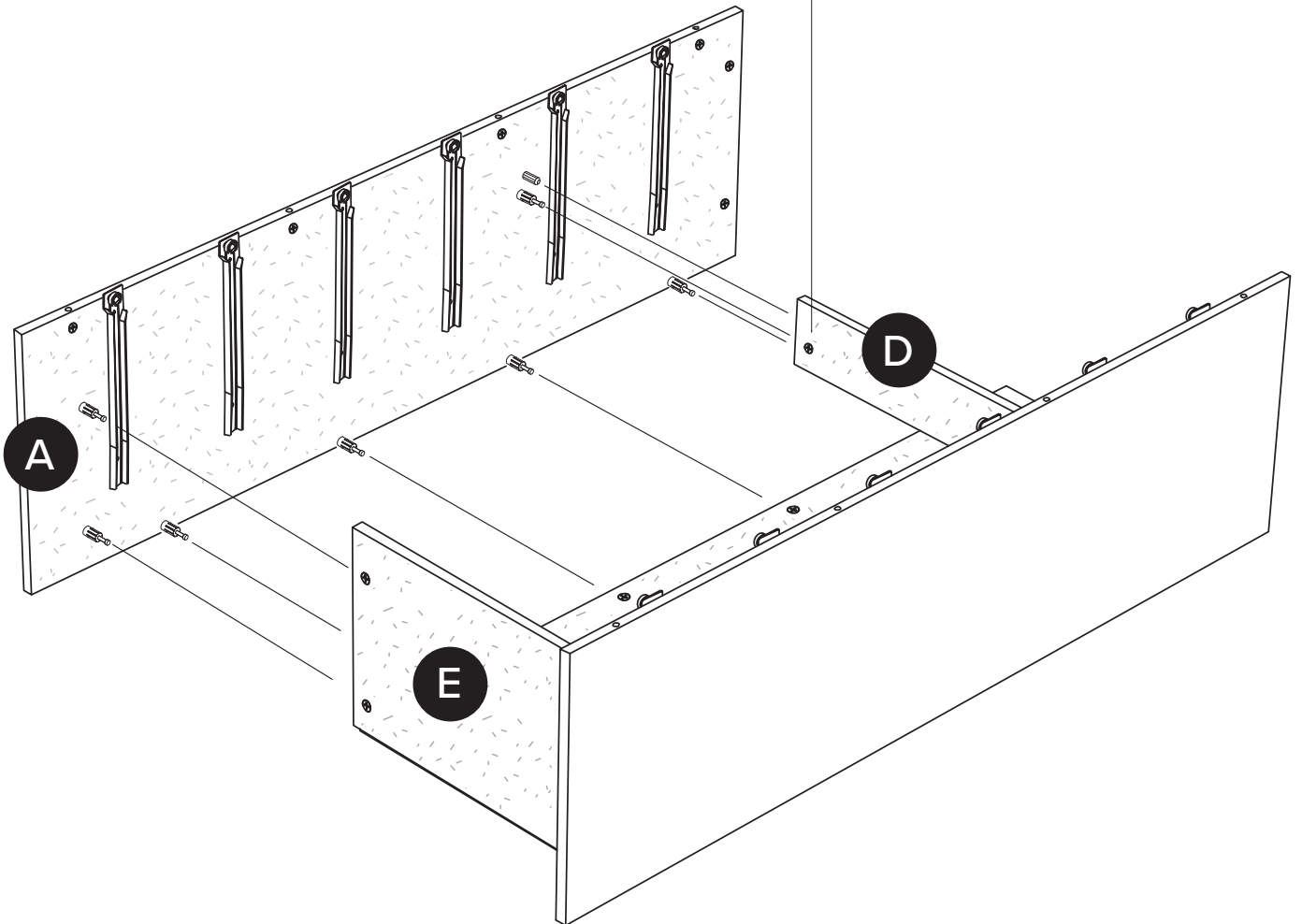
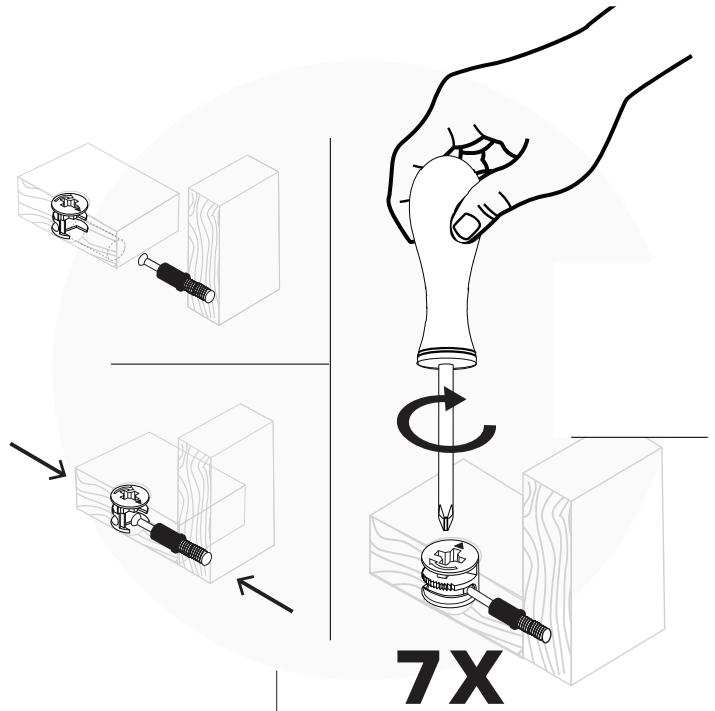
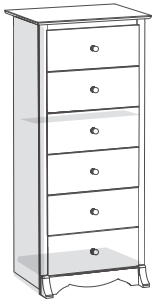

8

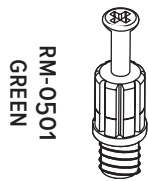
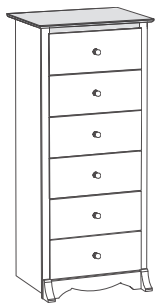

RM-0501
GREEN

4X

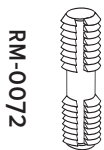

RM-0072

2X

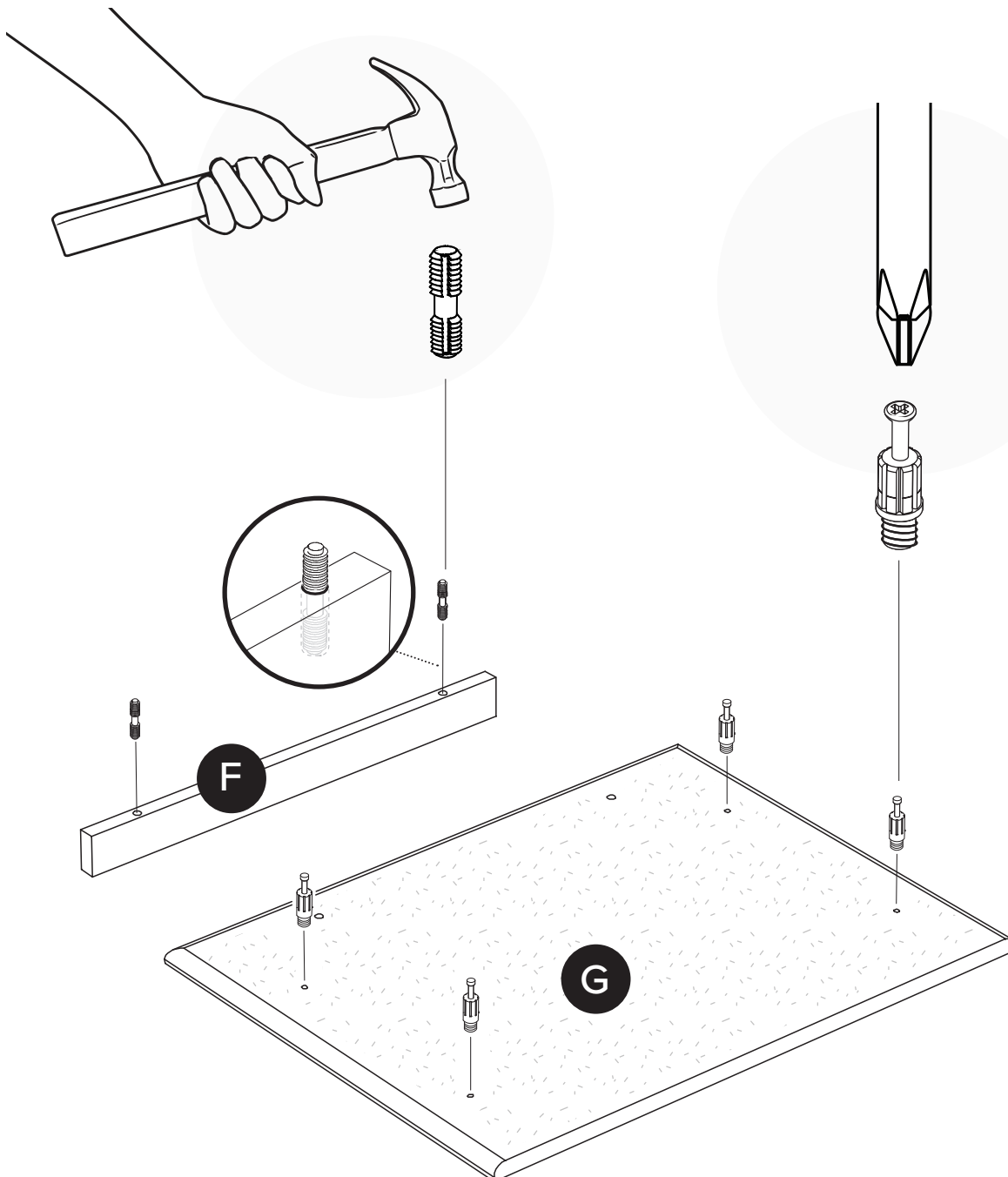

9

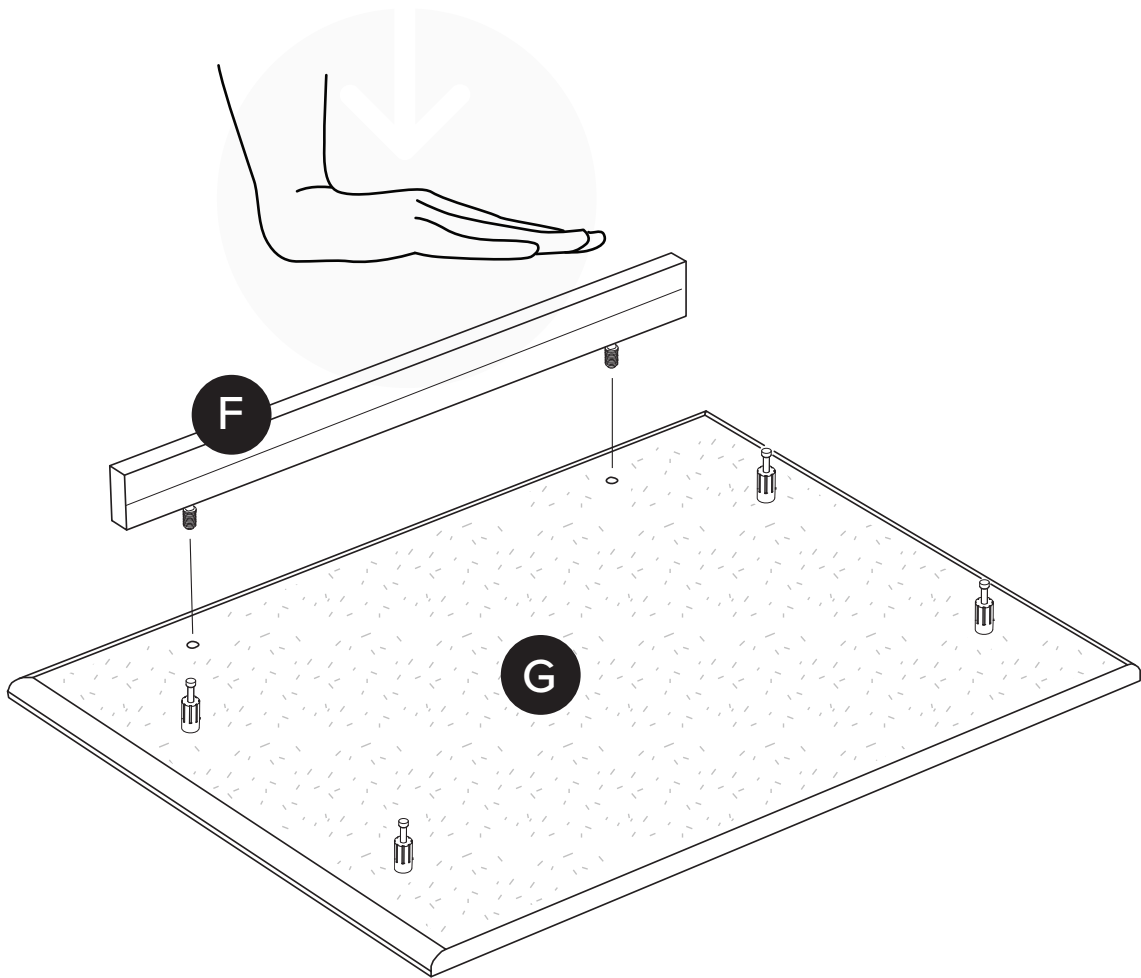
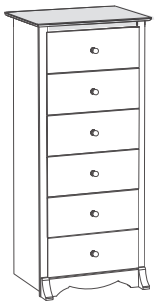

10

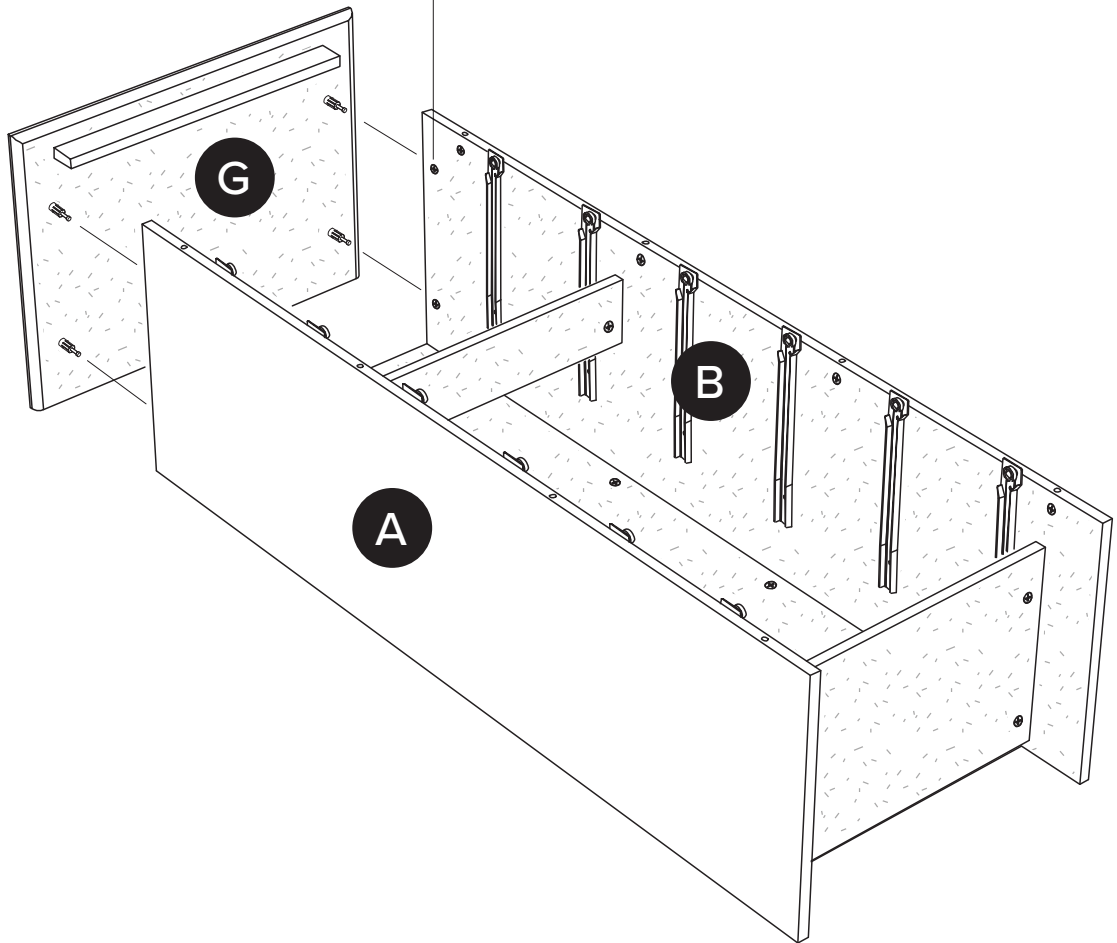
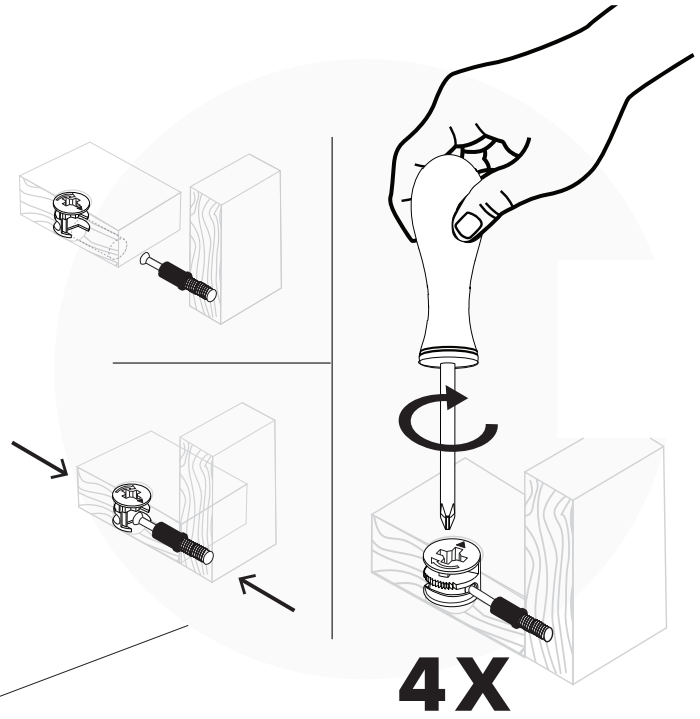
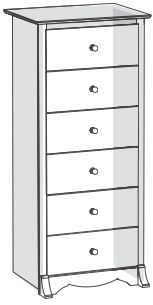

11

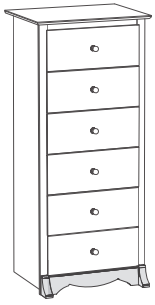

RM-0103



2X

RM-0501
GREEN



2X

RM-0069



2X

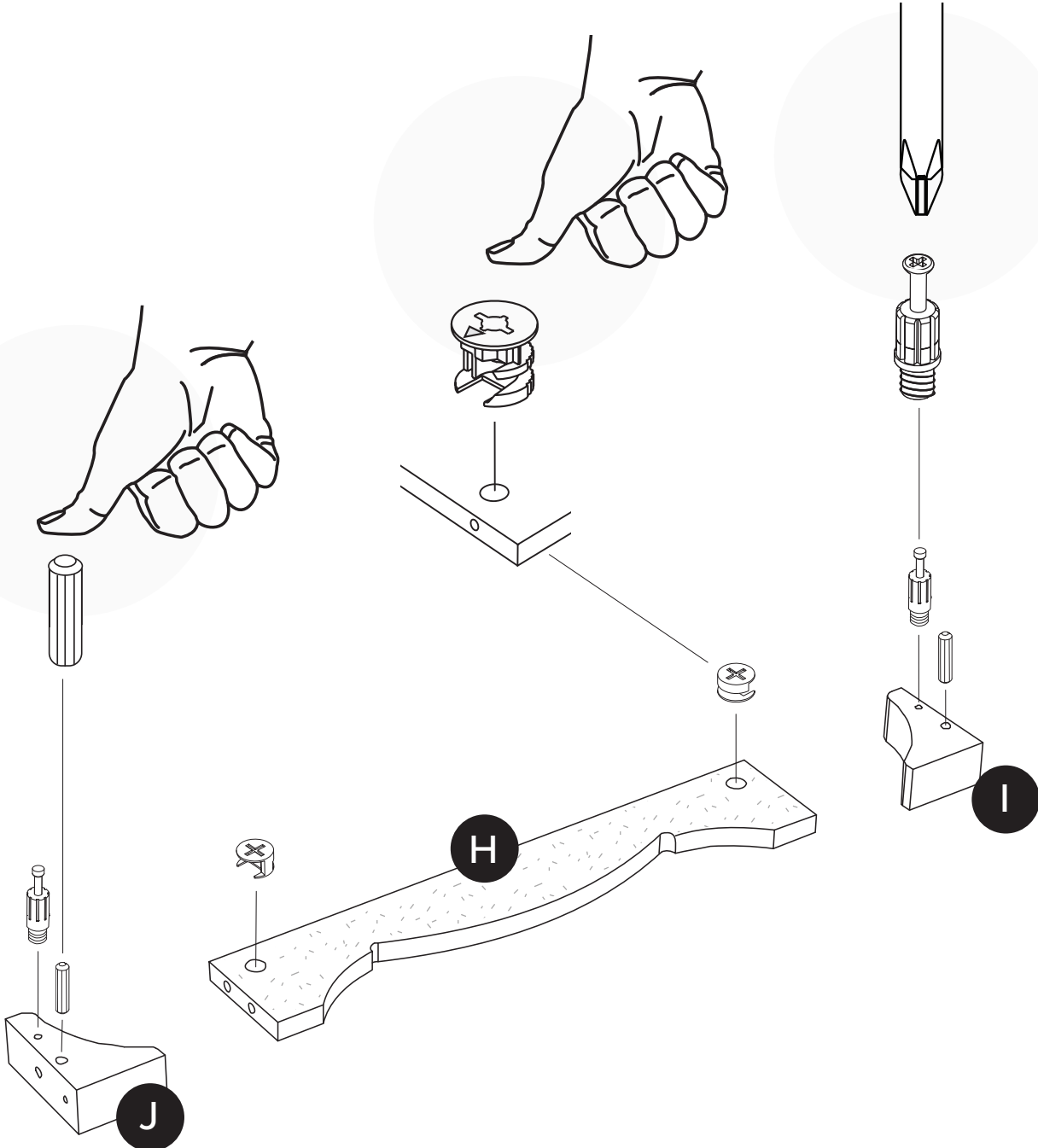

12

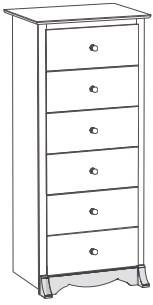

RM-0069

2X

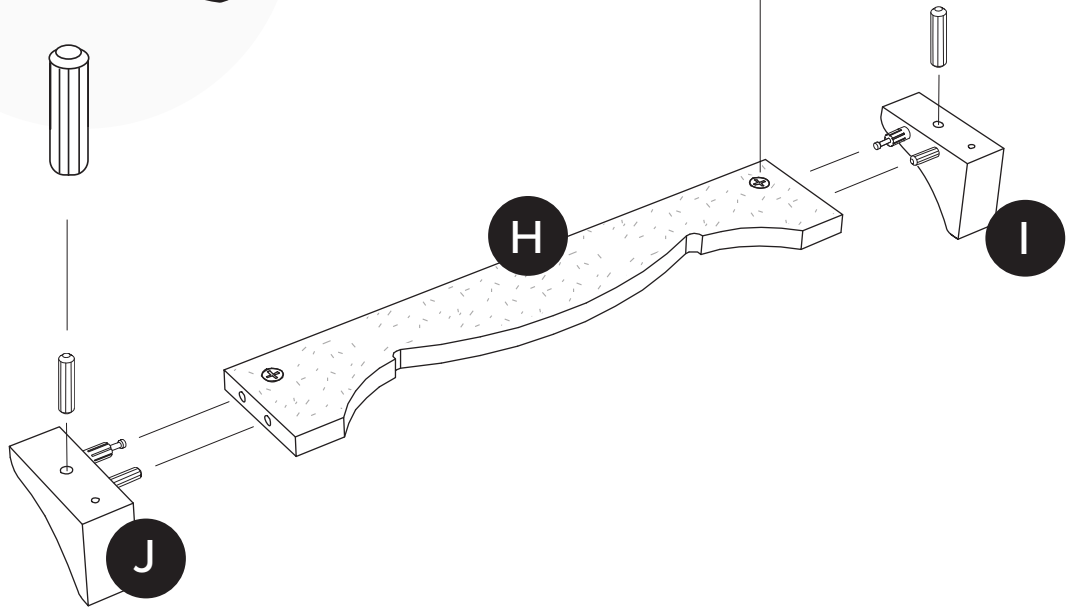
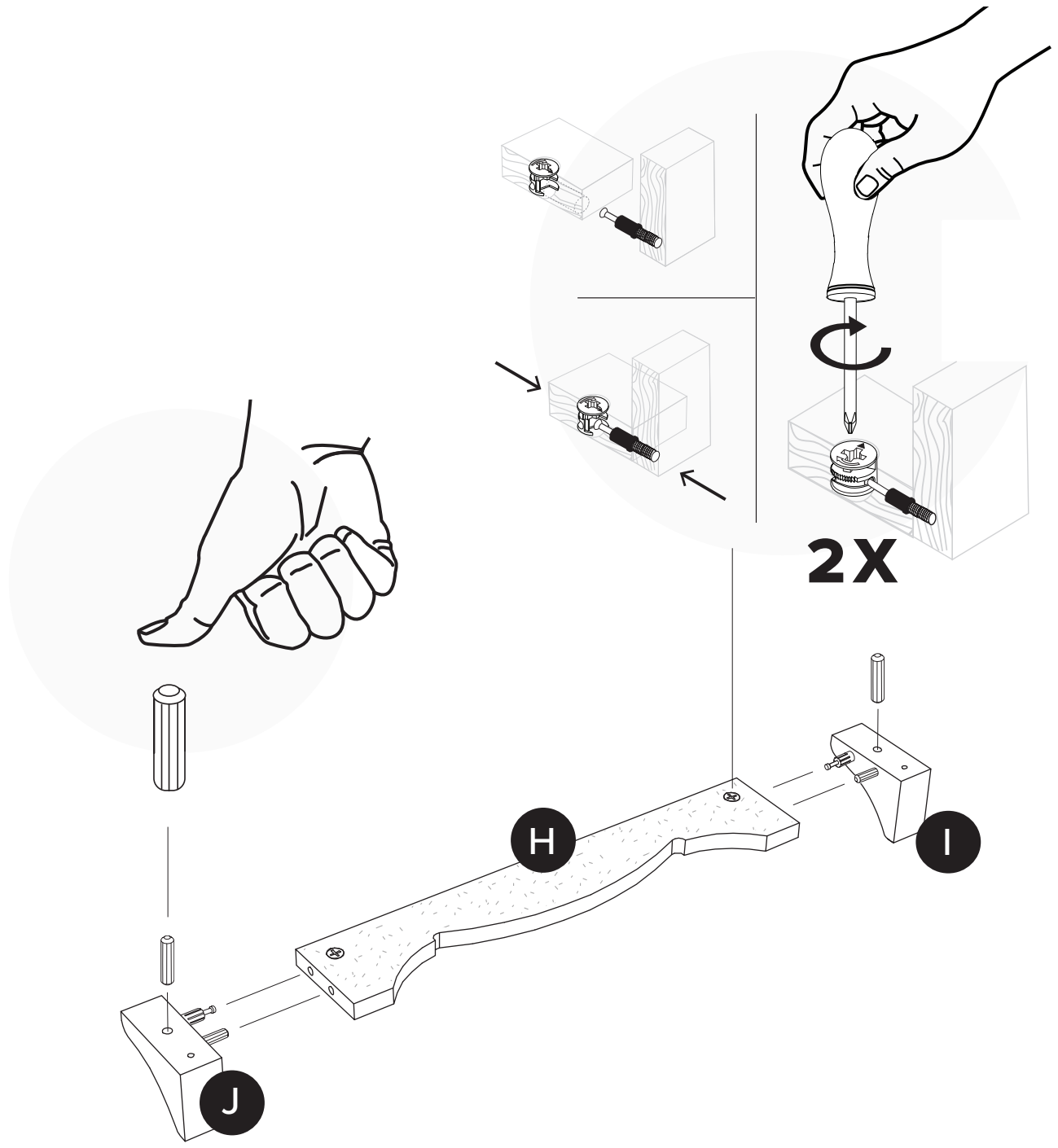

13

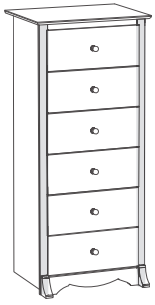

RM-0583
BLUE



8X

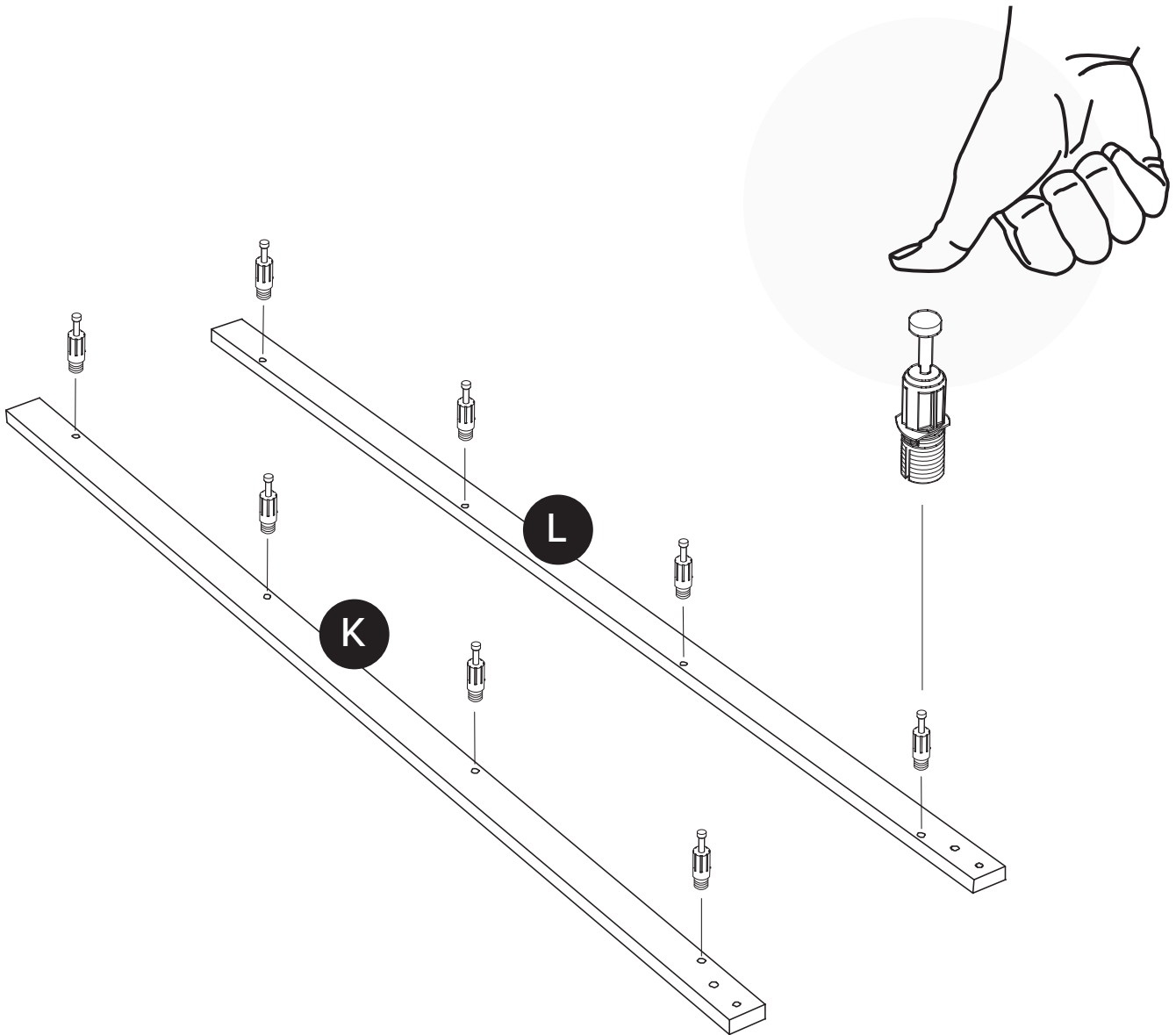

14

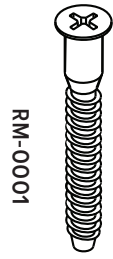
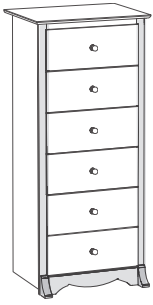

RM-0001

2X

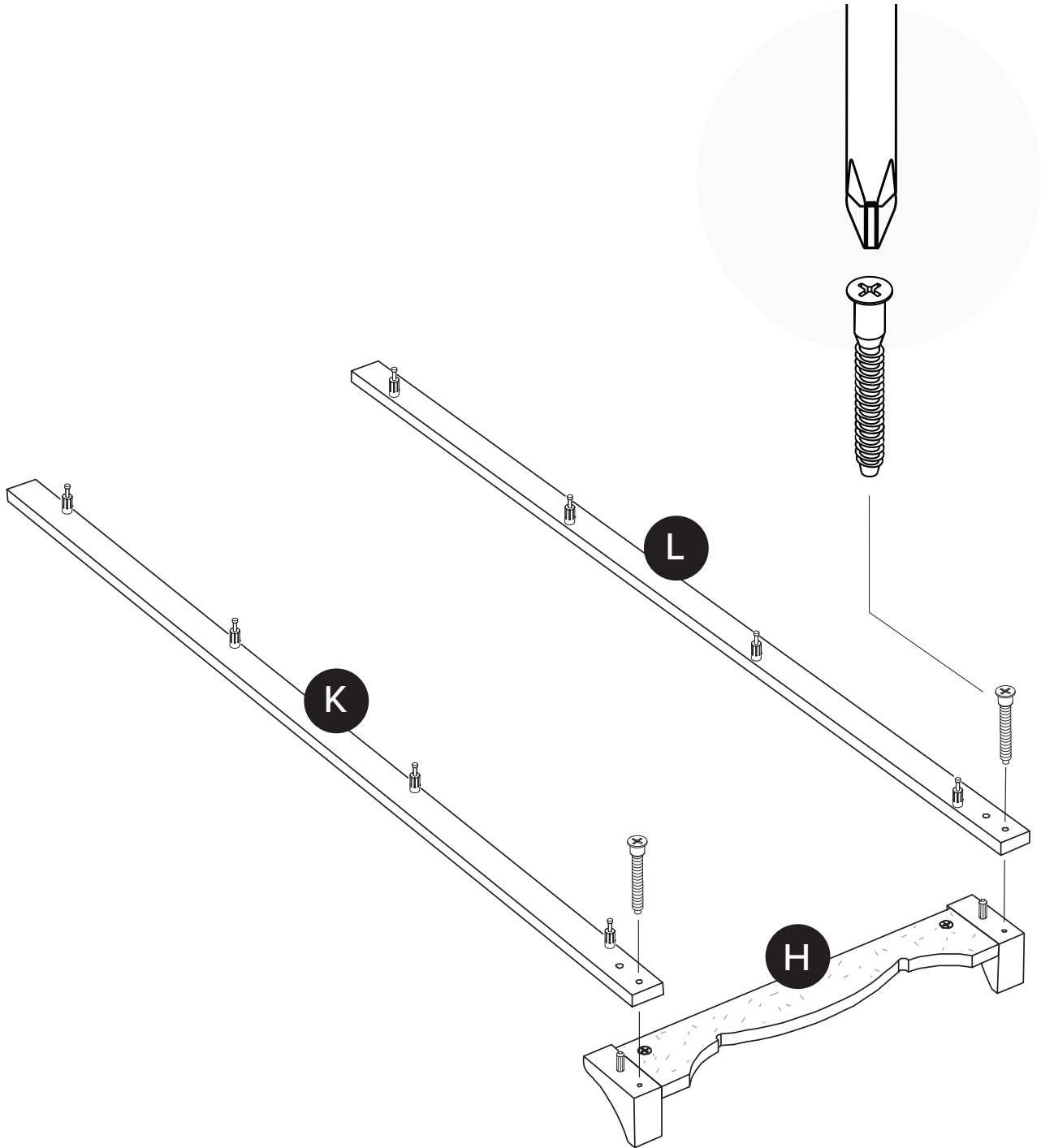

15

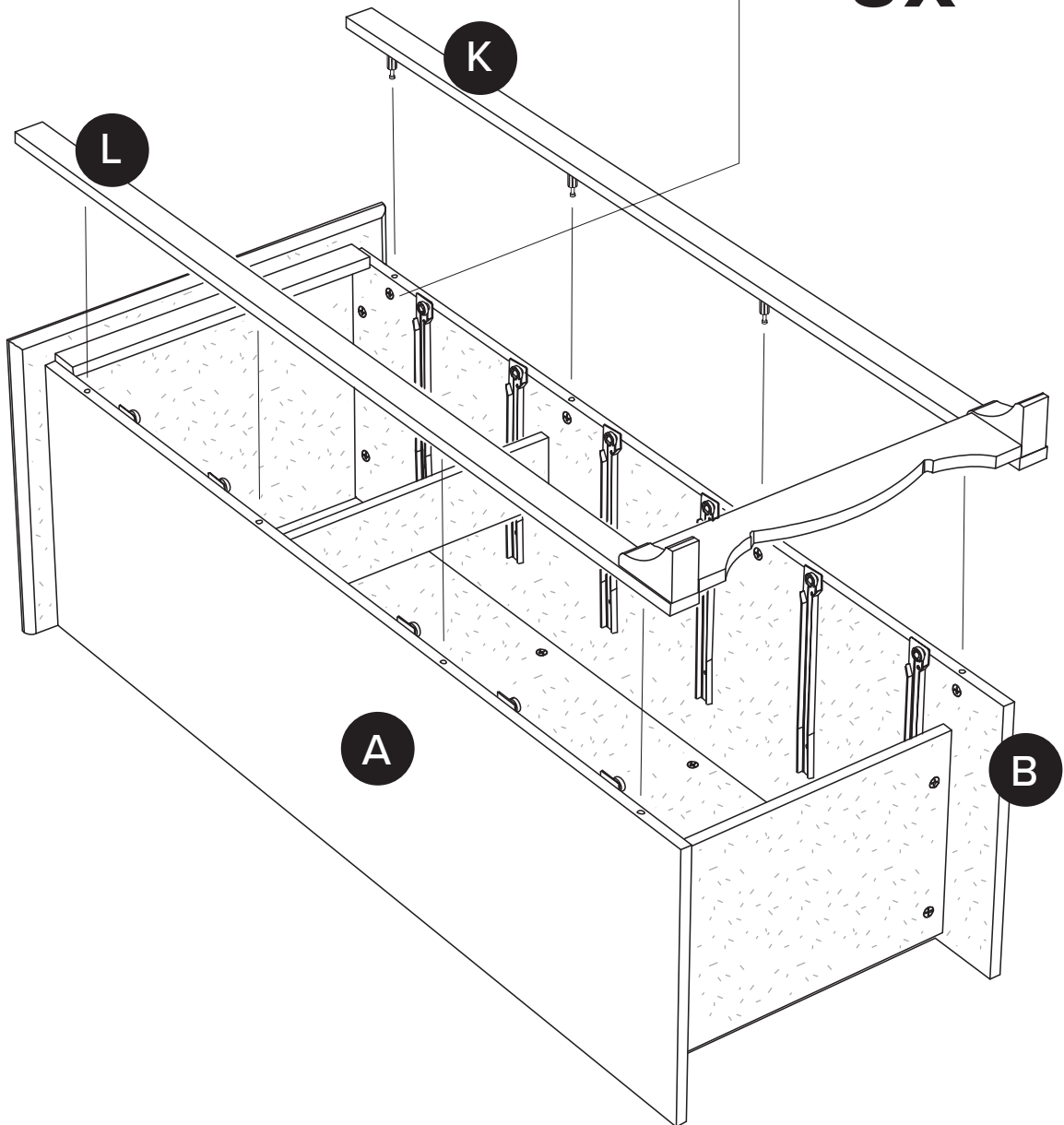
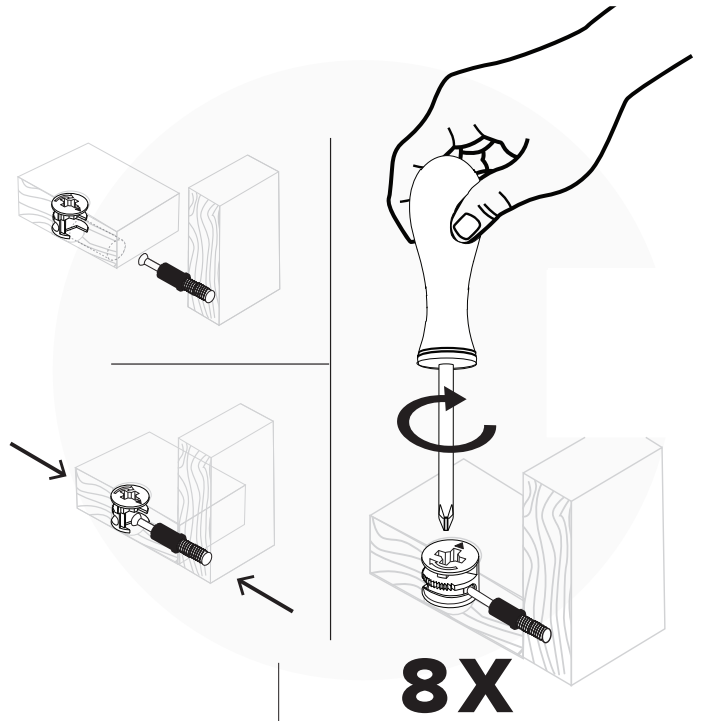
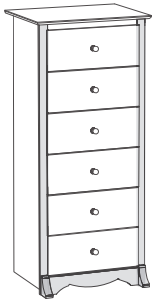

16

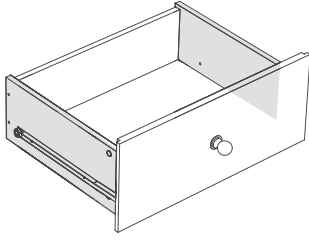

4X



RM-0074

1X

Blue Wheel Slider (Drawer Side)

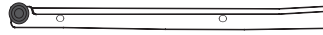

1X

Red Wheel Slider (Drawer Side)

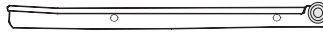

Blue Wheel Slider
Drawer Left (DL)

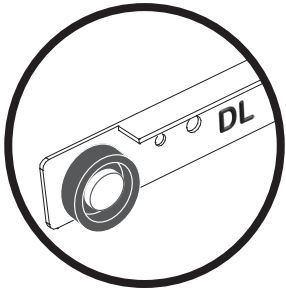

Red Wheel Slider
Drawer Right (DR)

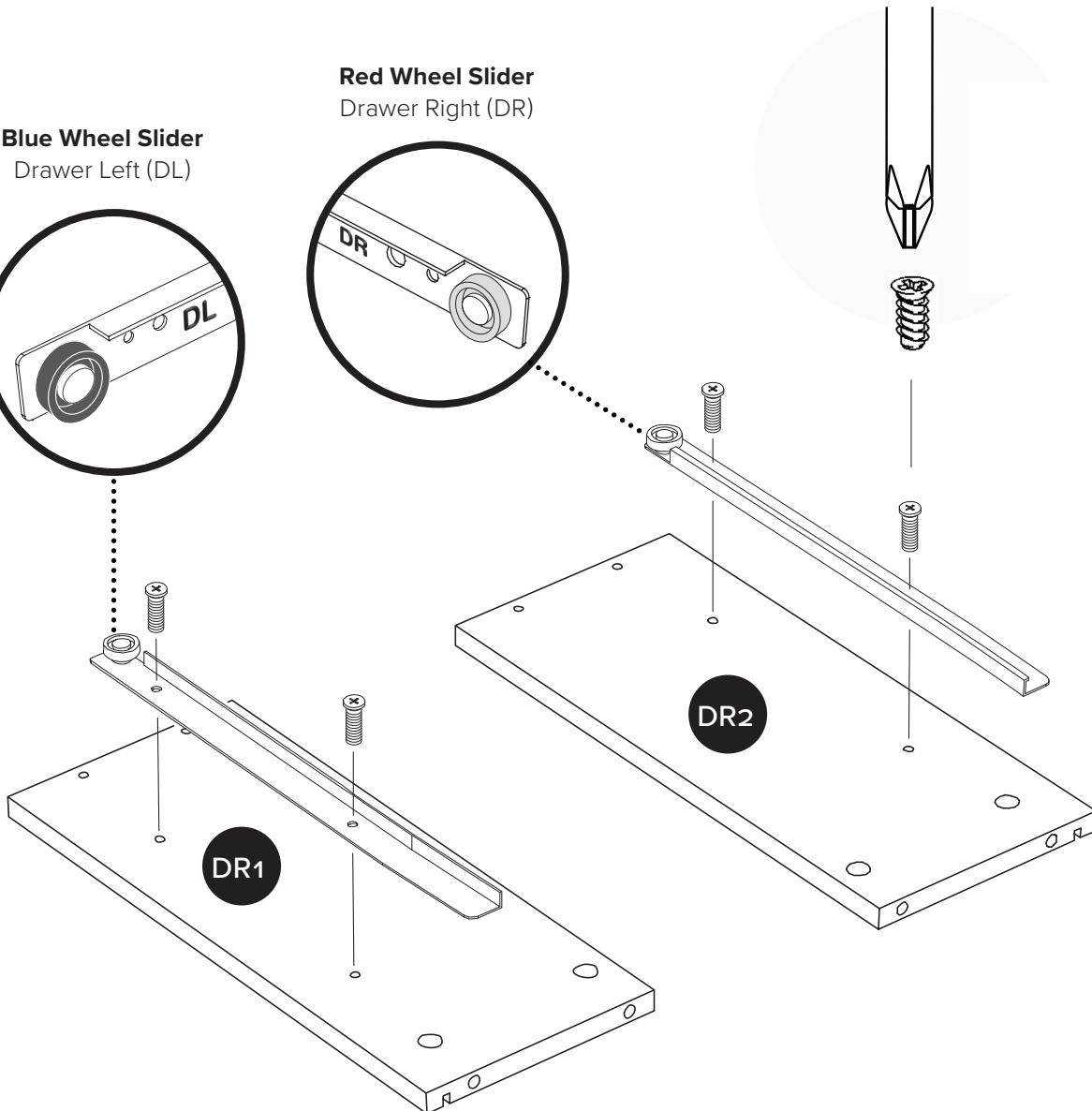
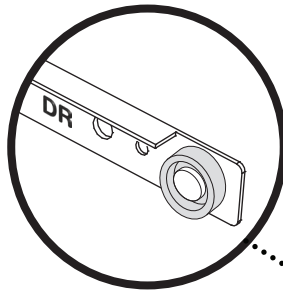

17

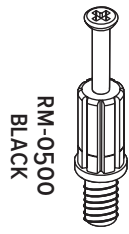
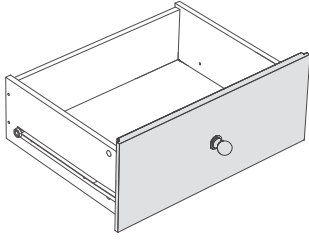

RM-0500
BLACK

4X

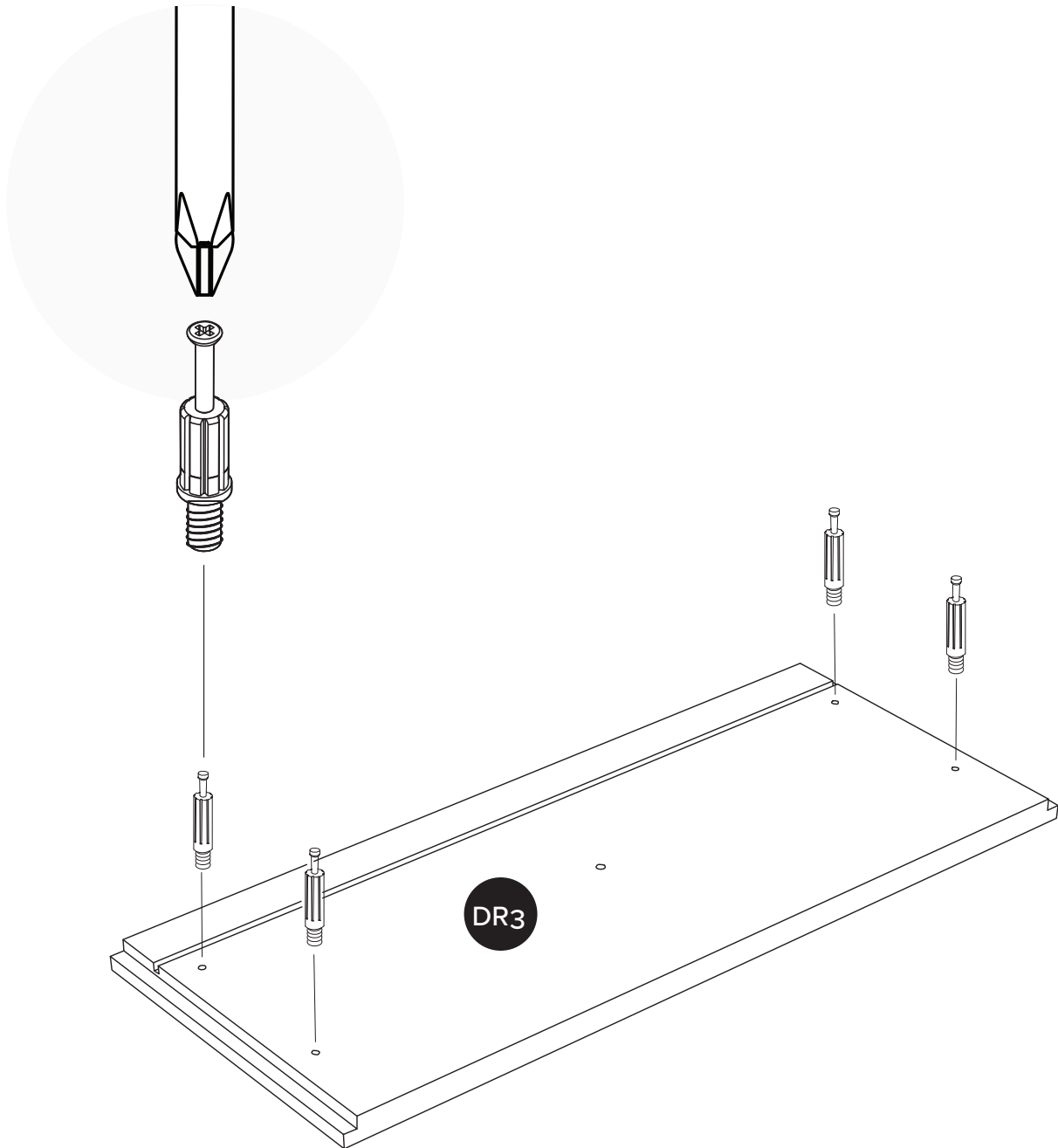

18

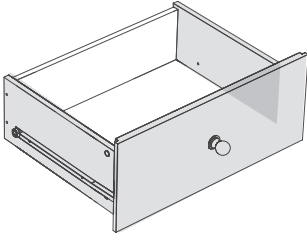

RM-0715



4X

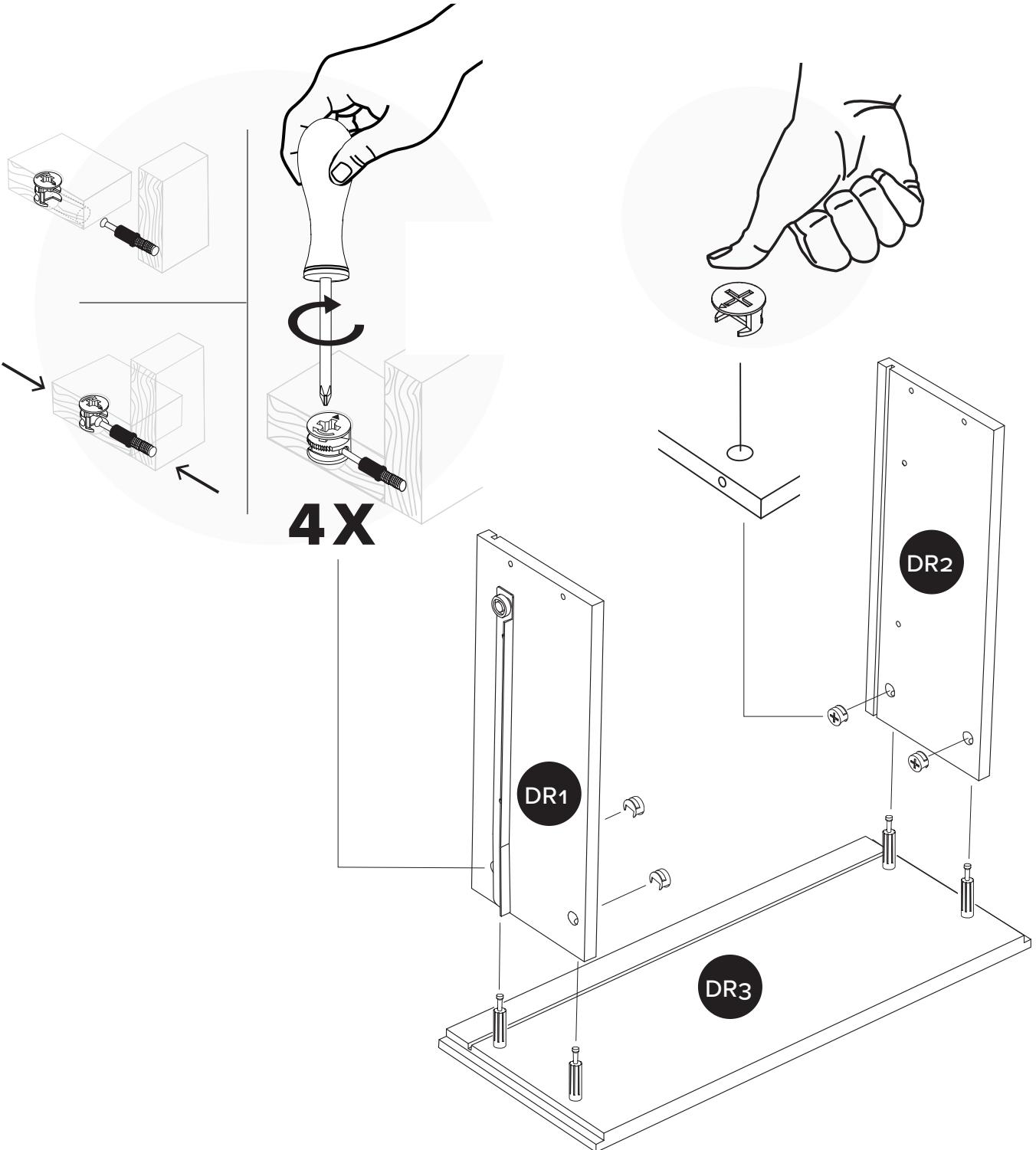

19

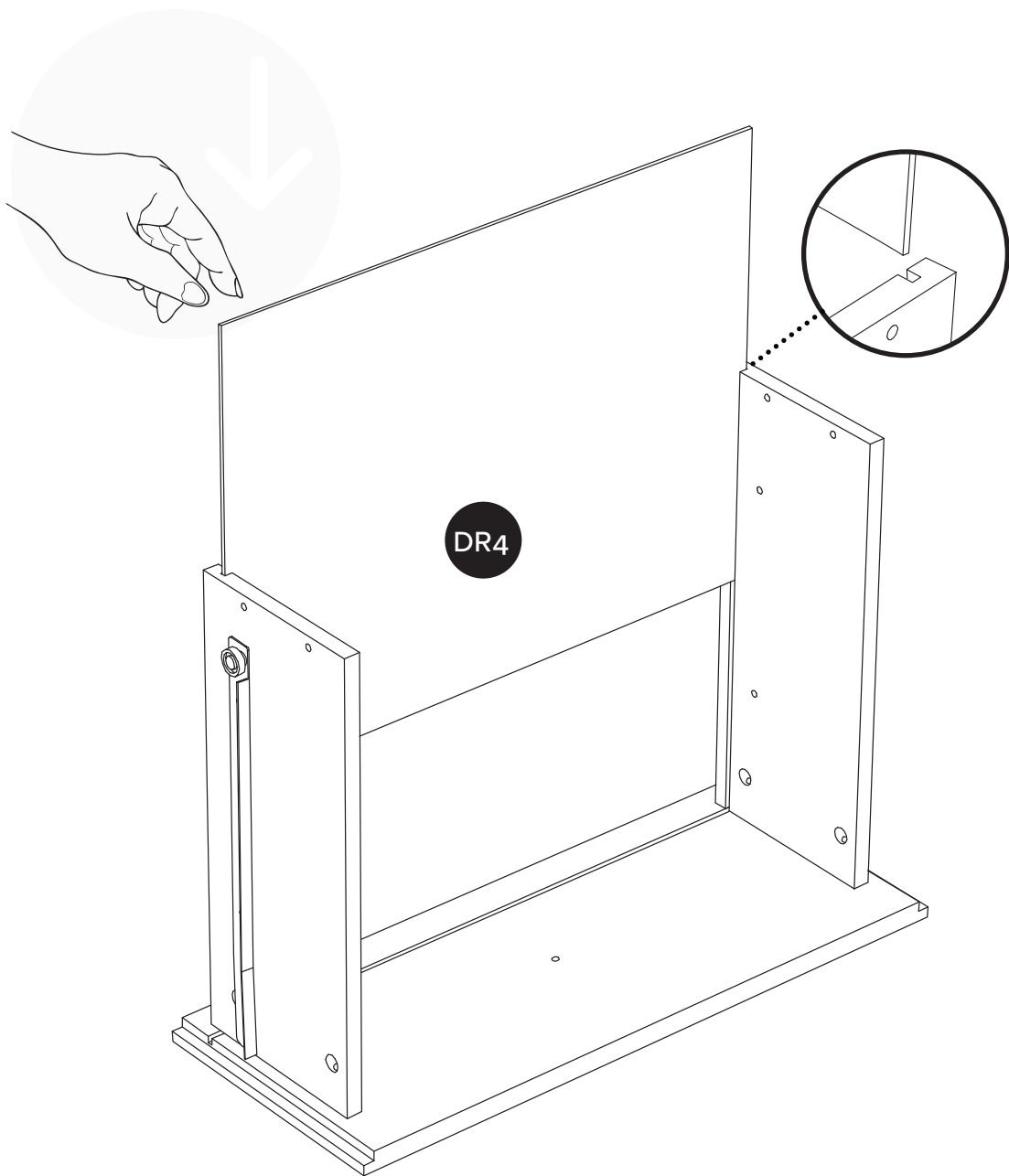
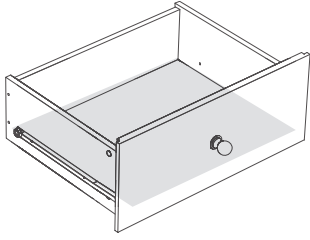

20

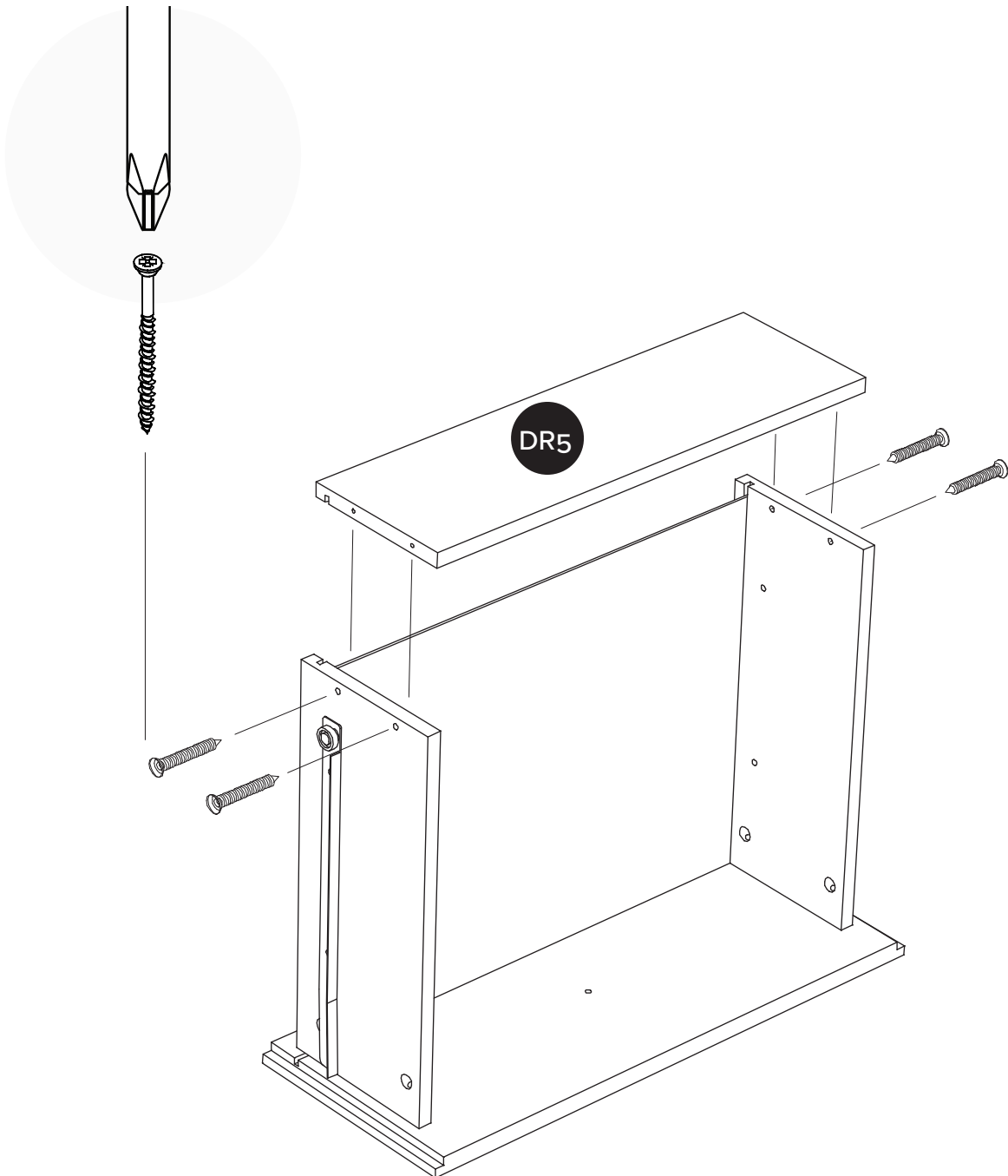
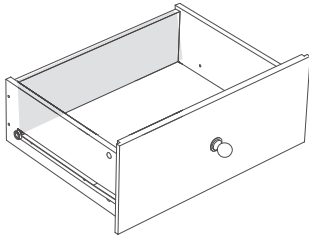

21

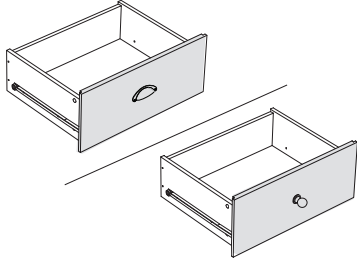

RM-0847
for Drifted Gray

1X

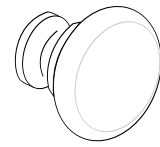

RM-0464 for Black
RM-0625 for Cherry & White

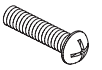

RM-0465

1X

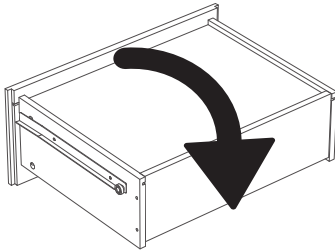

⚠ WARNING	
	<p>Children have died from furniture tipover. To reduce the risk of furniture tipover:</p> <ul style="list-style-type: none">• ALWAYS install tipover restraint provided.• NEVER put a TV on this product.• NEVER allow children to stand, climb or hang on drawers, doors, or shelves.• NEVER open more than one drawer at a time.• Place heaviest items in the lowest drawers. <p><i>This is a permanent label. Do not remove!</i></p>
	

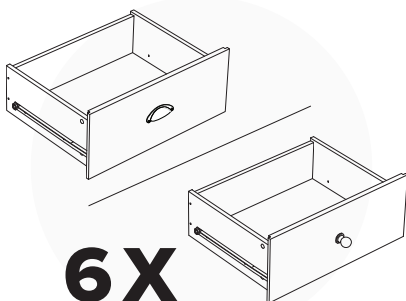
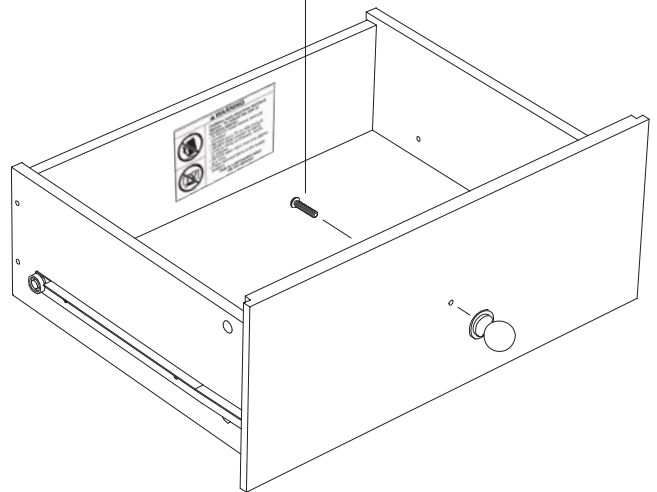
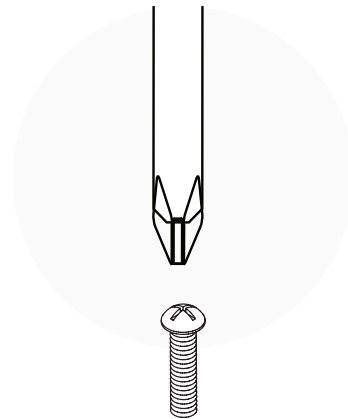
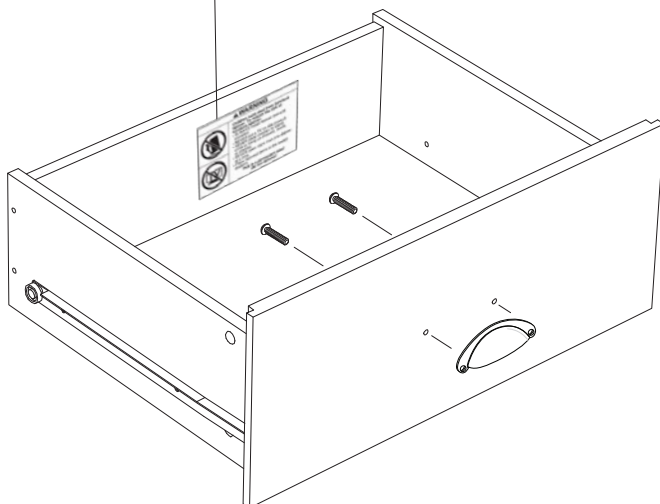

6X

Repeat step 16–21 for 6 drawers

Répétez l'étape 16–21 pour 6 tiroirs

Repita los pasos 16–21 para 6 cajones

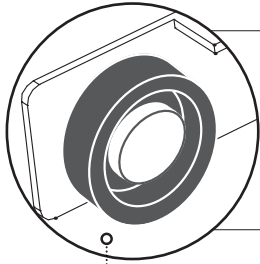

Blue Wheels for the left side

Roues bleues pour le côté gauche
Ruedas azules para el lado izquierdo

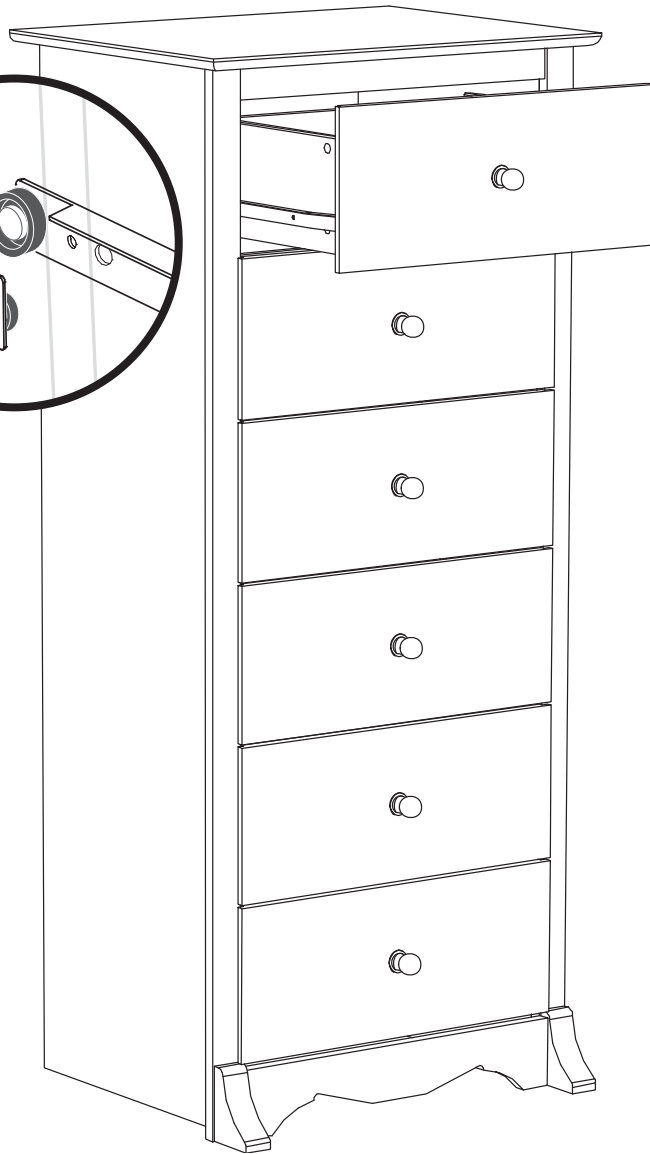
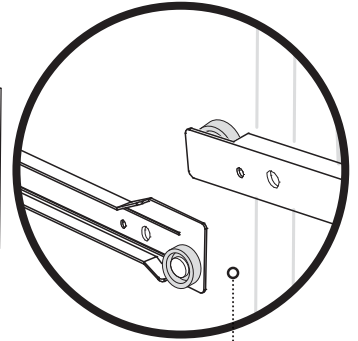
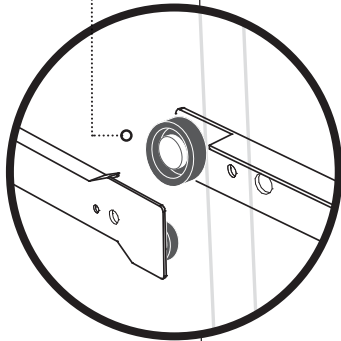

Red Wheels for the right side

Roues rouges pour le côté droit
Ruedas rojas para el lado derecho

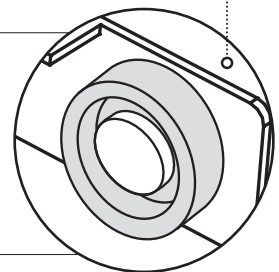

All done!
Good job!

Tout est fait! Bon travail!

¡Todo listo! ¡Buen trabajo!

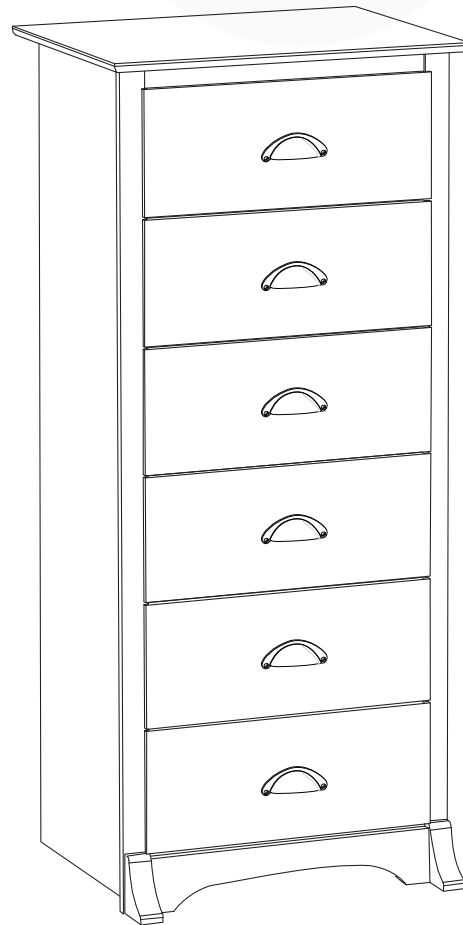
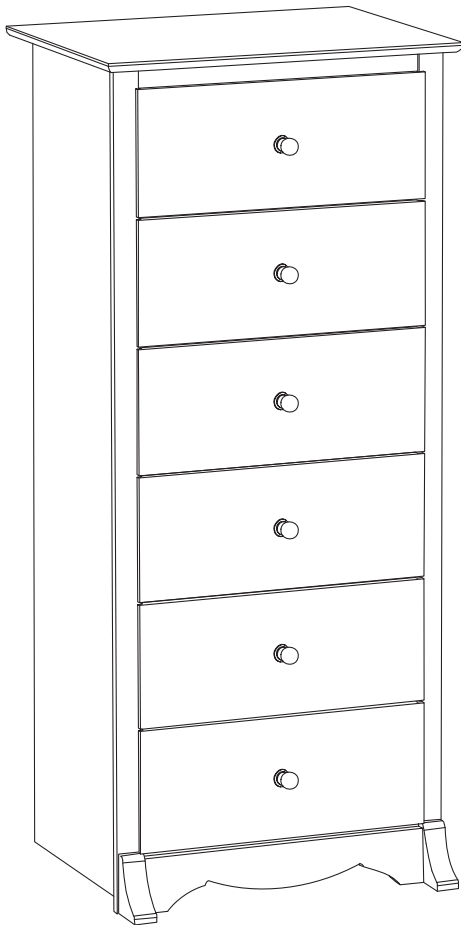

Tipover Restraint Device

Fixation du dispositif de retenue
Instalando la correa de seguridad

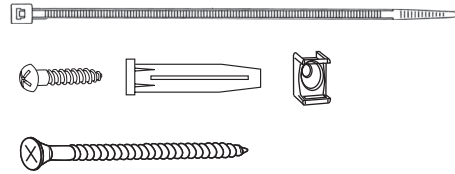

HP-1088-LB

Safety Notice

Prepac recommends anchoring furniture in homes where children live or visit and has included an easy to install safety device. Please make sure that it is installed according to the following instructions.

Noticia de seguridad

Prepac recomienda anclar muebles en hogares donde viven niños o ellos visitan. Prepac ha incluido un dispositivo de seguridad de facil instalacion. Por favor seguresse de que esta instalado de acuerdo a las siguientes instrucciones.

Avis de sécurité

Prepac recommande l'ancrage des meubles dans les domiciles où habitent ou visitent des enfants, d'où l'inclusion d'un dispositif de sécurité facile à installer. Veuillez vous assurer que ce dernier est installé conformément aux présentes instructions.

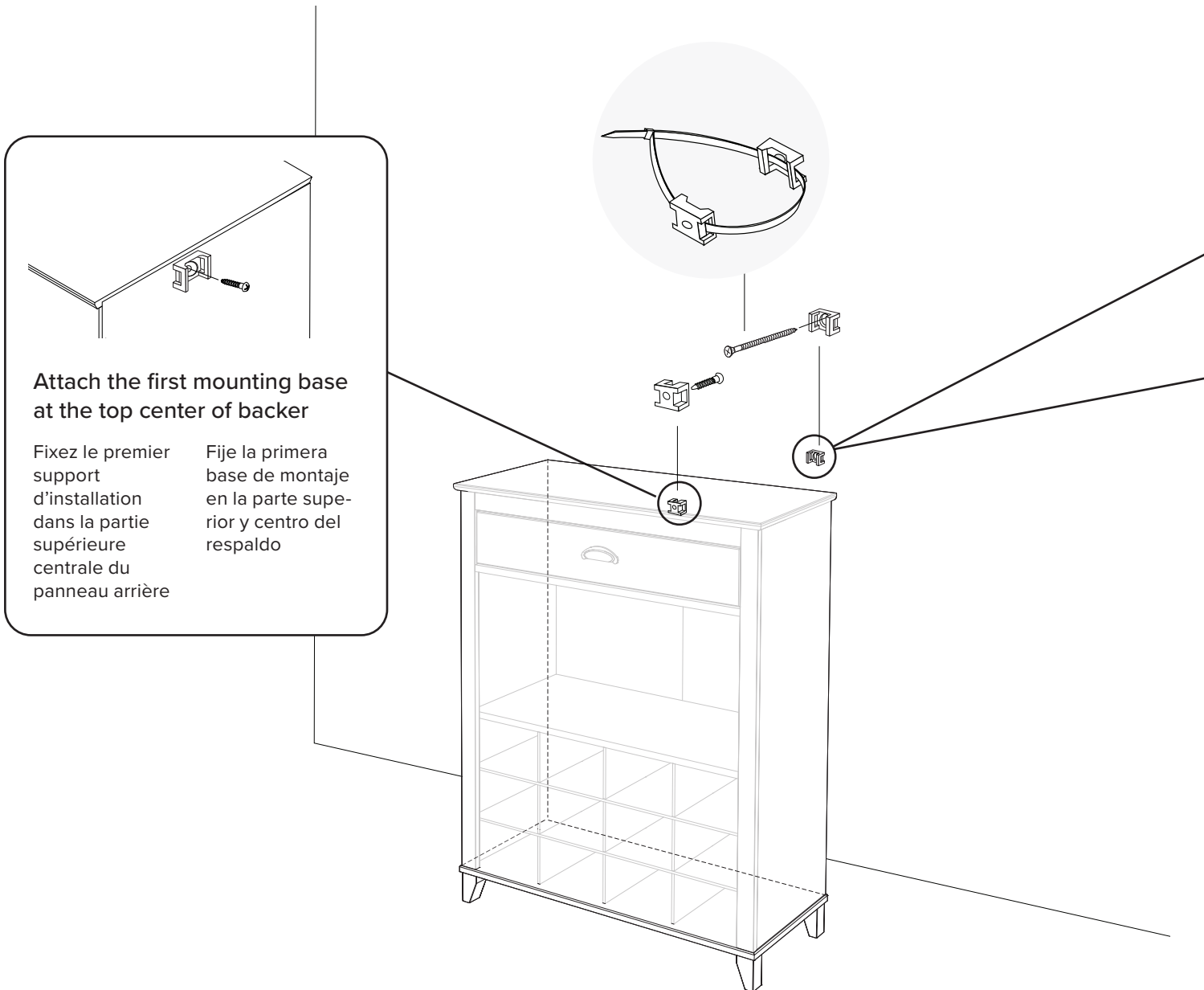

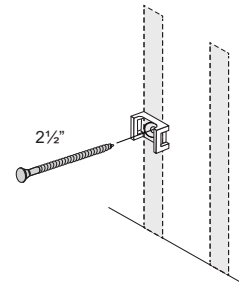
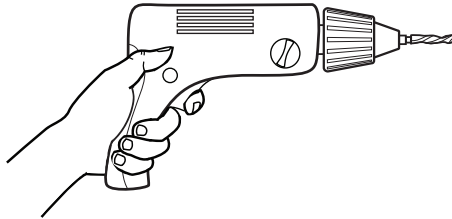
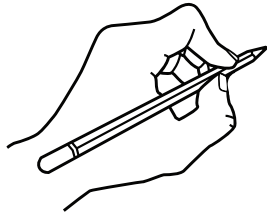

For walls constructed of wood with drywall

Pour les murs en cloison sèche avec montants en bois
Para paredes construidas de madera con paneles prefabricados

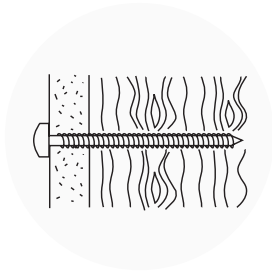

1. With a pencil mark location of second mounting base position
2. Drill pilot hole using an 1/8 inch drill bit 2 inches deep
3. Attach mounting base to wall using the 2 1/2 inch screw provided

1. À l'aide d'un crayon, marquez l'emplacement du deuxième support
2. Percez un avant-trou de 2 po de profondeur avec une mèche de 1/8 po
3. Vissez le support dans le mur à l'aide des vis de 2 1/2 po fournies

1. Con un lápiz marcar la ubicación de la segunda base de montaje
2. Perforar el agujero usando una broca de 1/8 pulgadas 2 pulgadas de profundidad
3. Montar el soporte a la pared utilizando los 2 tornillos de 2 1/2 pulgadas proporcionados

For walls constructed of drywall (unable to hit a stud)

Pour les murs en cloison sèche (où il est impossible de visser dans un montant en bois)
Para muros construidos de drywall (Sin travesaño)

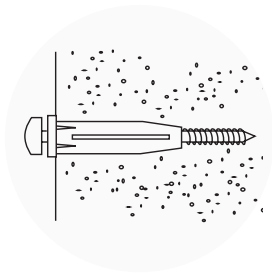

1. Drill pilot hole using a 5/16 inch drill bit only to the depth of drywall thickness
2. Using a rubber mallet or hammer insert wall anchor into drywall
3. Attach holder to wall anchor using 2 1/2 inch screw provided

1. Percez un avant-trou à l'aide d'une mèche de 5/16 po sans dépasser la profondeur de la cloison sèche
2. À l'aide d'un maillet en caoutchouc ou d'un marteau, insérez l'ancrage mural dans la cloison sèche
3. Vissez le support dans l'ancrage mural à l'aide des vis de 2 1/2 po fournies

1. Perforar el agujero utilizando una broca de 5/16 pulgadas solo a la profundidad del grosor del panel de yeso
2. Utilizando un martillo de goma o un martillo insertar el anclaje en pared de yeso
3. Fije el soporte de anclaje a la pared utilizando el tornillo de 2 1/2 pulgadas incluido

For walls constructed of concrete

Pour les murs en béton
Para muros construidos de hormigón

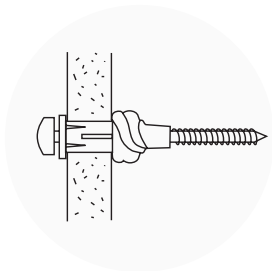

1. Drill pilot hole using a 5/16 inch drill bit 2 3/4 inches deep
2. Using a rubber mallet or hammer insert wall anchor into predrilled hole
3. Attach holder to wall anchor using 2 1/2 inch screw provided

1. Percez un avant-trou de 2 3/4 po de profondeur avec une mèche de 5/16 po
2. À l'aide d'un maillet en caoutchouc ou d'un marteau, insérez l'ancrage mural dans le trou
3. Vissez le support dans l'ancrage mural à l'aide des vis de 2 1/2 po fournies

1. Perforar un agujero de 2 3/4 de profundidad utilizando una broca de 5/16 pulgadas
2. Utilizando un martillo de goma o un martillo insertar el anclaje en el agujero preperforado
3. Fije el soporte de anclaje a la pared utilizando el tornillo de 2 1/2 pulgadas incluido

Tall 6-drawer Chest

Commode haute 6 tiroirs

Cómoda alta de 6 cajones

