

K
KELABEL

Congratulation on your purchase.

Questions and concerns about your our product ?

You can contact us, we are happy to serve you to
your satisfaction!

AFTER SALES SUPPORT

K **KELABEL** **BREAD BOX**

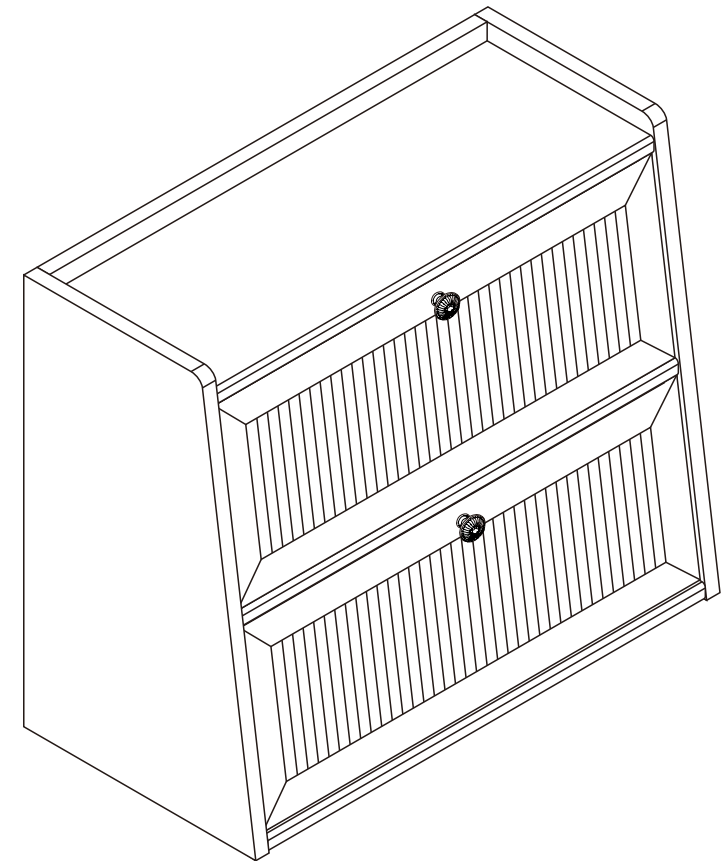

INSTRUCTION MANUAL

AFTER SALES SUPPORT

Before you begin

- 1.Check for damaged or missing parts
- 2.Gather all tools prior to assembly.
- 3.Use the assembly, surface to prevent product damage during assembly.
- 4.Do not over tighten.
5. During assembly,as this may damage the product. .
Do not use power tools.

Care Instruction

- 1.Wipe clean with damp cloth
- 2.Do not use strong detergents or abrasive cleaners, they may damage the surface
- 3.Check and tighten screws regularly
- 4.Do not stand on the product, do not use the product as a stepladder
- 5.Do not put anything hot on the surface.
- 6.Indoor use only.
- 7.Questions and concerns about your BALANBO product ? Send email to amazon@balanbo.cn

Part List

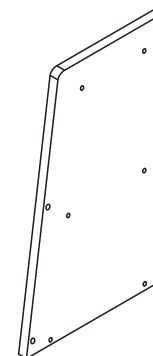

Ax1

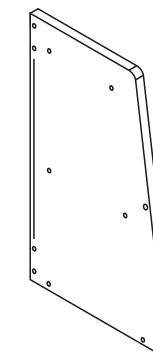

Bx1

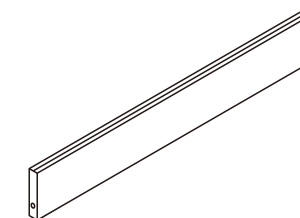

Cx2

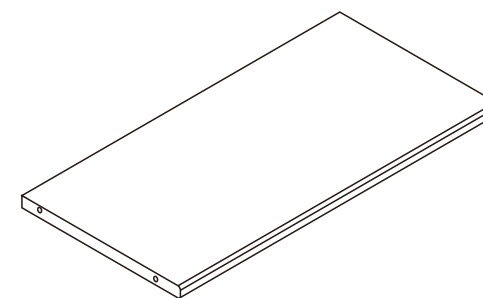

Dx1

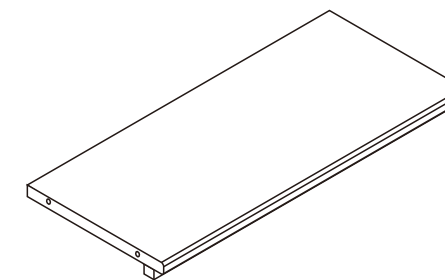

Ex1

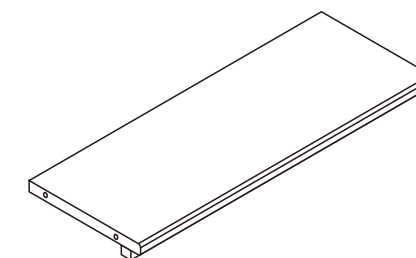

Fx1

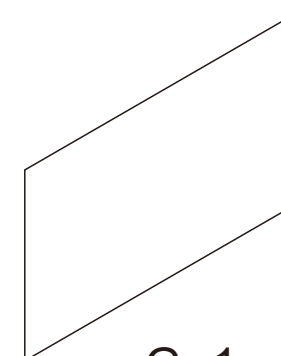

Gx1

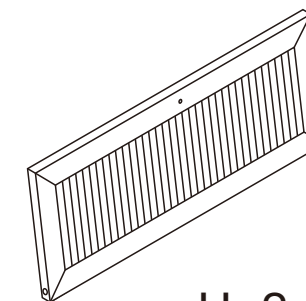

Hx2

Hardware List



① x16



② x4



③ x2



④ x2

STEP1

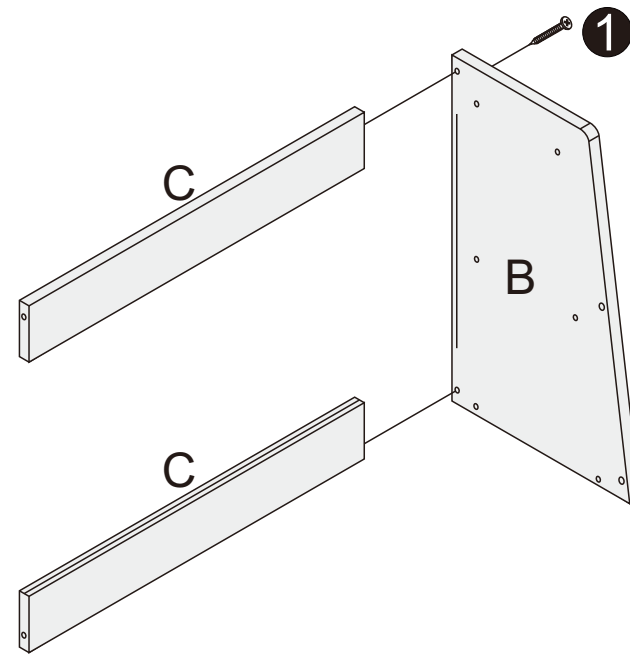

1 x2

STEP2

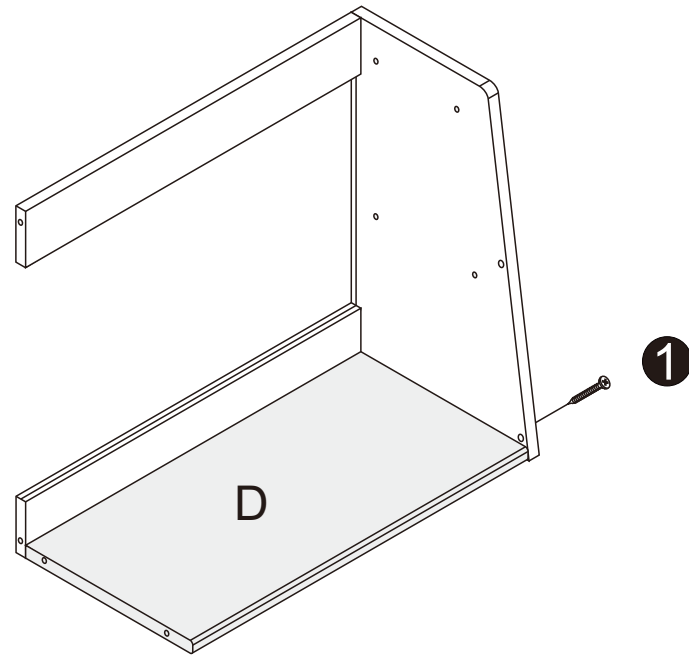

1 x2

AFTER SALES SUPPORT

STEP3

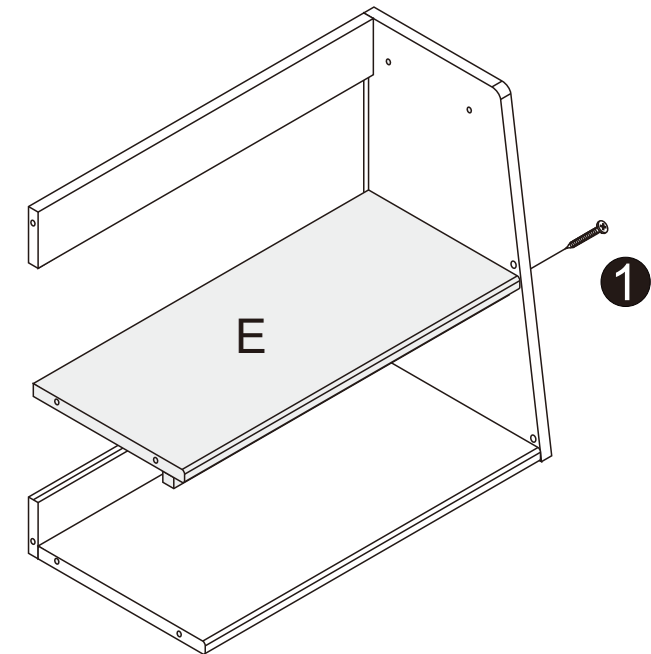

1 x2

STEP4

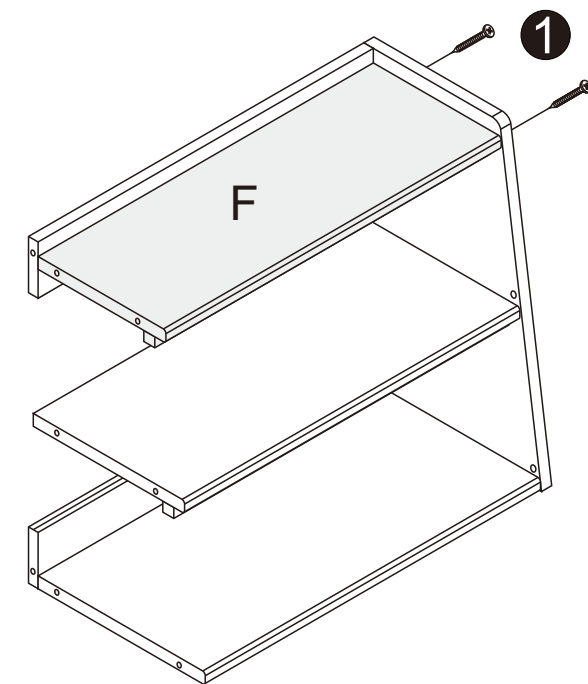

1 x2

AFTER SALES SUPPORT

STEP5

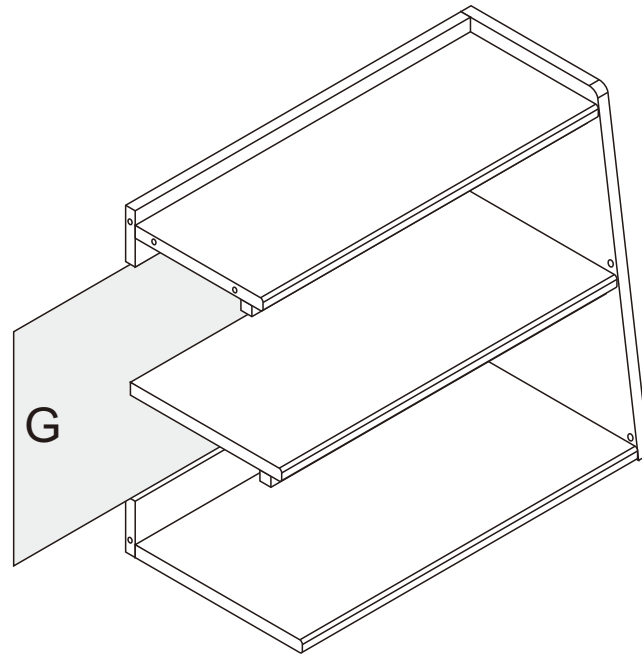

STEP6

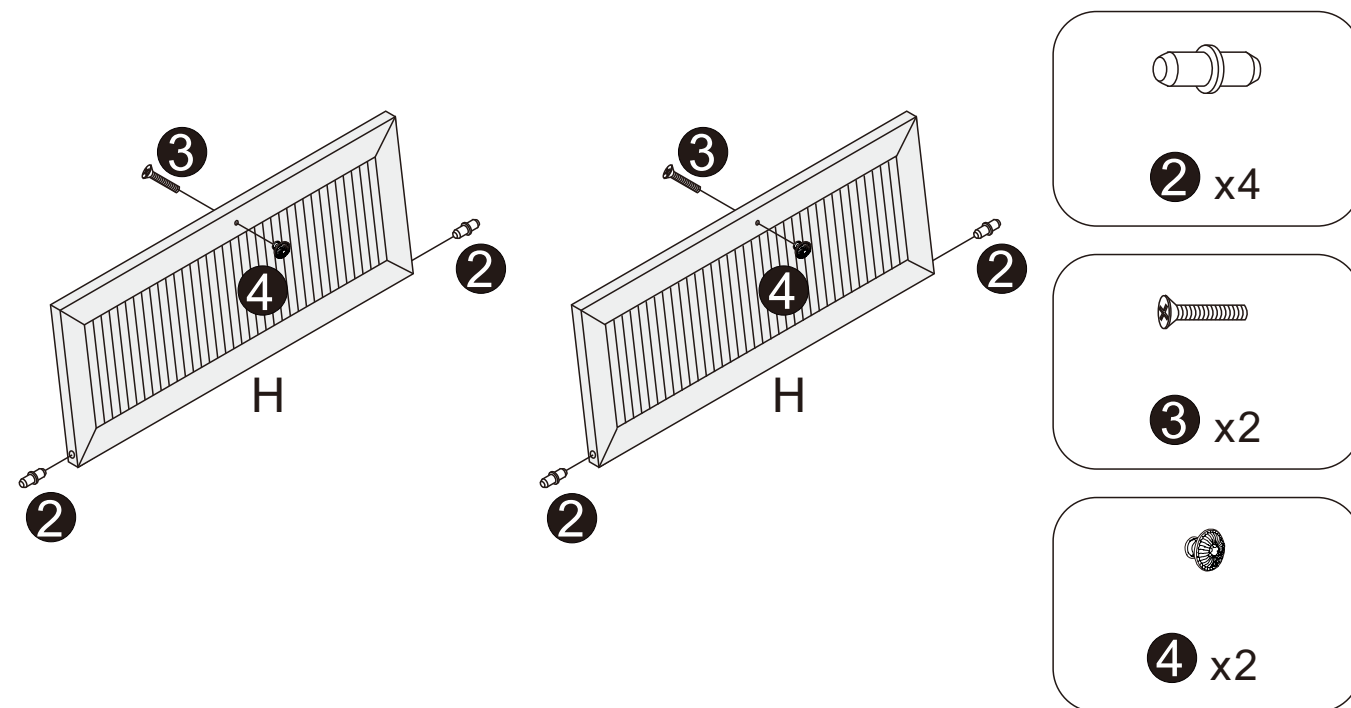

AFTER SALES SUPPORT

STEP7

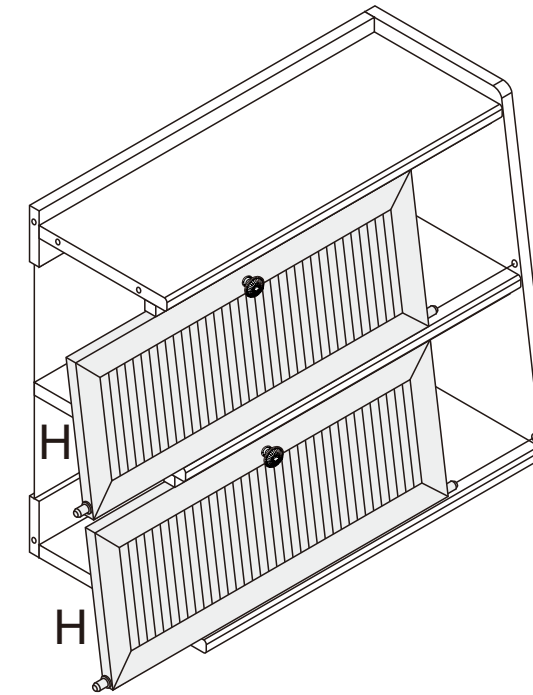

STEP8

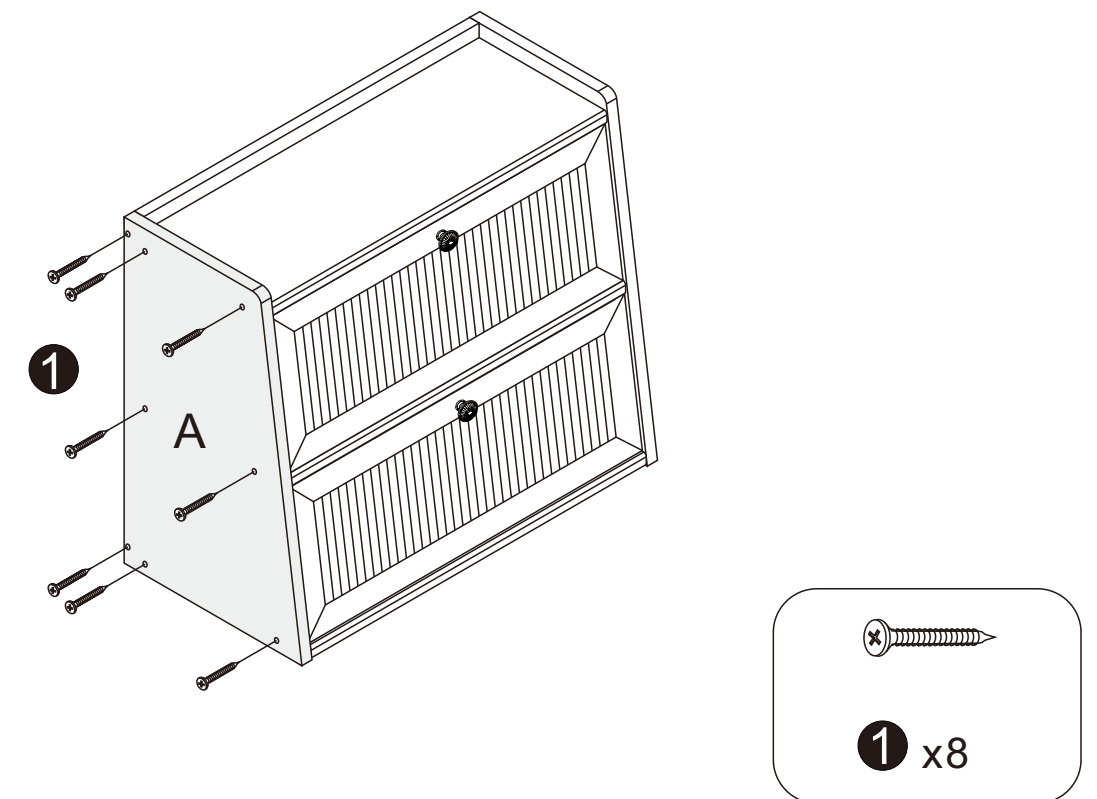

AFTER SALES SUPPORT