

TV STAND

Thank you for purchasing the **TV STAND !**

Before you start, here is some helpful advice:

1. We suggest you spend a short time reading through this leaflet and then follow the simple step-by-step instructions.
2. Owing to the size and weight of the desk, we recommend that it is assembled by two adults, on a carpeted or padded area, in the room that it is intended for. Approximate assembly time: 60 minutes.
3. Please do not use any tools other than those provided or recommended in these instructions.
4. Please do not throw away any of the packaging or instructions until you have checked all the components and hardware and the furniture is fully assembled.
5. Assemble all components loosely until advised to tighten. Depending on use, it may be necessary to tighten the components from time to time, so please save the tools that have been provided.
6. Please keep all pieces out of reach of children.

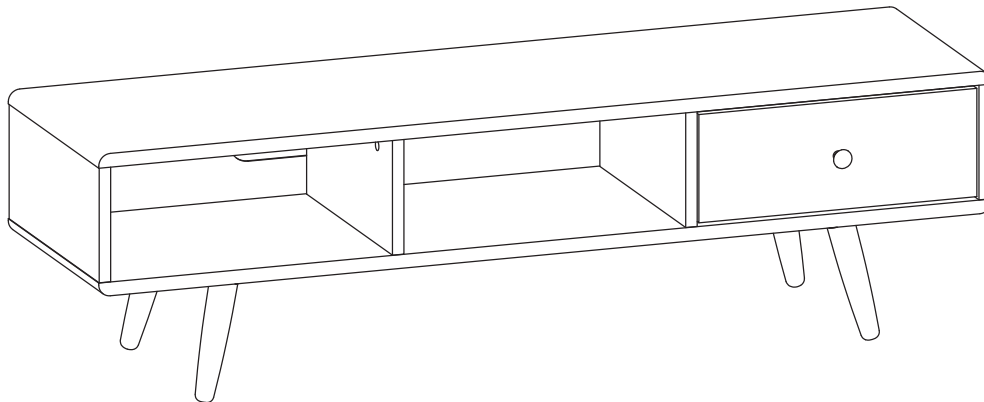

Hardware :

A ø 6 x 35 mm x 14	B ø 15 mm x 12	C ø 12 mm x 2	D M 7 x 50 mm x 4	E ø 6 x 30 mm x 2
F ø 8 x 30 mm x 16	G L 4 x 1	H 300 mm x 1	I M 6.5 x 10.5 mm x 4	J M 3.5 x 13 mm x 6
K M 8 x 39 mm x 4	L 70 x 62 x 17 mm x 4	M M 4 x 16 mm x 16	N HANDLE x 1	O M 4 x 20 mm x 1
P ø 15 mm(Long) x 6	Q 9 x 14 x 10 mm x 8	R M 3.5 x 15.5 mm x 8	S Screwdriver (Not Include) x 1	

Components:

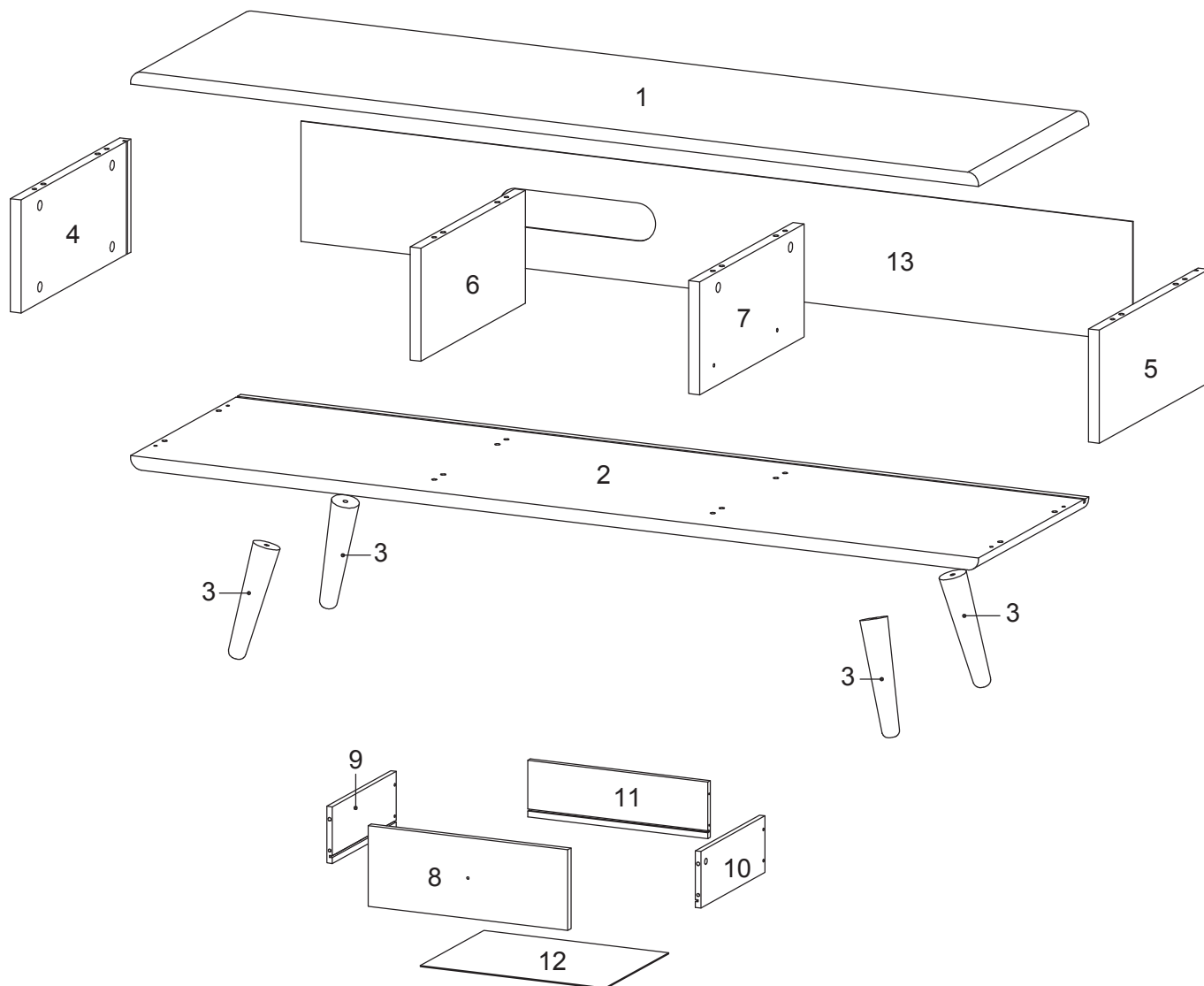



1	Top Board	x1	2	Bottom Board	x1	3	Leg	x4	4	Side Board Left	x1
5	Side Board Right	x1	6	Center Board 1	x1	7	Center Board 2	x1	8	Front Drawer	x1
9	Side Drawer Left	x1	10	Side Drawer Right	x1	11	Back Drawer	x1	12	Bottom Drawer	x1
13	Back Board	x1									

TV STAND

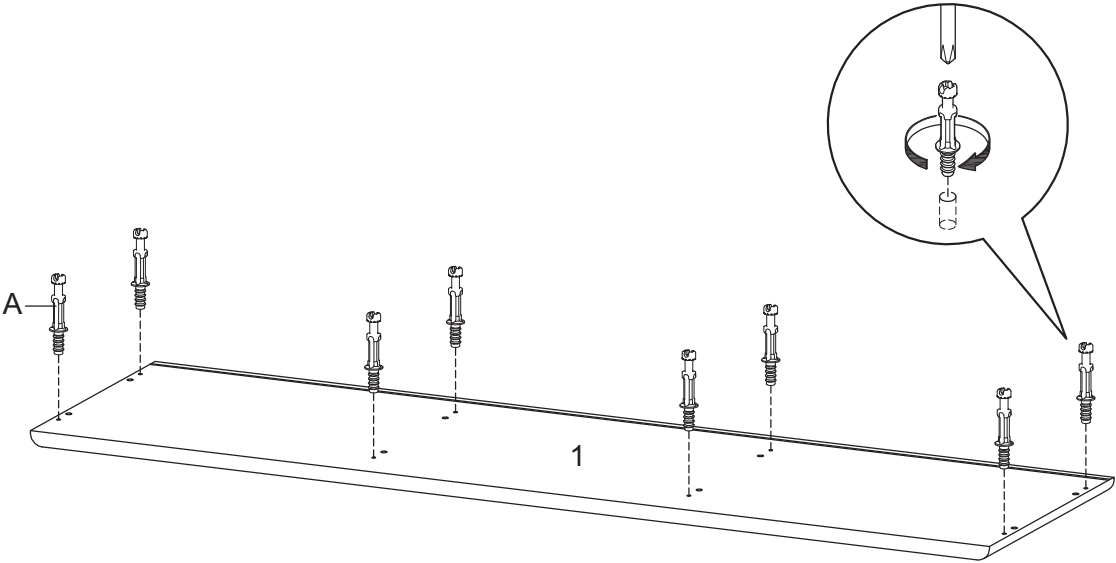
STEP 1:



	
Ax8	Sx1

Hardware required. Screwdriver not included

STEP 2:

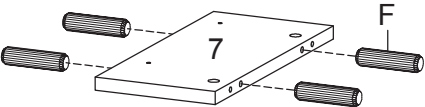
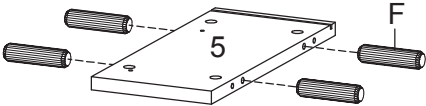
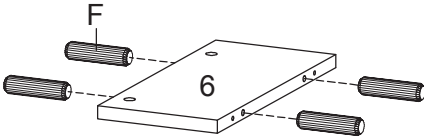
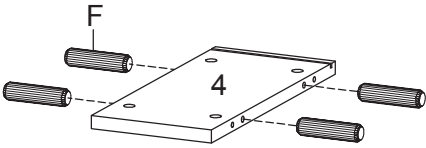





Fx16

Hardware required

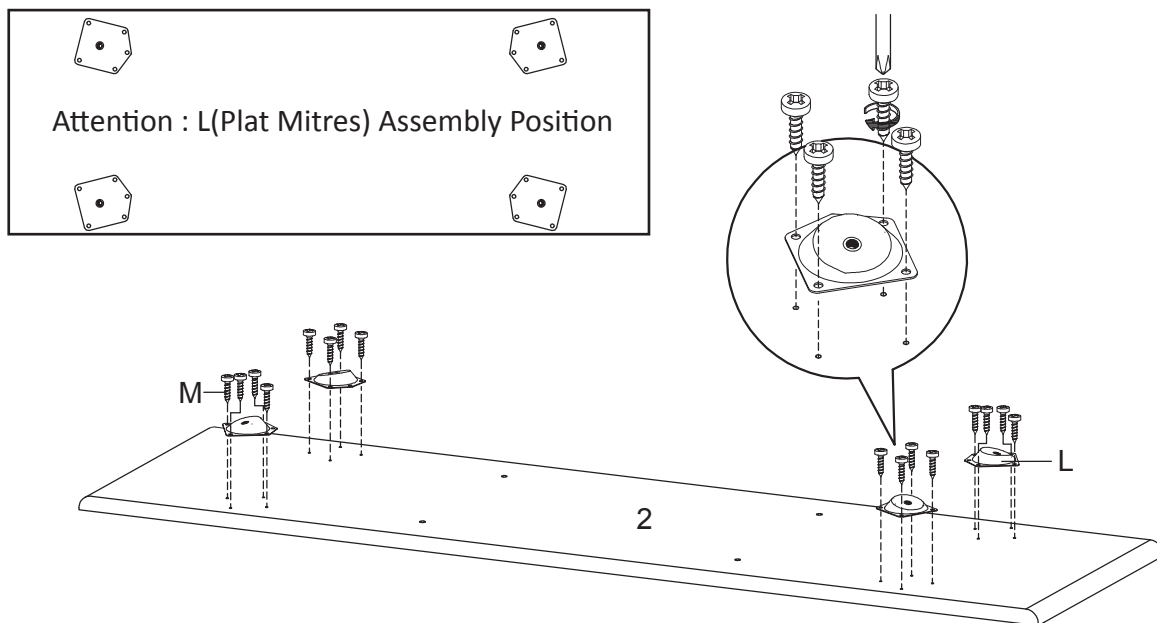
TV STAND

STEP 3:

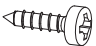
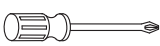

		
Lx4	Mx16	Sx1

Hardware required. Screwdriver not included

STEP 4:

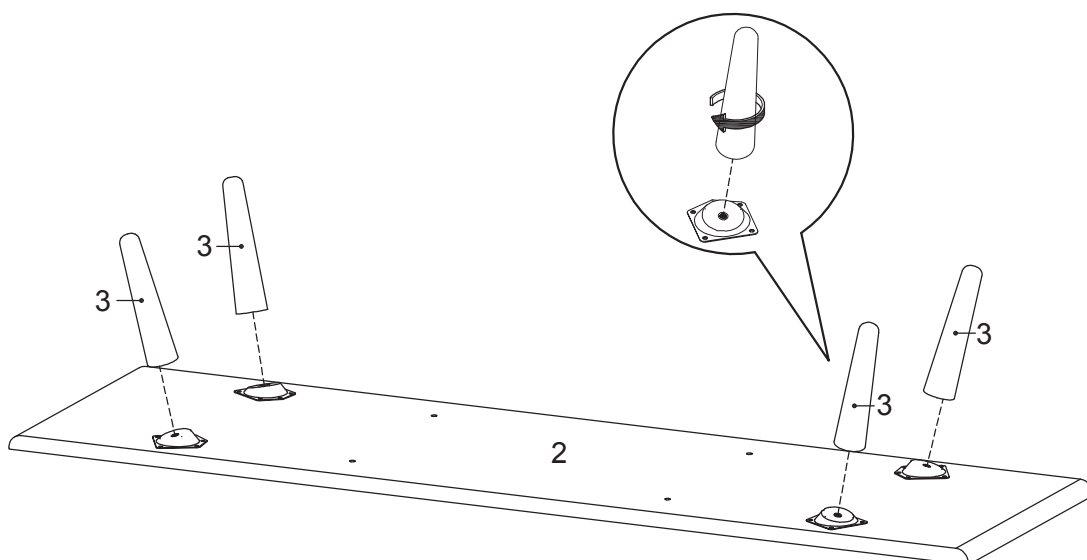

TV STAND

STEP 5:

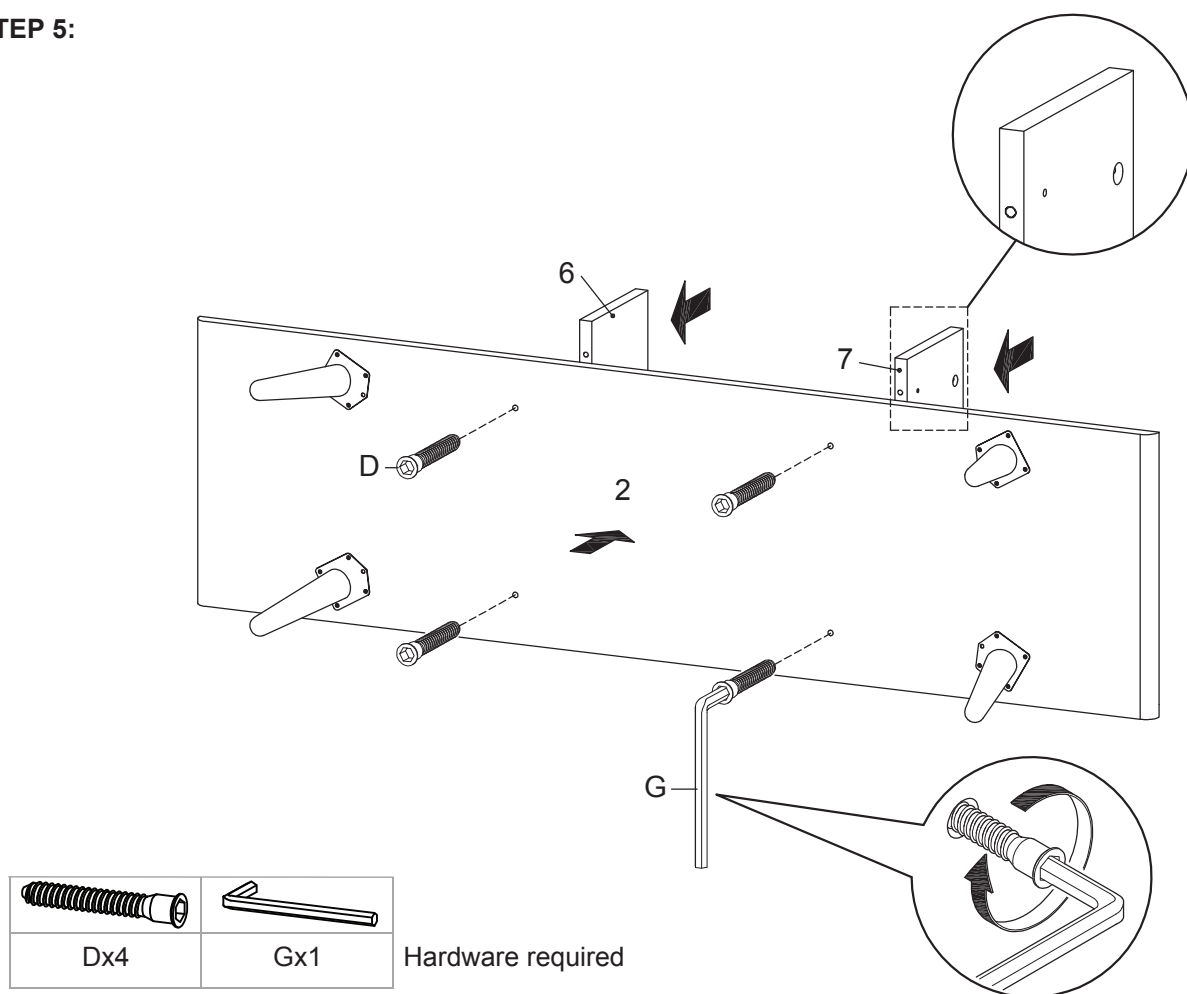

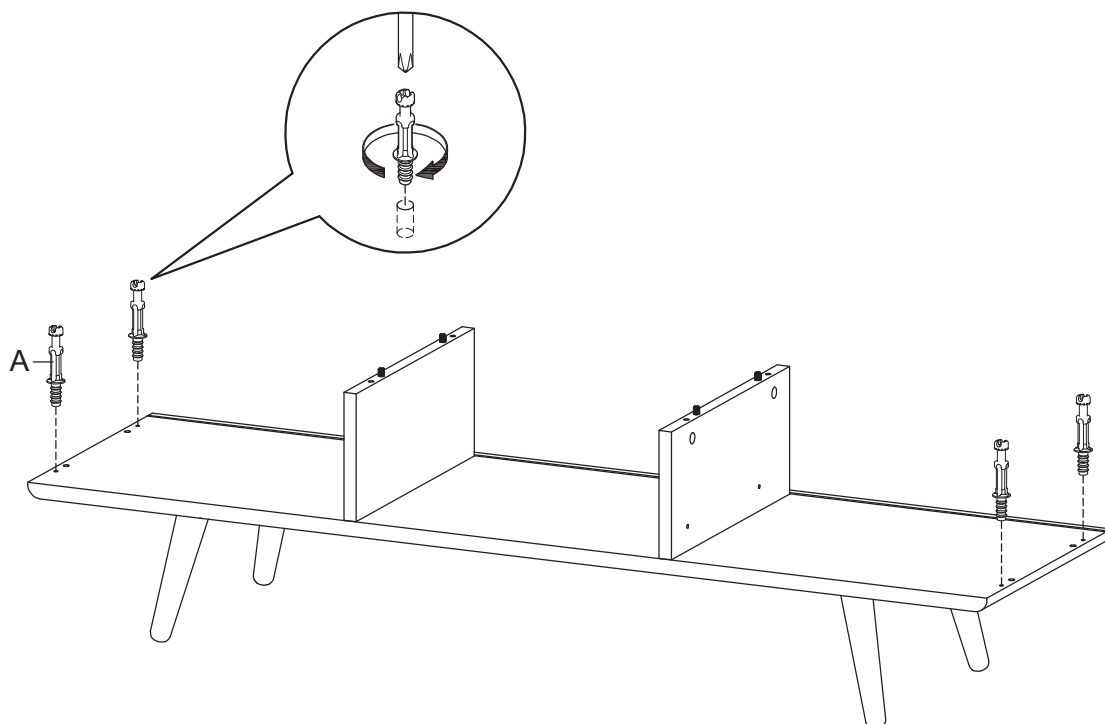

STEP 6:

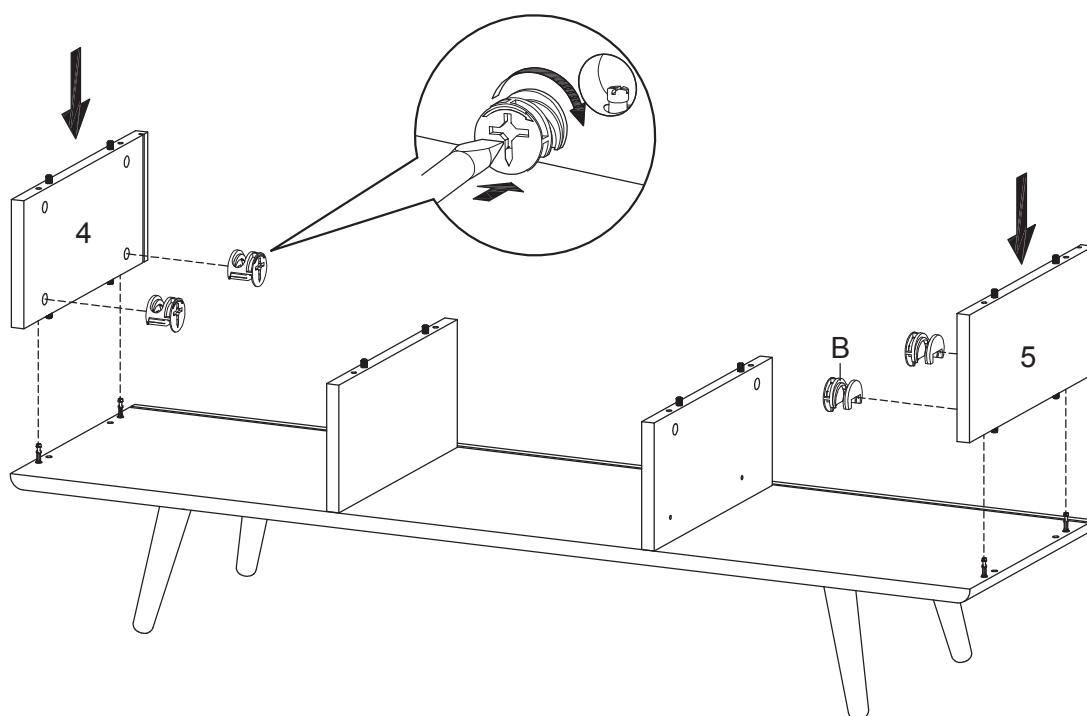

TV STAND

STEP 7:



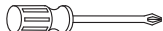

	
Bx4	Sx1

Hardware required. Screwdriver not included

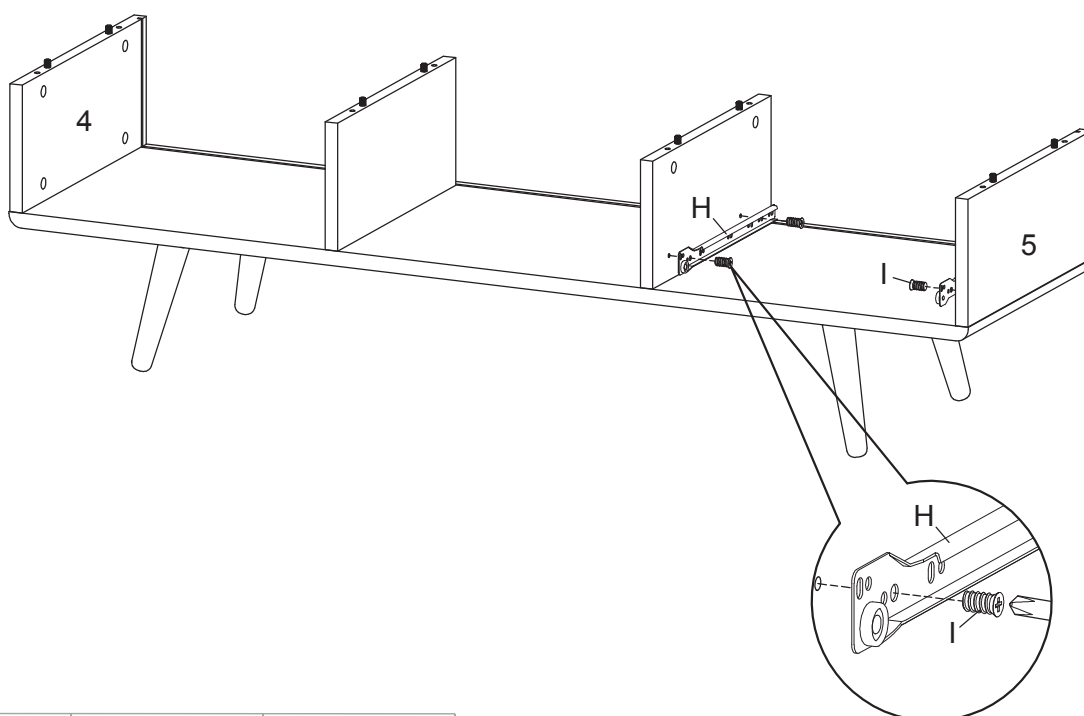
STEP 8:

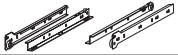

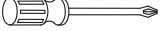
		
Hx1	Ix4	Sx1

Hardware required. Screwdriver not included

TV STAND

STEP 9:

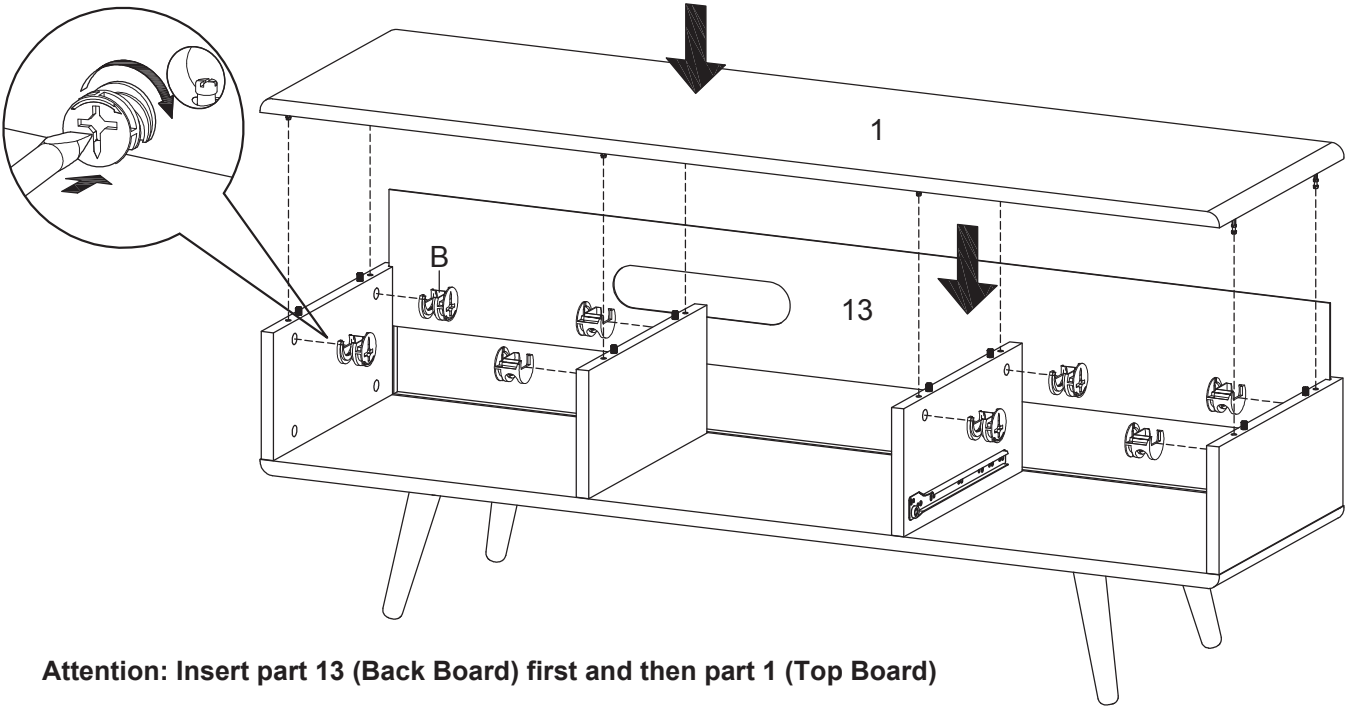

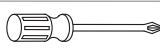

Attention: Insert part 13 (Back Board) first and then part 1 (Top Board)

	
Bx8	Sx1

Hardware required. Screwdriver not included

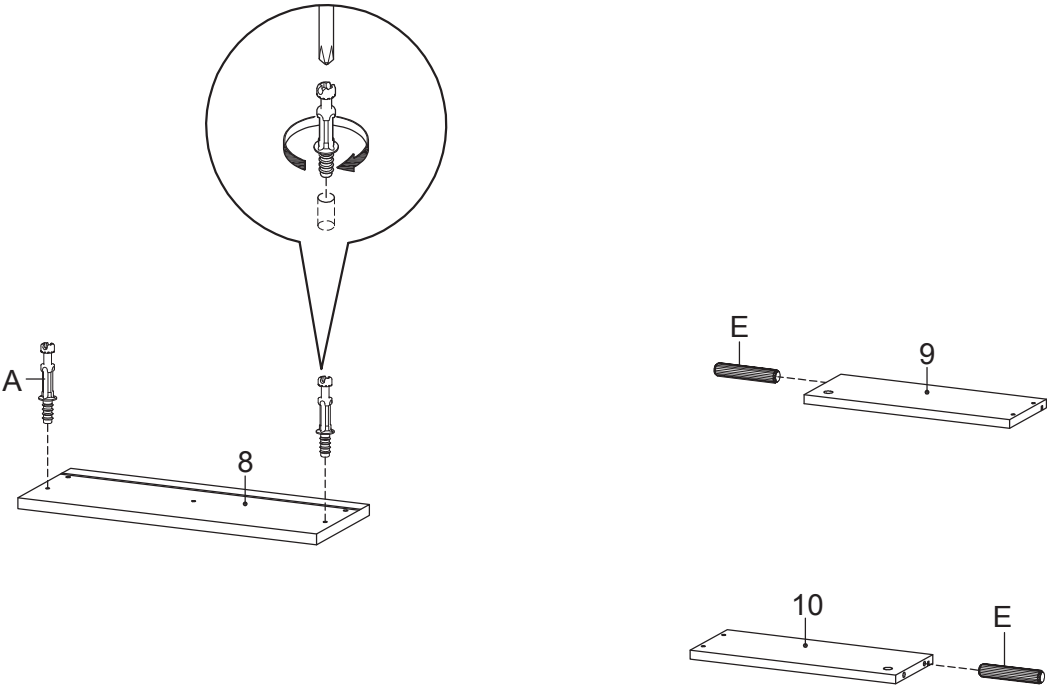
STEP 10:

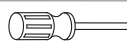

		
Ax2	Ex2	Sx1

Hardware required. Screwdriver not included

TV STAND

STEP 11:

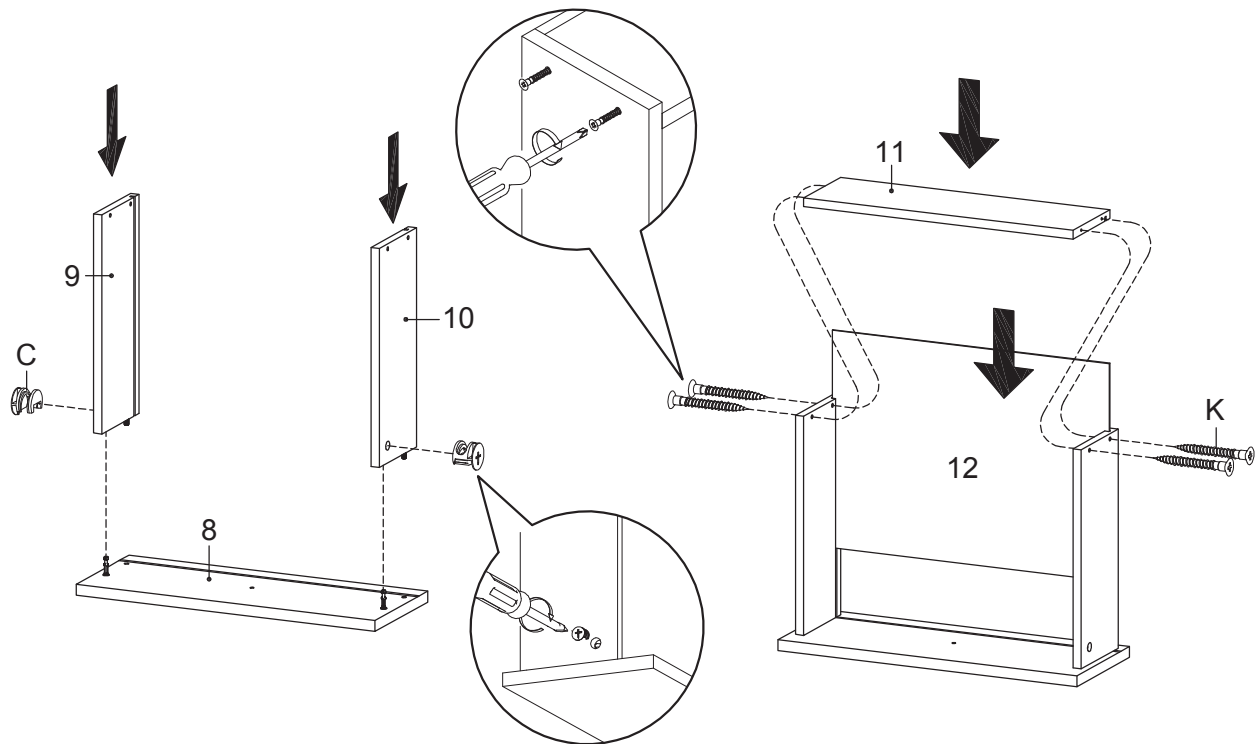

Attention: Insert part 12 (Bottom Drawer) first and then part 11 (Back Drawer)

Cx2	Kx4	Sx1

Hardware required. Screwdriver not included

STEP 12:

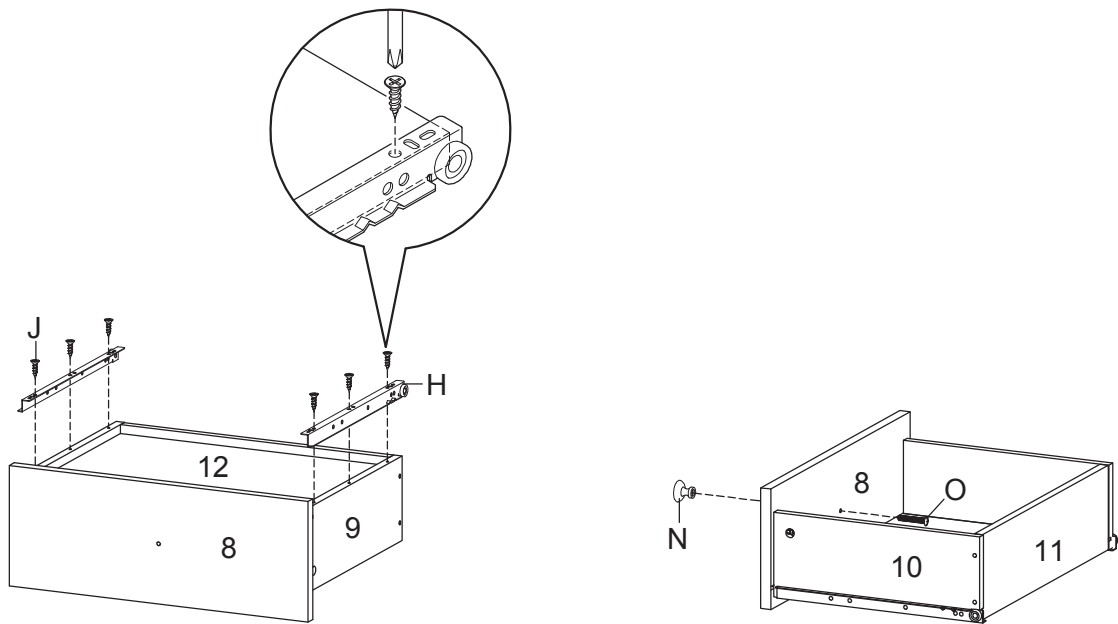

Hx1	Jx6	Nx1	Ox1	Sx1

Hardware required.
Screwdriver not included

TV STAND

STEP 13:

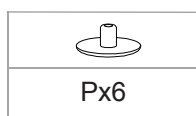
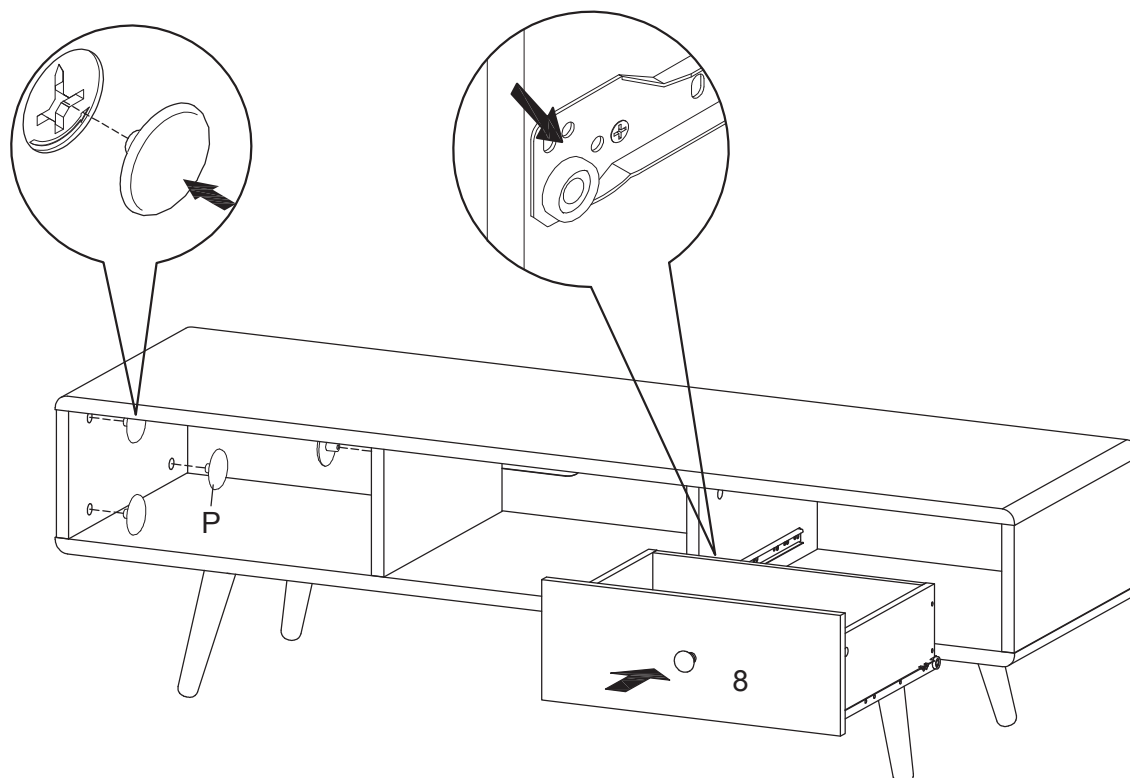

Hardware required

STEP 14:

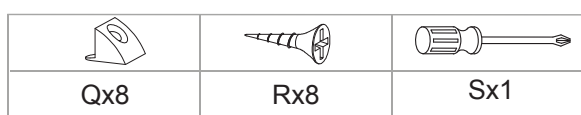
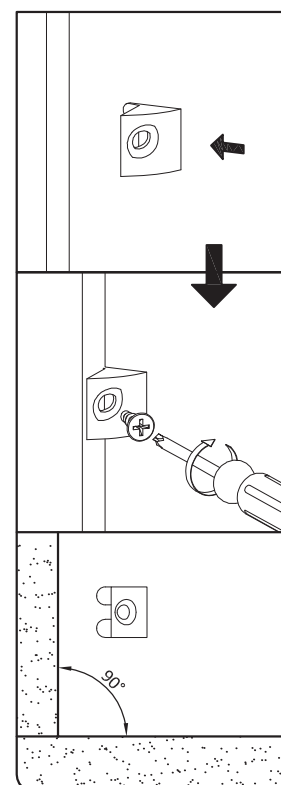
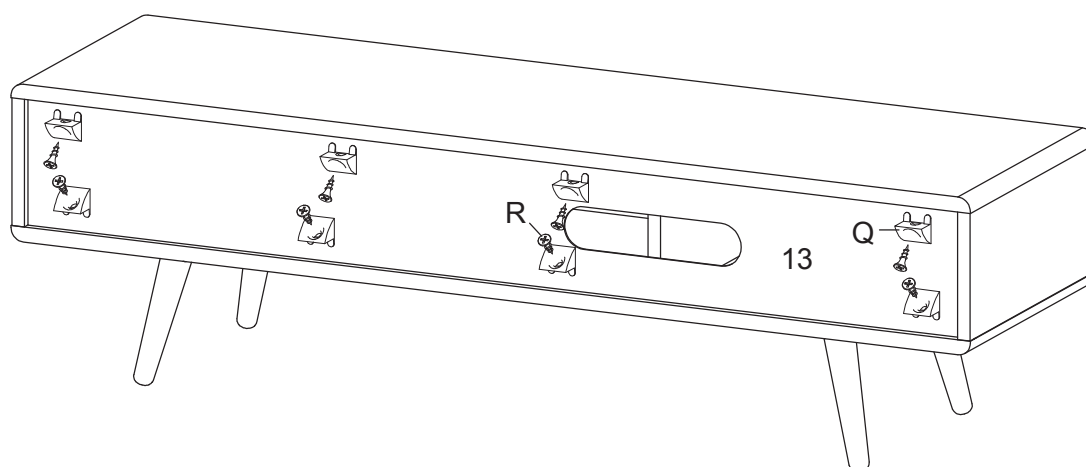

Hardware required. Screwdriver not included

TV STAND

STEP 15:

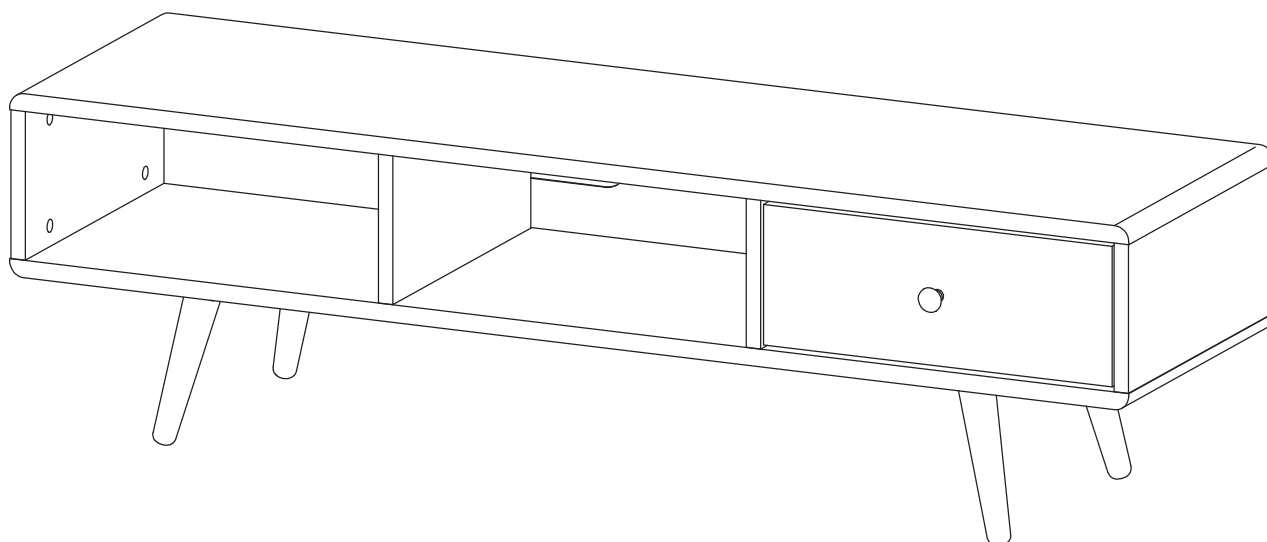

Assembly is completed. The TV Stand is ready to enjoy now !