

Assembly Instructions

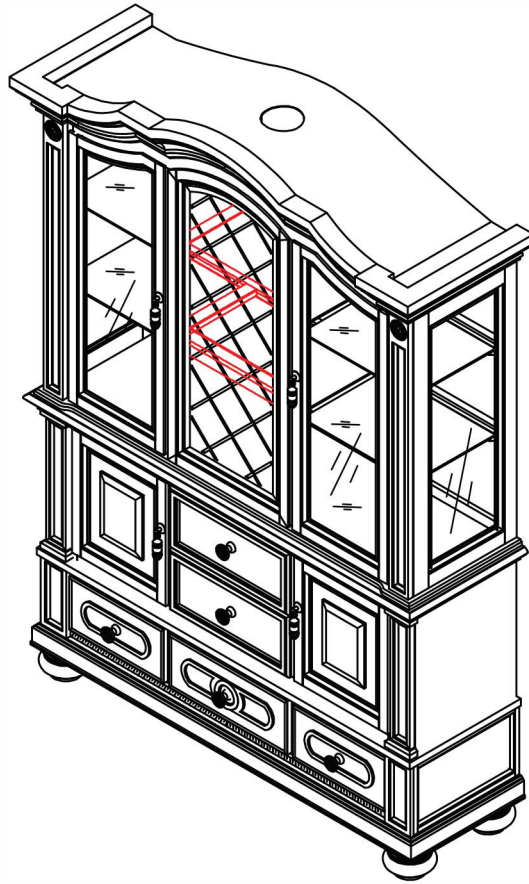

ASSEMBLY RATING

The Assembly Rating is a 5-point system that shows the degree of effort needed in assembling a specific product (with 1 being easy and 5 being difficult). For some products, two persons are recommended.

Tools Required For Assembly:

Phillips Screwdriver

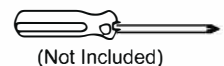

(Not Included)

EASY



DIFFICULT



2 PERSONS RECOMMENDED

ASSEMBLY & CARE ADVICE

FOR YOUR FURNITURE TO LAST, CORRECT ASSEMBLY AND PROPER MAINTENANCE ARE NECESSARY. PLEASE FOLLOW THE INFORMATION PROVIDED BELOW TO FULLY ENJOY YOUR FURNITURE.

BASIC ASSEMBLY TECHNIQUES

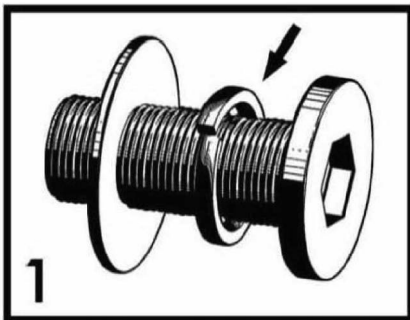

1 When lock or spring washer is used in an assembly, please make sure the lock or spring washer is placed between the larger flat washer and the head of the screw or bolt.

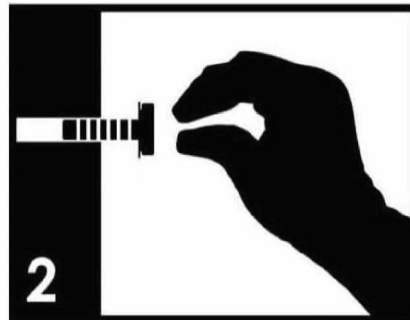

2 Position each part correctly and insert screws or bolts into their respective holes by hand tighten or using the proper hand tool. Only tighten when step is completed or when instructed to do so.

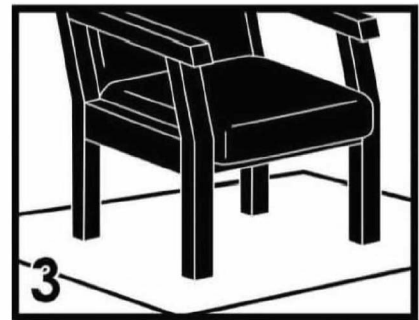

3 Use cardboard or carpet area when assembling furniture to prevent scratches. Make sure the furniture rests on a flat and level surface with each leg evenly touching the floor.

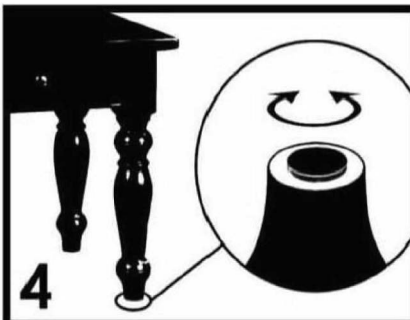

4 Some furniture comes with height adjustment knobs underneath each leg. To lower or to raise each leg, you need to turn clockwise or counterclockwise, respectively.

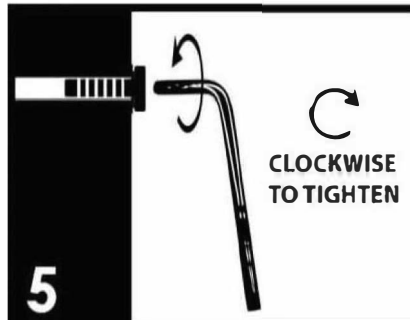

5 Make sure all parts are properly aligned, then use the appropriate hand tool to completely tighten the bolts or screws. Do not use power tools and do not overtighten.

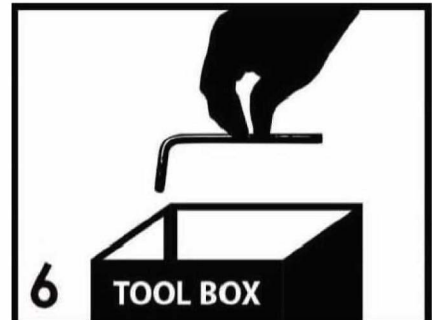

6 Save the instructions and store the Allen wrench or any supplied tool for later maintenance. After two weeks, check and tighten any loose hardware and repeat again every six months thereafter.

IT IS THE USER'S RESPONSIBILITY TO MAINTAIN THE FURNITURE. THE HARDWARE MAY LOOSEN OVER TIME AND MAY CAUSE THE FURNITURE TO BE WOBBLY AND UNABLE TO SUPPORT ITS INTENDED WEIGHT CAPACITY. THIS MAY LEAD TO COLLAPSE AND MAY CAUSE SERIOUS INJURY.



FAILURE TO FOLLOW THE GUIDELINES ABOVE MAY RESULT IN INJURY AND/OR PROPERTY DAMAGE.

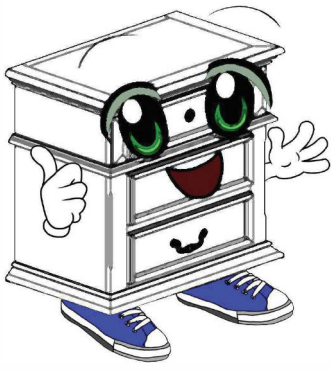

Before you begin, please read Page 2 of "Assembly and Care Advice".

And remember, do not tighten until each step is completed or instructed.

Parts List

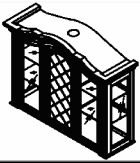

#1 x 1pc
Hutch

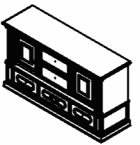

#2 x 1pc
Buffet



#3 x 4pcs
Bun Foot



#4 x 4pcs
Side Glass Shelf



#5 x 2pcs
Middle Glass Shelf

Hardware List

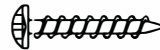

#A x 4pcs
Screw #7 x 5/8"



#B x 8pcs
Shelf Support

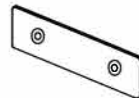

#C x 2pcs
Metal Plate

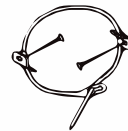

#D x 2Set
Tipping Restraint

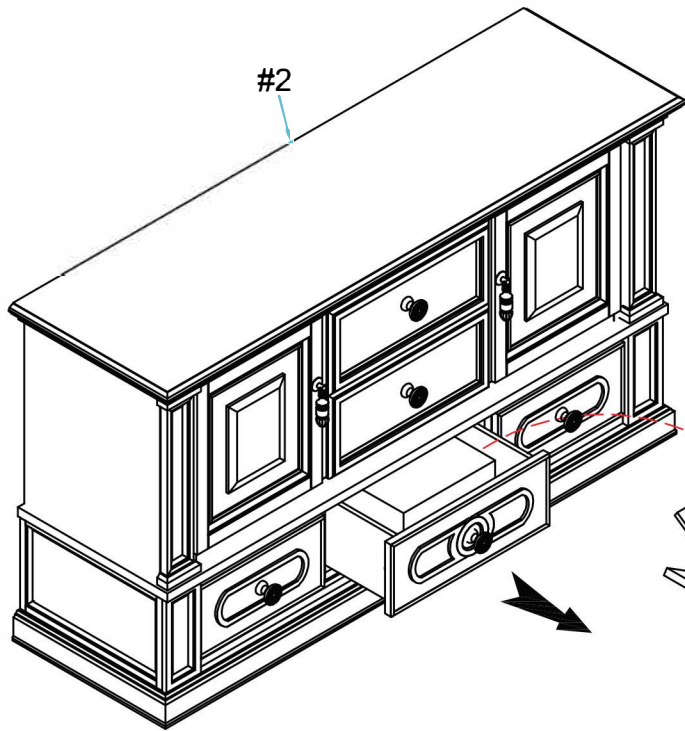

Open drawer for bun foot.

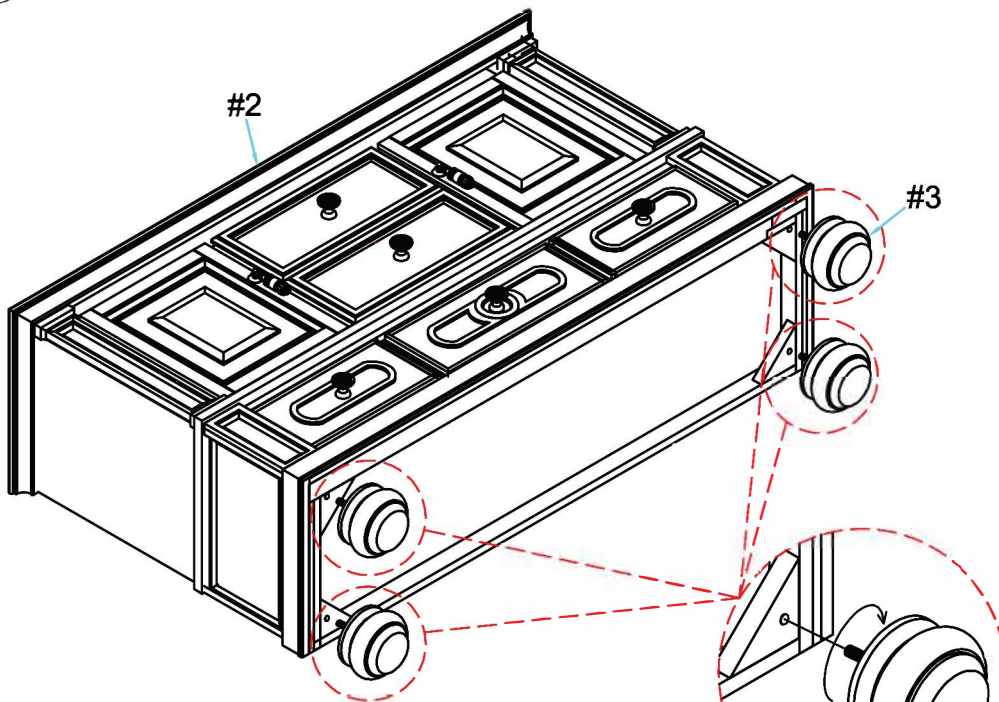
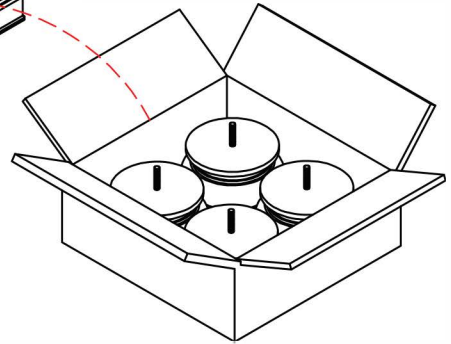

Insert the threaded ends of the feet (#3) into the holes along the bottom, turn right to tighten.



#3

#D x 1PC

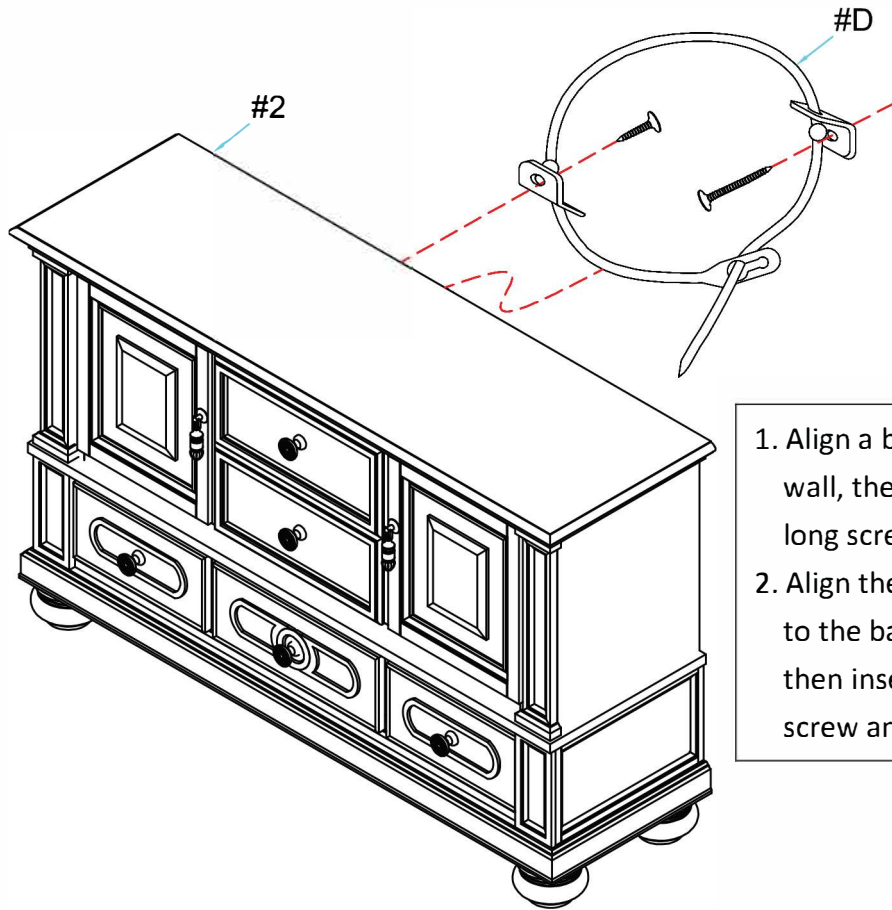

1. Align a bracket to the wall, then insert the long screw and secure.
2. Align the other bracket to the back of the buffet, then insert the short screw and secure.



#4

#5 x 2PCS
#A x 4PCS
#C x 2PCS

Align the metal plates (#C) to the holes along the back, then insert the screws (#A) and secure using a screwdriver.

Place the middle glass shelves (#5).

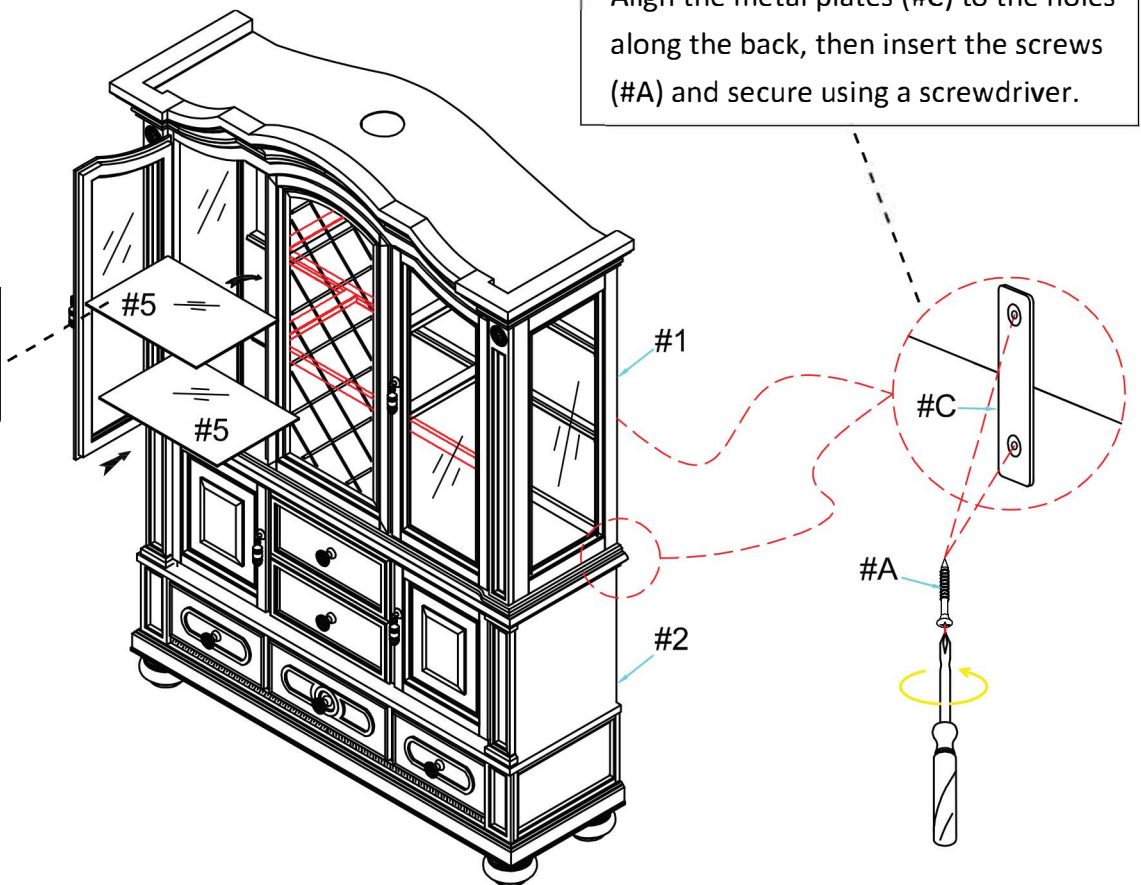



#5

#4 x 8PCS

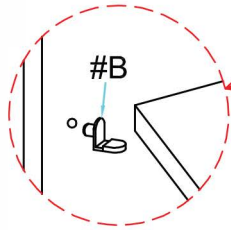

Insert the shelf supports (#B) into the desired holes, then place the the side glass shelves (#4).

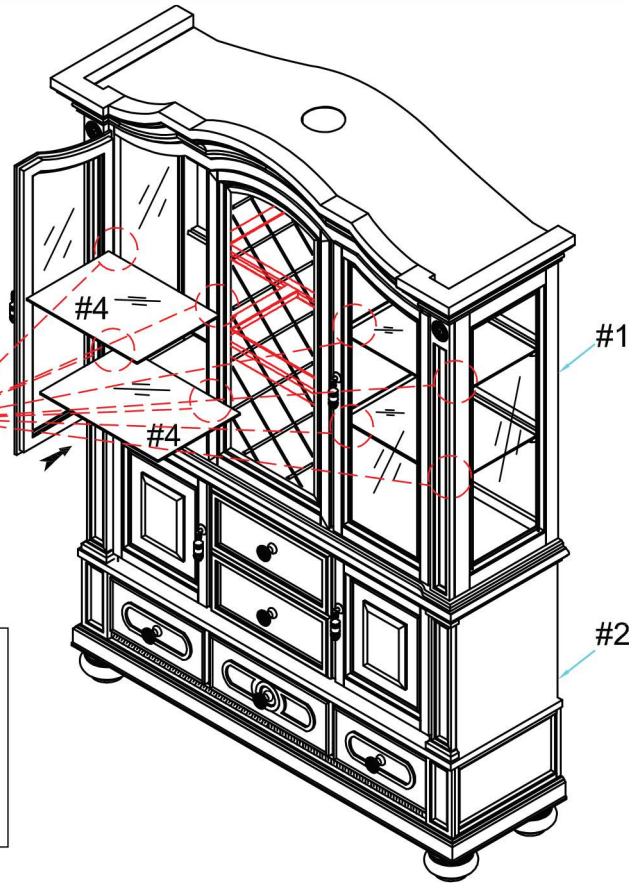

#6

#D x 1PC

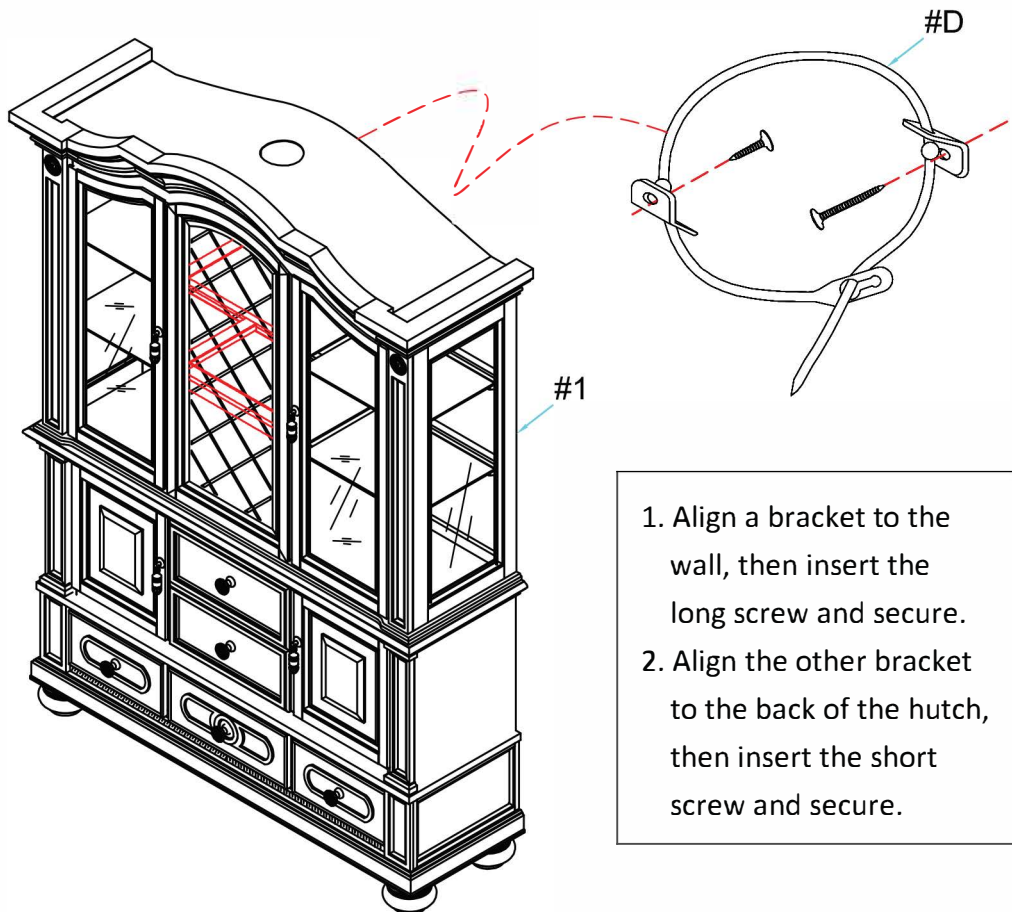

1. Align a bracket to the wall, then insert the long screw and secure.
2. Align the other bracket to the back of the hutch, then insert the short screw and secure.