

# ASSEMBLY INSTRUCTIONS



## ASSEMBLY TIPS

- 1.Remove hardware from box and sort by size.
- 2.Please check to see that all hardware and parts are present prior to start of assembly.
- 3.Please follow attached instructions in the same sequence as numbered to assure fast & easy assembly.



### Warning !

- 1.Don't attempt to repair or modify parts that are broken or defective.Please contact the store immediately.
- 2.This product is for home use only and not intended for commercial establishment.

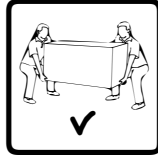

ASSEMBLY TIME PER UNIT: 70 MINUTES

### PARTS IDENTIFICATION:

(A) LEFT SIDE PANEL

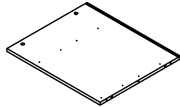

1PC

(B) LEFT DIVIDER PANEL

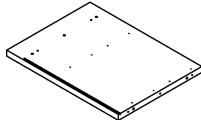

1PC

(C) RIGHT DIVIDER PANEL

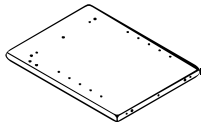

1PC

(D) RIGHT SIDE PANEL

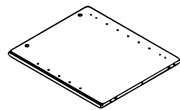

1PC

(E) LEFT BOTTOM PANEL

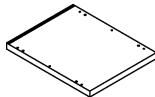

1PC

(F) RIGHT BOTTOM PANEL

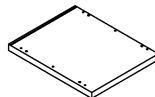

1PC

(G) SMALL LEFT TOP PANEL

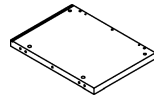

1PC

(H) SMALL RIGHT TOP PANEL

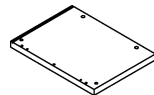

1PC

(I) SMALL BACK PANEL

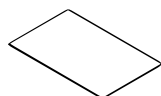

2PCS

(J) LARGE BACK PANEL

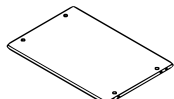

1PC

(K) KEYBOARD SHELF

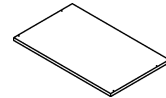

1PC

(L) ADJUSTABLE SHELF

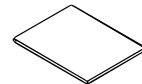

1PC

(M) DOOR

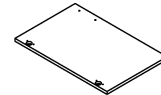

1PC

(N) LARGE TOP PANEL

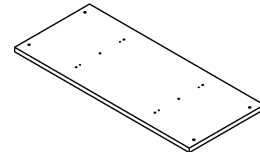

1PC

(O) LARGE DRAWER FRONT PANEL

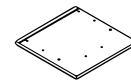

1PC

(P) LARGE DRAWER BACK PANEL



1PC

(Q) LARGE LEFT DRAWER SIDE PANEL

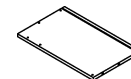

1PC

(R) LARGE RIGHT DRAWER SIDE PANEL

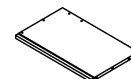

1PC

(S) SMALL DRAWER FRONT PANEL

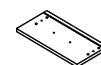

1PC

(T) SMALL DRAWER BACK PANEL



1PC



(U) SMALL LEFT DRAWER SIDE PANEL

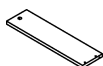

1PC

(W) DRAWER BOTTOM PANEL

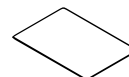

2PCS

(V) SMALL RIGHT DRAWER SIDE PANEL

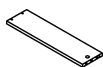

1PC

Z							
HARDWARE PACKAGE							
NO	DESCRIPTION	FIGURE	Q'TY	NO	DESCRIPTION	FIGURE	Q'TY
1	GLUE 40g		1PC	12	SCREW $\phi 3 \times 12 \text{mm}$ FOR EURO SLIDE		28PCS
2	WOODEN DOWEL $\phi 8 \times 30 \text{mm}$		38PCS	13	HANDLE L=120mm		3PCS
3	CAM BOLT $\phi 7 \times 35.5 \text{mm}$		20PCS	14	HANDLE BOLT $\phi 4 \times 20 \text{mm}$		6PCS
4	CAM LOCK $\phi 15 \times 12 \text{mm}$		20PCS	15	FOOT $50 \times 50 \times 18 \text{mm}$		8PCS
5	BOLT $\phi 9.5 \times 55 \text{mm}$ FOR BOTTOM PANEL		12PCS	16	LONG SCREW $\phi 5 \times 20 \text{mm}$		16PCS
6	SCREW $\phi 4.3 \times 35 \text{mm}$ FOR DRAWER		8PCS	17	HINGE		2PCS
7	DOOR CATCH		1PC	18	SCREW $\phi 4 \times 15 \text{mm}$ FOR HINGE		8PCS
8	PIN $\phi 4.9 \times 8 \text{mm}$		4PCS	19	IRON BAR L=80mm		4PCS
9	RAIL L = 350mm		1SET	20	BOLT M6x38mm FOR IRON BAR		4PCS
10	SCREW $\phi 3.5 \times 12 \text{mm}$ FOR RAIL		10PCS	21	IRON BAR $\phi 4.8 \times 312 \text{mm}$		2PCS
11	EURO SLIDE L = 450mm		2SET	22	STICKER $\phi 20 \text{mm}$		4PCS

Z9,Z10,Z11,Z13,Z14,Z15,Z17,Z19,Z21 not included in blister packaging.



# STEP 1 :

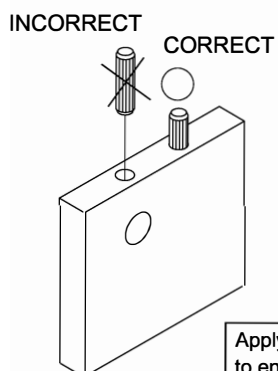
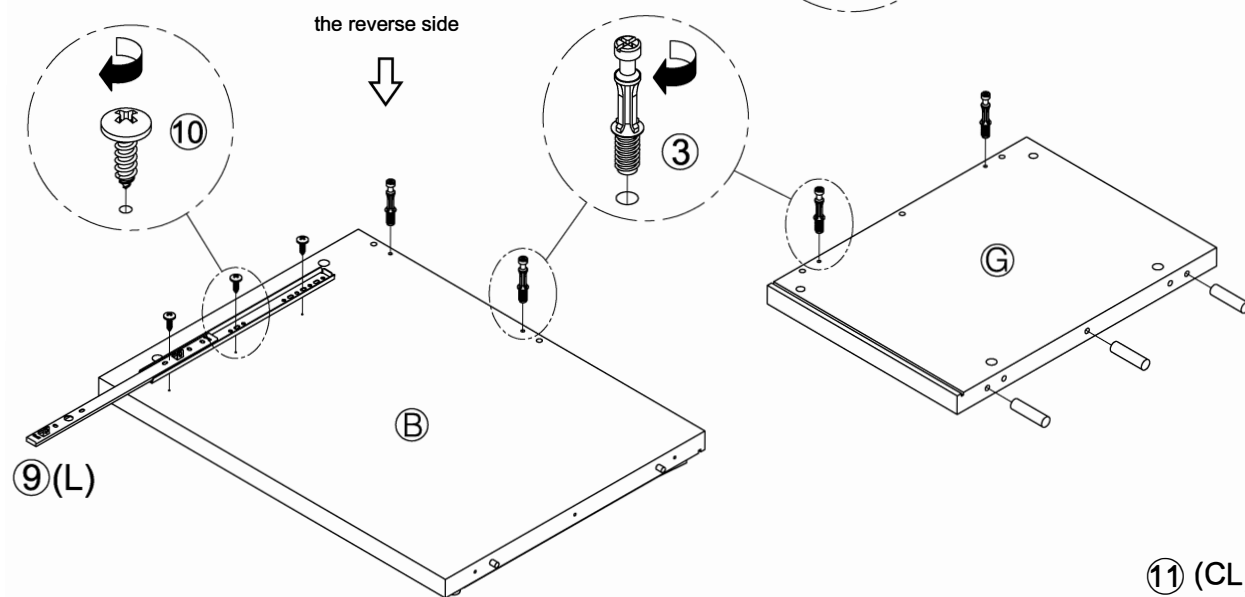
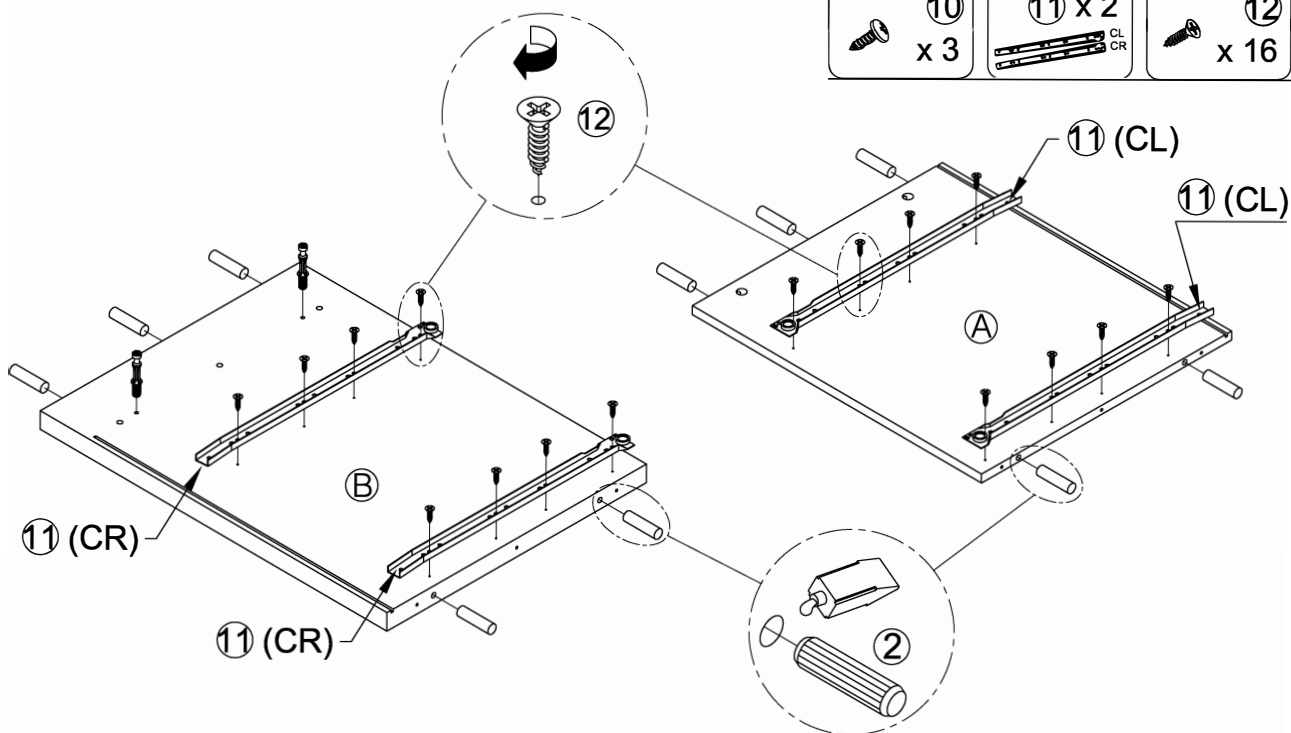
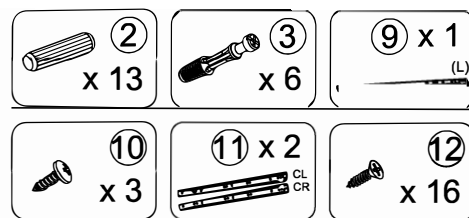

Apply glue on all wooden dowels to ensure integrity of the structure.

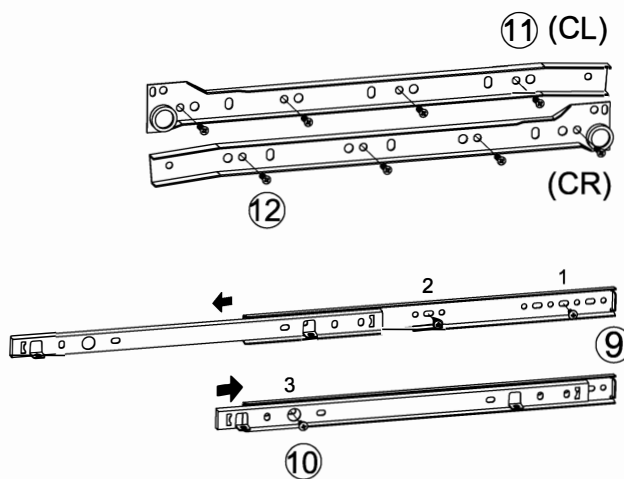



## STEP 2 :

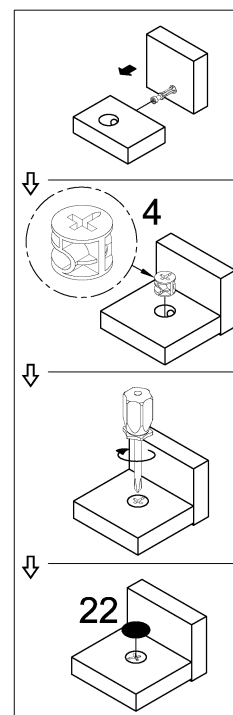
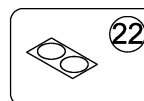
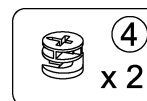
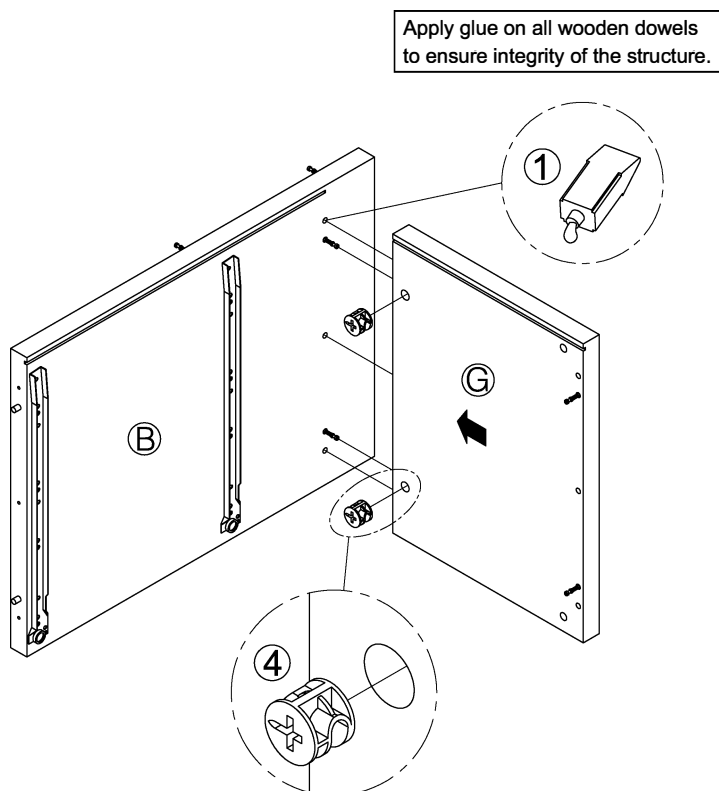

## STEP 3 :

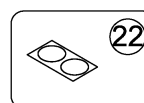
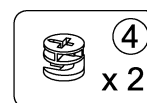
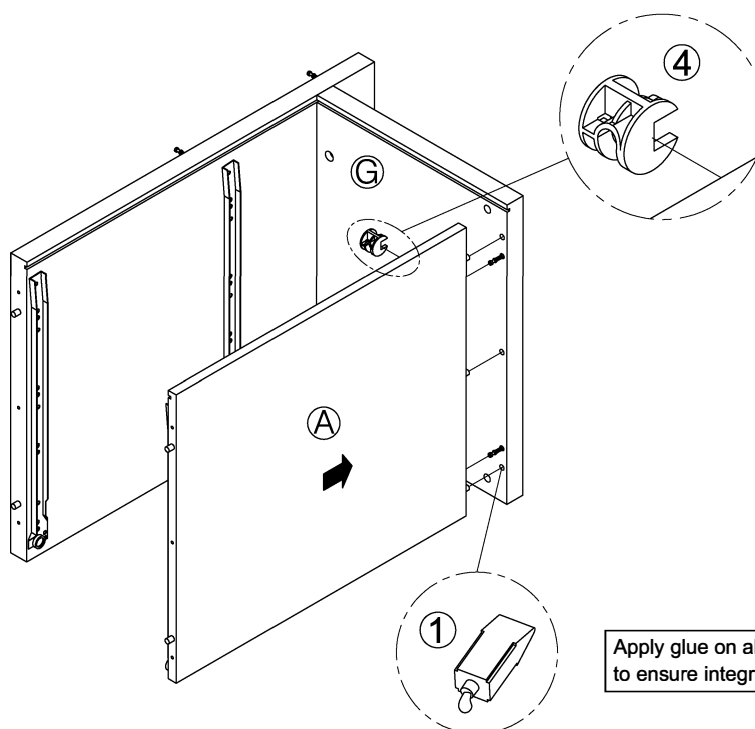

Apply glue on all wooden dowels to ensure integrity of the structure.



# STEP 4 :

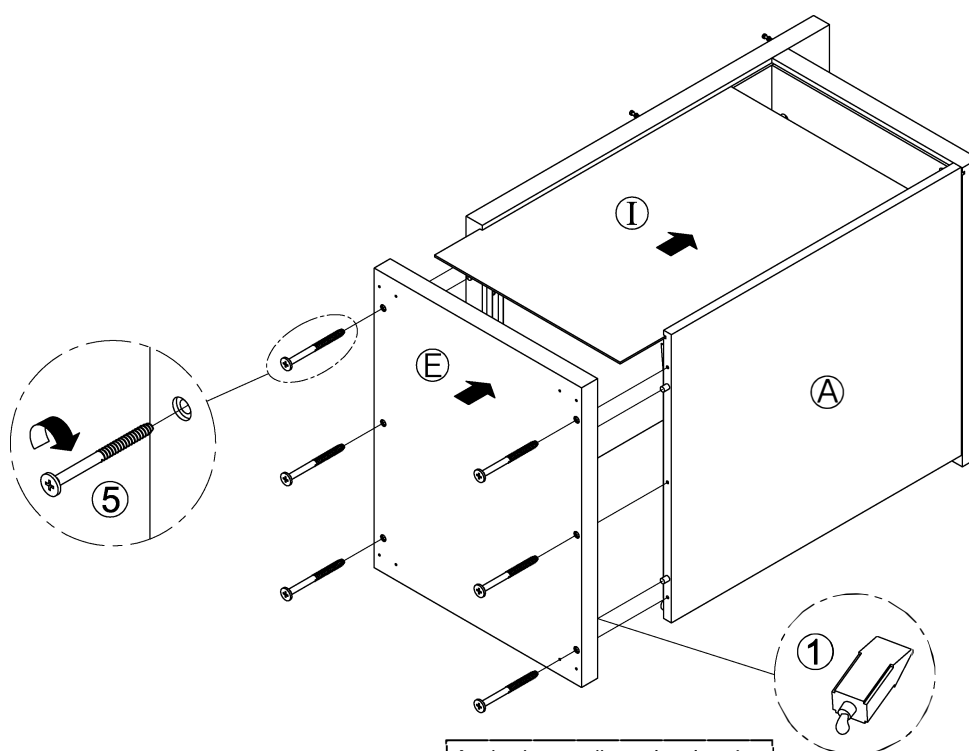
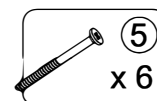

Apply glue on all wooden dowels  
to ensure integrity of the structure.

# STEP 5 :

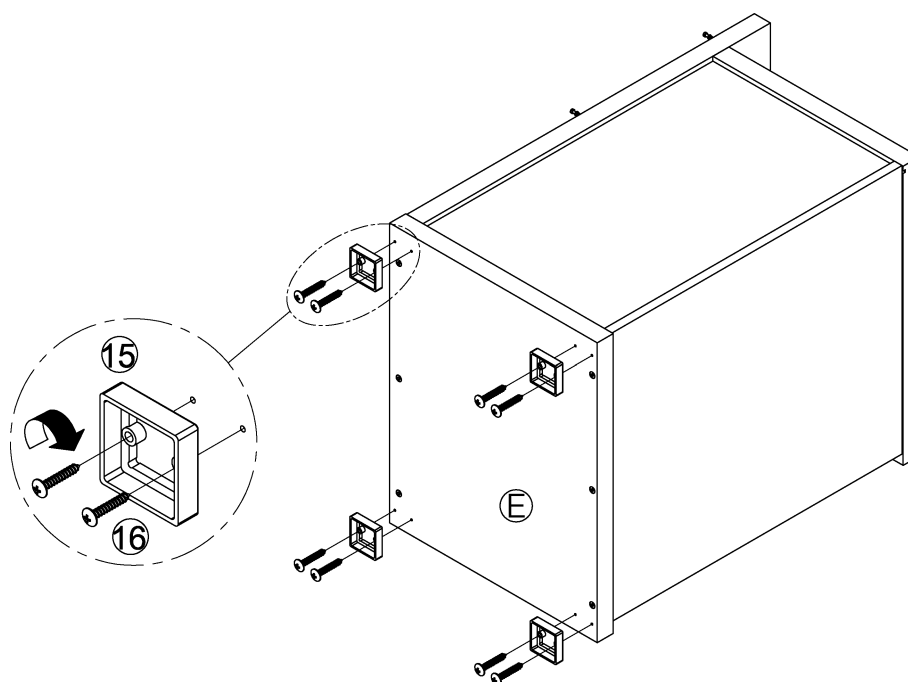
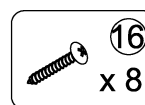
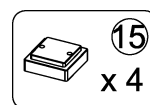



# STEP 6 :

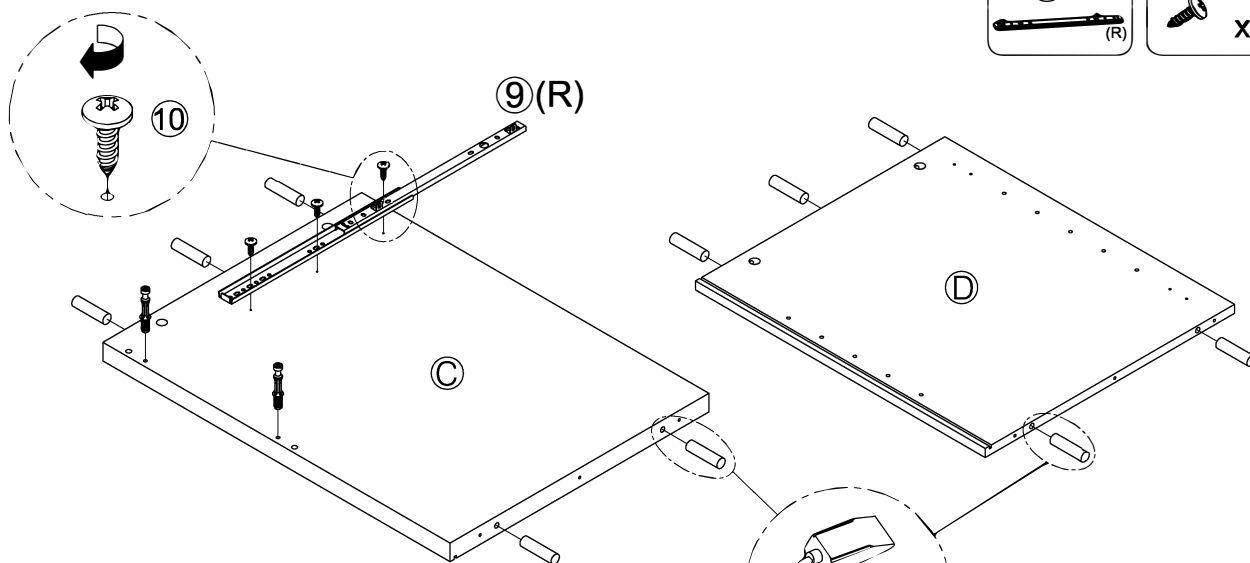
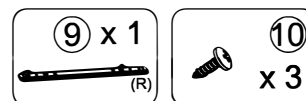
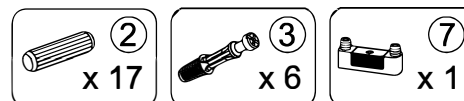

the reverse side

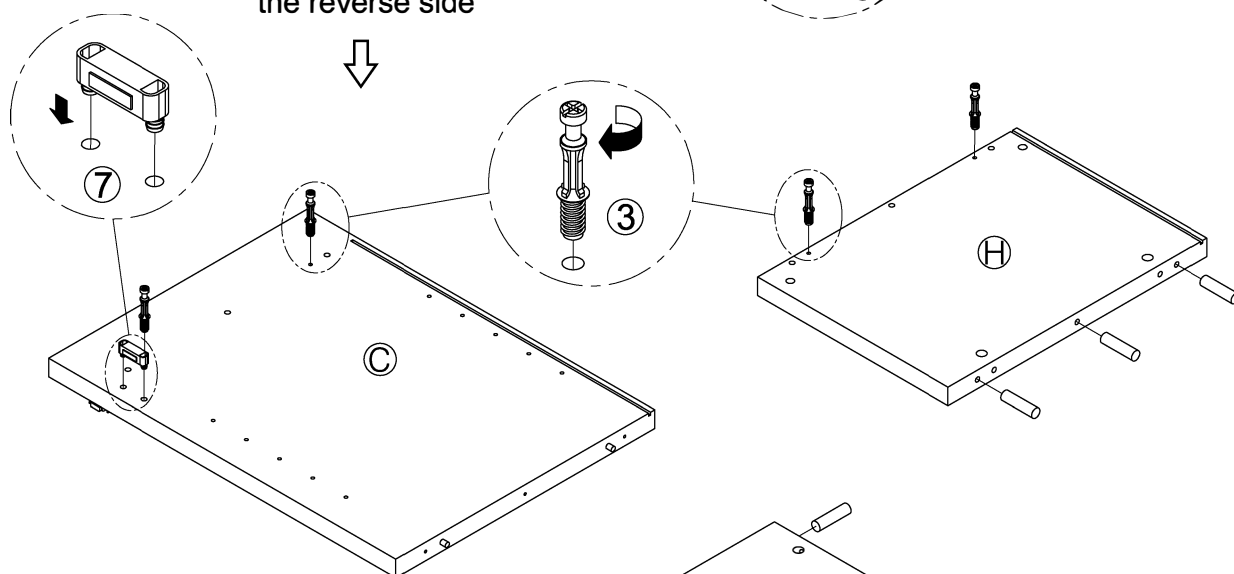

INCORRECT CORRECT

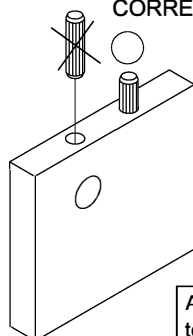

Apply glue on all wooden dowels to ensure integrity of the structure.

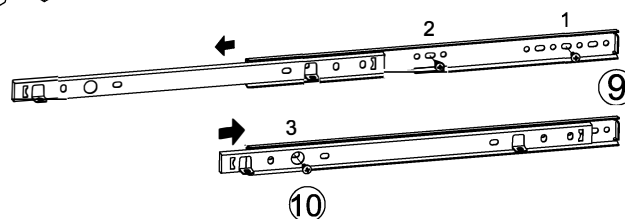



## STEP 7 :

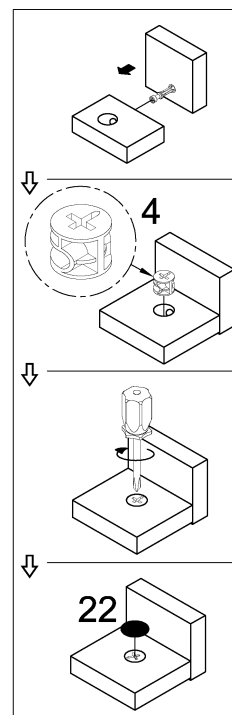
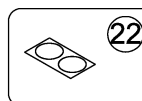
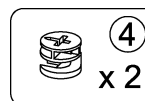
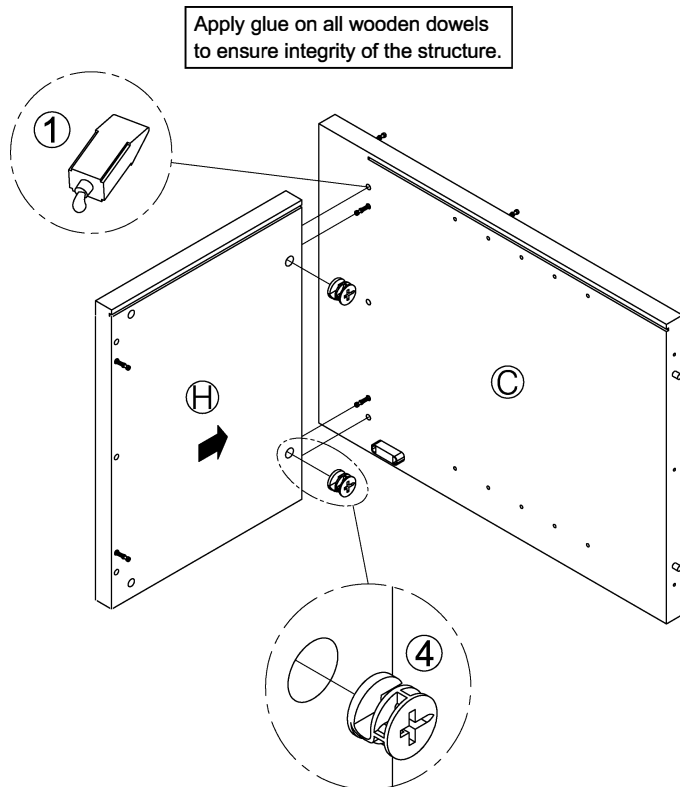

## STEP 8 :

Apply glue on all wooden dowels to ensure integrity of the structure.

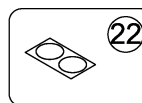
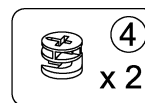
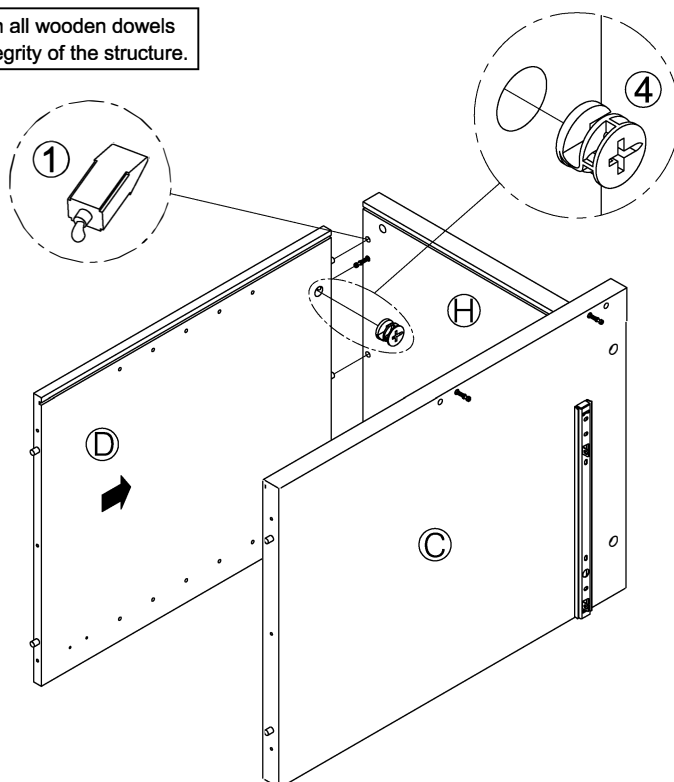



## STEP 9 :

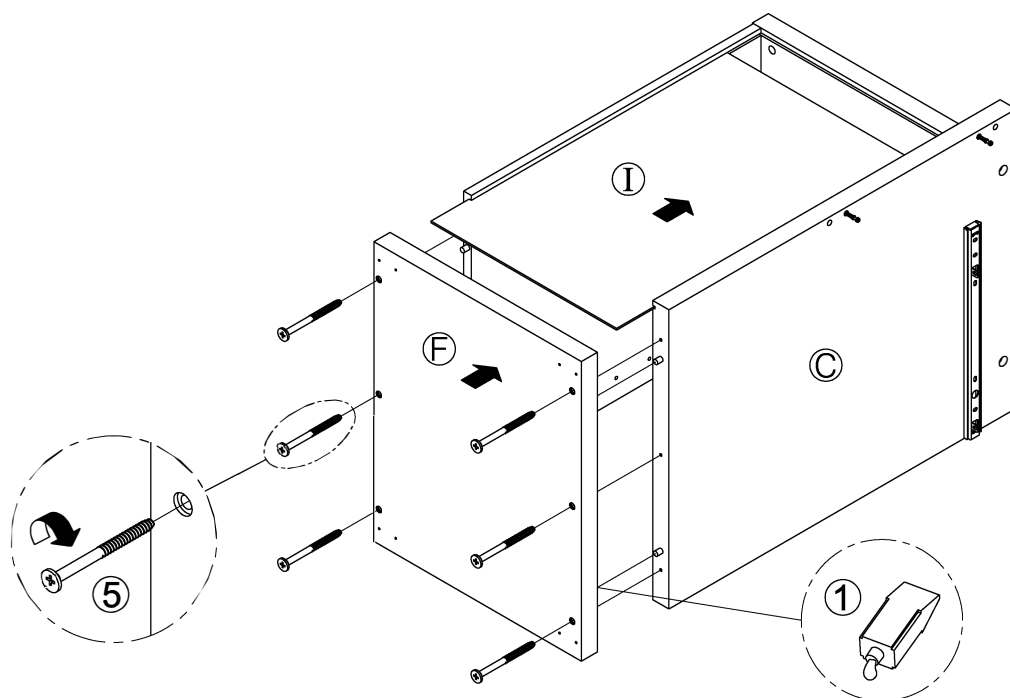
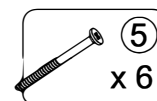

Apply glue on all wooden dowels  
to ensure integrity of the structure.

## STEP 10 :

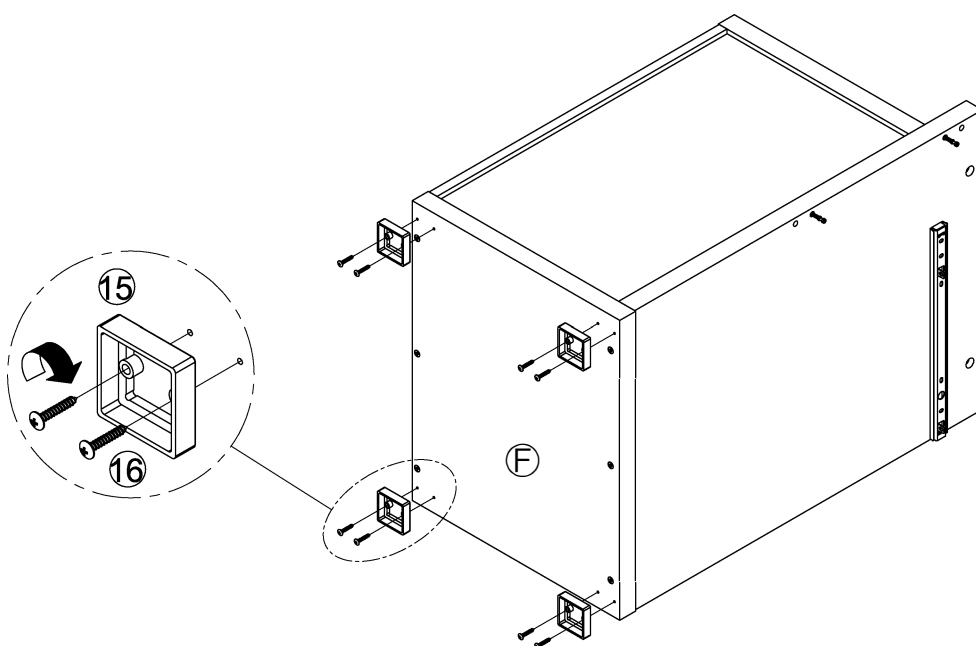
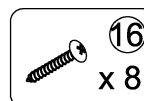
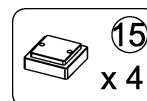



## STEP 11 :

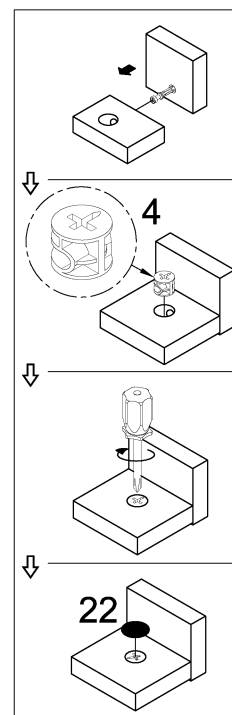
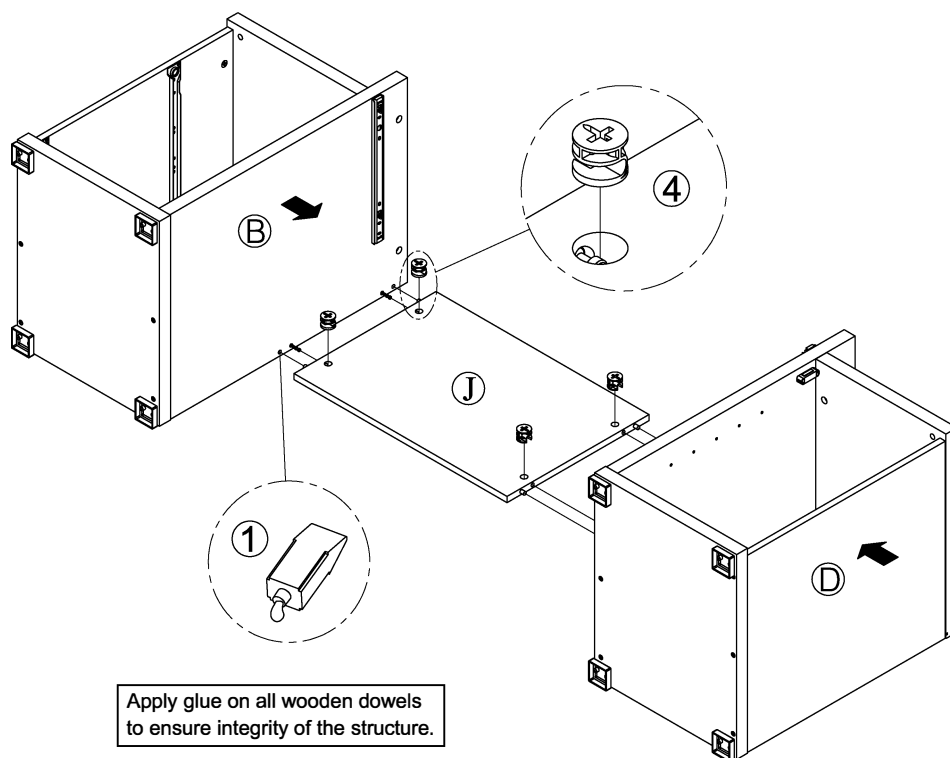

## STEP 12 :

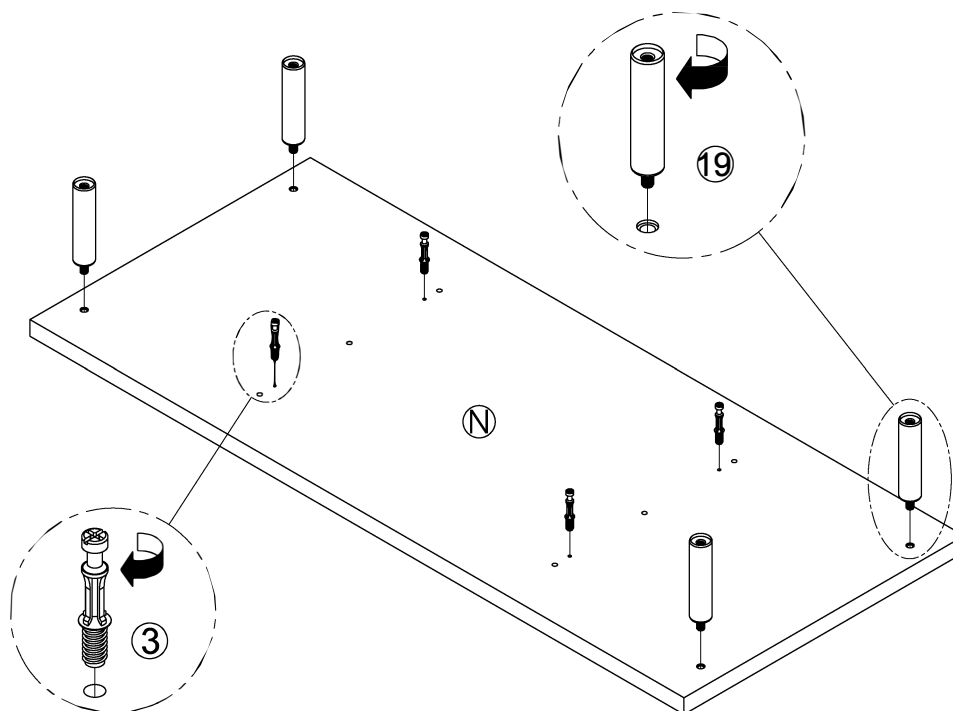
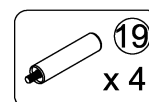
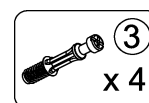



### STEP 13 :

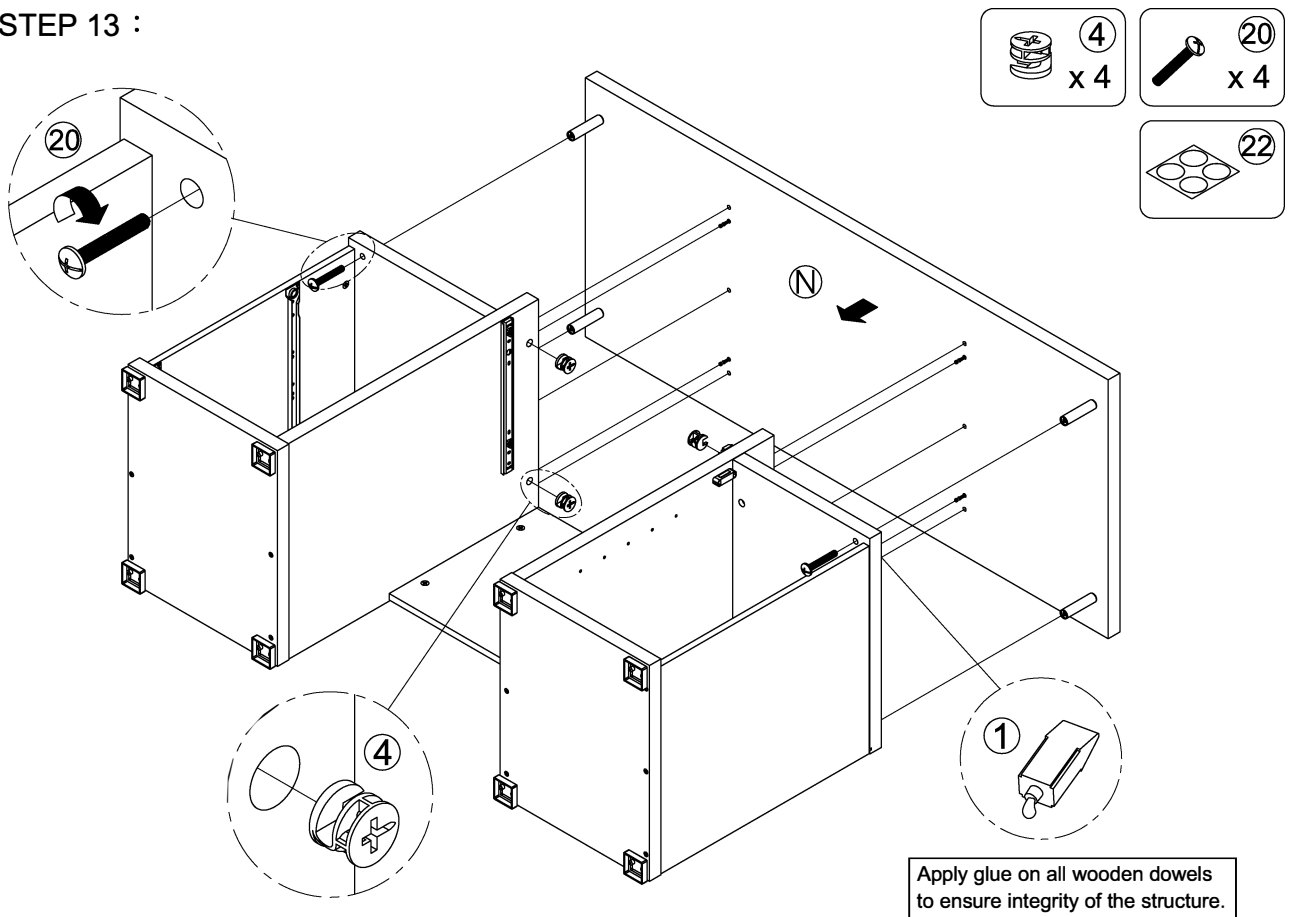

### STEP 14 :

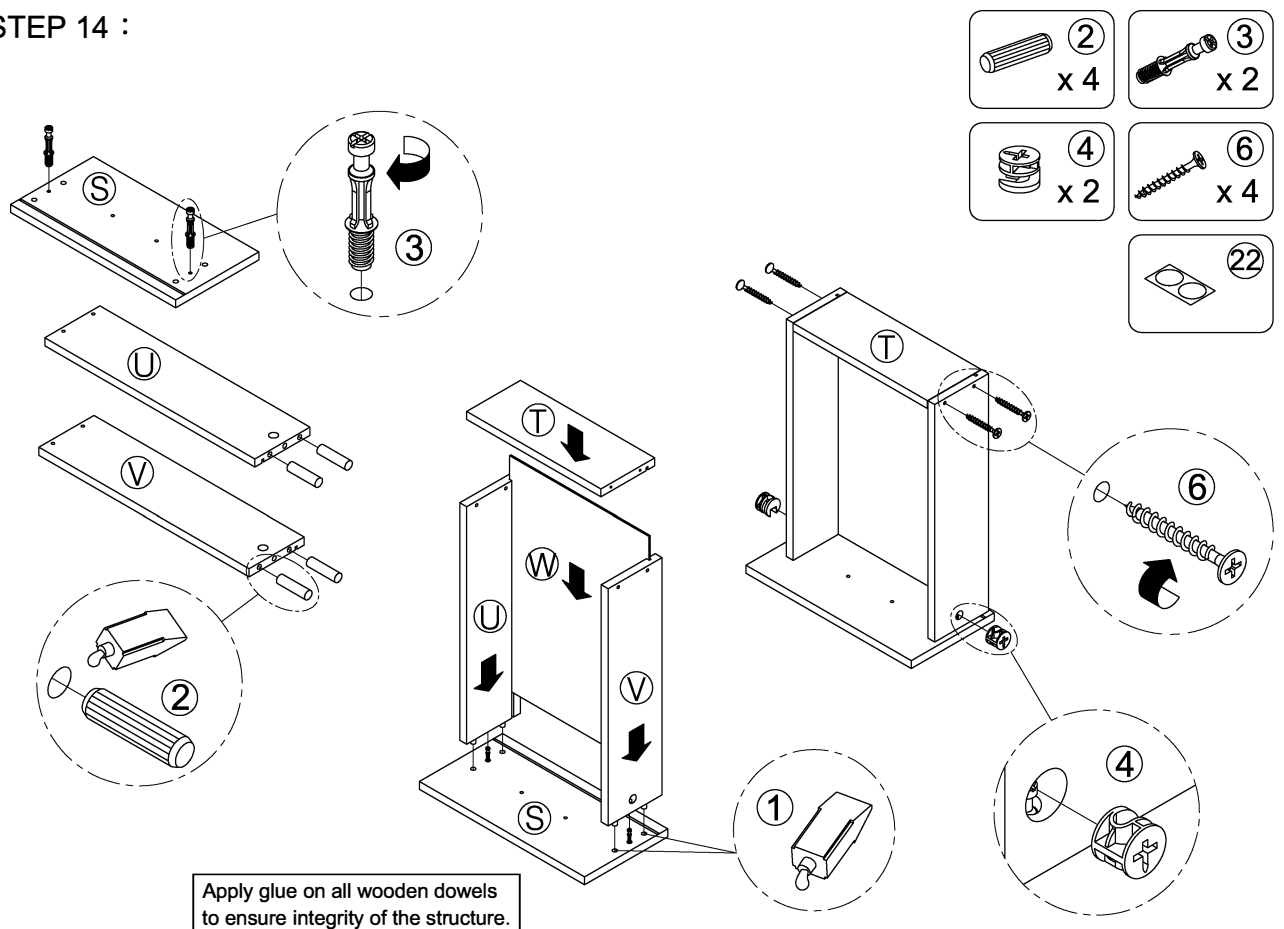



## STEP 15 :

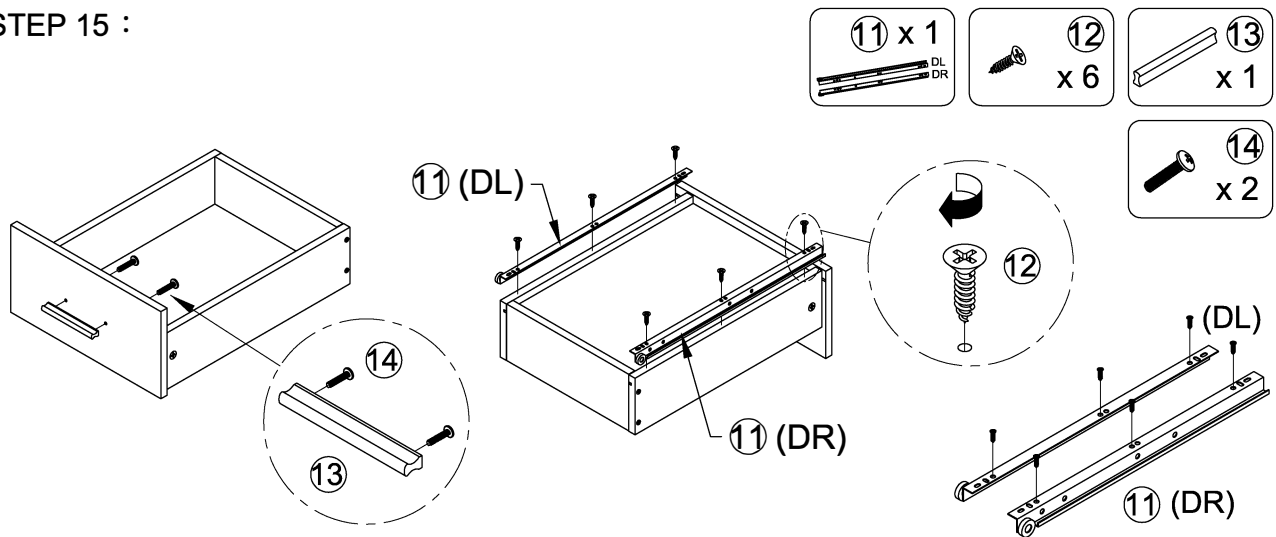

## STEP 16 :

Apply glue on all wooden dowels to ensure integrity of the structure.

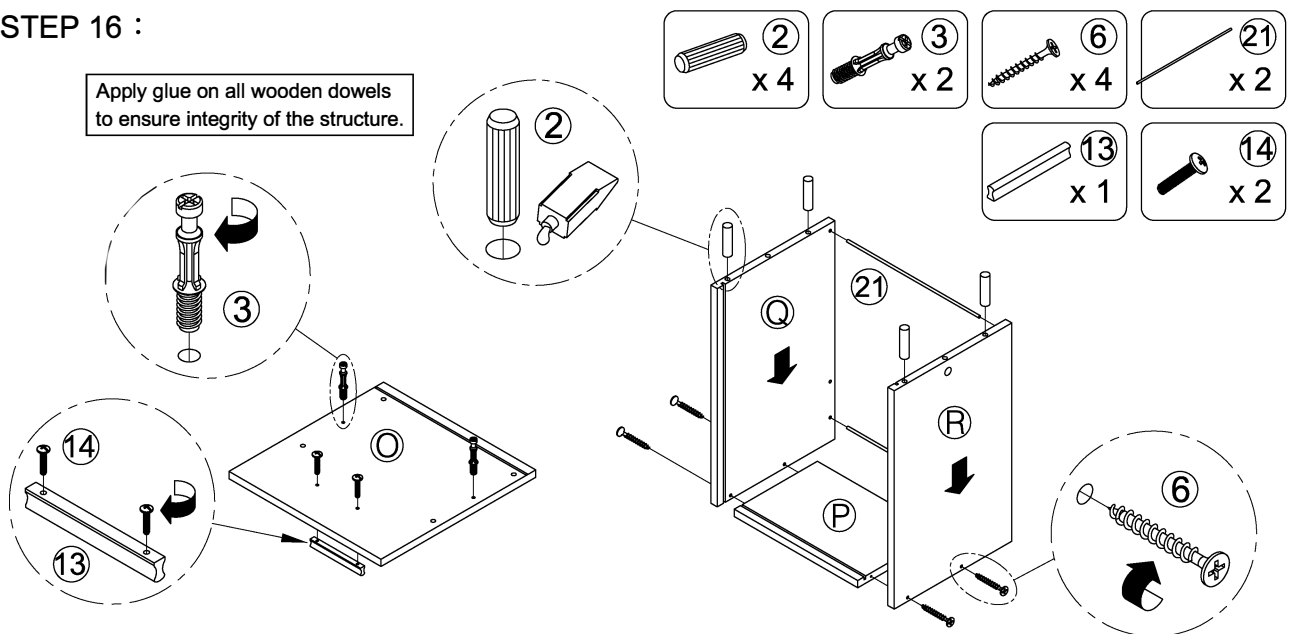

## STEP 17 :

Apply glue on all wooden dowels to ensure integrity of the structure.

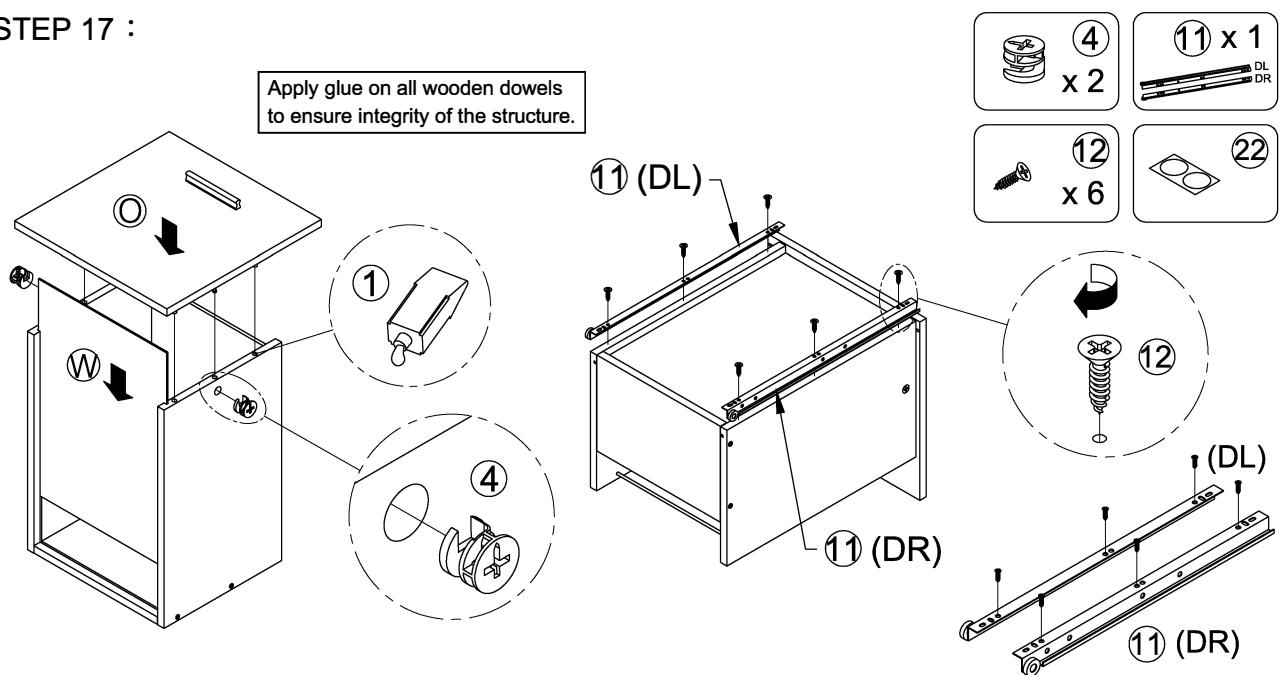



STEP 18 :

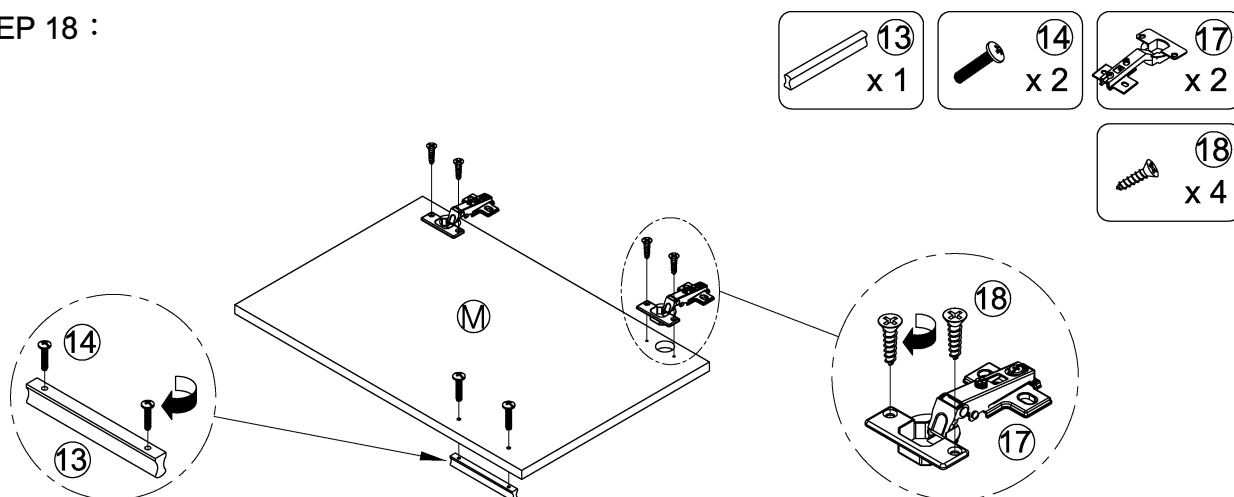

STEP 19 :

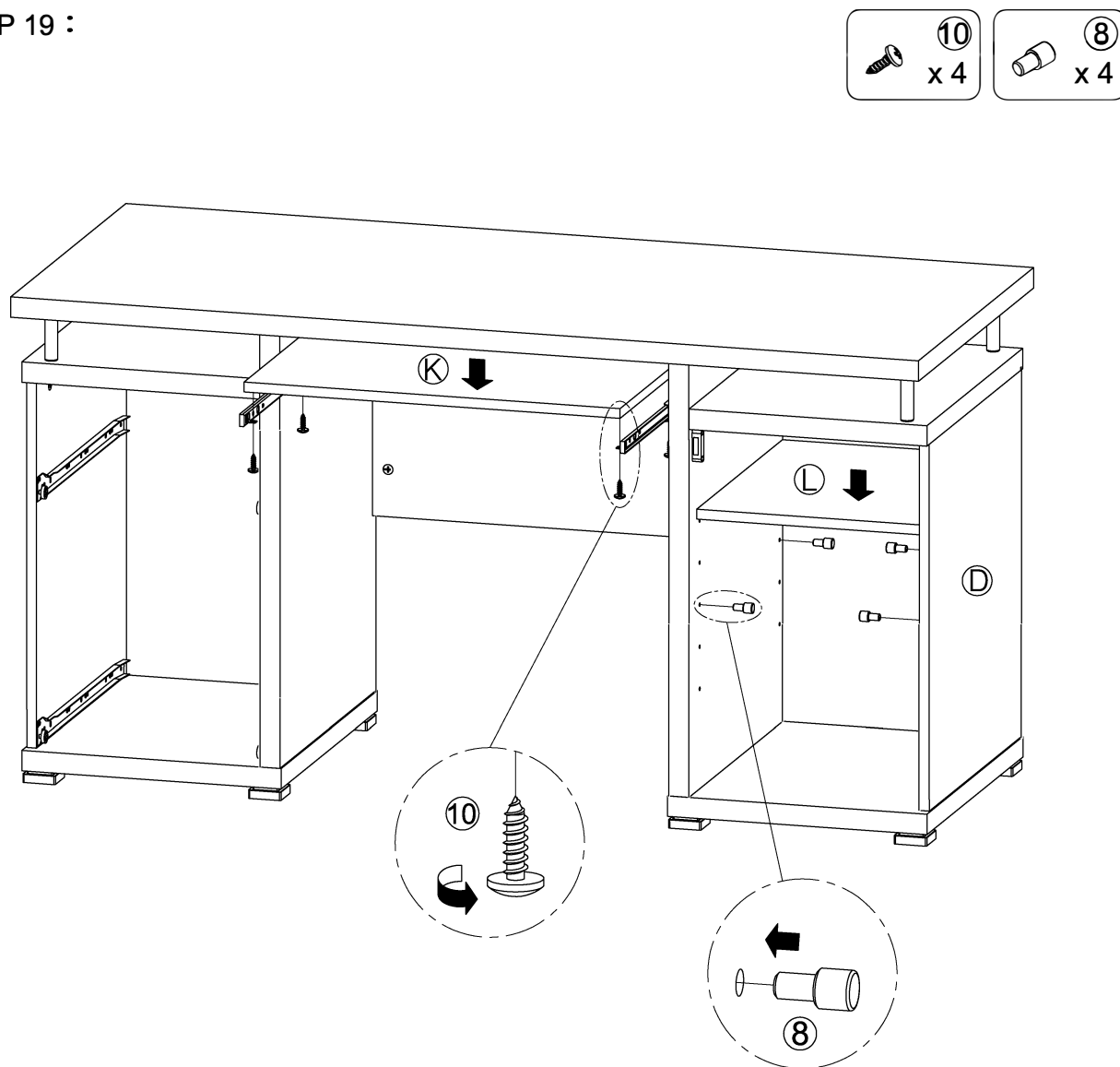



STEP 20 :

 **18**  
x 4

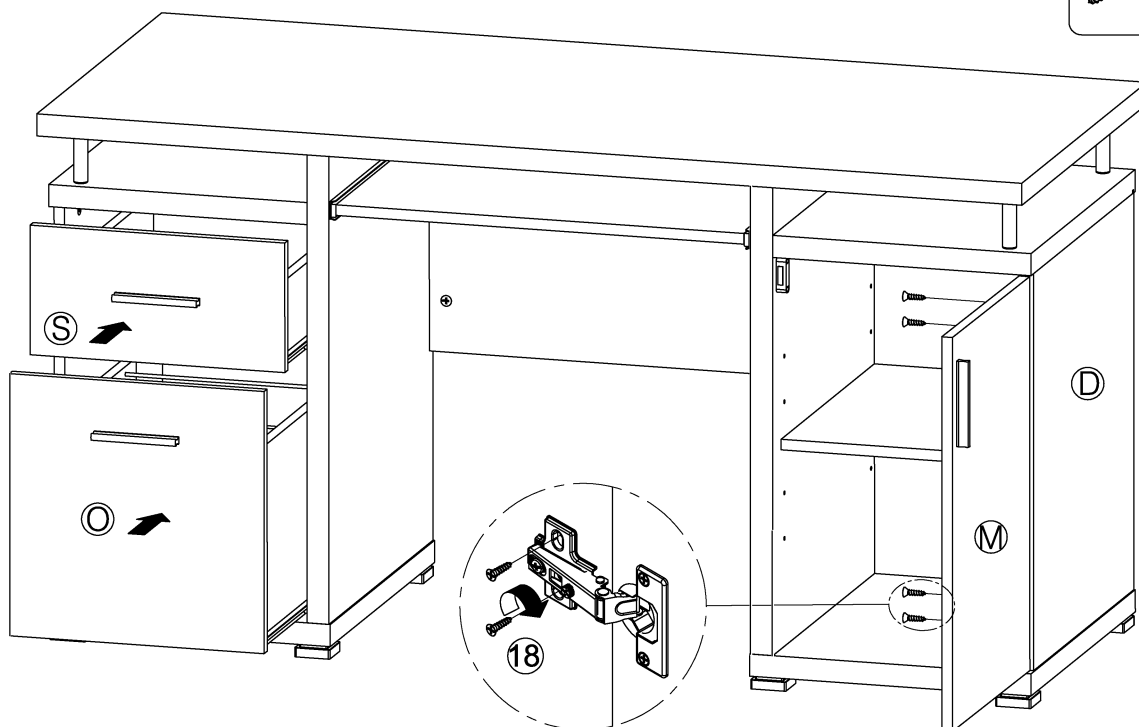

FINISH

