

Assembly Instructions

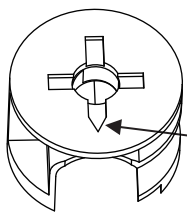

NOTICE "pointer arrow" on face of Cam (Part B)

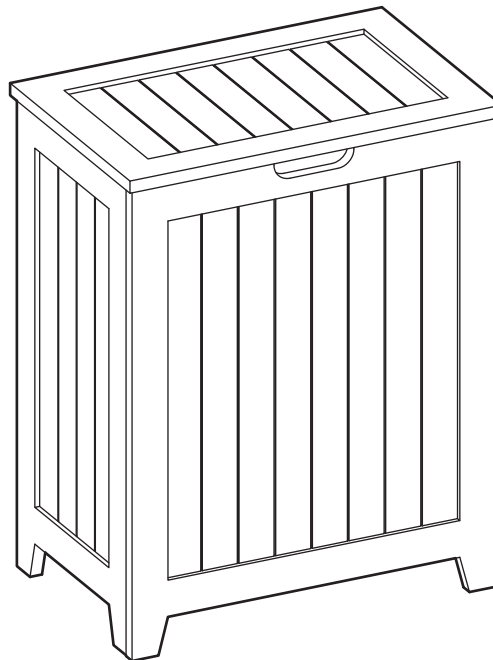

Dimensions

Width-46.5cm
Depth-30cm
Height-59cm

Place the Cam so that the "pointer arrow" faces the edge of the panel. This allows for the Pin (Part A) to be correctly aligned with the opening of the Cam.

Turn the Cam clockwise (normally about $\frac{1}{2}$ turn. The Cam will capture the head of the Pin. As the Cam is turned it will draw the two panels together.

See picture above and figures 1.1, 1.2, 1.3 for reference.

1 x 1pc	2 x 1pc	3 x 1pc	4 x 1pc	5 x 1pc	6 x 1pc	7 x 1pc	8 x 1pc
A x 8pcs	B x 8pcs	C x 4pcs	D x 2pcs	E x 8pcs	F x 2pcs		

Assembly Instructions

STEP 1

IMPORTANT: It is very important not to over tighten. The "Cam Insert" only needs to engage and lock on the head of the post. It cannot be tightened and can easily be damaged if force is used.

NOTE Proper Cam & Pin alignment (Parts A & B)

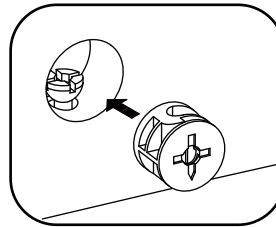
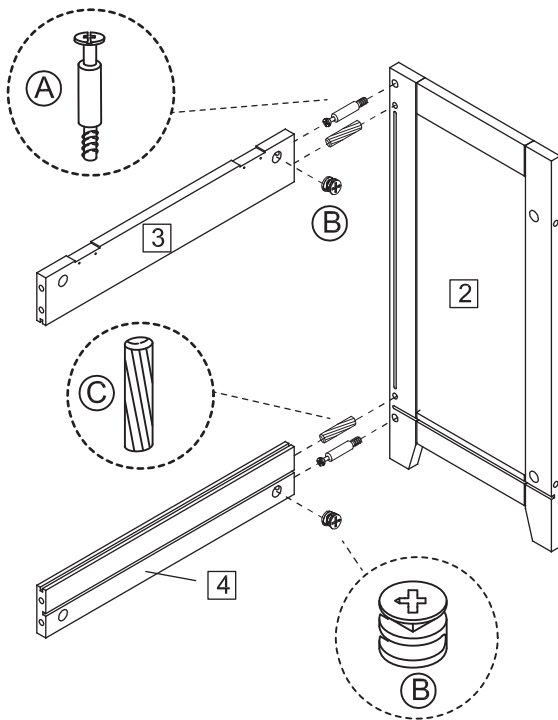

NOTE position of "pointer arrow" on Cam (Part B) points toward head of Pin (Part B)

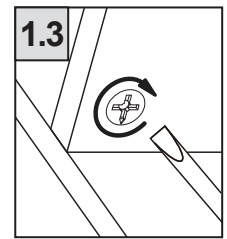
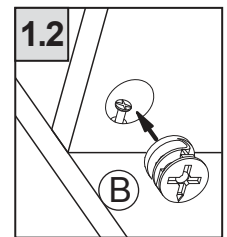
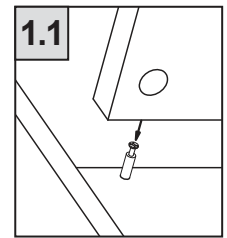

STEP 2

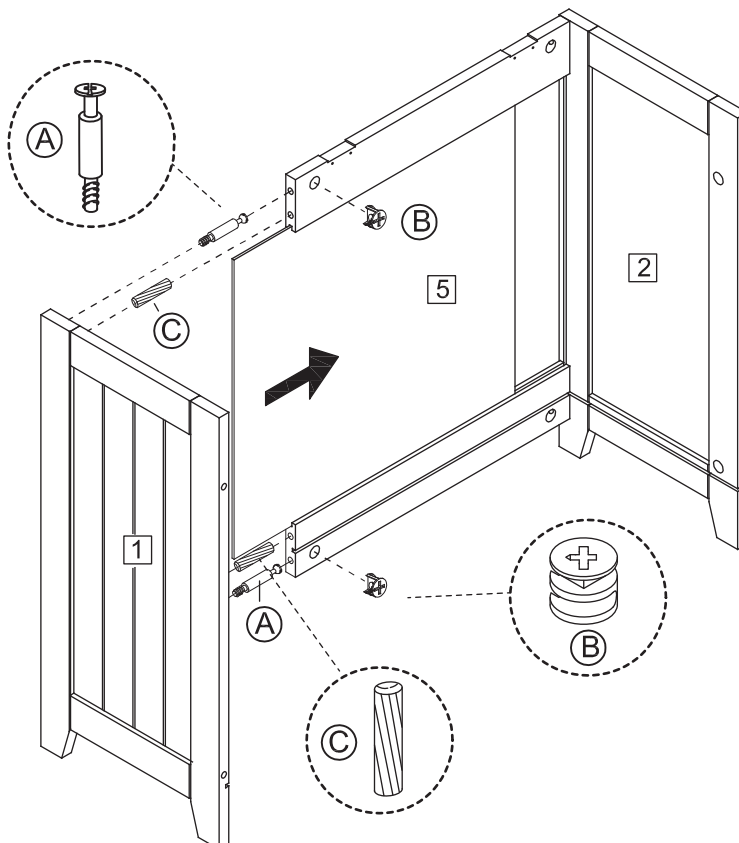

Assembly Instructions

STEP 3

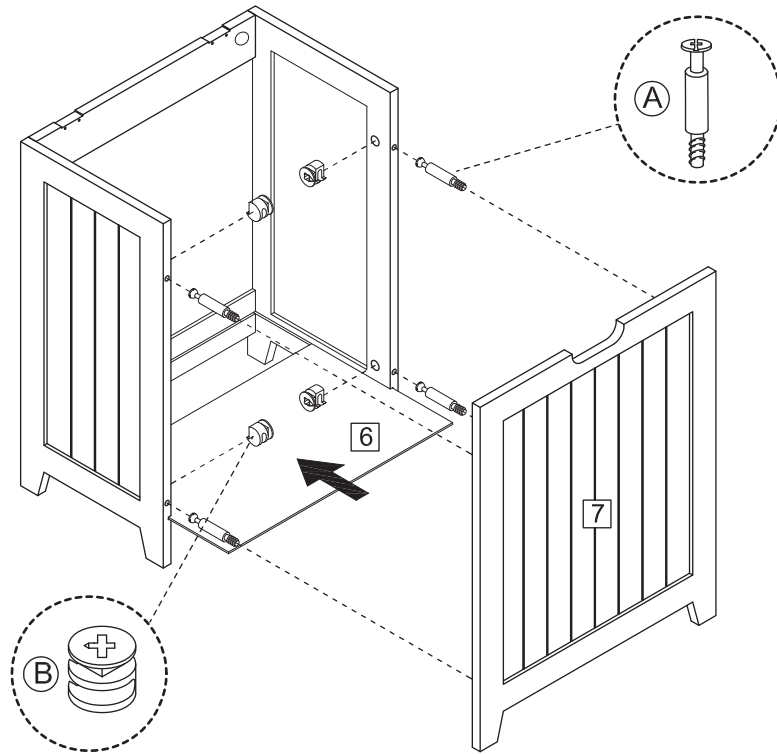

STEP 4

