

Writing Desk

ASSEMBLY INSTRUCTIONS

Before assembling your work table, please read through these instructions carefully. Familiarize yourself with the different parts.



Hexagon wrench



Adult assembly

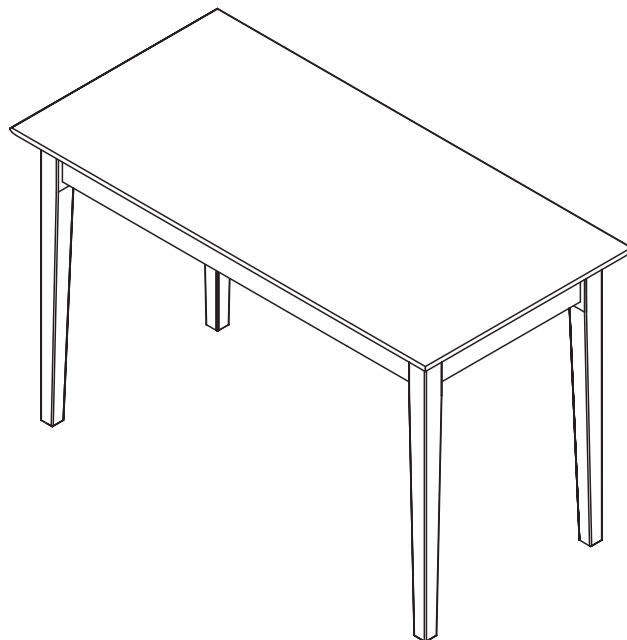

NOTE: WE INCLUDE SPARE HARDWARE IN CASE DAMAGE OCCURS DURING ASSEMBLY.



A Flat washer - 8 pcs
Spare - 2 pcs



B Hexagon nut - 8 pcs
Spare - 2 pcs



C Hexagon wrench - 1 pc

PARTS LIST

PO:

01 TOP PANEL

1 PC

02 LEG

4 PCS

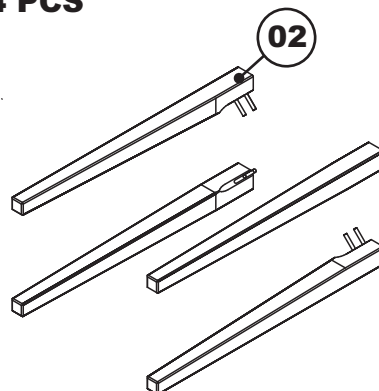
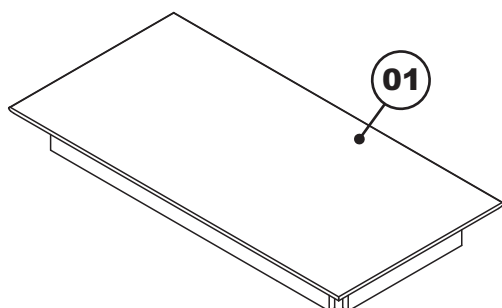

Writing Desk

Step 1

Attach the legs (02) to the top panel (01) as shown below using flat washers (A) and hexagon nuts (B), tighten with hexagon wrench (C).

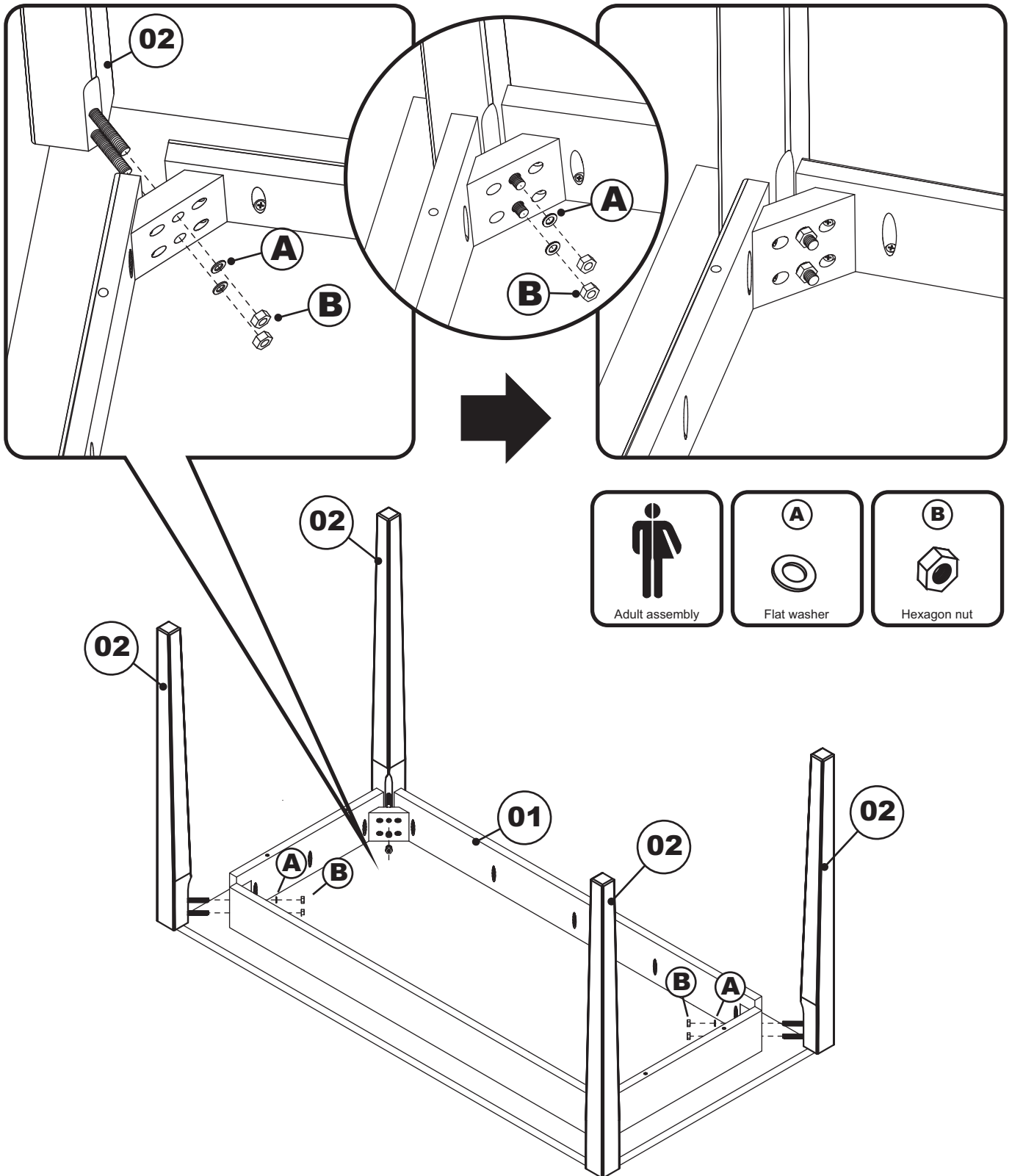

Congratulations!

Your work table is now ready for use.

We recommend that you recheck that all screws are tight, and that all parts are secure before use and periodically to ensure lasting safety.