

ASSEMBLY INSTRUCTIONS

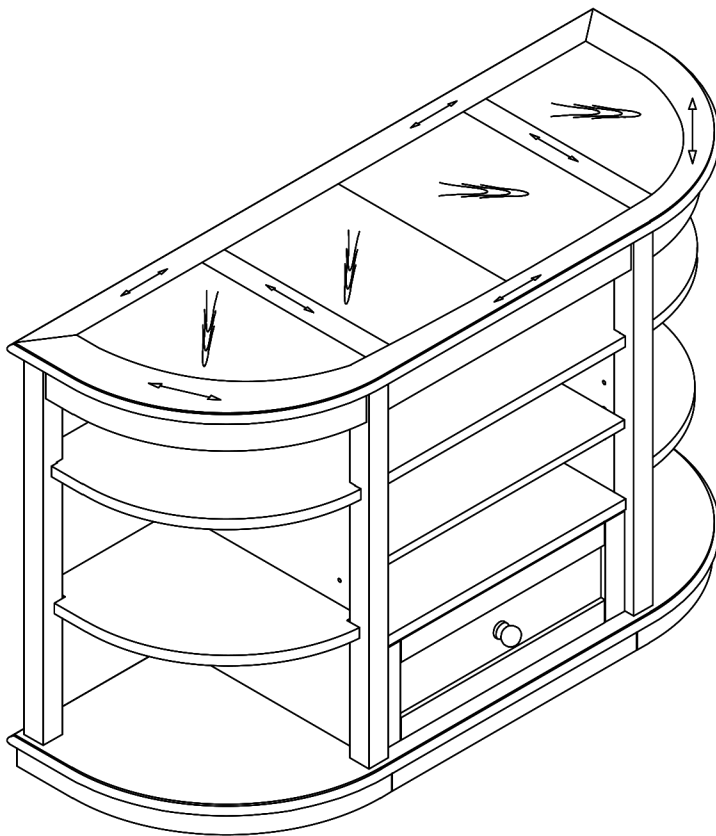

TOOLS REQUIRED



Allen Wrench

(Included)



Philips
Screwdriver

(Not Included)



2 - People
Recommended

ASSEMBLY RATING



EASY —————> DIFFICULT

The Assembly Rating is a 5-point system showing the level of effort needed to assemble a specific product.



CHECK BEFORE STARTING

☐

Are you missing anything?

Double-check all parts, hardware and accessories listed on Page 6 are accounted for.

☐

Check out our Quick Tips!

We recommend reviewing the pre-assembly handouts. Even experts need a refresher now and then!

☐

Should we send any replacements?

Are there any irregularities or flaws in the parts? We can send replacements!

☐

Prep Time!

Please review the assembly instructions and all diagrams prior to assembling. Arrange parts as recommended on Page 7 and group identical hardware together to make assembling easier.

PRE ASSEMBLY INTRODUCTION

We understand building ready-to-assemble furniture can be a challenging experience for some. To help avoid confusion, we have provided some helpful tips that may speed up the process.



Teamwork

ALWAYS have at least two people to help with transporting and assembling the product to avoid potential injury and/or damage.

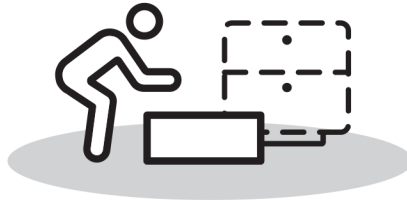

Suitable Location

Assembling near the area of the intended location is highly recommended.



Sufficient Space

Make sure you have enough space to move around during the assembly.



Avoid Scratches

Use cardboard, blankets or a carpeted area while assembling furniture to prevent scratches.

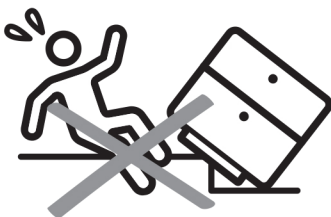

Flat Surface

Make sure the furniture rests on a flat and level surface with each leg evenly touching the floor.

ASSEMBLY AND CARE ADVICE



**FAILURE TO FOLLOW THE GUIDELINES BELOW MAY
RESULT IN INJURY AND/OR PROPERTY DAMAGE.**



Position each part correctly
and insert screws or bolts into
their respective holes.

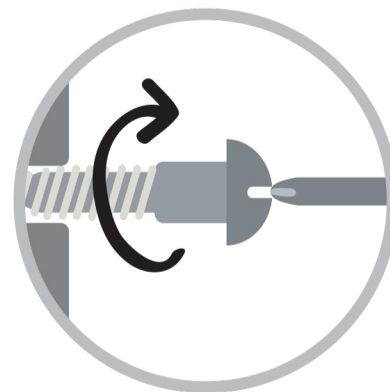

Turn clockwise to tighten and
only tighten when step is
completed or when instructed
to do so.



Save the instructions and store
any supplied tools for later
maintenance.

Use the appropriate hand tools
or power tools for assembly.
Select steps, such as tightening
screws and/or bolts, may require
hand tools to avoid causing
damage during assembly.

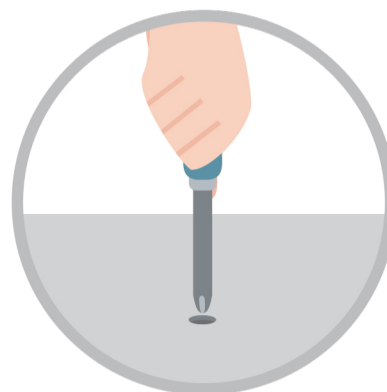

After two weeks, check and
tighten any loose hardware and
repeat again every six months
thereafter.

IT IS THE USER'S RESPONSIBILITY TO MAINTAIN THE FURNITURE. THE HARDWARE MAY LOOSEN OVER TIME AND MAY CAUSE THE FURNITURE TO BE WOBBLY AND UNABLE TO SUPPORT ITS INTENDED WEIGHT CAPACITY. THIS MAY LEAD TO COLLAPSE AND MAY CAUSE SERIOUS INJURY.

TABLE



- Please keep instructions for future reference.
- Check the quantity and irregularity of parts and hardware before you start.

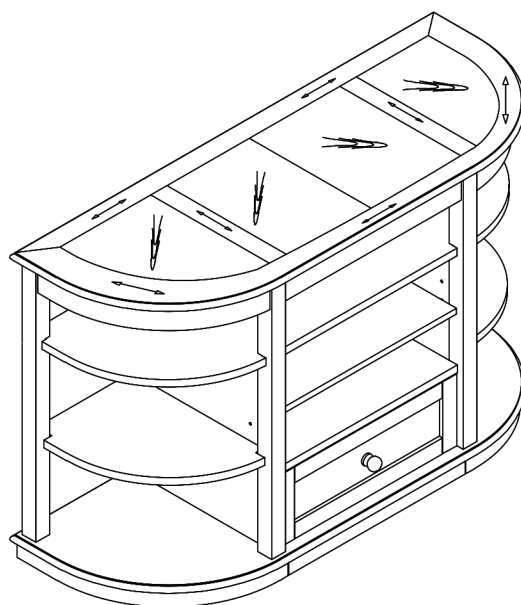

PARTS

#1 1pc

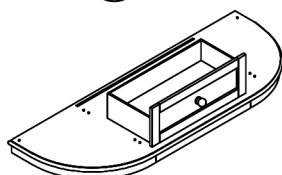

Bottom

#2 1pc

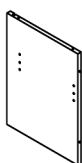

Middle riser left

#3 1pc

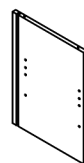

Middle riser right

#4 1pc

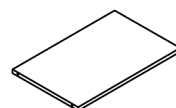

Fixed laminate

#5 1pc

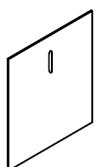

Backplane

#6 1pc

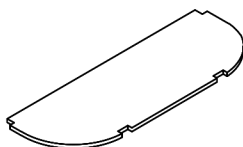

Upper board

#7 1pc

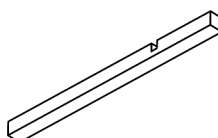

Front pillar left

#8 1pc

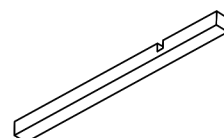

Front pillar right

#9 1pc

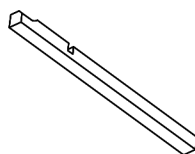

Rear column left

#10 1pc

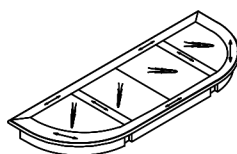

Top

#11 1pc

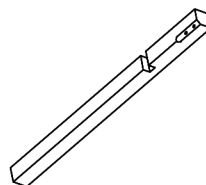

Rear column right

#12 1pc



Left shelf

#13 1pc

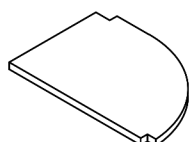

Right shelf

#14 1pc

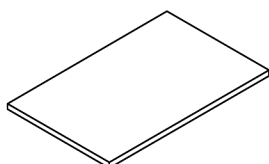

Mid-layer board

HARDWARE

#A 8pcs



Bolt 1/4" x 1-1/4"

#D 16pcs



Wood Dowel
8x30mm

#G 1pc



Allen Wrench 4mm

#H 6pcs



Screw 3*12mm

#B 8pcs



Bolt 1/4" x 2"

#E 16pcs



Washer 5/16" x 19mm

#C 16pcs



Lock washer 1/4"

#F 10pc



Shelf Support

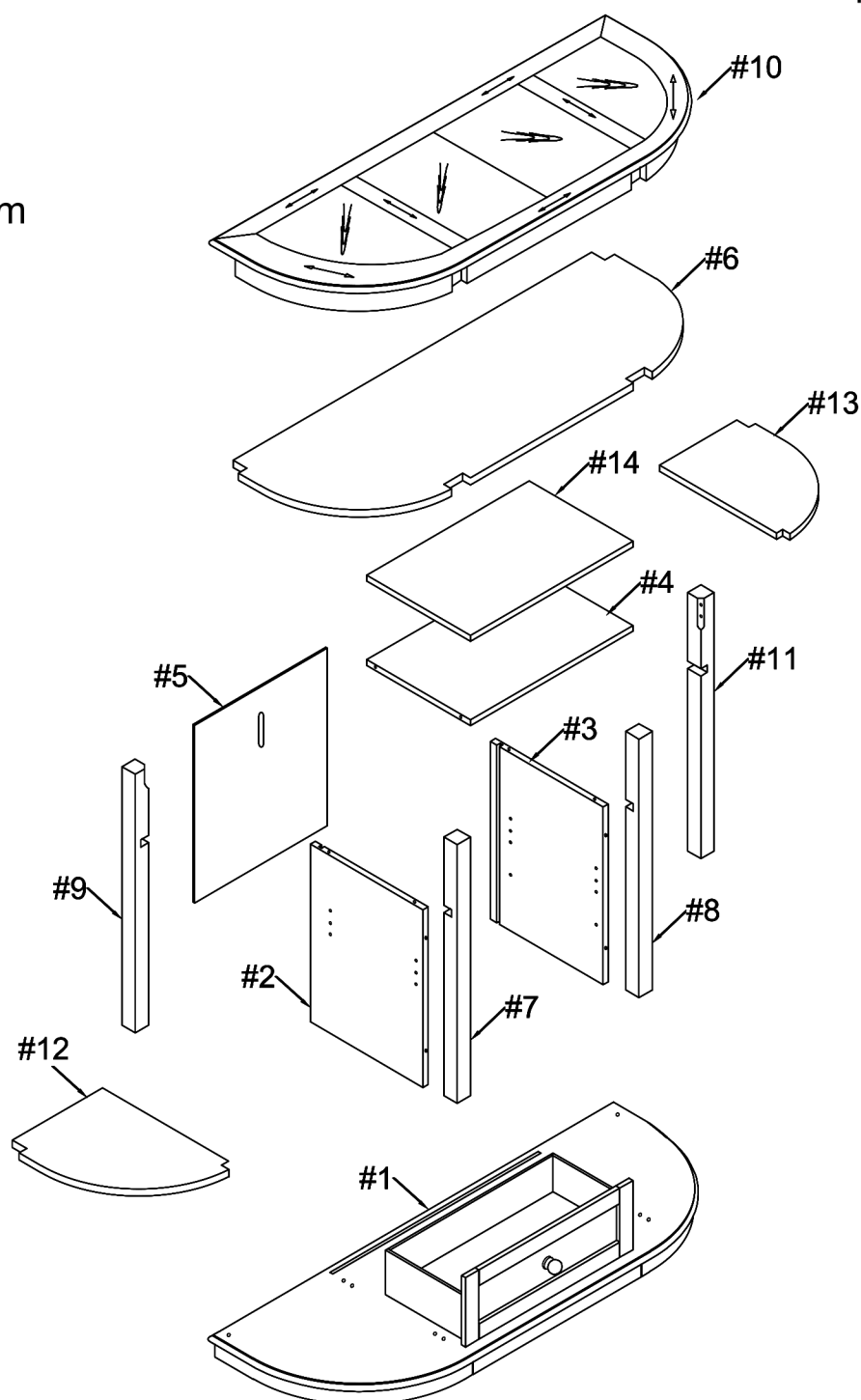

ASSEMBLY INSTRUCTIONS

1

Part #2 x1pc
Part #3 x1pc
Part #4 x1pc
Hardware #D x4pcs

Insert dowels (#D) to the middle risers (#2,3), then align middle risers (#2,3) to the fixed laminate (#4).

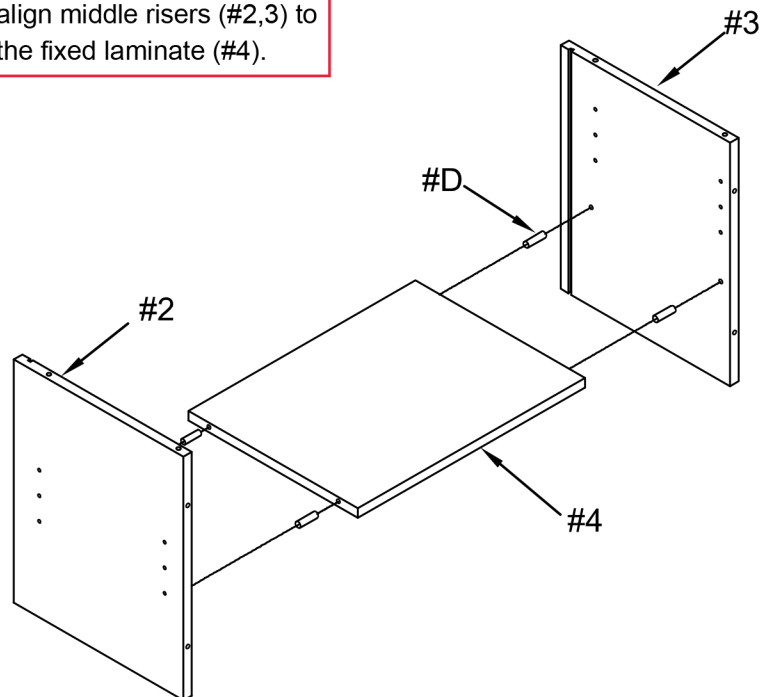

2

Part #1 x1pc
Hardware #A x4pcs
Hardware #C x4pcs
Hardware #D x4pcs
Hardware #E x4pcs

Insert dowels (#D) to the middle risers, then align middle risers to the bottom (#1). Secure by using bolts (#A) with washers (#C,E).

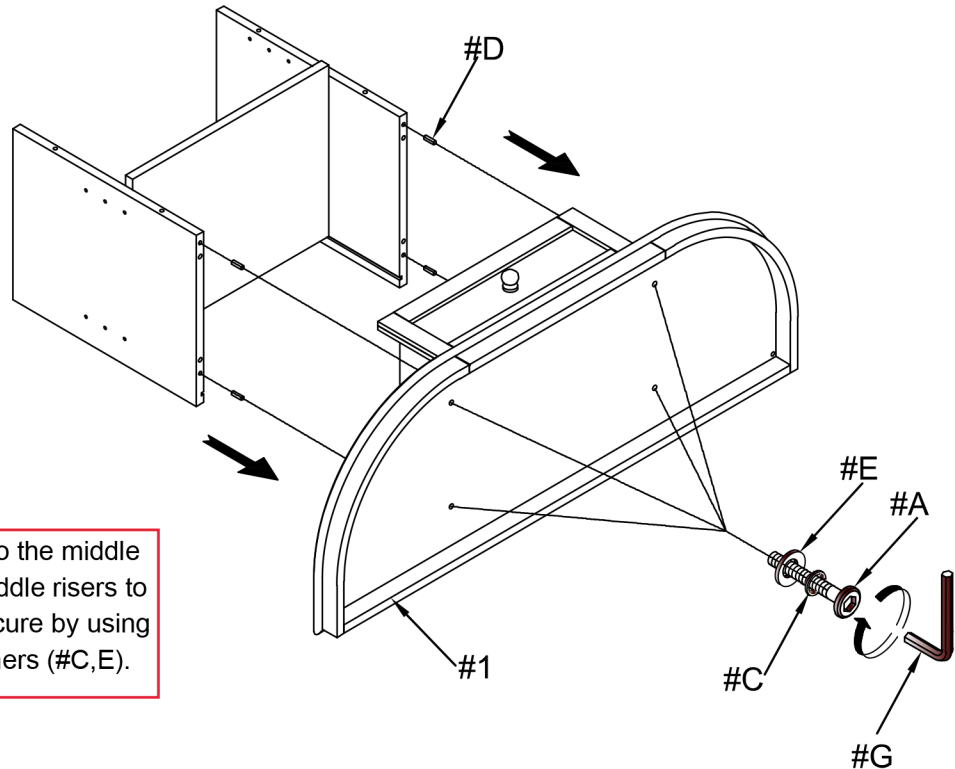

ASSEMBLY INSTRUCTIONS

3

Part #5 x1pc

Part #6 x1pc

Hardware #D x4pcs

Slide backplane (#5) to the grooves of the middle risers. Insert dowels (#D) to the upper board (#6), then align upper board (#6) to the middle risers.

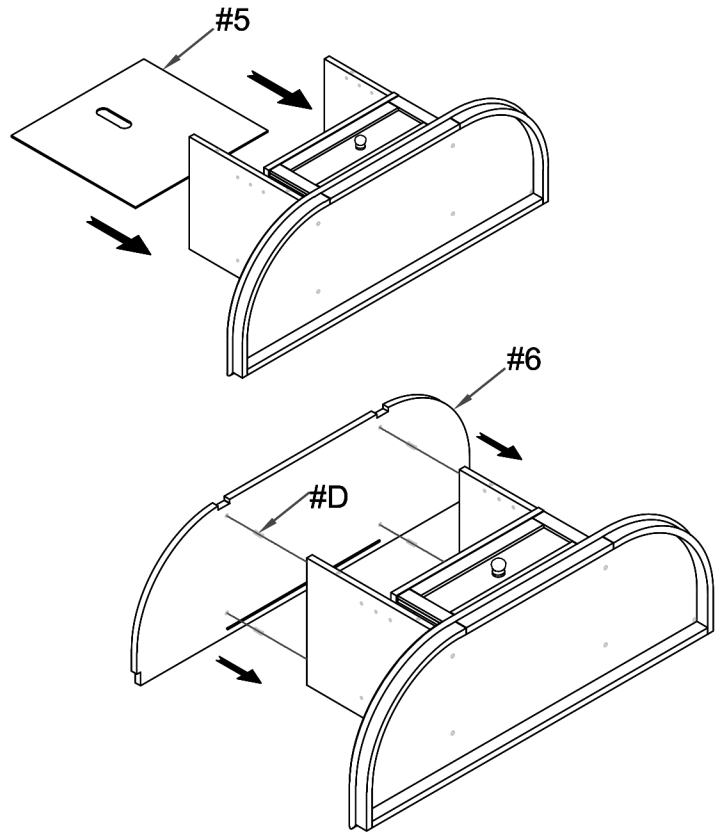

4

Part #7 x1pc

Part #8 x1pc

Part #9 x1pc

Hardware #A x3pcs

Hardware #C x3pcs

Hardware #D x4pcs

Hardware #E x3pcs

Align pillars (#7,8,9) to the unit with dowels (#D) attached to them, then secure by using bolts (#A) with washers (#C,E).

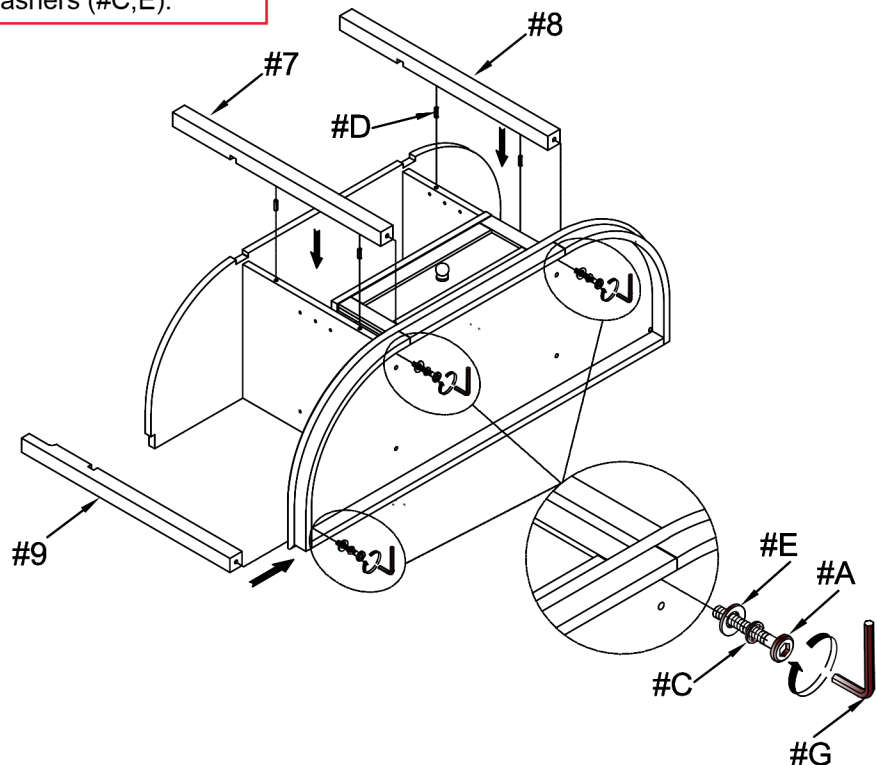

ASSEMBLY INSTRUCTIONS

5

Part #10 x1pc

Hardware #B x6pcs

Hardware #C x6pcs

Hardware #E x6pcs

Align top (#10) to the unit,
then secure by using bolts
(#B) with washers (#C,E).

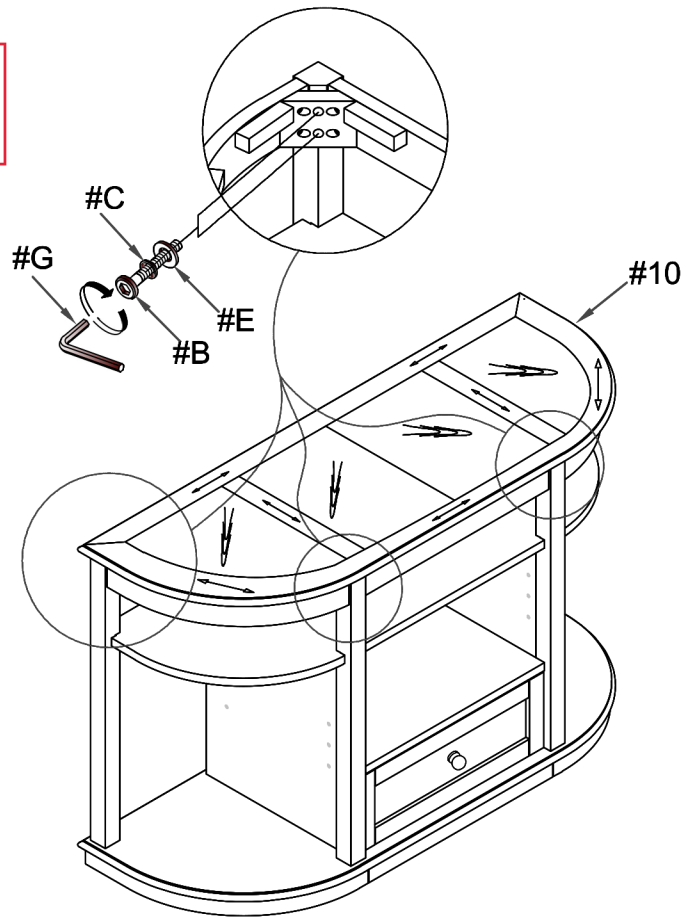

6

Part #11 x1pc

Hardware #A x1pcs

Hardware #B x2pcs

Hardware #C x3pcs

Hardware #E x3pcs

Align pillar (#11) to the unit,
then secure with the following
bolts as shown in the diagram.

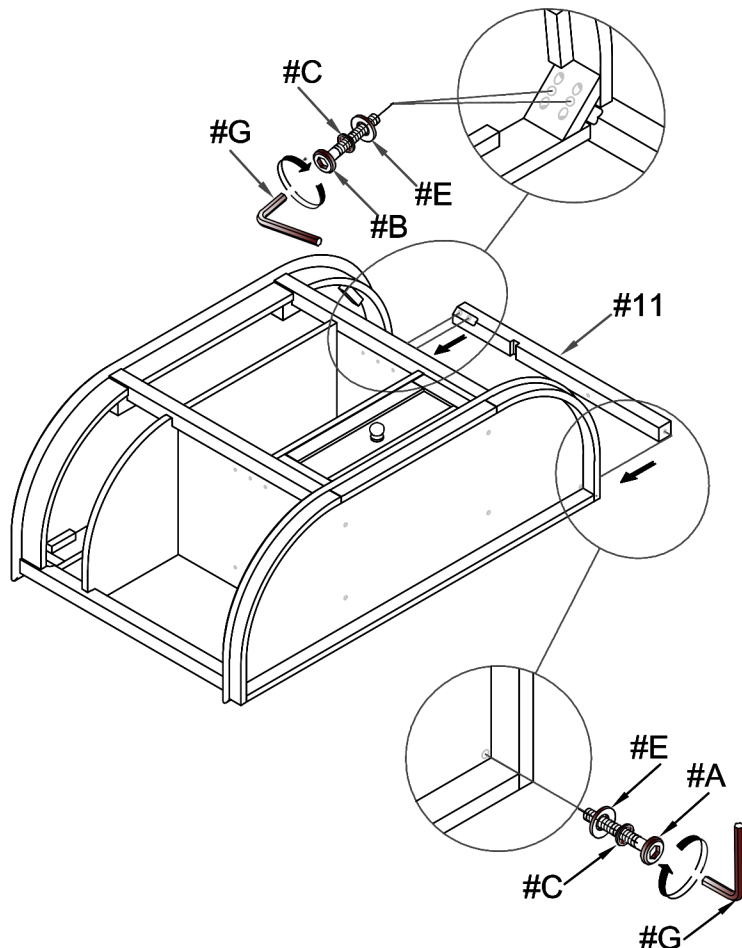

ASSEMBLY INSTRUCTIONS

7

Part #12 x1pc

Part #13 x1pc

Part #14 x1pc

Hardware #F x10pcs

Hardware #H x6pcs

Insert shelf pins (#F) to the unit, then align the shelves (#12,13,14) to the shelf pins (#F). Secure by using screws (#H).

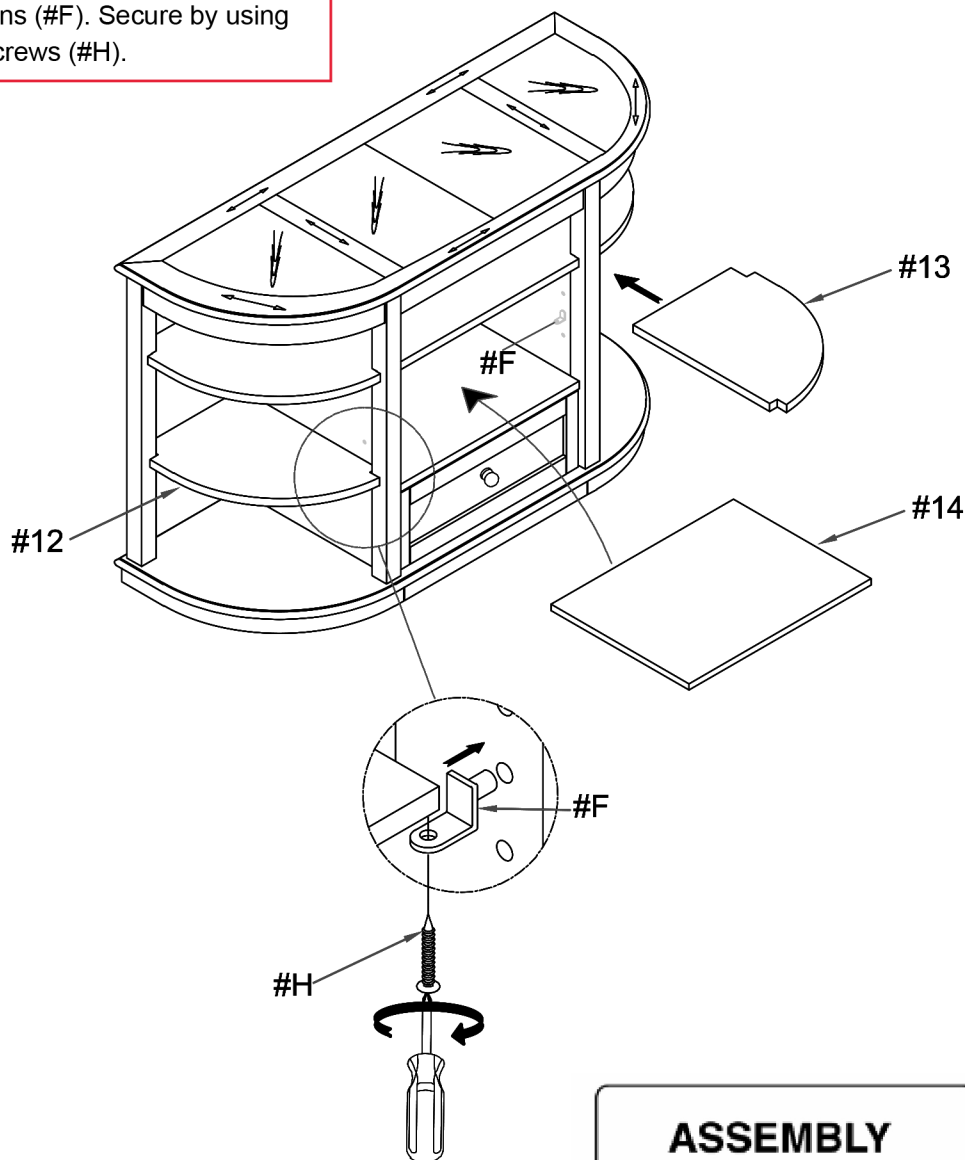

ASSEMBLY COMPLETED



Please ensure the furniture rests on an even and flat surface. If the product wobbles or feels loose, double-check all bolts and/or screws are properly tightened and secured.



Keep this handy!

Please retain this instruction manual and any order-related information for future reference.



Lift, don't drag!

To avoid damage to product please always LIFT the product when transporting or adjusting the placement.