

CLEAN AND PROTECTION

In order to keep clean, shiny and good function of faucet, please do it as below:

1. Clean it with clear water and soft cotton cloth.
2. Use mild liquid, colorless glass cleaner or non abrasive polisher to clean the surface dirt.
3. DO NOT use abrasive cleaner, polisher, gauze, tissue or knife, etc.
4. DO NOT use acid cleaner, insoluble granular cleaner, soap, etc.
5. Flow rate may become slow or small, as the aerator becomes dirty after long-time usage, please open the aerator by handle or a tool, clean it, the flow rate will become normal again after you assemble it back to the faucet.

Please clean pipe before install the faucet, or it may be blocked, water can't come out.

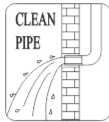

Warranty Card

Dear Customer:

Thank you for choosing HOXIYA products. If you have any questions, please Email us at hoxiyal@outlook.com, or follow us on the Facebook homepage HOXIYA We will reply within 24 hours. Welcome to leave feedback, if you are satisfied.

Thank you very much!
HOXIYA Team

A. Related Info:

Customer	Name:		
	Address:		
	Tel.:		
Retailer	Name:		
	Tel.:		
Model No.		Series No.	
Date of Purchase		Warranty time	1 Year from the date of purchase

B. Notes about the warranty card:

1. Please make sure that the above info is completed in the warranty.
2. This warranty and invoice are important documents for product maintenance. During warranty period, when the retailer or service people come for product maintenance, please present the Warranty and invoice.
3. This warranty cannot be reissued. Keep it in a proper place.

C. Free repairment policy:

During warranty period, if product failure/damage occurs under normal operation according to the user manual, free repair service will be provided.

D. The following repairment or maintenance should be paid:

1. Failure occurs out warranty period;
2. If this warranty/invoice is not presented;
3. Failure/damage occurs due to transportation/collision of the product after purchase;
4. Failure/damage occurs due to natural disasters such as fire, earthquake, flood damage, lightning or by environmental pollution, gas and abnormal voltage;
5. Failure/damage due to user's responsibility, improper repairment! or reassembling of the product;
6. Failure/damage due to improper cleaning of product (e.g. improper use of detergent or cleaning method);
7. Failure/damage due to sand, junk or other unexpected goods from water supply;
8. Relocation of the product up to end user's requirement

Shower System Installation Manual

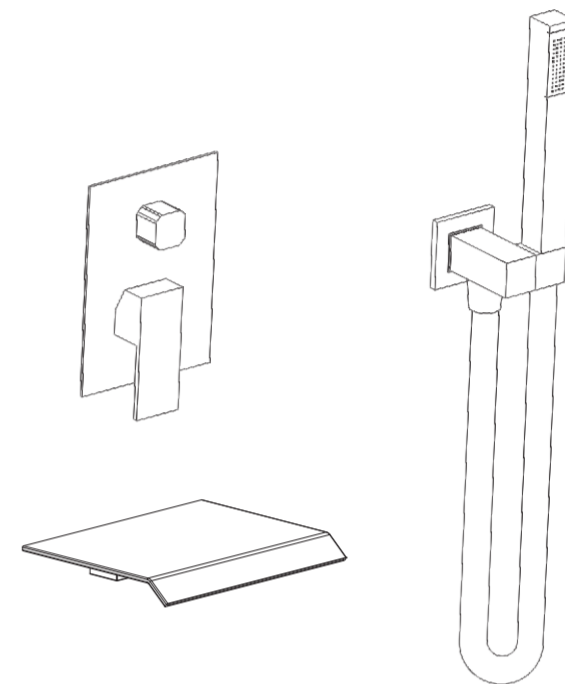
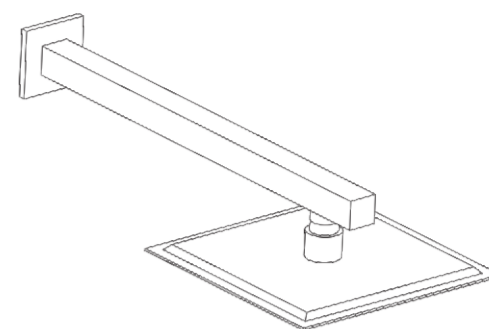

Dual function concealed faucet parts list

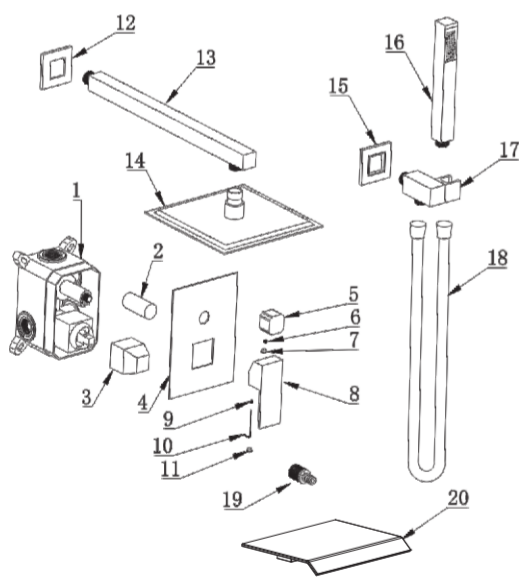

No	Description	QTY
1	Rough-in valve	1
2	protective cover	1
3	protective cover	1
4	cover board	1
5	diverter handle	1
6	Hexagonal screw	1
7	Decorative hat	1
8	on/off handle	1
9	Hexagonal screw	1
10	Allen key	1
11	Decorative hat	1
12	cover board	1
13	shower arm	1
14	shower head	1
15	Wall covering	1
16	handle shower	1
17	Bracket	1
18	shower hose	1
19	1/2-14NPT	1
20	rotatable bathtub spout	1

Technical drawing of dual function

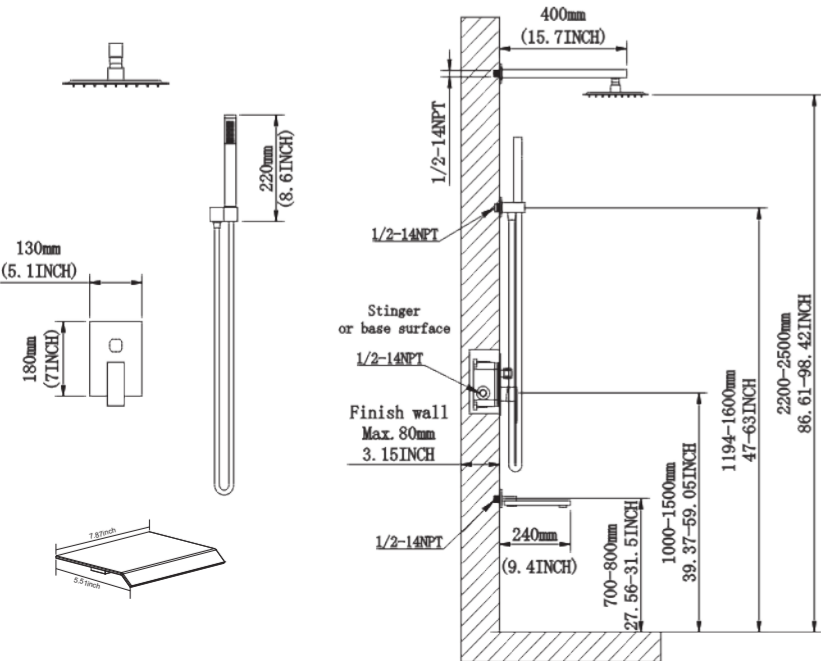

Technical drawing of drilling size

1. The size of the embedded box that needs to be drilled is 5.3" * 6.7"

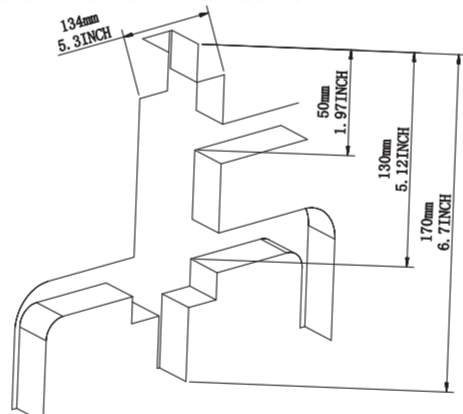

2. The depth of the embedded box is 2.36" ± 0.15". It's better to drill the depth of 2.36" for black wall

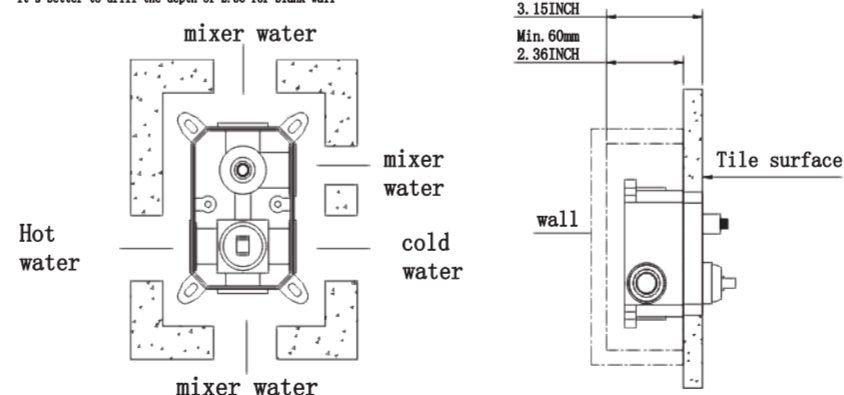

Pipe connection
1. Please drill the holes on the wall for the main body embedded part, hot and cold water inlet pipes as well as shower arm connection pipes according to the basic product dimension drawing as below.
2. Please make hot and cold water inlet pipe, the mixed water outlet pipe connect with control valve, and tightened with the wrench.

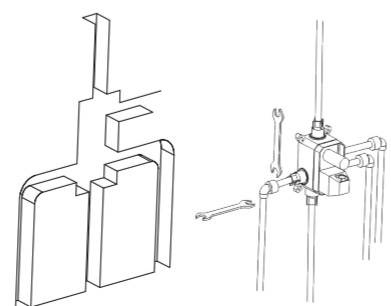

Water testing and sealing testing

1. After the pipe connection is completed, open the protective panel and cover, and open the cartridge, flush the pipeline; Then close the cartridge to check the pressure resistance and sealing performance of the pipeline, make sure there are no leakage.
2. Block each outlet pipe with a stopper then open the cartridge to check if the pipe joint is well-sealed and the pipe condition under pressure to ensure no leakage.

Testing Purpose: Flush the impurities and sludge in the pipeline to avoid clogging and affect the effluent functions.

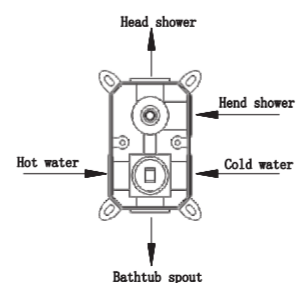

The procedure of sealing the wall.
Use a parallel ruler to measure the flatness of the embedded box casing and the vertical wall surface. If the wall surface is not flat, it should be patched to ensure the embedded box casing and vertical wall angle meets at nearly ideal angle of 90°, then lay the tile decoration.

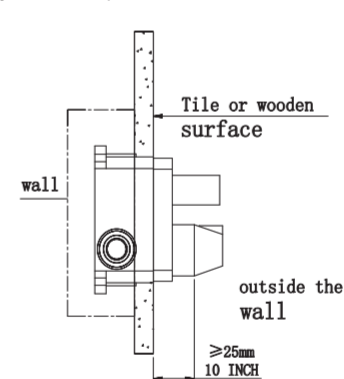

Install the shower head

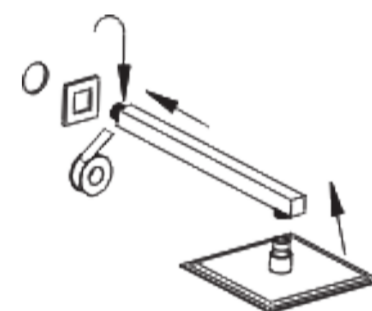

Handle shower installation

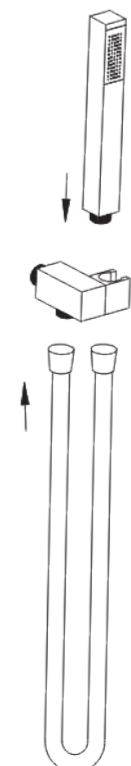

- Installation of Rough-in valve
1. Take off the protective panel and cover
 2. The decorative panel and the handle are connected to the control valve as shown below sequence

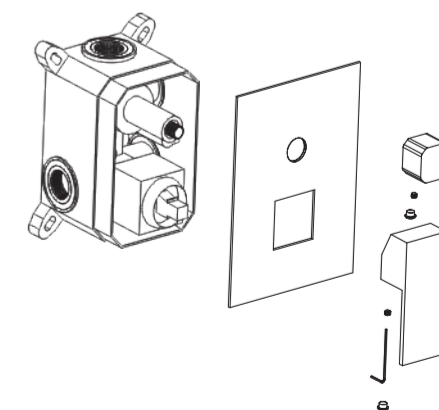

According to the figure below, please correctly adjust the direction of water separator handle

