

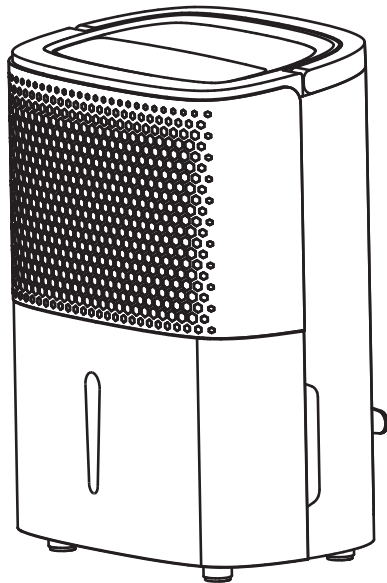

# 12L COMPRESSOR DEHUMIDIFIER

Model No: PM 412



## INSTRUCTION MANUAL

**WARNING!** To avoid damage, place the unit in an upright position for at least 24 hours before initiation.

# TABLE OF CONTENTS

---

ENGLISH	1 - 6
FRANÇAIS	7 - 12
ESPAÑOL	13 - 18
ITALIANO	19 - 24
DEUTSCH	25 - 30

Thank you for purchasing the innovative PureMate 12L Dehumidifier PM 412. We wish you many years of healthy indoor air with this efficient and effective product.

## SAFETY PRECAUTIONS

- ALWAYS use the appliance only on the voltage specified.
- NEVER immerse the product or power cable with water or other liquids.
- DO NOT leave the appliance unattended around children.
- DO NOT insert any objects or fingers into any openings.
- DO NOT use around heated surfaces, open flames, flammable substances or in direct sunlight.
- Please ensure the dehumidifier is set to OFF when the unit is not in use.
- Please turn off and unplug the appliance before cleaning or maintenance.
- DO NOT operate if there are signs of damage to the cord, plug or appliance. Do not attempt to repair or adjust any electrical or mechanical functions on this unit. Please Call Customer Service for assistance.
- NEVER tilt, move, or attempt to empty tank while it is operating. Ensure the dehumidifier is in an upright position.
- NEVER cover or restrict airflow to the dehumidifier whilst in use.
- Dispose of collected water, this is NOT suitable for drinking.
- When the appliance is not in use for a prolonged period, please turn it off, unplug it, pack it well, and store it in dry cool place. Please ensure water tank is always emptied before storing the dehumidifier.
- DO NOT run the cord under throw rugs, runners, or similar coverings. Arrange cord away from traffic area and where it will not be tripped over.
- DO NOT use the appliance for any other purpose than its intended use, as described in the manual.
- This dehumidifier is for indoor use only. DO NOT use outdoors.
- Avoid the use of extension cables to prevent risk of overheating and fire risk.
- This dehumidifier may be utilized by children aged from 8 years and over and individuals with reduced physical, sensory or mental capabilities or lack of experience and knowledge HOWEVER they must have be supervised or instructed concerning use of the appliance in a safely and understand the hazards involved.
- DO NOT by any means attempt to accelerate the appliances defrosting process.
- ENSURE to follow the cleaning process detailed by the manufacturer. DO NOT attempt to clean in any other way.
- DO NOT pierce, incinerate or cause damage to the appliances container of refrigerant tubing.
- Be aware that refrigerants may not contain any odour.
- The maximum refrigerant charge amount is 60g.
- In the rare occurrence the unit should malfunction, DO NOT attempt any repairs. All repairs are required to be taken out by a professional. Please contact Pure Mate Customer Services.



### ⚠ CAUTION

Do not use appliance at temperatures below 5°C, to prevent the possibility of a heavy ice up of the evaporating coil!

# COMPONENTS

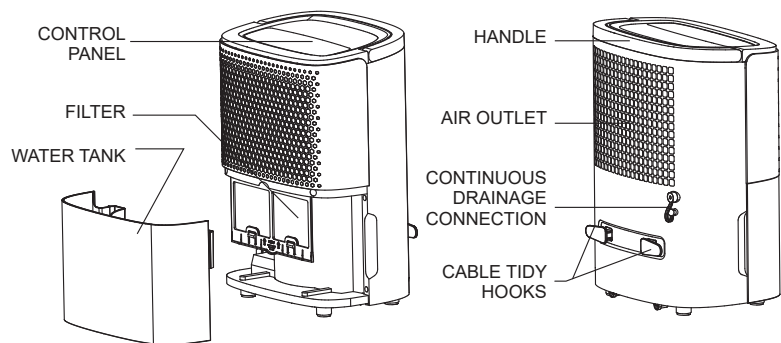

# CONTROL PANEL

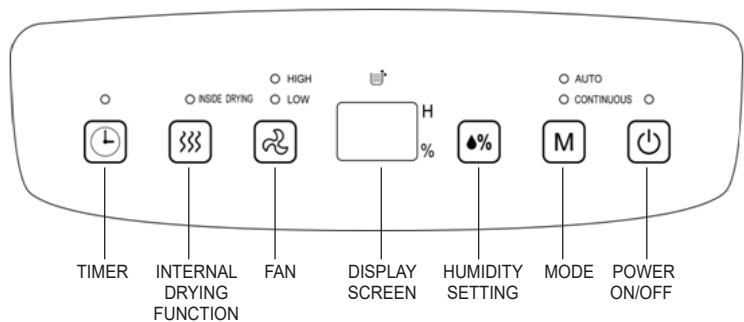

# OPERATING INSTRUCTIONS

**IMPORTANT:**  
Before use insert the 2 in 1 Anti-Formaldehyde & Active Carbon filter.

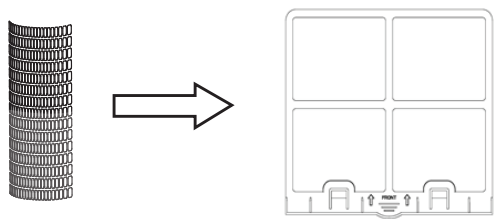



POWER BUTTON: Press to turn ON/OFF the dehumidifier.



MODE BUTTON: Press to choose between:

- Auto Dehumidifying
- Continuous Dehumidifying (dry clothes function).



HUMIDITY SETTING BUTTON: When in Auto Dehumidifying mode, press to set the desired relative humidity level. The humidity range is from 30% to 80%, increasing in 5% increments. The dehumidifier will turn off when the room reaches this target RH%



FAN BUTTON: Press to select between Low Fan and High Fan speeds.



INTERNAL DRYING FUNCTION: Press to start the internal drying mode. The units compressor will stop collecting water, the fan will run on high speed for 30 minutes, then on low speed for 20 minutes. This is to dry the dehumidifier ready for storage.

**NOTE: Before storing the dehumidifier ALWAYS ensure the internal drying function has been completed.**



TIMER BUTTON: Set the Timer to turn the unit on or off, between 1-24 hours.

Set the Dehumidifier to turn ON:

- When the dehumidifier is in Stand-by, press the timer button.
- Press the timer button to select the desired time, between 1-24 hours, until turn on.
- The time displayed will flash 5 times to confirm the timer is set. The display will show the remaining time till turn on.
- Select the desired mode and/or humidity settings before turn on.

Set the dehumidifier to turn OFF:

- Press the power button to turn on the dehumidifier.
- Select the desired mode and/or humidity settings.
- Press the timer button.
- Press the timer button to select the desired time, between 1-24 hours, until turn off.
- The time displayed will flash 5 times to confirm the timer is set. The display will return to show the current humidity level.
- To view the remaining time before turn off, press the timer button.

## REMOVING AND EMPTYING THE WATER TANK

When the Water Tank Full indicator illuminates and the dehumidifier sounds. The unit will automatically stop . Press the POWER button before removing the water tank.

1. Lightly press on the sides of the tank with both hands and pull the tank out gently.
2. Discard the collected water.

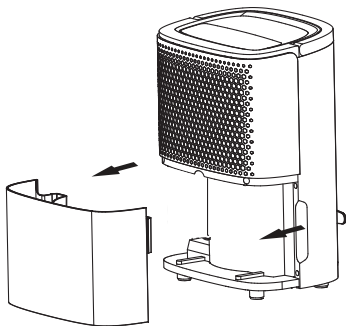

**NOTE :** Do not remove the float from the water tank. The water full sensor will no longer be able to detect the water level correctly without the float and water may leak from the water tank.

**NOTE:** When replacing the drainage tank, press the tank firmly into place with both hands. If the tank is not positioned properly, the “TANK FULL” sensor will be activated, and the dehumidifier will not operate.

## CONTINUOUS DRAINING

The unit features a continuous drainage port, connect a water pipe in the back, (inner diameter is 9mm) water can be drained continuously.

Please check if the pipe is stably connected with the drainage mouth to prevent leaking.

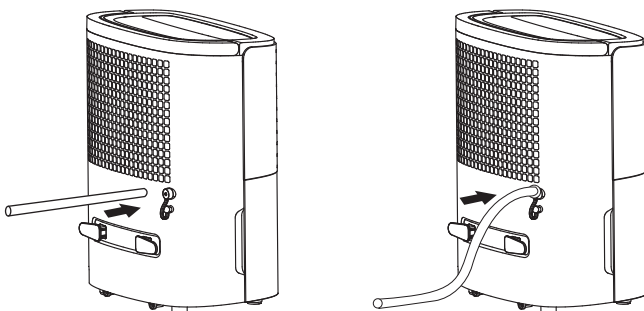

**CAUTION : DO NOT PLACE CONTINUOUS DRAINAGE HOSE OUTSIDE IN TEMPERATURES BELOW 1°C**

## CLEANING & MAINTENANCE

**IMPORTANT: Always turn off and unplug the unit from the mains before carrying out any maintenance or cleaning of the unit.**

1. Use a soft, dry cloth to wipe the unit clean, removing any dust or debris from the surface of the unit and inlet/outlet.

**Don't ever use volatile chemicals, gasoline, detergents, chemically treated clothes, or other cleansing solutions. All these could possibly cause damage to the cabinet.**

2. Remove the water tank, disposing of any collected water, and wipe with a soft damp cloth.

3. Remove the filters, by pulling down on the tab.

4. Remove the carbon filter from the pre-filter

5. Lightly vacuum the filters for easy cleaning. If the pre-filter is particularly dirty, clean it with very small amount of water.

### **DO NOT WET THE 2 IN 1 ANTI-FORMALDEHYDE & ACTIVE CARBON FILTER**

6. Make sure the pre-filter is completely dry before replacing. Reinstall the carbon filter into the pre-filter and return back into the dehumidifier.

7. Reinstall the water tank.

**It is recommended to clean the filter at least once fortnightly.**

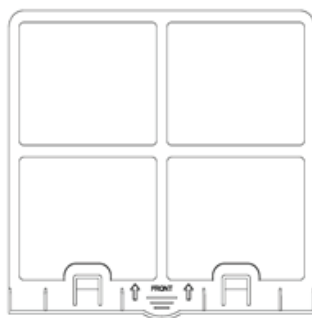
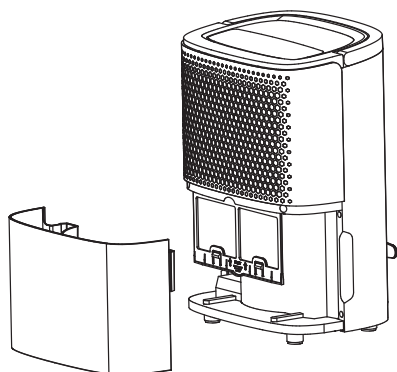

## SPECIFICATION

Power supply: 220 to 240V~50Hz
Power Consumption: 200W [High Setting]
Moisture Removal: 12L/24h (under test 30°C, 80%RH)
Room Temperature: 5°C - 32°C
Water Tank Capacity: 1.8 L
Dimensions: 29.6 x 21.7 x 43.6 CM
Net Weight: 10.5 kg

## DISPOSAL OF THIS DEVICE



At the end of the product life cycle, you should not throw this machine into the normal household garbage but ring the product to a collection point for the recycling of electrical and electronic equipment.