

# Assembly Instruction

**Note:**

1. Should be assembled on flat ground to keep balance.
2. Before completing the installation, do not tighten the screws.

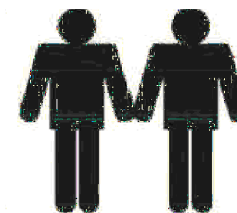
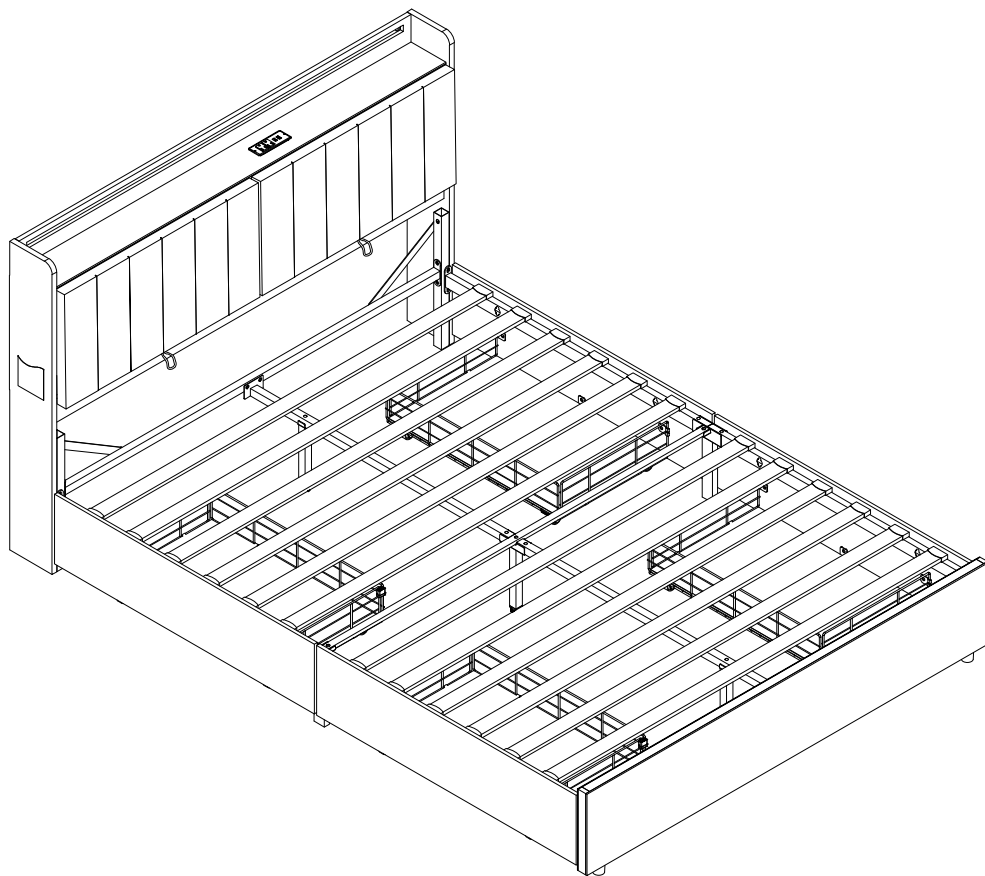

**It needs at least  
two people to install.**



**Before starting the  
assembly, you must  
read the whole  
manual and follow  
the instructions .**

# Assembly Instruction

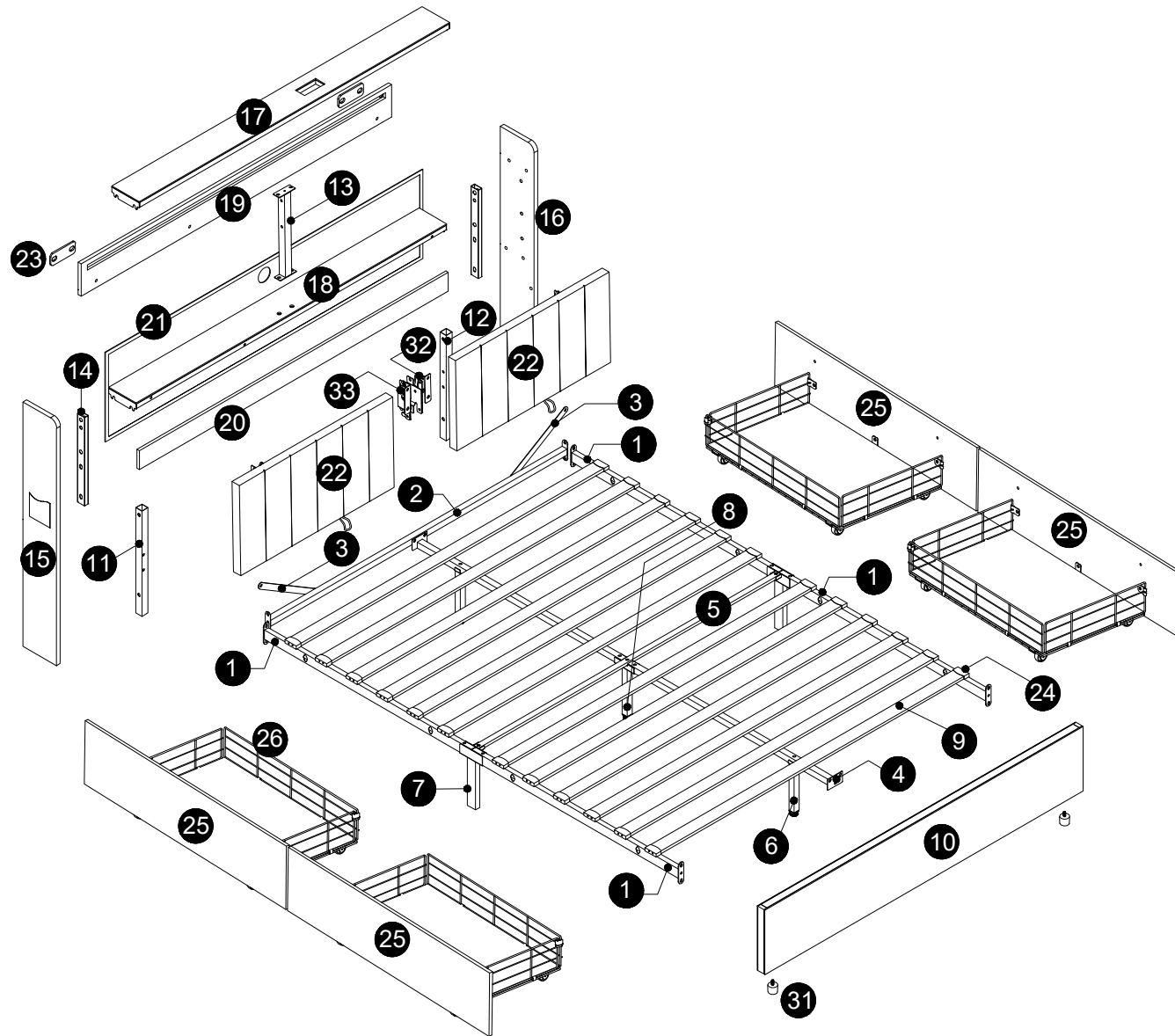

# Assembly Instruction

## Hardware parts 1

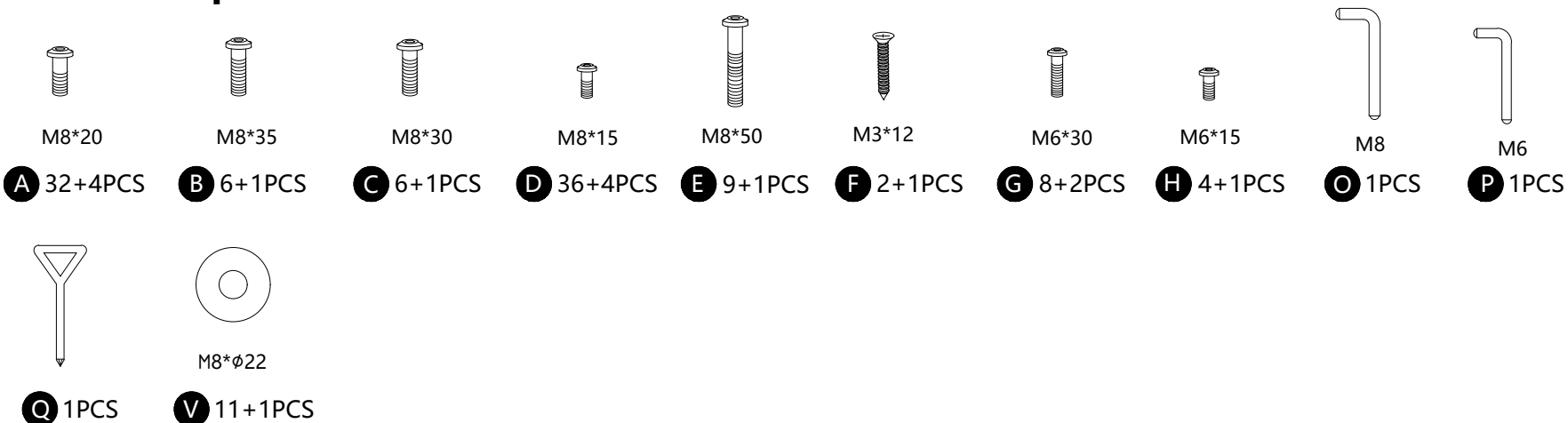

## Part list

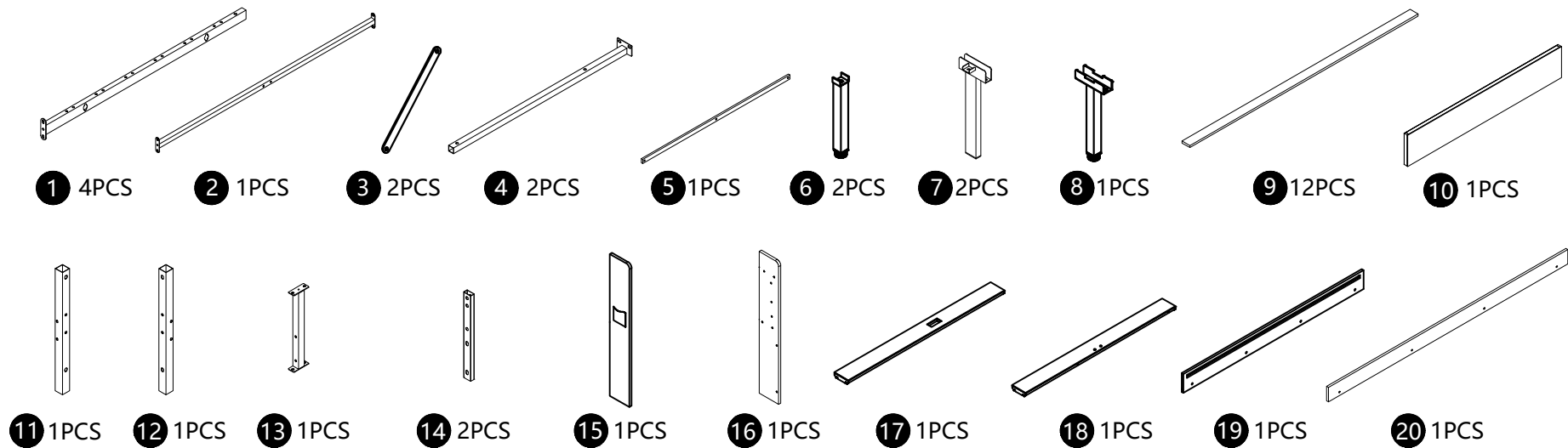

# Assembly Instruction of Bedside cabinet

## Part list

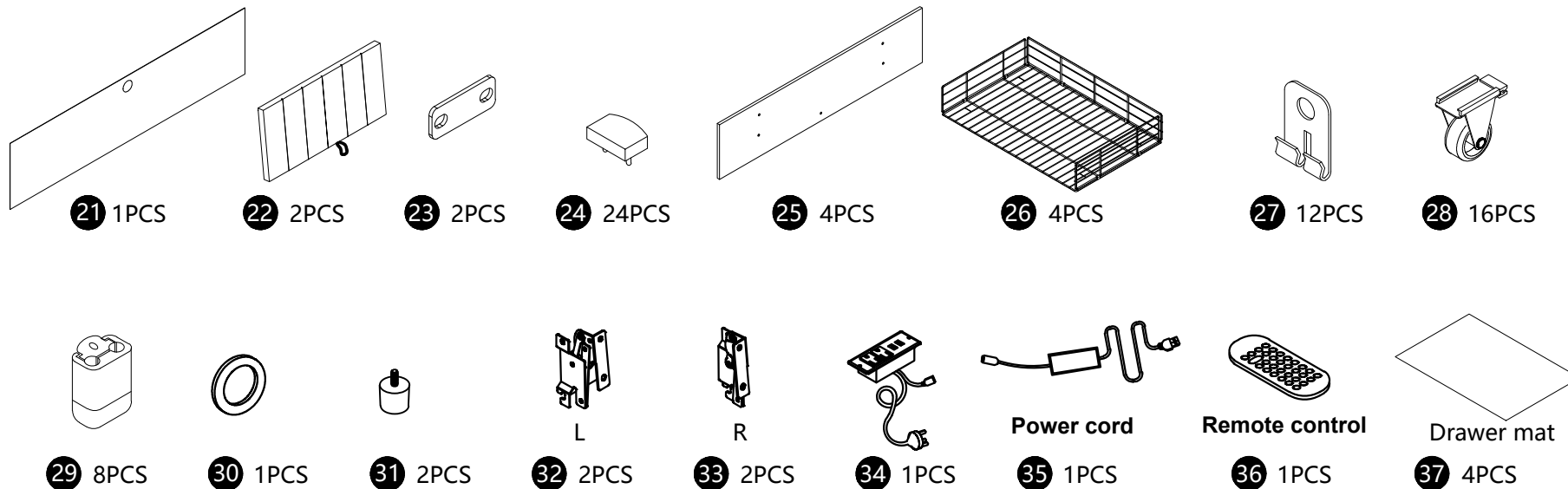

# Assembly Instruction of Bedside cabinet

Step:1

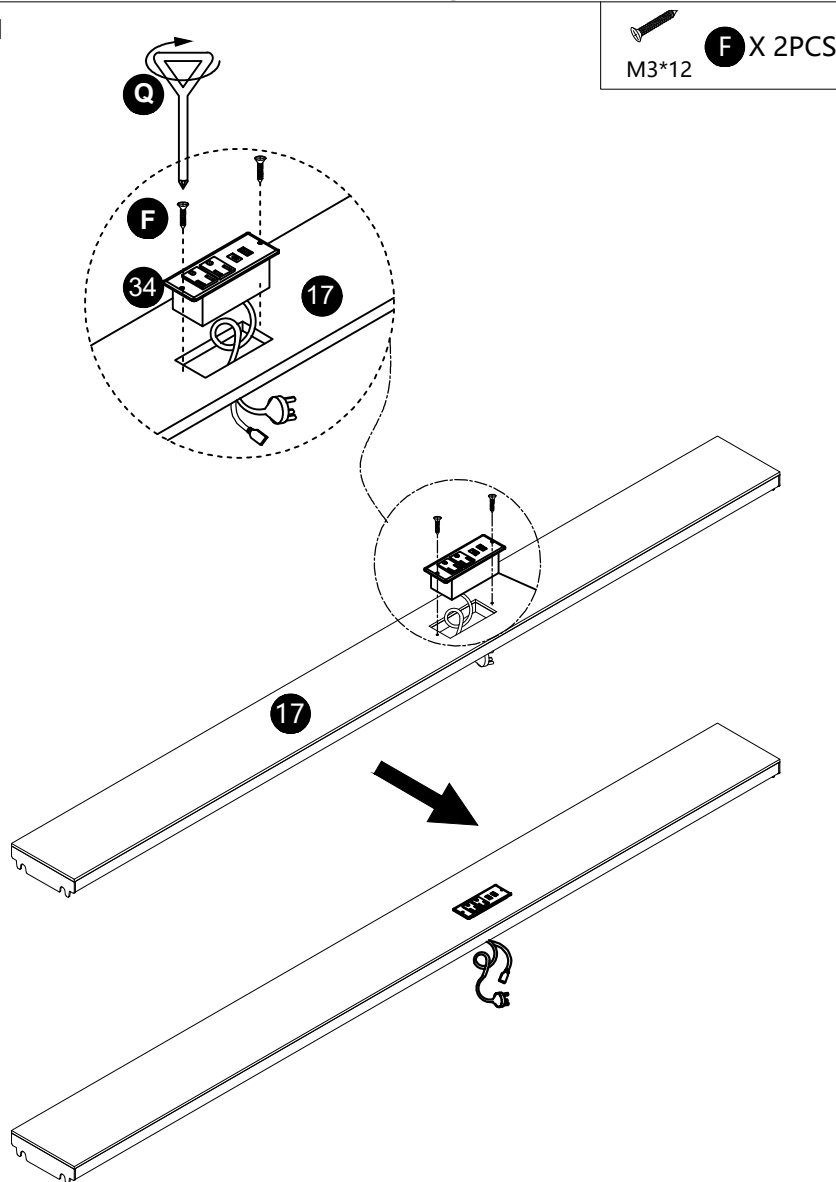

Step:2

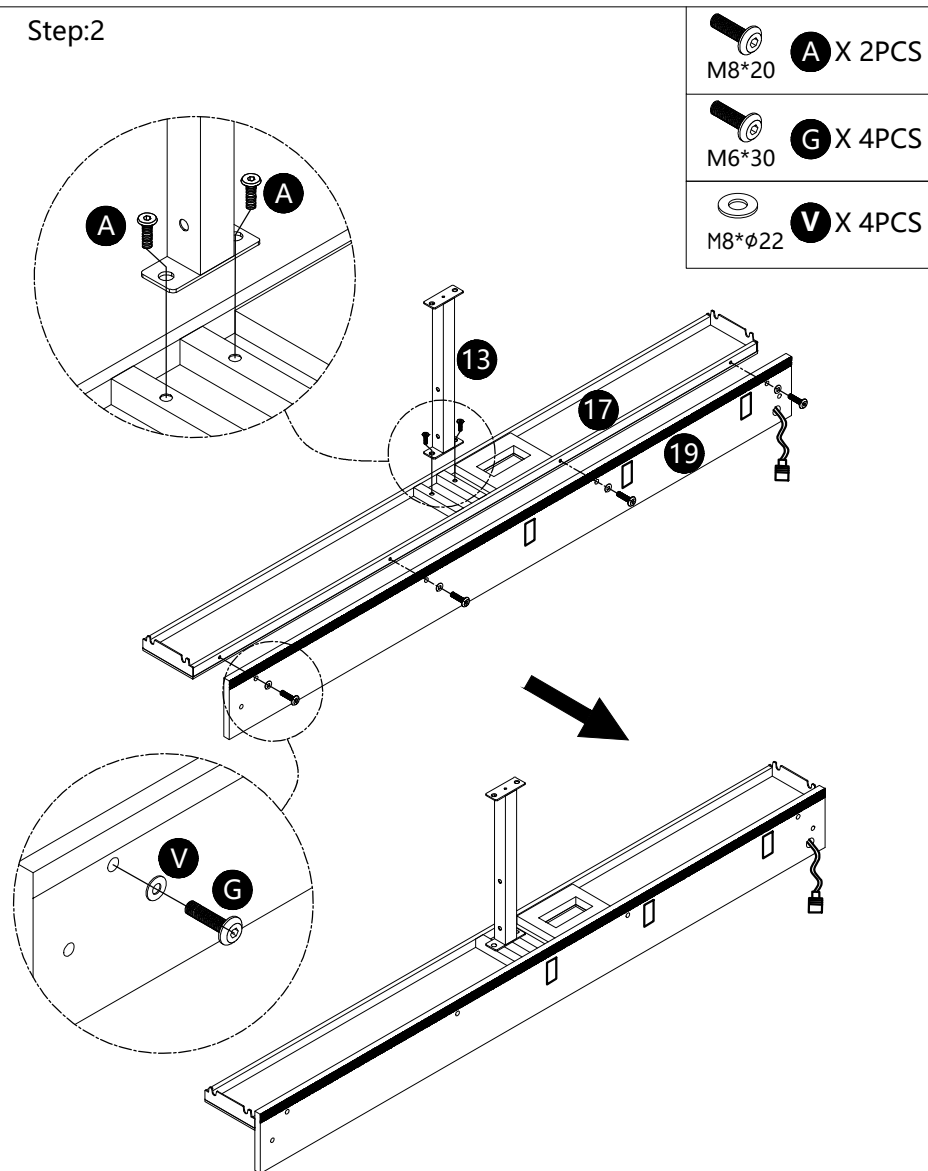

# Assembly Instruction of Bedside cabinet

Step:3

 M6\*30 **G** X 4PCS

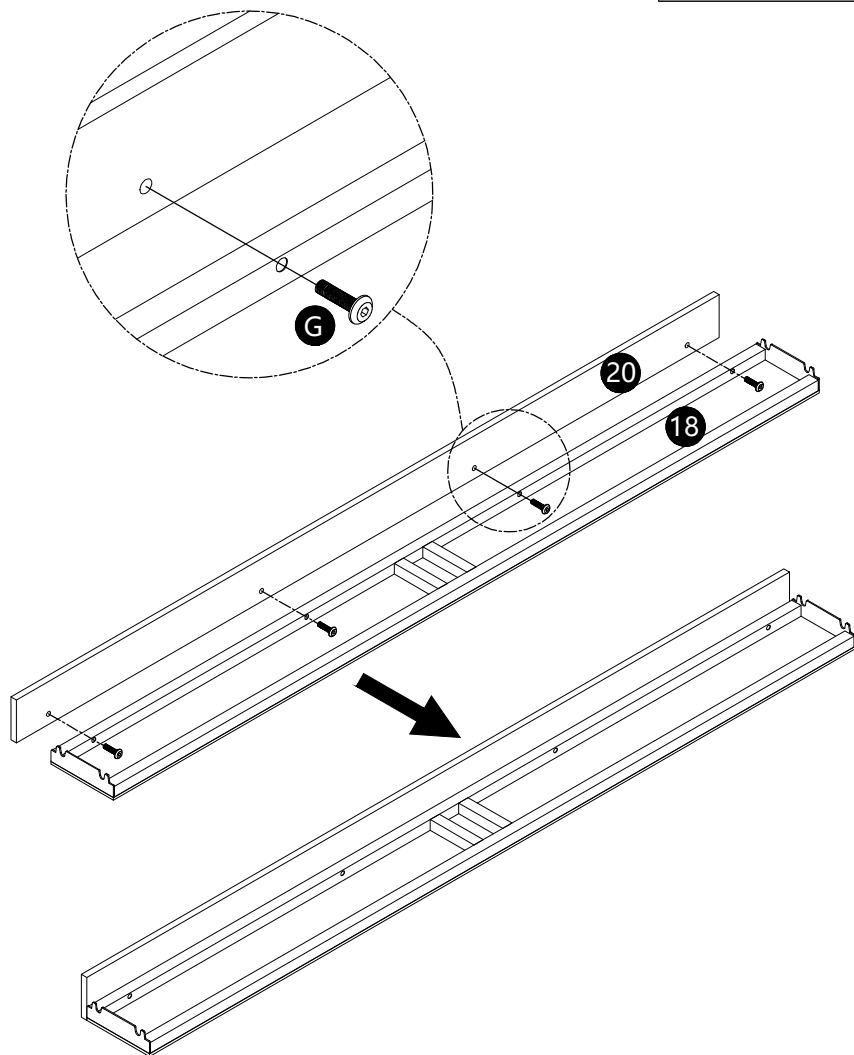

Step:4

 M8\*50 **E** X 4PCS

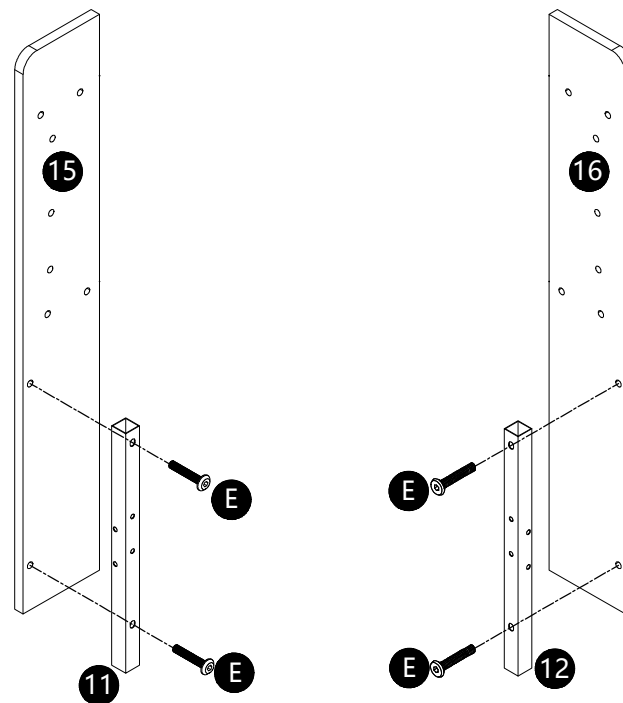

# Assembly Instruction of Bedside cabinet

Step:5

 M8\*20 **A** X 8PCS

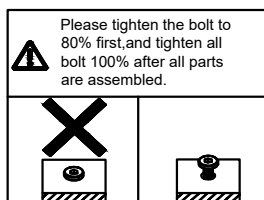
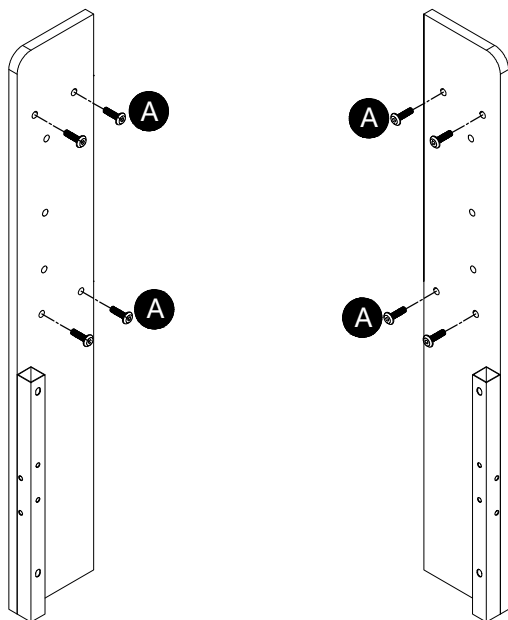

Step:6

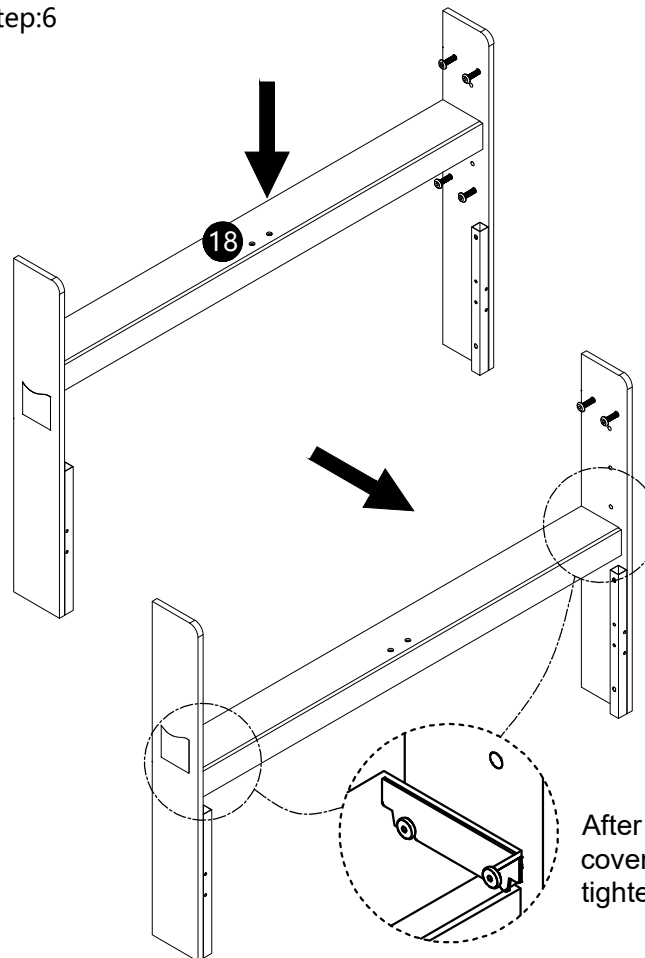

After flattening the cloth covers at both ends, tighten the screws.

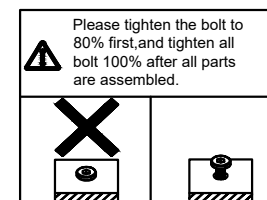

# Assembly Instruction of Bedside cabinet

Step:7

Nut facing outward

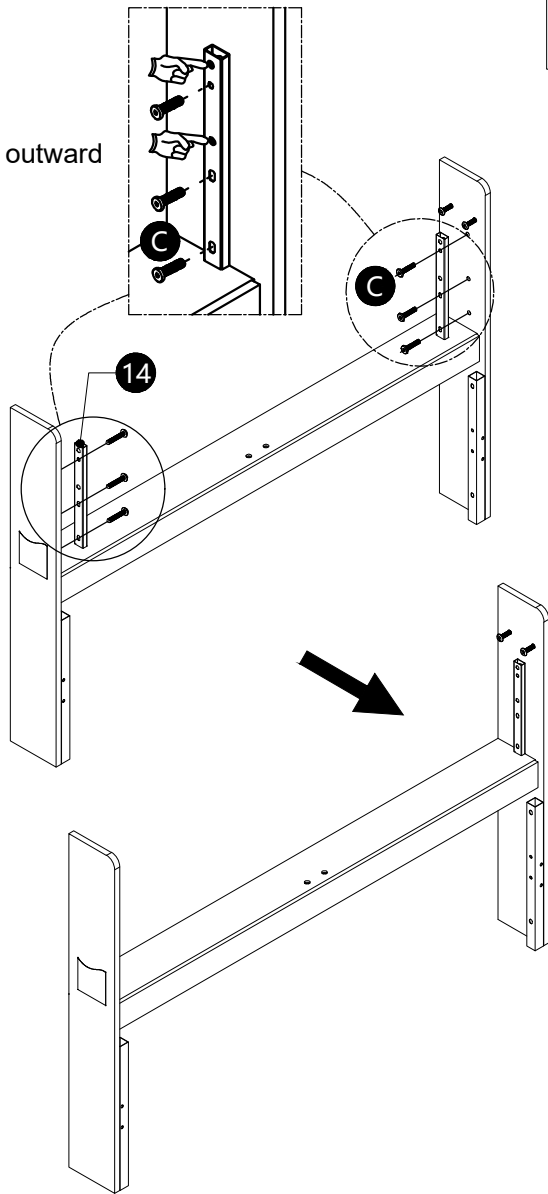

M8\*30 X 6PCS

Step:8

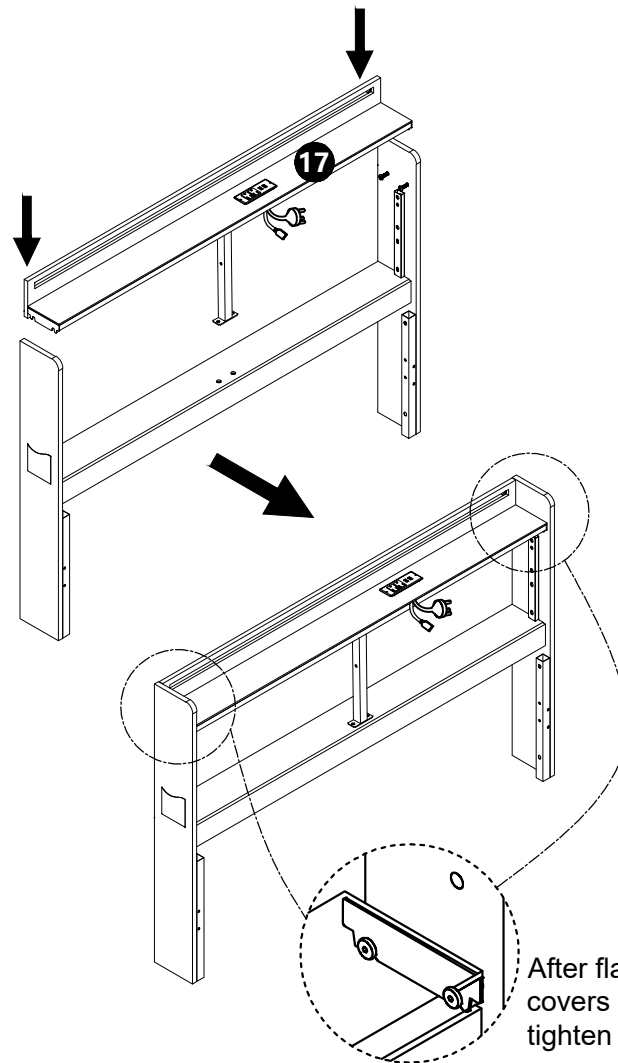

After flattening the cloth covers at both ends, tighten the screws.



# Assembly Instruction of Bedside cabinet

Step:9

M8\*20 **A** X 2PCS

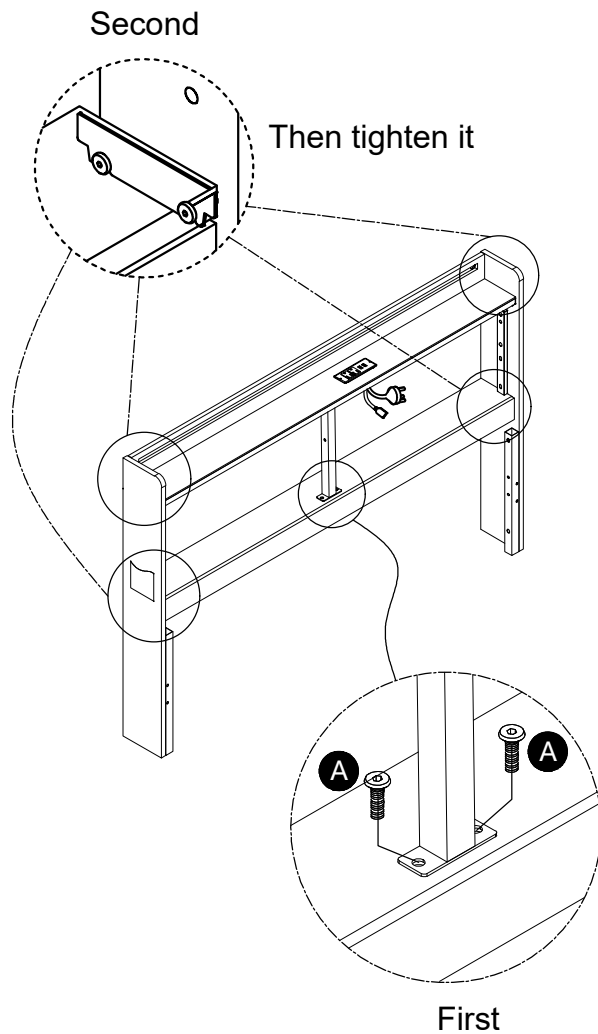

Step:10

M8\*15 **D** X 4PCS

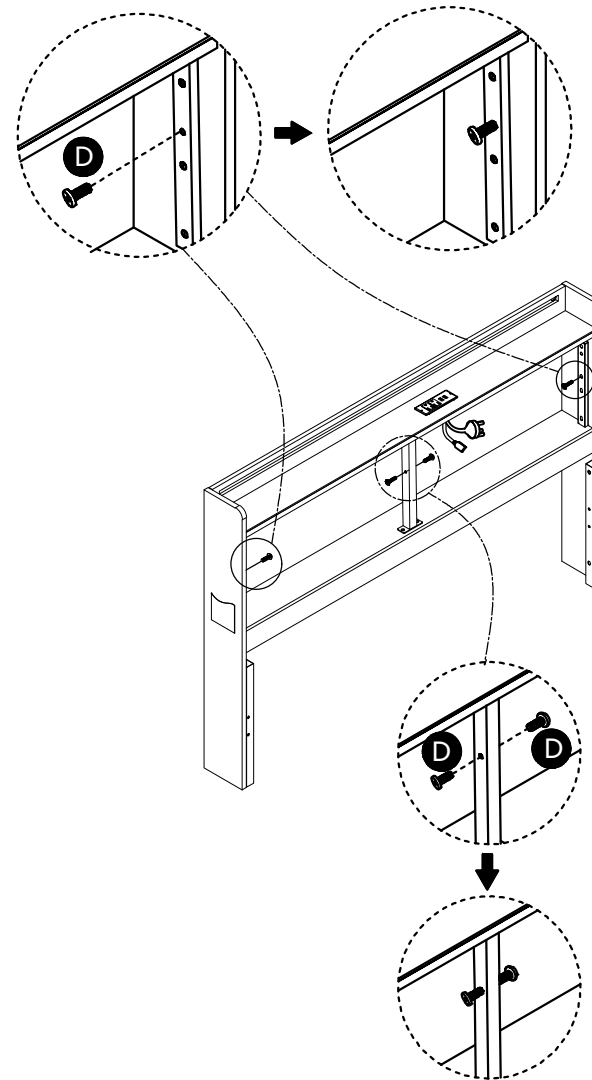

# Assembly Instruction of Bedside cabinet

Step:11

M8\*15 **D** X 8PCS

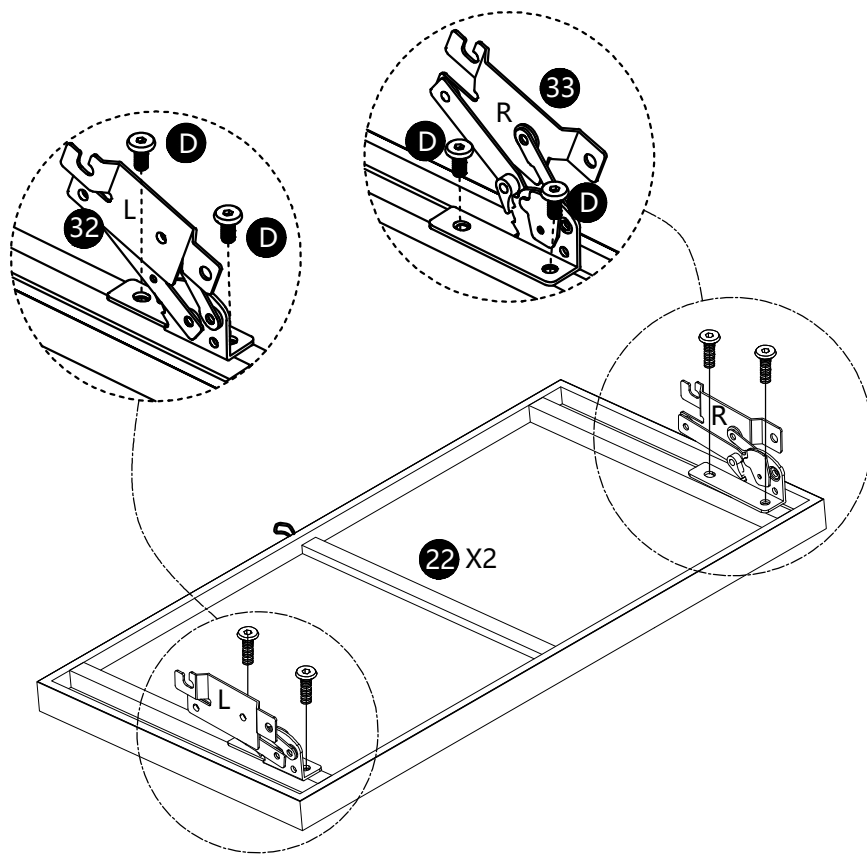

Step:12

Then tighten it

M8\*15 **D** X 4PCS

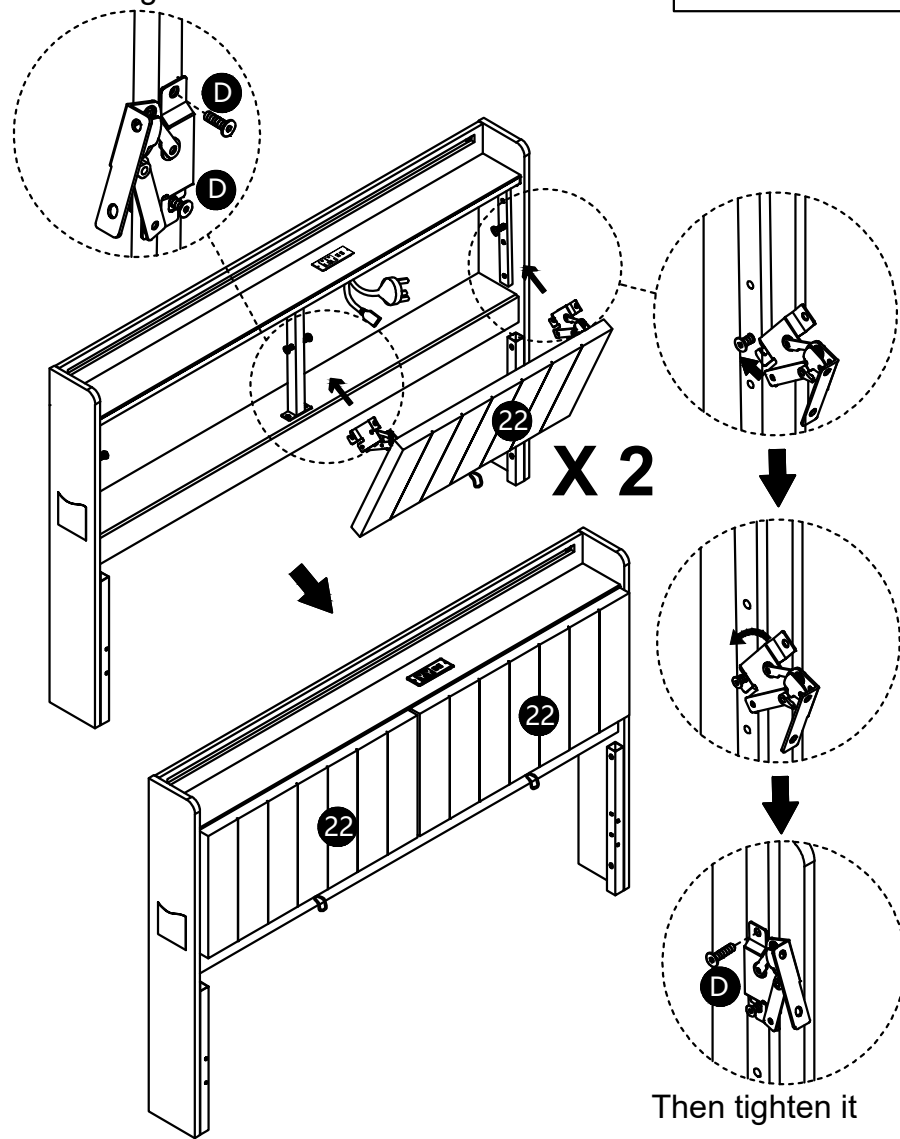

Then tighten it

# Assembly Instruction of Bedside cabinet

Step:13

 **A** X 4PCS  
M8\*20

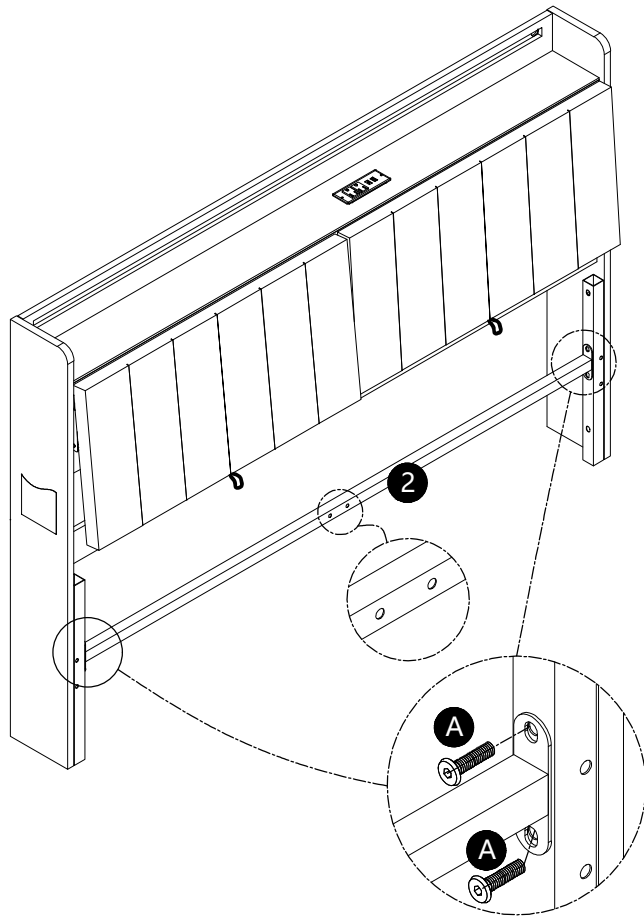

Step:14

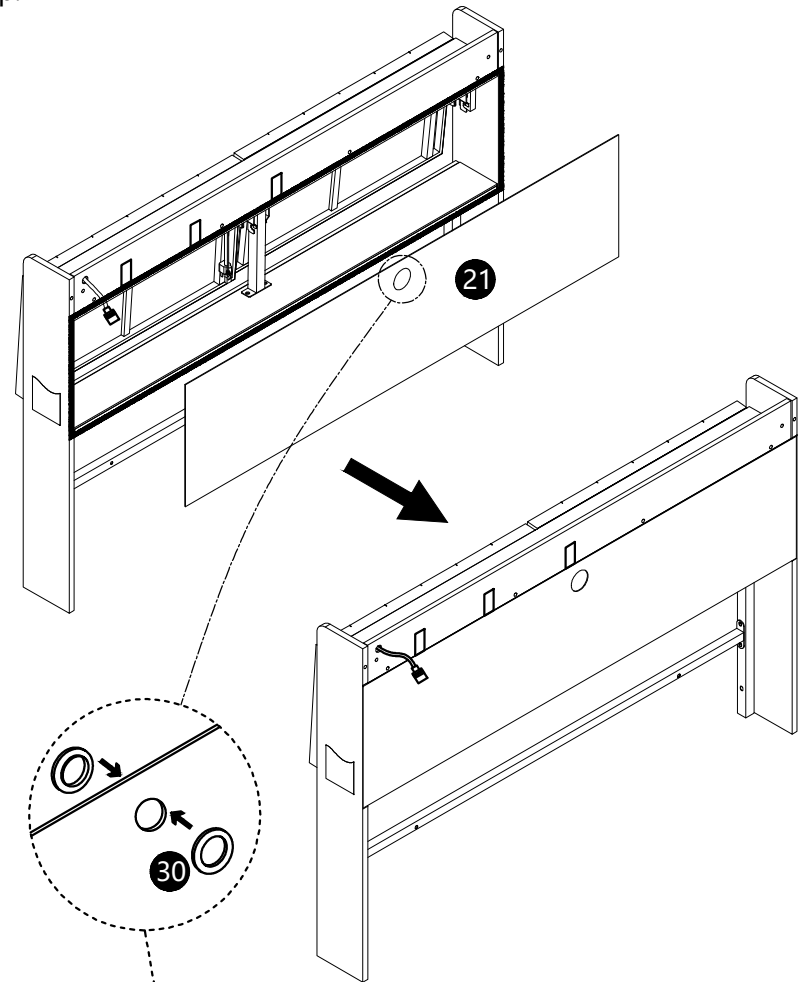

First Open accessory(30)

Second Place them separately on  
the front and back of the (21)  
hole and press them tightly

# Assembly Instruction of Bedside cabinet

Step:15

 M8\*20 **A** X 4PCS

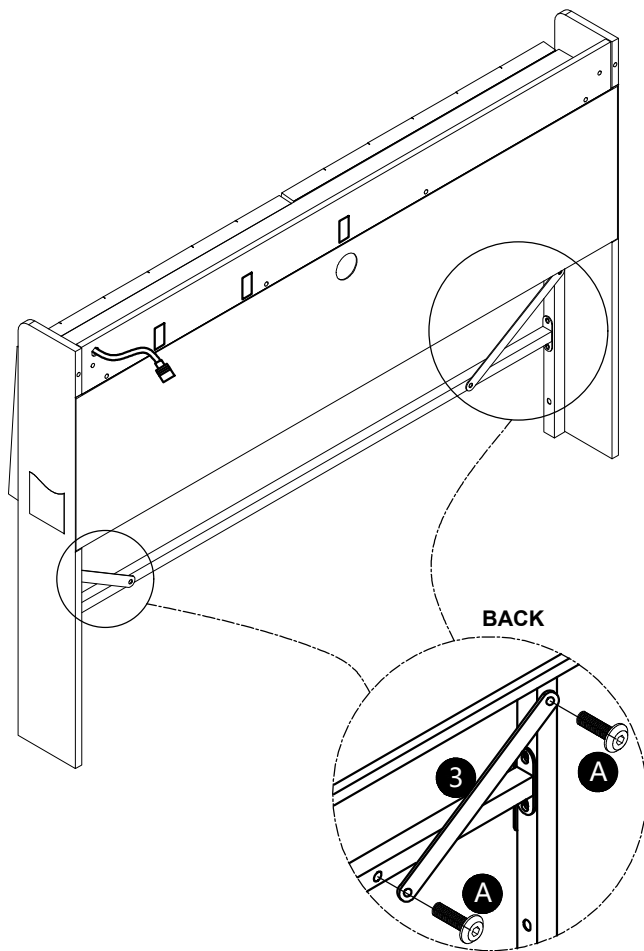

Step:16

 M6\*15 **H** X 4PCS

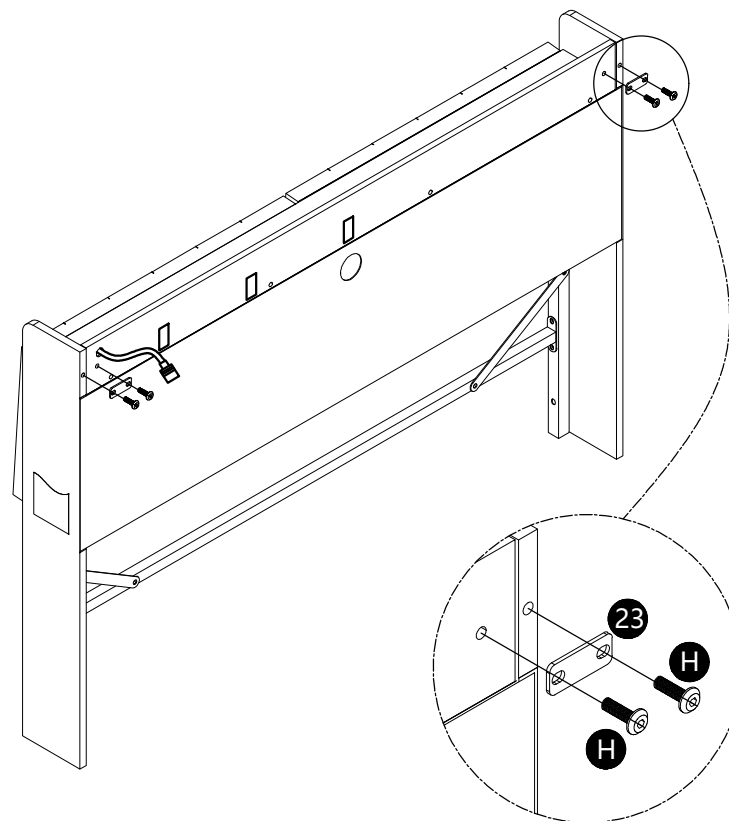

# Assembly Instruction

Step:17

 **E** X 4PCS  
M8\*50

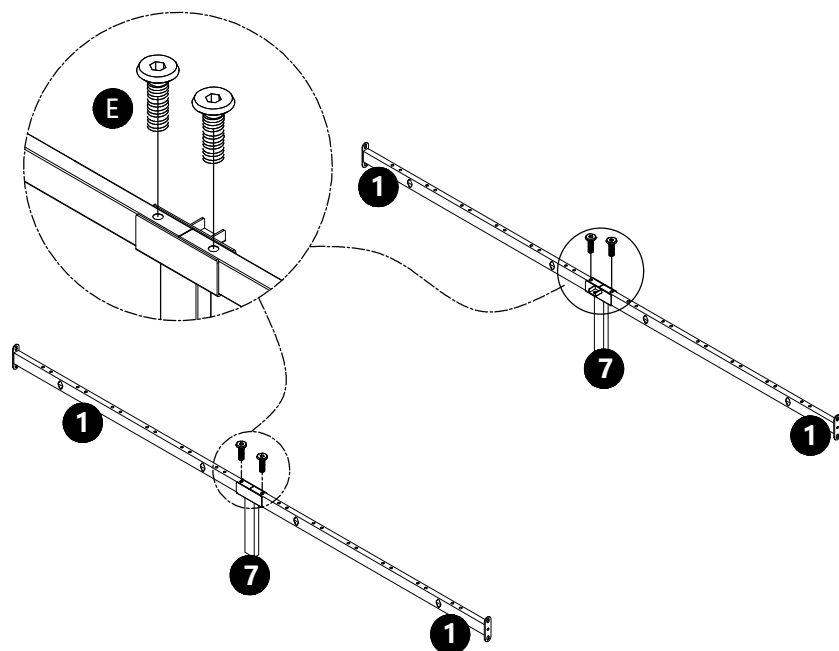

Step:18

 **A** X 8PCS  
M8\*20

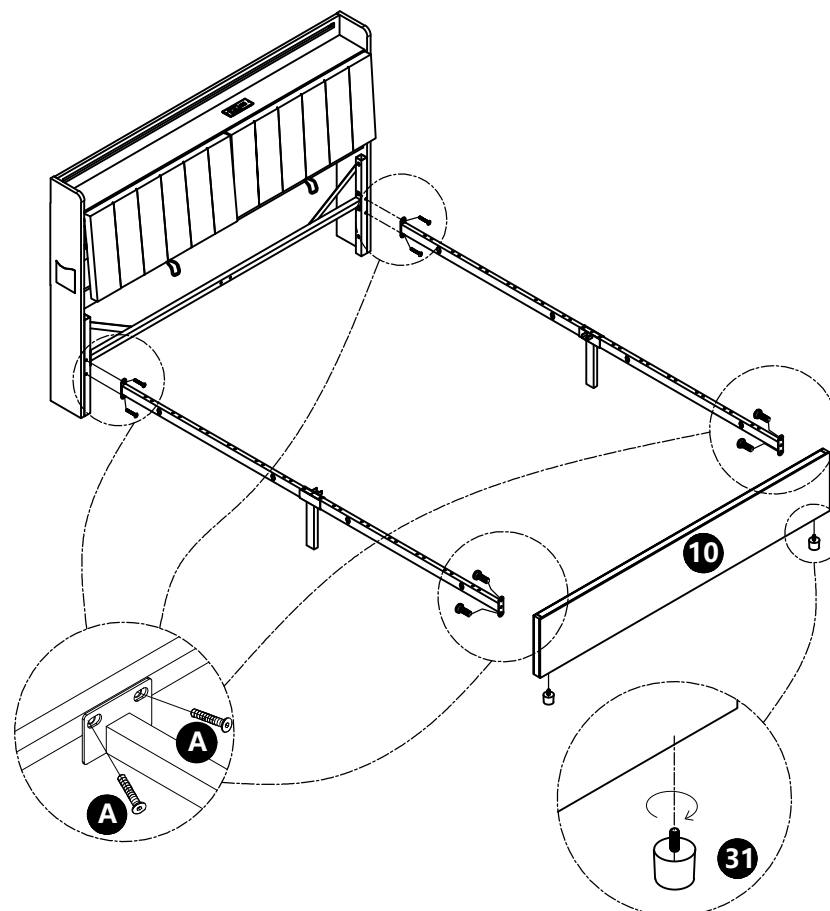

Install the adjusting feet first

# Assembly Instruction

Step:19

 **B** X 2PC  
M8\*35

 **V** X 2PCS  
M8\*ø22

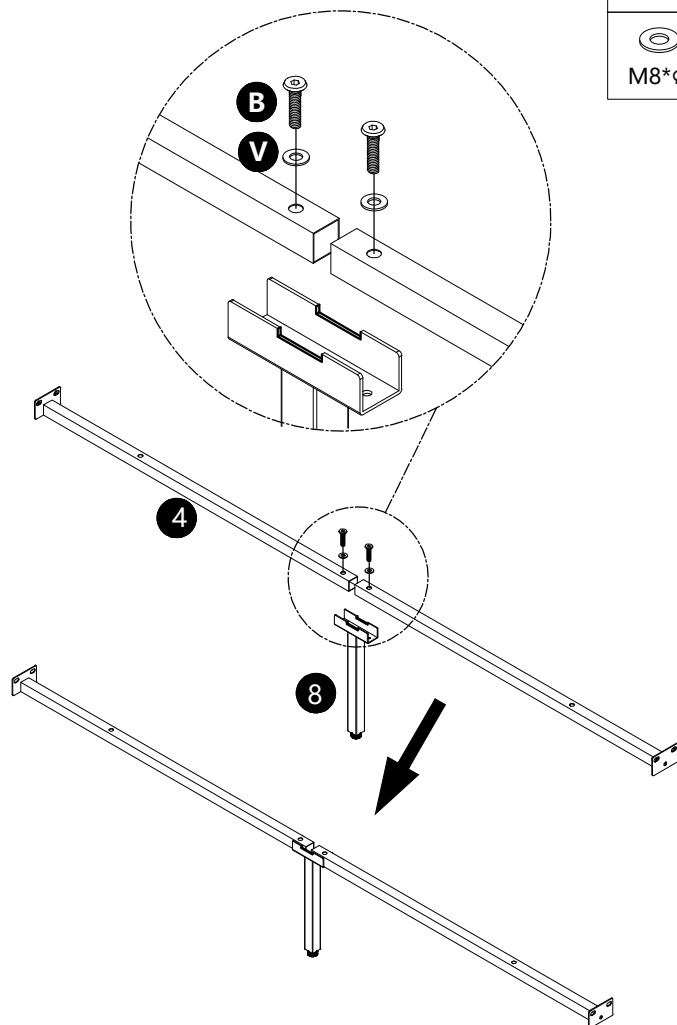

Step:20

 **A** X 4PC  
M8\*20

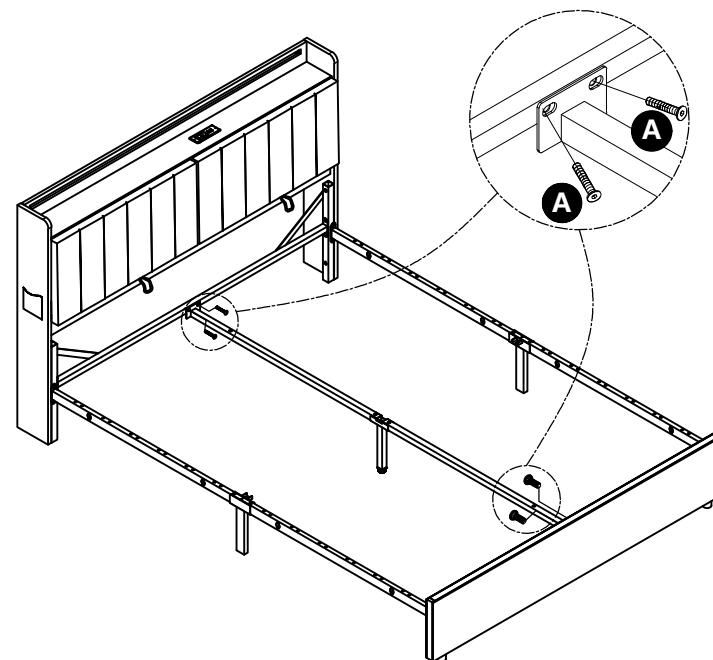

# Assembly Instruction

Step:21

M8\*35 **B** X 4PCS

M8\*50 **E** X 1PCS

M8\* $\phi$ 22 **V** X 5PCS

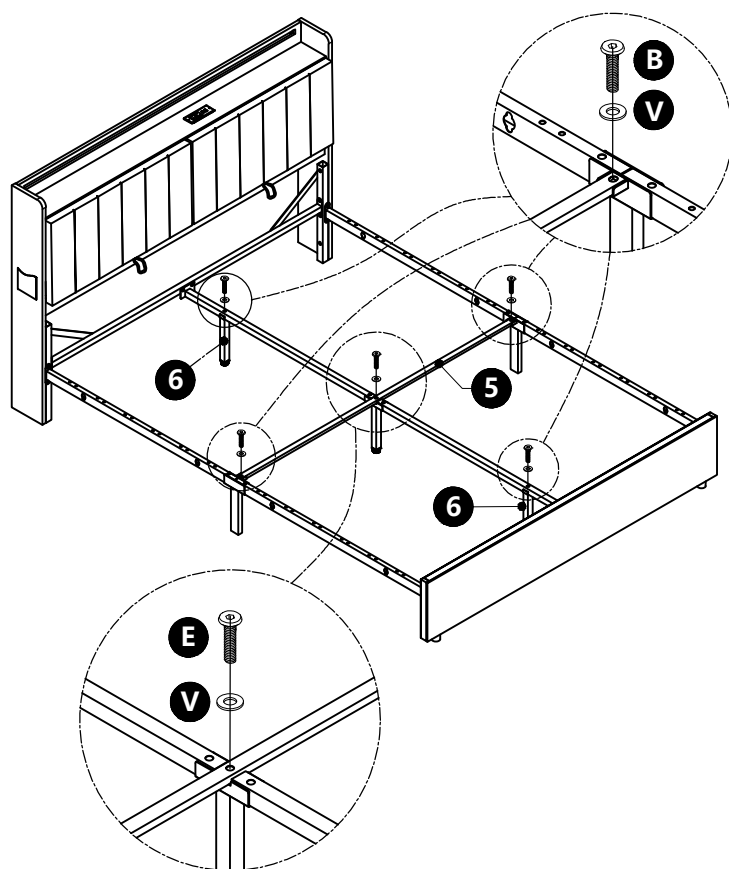

Step:22

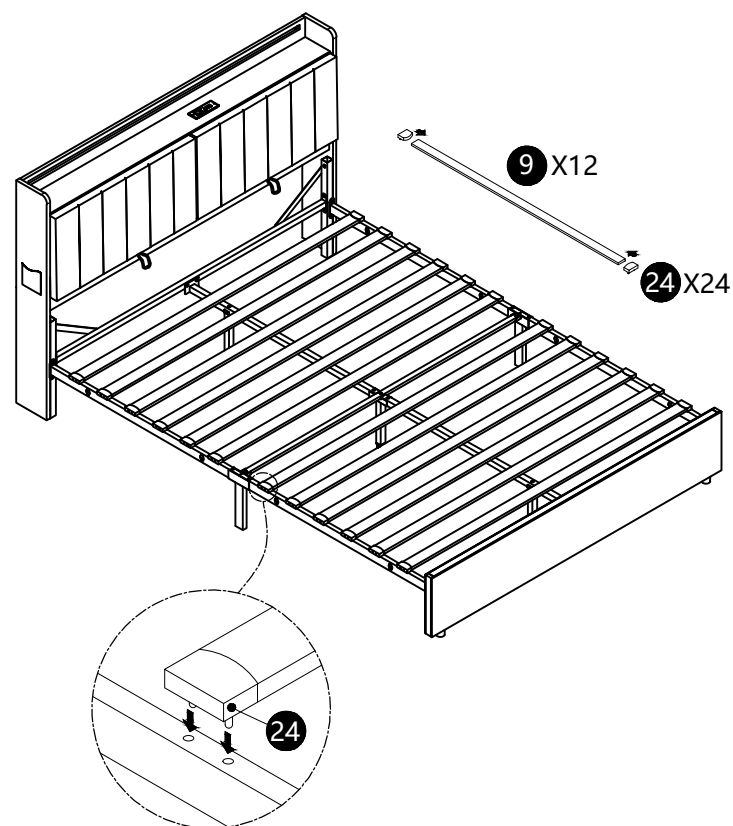

# Assembly Instruction

Step:23

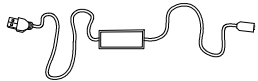

**35** 1PC  
Power cord

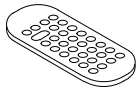

**36** 1PC  
Remote control

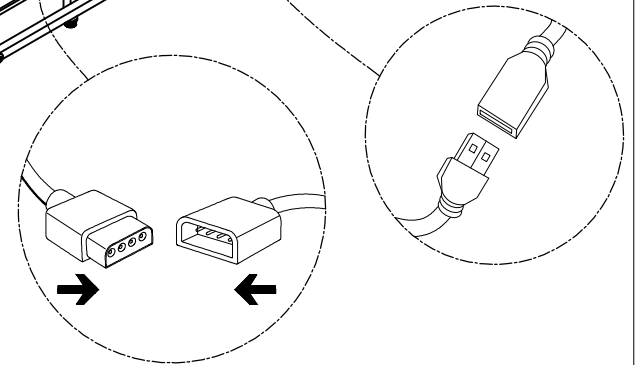
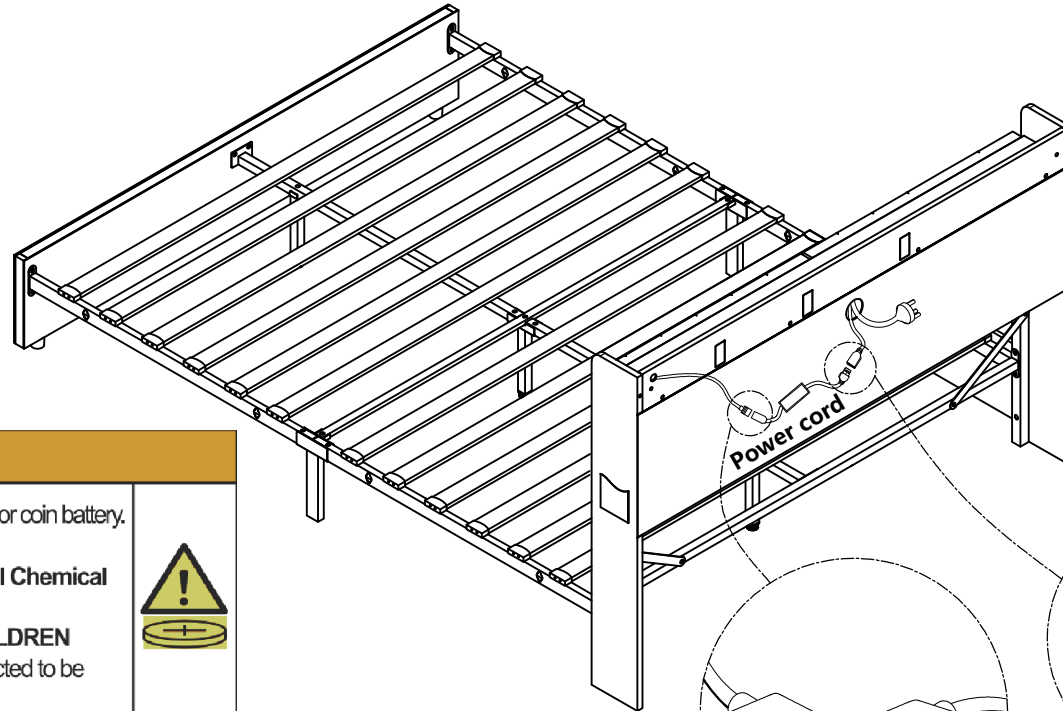

## ⚠ WARNING

- **INGESTION HAZARD:** This product contains a button cell or coin battery.
- **DEATH** or serious injury can occur if ingested.
- A swallowed button cell or coin battery can cause **internal Chemical Burns** in as little as **2 hours**.
- **KEEP** new and used batteries **OUT OF REACH** of **CHILDREN**
- **Seek immediate medical attention** if a battery is suspected to be swallowed or inserted inside any part of the body.





# Assembly Instruction of **drawer**

## **Black plastic buckle** instructions for assembling drawer mesh

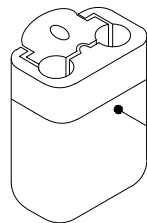
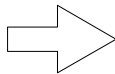
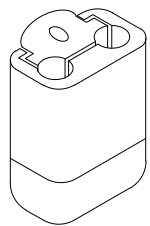

Remember this  
convex coil

Reverse  
direction

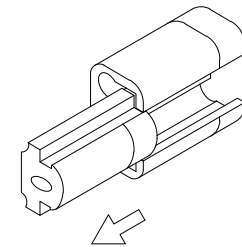
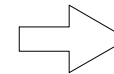
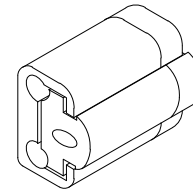

You can pull the buckle out by  
following the direction indicated  
by the arrow

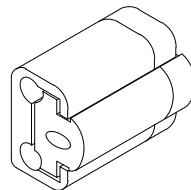
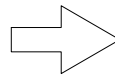
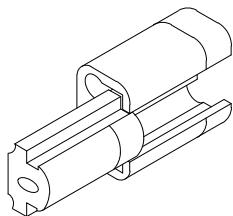

**So** This is the only direction that  
can be locked

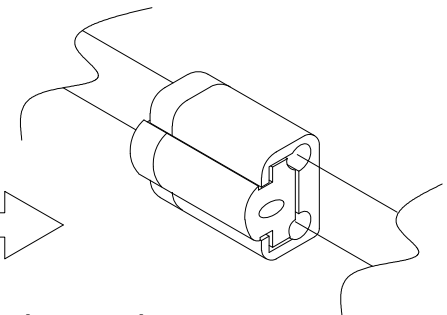
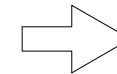
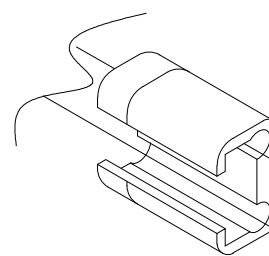

Place round iron tube as shown  
for better drawer assembly

# Drawer Base's Assembly Instruction



**Please note that this drawer base (26) has front and back sides! Please see the instructions clearly before assembling!!!**

As shown in the figure Clip the pulley into position first

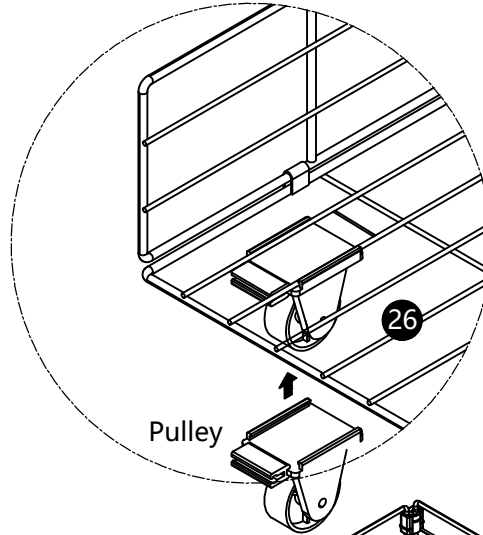

Then push the pulley to the side  
At the same time, clamp the iron wire at the edge. It takes a little strength

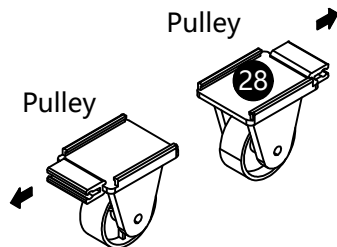
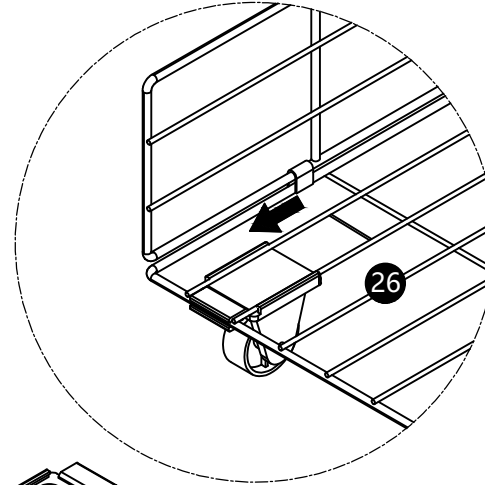

**Pay attention to the orientation before clamping in**

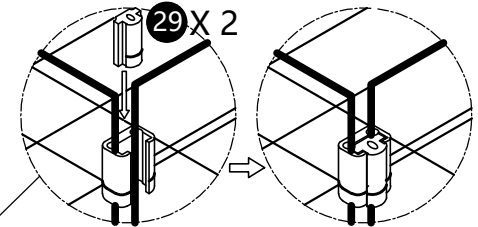
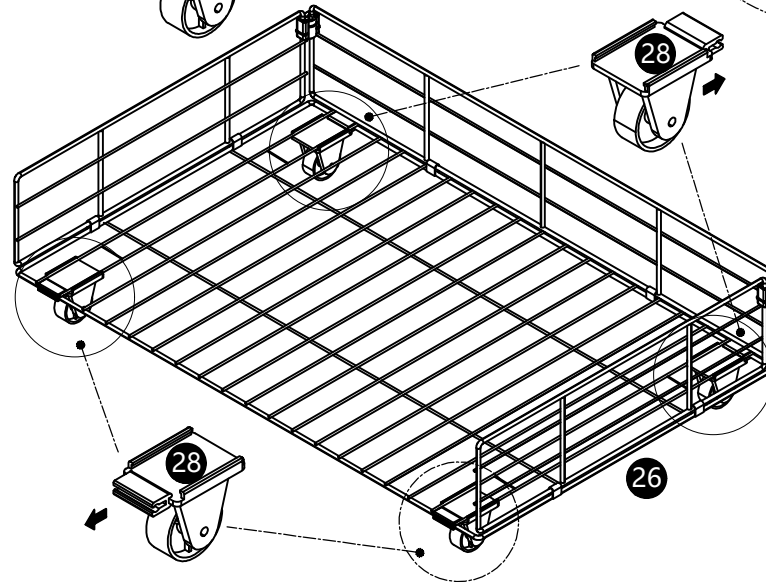

Assemble the other three drawers in this way. 4 drawers in total.

# Assembly Instruction of **drawer**

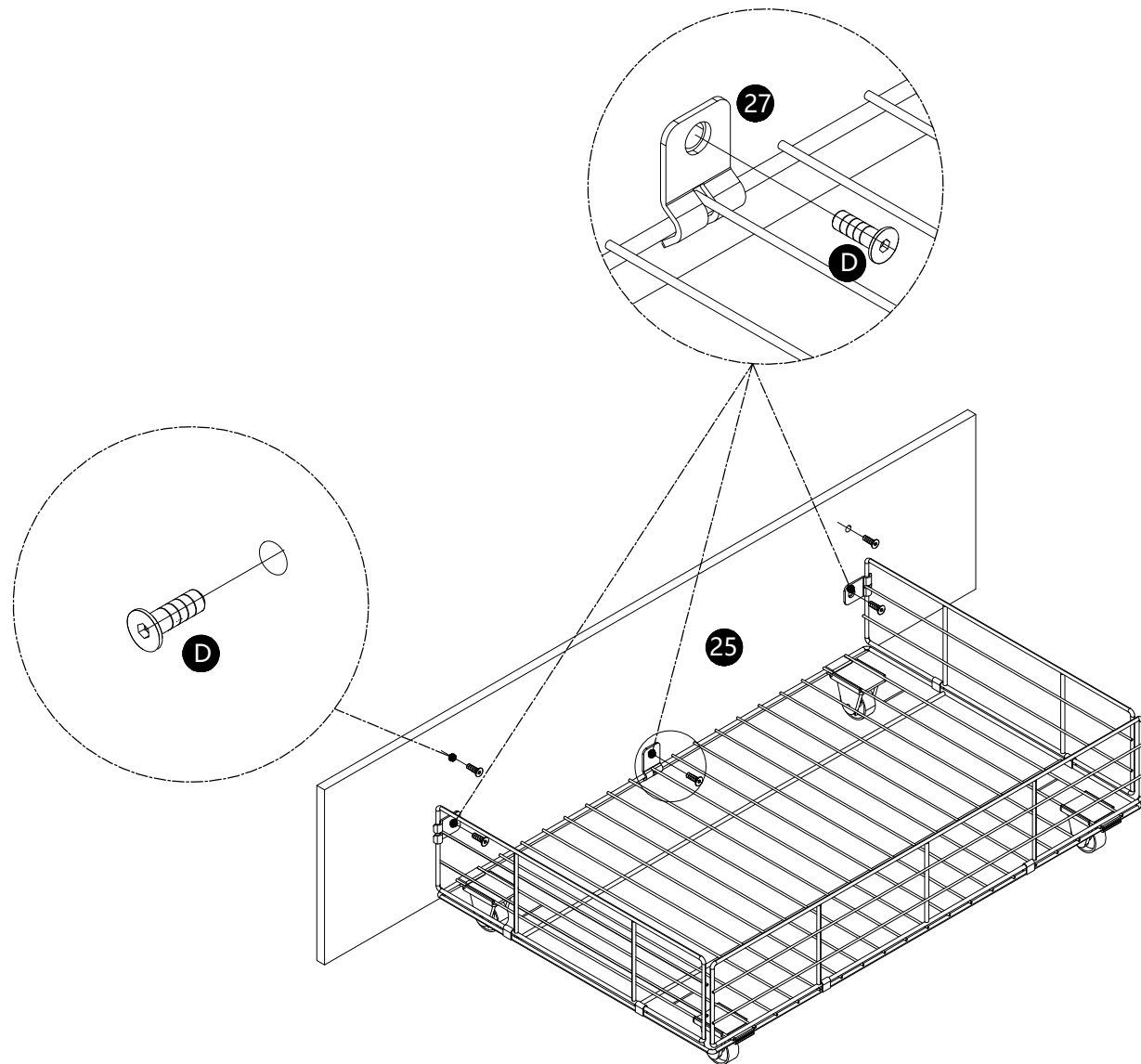

Iron buckle x 12



M8\*15

Screw x 20pcs

# Assembly Instruction

**1:** You must put the drawer pad ( 37 ) in the drawer

**2:** This screw must be turned out slightly, leaving a distance of 2-3mm

**3:** Gently lift the drawer, align the screw with the gourd hole

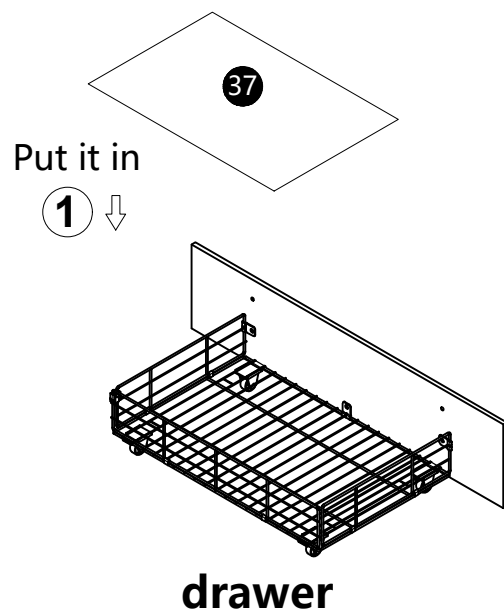

**When pushing into the drawer,**  
**Lift the drawer gently,**  
**Align the screw with the gourd hole**  
**and push in**  
**When pulling out the drawer,**  
**Lift the drawer gently,**  
**Align the screw with the gourd hole,**  
**and then pull it out**

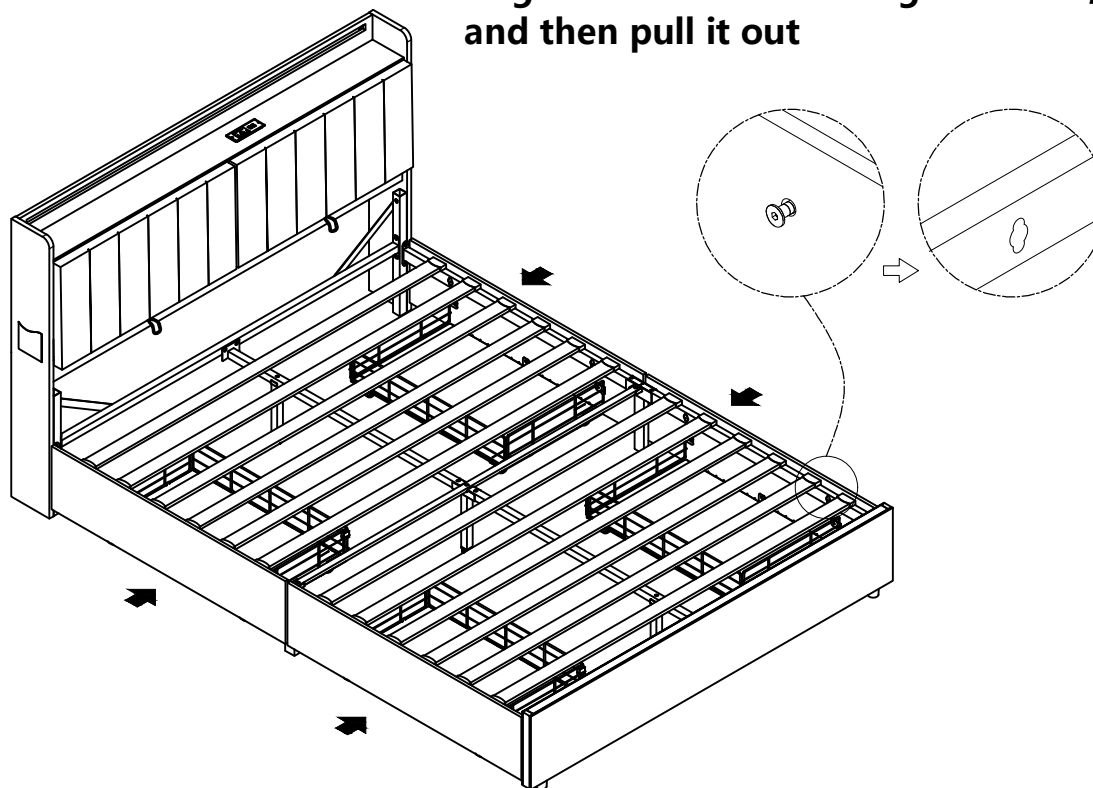

# Assembly Instruction of **drawer**

