

Best Bathroom Mirror

User Manual

LED Bathroom Mirror



Clear Mirror



Three-colored light



Defogging



Human sensor interaction

Whats included in the box?

LED Bathroom Mirror

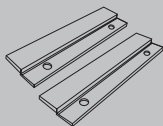
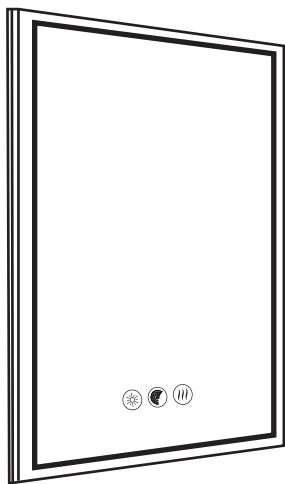

Bracket



Screw



crash cushion

Before you commence

Safety Information

Please check the electrical circuits carefully to avoid the possibility of electric shock or bodily injury.

- Turn off circuit breaker before installing this Bathroom Mirror.
- Suitable for use in wet environments at temperatures ranging from -22°F to 100°F.
- Not intended for use with emergency fixtures.
- Not compatible with timing devices.
- Not compatible with third party sensors.
- All electrical connections must be secure.
- Accordance with local and National Electric Code (N.E.C.) standards.
- Please review installation manual carefully before proceeding. Consult a qualified electrician if you are unfamiliar with proper electrical wiring connections.

WARNING:

Cancer & Reproductive Harm- www.P65Warnings.ca.gov

This device complies with Part 15 of the FCC rules. Operation is subject to the following two conditions:

- 1.) This device may not cause harmful interference.
- 2.) This device must accept any interference that may cause undesired operation. Please review all instructions carefully.

Functional Description



Turn on the light.

Click to turn on the light



Three-color lighting

Click to change color, long press to adjust brightness



Human interaction

Automatically turn light when someone approaches



Defogging

Click to turn on defogging, long press to turn on or off the body sensing function.

Installation Tutorial

STEP 1

Confirm the position of the bracket with a level and mark the 4 holes

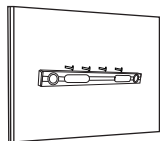

STEP 2

Use an electric drill to punch holes at the marked spots, and then apply wall anchors with a hammer

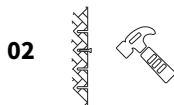
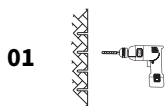

STEP 3

Screws fasten the two brackets to the wall

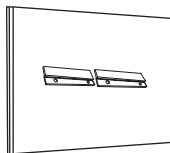

Installation Tutorial(Cont.)

STEP 4

4 rubber backing pads attached to the back

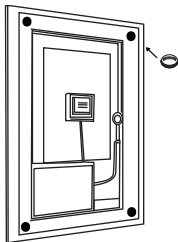

Option 1

Plug-in:

Plug the power cable to a standard socket.



Option 2

Hardwiredcut:

The head off the plug and hardwire it into an outlet.

Black wire--power supply N (NEUTRAL)

White wire--power supply L (LIVE)

Green wire--power supply E (EARTH)



WARNING: This mirror must be earthed.

REMINDER: Please make sure the power is cut off before installation

Product Details

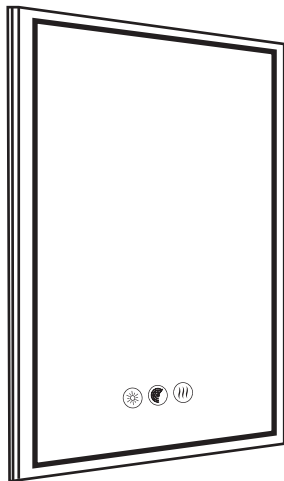

Voltage:	120V	Wattage:	30W
Waterproof :	Yes	Average Lifetime:	50,000+ hours
CRI:	85%	Mirror clarity:	100% high definition
Human interaction:	Yes	Defogging:	Yes
Three-color light:	Yes	Aesthetic design:	Yes
Indoor:	Yes	Usage scenes:	Bathroom, Bedroom

Customer Support

Warranty Policy

This product is covered by our industry leading 5 year warraaanty

30 Day Return Policy

We value our customers and stand by the quality and performance of our products. If you are not completely satisfied with your purchase, we accept returns within 30 days of your purchase date.

Customer Service

Our company has been making bathroom mirror lights for over 20 years, and our team of professional lighting experts can help you. Please contact us!

Best Bathroom Mirror