

PITTA WOOD 1 DRAWER HALL TREE

DESIGN# SFV4224

Assembly Instructions

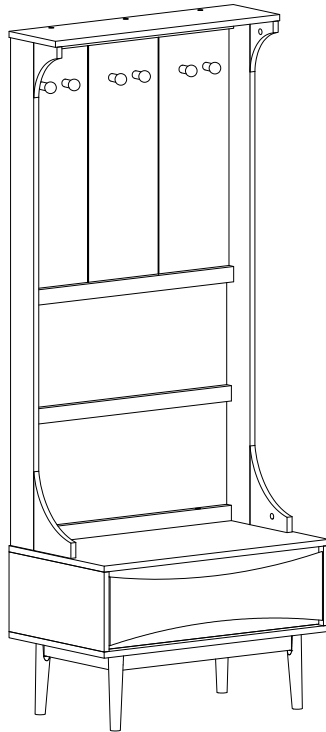

SAFAVIEH
C O U T U R E

Thanks for bringing Safavieh Couture into your home

Everything we make is incredibly simple to set up, including your new hall tree. You won't need any additional tools.

Parts List

A x 1
Base

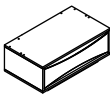

B x 4
Legs



C x 1
Right side panel

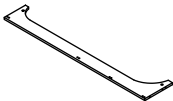

D x 1
Left side panel

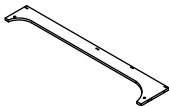

E x 1
Top panel

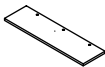

F x 1
Top rail

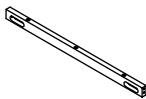

G x 2
Middle rail

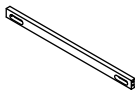

H x 1
Bottom rail

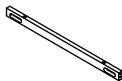

I x 2
Back panel

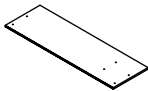

J x 1
Middle back panel

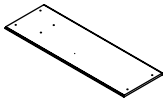

K x 6
Hook



Hardware List

HW1 x 8
Bolt 6x60mm



HW2 x 2
Bolt 6x50mm



HW3 x 11
Bolt 6x35mm



HW4 x 6
Bolt 4x20mm



HW5 x 6
Flat washer 4x10mm



HW6 x 8
Flat washer 6x16mm



HW7 x 8
Spring washer 6x10mm



HW8 x 12
Screws 4x20mm



HW9 x 4
Cam bolt



HW10 x 4
Cam lock



HW11 x 8
Semicircle washer



HW12 x 14
Wooden dowel



HW13 x 1
Allen key



HW14 x 4
Plastic Brackets



HW15 x 2
Restraint straps



HW16 x 4
Short screws



HW17 x 4
Plastic anchors



HW18 x 4
Long screws

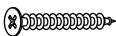

1

Insert the Wooden dowels (HW12) into the holes at both ends of the side panels (C&D) and rails (F&G&H). Attach the rails (H&G&F) to the side panels (C&D) by using the Allen key (HW13) to screw in the bolts (HW3) with the Semicircle washer (HW11) as shown.

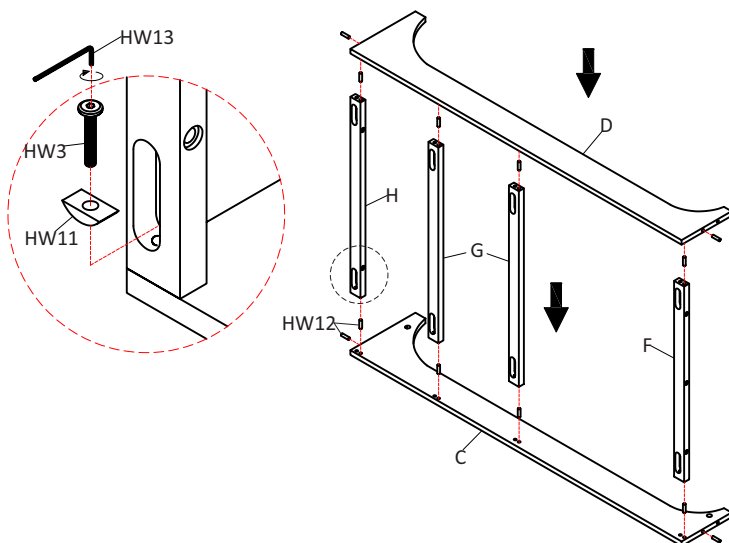

2

Attach the Cam bolts (HW9) to the Top panel (E). Do not over tighten. Insert the Cam lock (HW10) into the side panels (C&D). Attach the Top panel (E) to the side panels (C&D) and top rail (F) by using the Allen key (HW13) to screw in the bolt (HW3) and the Cam lock (HW10).

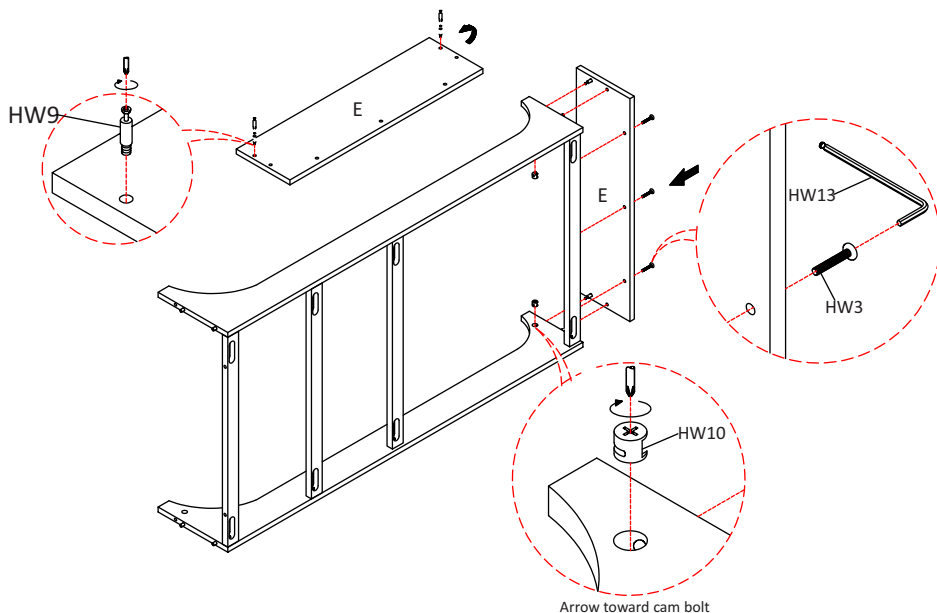

3

Connect the back panels (I&J) to each other by inserting the tenons into the grooves. Attach the back panels (I&J) to the top rail (F) and the middle rail (G) with the Screws (HW8). Align the screw hole on the Hook (K) to the screw holes on the back panels (I&J). Place the Flat washers (HW4) onto the Bolts (HW5). Screw in the bolts (HW4) to attach the back panels.

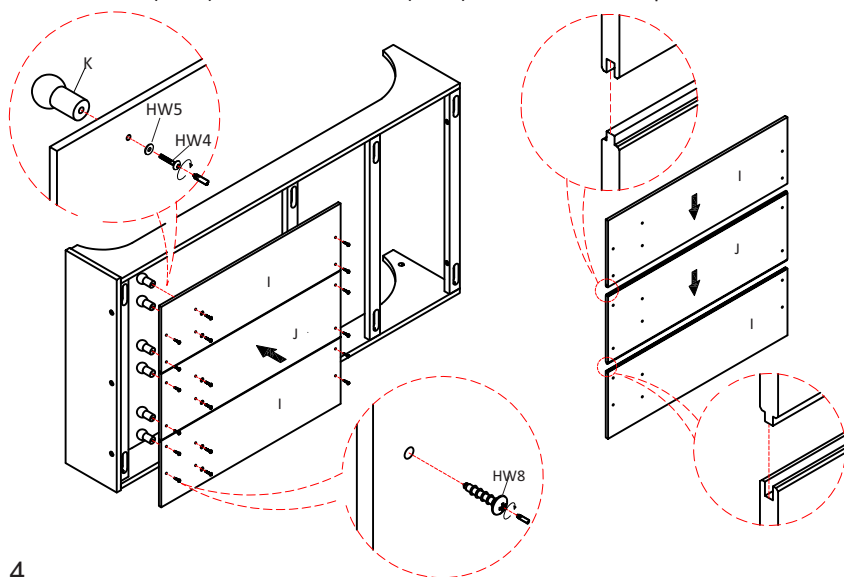

4

Place the base (A) on its side on a soft surface. Put the flat washer (HW6) and spring washer (HW7) on the Bolt (HW1). Attach the legs (B) to the base (A) by using the Allen key (HW13) to screw in the bolts (HW1) with the washers.

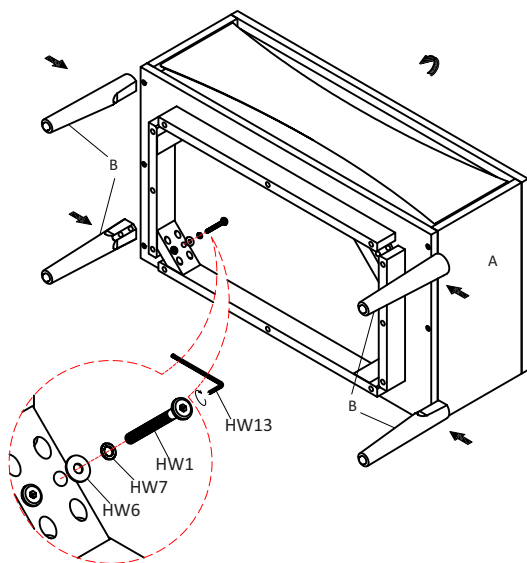

5

Insert the Cam bolts (HW9) into the base (A). Do not over tighten.

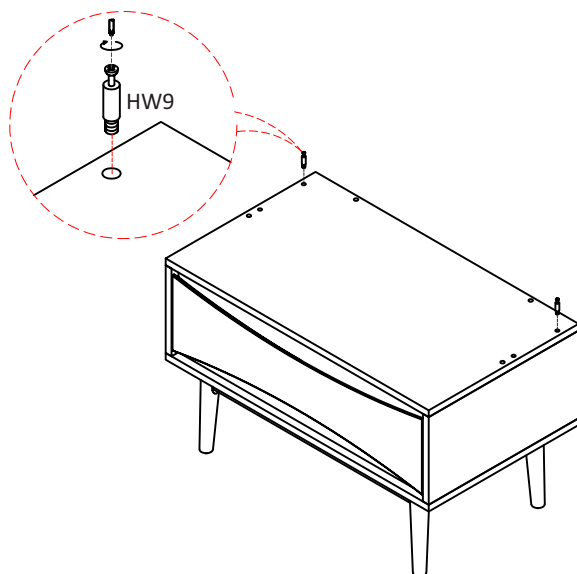

6

Insert the cam lock (HW10) into the side panel. Connect the hutch to the base by using the Allen key (HW13) to screw in the bolts (HW2) and the Cam locks (HW10).

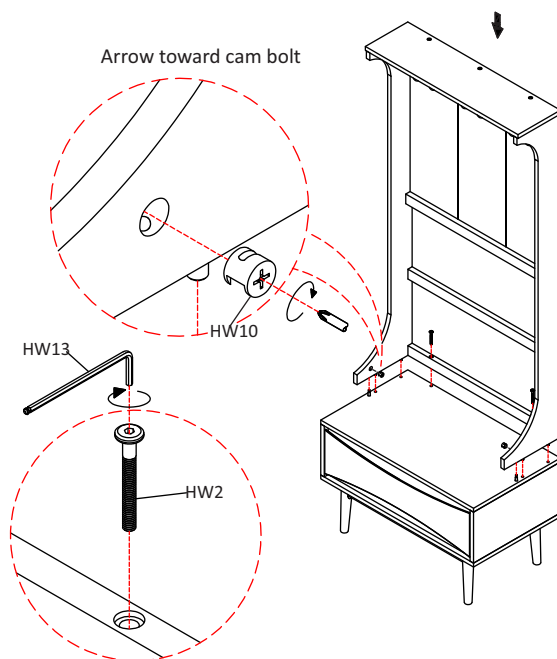

To help prevent the possibility of tipping over, install the tip over restraint kit provided.

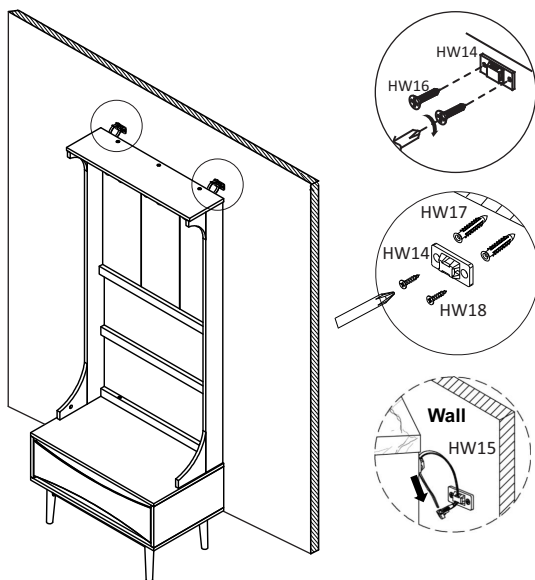

Place the hall tree in the place where you will use it. We'd love to see it – just tag us (we're @safavieh) and use the hashtag #safavieh on Instagram!



Need help?

Feel free to contact us via email or call
if you have any specific questions!

contact us:

cs@safavieh.com

866-422-9070