

# Shade Assembly Instructions

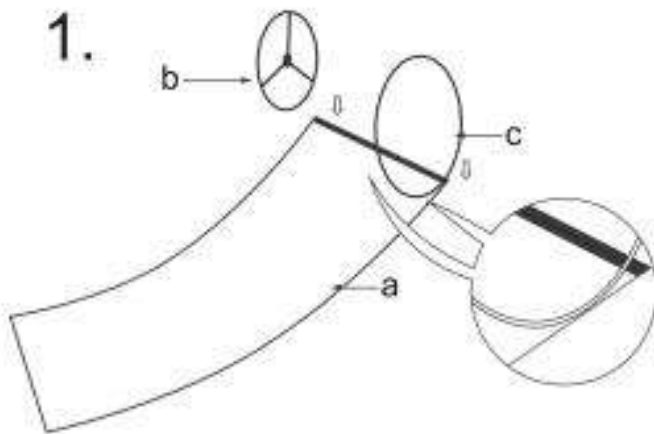

1. Please note that the bottom of the shade is longer than the top. Align the shade's longer side with Ring C and the shorter side with Ring B. Clip the pieces on the bottom and top of the shade to both Rings.

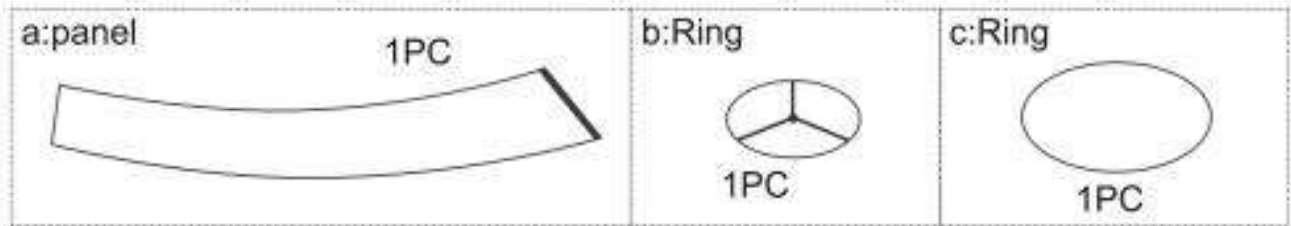
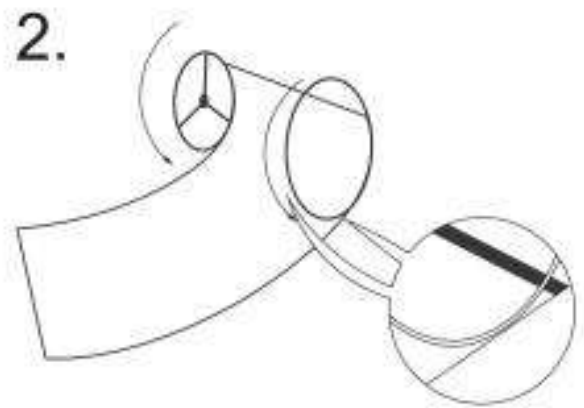

2. Roll both rings all the way around and make sure all the clips on the shade are secure onto both Rings.

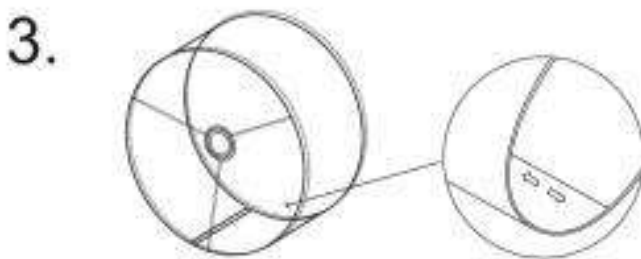

3. Secure the shade by pressing along the velcro.

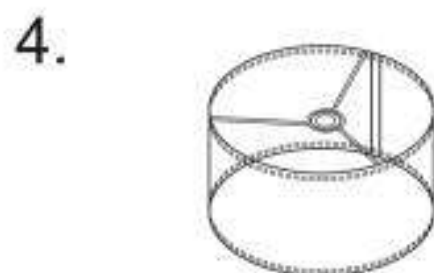

4. Finished as above picture.

Thank you for your purchase of the Lamp. We hope that you are completely satisfied with your purchase.