

Scope of application and instructions

1. This shower chair is an assistant facility for disabled people to take a bath more conveniently.
2. Before using the shower chair, please adjust it to the suitable seating height. Adjustment method: Press the pinball with your finger up and down to adjust these four legs into appropriate sitting height, please note that these four legs must be adjusted to the same height of the hole.
3. Check seat board, the backrest are securely installed, please sit in the middle position of the Shower chair when using it.

Storage Method

Please put the shower chair in a dry and ventilated place. Do not exposure it under the sun for a long time. To maintain the beauty of the original finish, clean with mild soap and rinse with warm water. Wipe bath seat dry after each use.

Precautions

To prevent the injury caused by shower chairs overturned, please do not take only one side support when stand up or sit down. Be carefully when using it on the uneven ground. Please clean and make it dry promptly after using. Do not take it under in water for a long time and keep the board dry.

⚠️ WARNINGS:

- ⚠️ Prior to each use check to assure that all screws, joints and fittings on the bath bench are tight. All four leg extensions with rubber tips MUST touch the floor simultaneously at all times. Be sure that all gold locking buttons fully protrude thru holes of each Adjustable Leg.
- ⚠️ DO NOT place bath bench on uneven surfaces.
- ⚠️ DO NOT use if wobbly, unstable or not level.
- ⚠️ DO NOT exceed user static pressure bearing weight of 205kg(450LBS).
- ⚠️ DO NOT stand on the bath bench.
- ⚠️ DO NOT use the armrest to fully support body weight when using the unit.
- ⚠️ Inspect all parts for shipping damage before assembly. If there is shipping damage - DO NOT USE. Contact dealer/carrier for further instructions
- ⚠️ This shower chair cannot be used in the bathtub.
- ✅ Excessive twisting or turning while seated on the bench may cause a loss of balance and damage to the product.
- ✅ Check rubber tips for rips, cracks or wear. If these conditions exist, DO NOT use the bath bench and replace the tips immediately.
- ✅ Check the bench for cracks or ruptures in the plastic.
- ✅ Check that all push buttons are fully protruded from the mainframe through the leg extensions and are properly engaged.
- ✅ Ensure all four legs are adjusted evenly and are free of any obstructions prior to use.



SHOWER CHAIR WITH BACK CST-3022

CAUTION
UP TO 450LBS



To ensure the safe installation, adjustment, and operation of the shower chair, these instructions MUST be followed. FAILURE TO FOLLOW INSTRUCTIONS MAY RESULT IN SERIOUS INJURY TO THE USER AND/OR DAMAGE TO THE PRODUCT. If you are unable to understand these warnings, cautions, and instructions, contact a professional or dealer before attempting to use this equipment. In particular, we are not to be held liable for any indirect or direct damage or consequential damage, loss or expenses in connection with the use or inability to use the device for a specific purpose.

SHOWER CHAIR WITH BACK CST-3022

Thanks for using our product.
Before using, please read the manual carefully.



Specifications:

1. Adjustable Height: 715-840mm/28.1-33.1"
2. Chair Back: 380*230mm/15*9.1"(LxW)
3. Seat: 510*305mm/20.1*12"(LxW)
4. The Height From Seat to Floor: 360-485mm/14.2-19.1"
5. Static pressure bearing force: 205kg/450lbs
6. Weight: 3.1kg/6.9lbs

Elements of the chair and manual for installation:



1. Chair back
2. Tube for chair back
3. Seat
4. Leg receivers
5. C-Clips
6. Chair leg
7. Cross brace
8. Install pipe for back

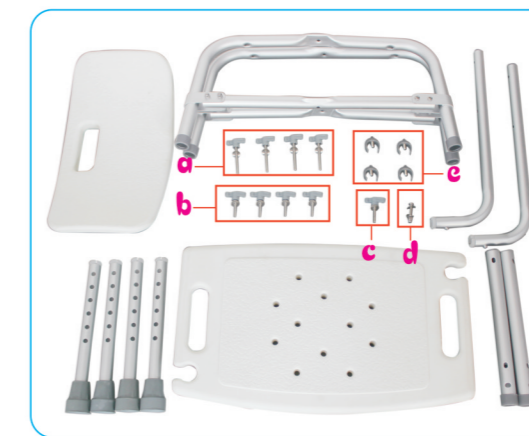

1. Take all the items out of package.

- a: use for locking install pipe for back;
- b: use for locking the chair back ;
- c : use for locking the center hole of the seat ;
- d: use for locking cross brace;
- e: use for adjusting leg;



2.3. Put the seat tube(1) into the seat plate (1) arc tank first. and then put the seat tube(2) into the seat plate(2) arc tank(as shown) .

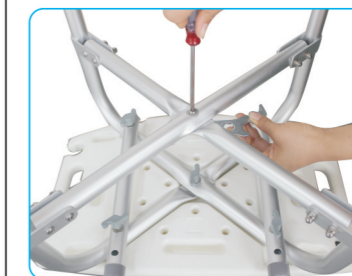

4. At first, place the backrest installation pipe in the position of the seat tube, align the hole position, and place the gasket and screw A ; second, place the gasket and screw C in the middle hole of the seat tube; and then insert the screw D into the center hole of the cross brace and screw in the nut. use the phillips screwdriver to tighten with the spanner in the screw bag. At last tighten the fixed screws A&C in turn.



6. Place the backrest tube on the back plate, align the hole position, put the gasket and the screw B, and tighten it in turn.



8. Assemble backrest. Insert the backrest assembly tubes into the back rest receiver on the underside of the seat.



5. Insert a leg into each of the leg receivers use a C-shaped(E) clip to secure each of the legs to the leg receiver.



7. The upper backrest tube setup complete. (as shown)



9. Setup Complete.