

Installation Instructions

TABLE LAMP

1. Please **CHECK** carefully whether the **ACCESSORIES ARE COMPLETE.**
2. Please **CHECK** whether the **LAMP SHADE AND LAMP BODY** are broken, if so, please **CONTACT LOKHOM** in time.

3. Unpack all parts from cartons carefully.
4. Install the KD shade with bracket.
5. Squeeze **HARP** together and insert into **SADDLE**.
6. Install Bulb (The sub-light is fixed and the main light is **NOT INCLUDED**) onto the **LAMP HOLDER** according to the wattage label.
7. Place **SHADE** onto **HARP** and Tighten **SHADE** by **FINIAL**.

TIP: You can grasp the **FINIAL** and **FASTENER** together to adjust the **SHADE** to correct position if it is skew. **FASTENER** is slightly rotatable by external force.

CAUTION: Refer to the wattage caution label located on the **LAMP HOLDER** for recommended maximum wattage. (**DO NOT** exceed recommended wattage.)

WARNING: Do not attempt to replace the bulb while the lamp is plugged into a wall receptacle.

IMPORTANT SAFETY INSTRUCTIONS

This portable lamp has a polarized plug (One blade is wider than the other) as a safety feature to reduce the risk of the electric shock. This plug will fit in a polarized outlet only one way. If the plug does not fit in the outlet, reverse the plug. If it still does not fit, consult a qualified electrician. Never use an extension cord unless the plug can be fully inserted. Do not alter the plug.

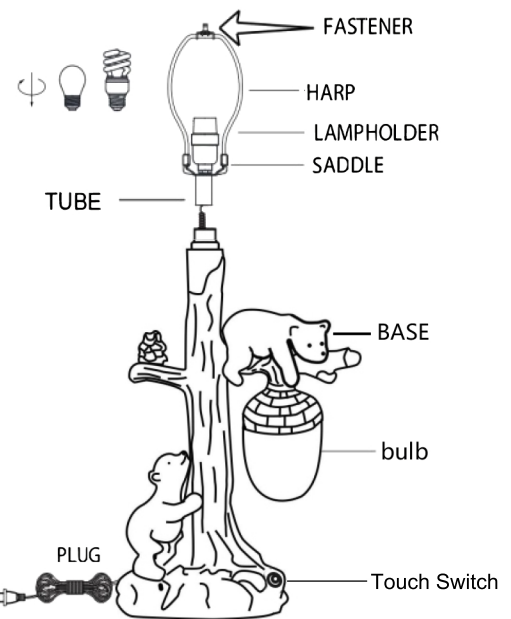
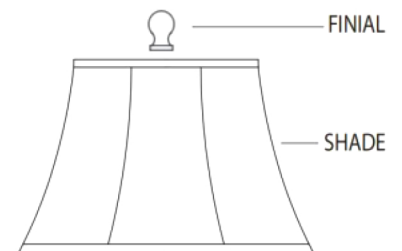
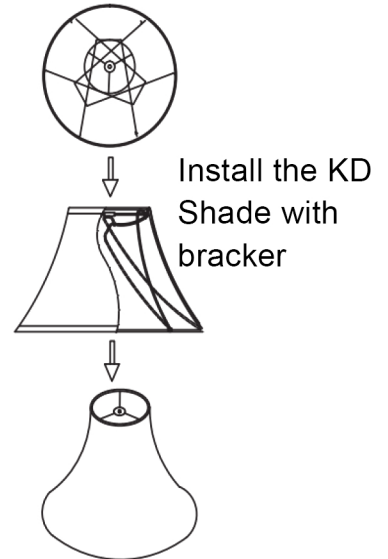

★ Keep this instruction for future reference.