

SQUARE END TABLE

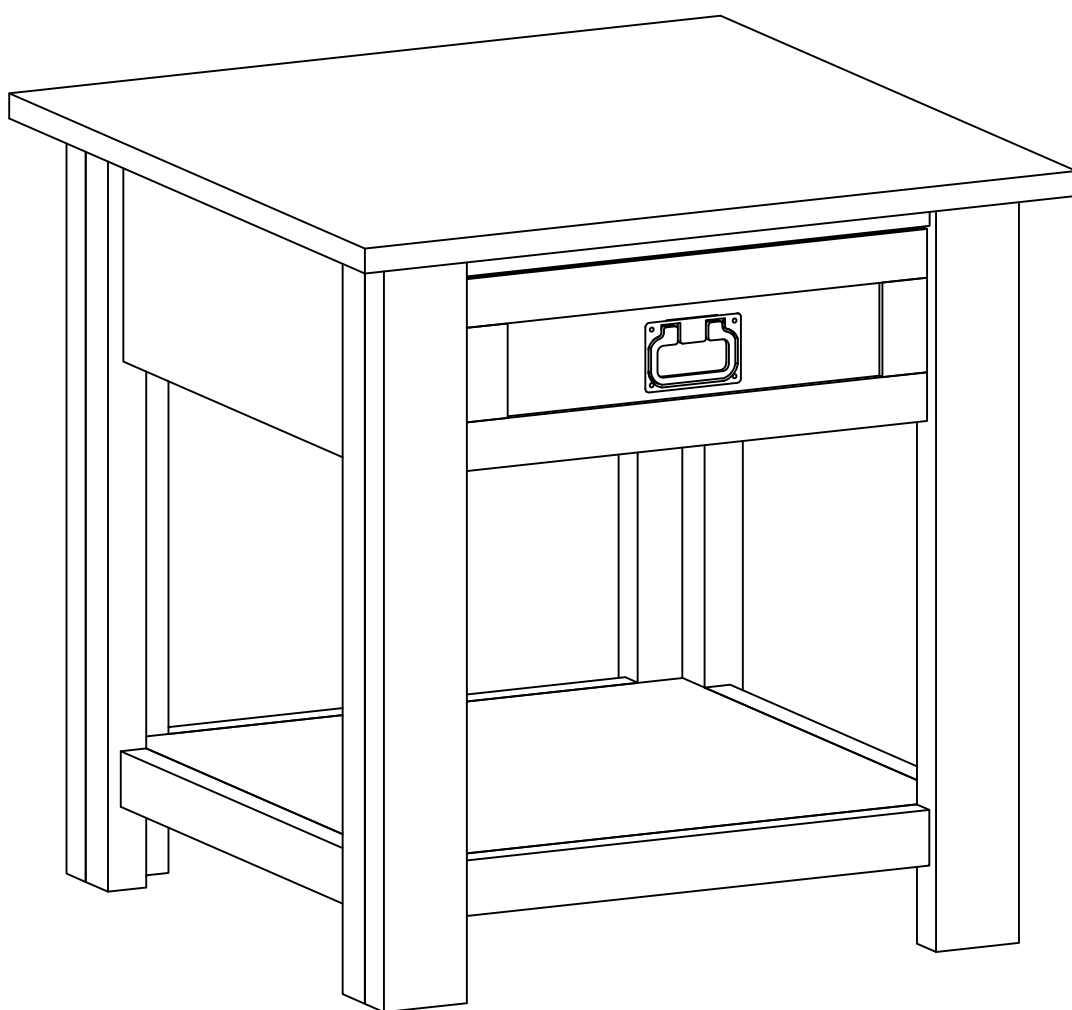

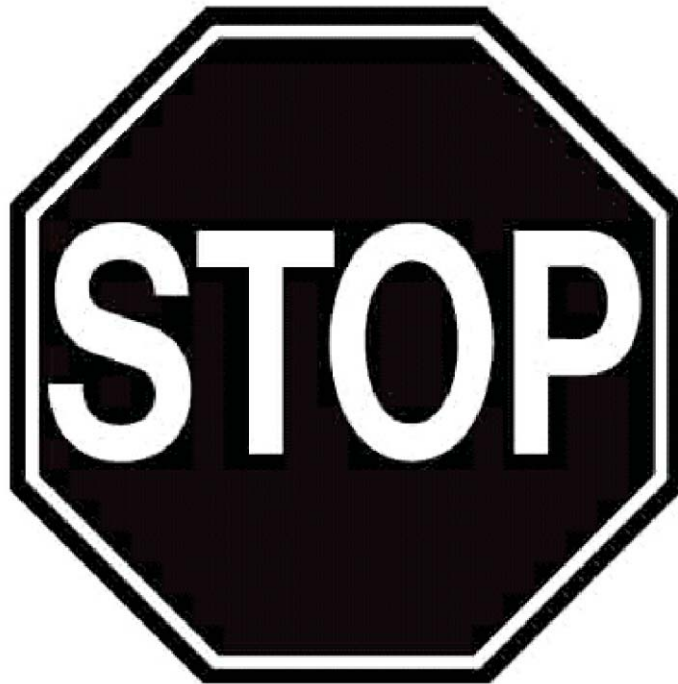

DO NOT RETURN

**FOR REPLACEMENT PARTS OR OTHER INQUIRIES
PLEASE CONTACT US**

**PLEASE ENSURE TO HAVE THE MODEL #
FROM THE PACKAGING OR
INSTRUCTION BOOKLET**

IMPORTANT : Please read this manual carefully before beginning assembly of this product. Keep this manual for future reference.

SAFETY INFORMATION

Identify all the parts and hardware. Do not discard of the packaging until you have checked that you have all of the parts and hardware required.
Hardware package may have spare parts.

WARNING: This item contains small parts which can be swallowed by children and pets. Keep children and pets away during assembly. To avoid danger of suffocation, always keep plastic bags away from children and pets. We recommend that you assemble this unit on a carpeted floor to avoid scratches. If using power tools, set the tool to low torque to avoid damage.

May require 2 people for ease of assembly.

CARE and MAINTENANCE

To clean, use a soft or slightly damp cloth, then wipe with a clean, dry cloth.
Dust with soft dry cloth.
Do not use ammonia-based cleaning products, as they will damage the finish.
Do not leave liquids or damp cloths on this furniture.
To avoid dulling of the finish, do not place furniture in direct sunlight.
Please inspect and tighten all screws or bolts on a regular basis to ensure proper performance and safety of your item.

PRE-ASSEMBLY INFORMATION

PART DESCRIPTION

A

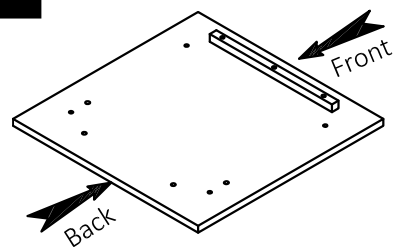

TOP
QTY 1

B

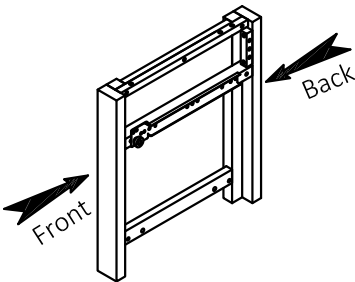

SIDE
QTY 1 PAIR

C

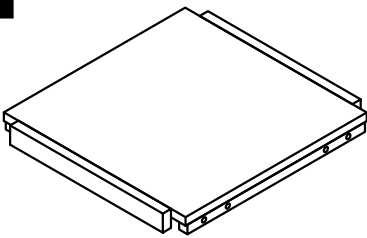

BOTTOM SHELF
QTY 1

D

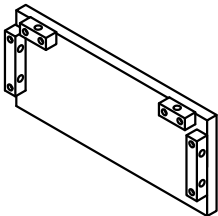

BACK PANEL
QTY 1

E

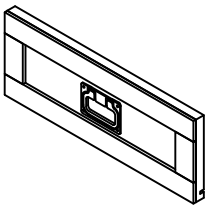

DRAWER FRONT
QTY 1

F

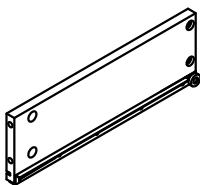

DRAWER SIDE
QTY 1 PAIR

G

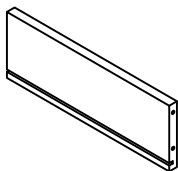

DRAWER BACK
QTY1

H

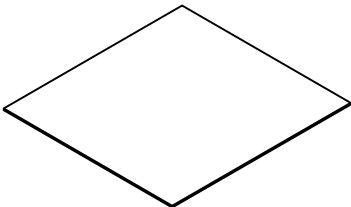

DRAWER BOTTOM
QTY 1

NEED HELP? For help with assembly or if you are missing a part,
Please call customer service

PRE-ASSEMBLY INFORMATION

HARDWARE DESCRIPTION

1

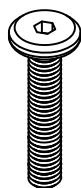

ALLEN KEY BOLT
M6 X 30mm
QTY 14

2

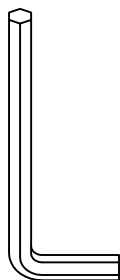

ALLEN KEY
QTY 1

3



DOWEL
Ø8 X 25mm
QTY 8

4

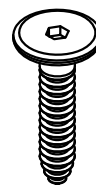

ALLEN KEY SCREW
M6 X 30mm
QTY 4

5

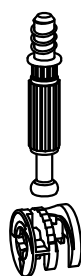

CAM LOCK PIN
CAM LOCK
QTY 4 SETS

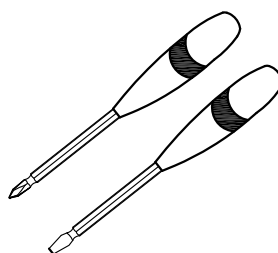

Required -
Flathead screwdriver
Phillips screwdriver
Not Included

NEED HELP? For help with assembly or if you are missing a part,
Please call customer service

COMPONENTS-KEY DIAGRAM

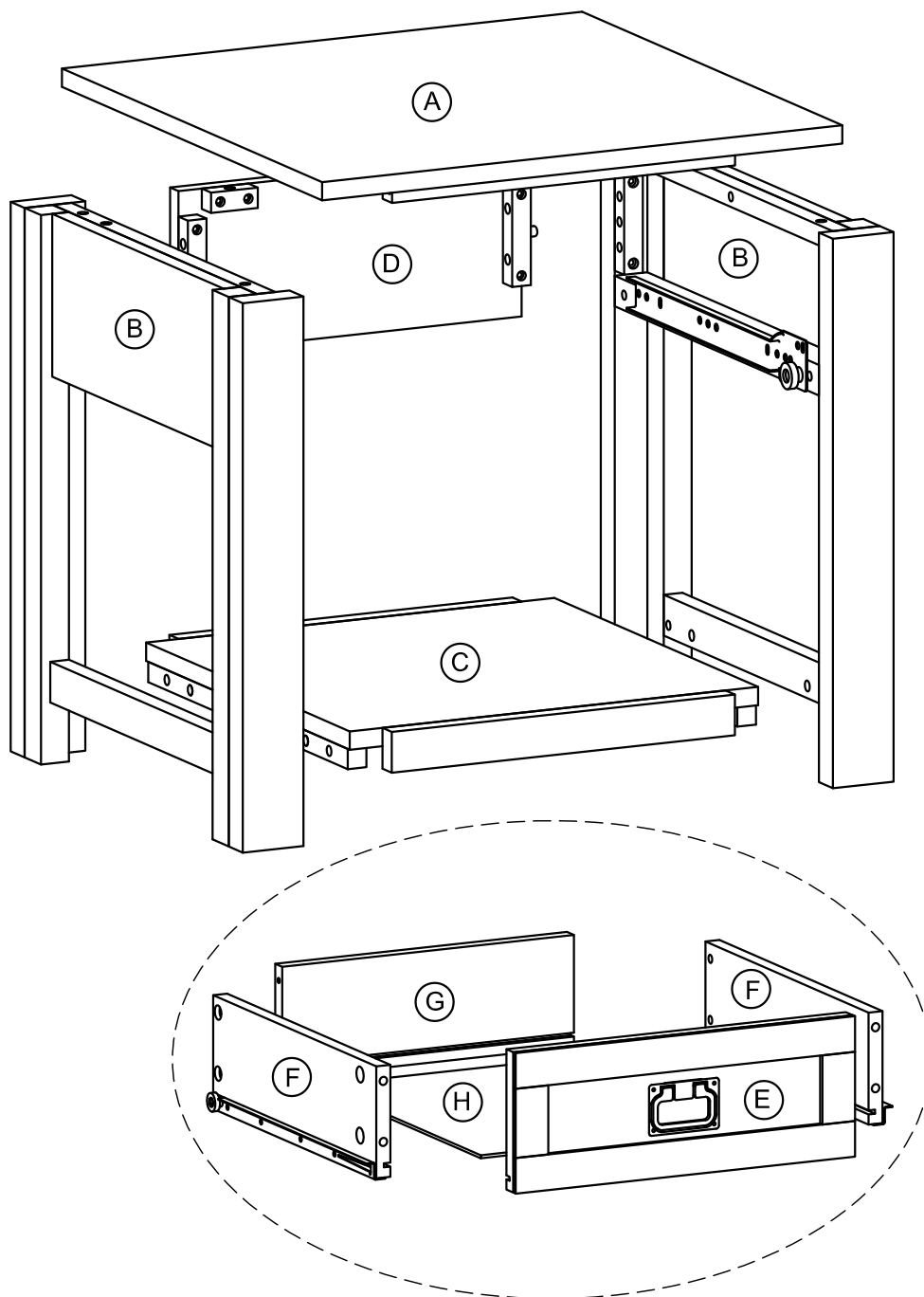

ASSEMBLY

STEP-1

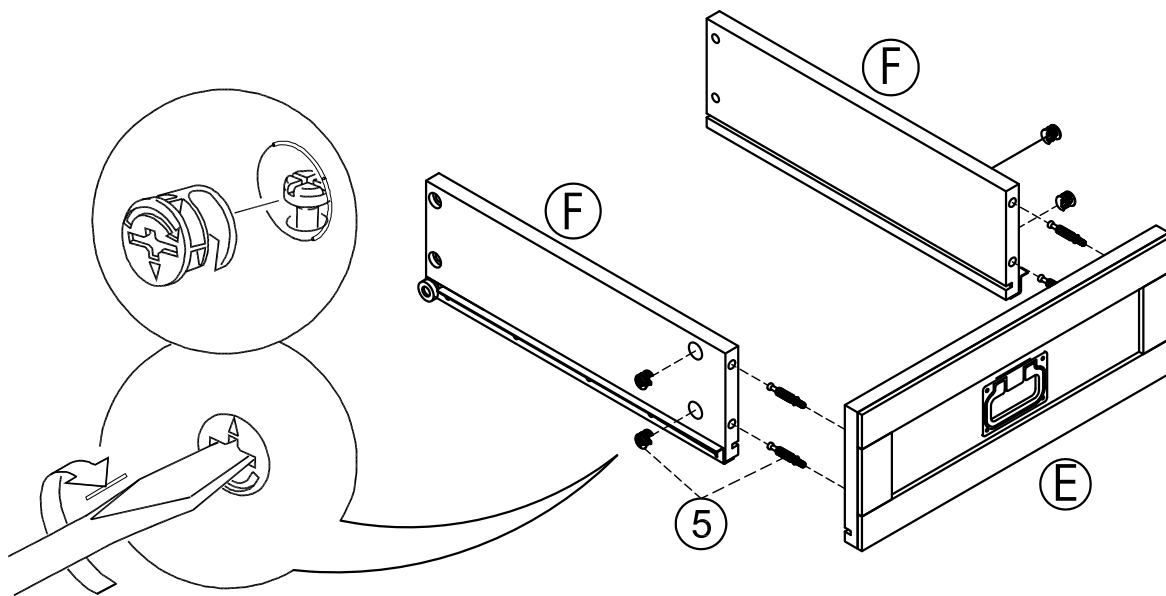

1. Attach 4 Cam Lock Pins (5) to pre-drilled holes at back of Drawer Front (E).
2. Align Cam Lock Pins with pre-drilled holes and attach Drawer Side (F).
3. Insert 2 Cam Locks (5) into pre-drilled holes on each Drawer Side (F).
4. Use flathead screwdriver secure Cam Locks.

STEP-2

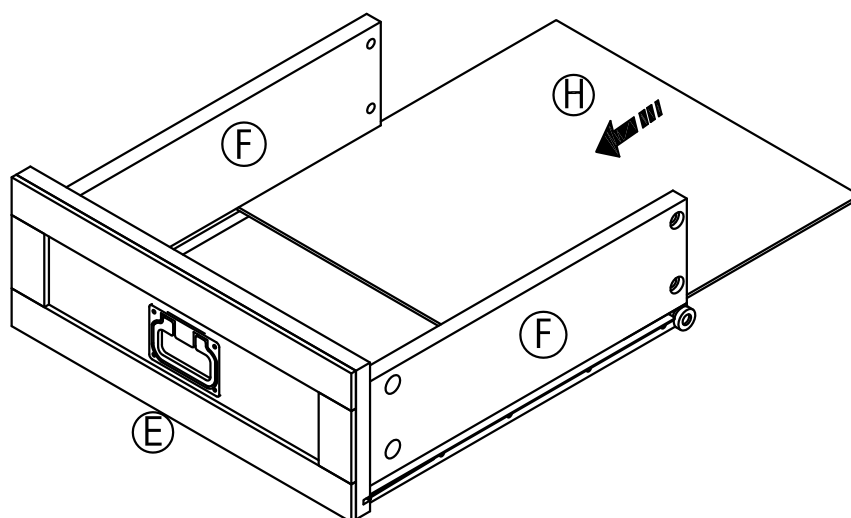

1. Slide Drawer Bottom (H) firmly into slots on Drawer Sides (F) and Drawer Front (E).

ASSEMBLY

STEP-3

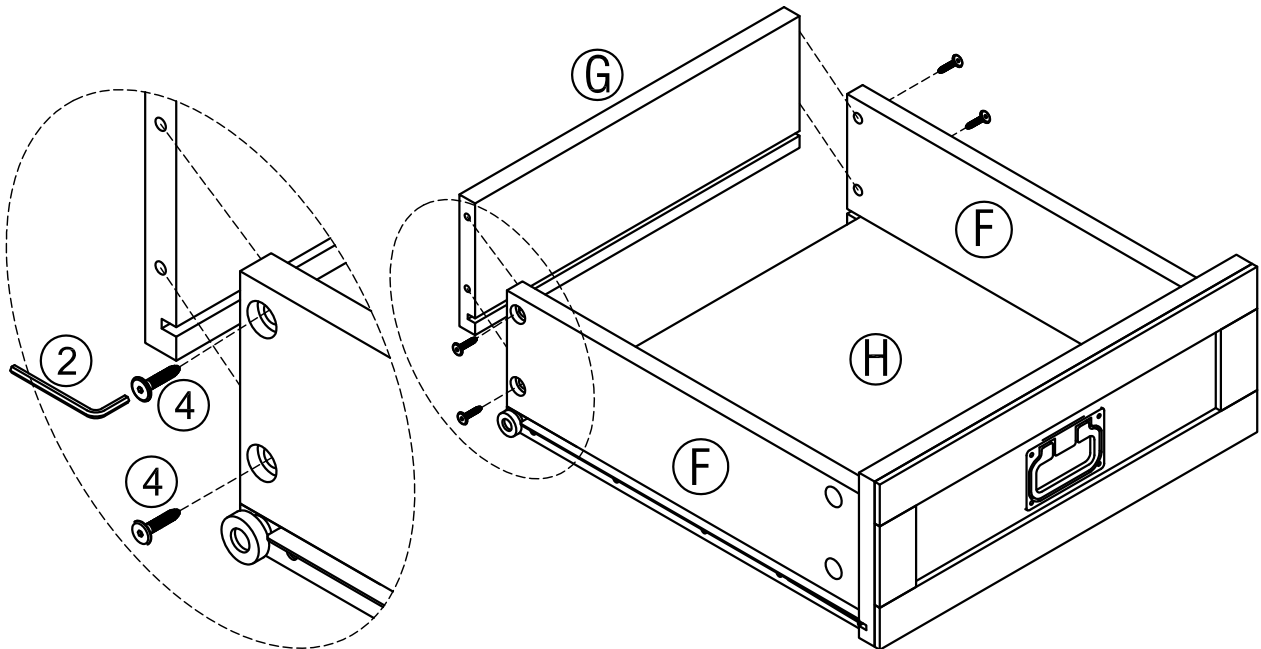

1. Align Drawer Back (G) with Drawer Bottom (H) and press firmly into slot.
2. Attach Drawer Back (G) using 2 Allen Key Screws (4) through pre-drilled holes on each Side (F).
3. Use Allen Key (2) to tighten screws. Do not over-tighten.

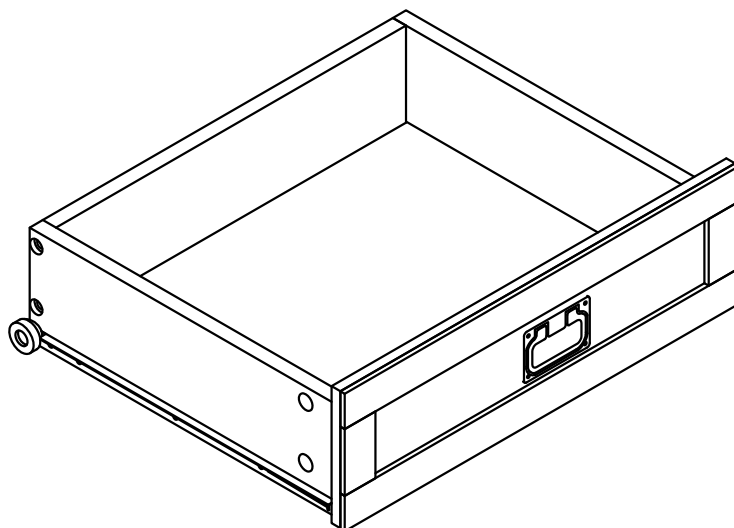

STEP-4

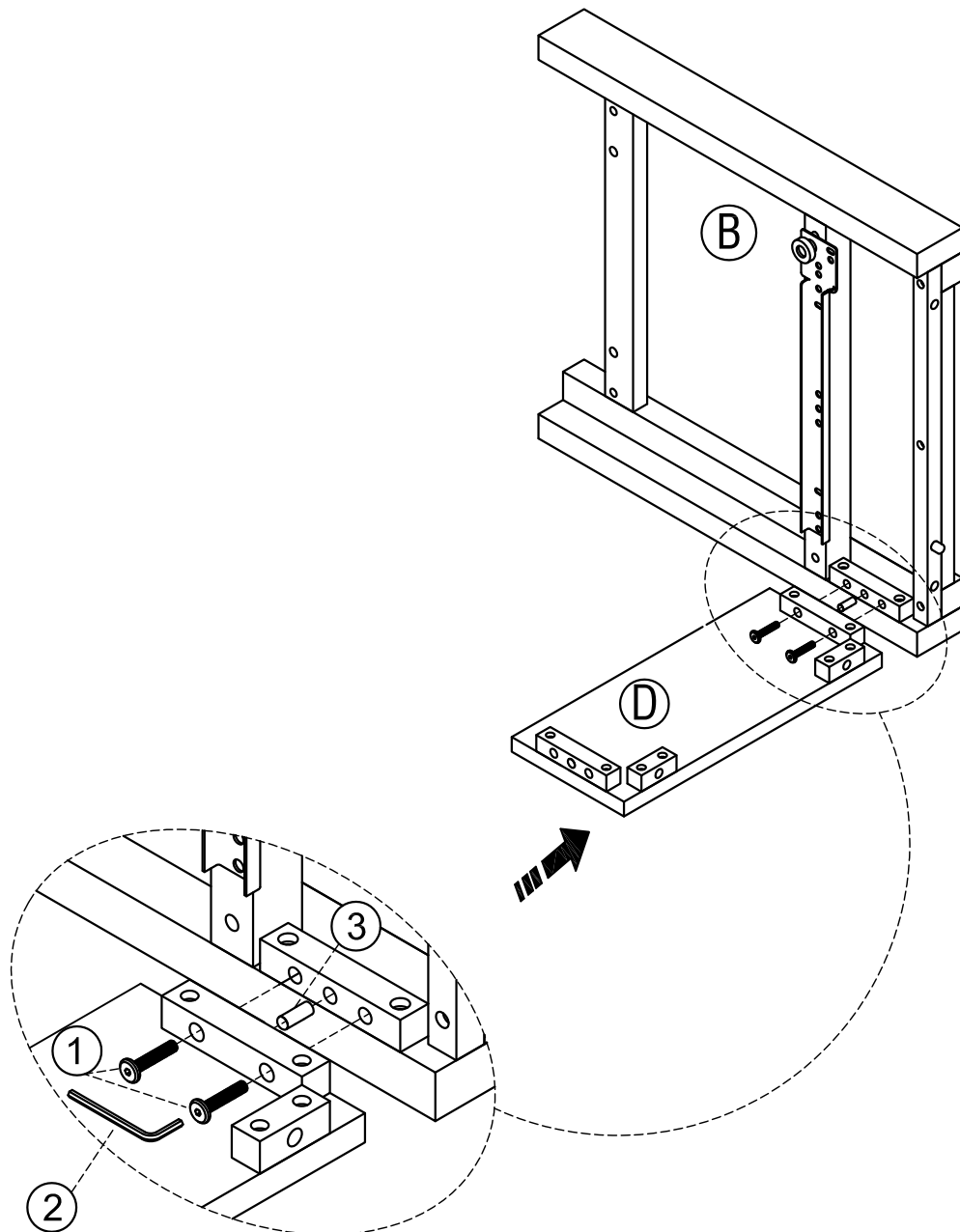

1. Insert Dowel (3) into pre-drilled holes on Back Panel (D).
2. Use rubber mallet to tap Dowels (3) into bottom of holes securely. ½ length of Dowels should be exposed.
3. Attach Back Panel (D) to Side (B) using 2 Allen Key Bolts (1).
4. Use Allen Key (2) to tighten. Do not over-tighten.

STEP-5

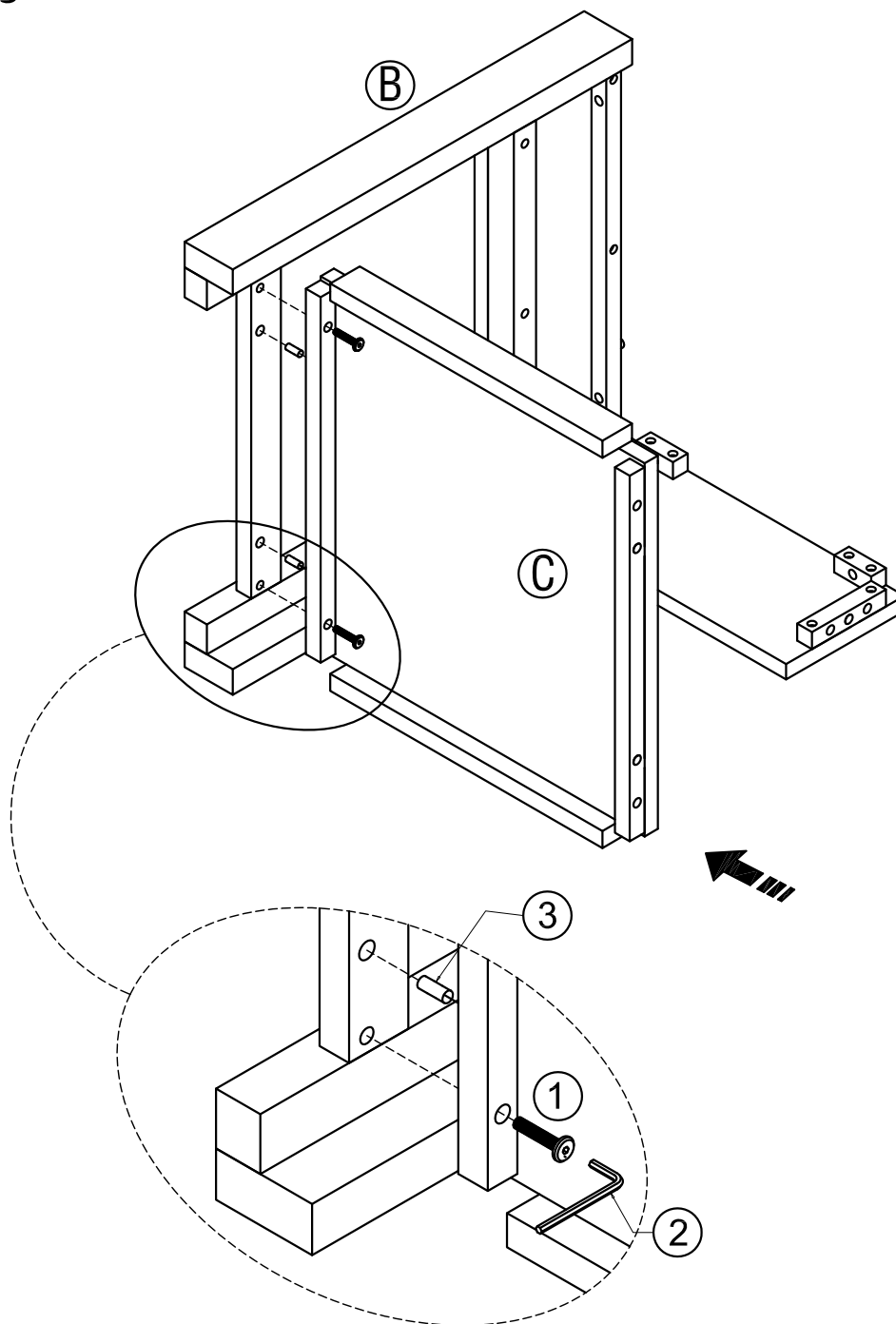

1. Insert 2 Dowel (3) into pre-drilled holes on each side Bottom Shelf (C).
2. Use rubber mallet to tap Dowels (3) into bottom of holes securely. $\frac{1}{2}$ length of Dowels should be exposed.
3. Attach Bottom Shelf (C) to Side (B) using 2 Allen Key Bolts (1).
4. Use Allen Key (2) to tighten. Do not over-tighten.

ASSEMBLY

STEP-6

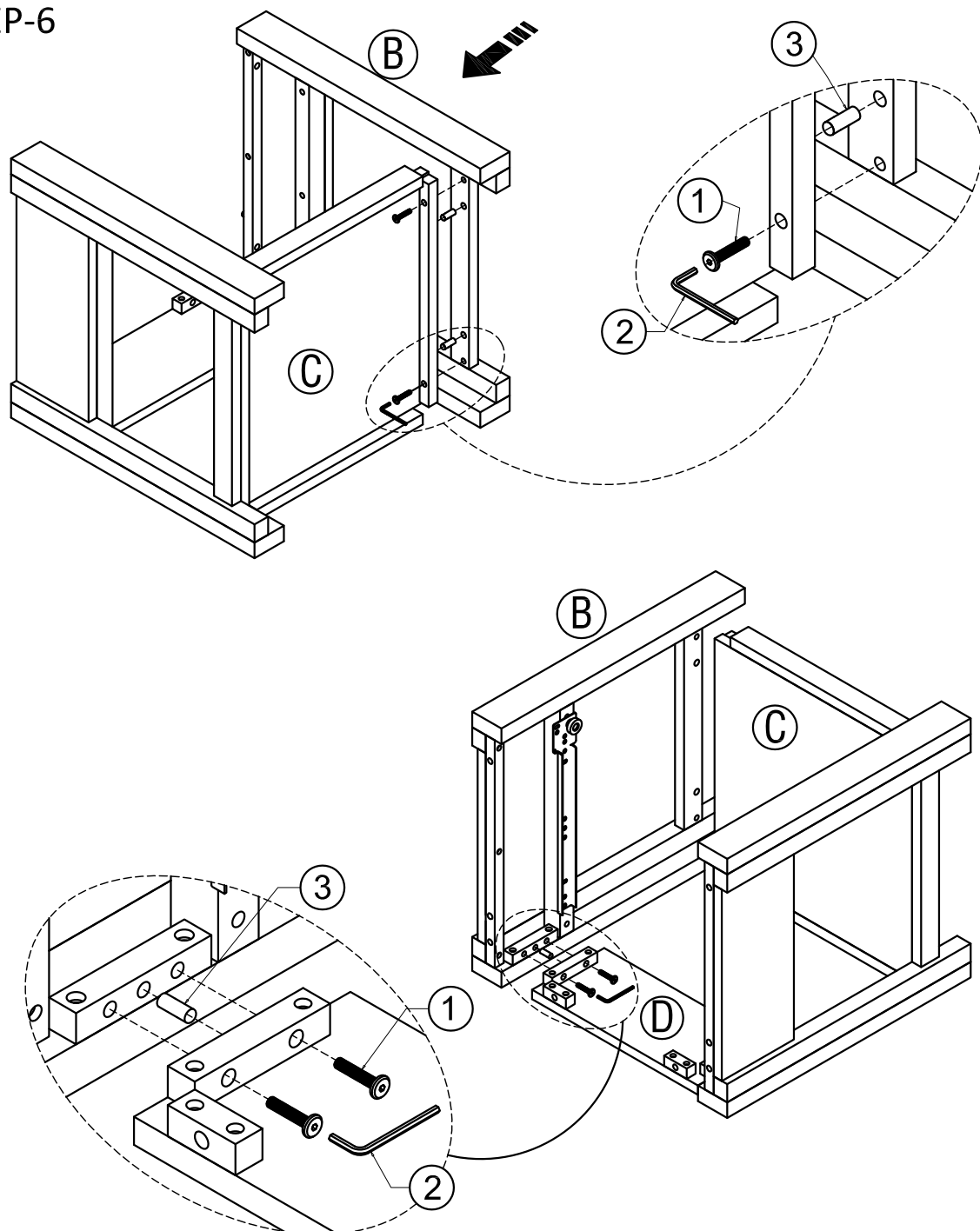

1. Repeat Step-4 and Step-5 for the opposite Side (B).

STEP-7

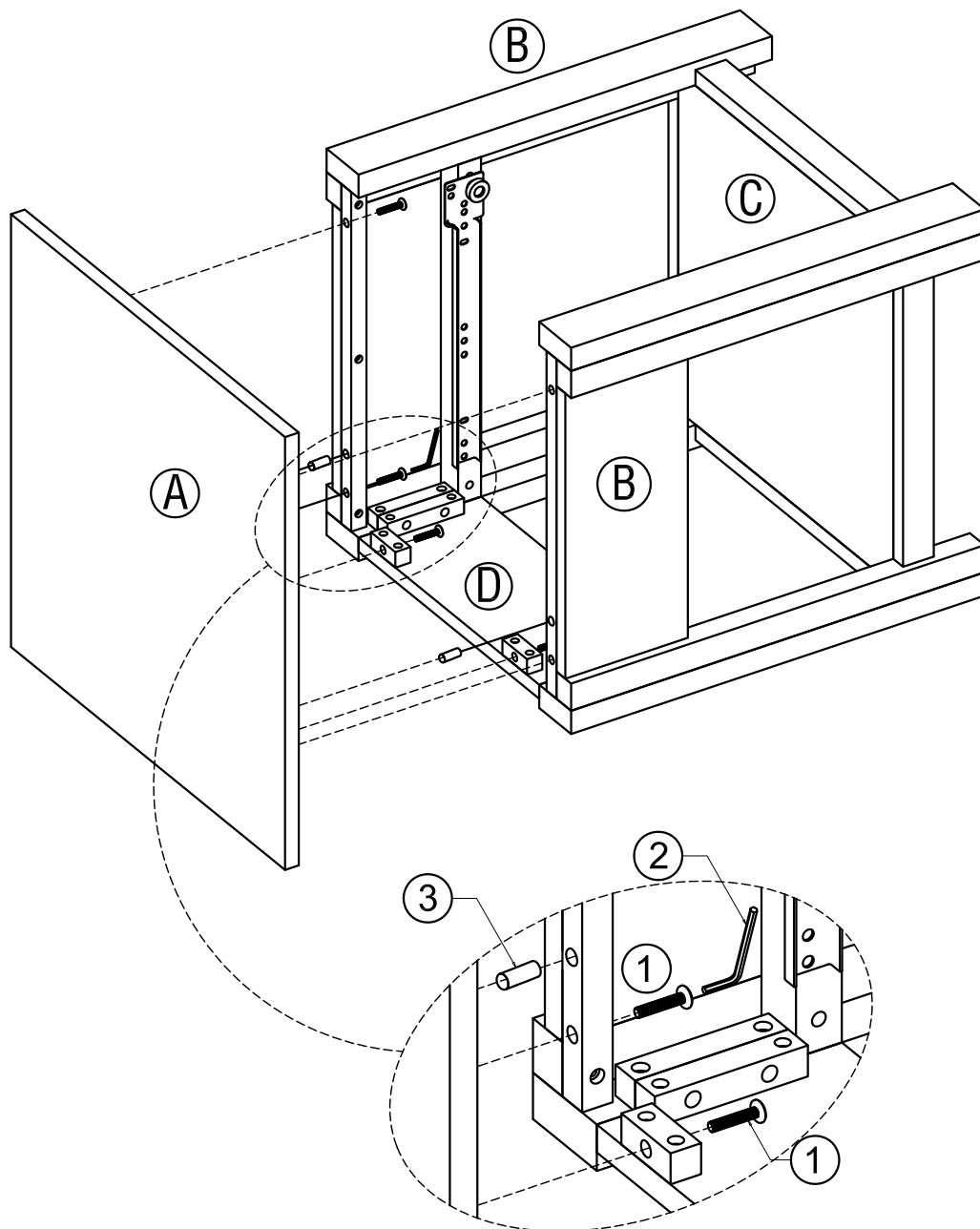

1. Insert Dowel (3) into pre-drilled holes on each Side (B).
2. Use rubber mallet to tap Dowels (3) into bottom of holes securely. ½ length of Dowels should be exposed.
3. Attach Top (A) to Sides (B) using 4 Allen Key Bolts (1) (2 Bolts on each Side).
4. Attach Top (A) to Back Panel (D) using 2 Allen Key Bolts (1).
5. Use Allen Key (2) to tighten. Do not over-tighten.

STEP-8

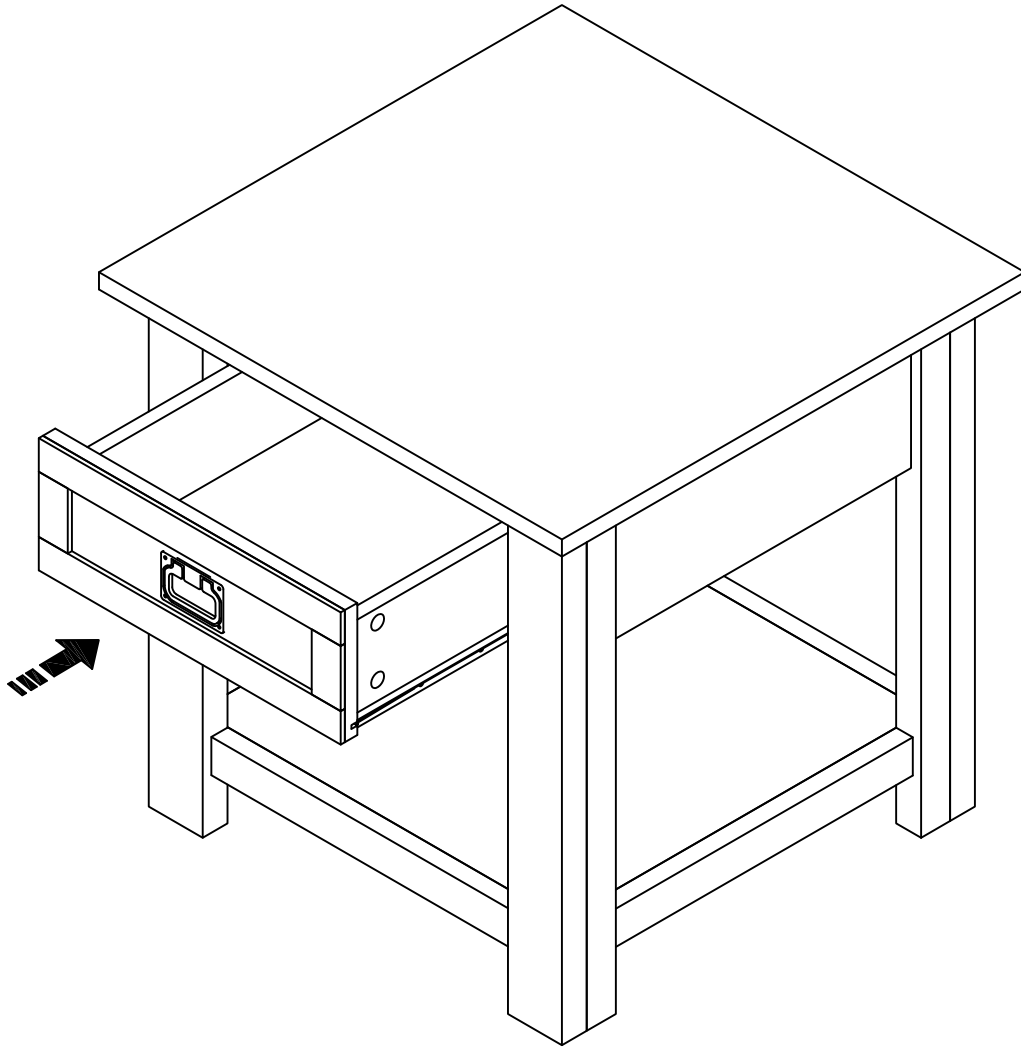

1. Insert assembled drawer into glides on assembled end table.

WARRANTY

Thank you for purchasing a product. These products have been made to demanding, high-quality standards and are guaranteed for domestic use against manufacturing faults for a period of 12 months from the date of purchase. This warranty does not affect your statutory rights.

In case of any malfunction of your product (failure, missing parts, etc.) please contact us at our toll free service line or by email.

We reserve the right to repair or replace the defective product, at its discretion.

This product is guaranteed for 12 months if used for normal purposes. Any warranty is invalid if the product has been overloaded or subject to neglect, improper use or an attempted repair by other than an authorized agent. Heavy-duty or daily professional/commercial usage are not guaranteed.

Due to continuous product improvement, we reserve the right to change the product specifications without prior notice.

PLEASE NOTE: This item is hand-crafted and hand-finished with utmost care. As such, variations and imperfections should be expected and should be welcomed as the natural beauty of the wood.