

PLEASE NOTE: Check that you have received all components and hardware before assembling.

Assembly Instructions

Flat High Back Office Chair



IMPORTANT NOTE #1: Parts I are screwed into the underside of part B. Remove screws and washers from frame and then use to attach to part D as shown in Step 1.

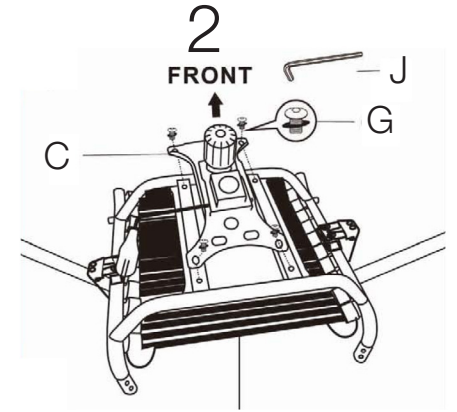
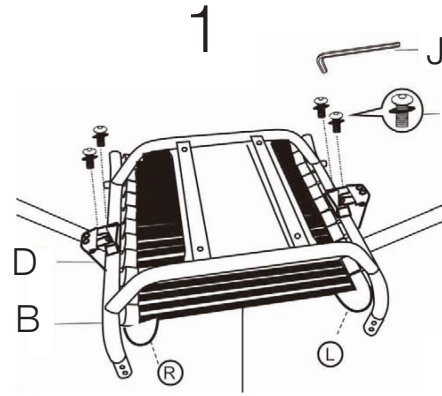

IMPORTANT NOTE #2: Parts G are screwed into the underside of part B. Remove screws and washers from frame and then use to attach to part C as shown in Step 2.

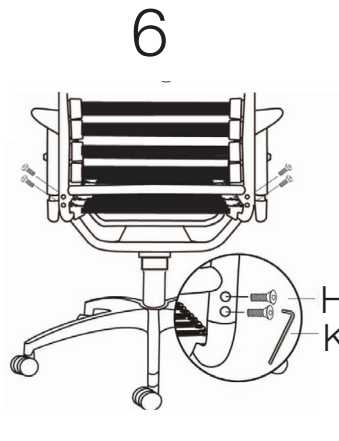
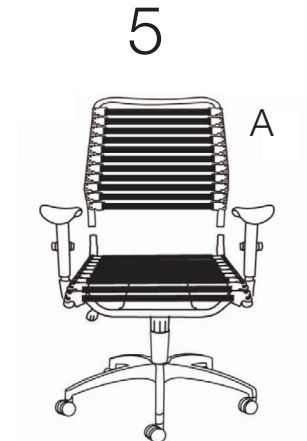
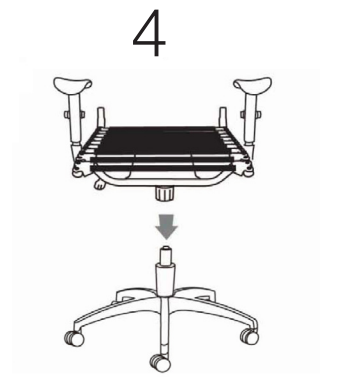
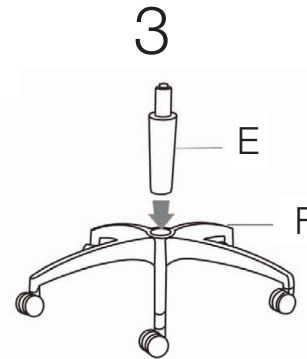

A (1 pc)



B (1 pc)



C (1 pc)

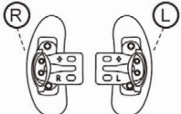

D (2 pcs)



E (1 pc)

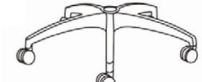

F (1 pc)



G (4 pcs)
M8 x 14mm



H (4 pcs)
1/4" x 5/8"



I (4 pcs)
M8 x 16mm



J (1 pc)
5mm



K (1 pc)
4mm

During assembly, hand tighten screws only. When the screws are in place, tighten completely.