

STEP 1

Get the front legs and back legs out of the upholstered frame as shown.

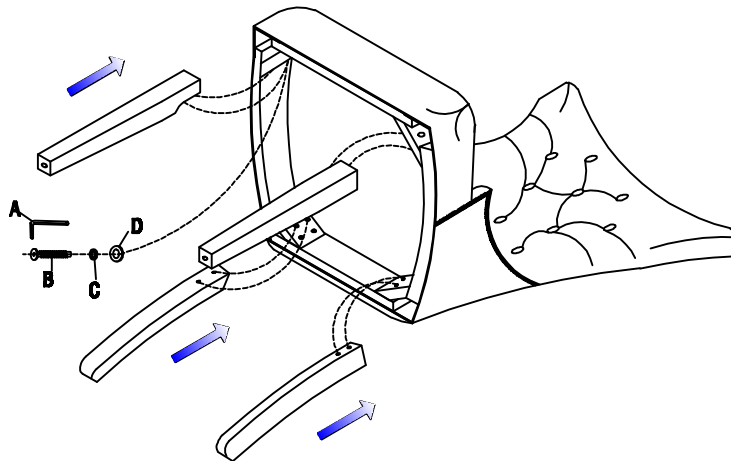

STEP 2

Attach the front legs and back legs into the upholstered frame. Secure them by using the allen wrench (A), allen bolt (B), spring washer (C) and flat washer (D).

ASSEMBLY INSTRUCTIONS

HARDWARE LIST

NO	DRAWING	DESCRIPTION	QTY
A		Allen Wrench	01
B		Allen Bolt	08
C		Spring washer	08
D		Flat washer	08

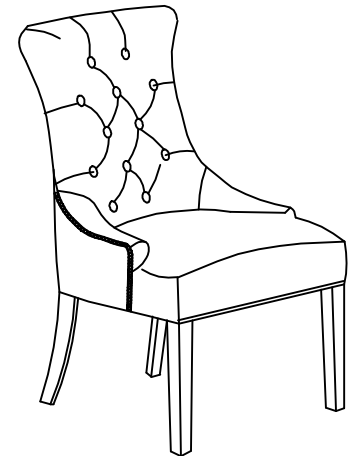

Assembly is completed