

Assembly Instructions



ASSEMBLY RATING

The Assembly Rating is a 5-point system that shows the degree of effort needed in assembling a specific product (with 1 being easy and 5 being difficult). For some products, two persons are recommended.

EASY  DIFFICULT

Tools Required for Assembly:

Allen Wrench



(Included)

Wrench

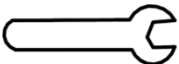

(Included)



2 PERSONS RECOMMENDED

ASSEMBLY & CARE ADVICE

FOR YOUR FURNITURE TO LAST, CORRECT ASSEMBLY AND PROPER MAINTENANCE ARE NECESSARY.
PLEASE FOLLOW THE INFORMATION PROVIDED BELOW TO FULLY ENJOY YOUR FURNITURE.

BASIC ASSEMBLY TECHNIQUES

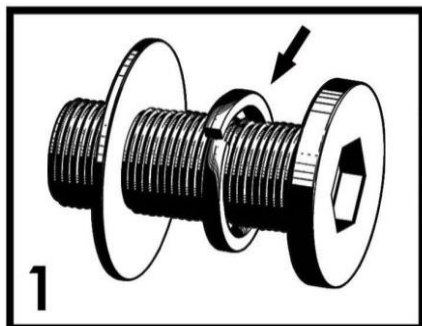

When lock or spring washer is used in an assembly, please make sure the lock or spring washer is placed between the larger flat washer and the head of the screw or bolt.

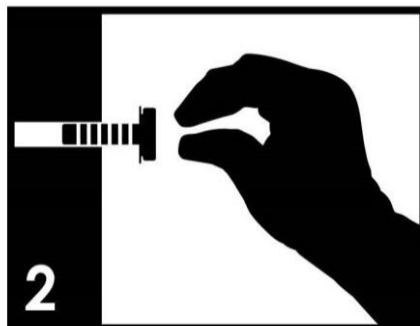

Position each part correctly and insert screws or bolts into their respective holes by hand tighten or using the proper hand tool. Only tighten when step is completed or when instructed to do so.

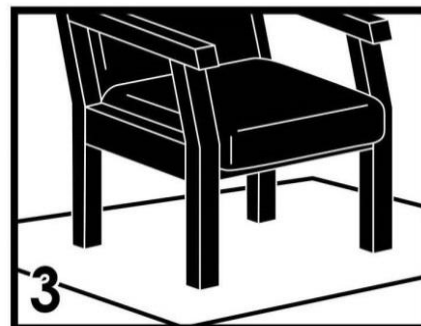

Use cardboard or carpet area when assembling furniture to prevent scratches. Make sure the furniture rests on a flat and level surface with each leg evenly touching the floor.

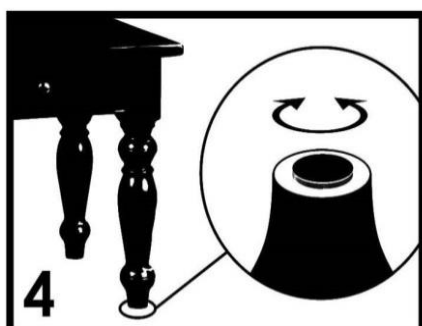

Some furniture comes with height adjustment knobs underneath each leg. To lower or to raise each leg, you need to turn clockwise or counterclockwise, respectively.

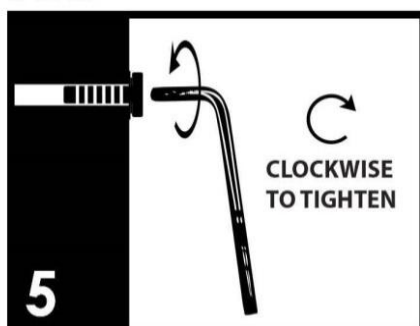

Make sure all parts are properly aligned, then use the appropriate hand tool to completely tighten the bolts or screws. Do not use power tools and do not overtighten.

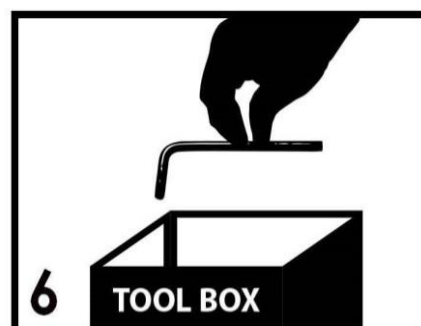

Save the instructions and store the Allen wrench or any supplied tool for later maintenance. After two weeks, check and tighten any loose hardware and repeat again every six months thereafter.

IT IS THE USER'S RESPONSIBILITY TO MAINTAIN THE FURNITURE. THE HARDWARE MAY LOOSEN OVER TIME AND MAY CAUSE THE FURNITURE TO BE WOBBLY AND UNABLE TO SUPPORT ITS INTENDED WEIGHT CAPACITY. THIS MAY LEAD TO COLLAPSE AND MAY CAUSE SERIOUS INJURY.



FAILURE TO FOLLOW THE GUIDELINES ABOVE MAY
RESULT IN INJURY AND/OR PROPERTY DAMAGE.

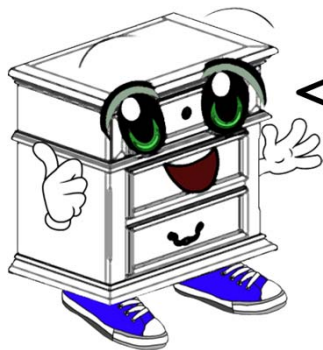

Before you begin, please read Page 2 of "Assembly and Care Advice".

And remember, do not tighten until each step is completed or instructed.

MD

Parts List



#1 x 1 pc
Seat



#2 x 1 pc
Backrest



#3 x 1pc
Left Bench End



#4 x 1 pc
Right Bench End



Hardware List

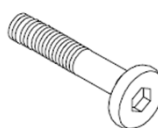

#A x 4 pcs
Bolt 1/4"x2-3/4"



#B x 4 pcs
Bolt 1/4"x1-3/8"



#C x 4 pcs
Hex Nut



#D x 8 pcs
Flat Washer



#E x 4 pcs
Cap Nut



#F x 1 pc
Allen Wrench

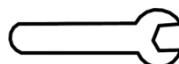

#G x 1 pc
Wrench



Due to the size and/or weight of this product, it is highly recommended that the assembly should be done near the area of its intended location. Make sure you have enough space to move around during the assembly. ALWAYS have at least two people to help with transporting and assembling the product to avoid any potential injury and/or damage.



- I. Align the seat (#1) with the left bench end (#3) and the right bench end (#4).
- II. Insert 4 flat washers (#D) onto 4 bolts (#B). Then insert those bolts through the bench ends (#3 & #4) using the Allen wrench (#F) lock them with the seat (#1).

#B x 4 pcs
#D x 4 pcs

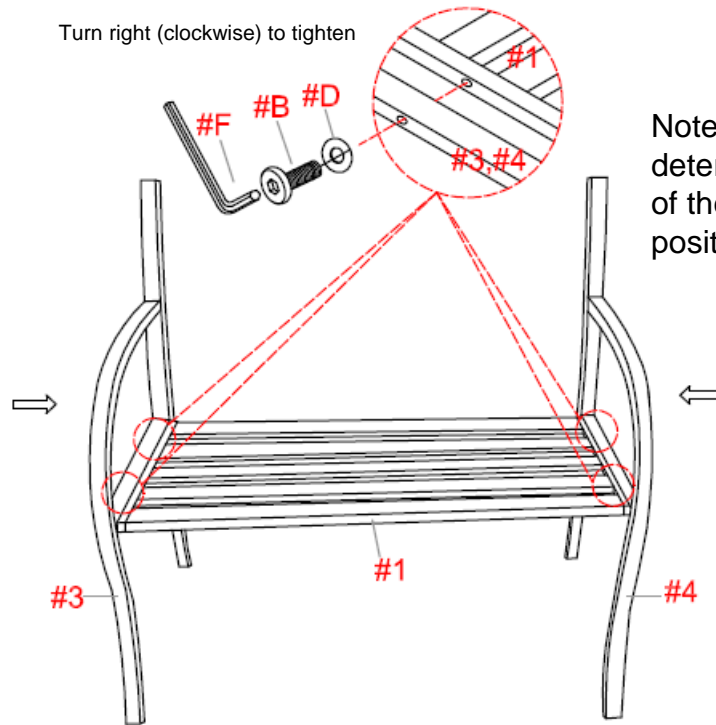

#A x 4 pcs
#C x 4 pcs
#D x 4 pcs
#E x 4 pcs

- I. With the help of another person, align the backrest (#2) with the pre-drilled holes on the left bench end (#3) and the right bench end (#4).
- II. Insert 4 bolts (#A) through the bench ends using the Allen wrench (#F) until at least 3/4" of the threads are shown through the other side of the backrest (#2). Insert 4 flat washers (#D) onto the bolts (#A) and tighten with 4 hex nuts (#C) using the wrench (#G). It is best if one is stabilizing the hex nut (#C) with the wrench (#G) while the other is tightening the bolt (#A) with the Allen wrench (#F).
- III. Place 4 cap nuts (#E) over the bolts (#A) and the hex nuts (#C).

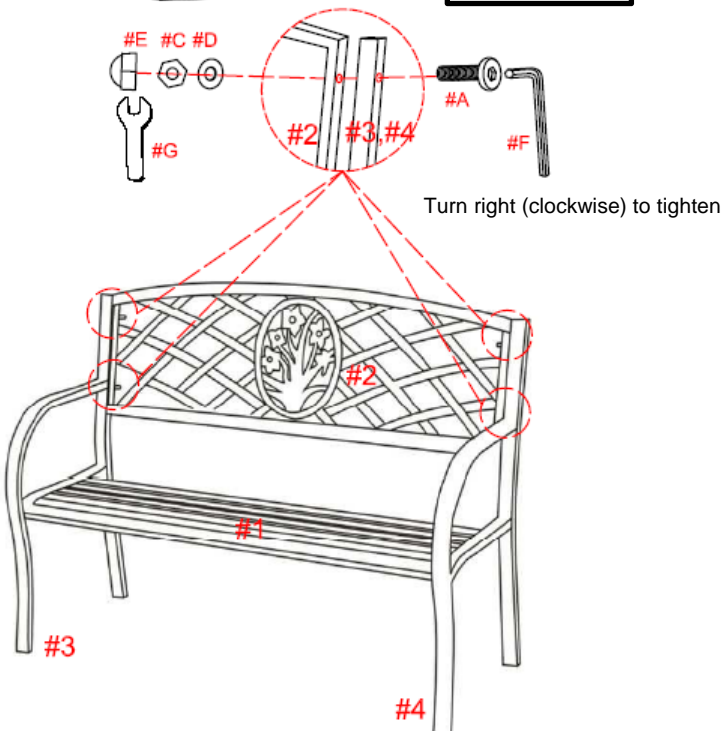

ASSEMBLY IS COMPLETED