

Assembly Instruction Sheet for Model HL620255

Package Contents

Part	Description	Quantity
A	Lamp Body	1 pc.
B	Lamp Shade	1 pc.

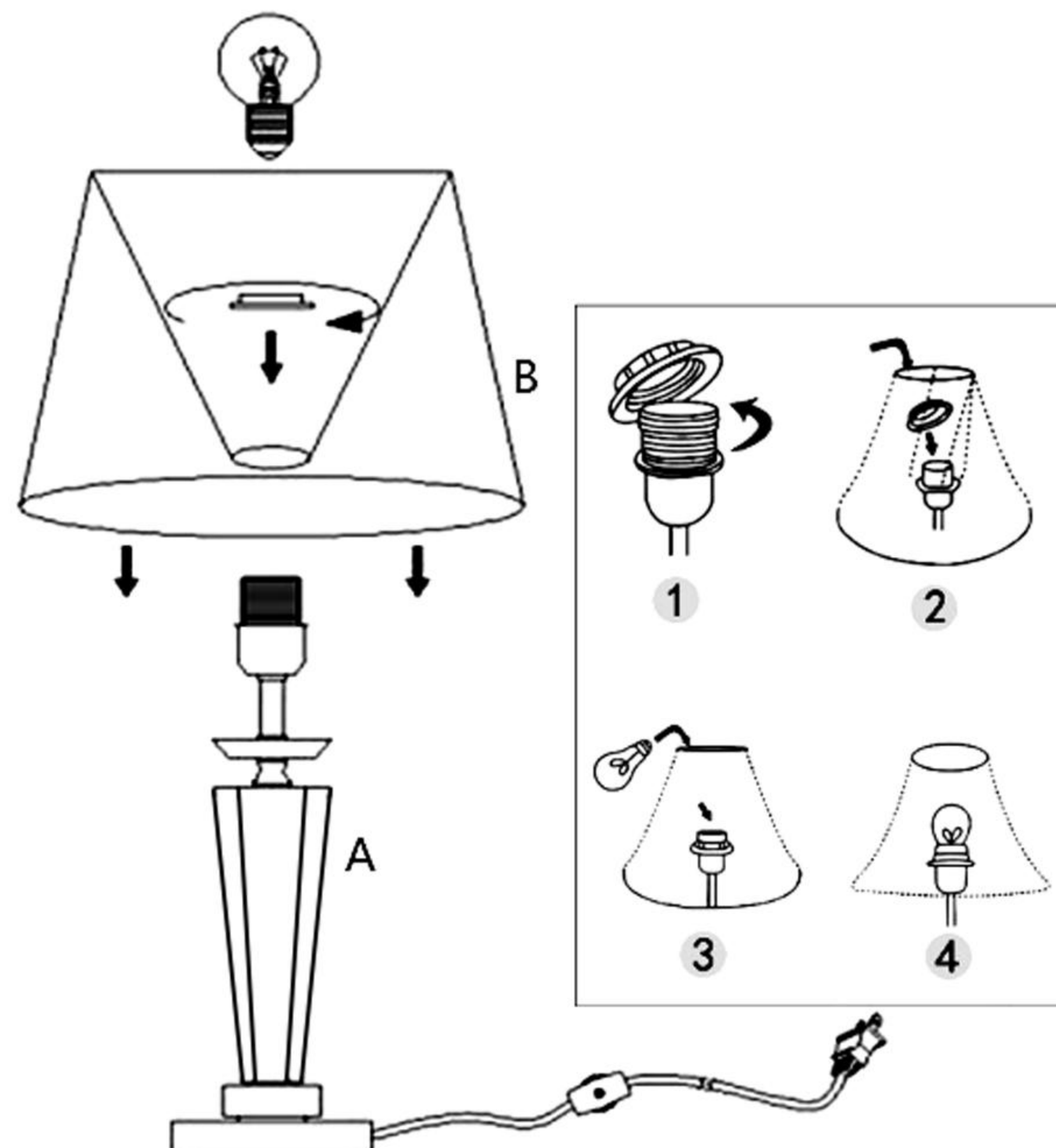

STEP 1

Unpack the package, take out the Lamp Body(A), and place the Lamp Body(A) on the table.

STEP 2

Unscrew the ring on the lamp head of the Lamp Body(A).

Place the Lamp Shade(B) on the lamp head and screw the ring back in place.

STEP 3

Insert the bulb (Bulb not included) into the bulb base.

Plug in.

Your fixture is now assembled and ready to use.