

MIRROR CABINET

JG-W, JG-B, JG-L-W, JG-L-B INSTALLATION MANUAL

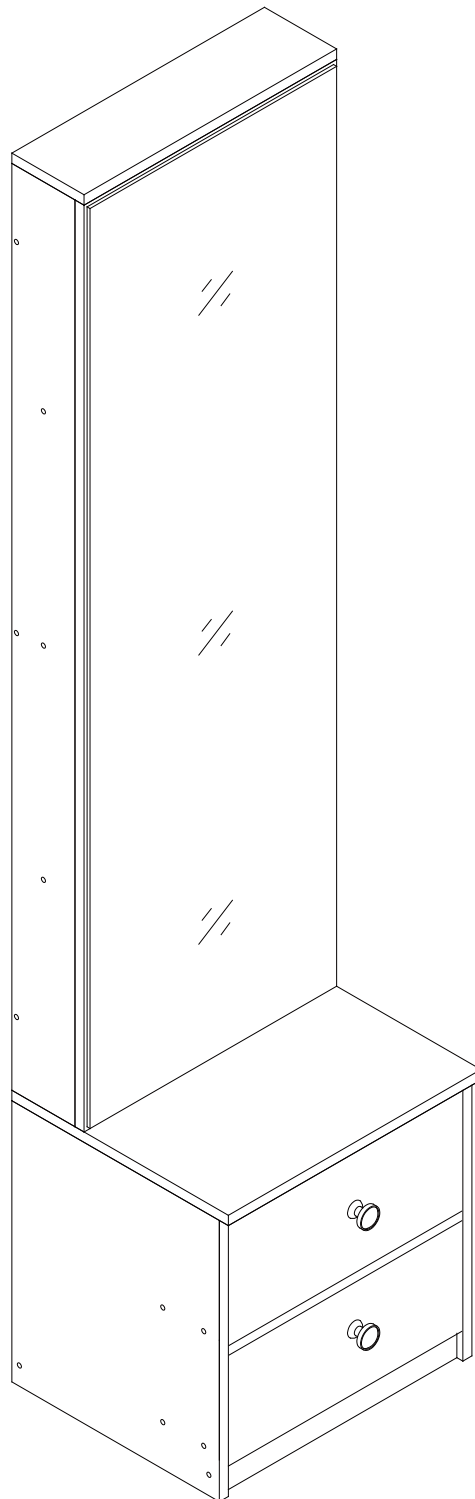



Please scan the code to obtain the installation
video before assembly

This is the unified installation manual for the JG mirror cabinet, suitable for simple version and luxury version.

Simple version: Without mirror light function.

Luxury version: With mirror light function.

Also note that:

1, Screw L is a drawer positioning pin that prevents the drawer from falling off when opened. After installation, please confirm that all positioning screws L have been installed.



2, For luxury version, part 34 has wiring hole, and part 40 has the mirror light; For simple version, part 34 does not have wiring hole, and part 40 does not have the mirror light.

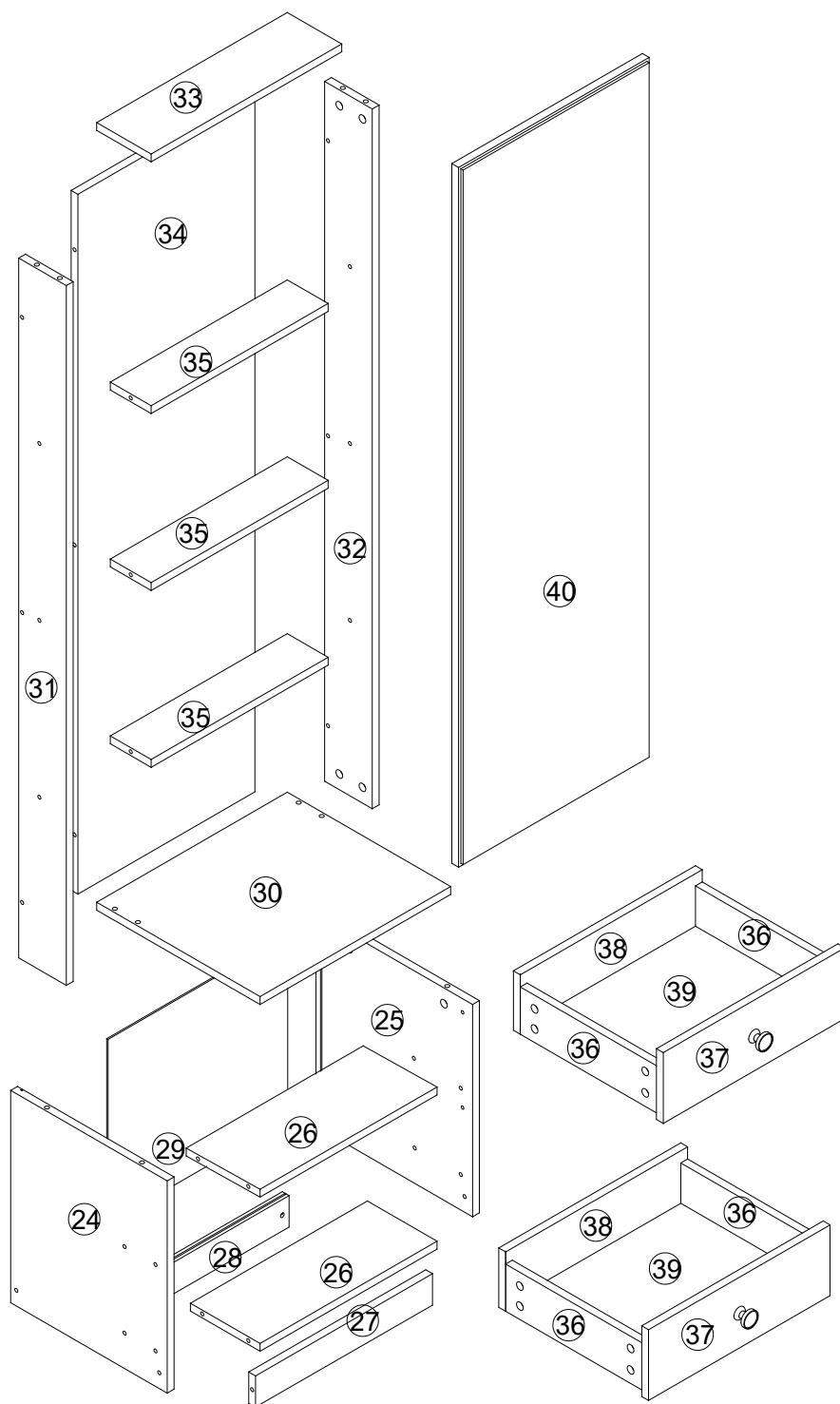

24 - x1	29 - x1	34 - x1	39 - x2
25 - x1	30 - x1	35 - x3	40 - x1
26 - x2	31 - x1	36 - x4	
27 - x1	32 - x1	37 - x2	
28 - x1	33 - x1	38 - x2	

Before installation, please use an erasable marker to write the corresponding numbers on each board according to the numbers in the figure below, and then arrange all boards according to the method shown in the figure.

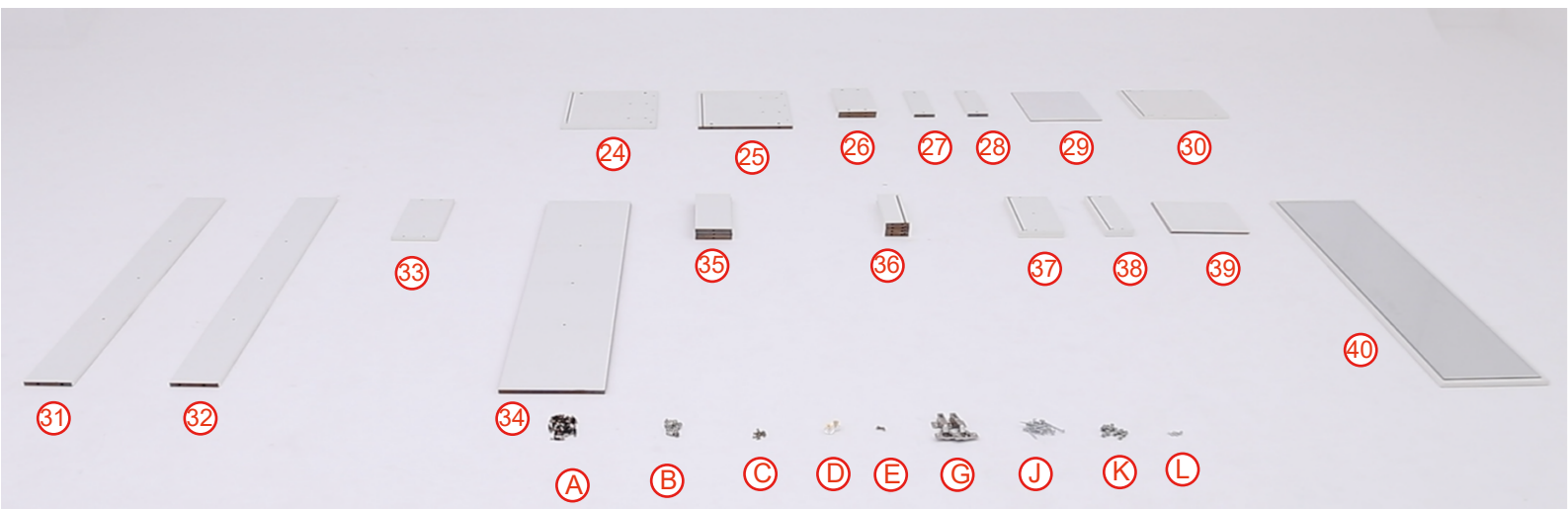



24 -x1



25 -x1



26 -x1



27 -x1



28 -x1



29 -x1b



30 -x1



31 -x1



32 -x1



33 -x1



34 -x1



35 -x3



36 -x4



37 -x2



38 -x2



39 -x2



40 -x4

HARDWARE



A	SCREW & METAL LOCK	x28
---	--------------------	-----



B	SCREW & METAL LOCK	x28
---	--------------------	-----



C	SCREW	x12
---	-------	-----



D	HANDLE	x2
---	--------	----



E	SCREW	x2
---	-------	----



G	HINGE	x2
---	-------	----



J	SCREW	x24
---	-------	-----



K	PLASTIC LOCK	x24
---	--------------	-----



L	SCREW	x4
---	-------	----

1. Screw installation method

When the screw is installed, please keep it in line with the board, and do not tighten it too tightly

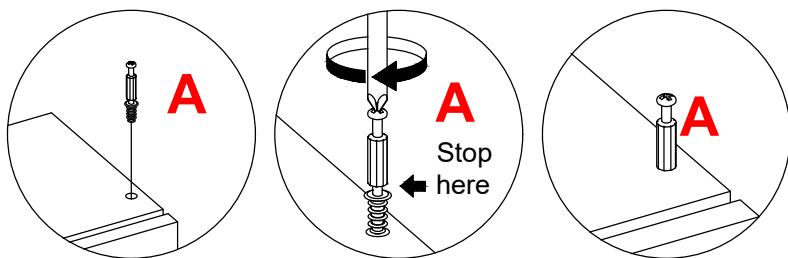

2. Check the Nut direction

This direction of the marked nut is consistent with the direction in which the screw is inserted

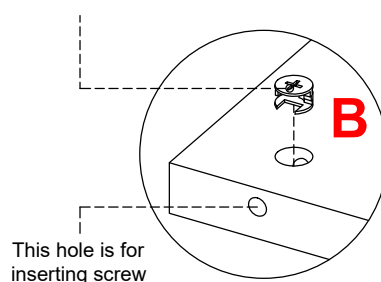

3. Installation on the board with fixing screws

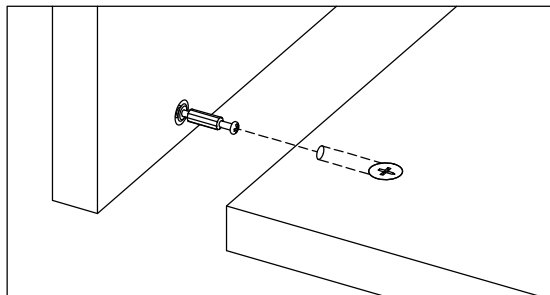

3. Rotate slowly until it stops

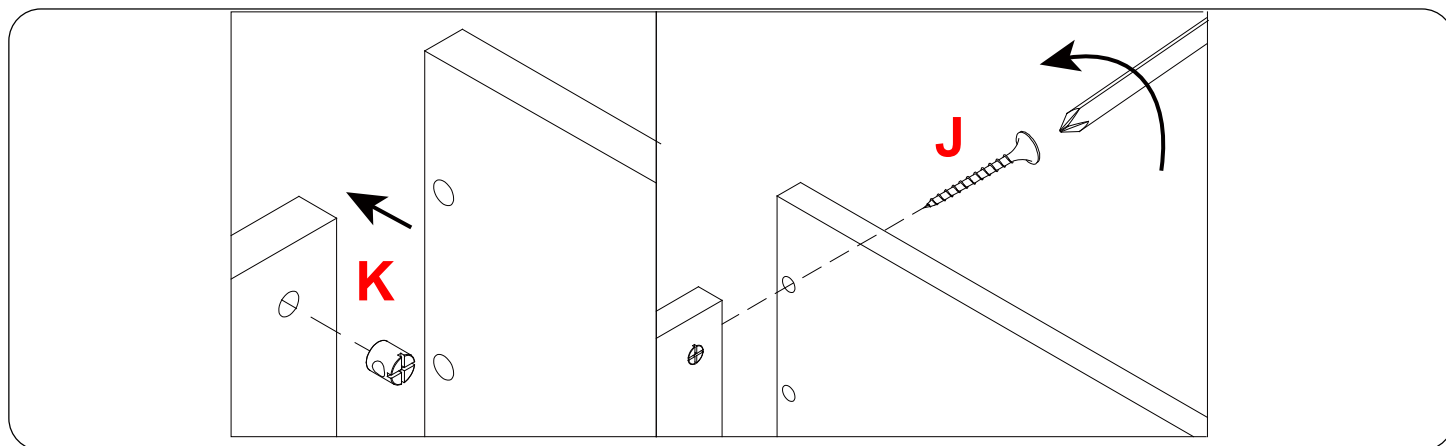
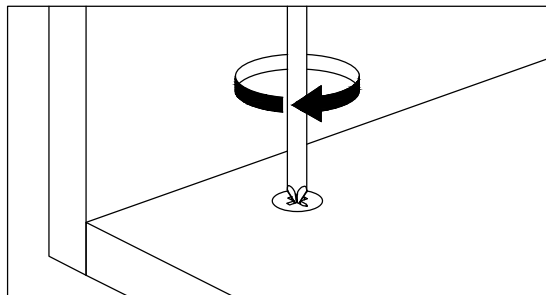

Step 01

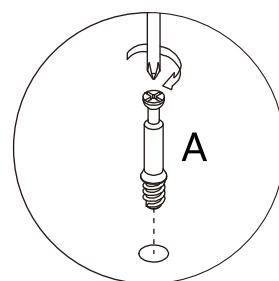
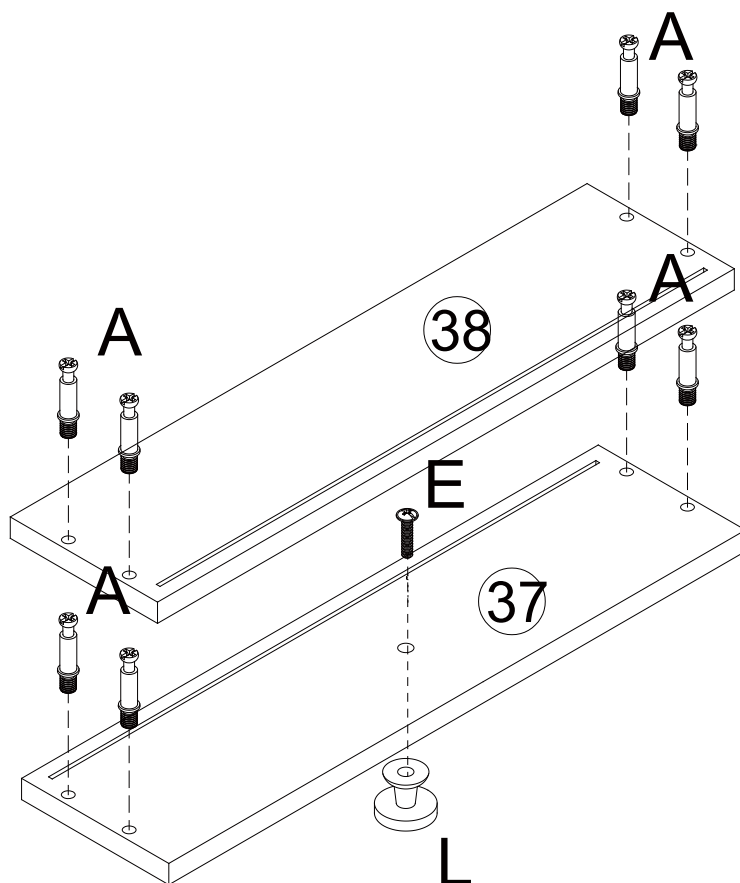

Step 02

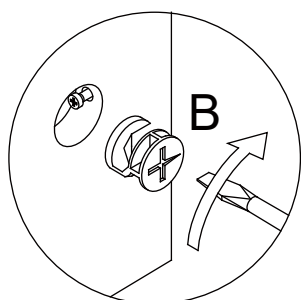
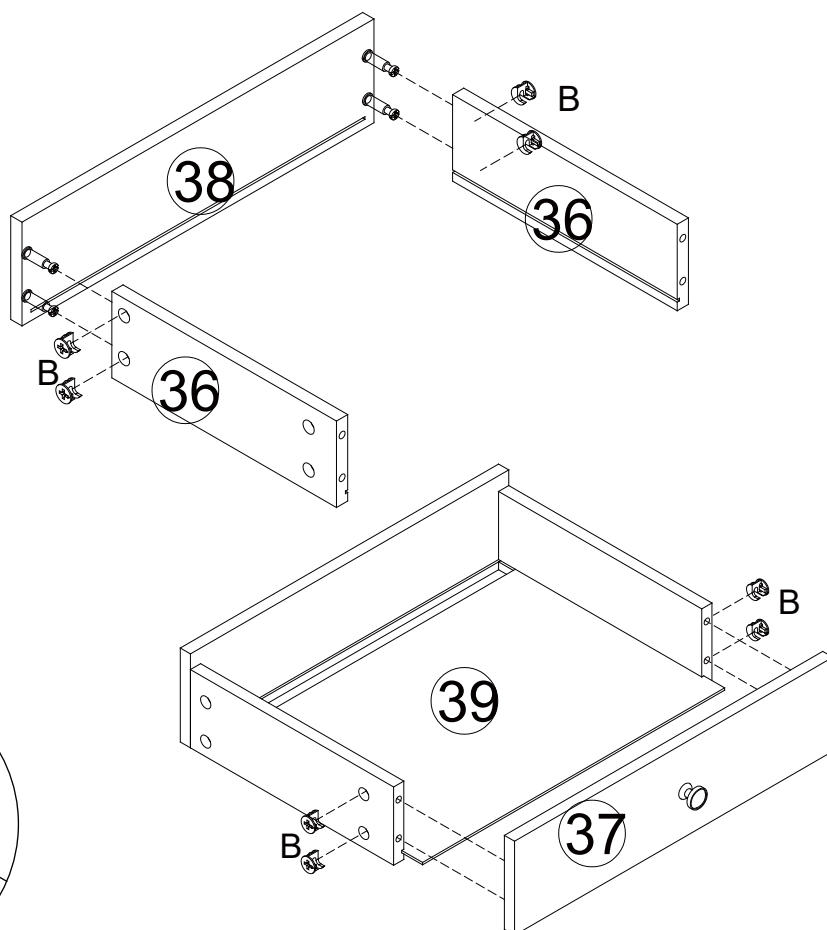

Step 02

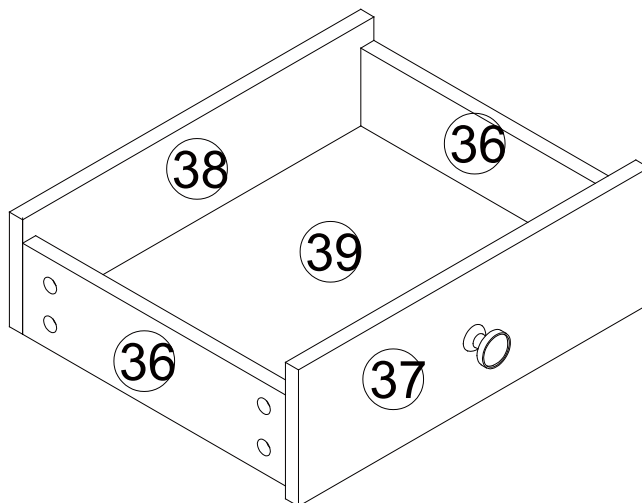
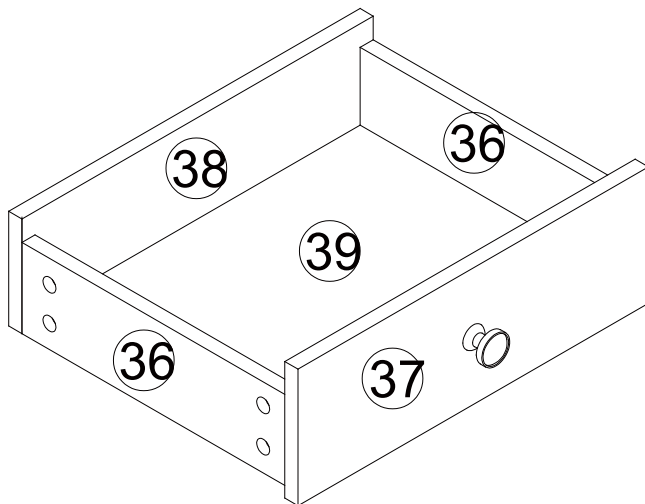

Step 03

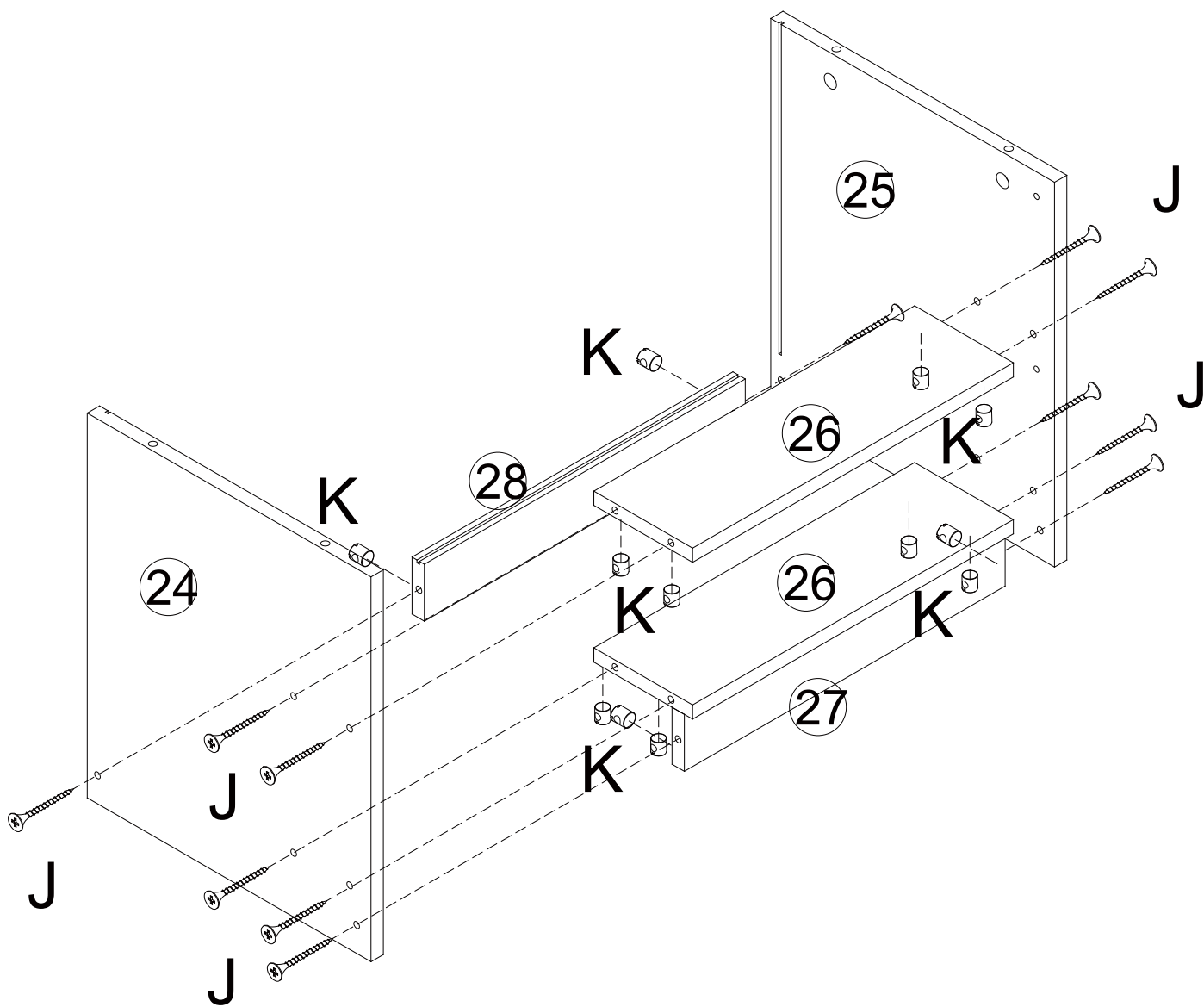

Step 04

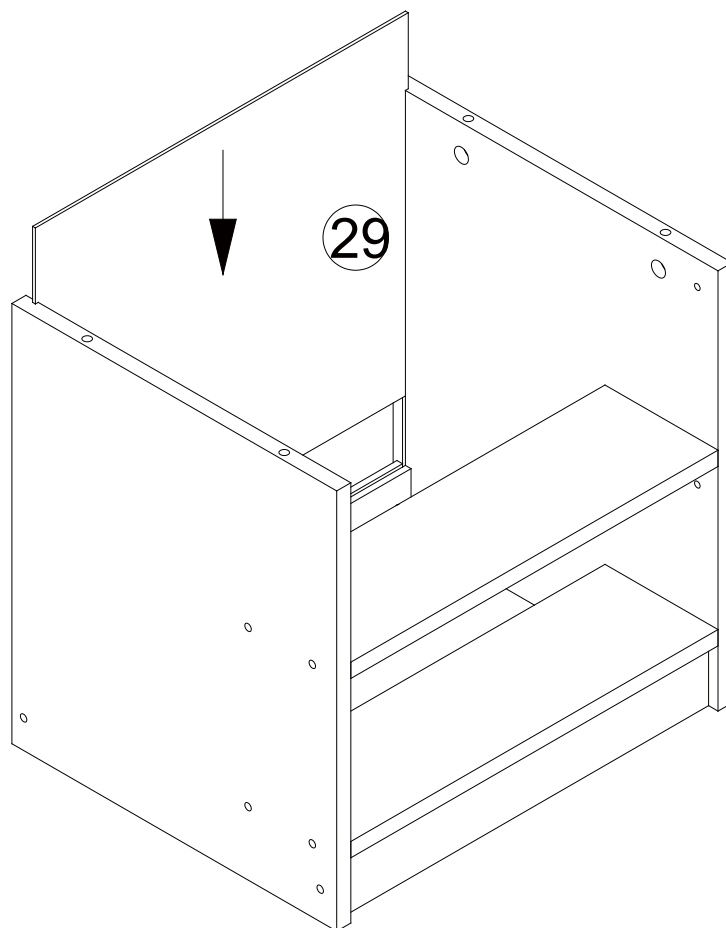

Step 06

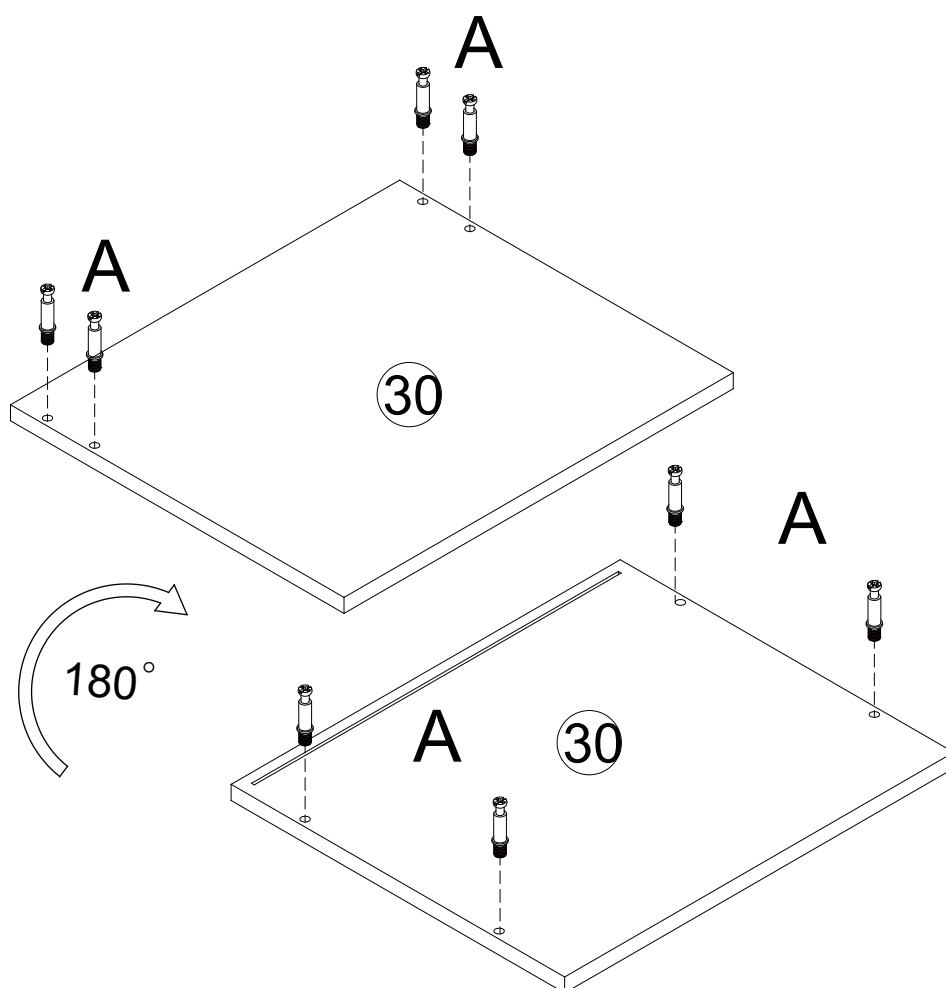

Step 05

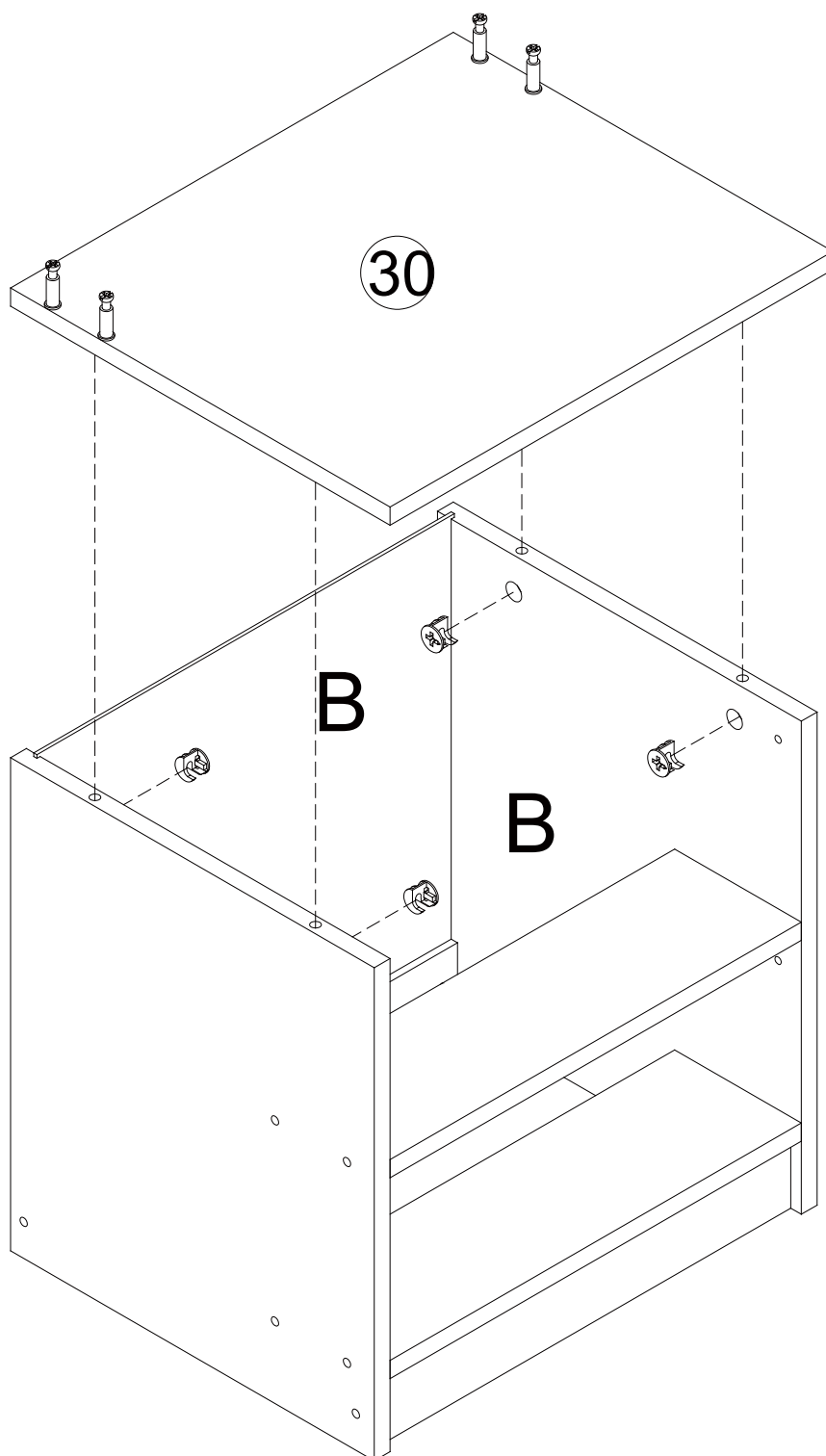

Step 06

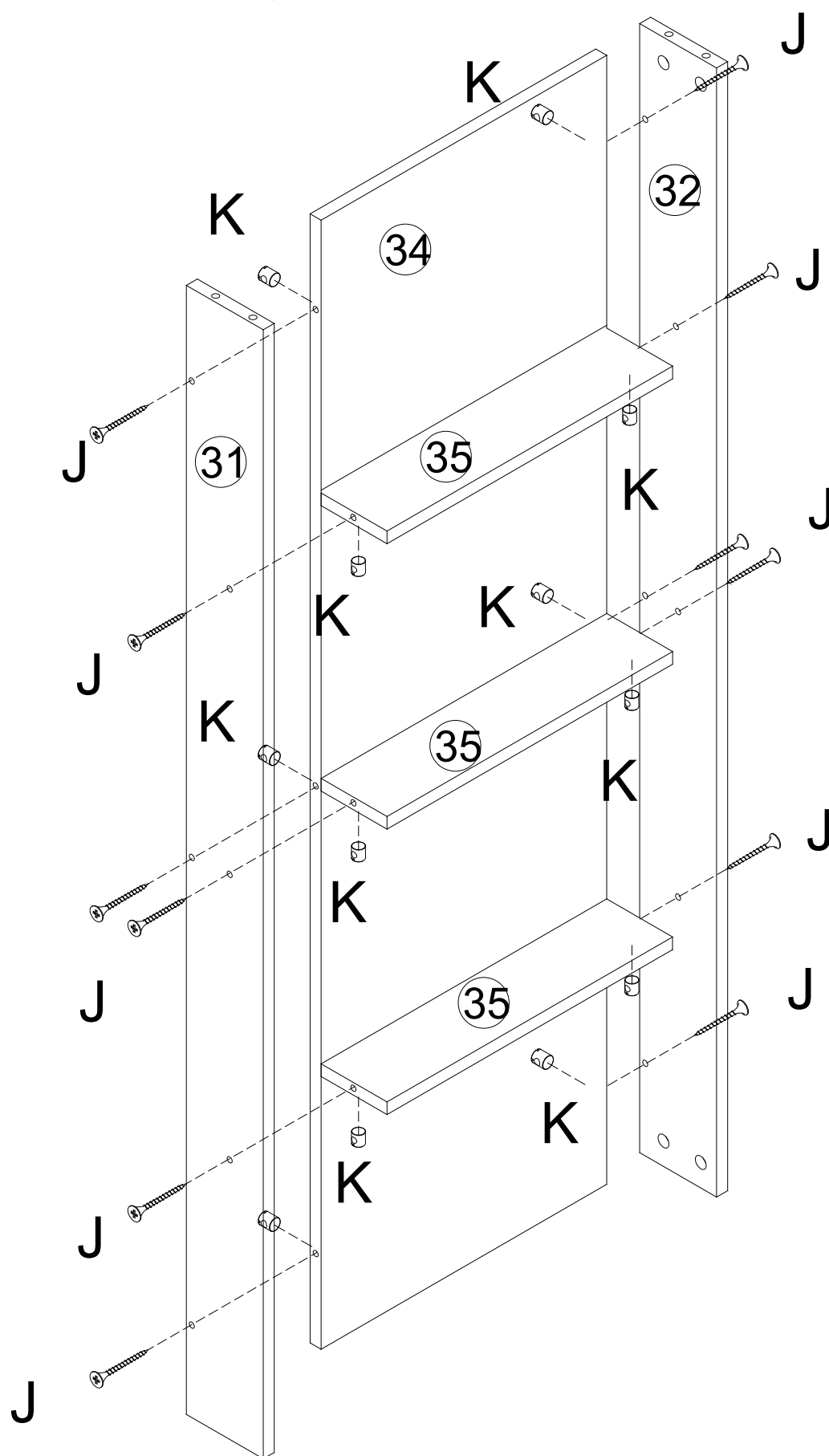

Step 07

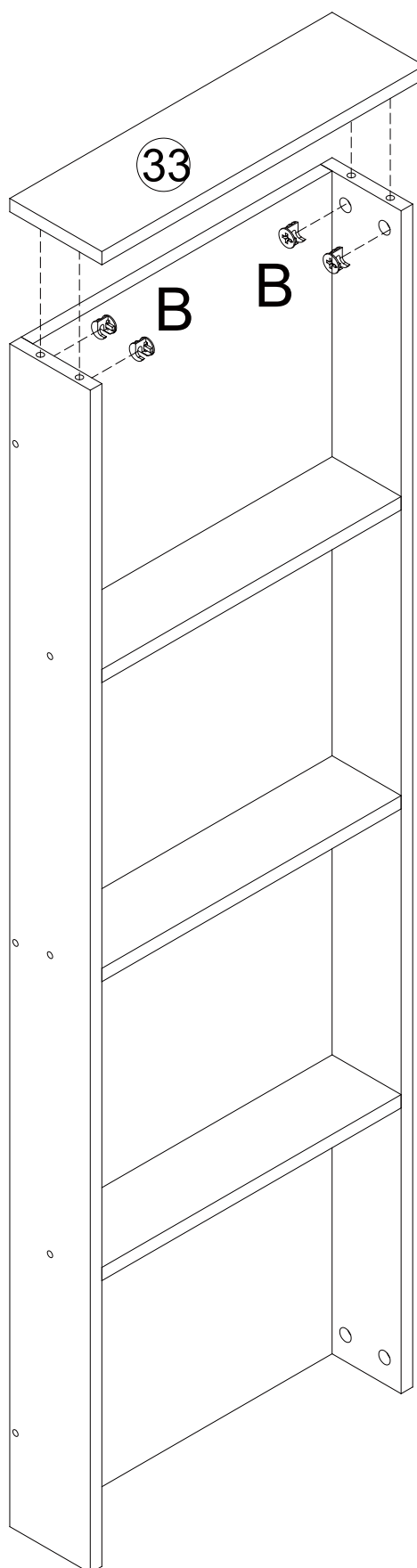
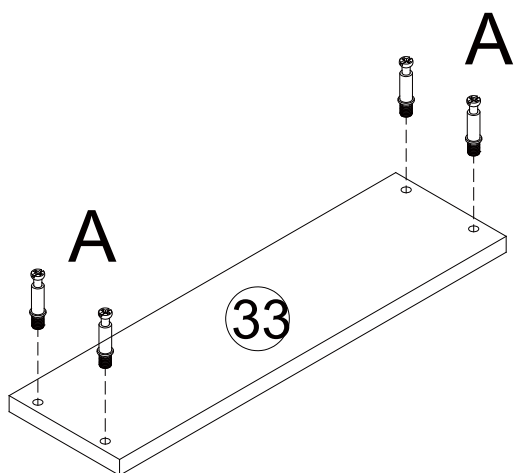

Step 08

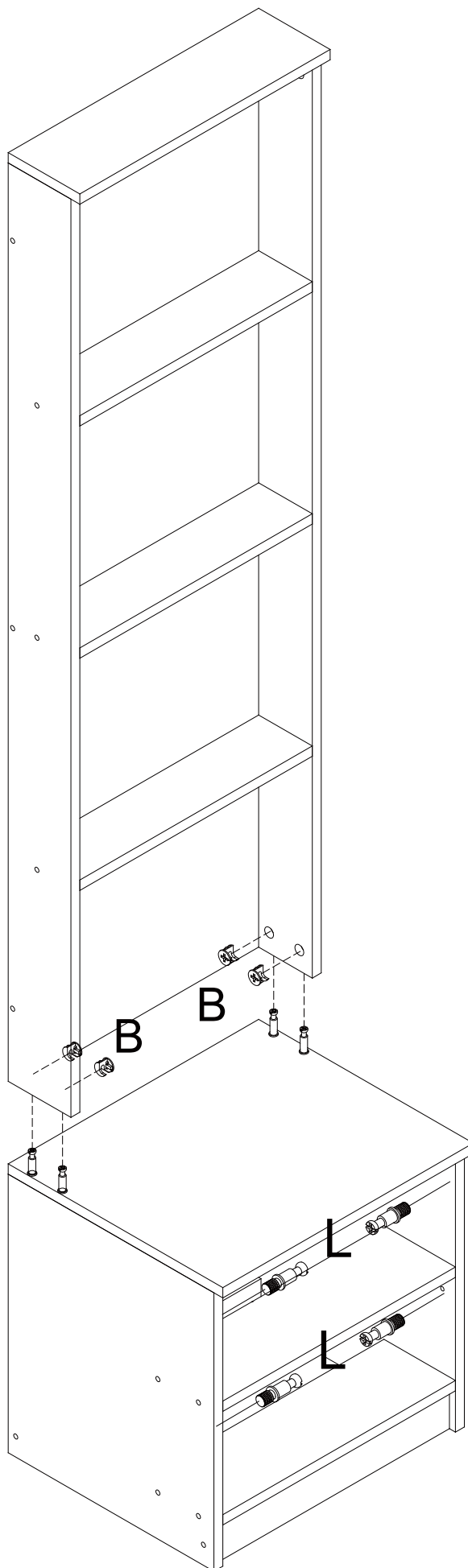

Step 09

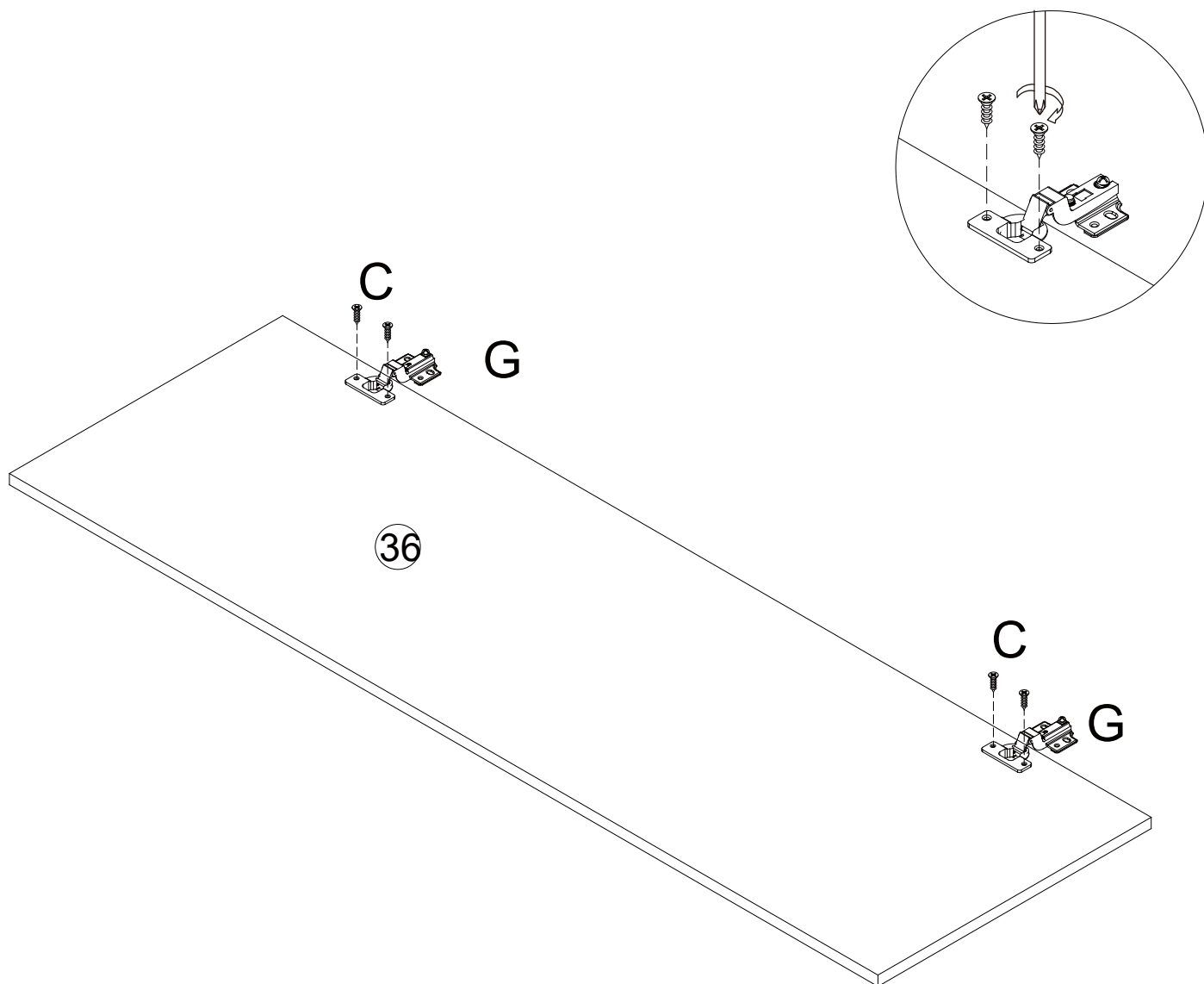

Step 10

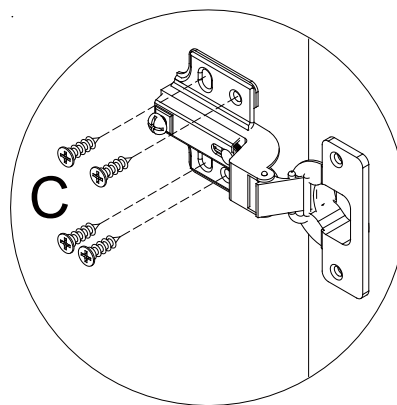
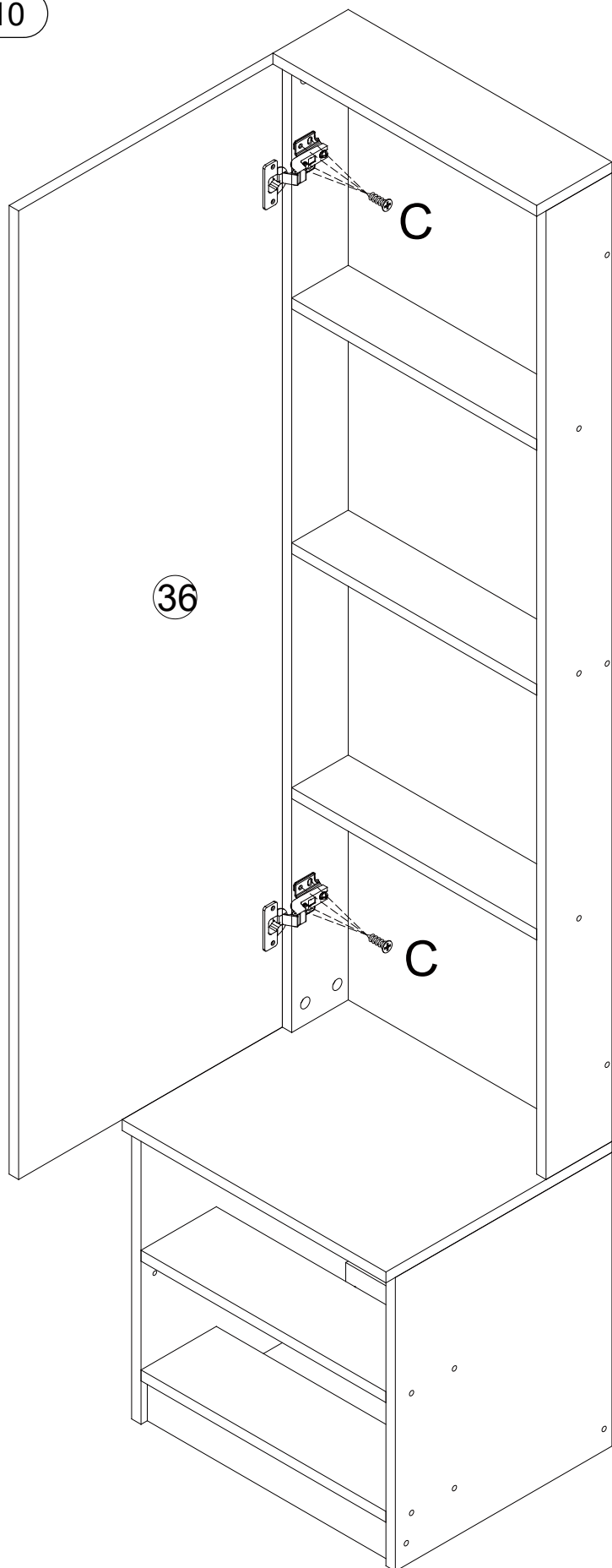



By adjusting the two adjustment screws on the hinge, the gap between the door and the cabinet, as well as the relative position between the door and the cabinet, can be adjusted to ensure alignment and flatness.

Step 11

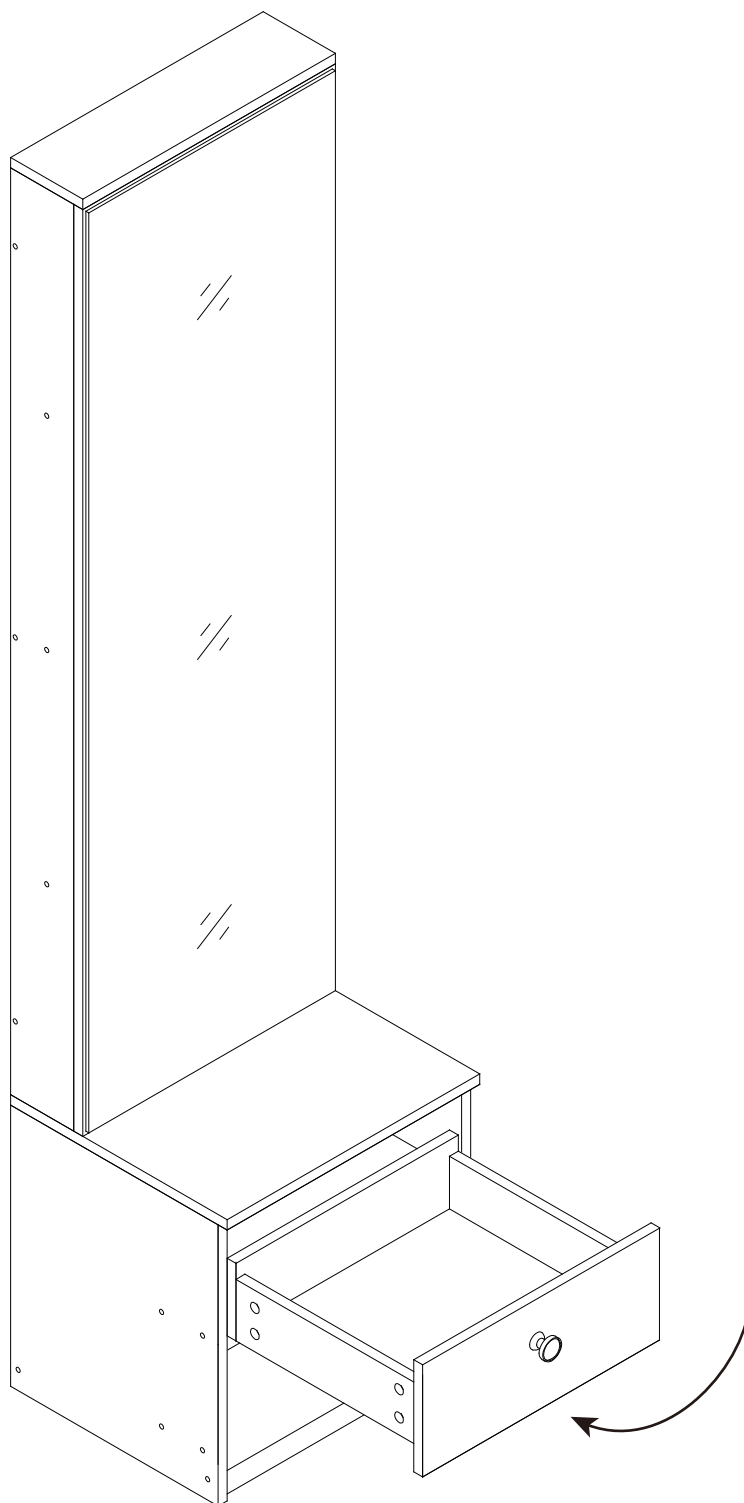

Please note that when placing the drawer in, the drawer positioning pin will block the drawer. Therefore, please follow the diagram to first insert the inner edge of the drawer using a concave method, and then push the drawer flat.

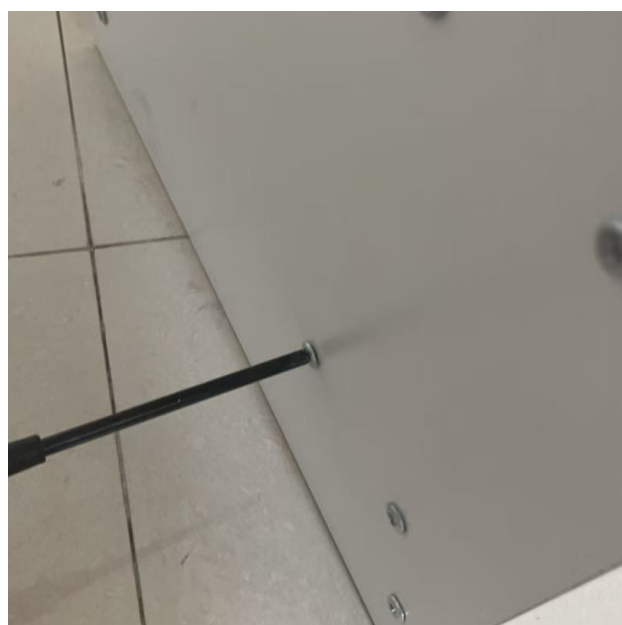
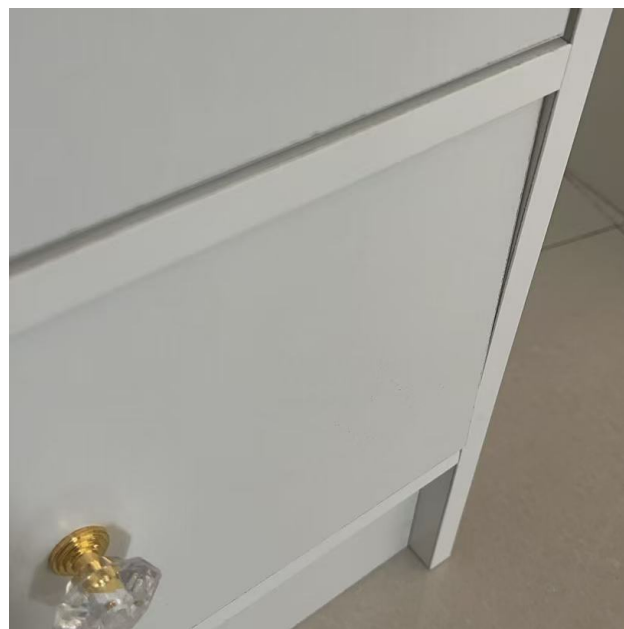

If the drawer cannot be fully inserted or the edge of the drawer is not flush with the edge of the cabinet, please loosen the fixing screws of the drawer support plate, adjust the angle of the drawer support plate until the drawer can be placed flat and kept flush with the edge of the cabinet, and then tighten the fixing screws of the drawer support plate.