



### **Do you need a round or elongated toilet seat?**

- On your toilet bowl measure the distance from the **center of the seat bolt holes** to the **outside front** of the bowl.
- Standard round toilet bowls measure about 16 ½ inches, so you would need a round toilet seat.
- Standard **elongated** toilet bowls measure about 18 ½ inches, so you would need an elongated toilet seat.

### **How to measure your toilet bowl hole spacing:**

Measure the distance from the center of each toilet bowl bolt hole. The above illustration shows a standard 5 ½ inches hole spacing.

*(These instructions and drawings disclose confidential and other data of proprietary nature owned by Renovator's Supply, Inc. and may not be used or disclosed to others without prior written consent of Renovator's Supply, Inc.)*

Installation Instructions Tempered Glass vessel Sinks

Suggested Tools Needed:

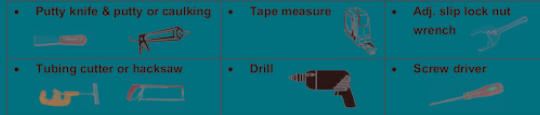

**Step 1**  
Drill 1-3/4 in. hole on countertop. Allow for adequate clearance under the countertop for faucet supply lines, drain assembly & any structural parts of the cabinet. Provide a 2 in. minimum clearance between the back of the sink & the back of the countertop. Countertop diagram is for reference only.

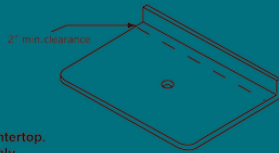

**Step 2**  
Place mounting ring, washer & glass vessel as shown. We recommend applying a silicone caulk bead both above & under the mounting ring to reduce vibration.

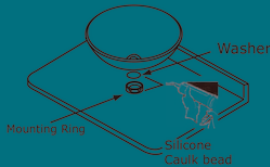

**Step 3**  
Connect trap to drain assembly (as shown). If necessary cut off part of the tailpiece or part of the horizontal leg pipe to complete installation.

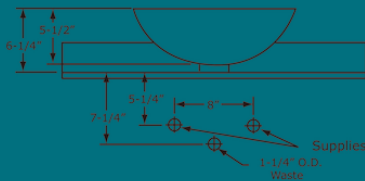
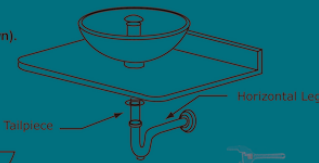

To avoid scratching do NOT use a wrench with serrations (teeth)

Supplies as needed  
Waste

Rev-2008

Before installing your sink

- Unpack & inspect your product immediately upon receipt for damage
- Additional floor & wall preparation may be required including additional supports
- Ensure you have the tools required to avoid damaging or scratching the product
- Shut off the water supply
- Observe all local plumbing codes & building codes

How to care for your product

- Do not over-tighten drain as this may cause damage
- Do not clean product with detergents, acids, abrasives, harsh cleaners
- Do not drop solid objects on or in your product & do not scratch its surface
- Use a damp soft cloth to clean your product
- Use a dry soft cloth to dry your product & avoid water spots
- If needed use a mild soap with a soft cloth to clean your product

Your Tempered Glass Vessel Sink is certified:

IGC 172-2005 Glass Lavatories and Sinks, CSA B45, 0-02 Plumbing Fixtures, CSA B45, 11-04 Glass Lavatories, IAPMO R & T procedure R-019

Faucets

Our Waterfall Faucets & Single Lever faucets coordinate beautifully with our tempered glass sinks  
[www.rensup.com](http://www.rensup.com)

- Choose from over 35 waterfall glass disk designs & colors to match your decor
- Various finishes chrome, brass PVD, satin nickel, antique brass & antique copper
- 500,000 cycle ceramic LEAKPROOF cartridges ensure these faucets last!
- Solid 100% brass inner workings for superior quality, NO ZINC ALLOYS!
- Sleek single lever design make these ergonomic & easy for all ages to use

Unique & Modern faucets arrive daily visit [www.rensup.com](http://www.rensup.com)



Dual Flush Toilets – MAKE the environmentally sound choice!  
Eco-savvy consumers select environmentally sound toilets from  
[www.rensup.com](http://www.rensup.com)

Over 45 Dual Flush Toilets to choose from with the latest Dual-Flush Technology at [www.rensup.com](http://www.rensup.com)

- Which puts you in control of your water consumption
- Choose from both 0.8 & 1.6 gallon flush at the touch of a button
- Lowers water usage & saves you money
- Crafted from Grade A Vitreous China

- Quantity DISCOUNTS on all items
- Most Web Orders over \$125 ship free at [www.rensup.com](http://www.rensup.com)

Rev-2008

Tempered Glass Sinks

Glass sinks are the ultimate in bathroom luxury & are offered in a variety of models at [www.rensup.com](http://www.rensup.com): vessels, over-the-counter, wall-mount & pedestal sinks. Tempered glass sinks are extremely durable and can withstand a change of 20 degrees without breaking. Most tempered glass sinks are resistant to small accident breakage, for example dropping plastic items into the sink. But like ceramic & vitreous china, tempered glass sinks can break or chip when a heavy or solid object falls in or on them like a heavy drinking glass.

However, glass is somewhat of an unpredictable material and a tempered glass sink will shatter into fragments if the tempering process is compromised. The tempering process intentionally puts internal stresses in the glass that produces its strength, durability and heat-resistance. After it is tempered, a small chip could localize these stresses and immediately weaken or break the glass allowing it to shatter. By virtue of its very own nature, tempered glass inherently has the potential to shatter when the tempering process is compromised. Unseen damage to a tempered glass sink may not be noticeable immediately and delayed breakage may occur weeks or months after installation.

In order to reduce the inherent capability of shattering, Renovator's Supply recommends examining your product immediately upon receipt for any defects and report any damage to customers service ([cs@rensup.com](mailto:cs@rensup.com) or 800-659-2211) within the time limit and terms and conditions set by our guarantee available at [www.rensup.com](http://www.rensup.com). Also please ensure that the installation instructions are followed to minimize delayed breakage. Be especially careful to use a caulk bead above and under the mounting ring to reduce vibration against the sink. Also, over-tightening or under-tightening nuts may cause a poor installation in which a delayed breakage may occur. Countertops that are not level and plumb may also contribute to an improper installation and will damage the sink causing a delayed breakage. Routinely check your sink for any cracks or chips. As stated earlier any small chip could localize these stresses and immediately weaken or break the glass. If you have any questions or concerns, contact us immediately at: [cs@rensup.com](mailto:cs@rensup.com) or 800-659-2211

Our tempered glass sinks are rigorously tested and have met these certifications:

- IGC 172-2005 Glass Lavatories and Sinks
- CSA B45.0-02 (Update No. 1: Jun-2003, Update No.2: Apr-2004, Supplement No.1: Oct-2004, Update No.3: Sep-2005) Plumbing Fixtures
- CSA B45.11-04 (Update No.1 March 2005) Glass Lavatories
- IAPMO R & T procedure R-019

At Rensup.com we want you to enjoy your quality product and we guarantee our tempered glass sinks. Please visit [www.rensup.com](http://www.rensup.com) for guarantee details and terms & conditions. If you have any questions or concerns please contact us immediately at: [cs@rensup.com](mailto:cs@rensup.com) or 800-659-2211

For additional web information please consult these links:

- Corning Museum of Glass, Article, Prince Rupert's Drop & Glass Stress <http://www.cmog.org/index.asp?pageid=735>
- Wikipedia, Article, Prince Rupert's Drop [http://en.wikipedia.org/wiki/Prince\\_Rupert's\\_Drops](http://en.wikipedia.org/wiki/Prince_Rupert's_Drops)
- Keidel.com, Article, Materials - Glass <http://www.keidel.com/design/select/sinks-glass.htm>

**Console Sink Installation Instructions**  
**Belle Époque, Double Belle Époque or Southern Belle**  
**with Bistro Leg Supports**

1. Locate proper position for bistro leg sink in your bathroom. Be sure to provide easy access to plumbing and drain fittings.
  2. Lift and place sink on bistro legs, adjust its position against the wall & make sure it is leveled using a level, adjust legs to plumb position.
  3. Mark the centerline on the floor & trace bistro leg base on the floor.
  4. Mark the wall with a pencil at each mounting hole on the underside of the sink & wall-mounting flanges of bistro frame.
  5. Carefully remove the sink from the bistro leg frame & install faucet & drain.
- Note: Install sufficient backing behind the finished wall to provide a secure material for the bolting devices**
6. Drill pilot mounting hole at the marked locations on the finished wall.
  7. Carefully lift the sink against the wall and on top of the bistro leg frame to ensure proper fit in the desired location.
  8. Place the metal washer followed by the rubber washer & then insert the bolts through the holes in the sink & into the wall.
  9. Secure the bistro frame to the wall with provided fasteners.
  10. Tighten the bolts (sold separately) alternately until the sink is snug against the wall.  
"Caution do not over-tighten the wood screw and washer.  
It may damage the product"
  11. Complete the plumbing connection as required.

**Optional: It is recommended to apply silicone caulk between the back of the sink & the wall, where support legs join the sink & also between the floor & the legs.**



*Our console sinks feature not only elegance in design but built-in functionality that allows you & your family the practicality of modern convenience without sacrificing quality & style.*

**Made of Grade A Vitreous China**

Our consoles are hard-fired at intense temperatures. This process allows our superior quality porcelain glazes to fuse and cure with console molds and provide a vitreous finish that is impervious to water & other common household acids & chemicals. Our consoles do not stain like lesser grades of vitreous china consoles.

**Our Porcelain Glazes**

Are manufactured to provide stunning colors and designs for which we are renowned worldwide. Our whites are white unlike cheaper manufacturers who settle for grayish or yellowish glazes. Our porcelain glazes do not fade with time & are scratch-resistant. Perfect for everyday wear & tear.

**Console Sinks:**

- Self-draining soap dishes keeps your sink surface tidy – gravity does the work for you
- Ample counter space for toiletries
- Contoured rim & built-in back splash keeps water off the floor & in the sink, less mess!
- Select between white, bone & black colors to match any bathroom décor
- Choose from a compact 4" center set or an elegant 8" widespread faucet sink design
- A variety of supports to choose from:
  - Spindle – space-saving tapered legs perfectly show-off your sink
  - French Provincial – ornate & elegantly curved for a dash of style
  - Roman – most popular for a sturdy Romanesque look
  - Bistro Chrome – tarnish resistant chrome-plated brass
  - Bistro Brass PVD – Physical Vapor Deposition guarantees tarnish-free brass for a lifetime
  - Includes brackets where needed

**Belle Époque Deluxe**

- Ergonomic design, slightly concave sink front let's you get closer to the faucets for less back strain
- Lovely contouring rim & luxurious countertops provide an exquisite design

**Belle Époque Double Deluxe**

- The marriage-saver, perfect for His & Hers
- Two sinks are twice as efficient & time-saving for getting the entire family ready
- Maximizes bathroom real estate while indulging in a double sink console
- Unlike double vanities the double console is more space efficient & easier to clean

**Southern Belle**

- Generous right-side counter top for all those toiletries that we've just got to have!
- Contoured by beautiful detailing the Southern Belle is unique in design

**Belle Époque Deluxe & Southern Belle Corner Sinks**

- Maximizes the use of smaller spaces
- Allows you to have a bathroom centerpiece even in a smaller bathroom

**Always dreamed of a cast iron clawfoot tub! Visit [www.rensup.com](http://www.rensup.com) for a wide selection**

- Extra thick cast iron tubs 5/16" thick retain heat longer so you can soak longer!
- Authentic white porcelain glaze
- Primed & ready to be painted
- Wide selection of clawfoot finishes

**Eco-savvy consumers know we have the widest selection of environmentally sound toilets!**

**At [www.rensup.com](http://www.rensup.com) we have:**

**Dozens of Dual Flush Toilets to choose from with the latest Dual-Flush Technology**

- Which puts you in control of your water consumption
- Choose from both 0.8 & 1.6 gallon flush at the touch of a button
- Lowers water usage & saves you money

**Over 350 High-tank Toilets & Conversion Kits** that allow you to have that Old World charm

- Yet take advantage of water saving technology
- Are adjustable to accommodate various size bathrooms
- Come in a variety of colors & finishes

Please Read The Following Instructions Before Installing:  
Classic Z-pipe High Tank Toilet Conversion KIT

Preparation and disassembly

1. Shut off water supply to the existing water closet
2. Disconnect water supply tubing from the existing tank and angle stop valve
3. Remove existing toilet tank
4. Leave existing toilet water closet bowl - optional

If you wish to or if you wish to replace just the wax ring on the existing water closet bowl see the optional instructions below, or if you want to replace the entire existing water closet bowl read the optional instructions below.

Optional Toilet Bowl Install & Wax Ring Replacement

5. Remove the existing water closet bowl to remove the old wax ring.
6. Remove old wax ring & clean area around drain.
7. Draw a center line (as illustrated) through the center of the drain to the wall.
8. Plumb line vertically to the wall up to 79", at this point draw a horizontal line on either side of the center line.
9. To install the toilet bowl turn it upside-down. Place the NEW wax ring (available at any Hardware store) & sleeve over the drain horn. Press it down firmly.
10. Note: if the ring has a paper cover, remove it. Make sure the toilet flange is clean & the floor bolts point straight up. Carefully position the toilet bowl over the flange, & fit the holes in the toilet base directly over the floor bolts.
11. Press down on the toilet bowl to compress the wax ring, to form a tight seal. Attach the washers & nuts to the floor bolts, & tighten them with an (non-scratch) adjustable wrench. (Note: Don't over-tighten the bolts as you may crack the ceramic base)

Toilet Bolt Covers are available at rensup.com  
17612 White, 17613 Bone, 17614 Black



INSTALLATION PROCEDURE

11 STEPS

Part #	Part Name	Qty
1	Water Tank	1
2	Flange	1
3	Water Closet (Ceramic) (W/C) (Left)	1
4	Water Closet (Ceramic) (W/C) (Right)	1
5	Flange	1
6	Water Ring	1
7	Water Ring	1
8	Water Ring	1
9	Water Ring	1
10	Water Ring	1
11	Water Ring	1
12	Water Ring	1
13	Water Ring	1
14	Water Ring	1
15	Water Ring	1
16	Water Ring	1
17	Water Ring	1
18	Water Ring	1
19	Water Ring	1
20	Water Ring	1
21	Water Ring	1
22	Water Ring	1
23	Water Ring	1
24	Water Ring	1
25	Water Ring	1
26	Water Ring	1
27	Water Ring	1
28	Water Ring	1
29	Water Ring	1
30	Water Ring	1
31	Water Ring	1
32	Water Ring	1
33	Water Ring	1
34	Water Ring	1
35	Water Ring	1
36	Water Ring	1
37	Water Ring	1
38	Water Ring	1
39	Water Ring	1
40	Water Ring	1
41	Water Ring	1
42	Water Ring	1
43	Water Ring	1
44	Water Ring	1
45	Water Ring	1
46	Water Ring	1
47	Water Ring	1
48	Water Ring	1
49	Water Ring	1
50	Water Ring	1
51	Water Ring	1
52	Water Ring	1
53	Water Ring	1
54	Water Ring	1
55	Water Ring	1
56	Water Ring	1
57	Water Ring	1
58	Water Ring	1
59	Water Ring	1
60	Water Ring	1
61	Water Ring	1
62	Water Ring	1
63	Water Ring	1
64	Water Ring	1
65	Water Ring	1
66	Water Ring	1
67	Water Ring	1
68	Water Ring	1
69	Water Ring	1
70	Water Ring	1
71	Water Ring	1
72	Water Ring	1
73	Water Ring	1
74	Water Ring	1
75	Water Ring	1
76	Water Ring	1
77	Water Ring	1
78	Water Ring	1
79	Water Ring	1
80	Water Ring	1
81	Water Ring	1
82	Water Ring	1
83	Water Ring	1
84	Water Ring	1
85	Water Ring	1
86	Water Ring	1
87	Water Ring	1
88	Water Ring	1
89	Water Ring	1
90	Water Ring	1
91	Water Ring	1
92	Water Ring	1
93	Water Ring	1
94	Water Ring	1
95	Water Ring	1
96	Water Ring	1
97	Water Ring	1
98	Water Ring	1
99	Water Ring	1
100	Water Ring	1

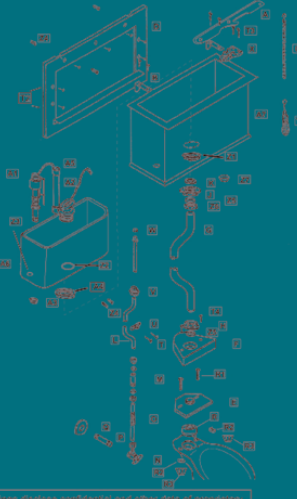

These illustrations and drawings disclose confidential and other data of proprietary nature owned by Renovator's Supply, Inc. and may not be used or disclosed to others without the prior written consent of Renovator's Supply, Inc. ®

INSTALLATION PROCEDURE

11 STEPS

Optional, if a new bowl (closet) is being installed follow the manufacturers' specifications.

1. Close up the toilet bowl as per manufacturers' specifications and instructions.
2. Attach flush arm (1) to the brass clevis (16) mounted on the right side of the wood tank (17). Mount the end of the pull chain (15) to the flush arm and tighten chain to the opposite side. (Fig. 1)
3. Make sure and check that the w/ft tube (18) is mounted on top of the overflow pipe. (Fig. 2)
4. To mount existing toilet (21) locate the centerline on the wall behind the base and flush horn height. We recommend that the bottom edge of the existing base about 40 inches from the floor for regular base bowl height. 36 inches. Secure existing bracket to studs with existing screws (1). If studs cannot be re-used per requirement check studs for use re-use into the vertical studs, use plastic anchors (24) to the bottom part of the existing bracket (1) and to the bottom of the outside perimeter of the existing bracket (21). This area will be exposed. (Fig. 4)
5. Align hanger brackets (10) on the wood tank to the inside studs of the existing bracket (1) and hang the wood tank (17). (Fig. 3B)

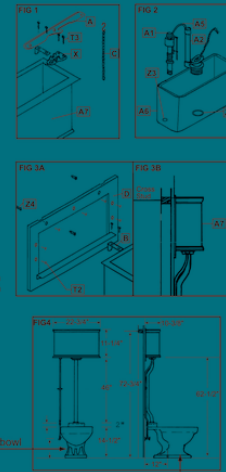

These instructions and drawings disclose confidential and other data of proprietary nature owned by Renovator's Supply, Inc. and may not be used or disclosed to others without the prior written consent of Renovator's Supply, Inc. ®

INSTALLATION PROCEDURE

11 STEPS

6. Fasten conversion panel (8). Place cover plate (7) on top of conversion panel (8). Tighten with cover plate screws (14). (Fig. 5)
7. Slide brass ring nut (20) followed by plastic ring joint washers (21) and cage decorative nut (19) with rubber washer (22) over the 47" stainless steel tube (12). Insert rubber water restrictor (23) inside the 47" stainless steel tube (12) and firmly attach the large decorative nut (19) to the receiving thread of the flush valve (12) on the wood tank slightly higher all parts. (Fig. 6)
8. Slide the medium decorative nut (18) followed by the plastic ring joint washers (21) to the bottom end of the 47" stainless steel tube and loosely attach to the receiving thread of the conversion panel (8). (Fig. 6)

Note: Steps 6 & 7 involves slight pulls and pushes of the 47" stainless steel tube (12) that will enable proper fitting of the 47" stainless steel tube (12). Then check final alignment of the tube and tighten all parts.

9. Install the nipple (9) to the water fitting from the wall. Secure the nipple (12) onto the nipple (9) and rotate the end off nipple (9). (Fig. 6)
10. Slide the small brass decorative nut (19) from the opposite end of the 1/2" water supply line (11) (unthreaded end) and insert into nipple (12) in the bottom of the 1/2" water supply line (11) and the large brass decorative nut (19) on the opposite end. Connect the large brass decorative nut (19) to the flush valve handle and hand tight. Connect the 1/2" water supply line (11) and 1/2" supply line (12) to the end of the flush valve (12). Slide remove the nut and brass nipple from the shut off valve (12) align the 1/2" supply line (12) to the end of the flush valve (12) measure appropriate length and use adjustable pipe the brass nut however by the brass nipple removed from the shut off valve water into the 1/2" supply a arrow and make sure all connections are properly engaged in accordance. Rotate the brass lock handle of operation are tightened. (Fig. 7)

11. Turn on the shut off valve and fill the tank to the waterline and add flush system (checking for leaks). Water level is established from the factory, in some instances readjustment might be necessary. Caution: Before turning on the water, please make sure that all parts are installed properly. Never use oil-based, solvents or acids to clean the unit. Use only mild soap and water with a soft cloth to clean the unit. The unit is made of high quality plastic and any kind of damage the unit will not be covered by the warranty.

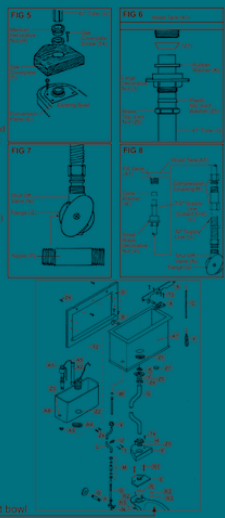

Your existing toilet bowl

These instructions and drawings disclose confidential and other data of proprietary nature owned by Renovator's Supply, Inc. and may not be used or disclosed to others without the prior written consent of Renovator's Supply, Inc. ®

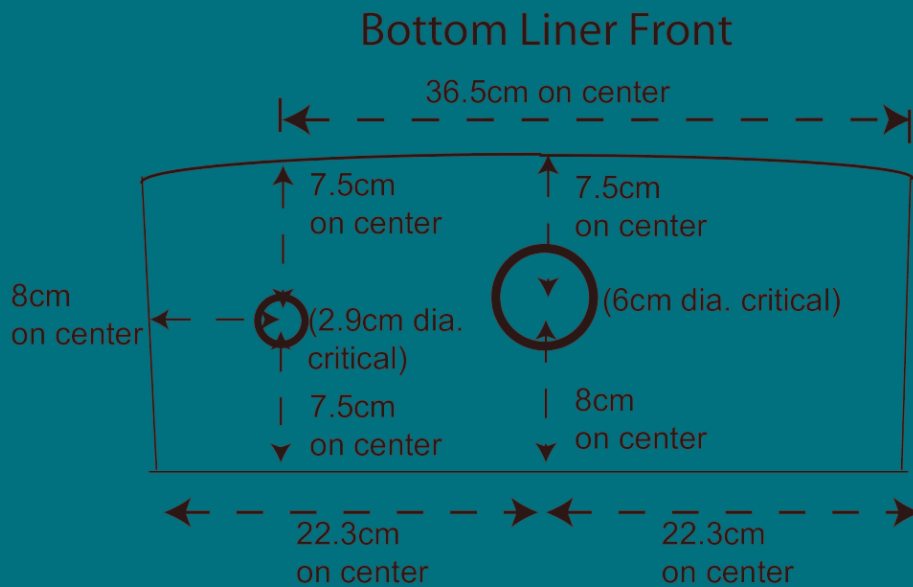
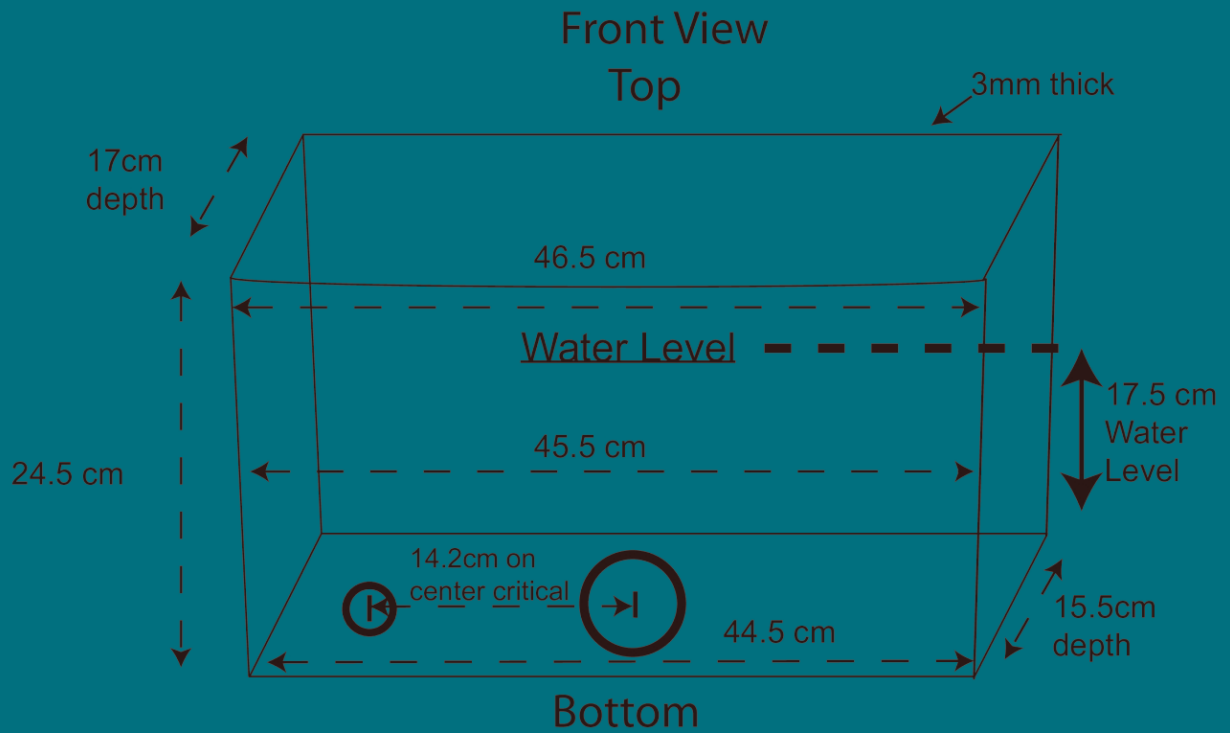

### Bottom Liner Back

(+/- 0.5cm overall tolerance on non-critical specifications)



Renovators Supply, Inc.© www.rensup.com

Please Read The Following Instructions Before Installing.

**NOTE:** It is not recommended to pre-install or rough-in the product before actually receiving it on location. This is due to slight variations in the product.

**Preparation and disassembly:**

1. Shut off water supply to the existing water closet
2. Disconnect water supply tubing from existing tank and angle stop valve
3. Remove existing water closet and tank from floor
4. Remove old wax seal and clean area around the drain

**Toilet Bowl Installation**

1. To install the toilet bowl turn it upside-down. Place the new wax ring (available at any hardware or plumbing supply store) and sleeve over the drain horn. Press it down firmly. Note: if the ring has a paper cover, remove it.

2. Make sure the toilet flange is clean and the floor bolts point straight up. Carefully position the toilet bowl over the flange, and fit the holes in the toilet base directly over the floor bolts.

3. Press down on the toilet bowl to compress the wax ring. To form a tight seal. Attach the washers and nuts to the floor bolts, and tighten them with a (non-scratch) adjustable wrench.

**(Note:** Don't over-tighten the bolts as you may crack the ceramic base).

Toilet Bolt Covers are available at rensup.com  
17612 White  
17613 Bone  
17614 Black

Our No Slam Toilet Seats are available at rensup.com  
White round 14349, elongated 13506.  
Bone round 15390, elongated 15389.



These instructions and drawings disclose confidential and other data of proprietary nature owned by Renovator's Supply Inc.© and may not be used or disclosed to others without the prior written consent of Renovator's Supply Inc.©



Renovators Supply, Inc.© www.rensup.com

Please Read The Following Instructions Before Installing.

**NOTE:** It is not recommended to pre-install or rough-in the product before actually receiving it on location. This is due to slight variations in the product.

**Standard 12 inch rough-in:**

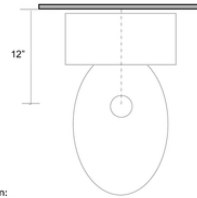

**Corner 12 inch rough-in:**

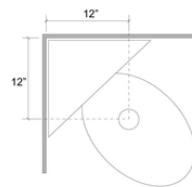

These instructions and drawings disclose confidential and other data of proprietary nature owned by Renovator's Supply Inc.© and may not be used or disclosed to others without the prior written consent of Renovator's Supply Inc.©



Renovators Supply, Inc.© www.rensup.com

Before installing, remove old fittings and clean tank. Do NOT use plumber's putty to seal fittings. Do NOT use chlorine (bleach) cleaners or related products. Note: valves shown below may vary in appearance from the actual valves you may have received.

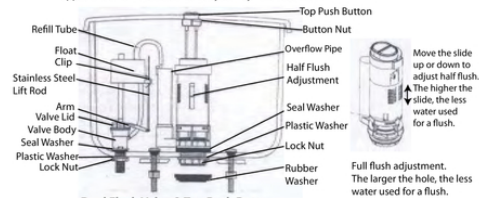

**Fill Valve**

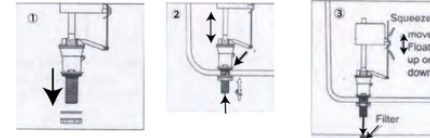

Disassemble the Lock Nut & Plastic Washer for valve installation.

Position valve inside tank. Push down the valve shank (not the top) while attaching plastic washer & tightening lock nut beyond hand tight.

Adjust water level by squeezing level adjustment clip & moving float up or down along the stainless steel lift rod. Always clean the filter.

These instructions and drawings disclose confidential and other data of proprietary nature owned by Renovator's Supply Inc.© and may not be used or disclosed to others without the prior written consent of Renovator's Supply Inc.©



Renovators Supply, Inc.© www.rensup.com

**Dual Flush Valve**

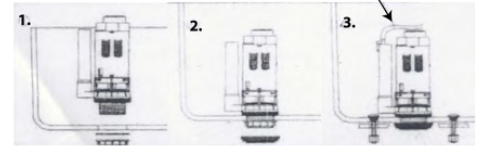

Disassemble the lock nut for valve installation. Position the valve inside the tank. Push down on the valve body while tightening the lock nut from outside.

Position the rubber washer in the lock nut.

Position the tank gasket on the lock nut & position the tank on the toilet bowl. Fasten the tank to the toilet bowl using tank bolts. NOTE: tighten bolts simultaneously.

**Dual Push Button**

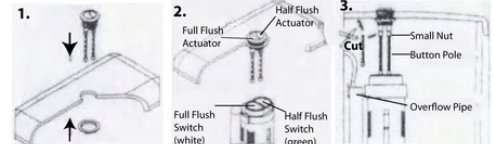

Unscrew the lock nut from the push button by hand. Insert the push button body into the tank cover hole from outside of tank cover. Screw the lock nut into the thread of the push button from the inside of the tank cover. (Keep it loose)

Adjust the push button to assure their poles are in the correct direction with the flush valve switch. Then tighten the lock nut.

Loosen the small nuts & adjust the button poles to the suitable length. If needed cut the button poles to adjust length.

These instructions and drawings disclose confidential and other data of proprietary nature owned by Renovator's Supply Inc.© and may not be used or disclosed to others without the prior written consent of Renovator's Supply Inc.©