

# Product&Notes&Installation

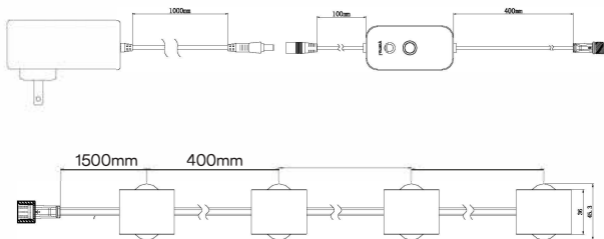

## Get Ready

---

Know your Wi-Fi network and password.

Make sure your mobile device meets the following requirements:

For iOS: Ensure your device is running iOS 13.3 or higher.

For Android: Ensure your device is running Android 9.0 or higher.

Ensure that you are connecting to a 2.4GHz Wi-Fi network as devices are not compatible with 5GHz networks.

## Notes

---

Button Functions:

1. Hold down the button for 5 seconds to enter network configuration mode. Upon powering up, the factory-set equipment will automatically make the lights flash.
2. A single press changes the mode, which varies with each press.
3. Pressing the button twice quickly will turn the device off. It will remember the color or the state from before the last time it was turned off.

(Note: A long press of 5 seconds, in any mode, will initiate the network configuration mode.)

# Installation

Double-sided glowing wall lamp

The wall lamp supports a single head displaying different colors or one color temperature and color simultaneously. It comes with default and DIY scenes and supports local MIC as well as cloud app music modes. It can be controlled via remote control, app, and third-party voice control.

The double-headed wall lamp can be arranged in different shapes as needed, such as letters: C, L, M, N, J, O, S, U, V, Z.

It can be installed in common horizontal or vertical directions.

## Installation Instructions :

- 1.Choose the wall lamp you need to install; we offer products with double 7-head and double 14-head options(400mm spacing between lamps).
- 2.Ensure the installation location is on the same plane as much as possible.
- 3.Choose a location close to an outlet to ensure the power adapter can connect to the outlet properly.
- 4.Confirm the shape first, then choose adhesive installation based on the shape. If it is not secure enough, drill holes at the confirmed position to insert the glue plug, then fix the base of the wall lamp with screws.
- 5.The base of the wall lamp connects to the lamp body via a sliding rail, so during installation or removal, slide in or out along the connector.

For a cement wall, first confirm the base installation position, then drill holes and install anchors. Next, peel off the 3M backing from the lamp base, align it with the pre-drilled holes, and mount it. After installation, remove the lamp body and secure the base cover with screws.

For wooden or other easily screwable wall structures, assemble the lamp first, then remove the base cover and directly secure it with screws. Then proceed with the lamp installation as instructed.

1. Keep the wall clean and dry, remove the release papers from the 3M adhesives and stick the hanging boards on the wall.

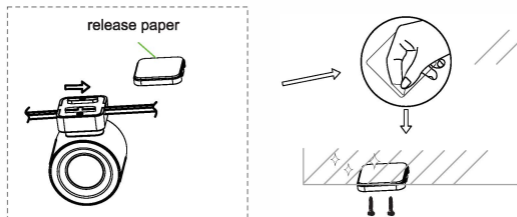

2. Install the screws into the holes of the hanging boards and fix them, Slid the lamp body into the hanging boards.

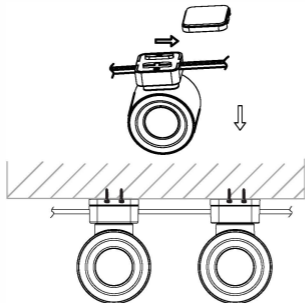

## Troubleshooting

1. Can't connect to your Wi-Fi network.

Ensure that you have entered the correct Wi-Fi password during the setup process. Check for any potential issues with your internet connection. If the Wi-Fi signal is weak, consider resetting your Wi-Fi router and attempting the setup process again.

2. If binding fails, you'll require two phones. One phone will set up a hotspot, and the other will connect to the hotspot and add the device via the app. If the device is successfully added, it should operate normally. If issues persist, the problem may lie with the router. Check your router settings for MAC and DHCP restrictions.

# Remote Control

---

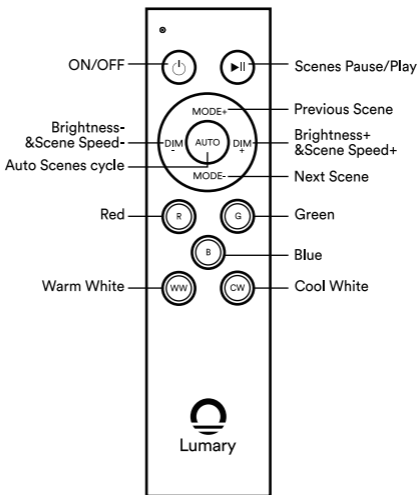

The remote control can operate both networked and unconnected devices.

Here's how to handle each scenario:

1. For unconnected devices:

- Wait until the device stops flashing.
- Press the on/off button for 3 seconds. Note that this method is not recommended.

2. For devices connected to the network:

- Power off and then on the device.
- Long press the on/off button for 3 seconds.
- The light will blink to indicate successful pairing.

# Important Information \_\_\_\_\_

## Troubleshooting

Unable to Connect to Your Wi-Fi Network:

Please ensure that you entered the correct Wi-Fi password during the setup process. Check for any potential Internet connection issues. If the Wi-Fi signal is weak, consider resetting your Wi-Fi router and attempting to connect again.

## Parameter information \_\_\_\_\_

Name	Smart Wall Sconces
Model	01
Input Voltage	100-130VAC,60Hz
Lights Qty	7/14PCS
Color Temperature	RGBAI+WW+CW
Operating Temperature	-20℃~45℃ (-4°F~113°F)
IP Rating	IP20
Beam Angle	100°
Rated Life	15000h



**RoHS**



**Contains FCC ID:2ANDL-CBU**

**Made in China**

## **CAUTION:**

This device complies with Part 15 of the FCC Rules. Operation is subject to the following two conditions:

1. This device may not cause harmful interference.
2. This device must accept any interference received, including interference that may cause undesired operation.

Changes or modifications not expressly approved by the party responsible for compliance could void the user's authority to operate the equipment.

Note: This equipment has been tested and found to comply with the limits for a Class B digital device, pursuant to Part 15 of the FCC Rules. These limits are designed to provide reasonable protection against harmful interference in a residential installation. This equipment generates, uses, and can radiate radio frequency energy and, if not installed and used in accordance with the instructions, may cause harmful interference to radio communications. However, there is no guarantee that interference will not occur in a particular installation. If this equipment does cause harmful interference to radio or television reception, which can be determined by turning the equipment off and on, the user is encouraged to try to correct the interference by one or more of the following measures:

- Reorient or relocate the receiving antenna.
- Increase the separation between the equipment and receiver.
- Connect the equipment into an outlet on a circuit different from that to which the receiver is connected.
- Consult the dealer or an experienced radio/TV technician for help.