

ASSEMBLY AND DRESSING INSTRUCTIONS

A=  (9/50-2")*64PCS

B= 
 (3 Jewels +1 Square 4 Holes)+(3 Jewels + 9/75-3")*6PCS

C=  (14 Jewels Strand)*12PCS

D= (9/38-1.5") * 6PCS

E=  (1 Ring + 1 Square 4 Holes + 9/75-3")*6PCS

F= (1x 40mm Ball + 3 Jewels)*1PC

G=
(24 Jewels Strand)*6PCS

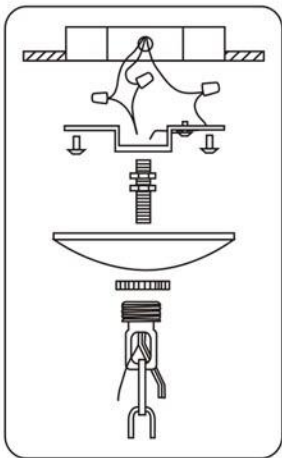

1 Bobeche with
4 **A** Trim.

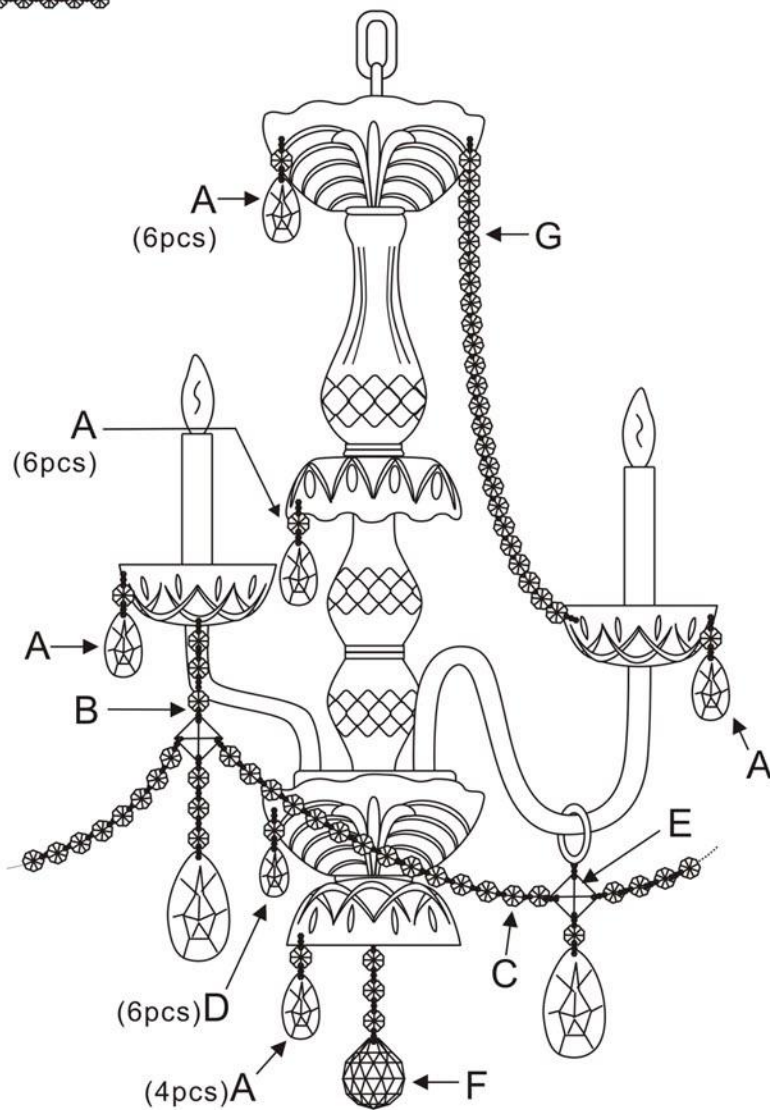
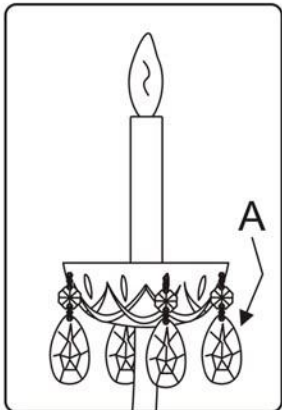

All electrical components must be installed by a licensed electrician in accordance with the National Electric Code and the appropriate local electrical codes.

