

CHAIR SETUP INSTRUCTION

MODEL: CHAIRMAN SWIVEL

Please unscrew all hardware from cushion before assembly.

Step 1

Insert the Gas Lift into the base

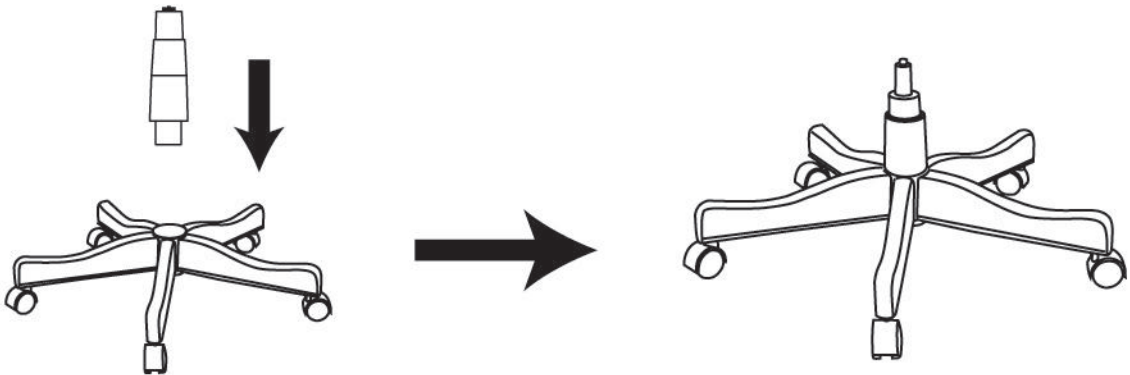

Step 2

Place the Chair onto the Base

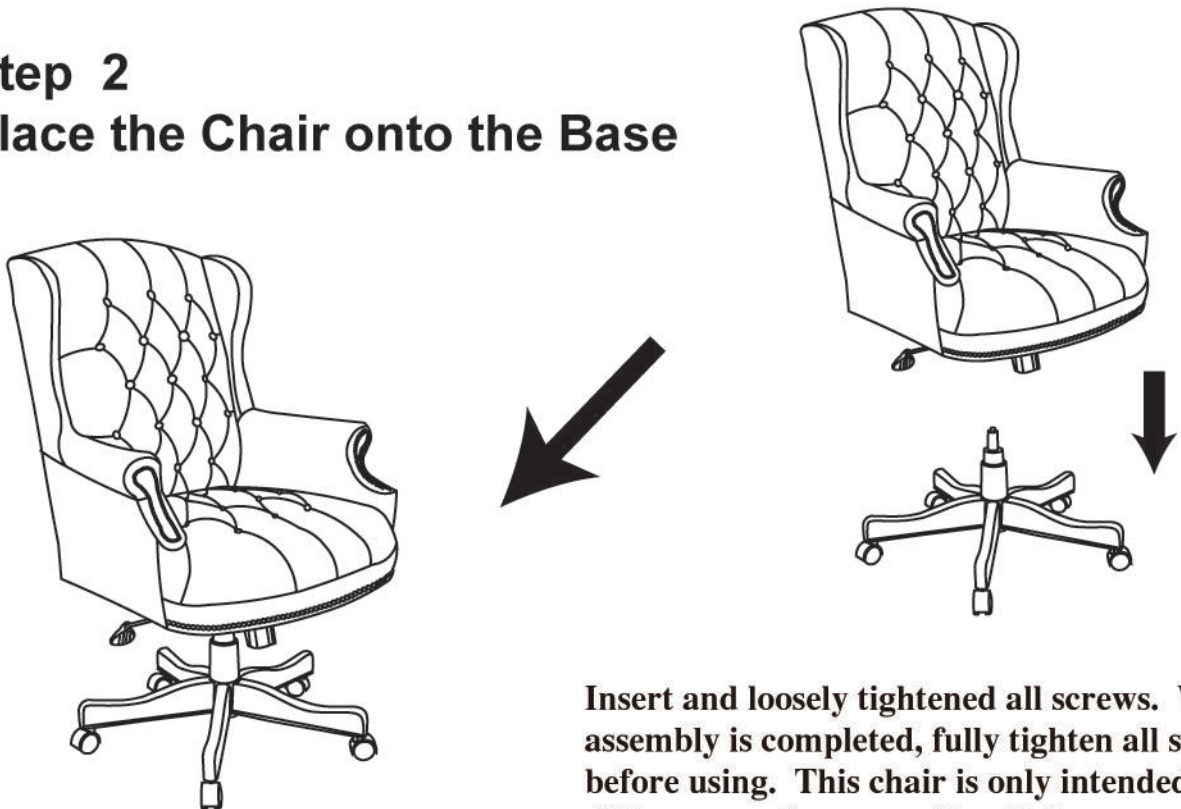

Insert and loosely tightened all screws. When assembly is completed, fully tighten all screws before using. This chair is only intended for sitting, any other use will void the warranty.

If you encounter any problems with the operation of your chair, please refer to the downloads section of our web site

