

## Assembly Instructions

### PACKAGE

(A) 1-Table

### HARDWARE

(H1) 1-Knob

(H2) 1-Screw

(H3) 1-Plastic washer

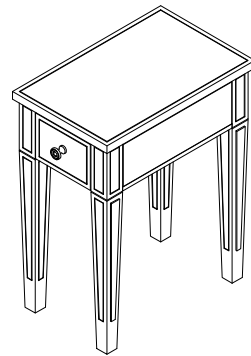

**Read all instructions before starting assembly.**

**Step#1** Attach the knob(H1) to the front of drawer using screw(H2) and plastic washer(H3) as shown below. Securely tighten the bolt with screw driver (not provided) .

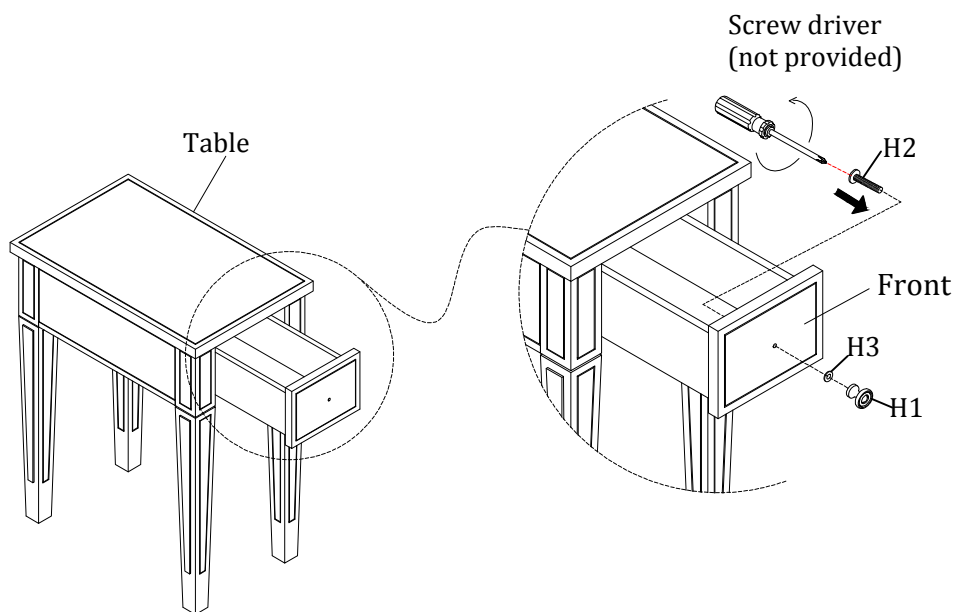

**(\*) Caution: Do NOT OVER TIGHTEN.**

In any correspondence regarding this product, please include the complete identification number located on the underside of the product.

*We hope this will be a useful and decorative addition to your home for years to come.*