

# STANDARD BED

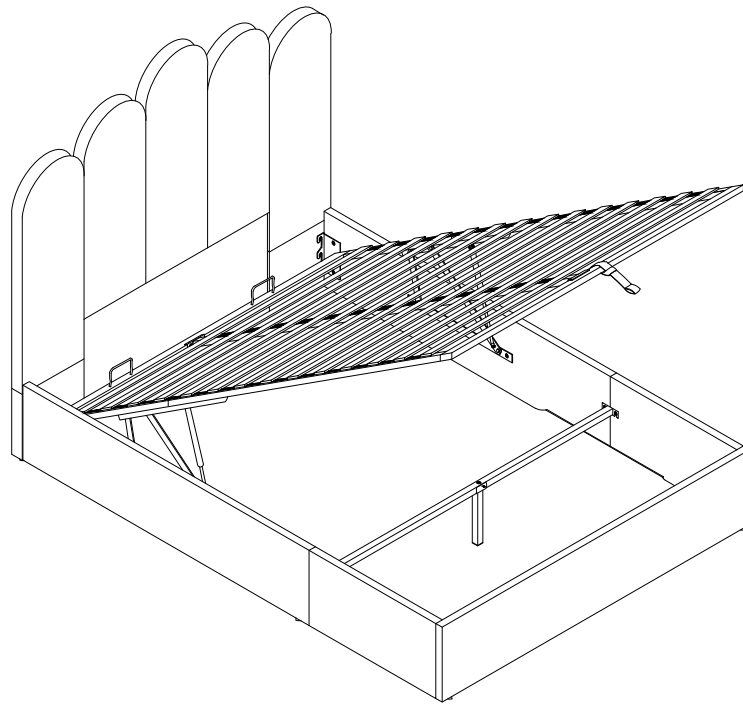

## IMPORTANT NOTE

1. FOR THE PROTECTION OF YOUR FURNITURE, PLACE ALL PARTS ON A CLEAN AND SMOOTH SURFACE TO PREVENT ANY DAMAGE.
2. DO NOT USE POWER TOOLS TO ASSEMBLE THE BED.
3. PLEASE PERIODICALLY CHECK ALL FITTINGS AND RE-TIGHTEN AS NECESSARY.
4. DO NOT USE THE BED UNLESS ALL BOLTS AND SCREWS ARE FIRMLY SECURED.
5. NEED PARTS OR ASSISTANCE? EMAIL US
6. YOU CAN ASSEMBLE IT WITH OUR PACKAGING TOOLS OR WITH A.

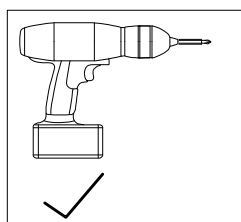

## PART LIST

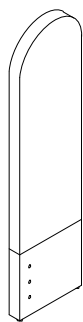

1 x 1pc

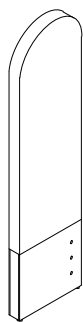

2 x 1pc



3 x 1pc

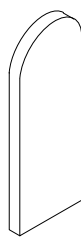

4 x 2pcs

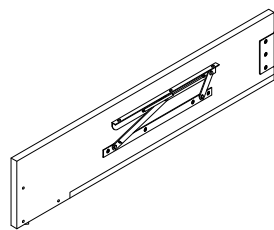

5 x 1pc

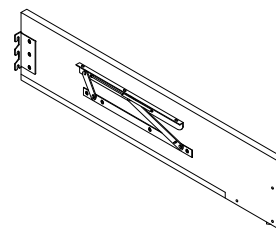

6 x 1pc

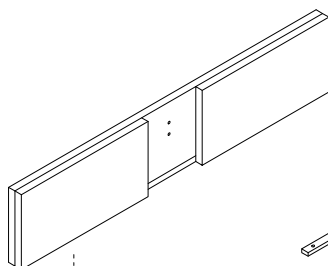

7 x 1pc

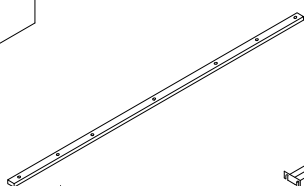

8 x 2pcs

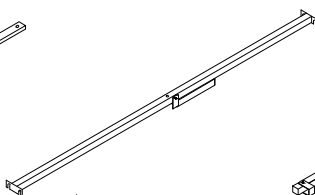

9 x 1pc

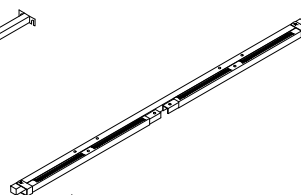

10 x 1pc

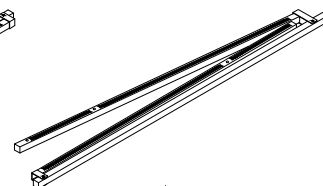

11 x 1pc

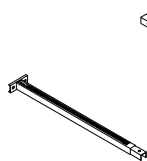

12 x 1pc

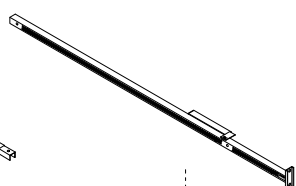

13 x 1pc



14 x 2pcs



15 x 2pcs



16 x 1pc

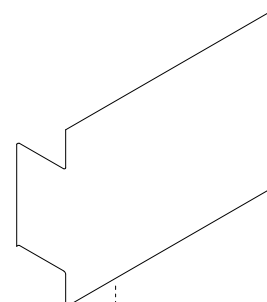

17 x 1pc

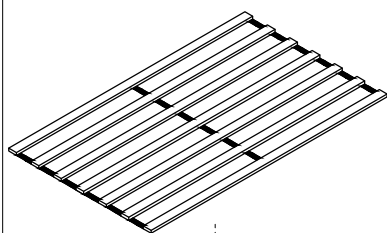

18 x 2pcs

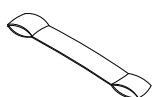

19 x 1pc



20 x 2pcs

## HARDWARE LIST



H1 M5 x 1pc



H2 M8x25mm x 13pcs



H3 M8x35mm x 28pcs



H4 M8x60mm x 2pcs



H5 M8 x 51pcs



H6 M8x17mm x 51pcs



H7 M8 x 6pcs



H8 M14 x 1pc



H9 M8x45mm x 8pcs

1

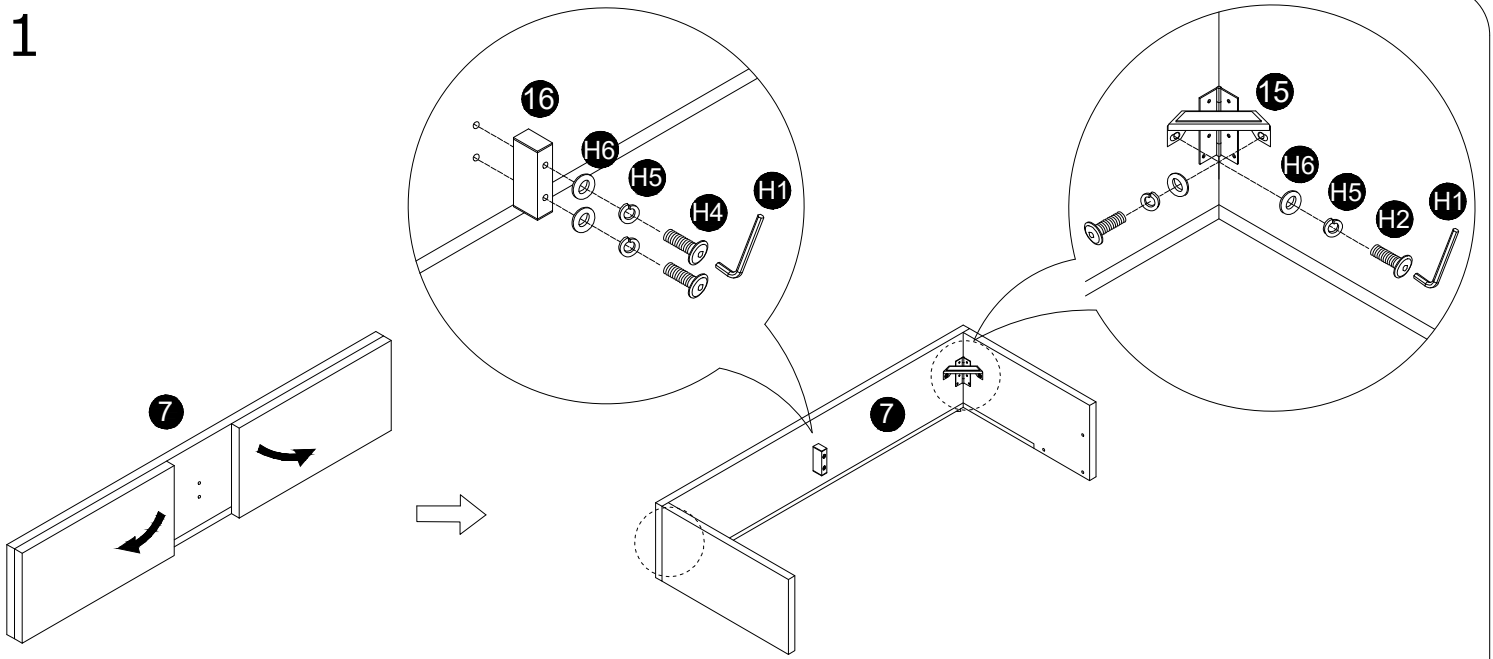

2

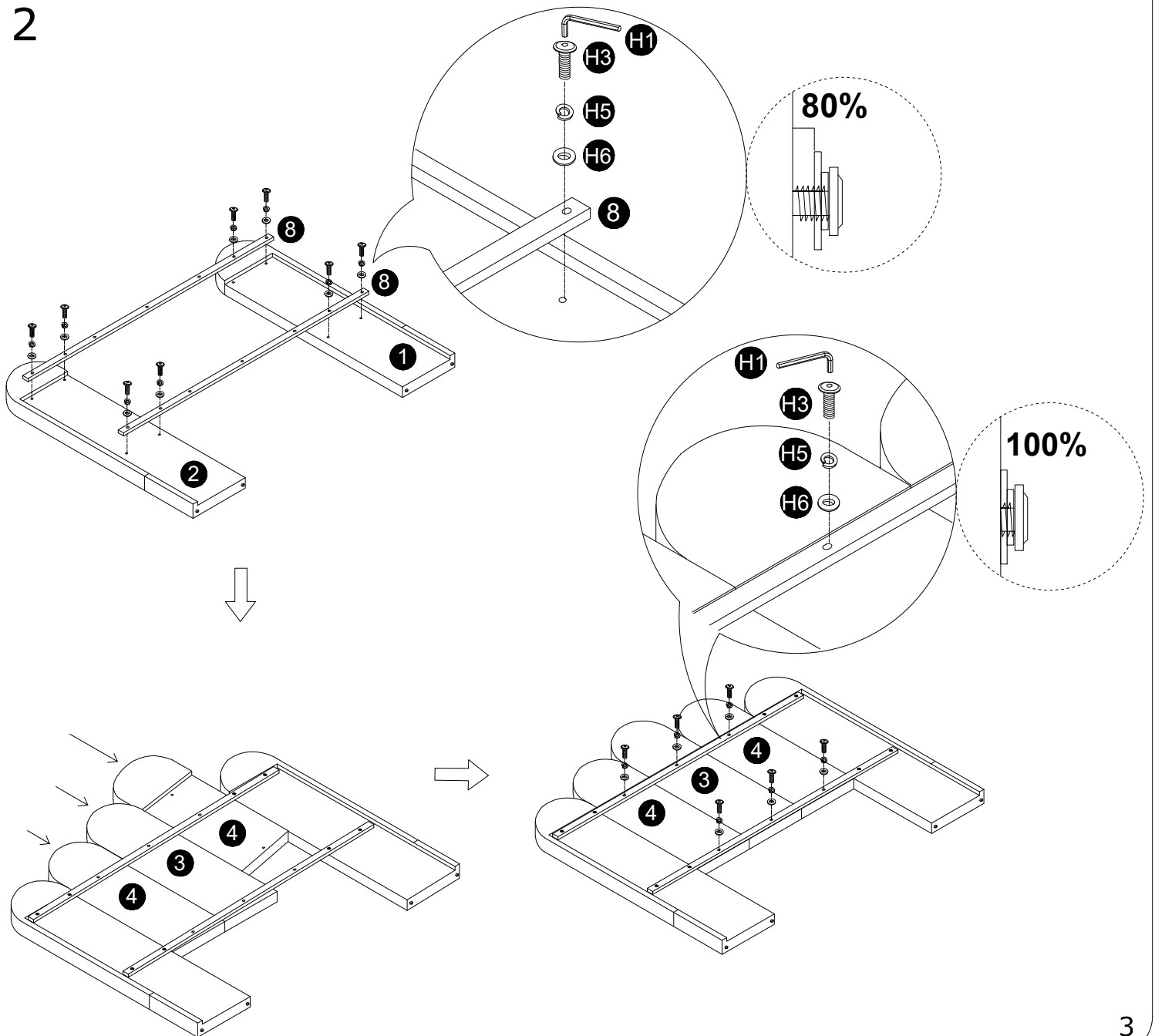

3

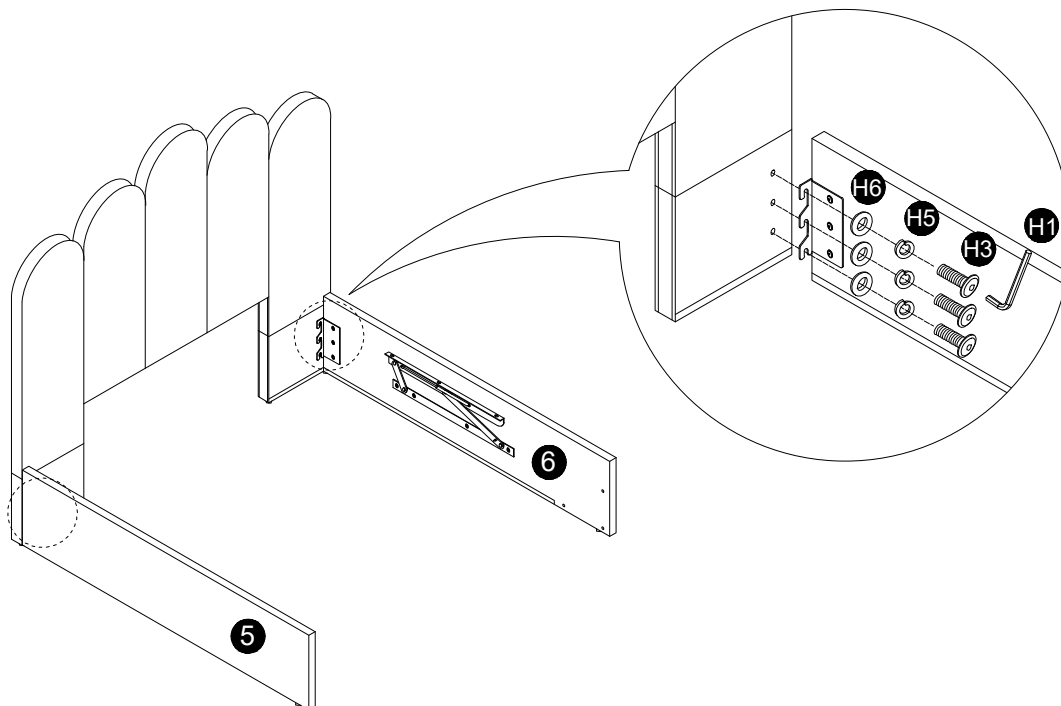

4

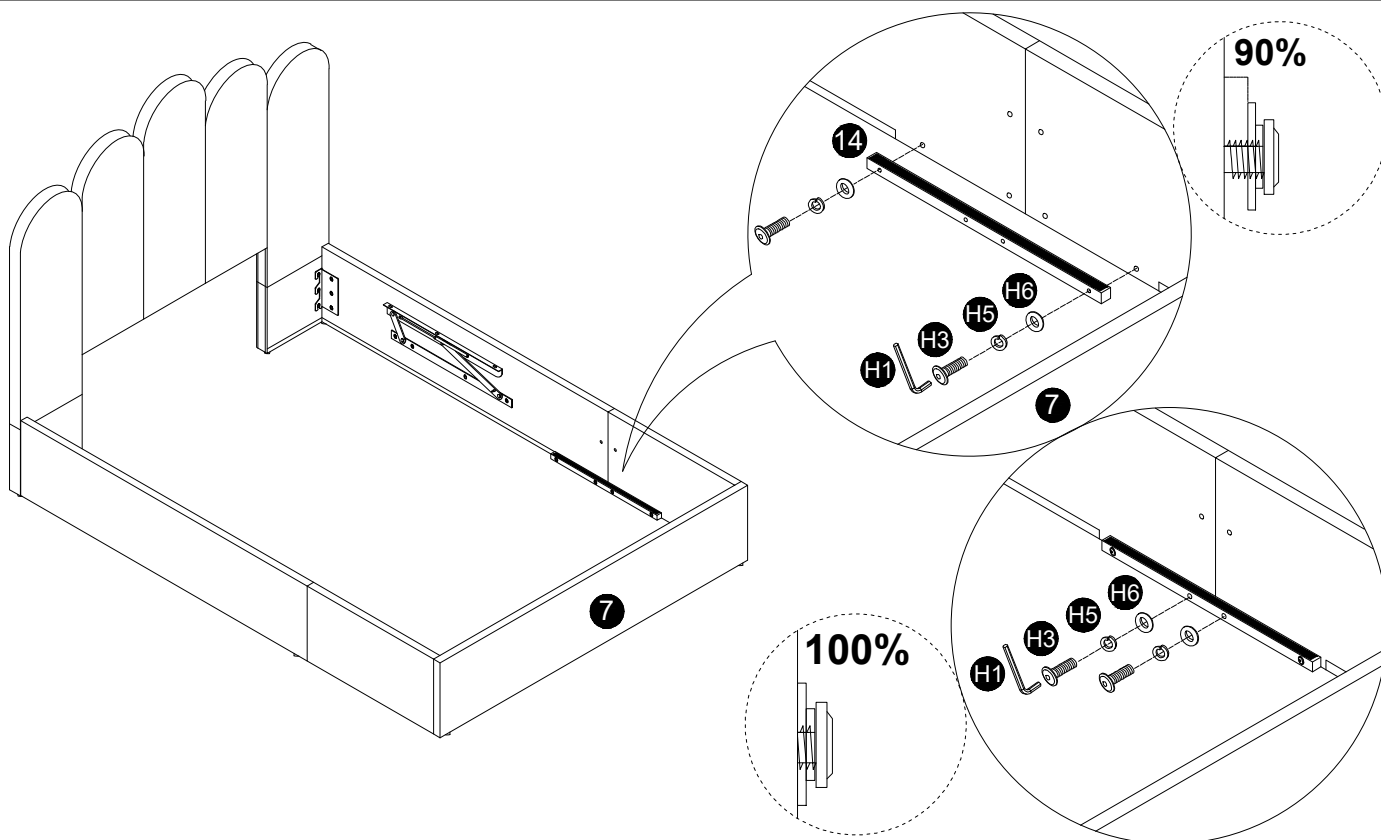

5

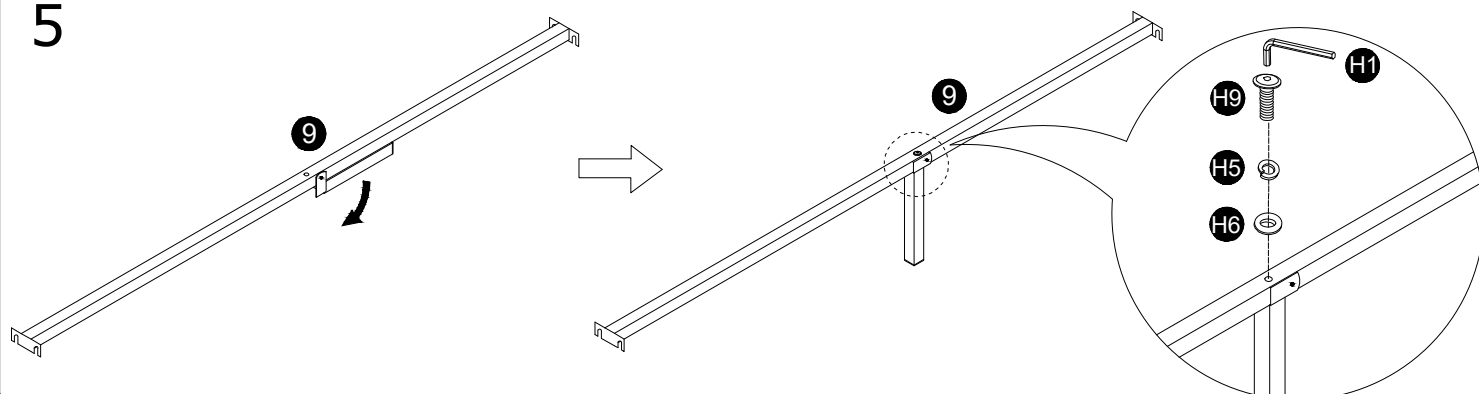

6

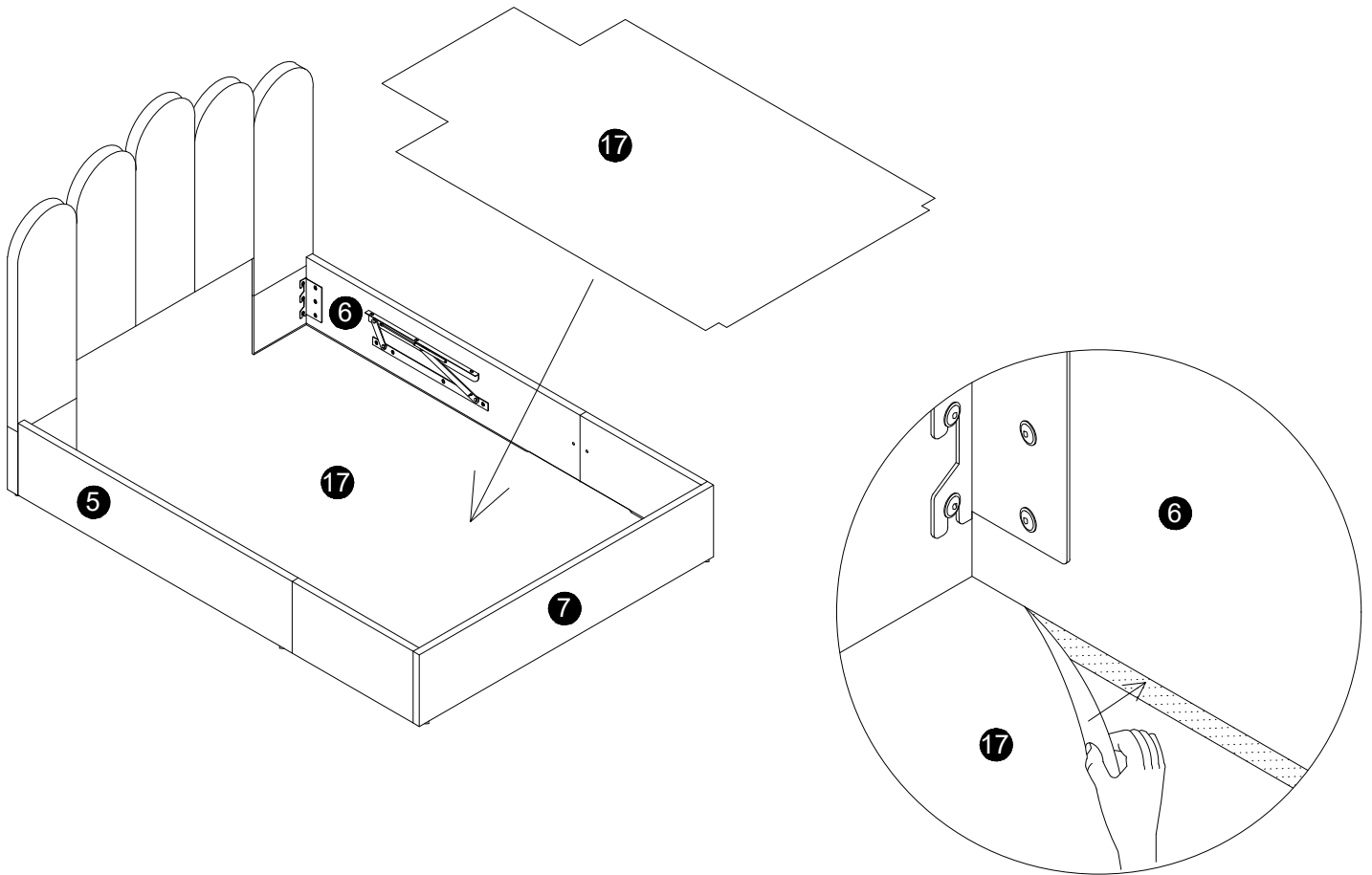

7

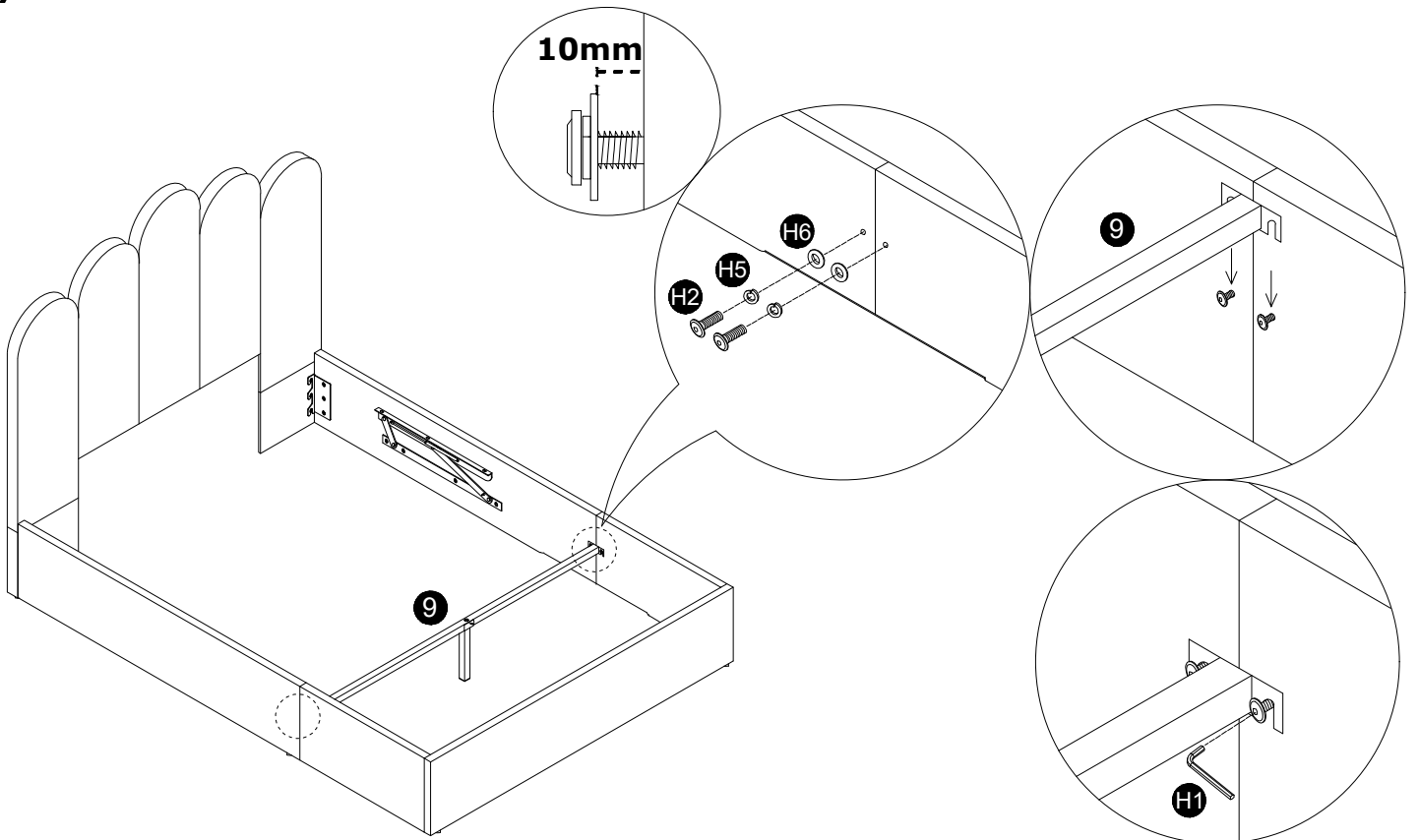

8

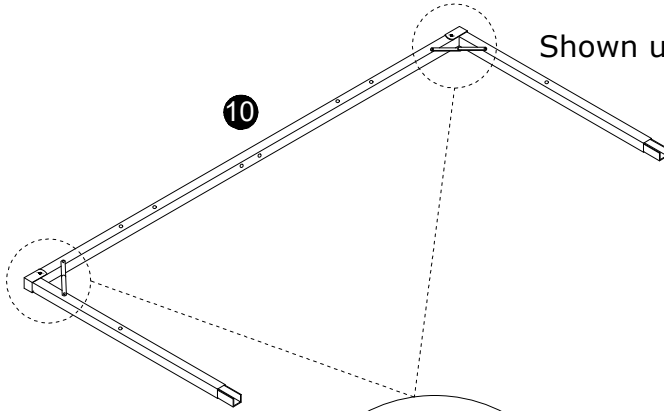
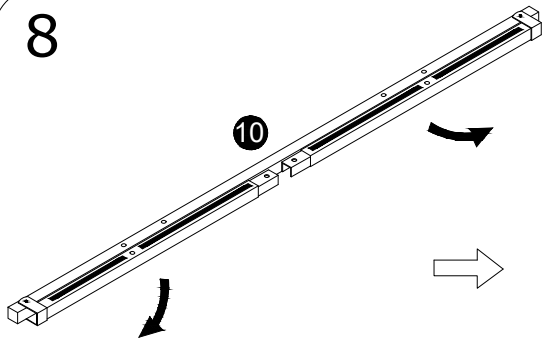

Shown upside down

10

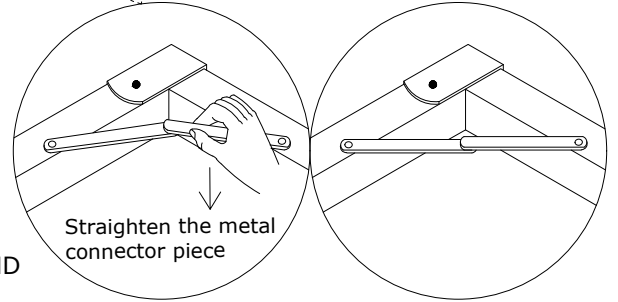

Straighten the metal connector piece

BEWARE OF CLAMP HAND

9

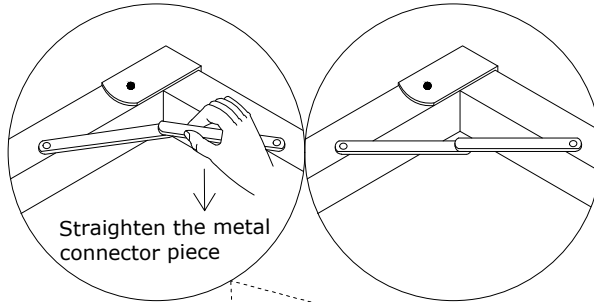
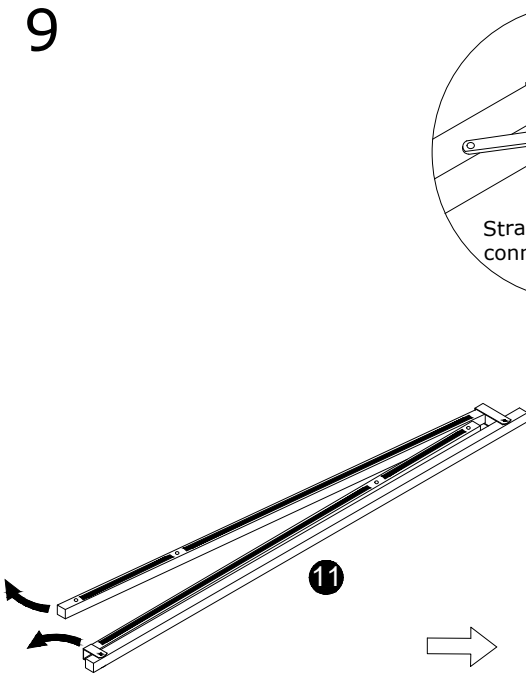

Straighten the metal connector piece

BEWARE OF CLAMP HAND

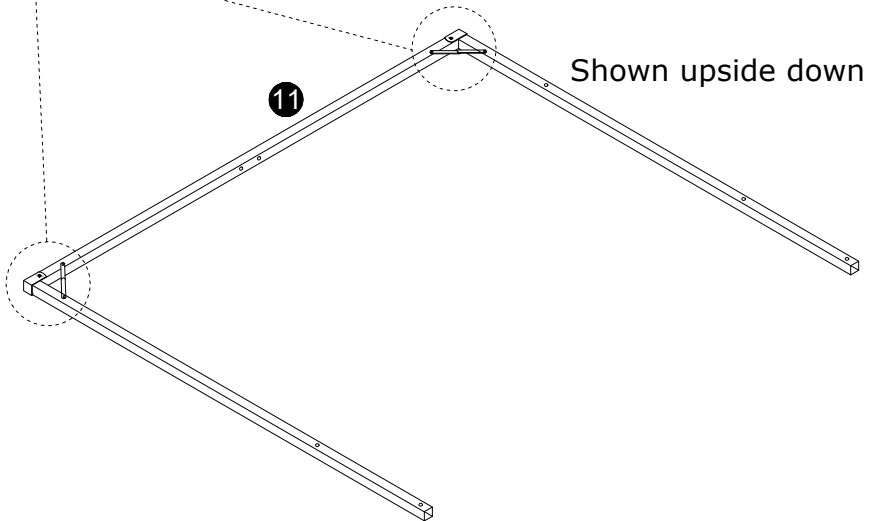

Shown upside down

11

10

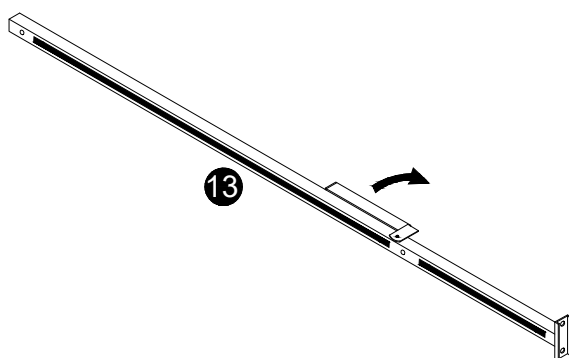

13

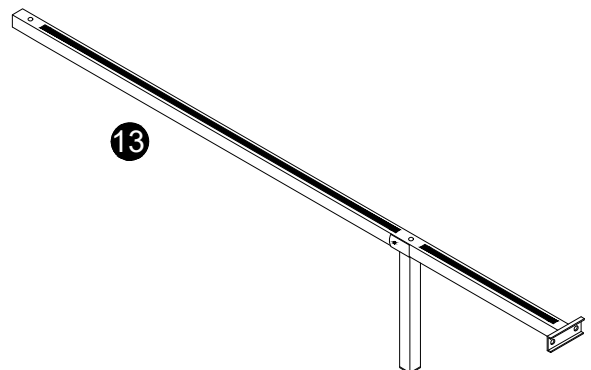

13

# 11

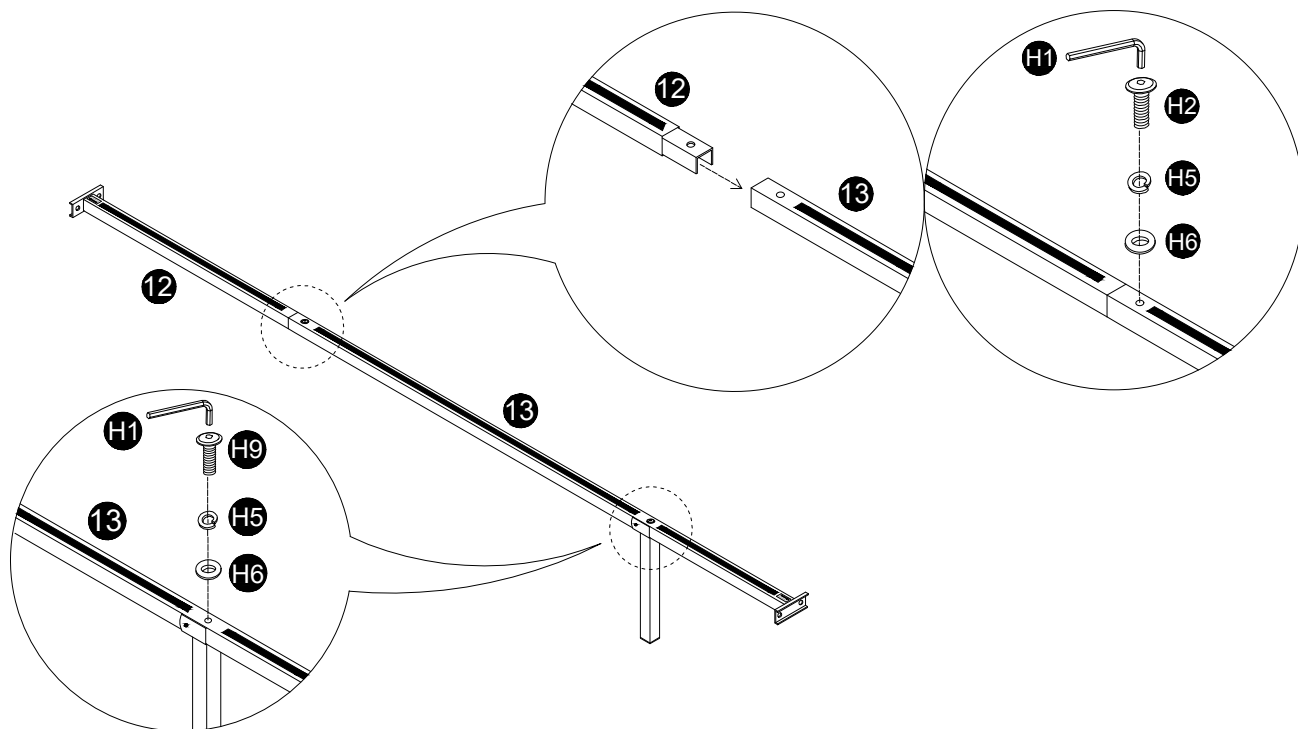

# 12

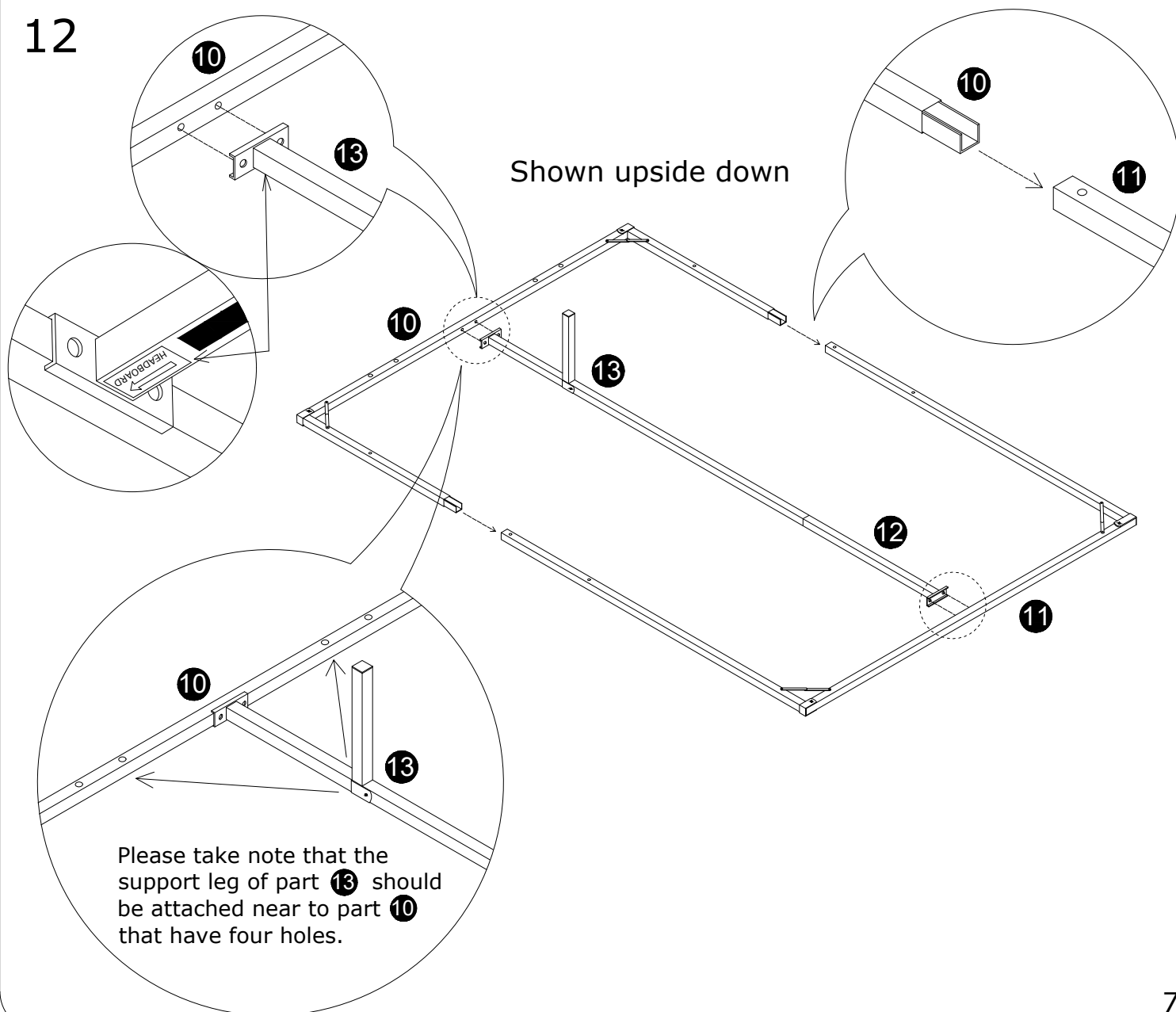

13

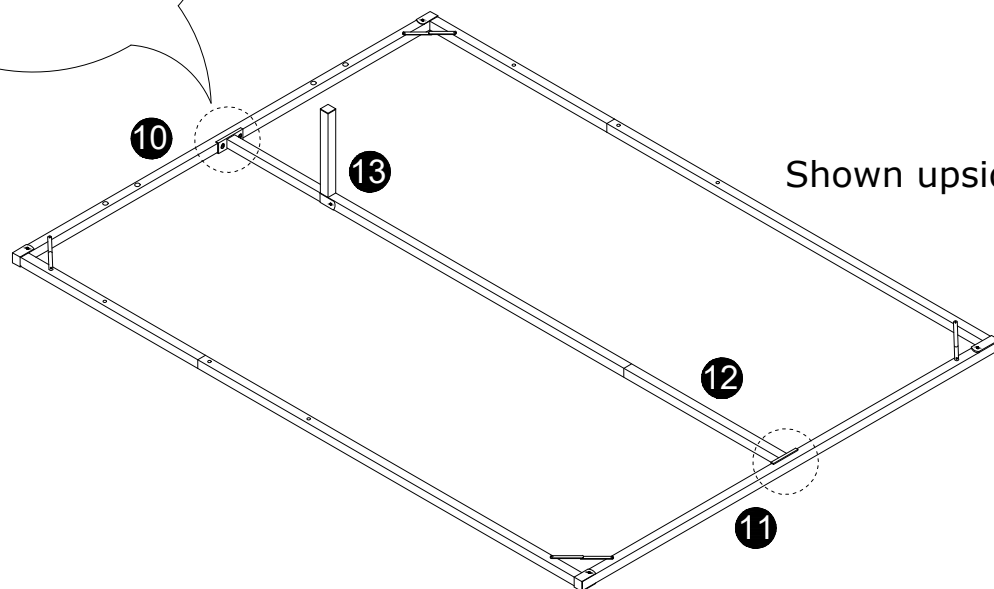
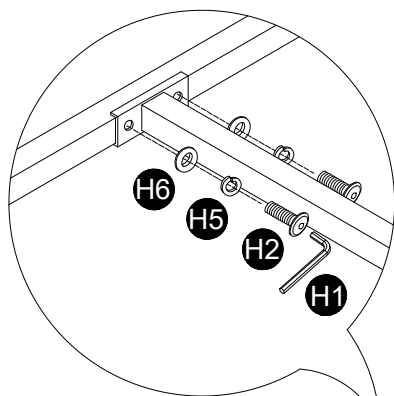

Shown upside down

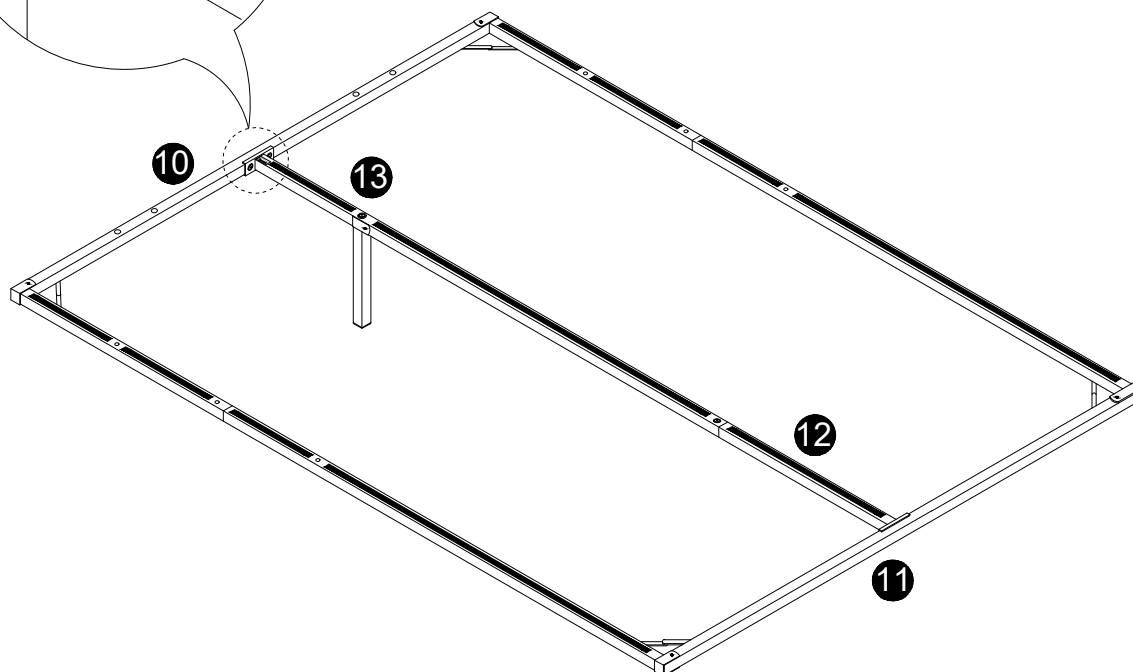
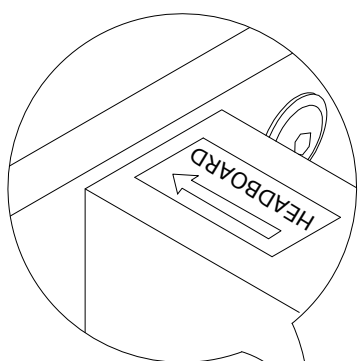



14

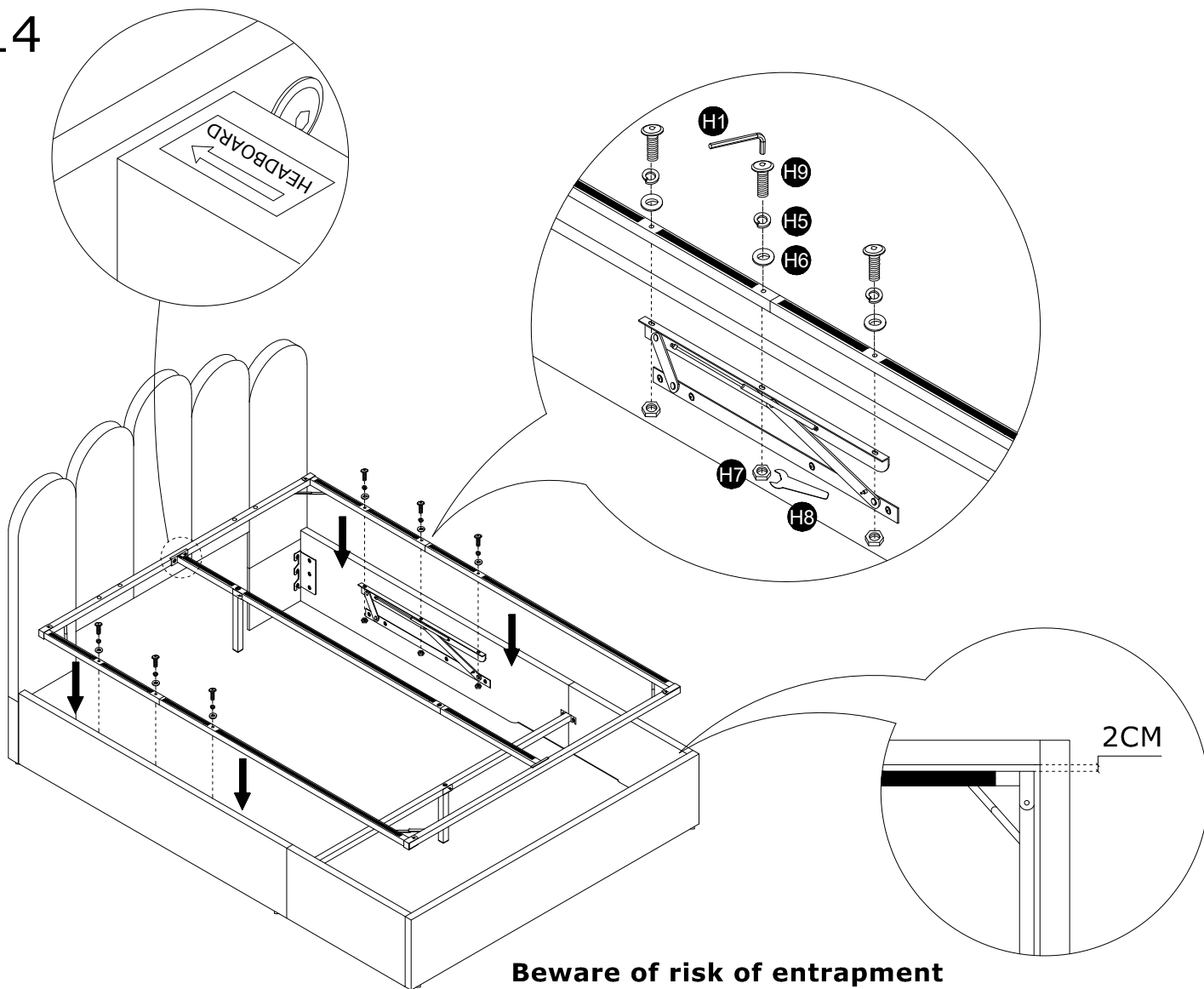

**Beware of risk of entrapment from folding hinges!**

15

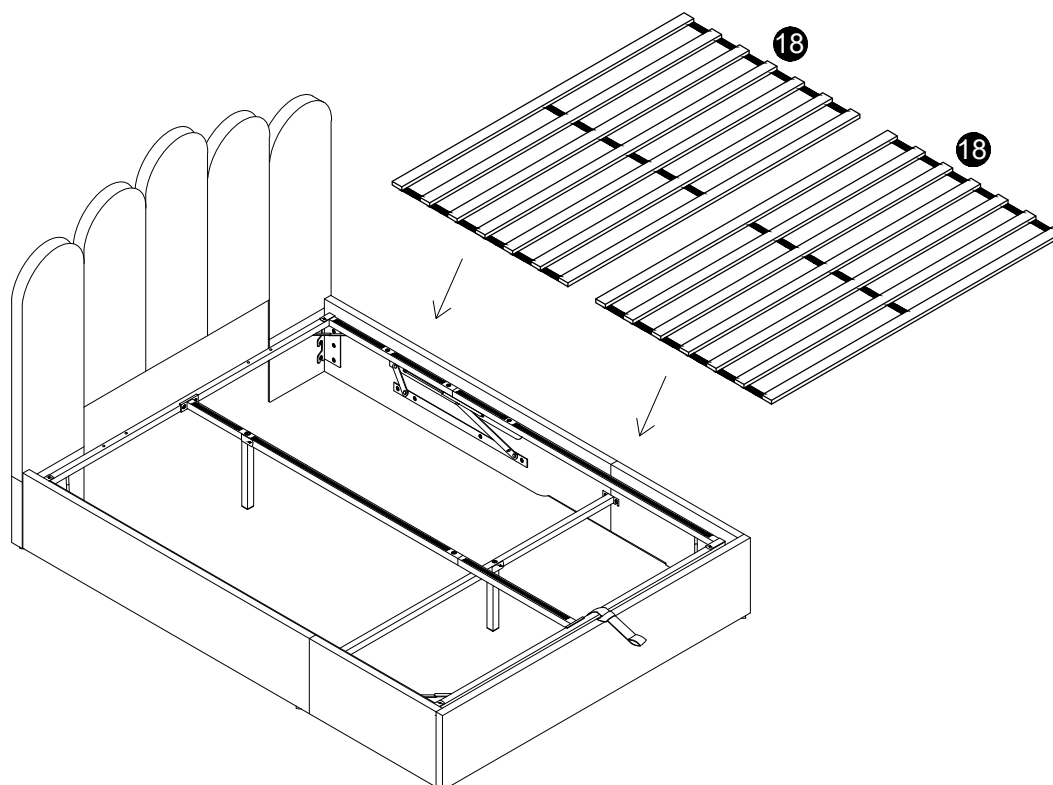

# 16

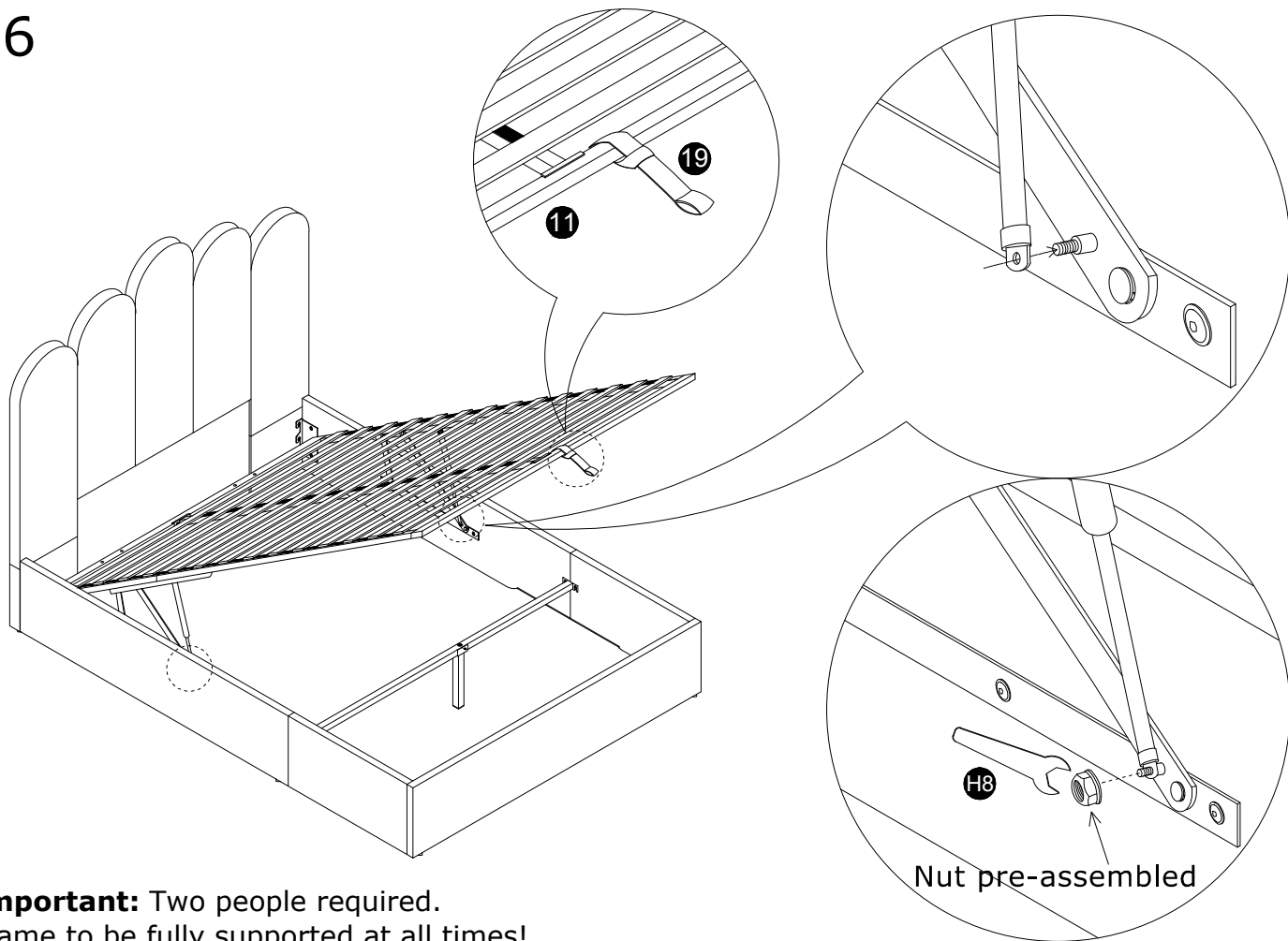

# 17

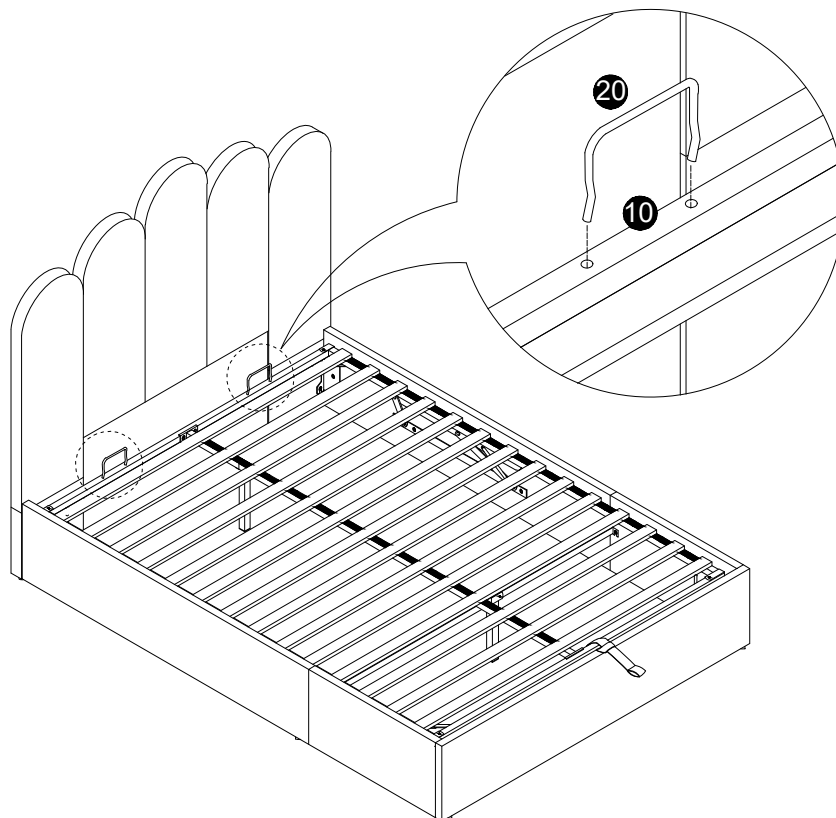

## **Job Complete !**

*In the interest of our environment please dispose of all packaging thoughtfully.*