

Coffee Table

assembly guide

introduction



Valued Customer,

We design and carefully manufacture our products for our customers. We wish that our customers to have fun while they are doing their new furniture.

The product you just purchased was subjected to all sorts of tests and controls before sending out to you.

Hope you enjoy your new furniture!!!



Before starting, please check all components and accessories according to the provided list. If you purchased more than one product, to prevent confusion, be sure that you completed the first product, then start the next one. Please make sure that you select correct numbered part and use specific connector to assemble. We do not recommend any modification or rotation in assembly. Please follow the manual carefully.



Furniture parts are going to several manufacturing procedures. During this process, parts can have little dust or marks. Please clean the parts with damp cloth before assembly to get the best result. Usual cleaning would be suffice.



Although all products are carefully manufactured and packed, sometimes we experience damage during transportation. In such cases,



Do not use your furniture for out of purposes. If you would like to use it out of purpose or would like to do some modification or rotation, please contact us for more details.

Please do not expose your furniture with excessive heat, cold and humidity because product can be affected negatively.

before you start

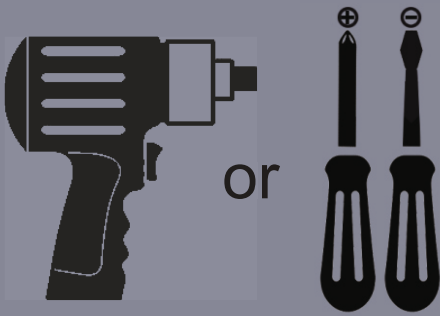

Get required installation tools prepared.

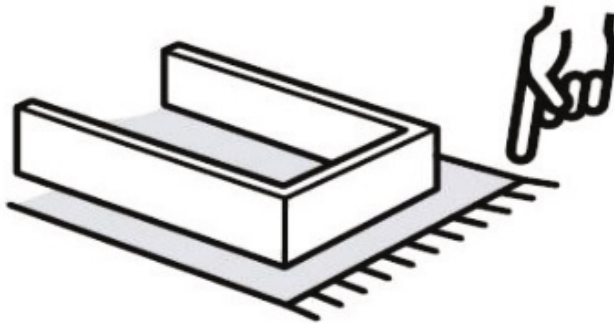
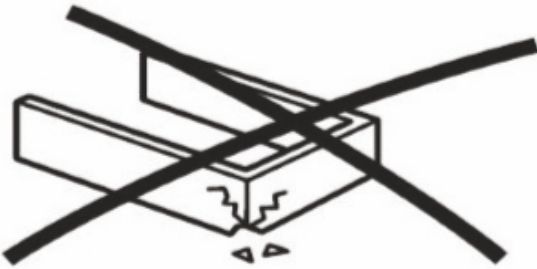
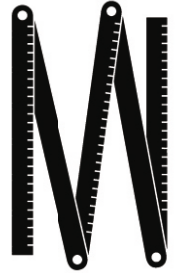

Do not install the product on rough surfaces.

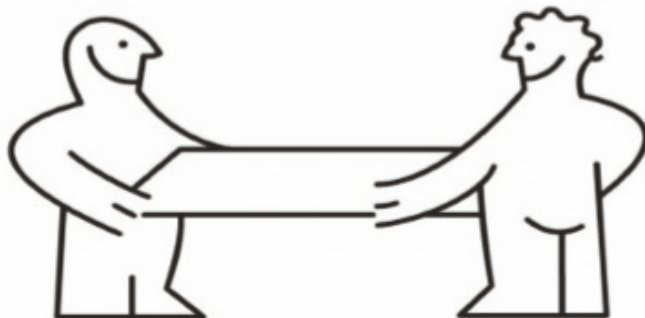

Get help from someone else!

ACCESSORY LIST

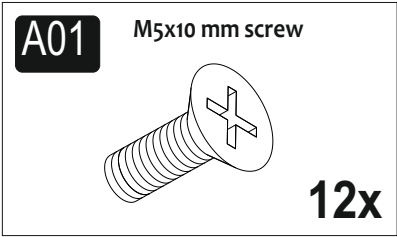

GENERAL VIEW

Part1	1x
Part2	1x
Part3	1x
Part4	1x
Part5	1x
Part20	1x
Part21	1x
Part22	3x
TOTAL	10x

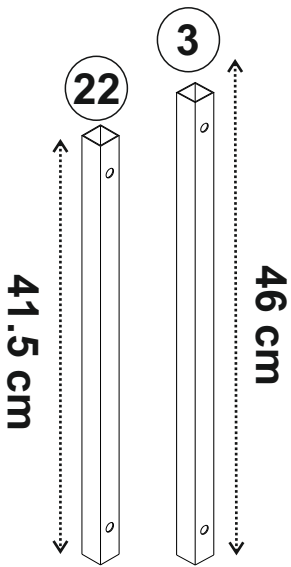
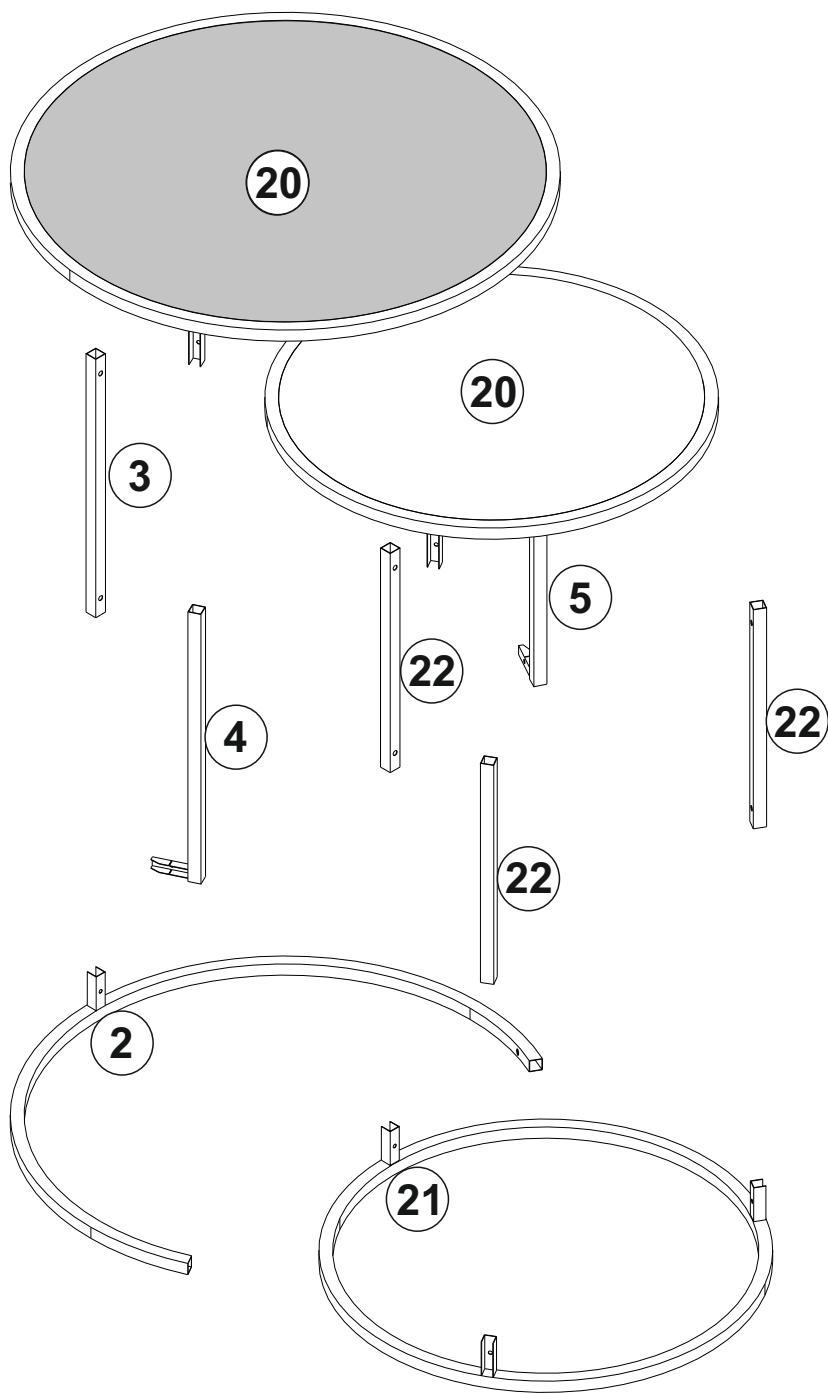

1 step a

*Please insert the metal pieces #22 onto the piece #21 as shown below



Please install the all the metal bars the way both holes will face the same direction

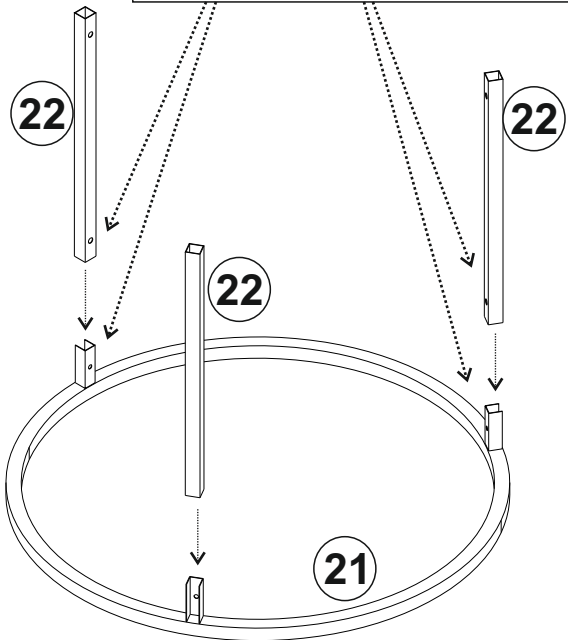

before installation

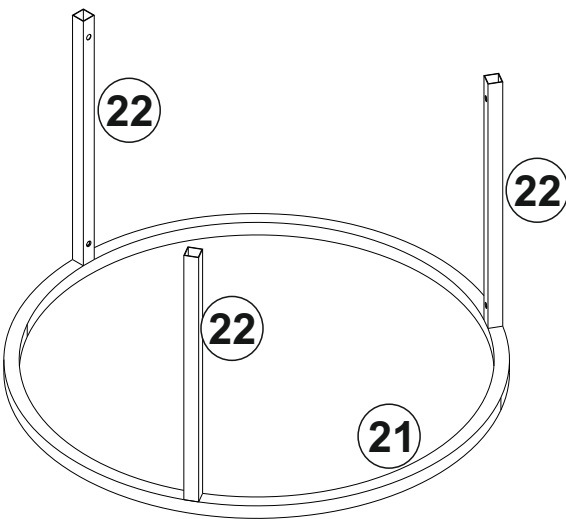

after installation

2 step b

*Please push **the part we installed in step a** from specified points with both of your hands against the floor as shown below

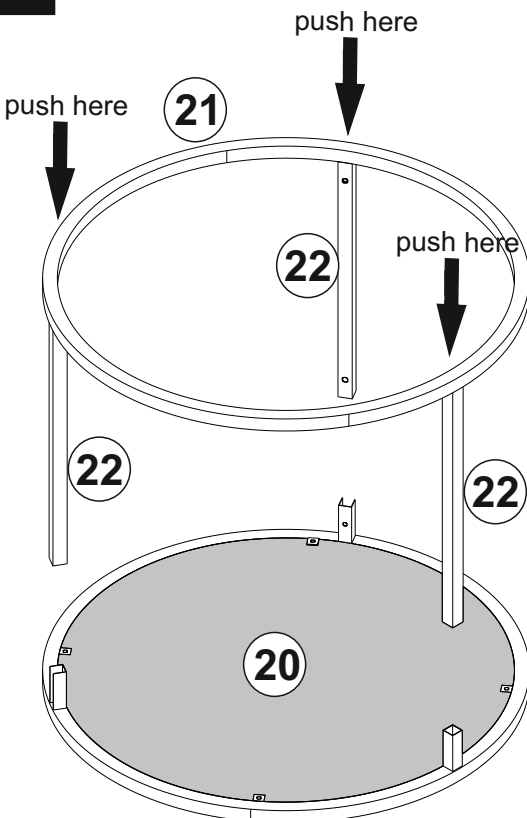

While inserting metal the pieces #22, you may need to apply force



After you pushed the metal bars ,some paint dust appear on the floor.Don't worry!

3 step c

*Please screw the A1(M5x10 mm screw) clockwise direction with help of a screwdriver as shown below

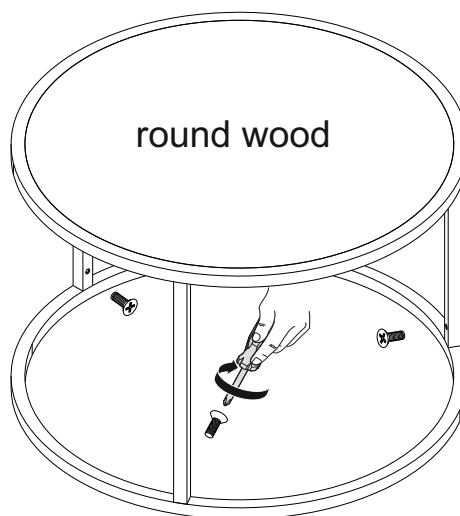
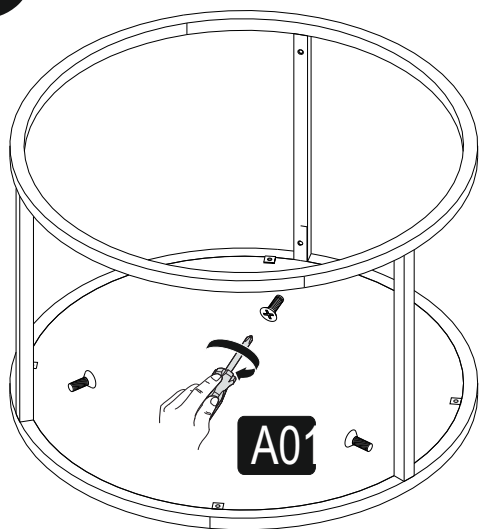

4 step d

*Please insert the metal pieces #3,#4 and #5 onto the piece #2 as shown below

push here



While inserting metal the piece # 3, you may need to apply force



Please install the all the metal bars the way both holes will face the same direction

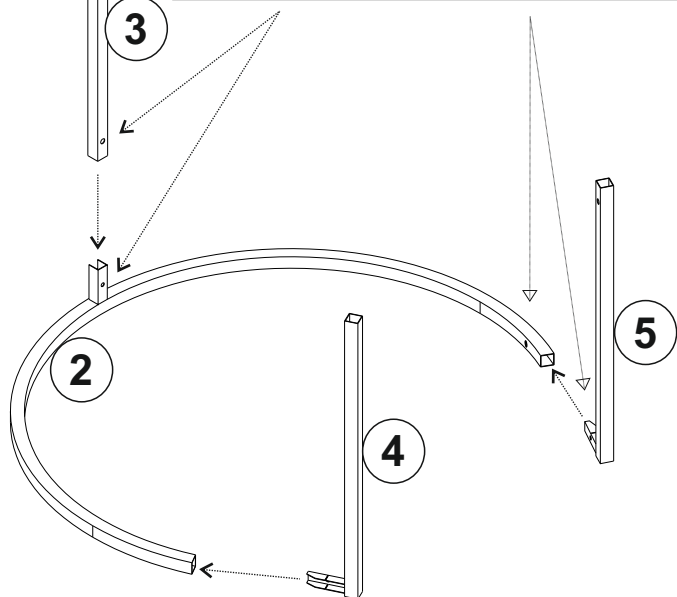

before installation

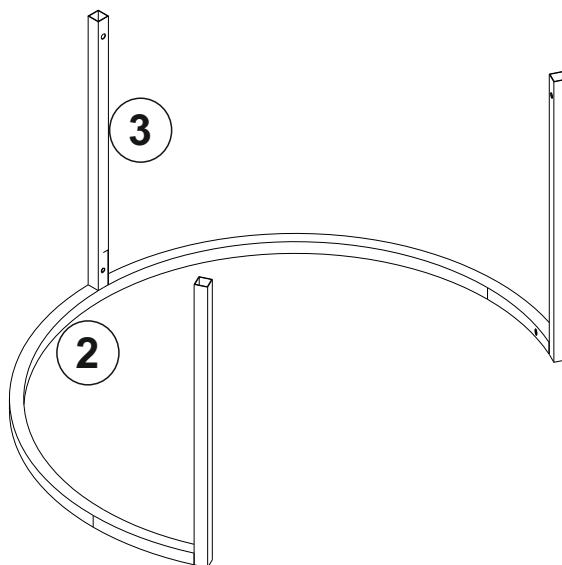

after installation



After you pushed the metal bars ,some paint dust appear on the floor.Don't worry!

5 step e

*Please push **the part we installed in step d** from specified points with both of your hands against the floor as shown below



After you pushed the metal bars ,some paint dust appear on the floor.Don't worry!

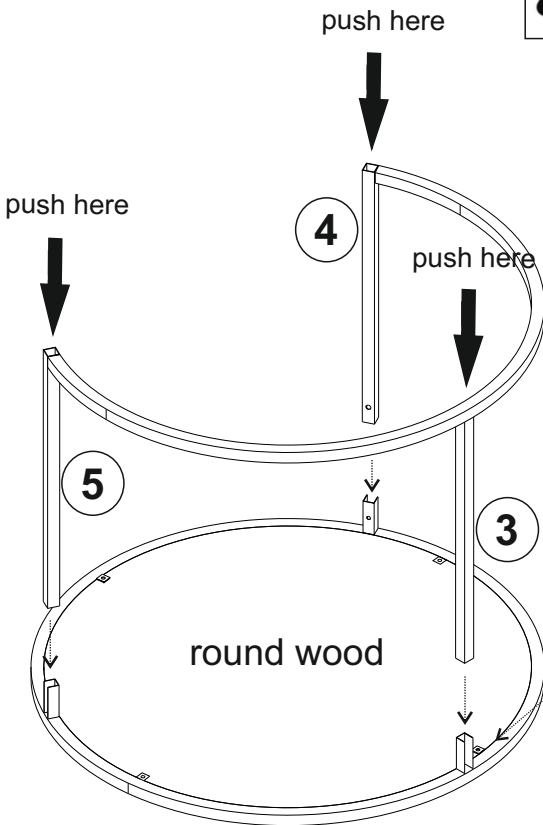

Please put the piece #3 onto the reference point.

6 step f

*Please screw the A1(M5x10 mm screw) clockwise direction with help of a screwdriver as shown below

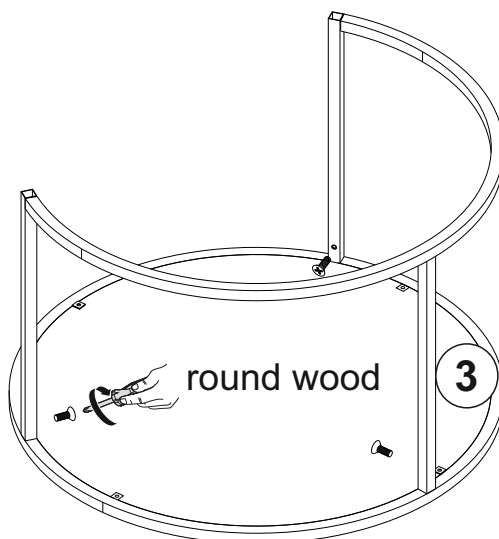
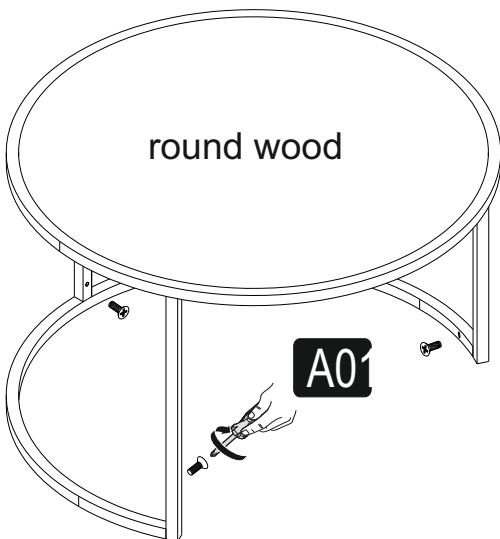

final look

