

Bathroom Accessories Installation Instructions

[B Style Accessory]

HELPFULL TOOLS



NOTICE:

1. Clean with the water and soft cloth usually.
2. Avoid contact with any acid detergents.
3. Recommend installing the towel holder with 3 screws and make it more stable.
4. If you have any problems during installation, please contact with us.
E-mail: sophia.lfy@hotmail.com

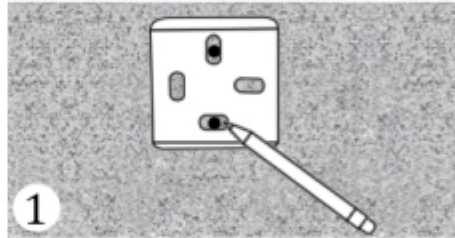

1 Choose the installation position, use pencil to draw the position of the screw hole in the gasket.

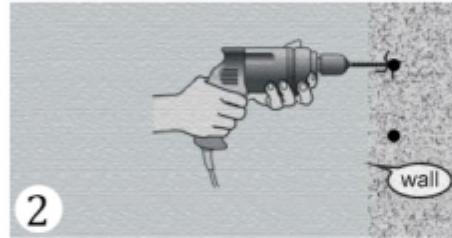

2 Measure the center distance of the hole on the wall first, then drill the hole.

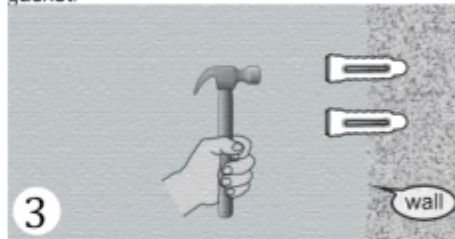

3 Hammer the anchor into the wall.

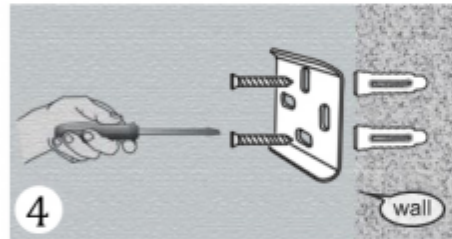

4 Place the gasket on the wall hole and insert the screw into the hole, then fasten with the philips screwdriver.

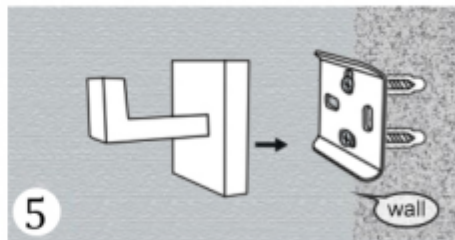

5 Put the hardware body onto the base gasket.

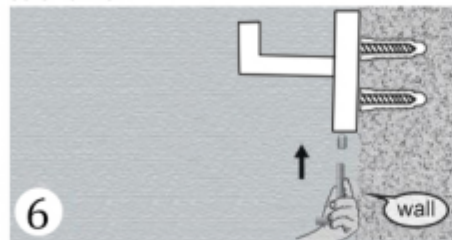

6 Fasten the hex screw with the hex wrench.