

Table lamp

Please refer to the video page for the installation video

■ Specification

Voltage: 110-130V
Wattage: 60 Watt Max
Material: Glass & Crystal
Lamp holder: E26

Bulb info: A19 6W 2700K
Wire Length: 59in/1500mm
Usage: Indoor use only

■ Package

1 x Lampshade
1 x Lamp Base
1 x User Manual
x Finial
x Harp

■ Easy Installation

How to Assemble the Lamp Shade

- 1. Attach the Socket:** Screw the socket (the "neck" with the threaded opening) onto the lamp body.
- 2. Insert the Harp:** Fit the harp (the U-shaped wire frame) over the socket.
- 3. Install the Bulb:** Screw in the light bulb.
- 4. Place the Shade:** Set the fabric lampshade on top of the harp.
- 5. Secure with Finial:** Fasten the shade in place by screwing the decorative finial (knob) onto the top of the harp.

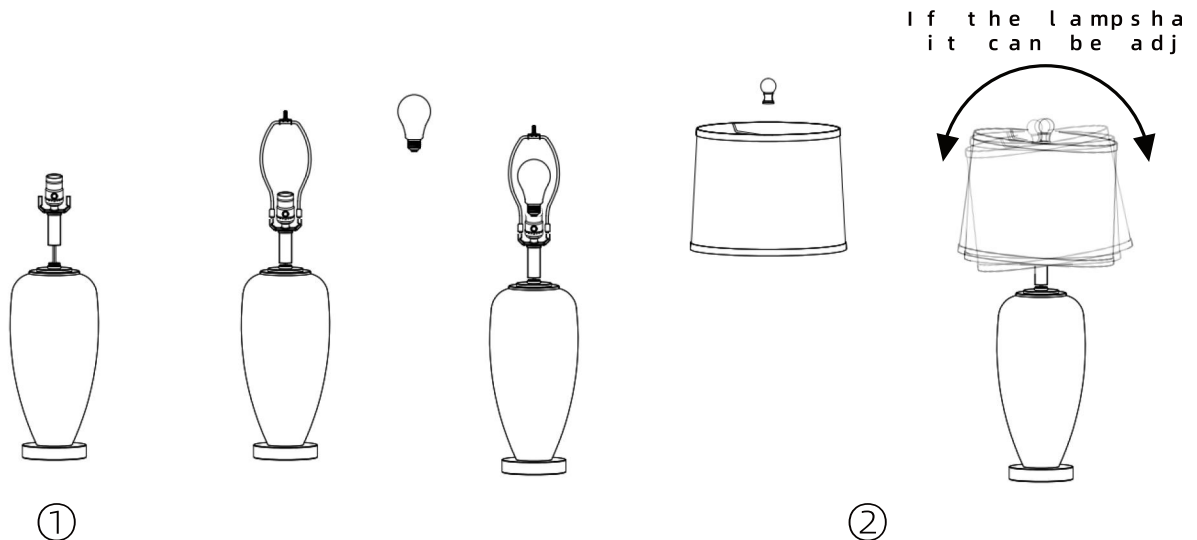

■ Attention

1. If you want to replace the included 2700K vintage LED bulb, it is recommended to use an incandescent bulb with a maximum wattage of 60 watts.
2. The bulb will increase the brightness when it is reaching its lifespan or has partial short-circuit. At that moment, please switch off, change a bulb and use it as you would normally.
3. Please shut off the power and unplug it before you screw in a new bulb.
4. Don't put the lamp in overheating working condition or cast it into fire.