

INSTRUCTION MANUAL

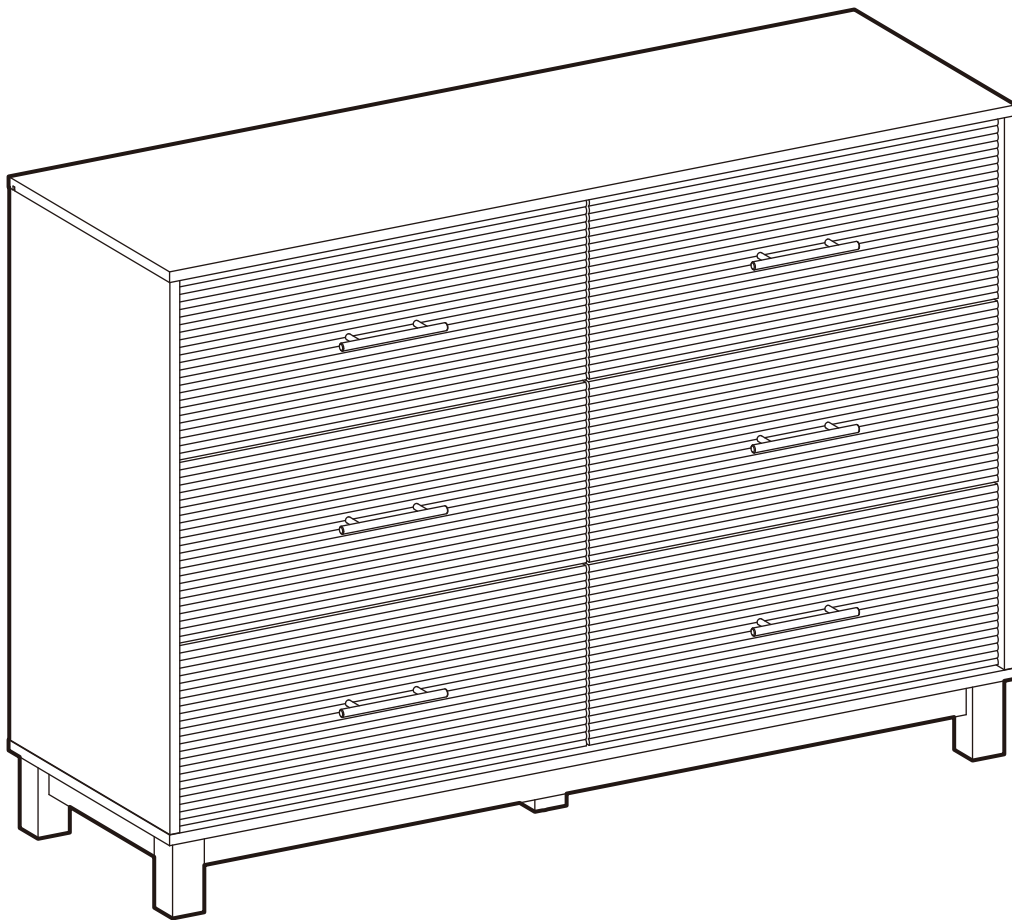

Dresser

Important Safety Information

- Please carefully read all instructions before attempting installation. If you do not understand the instructions or have any questions or concerns, please call technical support or email customer service.
- Before starting assembly, verify all parts are included and undamaged. Do not use damaged or defective parts. If you require replacement parts, please call technical support or email customer service.
- This product contains small parts that may pose a choking hazard.
- Avoid potential injuries and property damage that may be caused by furniture tip-over.
- Do not place a TV or other heavy objects on the top of this product.
- To avoid instability, place heaviest items in the lowest drawers, and never open more than one drawer at a time.
- Do not allow anyone to stand on top of this product.
- Never allow children to climb or hang on the product. To avoid head injury, do not allow children to play underneath open drawers.
- Due to the absence of drawer stops, never allow children to pull the drawer out, which may lead to the drawer falling and causing injury.
- In order to prevent this product from tipping over, it must be used with the wall attachment device provided. Use of tip-over restraints may only reduce, but not eliminate the risk of tip-over.
- Do not use this product for any purpose that is not explicitly specified in this manual. We are not liable for damage or injury caused by improper mounting, incorrect assembly, or inappropriate use.

Care and Maintenance

- Please clean the product with a damp cloth or mild detergent.
- Do not use bleach or other abrasive cleaners.

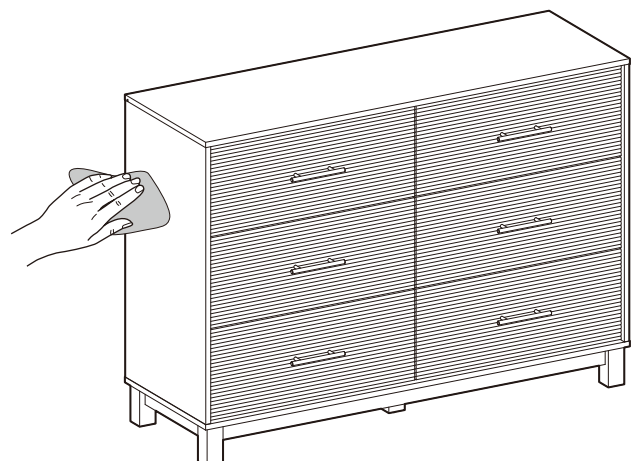

Installation Tips

- It is recommended that at least two people install this product together.
- Make sure you have enough space to lay the parts out before assembling.
- To avoid scratches, assemble this product on unfolded cardboard or a soft surface.

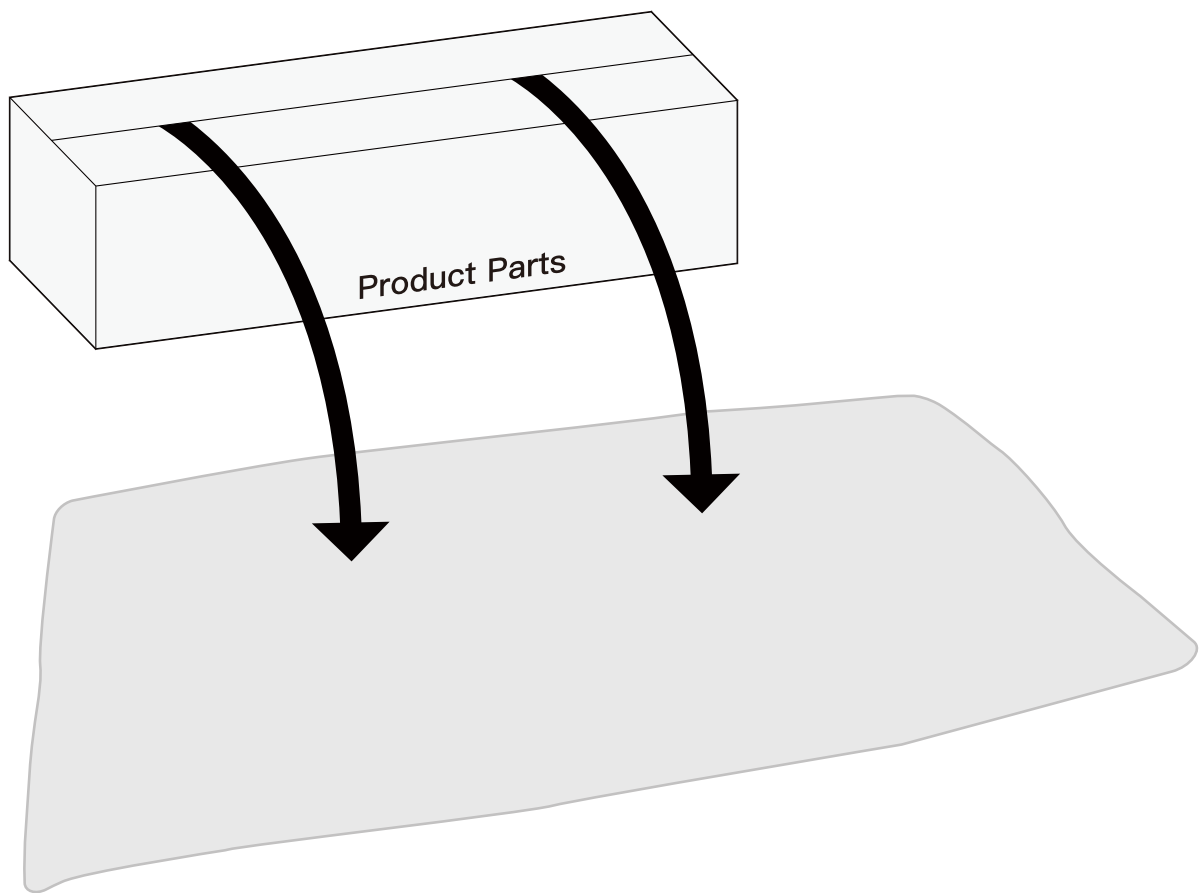

Tools Needed (Not Included)

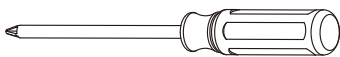

Phillips Screwdriver

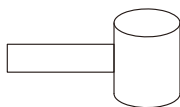

Rubber Mallet

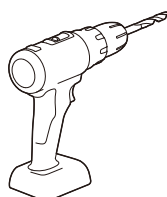

Electric Drill



Hammer

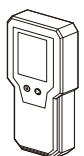

Stud Finder
(Optional)

How the Assembly System Works

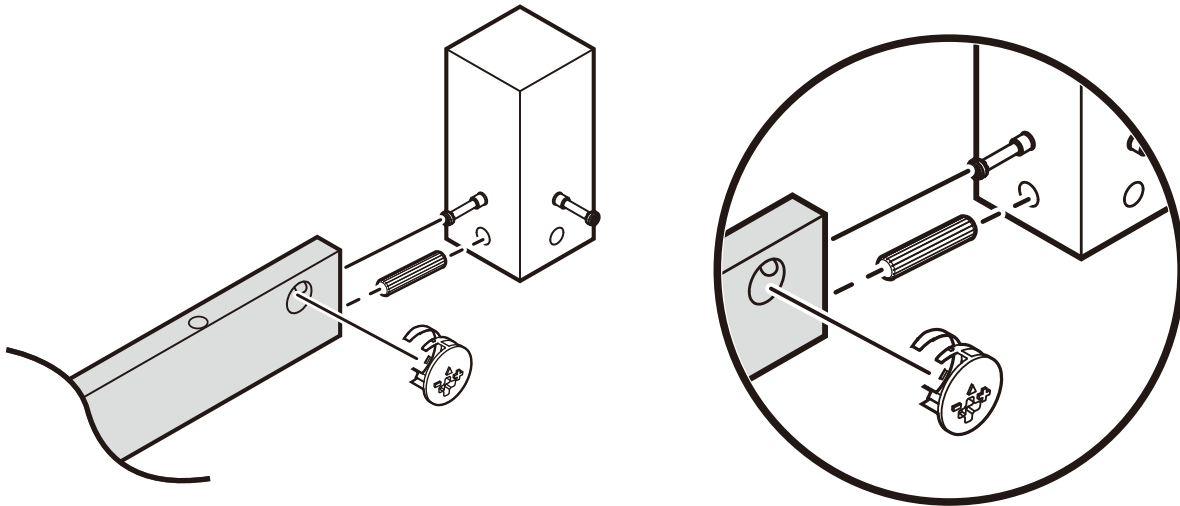

How to Install Wood Dowels

Insert the wood dowel [C] at least halfway into the hole. IF NECESSARY, lightly tap the wood dowel with a self-supplied rubber mallet.

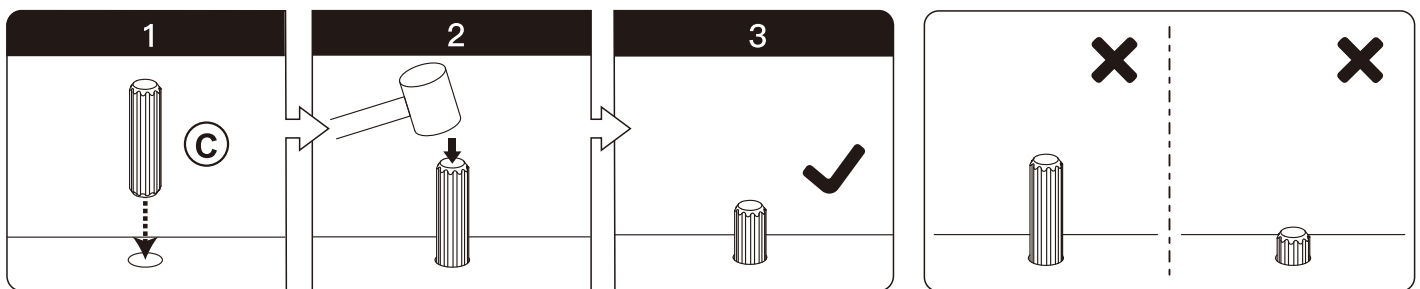

Using the Cam Lock System

1. Screw cam bolt [A] into threaded hole on the panel.
2. Connect both panels together. Make sure cam bolt [A] goes into the pre-drilled hole on the end of the panel for cam lock [B1/B2].
3. Insert cam lock [B1/B2] into large hole on the panel. Make sure the open slot on cam lock [B1/B2] faces the head of cam bolt [A].
4. Turn cam lock [B] clockwise to tighten.

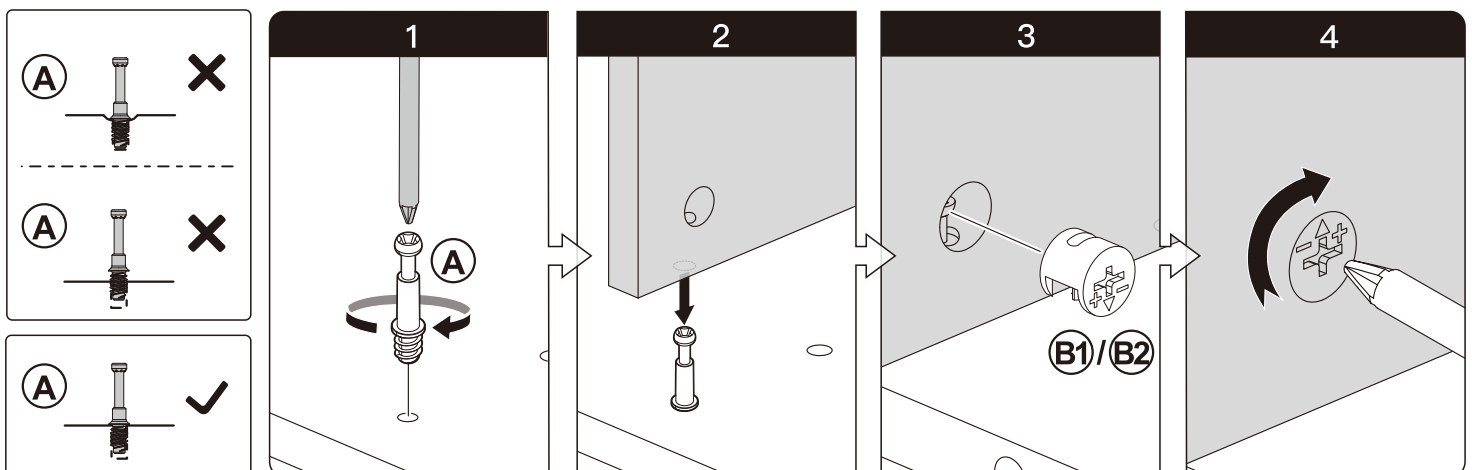

You are now ready to assemble the unit.

Exploded Drawing

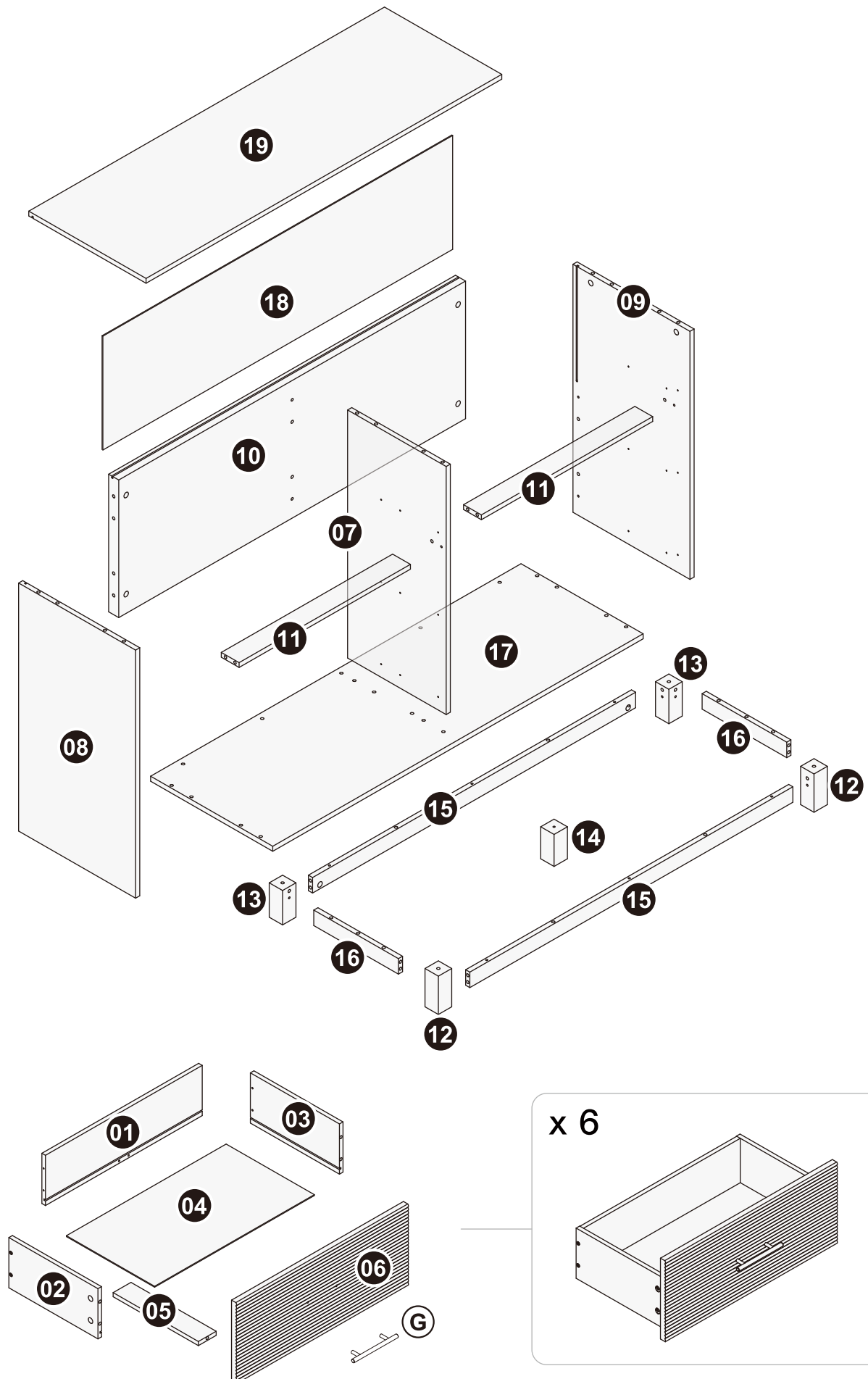

Supplied Parts and Hardware

01 x 6

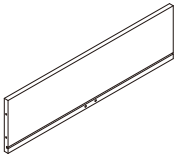

Drawer Back Panel

02 x 6

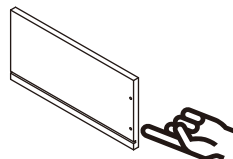

Drawer Side Panel (L)

03 x 6

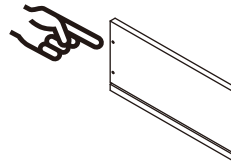

Drawer Side Panel (R)

04 x 6

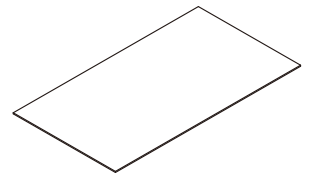

Drawer Bottom Panel

05 x 6

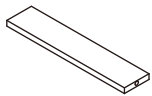

Drawer Bottom Support

06 x 6

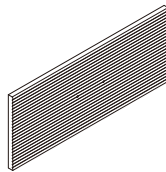

Drawer Front Panel

07 x 1



Middle Panel

08 x 1

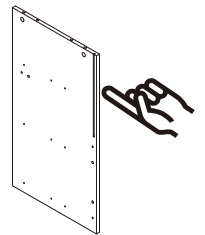

Left Side Panel

09 x 1

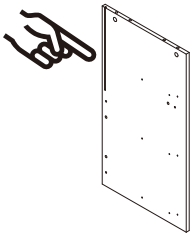

Right Side Panel

10 x 1

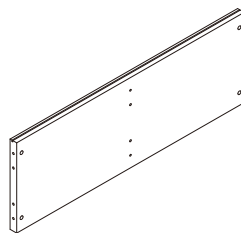

Back Panel

11 x 2

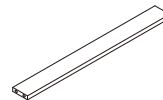

Center Rail

12 x 2

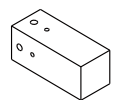

Front Leg

13 x 2

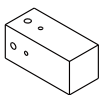

Back Leg

14 x 1



Middle Leg

15 x 2

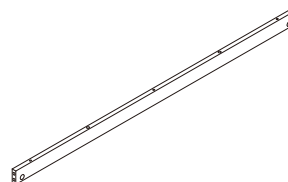

Bottom Side Rail

16 x 2

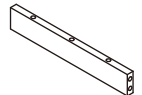

Bottom End Rail

17 x 1

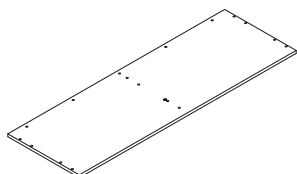

Bottom Panel

18 x 1

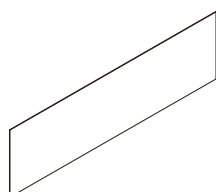

Back Panel

19 x 1

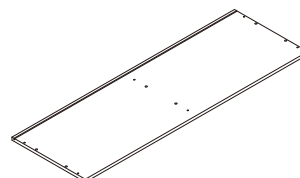

Top Panel

Supplied Parts and Hardware

(A) x 52



Ø6 x 35mm
Cam Bolt

(B1) x 22



Ø15 x 11mm
Tall Cam Bolt

(B2) x 30



Ø15 x 9mm
Short Cam Bolt

(C) x 42



Ø8 x 30mm
Wood Dowel

(D) x 46



Ø4 x 38mm
Screw

(E) x 60

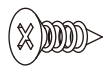

Ø3.5 x 12mm
Screw

(F) x 12



M4 x 25mm
Bolt

(G) x 6

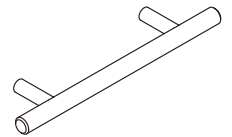

Drawer Pull

(H) x 12

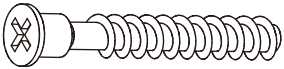

Ø6 x 50mm
Bolt

(I) x 8



Plastic Wedge

(J) x 8



Ø3 x 17mm
Screw

(L) x 6

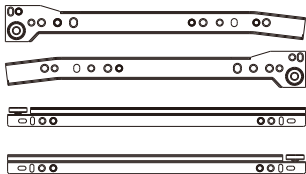

**Dresser
Slide**

L1(L) x 6

L1(R) x 6



**Drawer
Slide**

L2(L) x 6

L2(R) x 6



Anti-Tip Kit

ST4 x 12mm
Screw
x 2

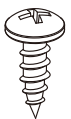

ST4 x 25mm
Screw
x 2



Washer
x 4



Strap
x 2

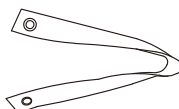

Ø8 x 30mm
Wall Anchor
x 2

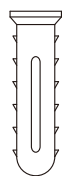

! CAUTION!

This wall anchor is for concrete
ONLY. DO NOT use them in
drywall or wood studs.

Step 1

Parts and Hardware

x 6

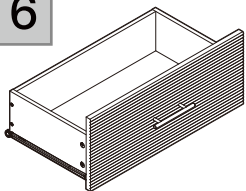

6x

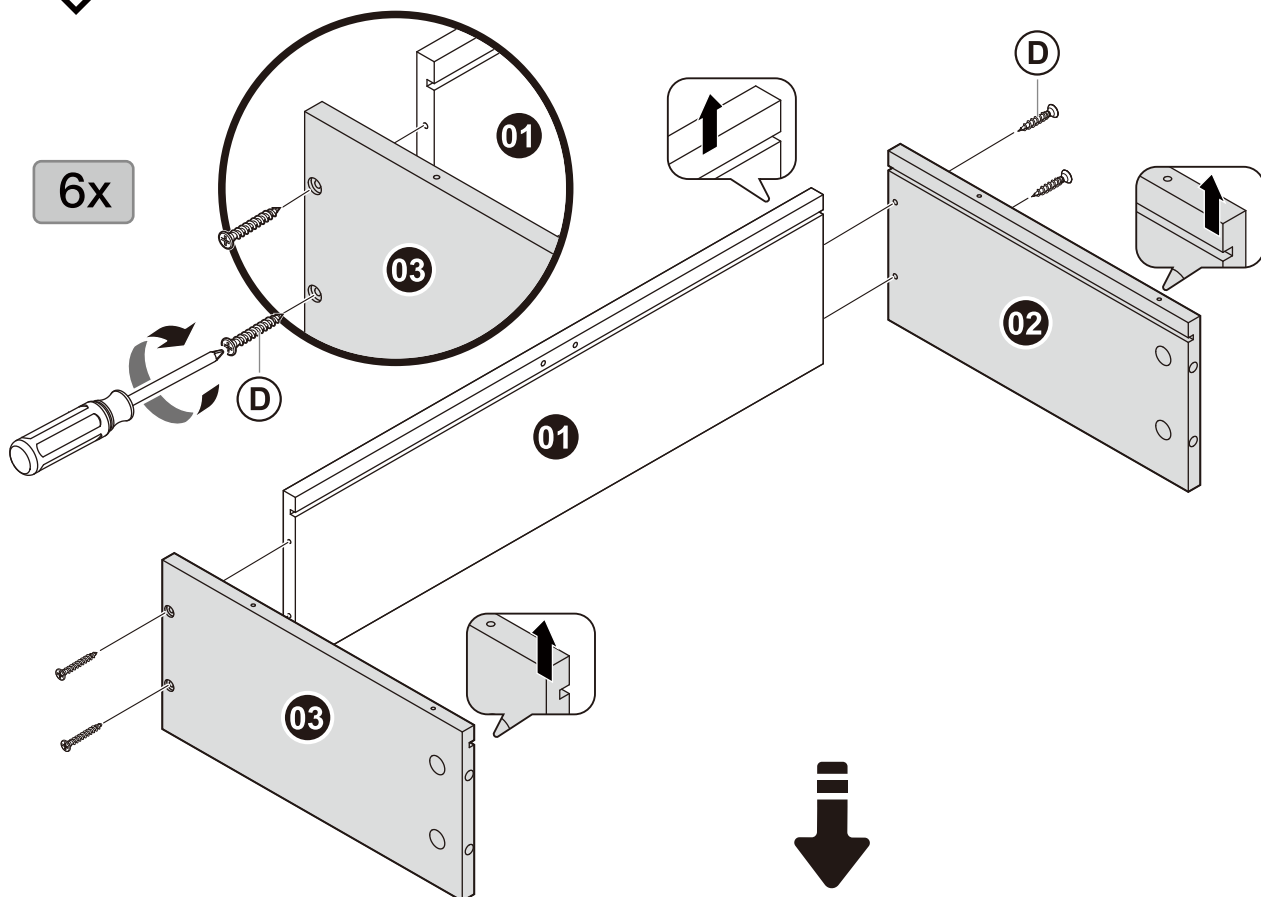

[D] x 24

[01] x 6

[02] x 6

[03] x 6

[04] x 6



Phillips
Screwdriver
(not included)

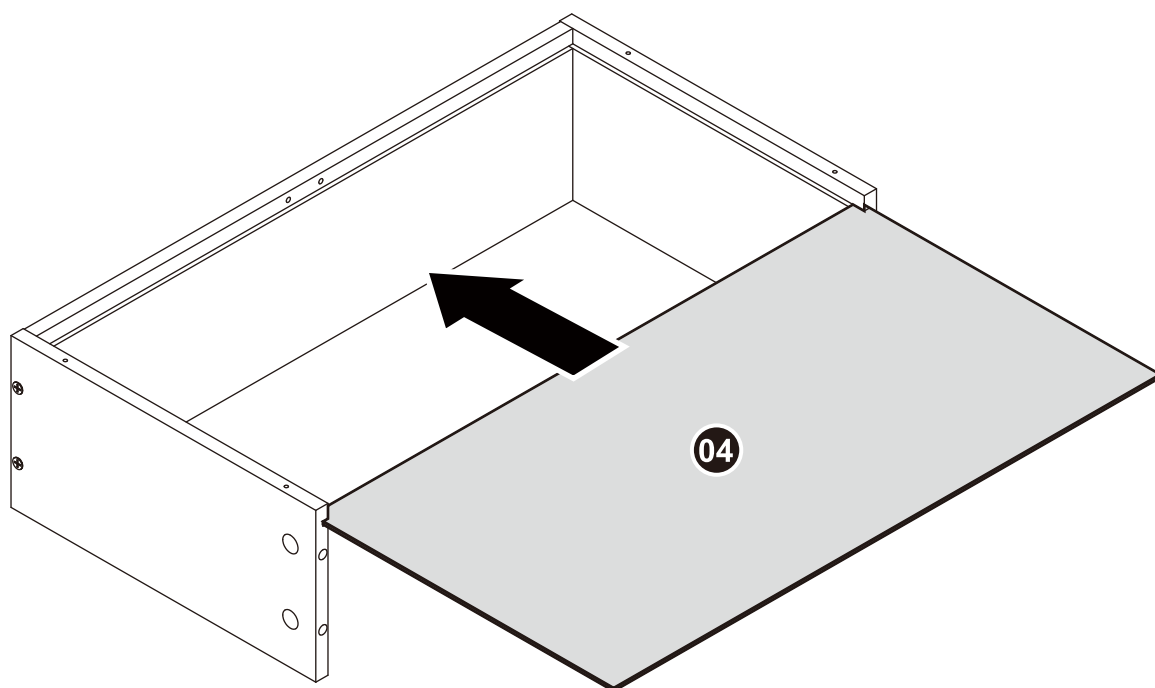

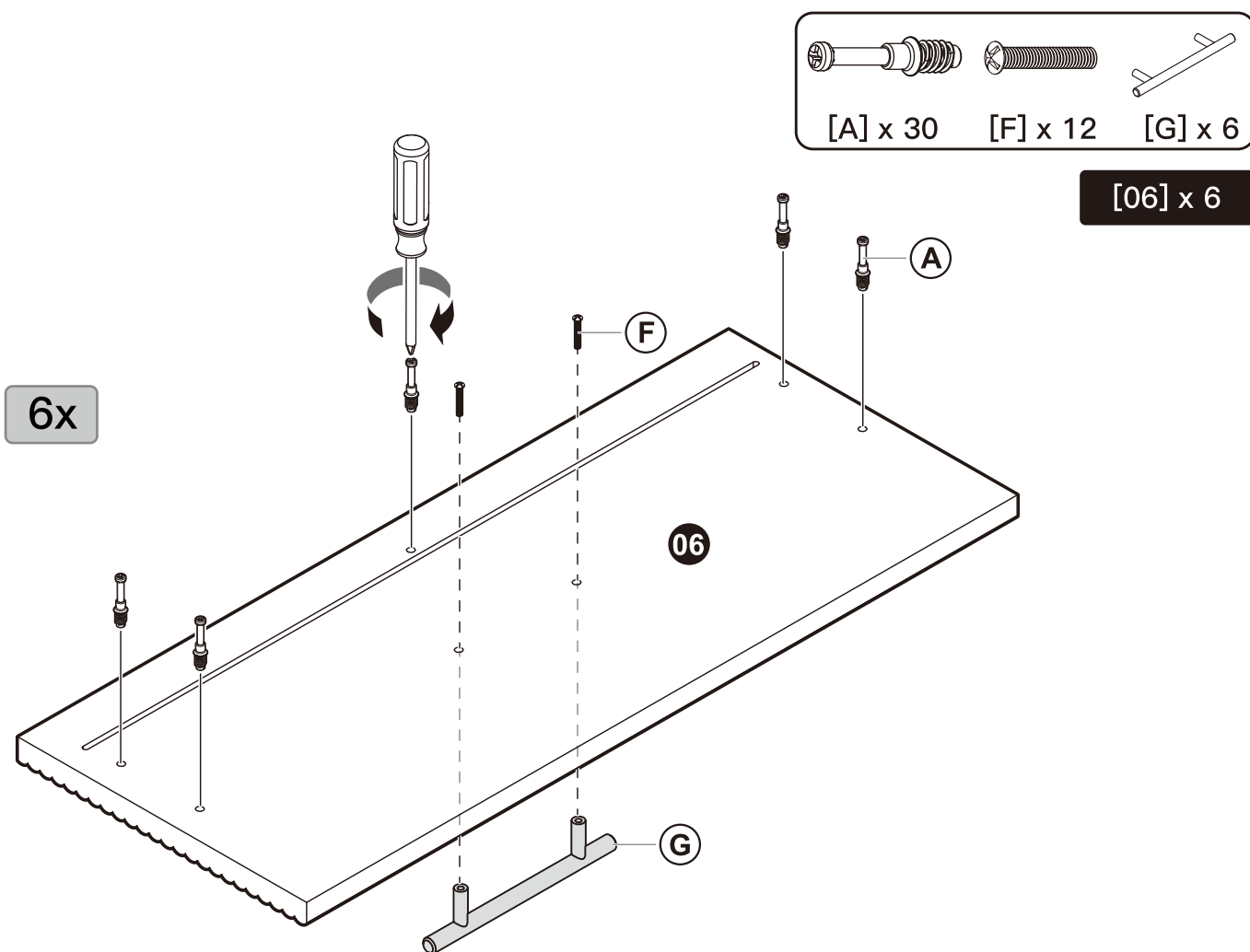
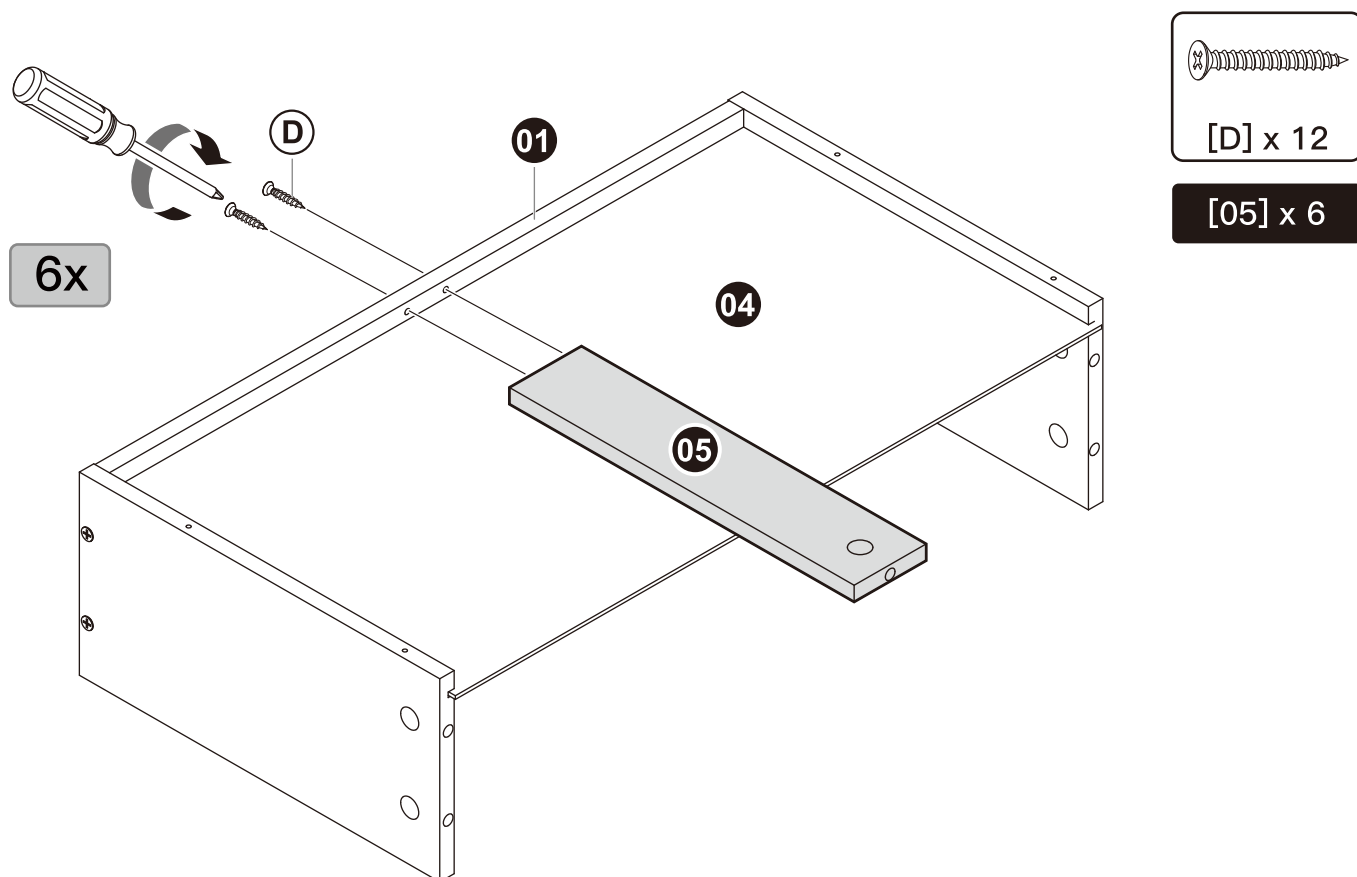

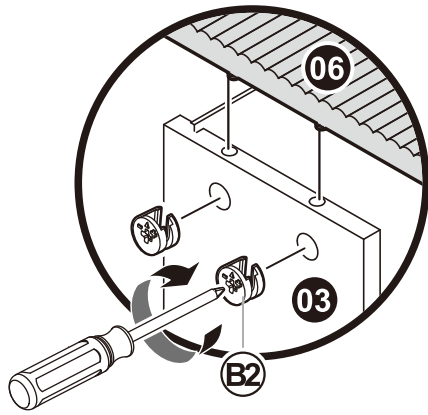

6x

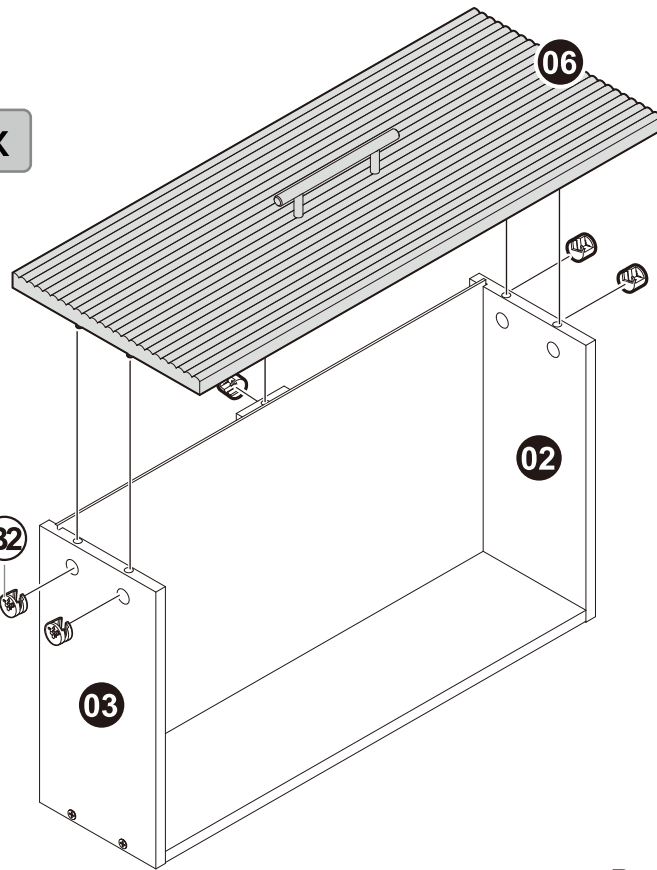
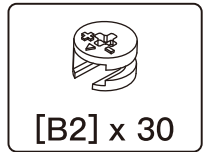

Using the Cam Lock System

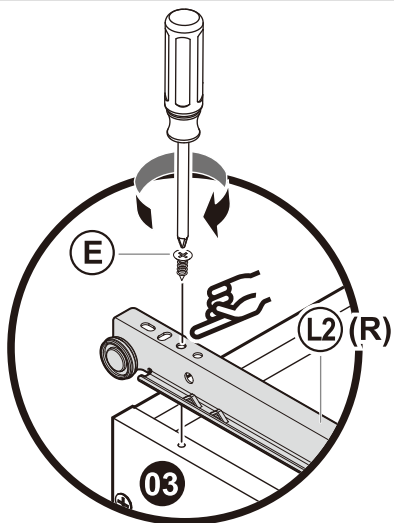
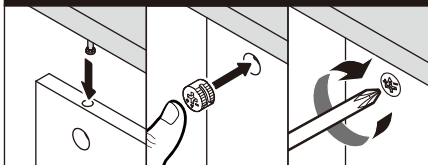

6x

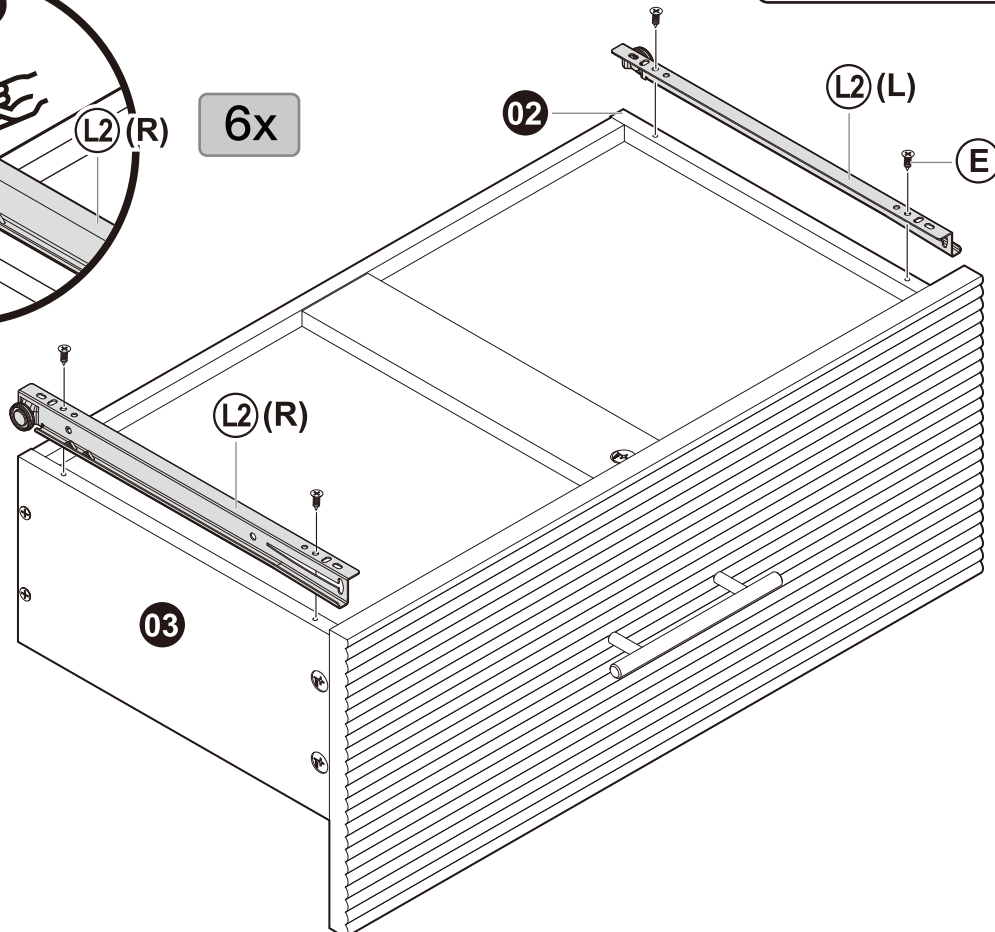
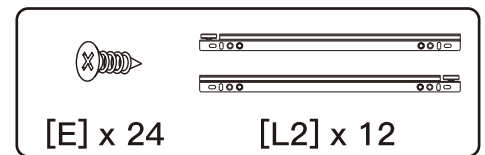

Step 2

Parts and Hardware

Note: Fully tighten screws to avoid loose drawers and ensure smooth movement.

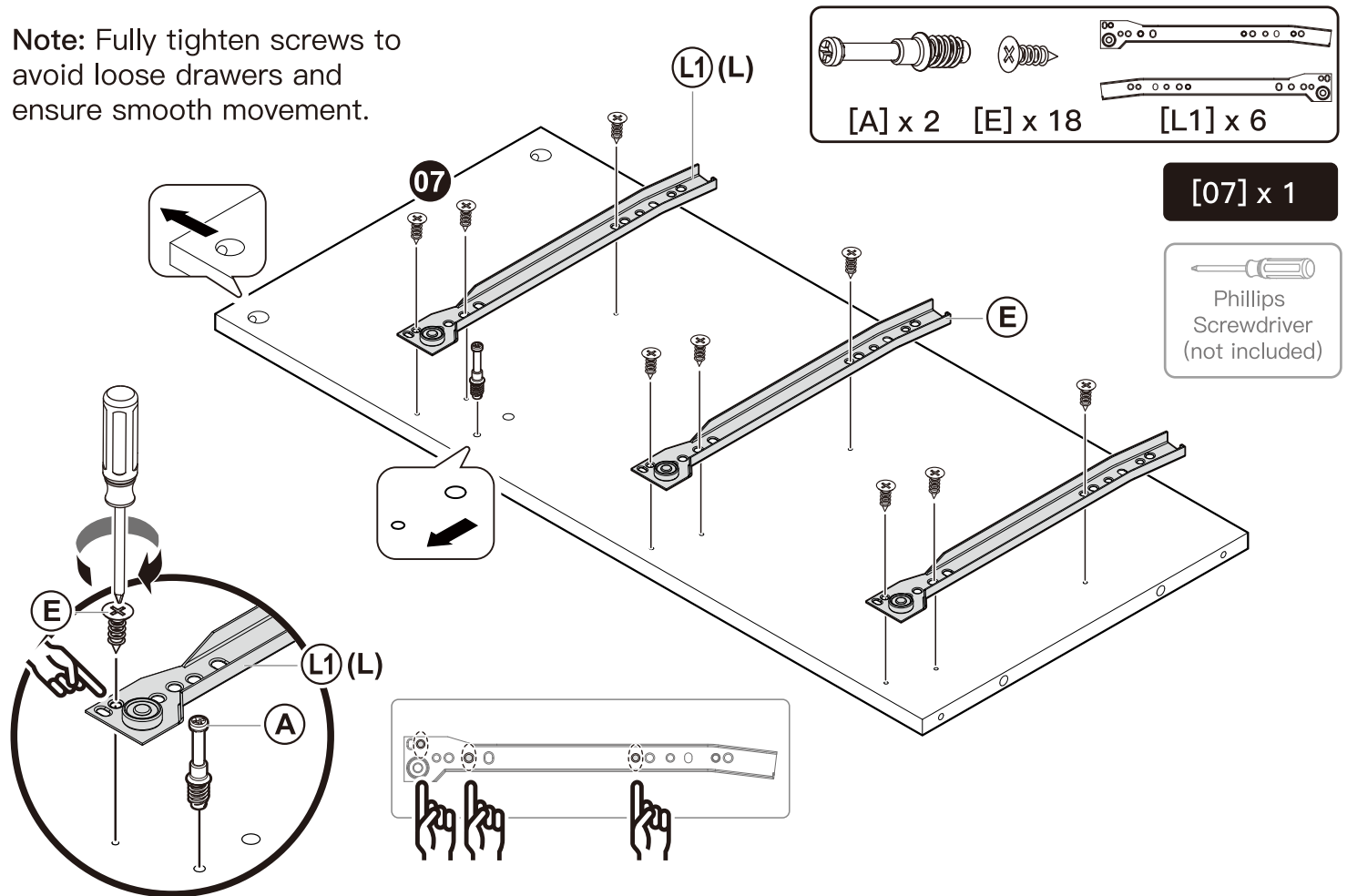

Flip 180°

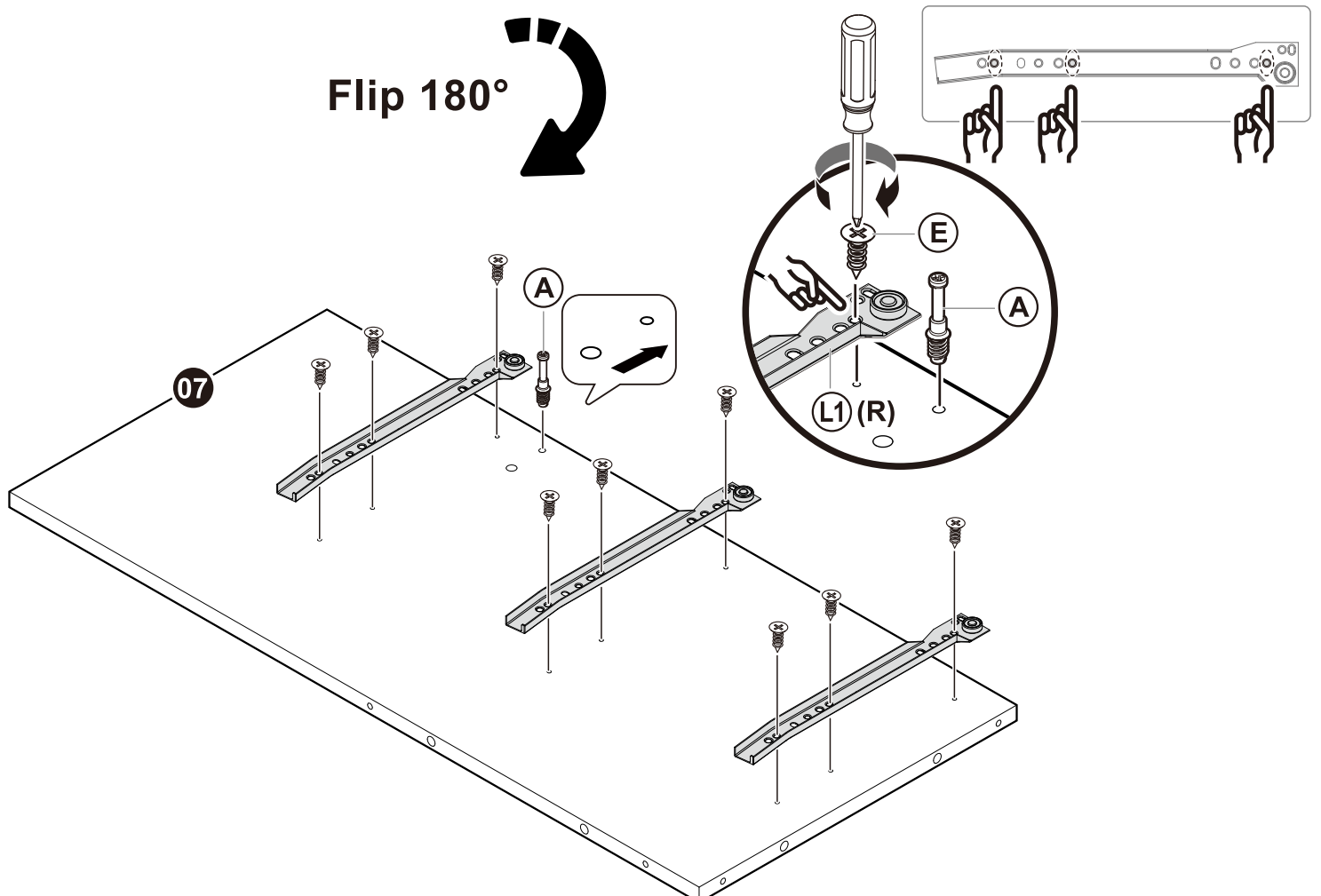

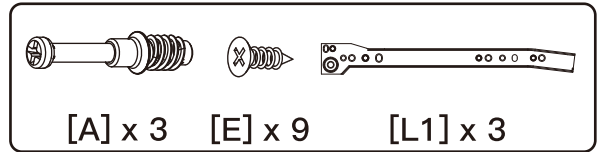

[08] x 1

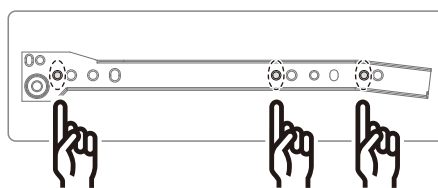
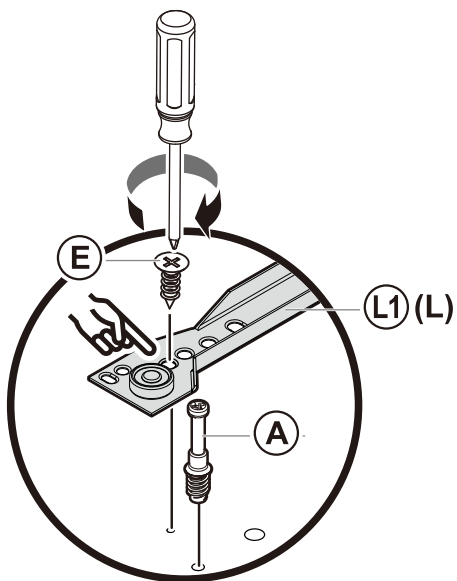
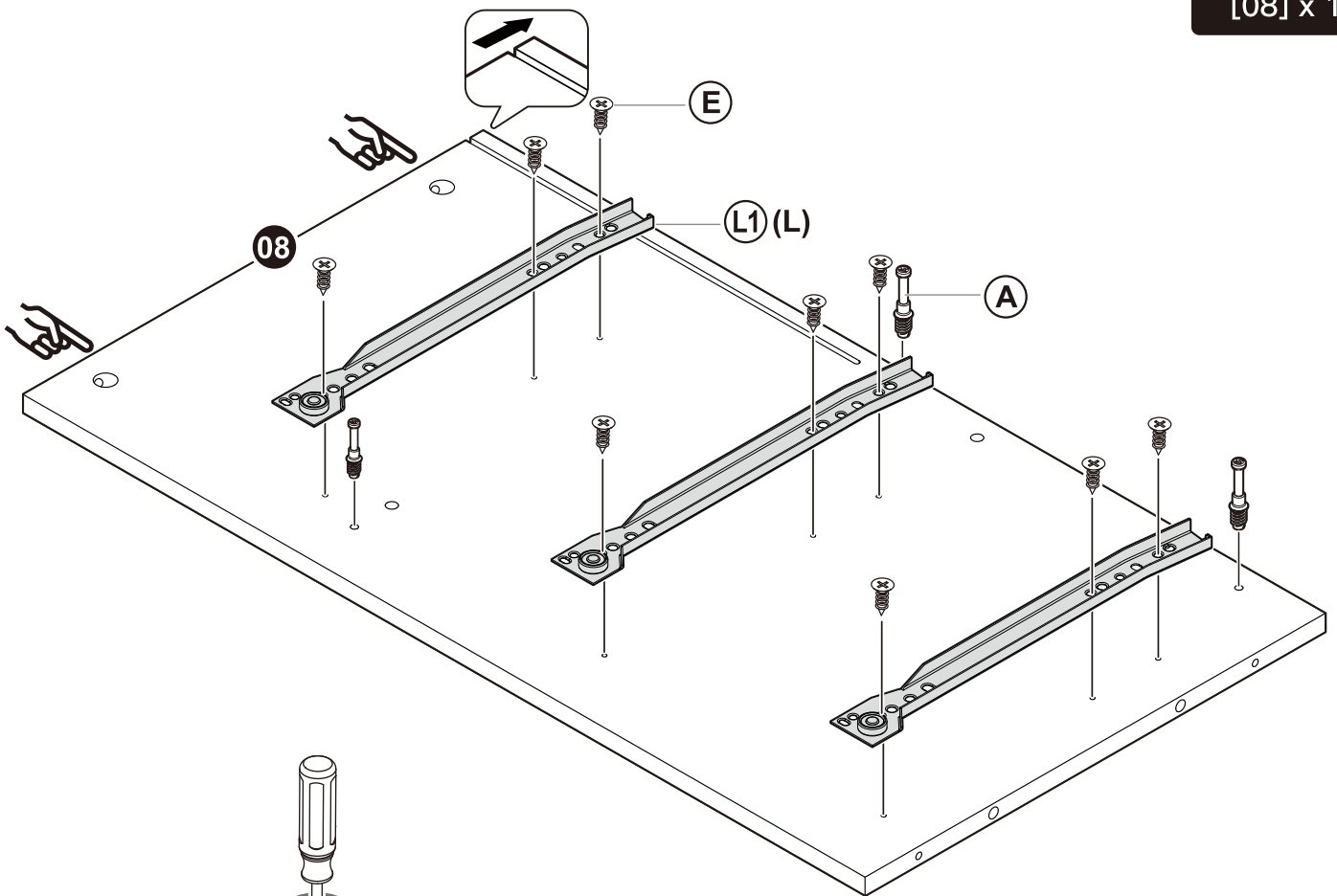

Note: Fully tighten screws to avoid loose drawers and ensure smooth movement.

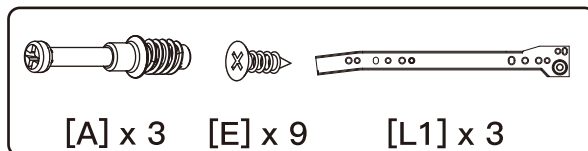

[09] x 1

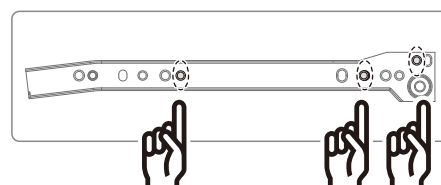
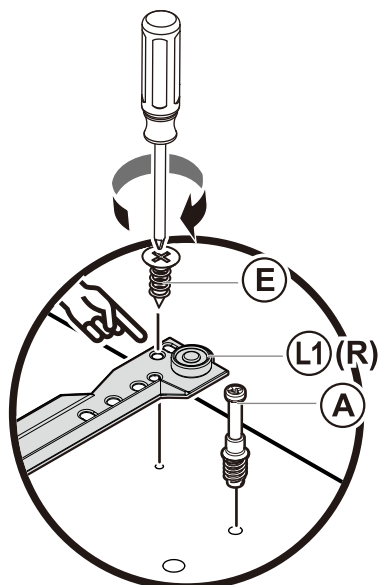

Note: Fully tighten screws to avoid loose drawers and ensure smooth movement.

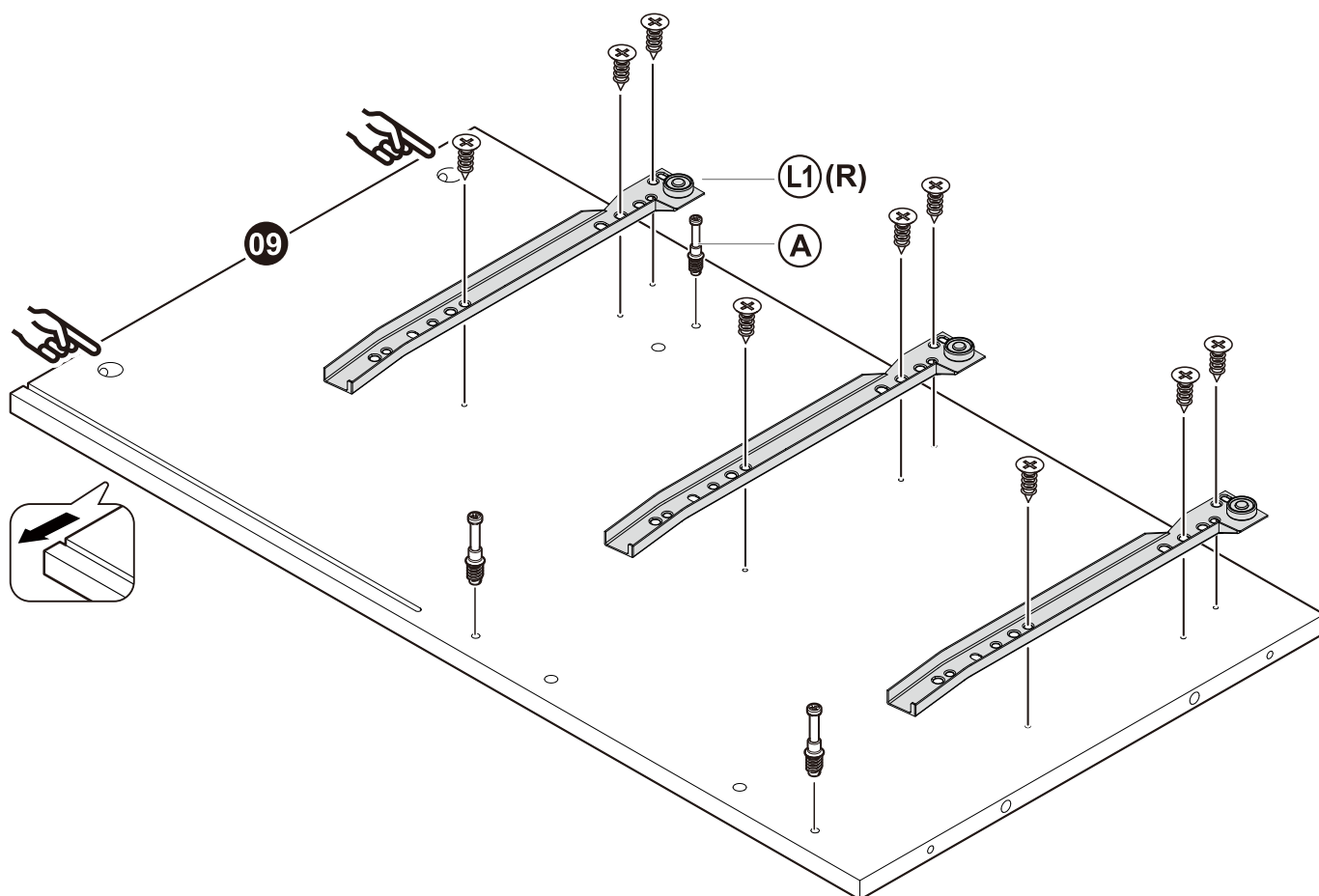

Step 4

Parts and Hardware



You may need assistance with this step.



[C] x 2



[H] x 2

[10] x 1



Phillips
Screwdriver
(not included)

Back

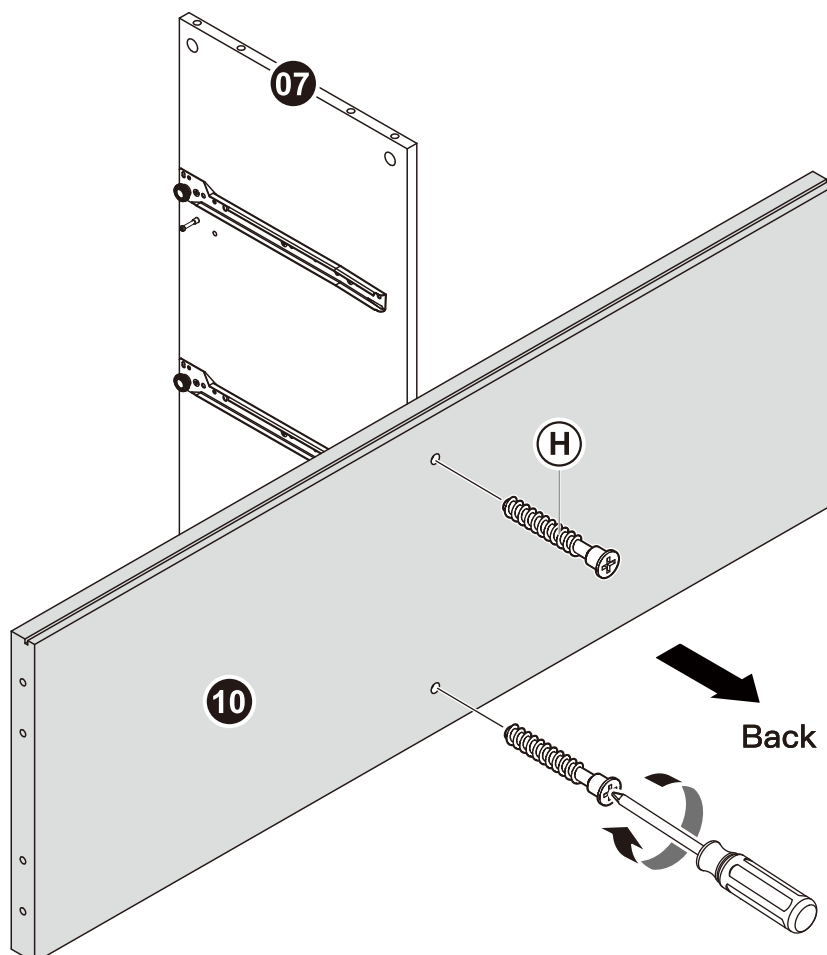
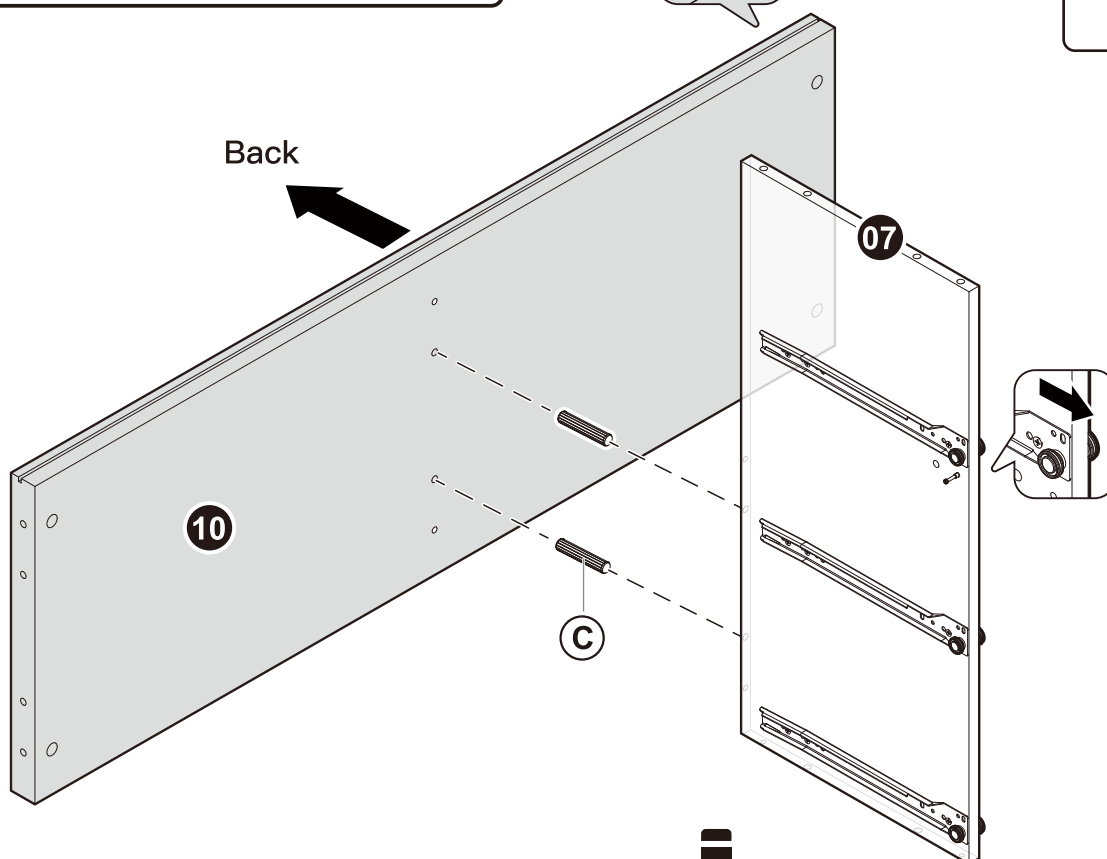



[B1] x 2



[C] x 2

[11] x 2



Phillips
Screwdriver
(not included)

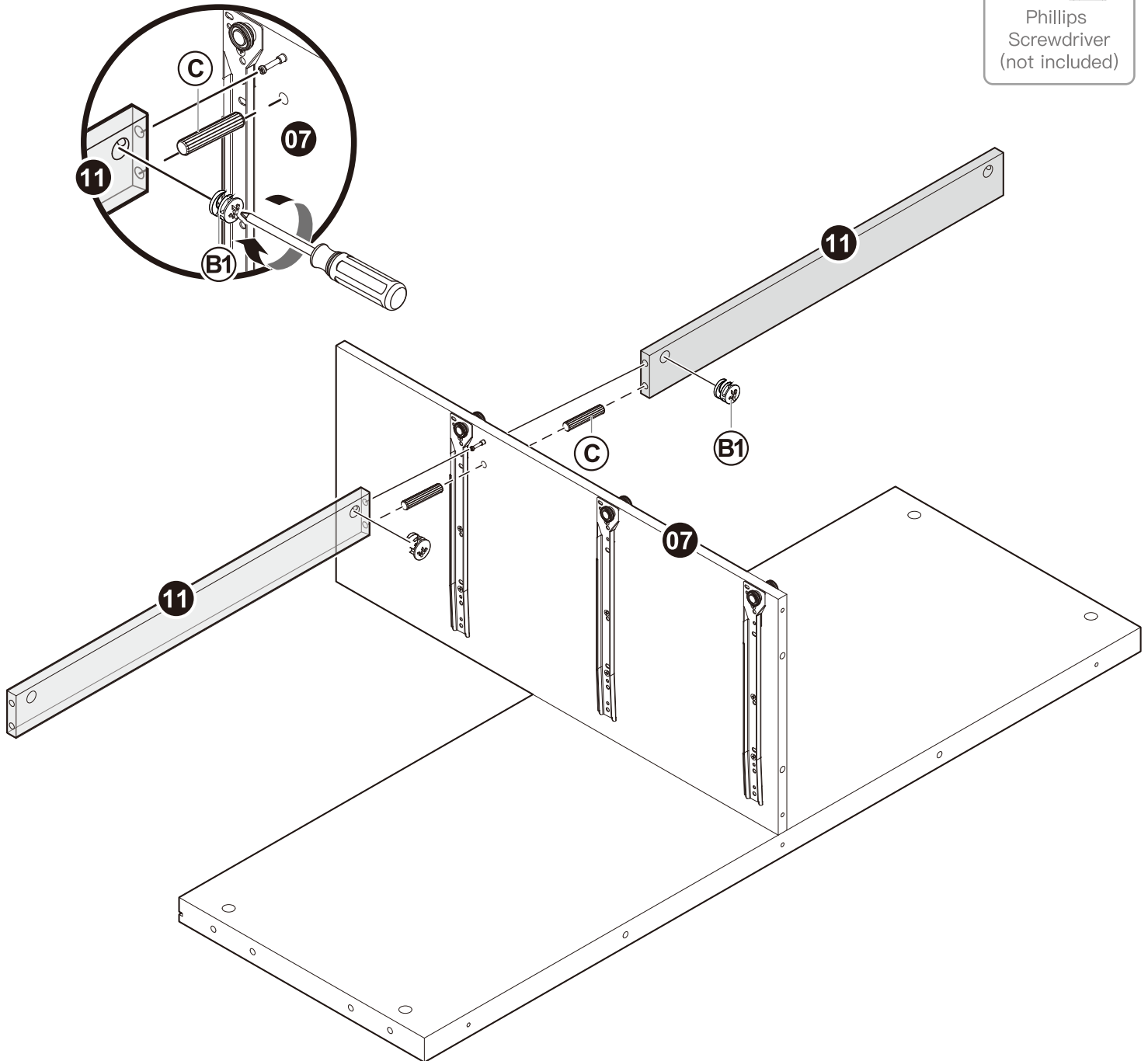

Using the Cam Lock System

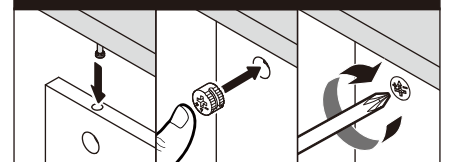

Step 6

Parts and Hardware



You may need assistance with this step.



[B1] x 6

[C] x 6



Phillips
Screwdriver
(not included)

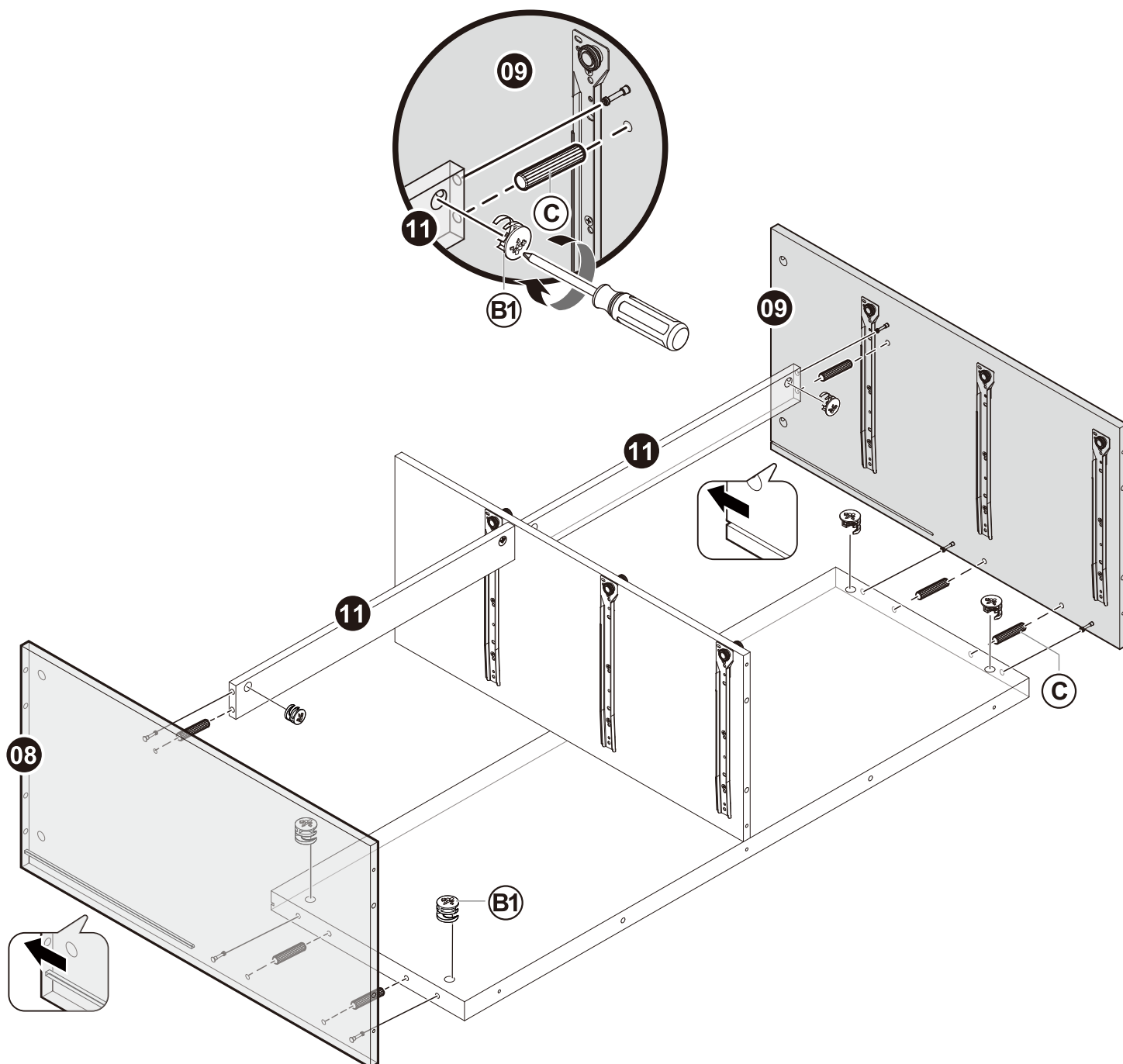

Using the Cam Lock System

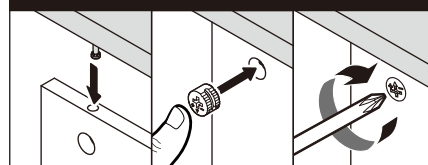

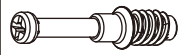
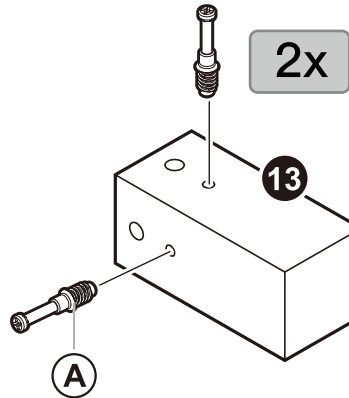
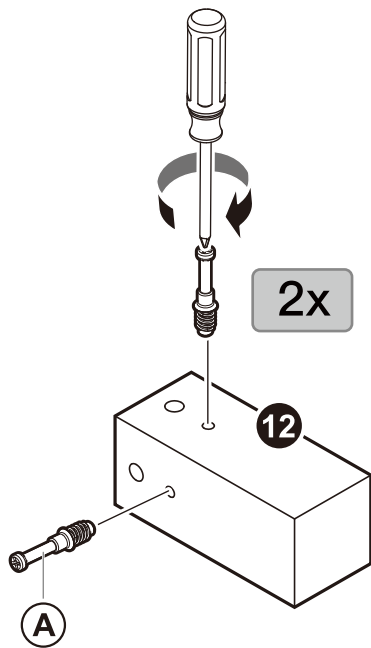

[A] x 8

[12] x 2
[13] x 2



Phillips
Screwdriver
(not included)

Parts and Hardware



[B1] x 4



[C] x 4

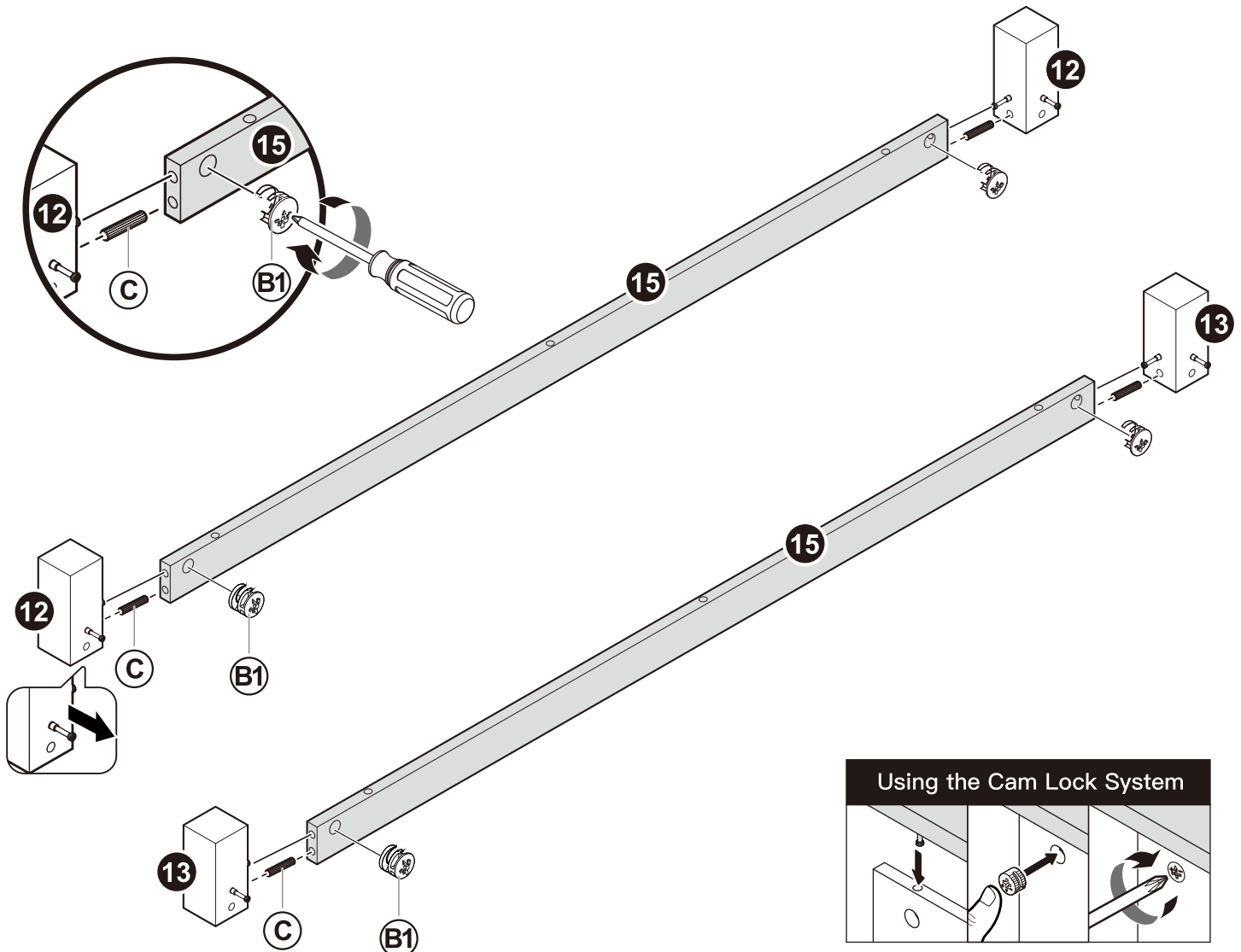

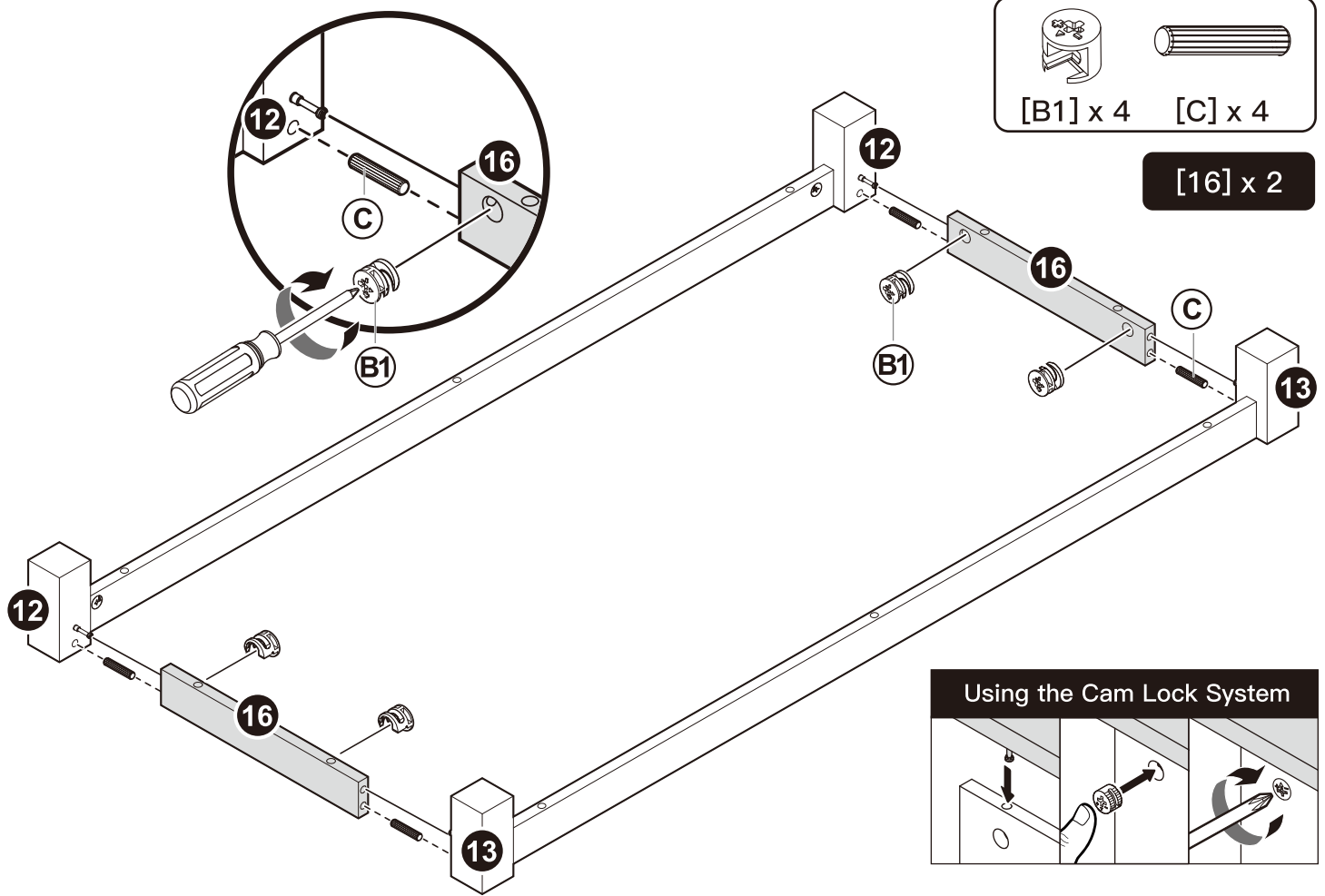

Step 8



You may need assistance with this step.

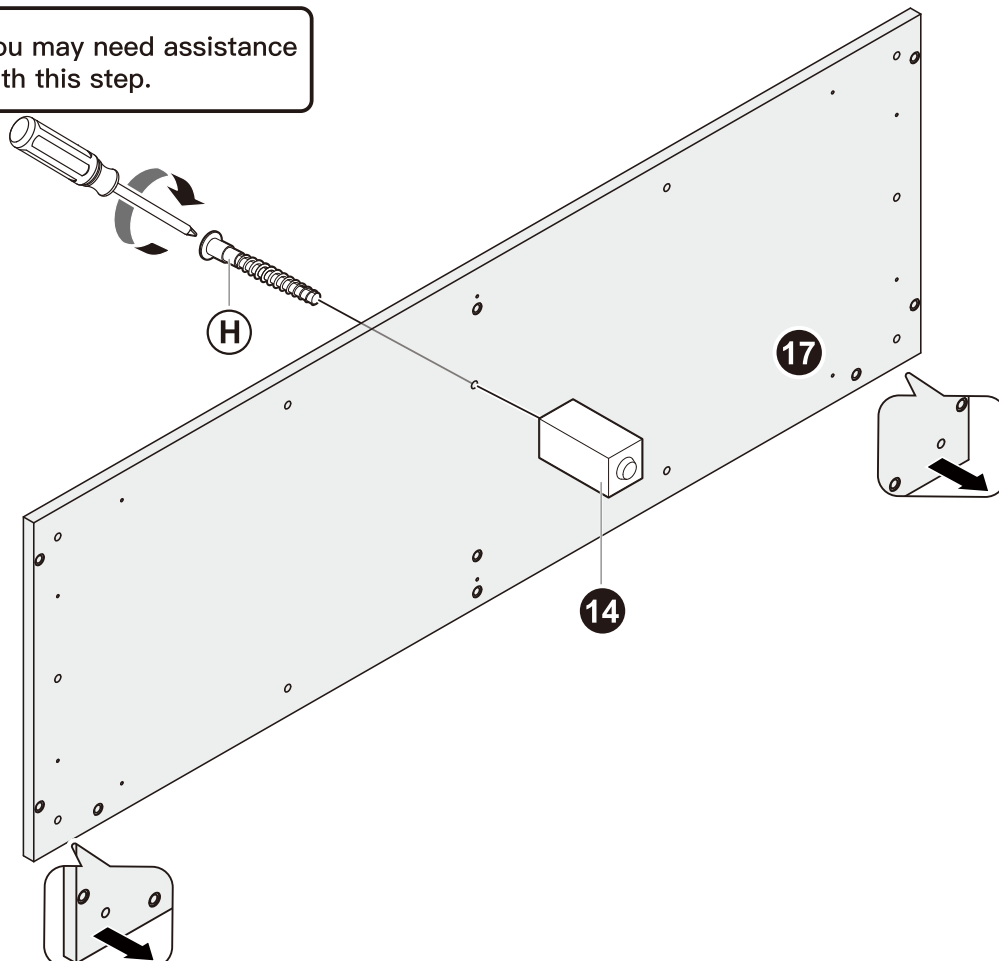

[H] x 1

[17] x 1



Phillips
Screwdriver
(not included)

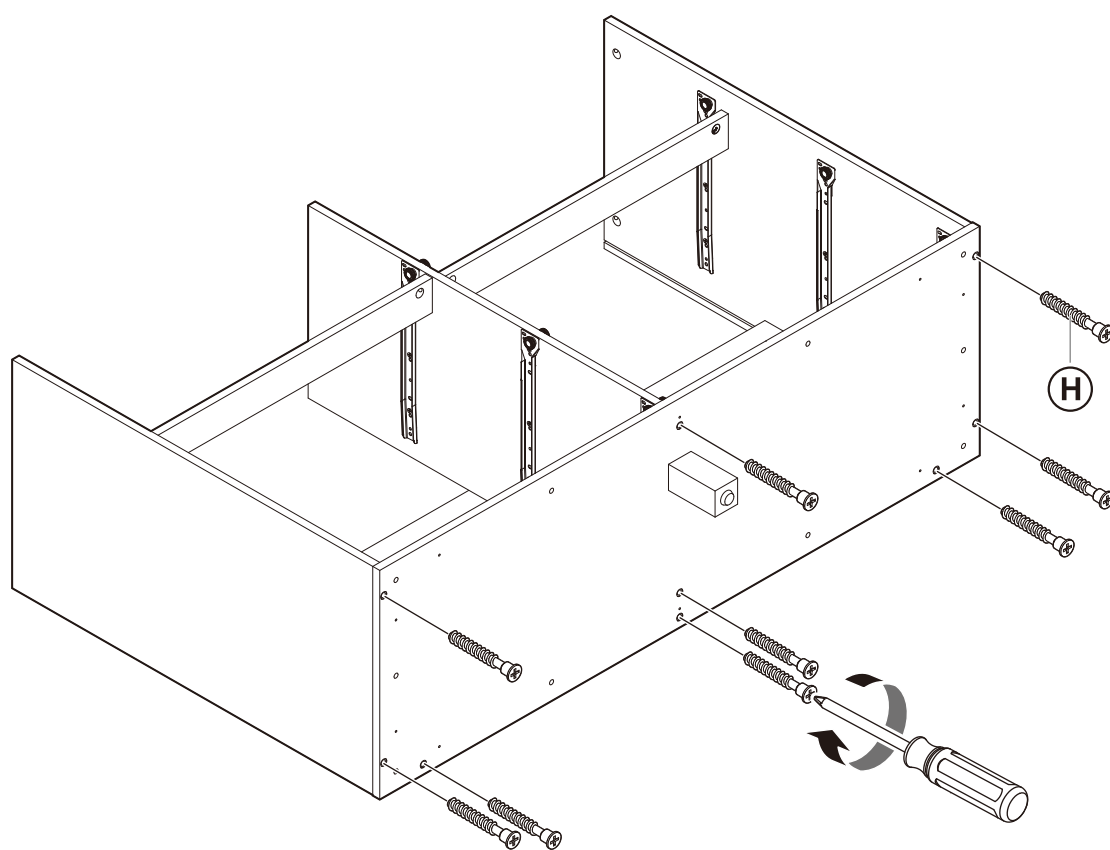
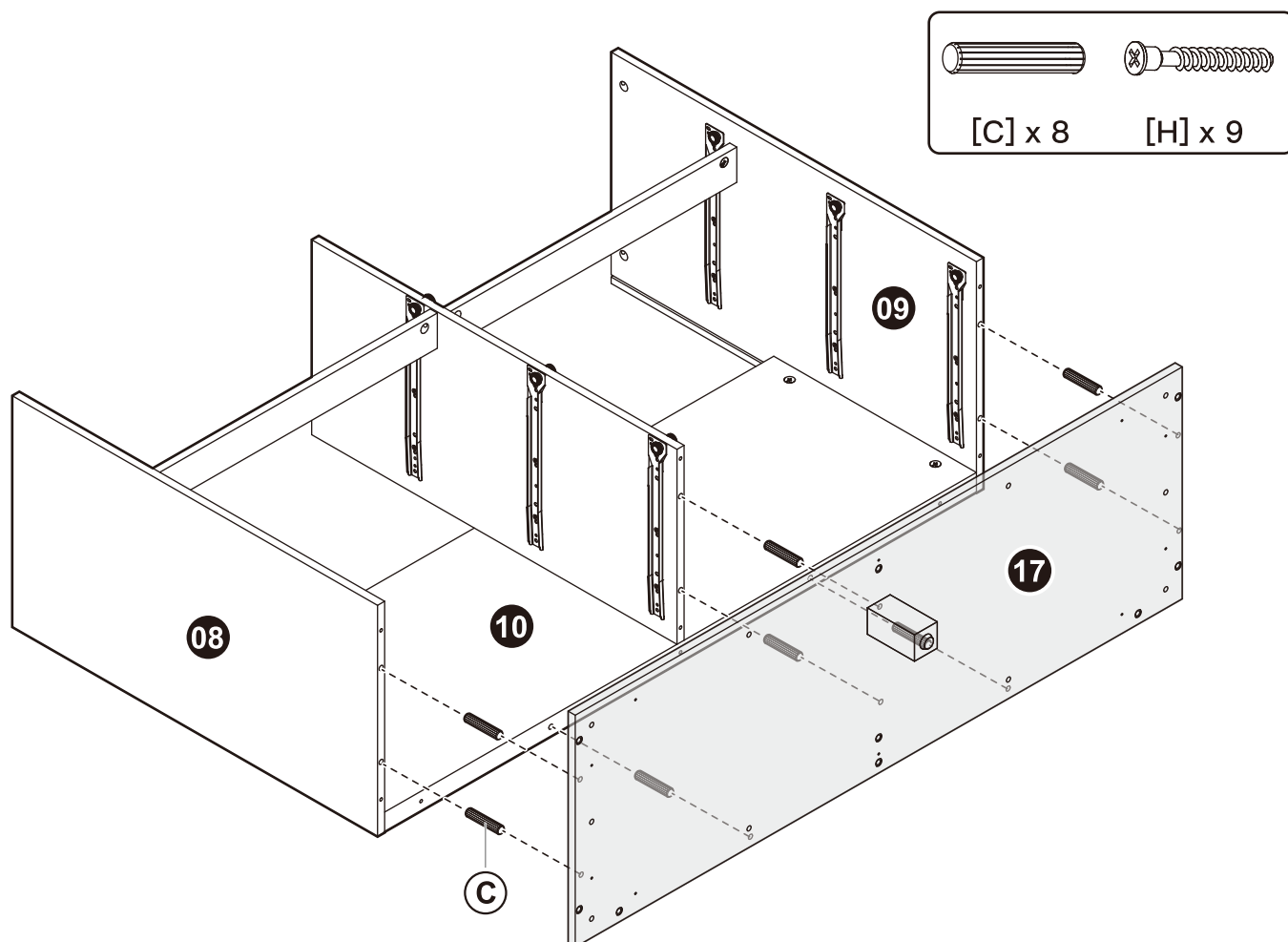

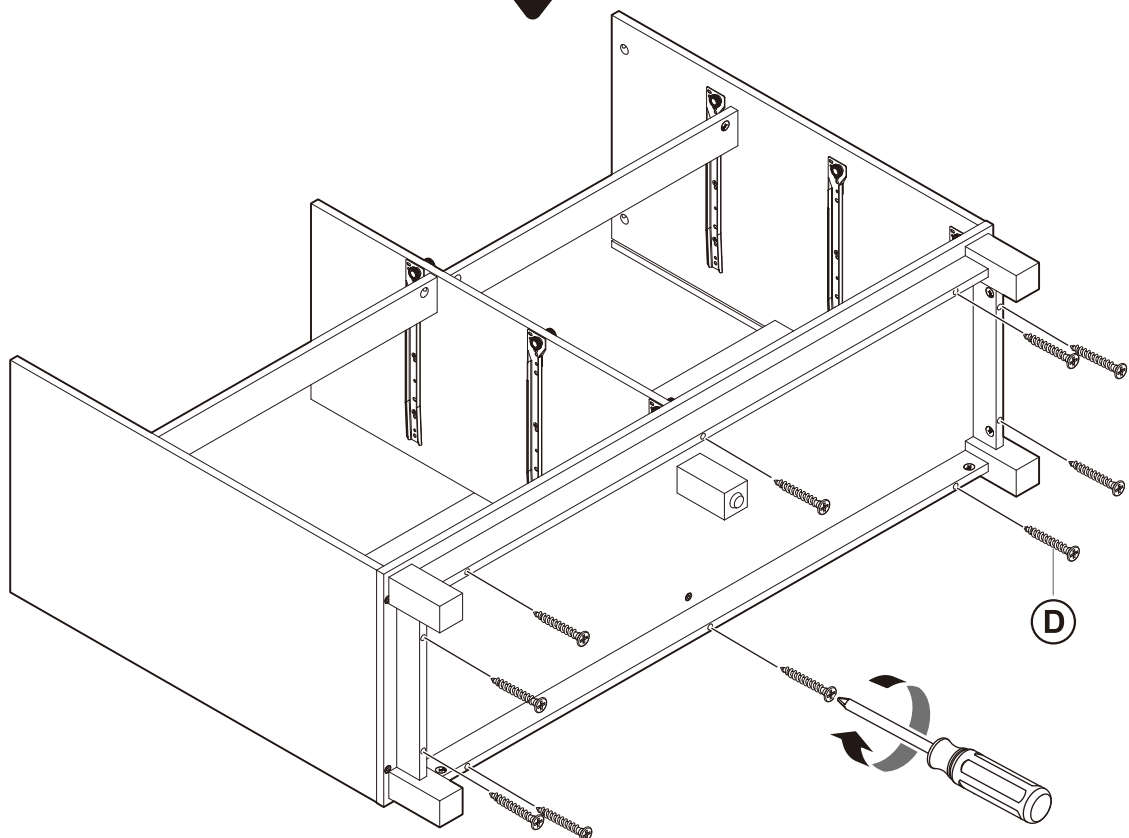
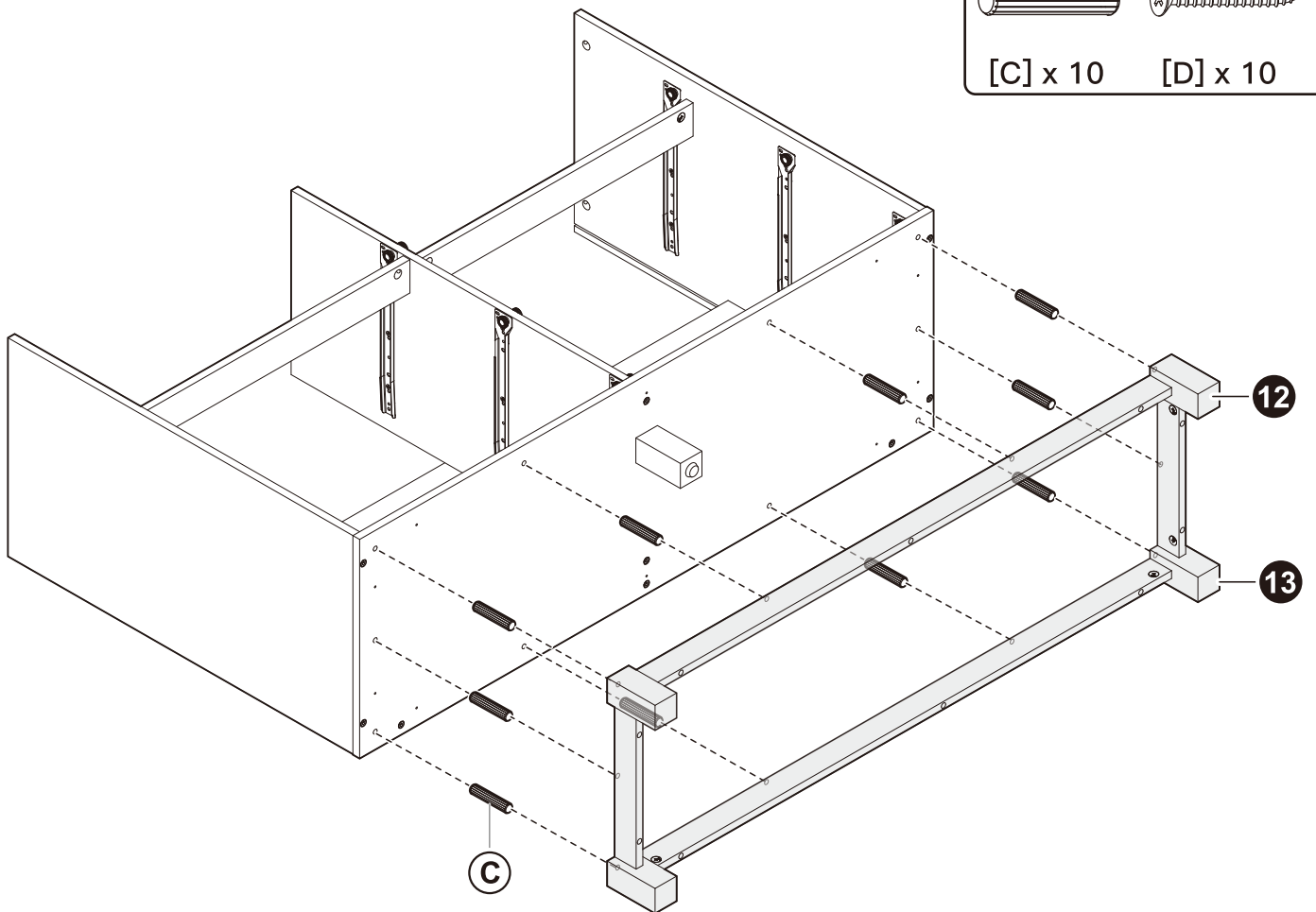
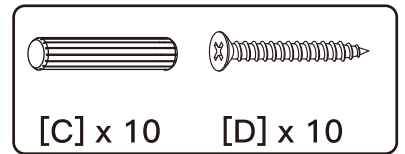

Step 9

Parts and Hardware

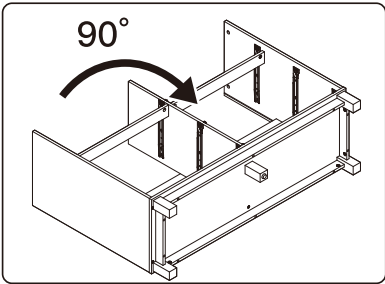

 You may need assistance with this step.

[18] x 1

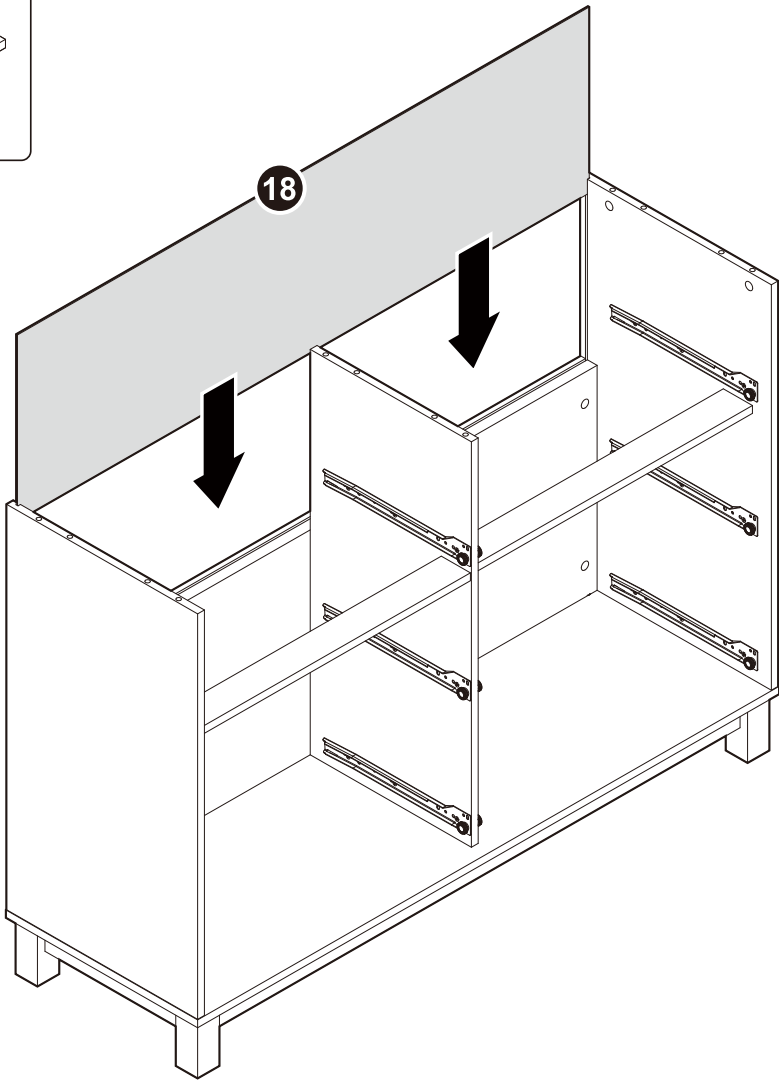

Step 10

Parts and Hardware

 You may need assistance with this step.

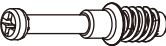
[A] x 6

[19] x 1

Phillips
Screwdriver
(not included)

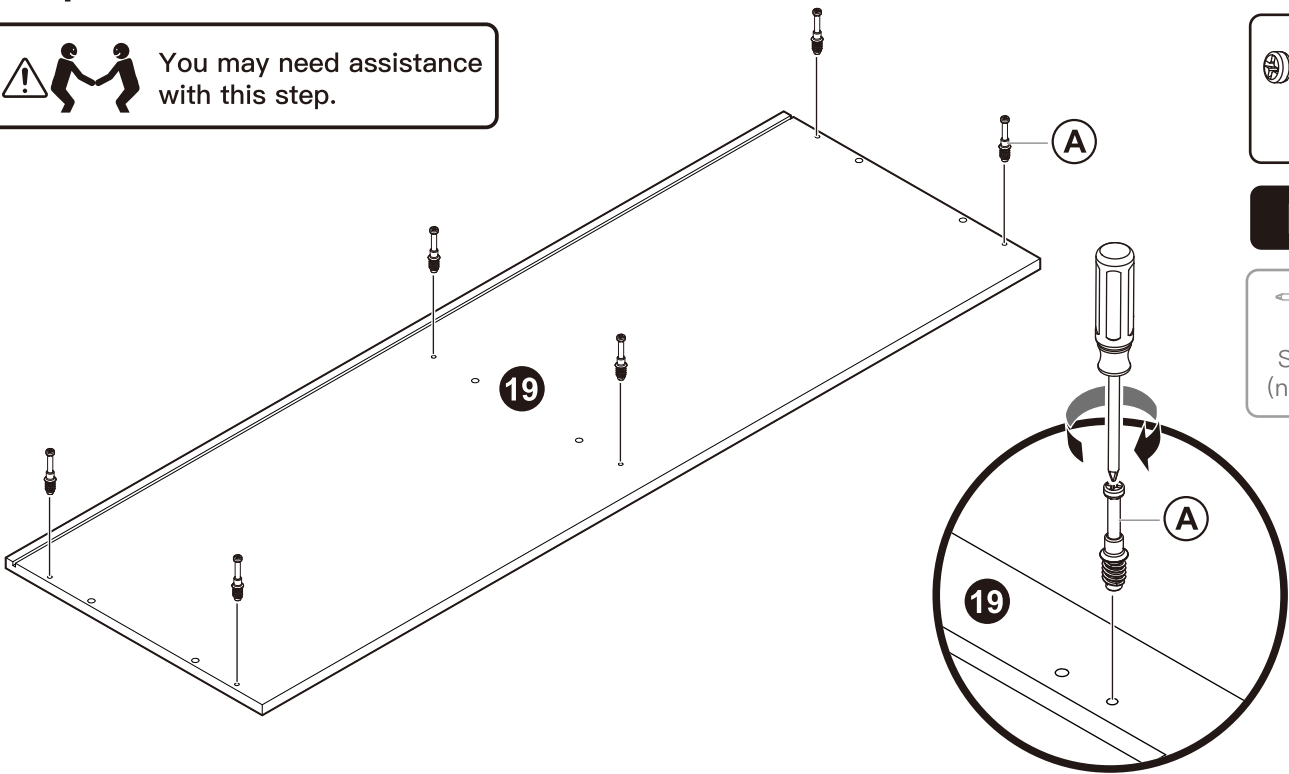

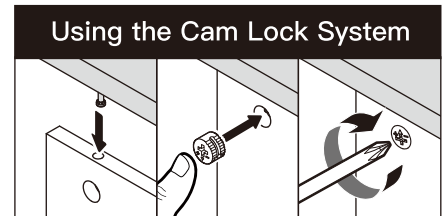
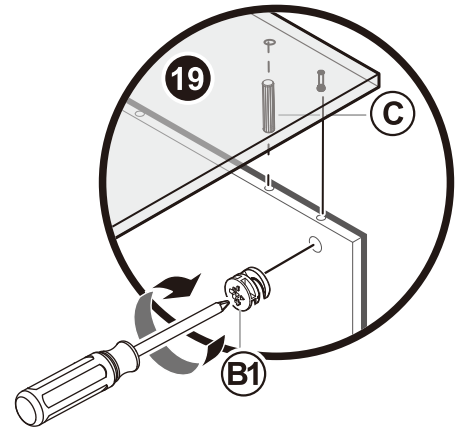
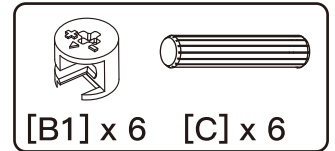
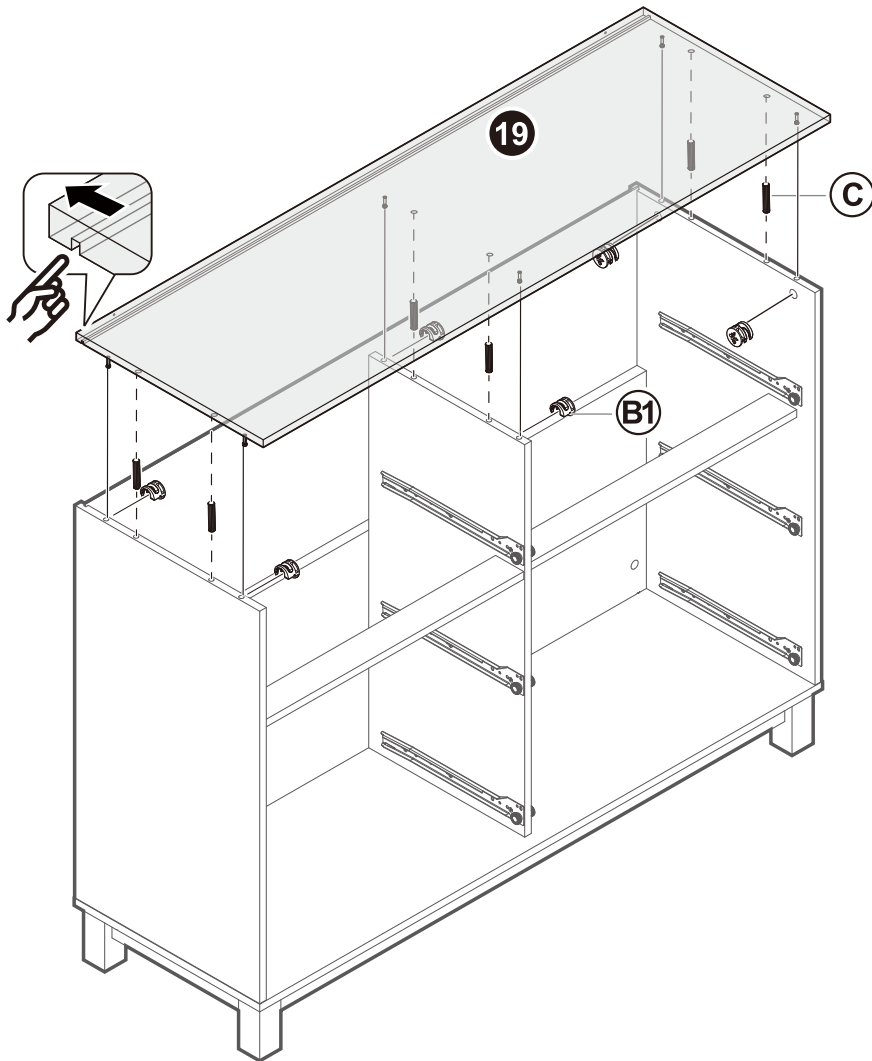

Step 11

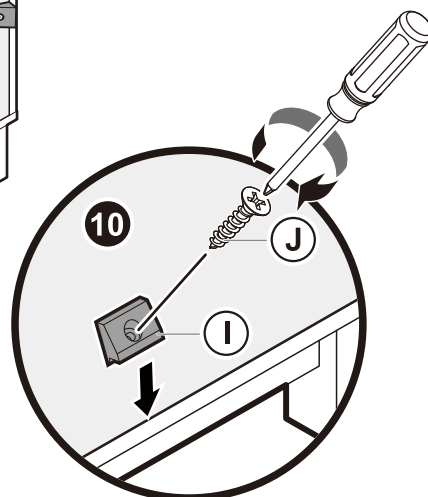
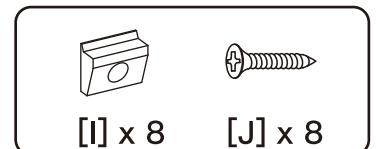
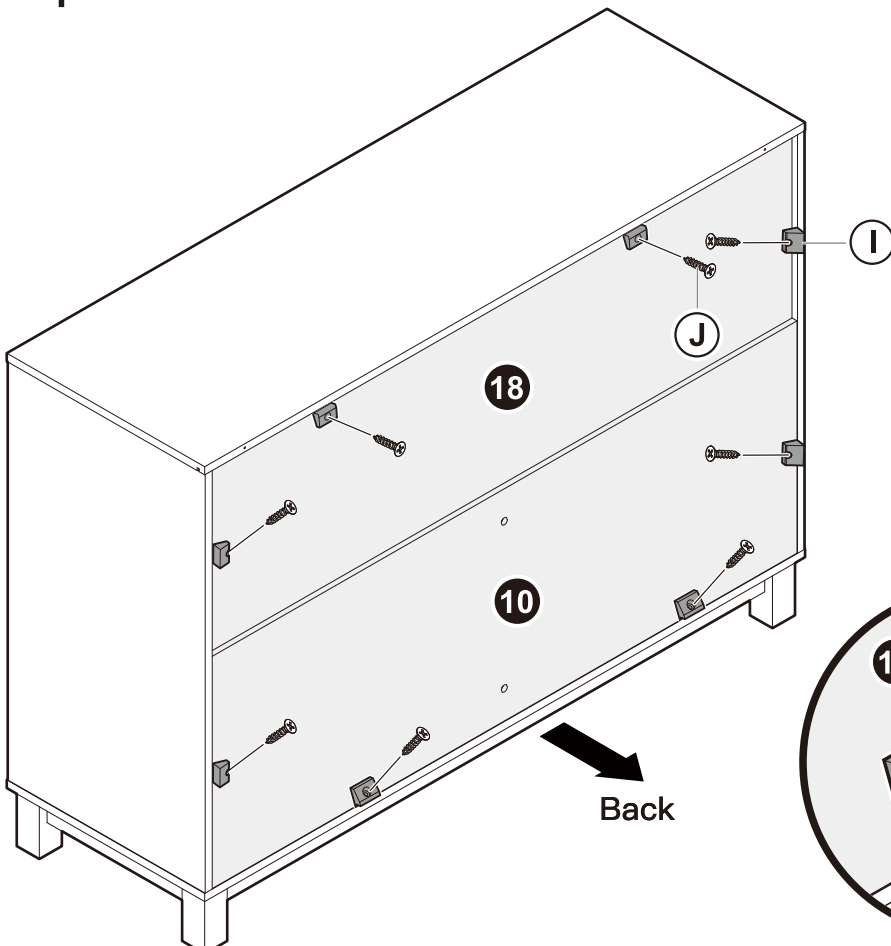

Step 12

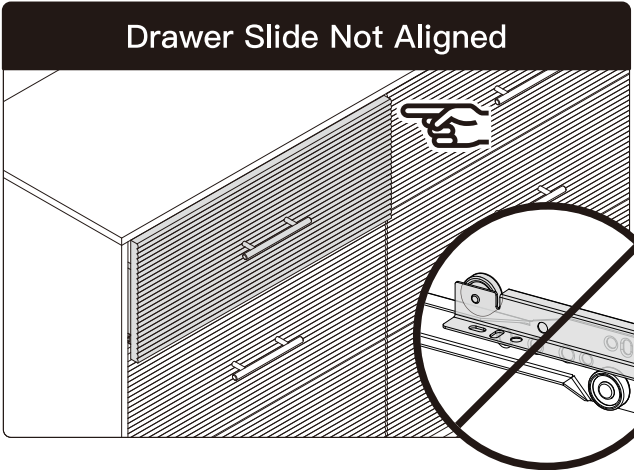
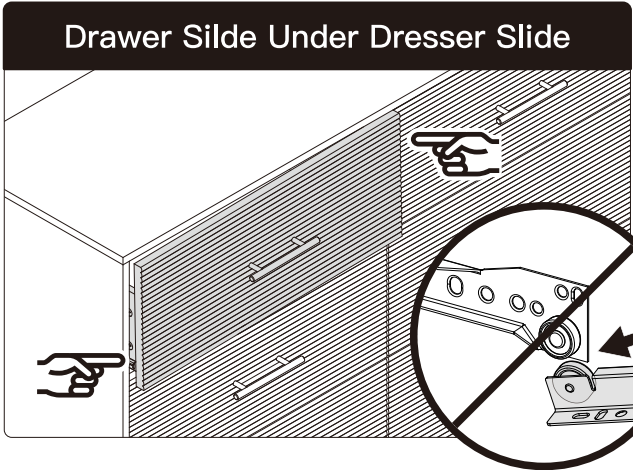
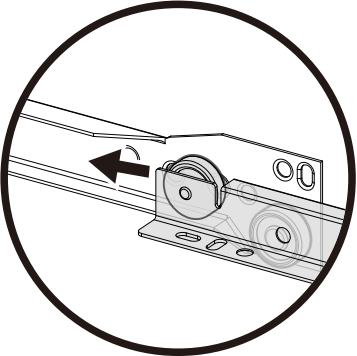
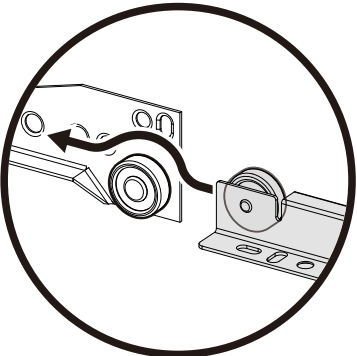
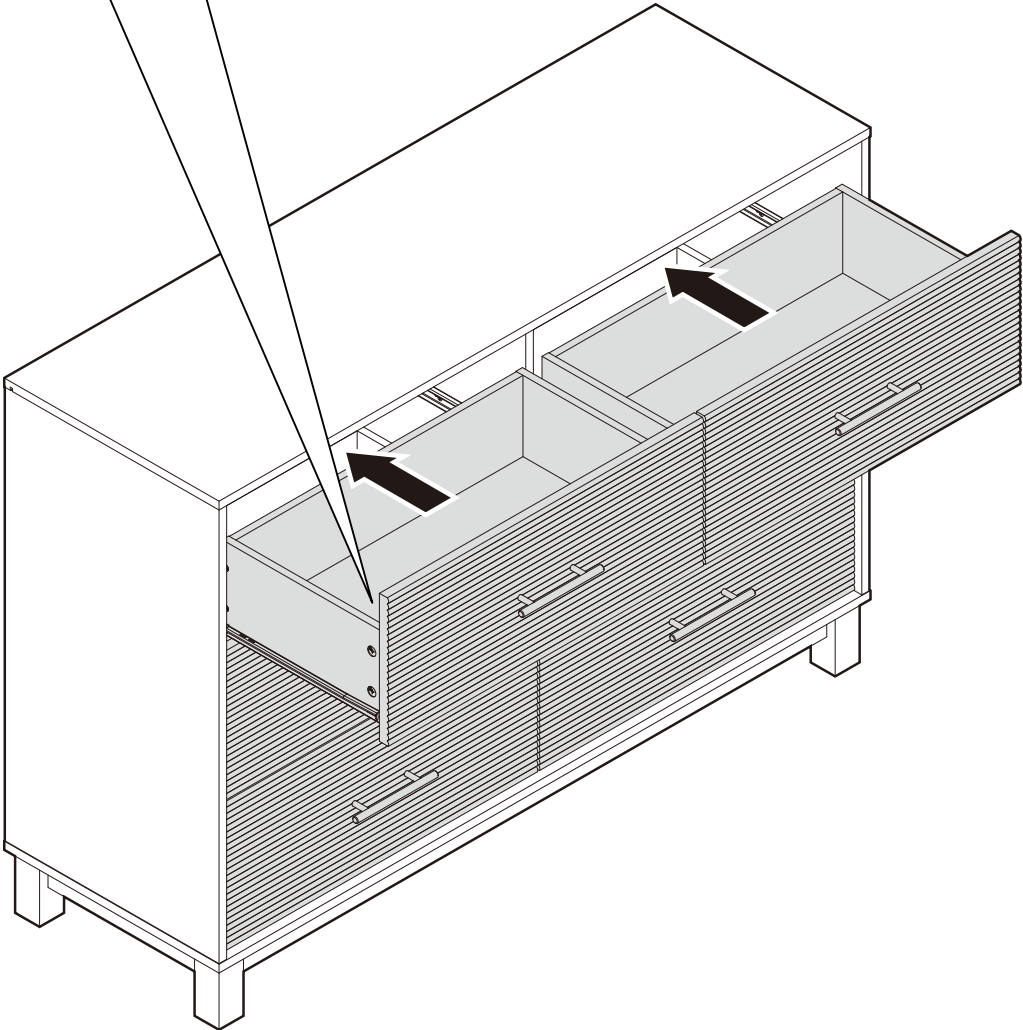
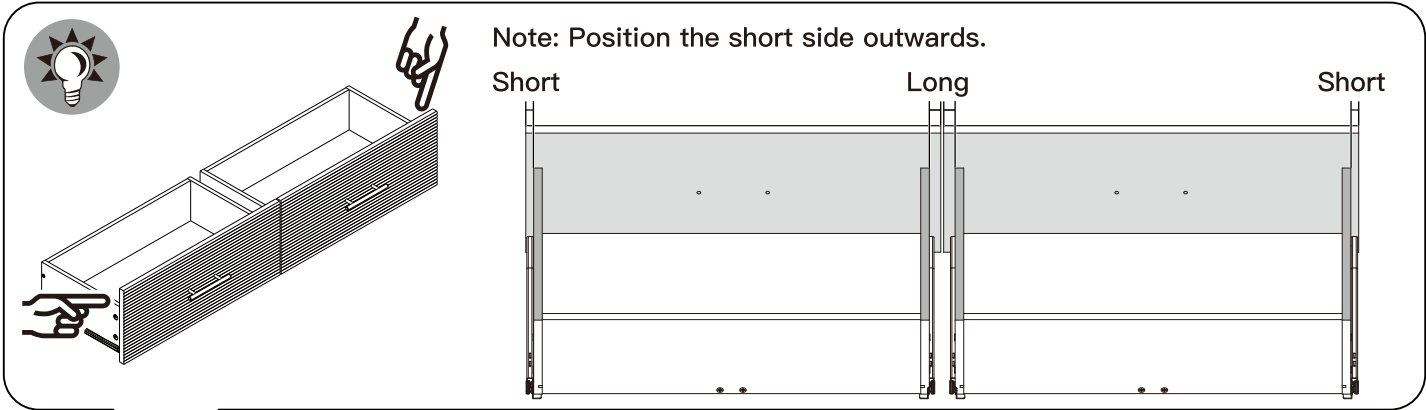

Step 13

Parts and Hardware

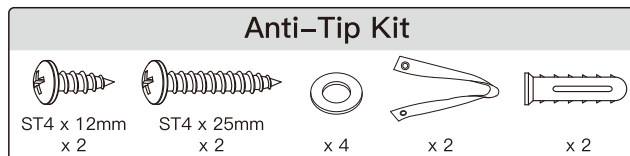
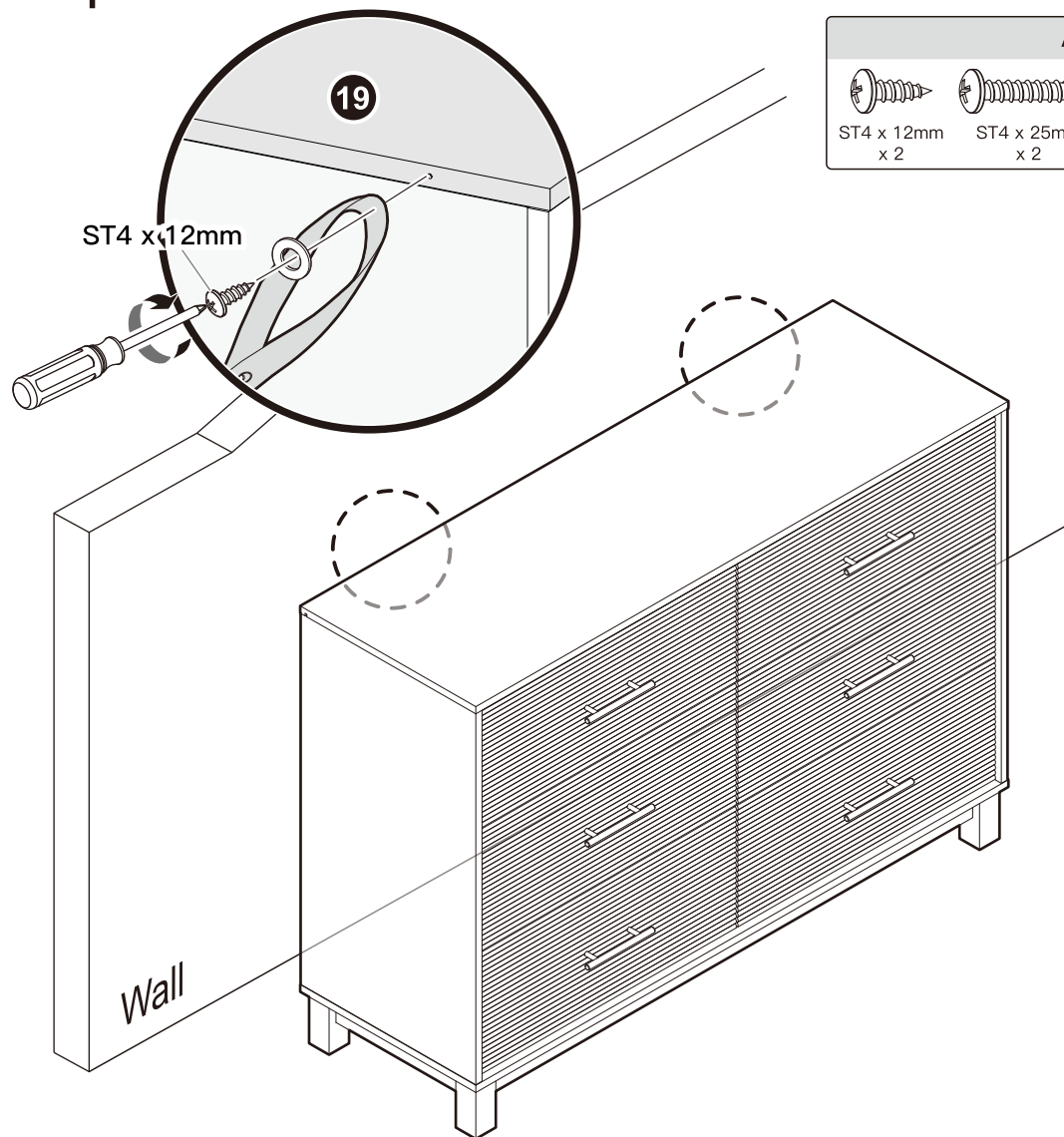

Phillips
Screwdriver
(not included)

Hammer
(not included)

Electric Drill
(not included)

Stud Finder
(not included)

Wood Studs

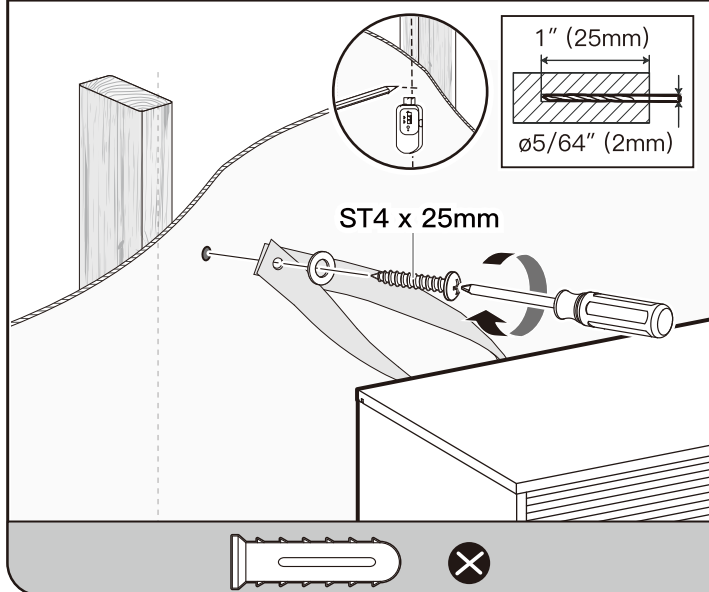

Solid Concrete

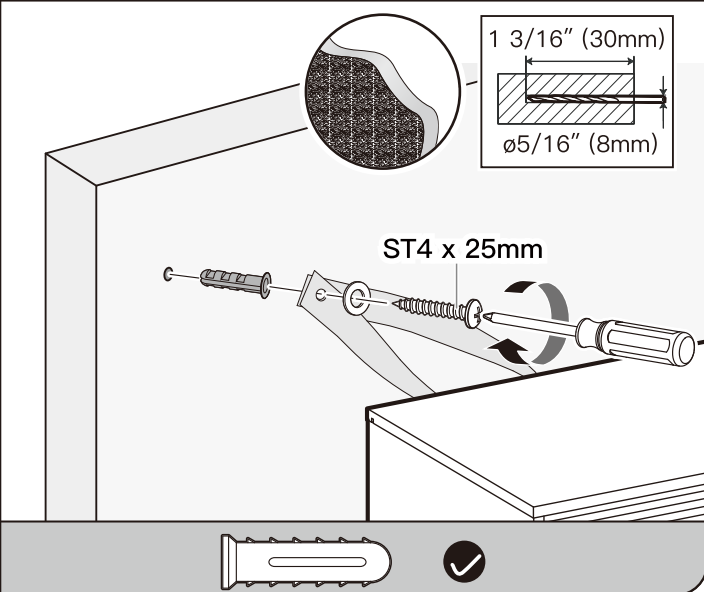

Installation Instructions:

1. Secure the strap to the top of the dresser using a short screw.
2. Determine where the dresser is to be placed. If you have a wood stud wall, locate a stud using a stud finder and mark the centerline.
3. Drill pilot holes in the wall at the appropriate height.
4. Secure the strap to the wall using long screws and washers.

Note: Use wall anchors for solid concrete. Do not use them on wood studs.