

HOW TO MAINTAIN FOUNTAINS:

Thank you for your purchase of Fountain! In this care sheet you will find important information about installing and maintaining your fountain. Products are made with the upmost care and best materials possible. With proper care and maintenance, your fountain will last for years and generations to come.

BASIC INFO:

~ Place fountains on a **flat, solid base**. Examples include: a concrete foundation, compacted gravel, or paver stones. Fountains need to be on a level surface to operate correctly.

~ Fountains with a large one-piece pond basin, (48" diameter and up) the basin must be placed on a soft surface like sand or gravel (not dirt). If a pond basin is to be installed on a hard surface like concrete or pavers, a 1"-2" layer of sand must be applied over the surface. The sand will help with leveling by allowing the basin to settle and be completely supported, reducing the risk of possible stress cracks due to uneven support. Sand can be grouted after installation to prevent and run-off.

~ Fountains do not require a permanent water line as come with recirculating pumps. Fountains can be filled using a hose, bucket, etc. when needed.

~ You need to have electrical outlet in close range to the location of the fountain. pumps have a three prong plug and the cord length is usually 12 ft long, so the outlet needs to be fairly close. Fountain pumps should only be plugged into a GFCI protected, outdoor outlet.

~ Water level must be full to the rim AT ALL TIMES (not doing so will cause the concrete to shock and crack).

~ During the winter months, protect your fountain from harsh or freezing weather by draining the fountain and covering it with a weather proof tarp, or dismantle fountain and store indoors. This will protect your fountain from cracking and/or severe damage. REMOVE WATER FROM FOUNTAIN DURING PROLONGED FREEZES. FREEZE DAMAGE WILL VOID YOUR WARRANTY.

~ Never fill a bowl with water when it is hot to the touch (doing so will shock the concrete and crack). Fill the bowl in the early morning or at night when it is cool out.

~ Keep the water pump clear of leaves and debris so that it does not get clogged

***Clean pump filter at least once a month**, depending on the area the fountain is. In heavily wooded areas, the pump needs to be checked and cleaned more often.

~ If the fountain develops algae or build up, drain the water from the fountain and scrub off with a brush or soft carwash sponge. Try not to scrub too hard or vigorously. Doing so may cause the stain to come off. Rinse after algae is scrubbed off.

*To prevent algae build up, use an algae reducer solution, such as **Fountec or CrystalClear-Sparkle**, to reduce any build up.

Do not use Chlorine or any other pool chemicals! Chlorine and most pool chemicals will damage the fountain and pump.

~ Hard water should be filtered before filling your fountain; you can use a hose-attached prefilter, such as the **PreFresh Spa & Pool Water Fill Filter**, available online or at a local swimming pool supply store. In areas with severe hard water, only distilled water should be used to fill your fountains. Filtering the water will not remove all mineral content in hard water, lime scale and white residue can still appear on your fountain, which should be removed immediately.

~ **Any white residue** (white scale, lime scale, calcium buildup, or efflorescence) that builds up on the fountain **should be removed immediately**. This buildup is normal and unavoidable in areas with a high mineral content (hard water) in the local water supply. The best way to remove any white residue would be to gently scrub a mixture of **Protec** or (**CrystalClear-SubLime**) and water along the surface of the fountain. A mixture of 3 parts white vinegar and 1 part water will also work and removing any white residue. Failure to remove any white residue will stain and/or damage the fountain. Adding **Protec** or **SubLime** to the fountain's water will help in softening the hard water, regular use in accordance to the instructions is EXCESSIVE WEIGHT OR PRESSURE ON FOUNTAINS AND/OR STATUARY MAY CAUSE THEM TO FALL. KEEP CHILDREN AND OTHERS FROM CLIMBING, SITTING OR LEANING ON YOUR FOUNTAIN AND/OR STATUARY ITEMS. ALL WALL FOUNTAINS HAVE AN ATTACHMENT POINT BEHIND THE TOP HALF OF THE WALL FOUNTAIN. ALL WALL FOUNTAIN TOPS MUST BE SECURED TO WALL, FENCE, etc. FOR STABILITY. SIGNATURE MEANS FULL UNDERSTANDING AND RELEASE OF LIABILITY FOR recommended. warranty does not cover damage due to white scale, lime scale, calcium buildup, efflorescence, or freeze damage. Please thoroughly review this care sheet for more information.

~ Most fountains have no interlocking component parts. The component parts are held together by gravity only. Gluing or cementing the component parts together is not recommended. The parts may need to be dismantled to replace the pump, hardware, or to move the fountain to another location.

CAUTION:

~ EXCESSIVE WEIGHT OR PRESSURE ON FOUNTAINS AND/OR STATUARY MAY CAUSE THEM TO FALL. KEEP CHILDREN AND OTHERS FROM CLIMBING, SITTING OR LEANING ON YOUR FOUNTAIN AND/OR STATUARY ITEMS. ALL HAVE AN ATTACHMENT POINT BEHIND THE TOP HALF OF THE WALL FOUNTAIN. **ALL WALL FOUNTAIN TOPS MUST BE SECURED TO WALL, FENCE, etc. FOR STABILITY.**

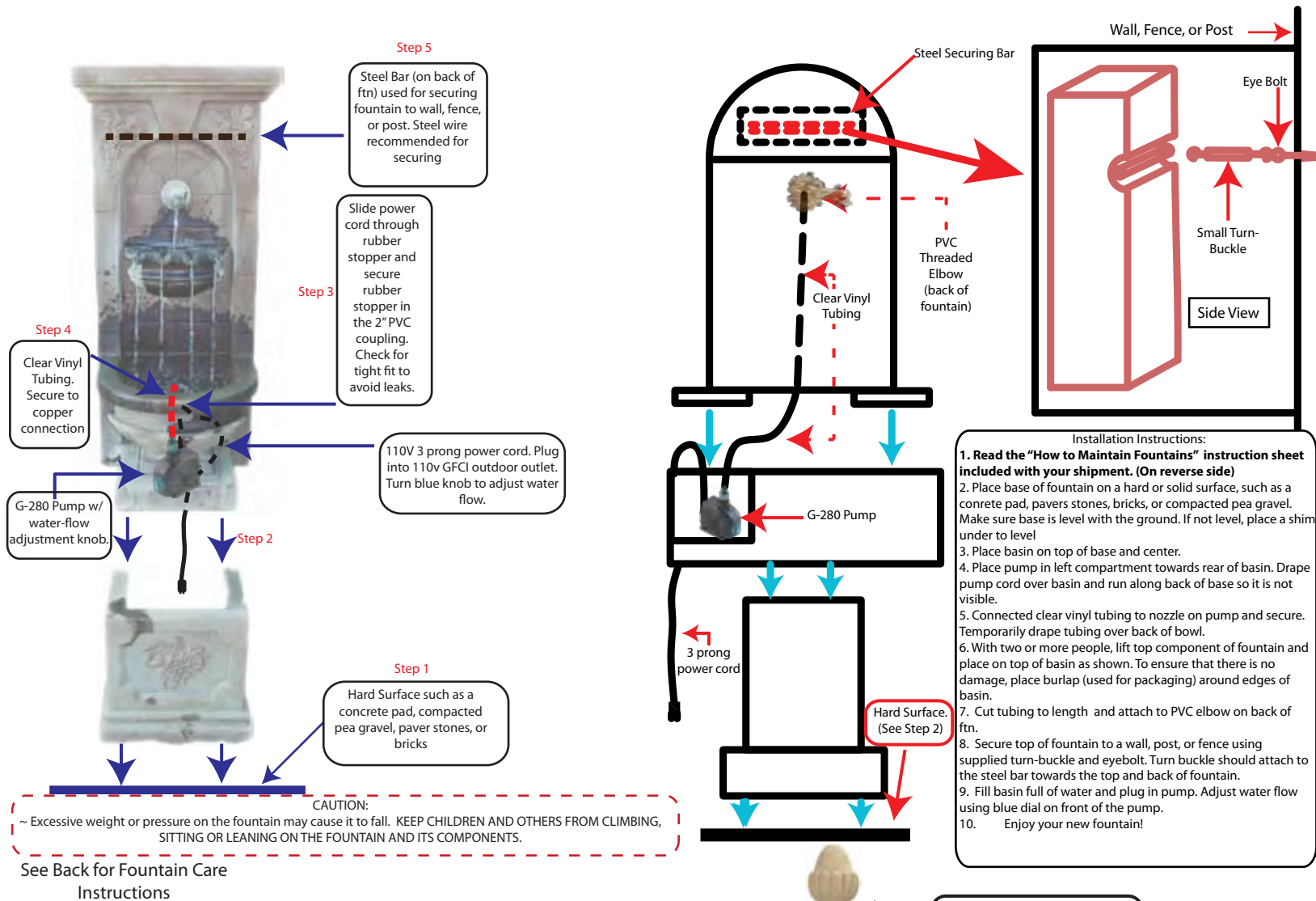

See Back for Fountain Care Instructions

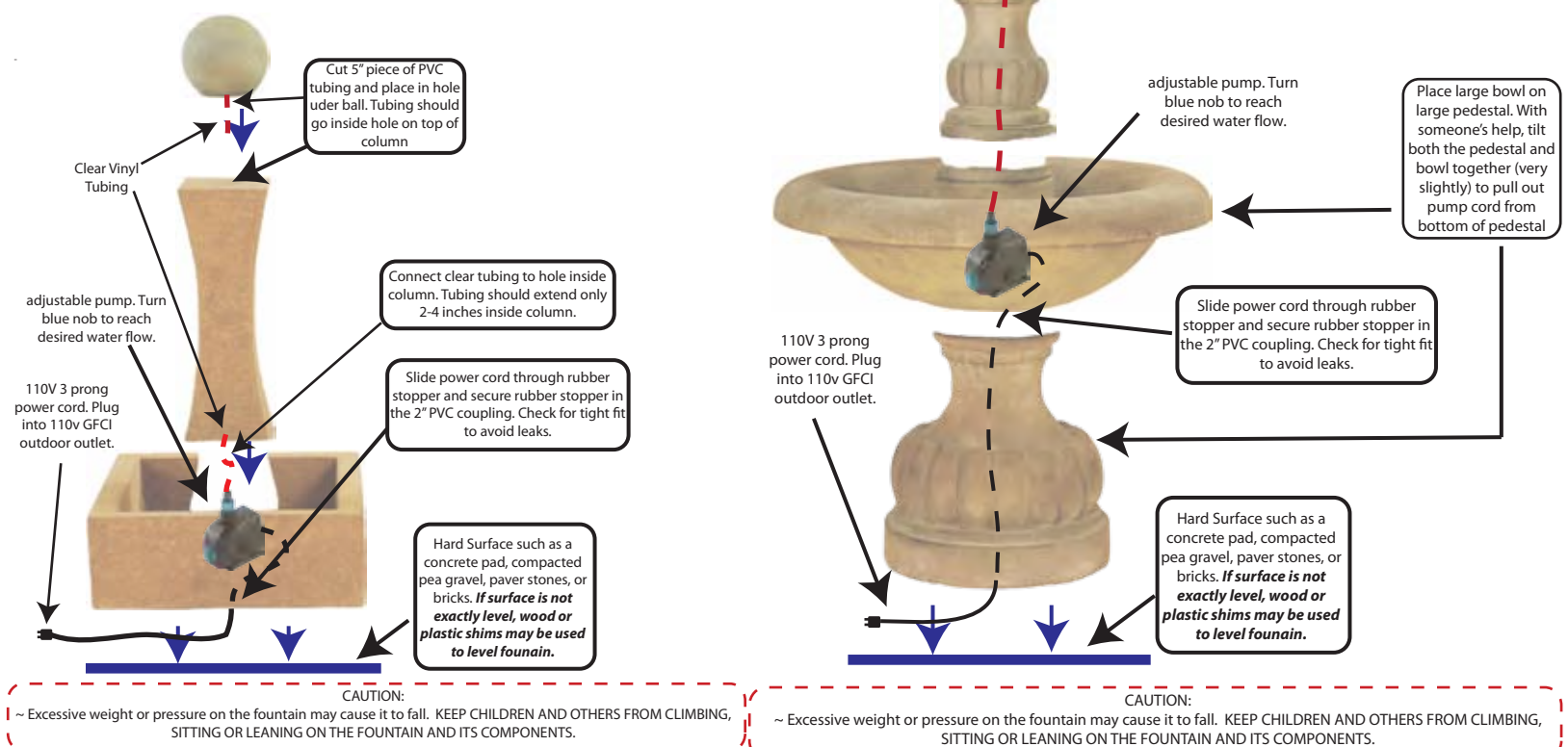

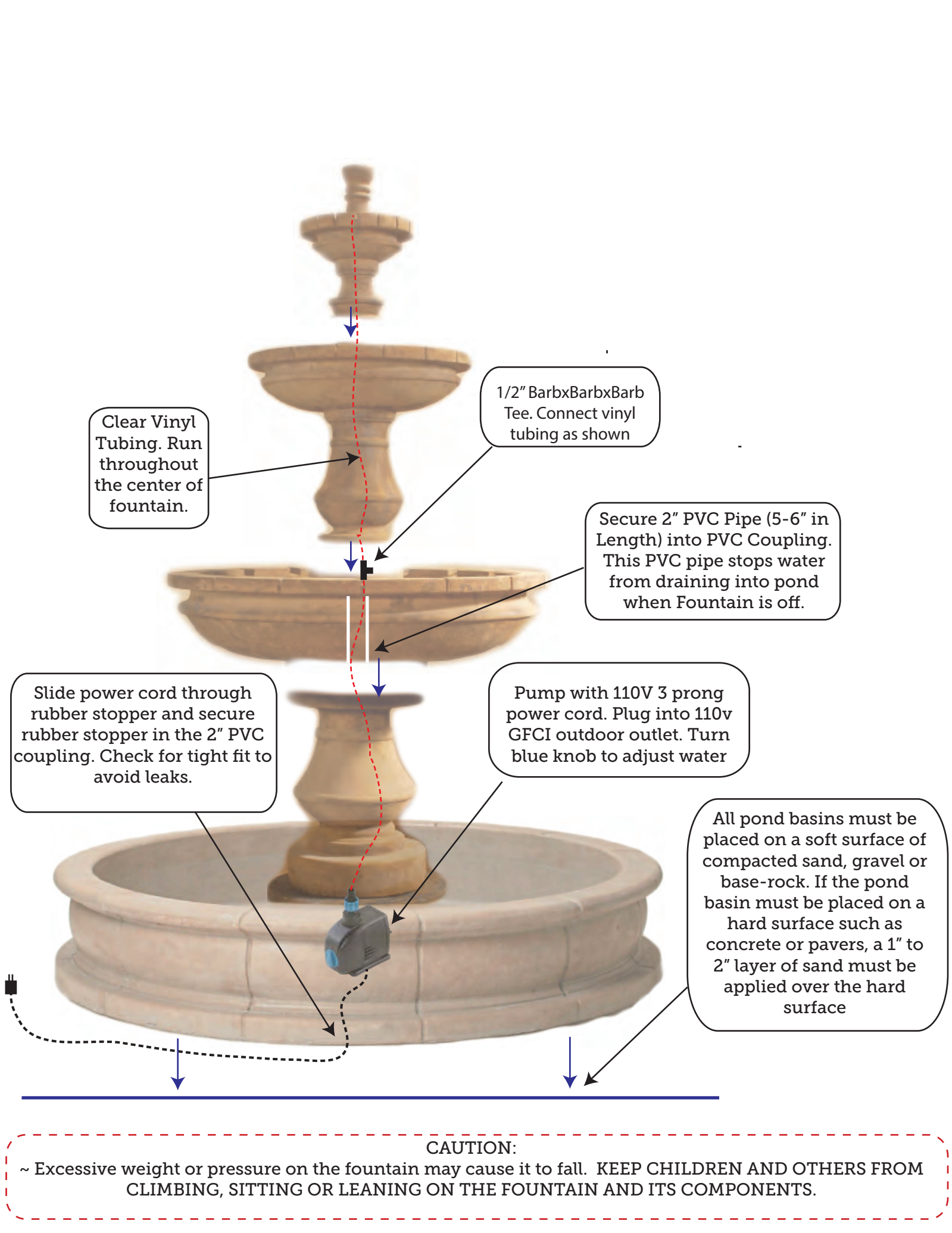
A diagram of a three-tiered stone fountain. A red dashed line shows the path of clear vinyl tubing running vertically through the center of the fountain. Blue arrows indicate the direction of water flow. A black pump is located in the base of the fountain. A black power cord is shown entering the pump from the bottom left. A white vertical line represents a 2-inch PVC pipe installed in the center of the fountain. A black rubber stopper is shown at the junction of the PVC pipe and the pump. A black 1/2-inch barbed tee is shown connecting the vinyl tubing to the PVC pipe. A black 2-inch PVC coupling is shown at the base of the fountain, where the PVC pipe is secured. The fountain is shown sitting on a blue horizontal line representing the ground.

Clear Vinyl Tubing. Run throughout the center of fountain.

1/2" BarbxBarbxBarb Tee. Connect vinyl tubing as shown

Secure 2" PVC Pipe (5-6" in Length) into PVC Coupling. This PVC pipe stops water from draining into pond when Fountain is off.

Slide power cord through rubber stopper and secure rubber stopper in the 2" PVC coupling. Check for tight fit to avoid leaks.

Pump with 110V 3 prong power cord. Plug into 110v GFCI outdoor outlet. Turn blue knob to adjust water

All pond basins must be placed on a soft surface of compacted sand, gravel or base-rock. If the pond basin must be placed on a hard surface such as concrete or pavers, a 1" to 2" layer of sand must be applied over the hard surface

CAUTION:

~ Excessive weight or pressure on the fountain may cause it to fall. KEEP CHILDREN AND OTHERS FROM CLIMBING, SITTING OR LEANING ON THE FOUNTAIN AND ITS COMPONENTS.

Pad Diagram for all One Piece Round Ponds & Easy Ponds, including the following sizes:

84", 82", 80", 71", 70", 66", 61" 58", 54", 51", 48", 37"

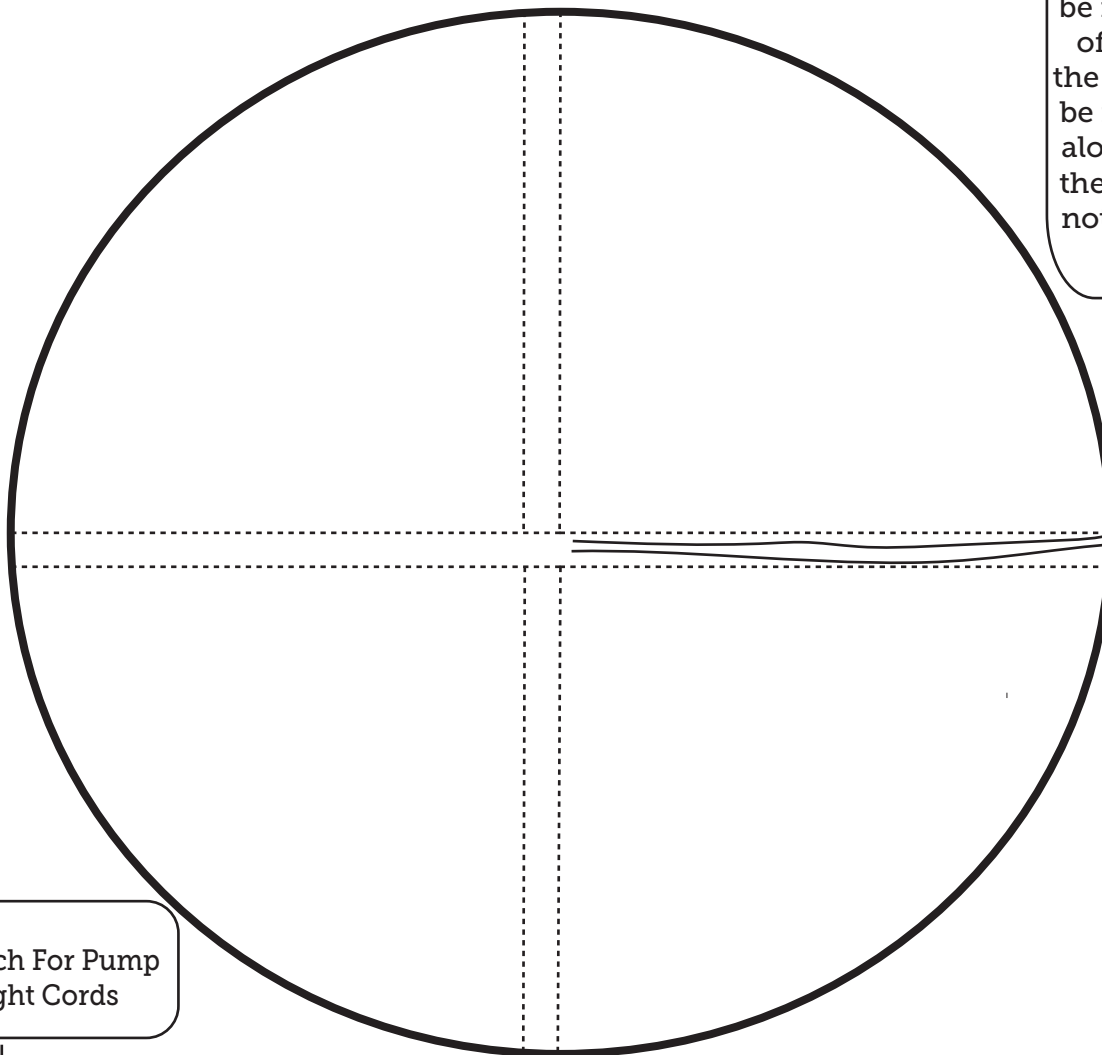

GFCI Duplex outlet with waterproof receptable box should be installed within 20' of the outer edge of the pond pad. Can also be installed anywhere along the pad edge as the pond has multiple notches for the pump and light cords.

Pump and submersible light wires come out from under the pond and above the pad. Pond includes a notch on the bottom for the cords.

----- = Notch For Pump & Light Cords

Various widths, depending on pond.
Reference invoice or quote for pond size.
Pad to be 4"-5" thick.

All pond basins must be placed on a soft surface of compacted sand, gravel or base-rock. If the pond basin must be placed on a hard surface such as concrete or pavers, a 1" to 2" layer of sand must be applied over the hard surface

VERY IMPORTANT IF INSTALLING ON A CONCRETE PAD: Concrete pad must be completely flat and level.

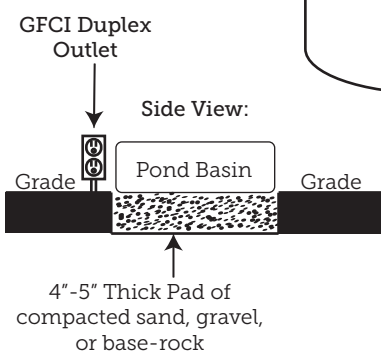

Garden Flame Collection



DANGER

IF YOU SMELL GAS:

- Shut off gas to the appliance immediately
- Extinguish any open flame
- If odor continues, keep away from the appliance and immediately call your gas supplier or fire department



WARNING

- HOT! DO NOT TOUCH. SEVERE BURNS MAY RESULT
- CLOTHING IGNITION MAY RESULT
- Glass and other surfaces are hot during operation and cool-down.



WARNING

For outdoor use only

CARBON MONOXIDE HAZARD!

This appliance can produce carbon monoxide. Using this appliance in an enclosed space can kill you! **Never use in an enclosed space such as campers, tents, cars, or inside your home.**



WARNING

FIRE PIT OR FIRE BOWL MUST BE INSTALLED BY A QUALIFIED TECHNICIAN WITH EXPERIENCE IN GAS AND ELECTRIC SERVICE. ALL GAS CONNECTIONS MUST BE CHECKED WITH COMMERCIAL LEAK-CHECKING EQUIPMENT.



WARNING

Improper installation, adjustment, alteration, service, or maintenance can cause injury or property damage.



WARNING

Do not burn solid fuels in this gas or propane appliance.



WARNING

Do not store or use gasoline, or other flammable vapors and liquids, in the vicinity of the fire pit or any other source of flame.



WARNING

Key valve & propane valve MUST be shut off when not in use. Key must be removed and stored in a safe place



WARNING

CHECK ENTIRE SYSTEM FOR LEAKS BEFORE OPERATING



WARNING

Children must be supervised at all times when near the fire pit or fire bowl.

GLASS AND OTHER SURFACES ARE HOT DURING OPERATION AND COOL-DOWN



WARNING

All vents must remain open and uncovered. Fire media such as glass and/or lava rock must not block airflow to and from vents.

DO NOT BURN WITHOUT GLASS OR OTHER SUBSTRATE IN BURNER.