

edishinē

LED Floor Lamp

SPU: HFLCD4A
[Instruction Manual]

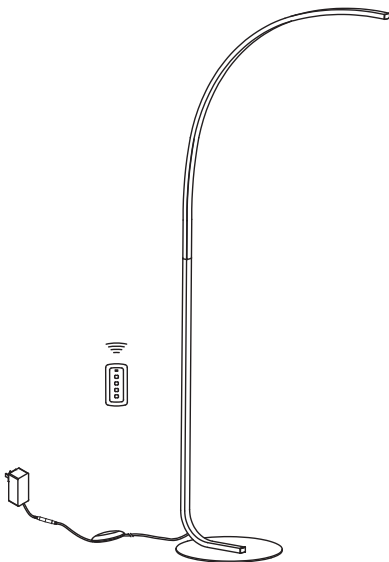

Please pay attention to the warning signs
Read the instructions with caution before operating
and keep it properly

CAUTION

1. Before assembly, place all parts out on a clean flat surface and inspect each part for defects that may have occurred during shipping.
2. Inspect wire insulation for any cuts, abrasions or exposed copper that may have resulted during shipping. If there are any defects in the wire, DO NOT continue to assemble. Please send an email to our Customer Service immediately.
3. Consult a qualified electrician if you have any electrical questions.
4. Never drape clothes over the lamp.
5. To reduce the likelihood of tipping over, we recommend placing the lamp behind furniture and keep children and pets away.
6. To prevent children from suffocating and choking, keep them away from packing materials.
7. Please keep this manual and hand it over when you transfer the product.

Packing List

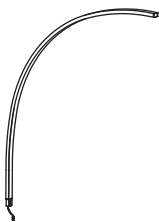

①

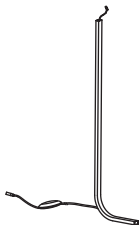

②



③

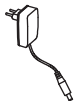

④



⑤



⑥



⑦



⑧

Part	Description	Quantity
1	LED Light Source	1
2	Fixture	1
3	Base	1
4	Adapter	1
5	Remote Control	1
6	M3*7mm Hex Screw	4
7	M4*10mm Hex Screw	3
8	2.5mm Allen wrench	1

Product Assembly

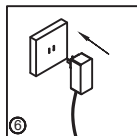
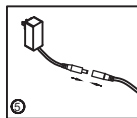
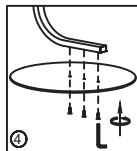
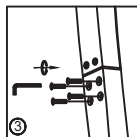
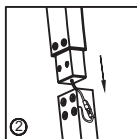
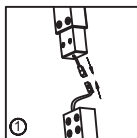
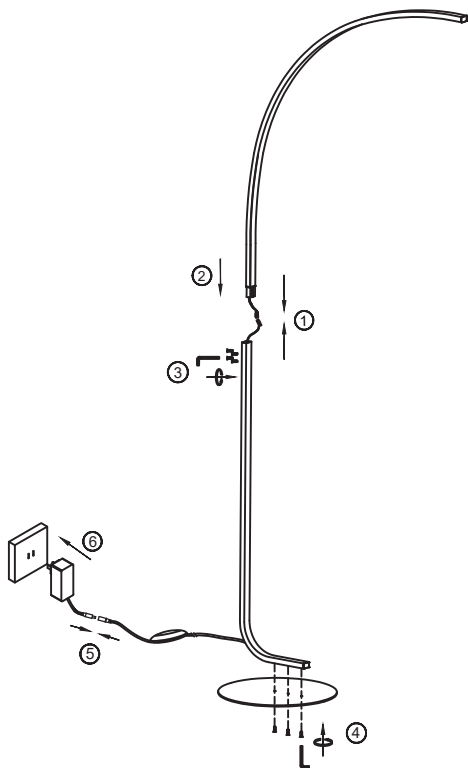

Foot Switch

Press the foot switch once to turn the light ON; short press the foot switch to select the color temperature (3000K/4000K/6500K). And then, short press the foot switch to turn OFF.

After the short press to turn it on, and then Long press the foot switch, the light will gradually to brighten or darken, just moves your feet away when you think the brightness is ok.

Memory function: the floor lamp can remember the mode of the brightness you settled before closing.

Remote Control

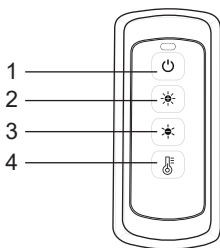

- 1.ON/OFF button (Short press to turn on or off)
- 2.Brightness + (Short press the button, the brightness gradually increases according to 5%/ 25%/ 50%/ 75%/ 100%, Long press stepless dimmable)
- 3.Brightness - (Short press the button, the brightness gradually decreases according to 100%/ 75%/ 50%/ 25%/ 5%, Long press stepless dimmable)
- 4.Color temperature switch button (Pressing the button will switch between 3000K/4000K/6500K)

(The lamps and remote control have been paired in the factory, If you can't control it please do the following)

Pairing between remote control and lamps:

Long press the on/off button for 5s within 30s after power on, the lamps will flash with 3000K color temperature for 1 time (100% bright) to complete the pairing.

Memory function: the floor lamp can remember the mode of the brightness and color you settled before closing.

Specifications

- Product Height: 78.3 IN
- Base Diameter: 13.8 IN
- Wire Length: 70.8 IN
- Materials: Aluminum
- Input Voltage: AC100V-240V 50/60Hz
- Power Consumption: 24W
- Color temperature: 3000K/4000K/6500K

One Year Limited Warranty

Supported by our professional R&D team and QC team, we provide One Year Warranty for materials and workmanship from the purchase date.

Please note that the warranty does not cover damage caused by personal misuse or improper installation.

Please attach your Order ID and Name so that our dedicated customer service team can help you better.

