

**AQUA  
GALLERY**

# User's Manual

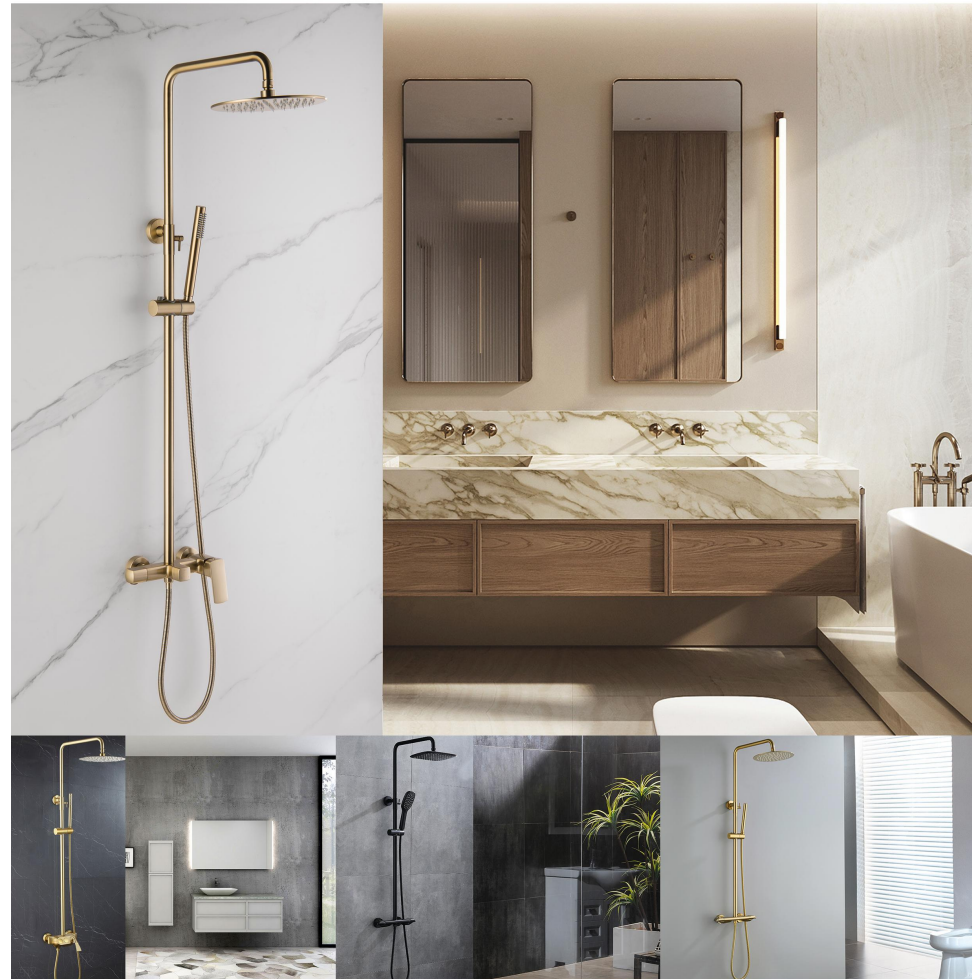

# INSTALLATION INSTRUCTIONS

## Installation Manual

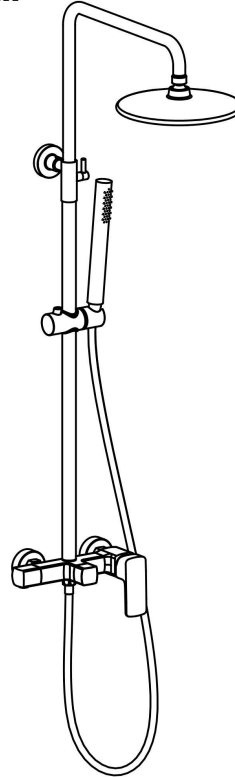

**IAPMO RESEARCH AND TESTING, INC.**  
500 East Philadelphia Street, Ontario, California 91761-2814 • USA • 909-473-4100 • 909-473-4244 • www.iapmo.com

**ANSI** **IAPMO** **UPC**

**CERTIFICATE OF LISTING**

IAPMO Research and Testing, Inc. is a professional testing and certification organization that provides a wide range of testing and certification services to its members. IAPMO Research and Testing, Inc. is a member of the International Association of Plumbing and Mechanical Officials (IAPMO).

This certificate is an attestation of compliance with the following listing criteria: IAPMO Research and Testing, Inc. is a member of the International Association of Plumbing and Mechanical Officials (IAPMO).

Effective Date: December 2019 Rev: 1/28/2020 Valid Until: December 2024  
Product: Plumbing Fixture Fittings - Components Plate No. 10243

Issued To: Apollo Shwing Co., Ltd.  
1700 S. 10th Street  
San Jose, CA 95128  
USA

**Identification:** Products shall be marked with manufacturer's name or trademark, a permanent "Use as instructed" marking, and a permanent marking. The marking shall also bear the "UPC" certification mark. Markings shall be by means of either a permanent mark on the product, a label on the product or a tag attached to the product.

**Characteristics:** Plumbing fixture fittings manufactured in various sizes, lengths and materials, which may or may not have an open bearing area. Components are to be installed for use in accordance with the manufacturer's instructions and the latest edition of the Uniform Plumbing Code and National Plumbing Code of Canada.

Products listed on this certificate have been tested by an IAPMO R&T recognized laboratory. This recognition has been granted based upon the following information:

*Tom Allright* *Ron Ching*

This listing is based on the information provided by the manufacturer. IAPMO Research and Testing, Inc. is not responsible for the accuracy of the information provided. IAPMO Research and Testing, Inc. is not responsible for the accuracy of the information provided. IAPMO Research and Testing, Inc. is not responsible for the accuracy of the information provided.

**IAPMO RESEARCH AND TESTING, INC.**  
500 East Philadelphia Street, Ontario, California 91761-2814 • USA • 909-473-4100 • 909-473-4244 • www.iapmo.com

**ANSI** **IAPMO** **UPC**

**CERTIFICATE OF LISTING**

IAPMO Research and Testing, Inc. is a professional testing and certification organization that provides a wide range of testing and certification services to its members. IAPMO Research and Testing, Inc. is a member of the International Association of Plumbing and Mechanical Officials (IAPMO).

This certificate is an attestation of compliance with the following listing criteria: IAPMO Research and Testing, Inc. is a member of the International Association of Plumbing and Mechanical Officials (IAPMO).

Effective Date: December 2019 Rev: 1/28/2020 Valid Until: December 2024  
Product: Plumbing Fixture Fittings - Components Plate No. 10243

Issued To: Apollo Shwing Co., Ltd.  
1700 S. 10th Street  
San Jose, CA 95128  
USA

**Identification:** Plumbing fixture fittings including with wild shankers shall be marked with the manufacturer's registered name, trademark, or other mark or, in the case of private labeling, the name, trademark or other mark of the customer for whom the fitting was manufactured. The marking shall be accompanied by use of a permanent mark or by placing a permanent label on the fitting. Markings on plumbing fixture fittings shall be visible after installation.

**Characteristics:** Single-handle, single-control, and automatic compensating mixing faucets and shower valves shall have identifiable temperature control markings in which the markings are indicated by words "Hot/Cold", "Open/Close", etc.; by numbers, or graphically.

Products listed on this certificate have been tested by an IAPMO R&T recognized laboratory. This recognition has been granted based upon the following information:

*Tom Allright* *Ron Ching*

This listing is based on the information provided by the manufacturer. IAPMO Research and Testing, Inc. is not responsible for the accuracy of the information provided. IAPMO Research and Testing, Inc. is not responsible for the accuracy of the information provided. IAPMO Research and Testing, Inc. is not responsible for the accuracy of the information provided.

**IAPMO RESEARCH AND TESTING, INC.**  
500 East Philadelphia Street, Ontario, California 91761-2814 • USA • 909-473-4100 • 909-473-4244 • www.iapmo.com

**ANSI** **IAPMO** **UPC**

**CERTIFICATE OF LISTING**

IAPMO Research and Testing, Inc. is a professional testing and certification organization that provides a wide range of testing and certification services to its members. IAPMO Research and Testing, Inc. is a member of the International Association of Plumbing and Mechanical Officials (IAPMO).

This certificate is an attestation of compliance with the following listing criteria: IAPMO Research and Testing, Inc. is a member of the International Association of Plumbing and Mechanical Officials (IAPMO).

Effective Date: March 2019 Rev: 1/28/2020 Valid Until: March 2024  
Product: Plumbing Fixture Fittings - Components Plate No. 10243

Issued To: Apollo Shwing Co., Ltd.  
1700 S. 10th Street  
San Jose, CA 95128  
USA

**Identification:** Each fitting component shall be permanent legible markings to identify the manufacturer. This marking shall be the trade name, trademark, or other mark shown on the manufacturer's packaging. The marking shall also bear the "UPC" certification mark. Markings shall be by means of either a permanent mark on the product, a label on the product or a tag attached to the product.

**Characteristics:** Plumbing fixture fittings components to be installed in accordance with the manufacturer's instructions and the requirements of the latest edition of the Uniform Plumbing Code.

Products listed on this certificate have been tested by an IAPMO R&T recognized laboratory. This recognition has been granted based upon the following information:

*Tom Allright* *Ron Ching*

This listing is based on the information provided by the manufacturer. IAPMO Research and Testing, Inc. is not responsible for the accuracy of the information provided. IAPMO Research and Testing, Inc. is not responsible for the accuracy of the information provided. IAPMO Research and Testing, Inc. is not responsible for the accuracy of the information provided.

## BEFORE INSTALLATION

### ► Notes before installation

1. Please check that all components are present.
2. Before installation ensure that all feed lines are clear of debris and on/off valve is present.
3. Pictures in the manual are general in content and may not represent exactly your purchased faucet.  
If you are having difficulties please contact a professional plumber.
4. If you will be away from home for an extended period you should shut off the main water supply.

### ► Recommend Tools And Materials

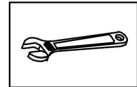

Adjustable Wrench



Hexagon wrench

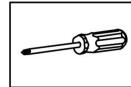

Philips Screwdriver



Pipe Tape

### ► Installation Dimension

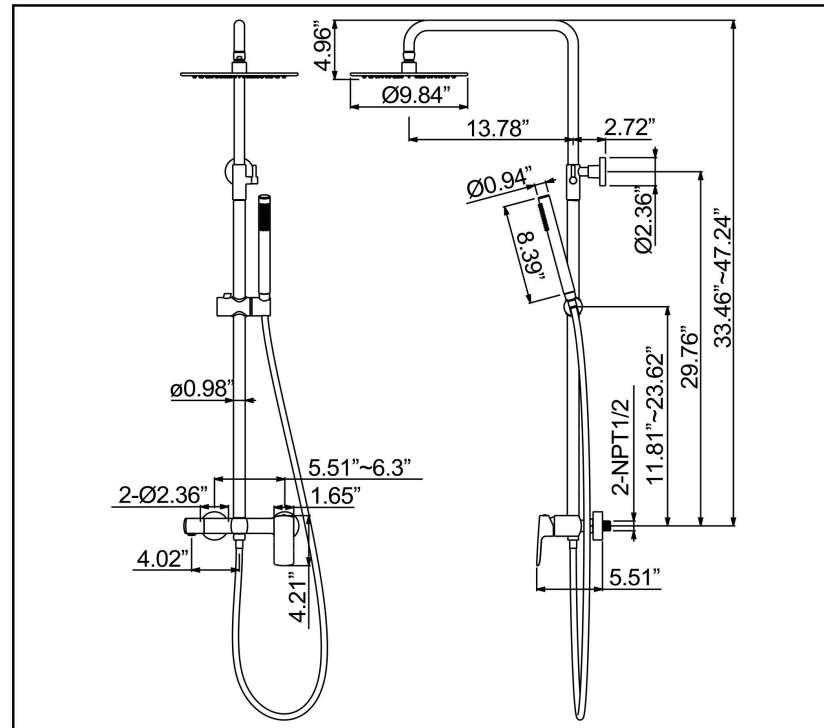

## INSTALLATION STEPS

This product has been inspected and debugged by the factory to the best condition. Please do not disassemble and assemble it yourself.

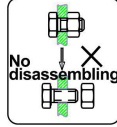

Before installing the product, please be sure to remove sundries and sludge from the water pipe to prevent sundries from blocking the product.

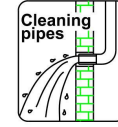

1. As shown, install the accessories and attach the tape.

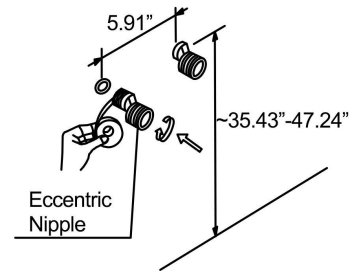

2. Install the main body and rubber pad.

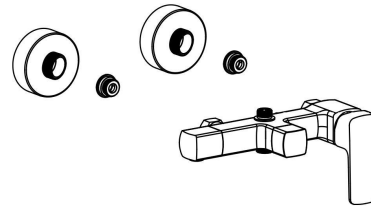

3. Install the riser on the faucet.

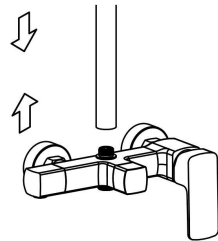

4. Install the mounting piece on the shower arm.

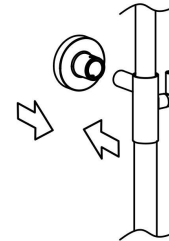

5. Make sure the riser is level, mark the position of the screw holes.

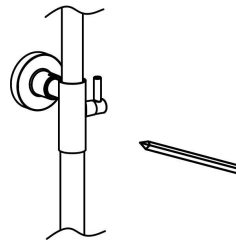

6. Remove the riser and the mounting piece.

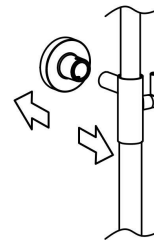

## INSTALLATION STEPS

7. Drill the screw holes and install the anchors.  
Install the mounting piece and mounting piece seal.

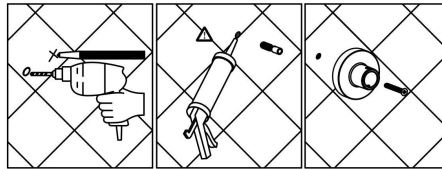

8. Install the riser on the faucet,  
tighten the screw.

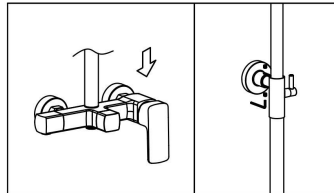

9. Install the shower rain head.

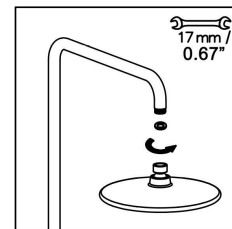

10. Place the hose washer in the short hose end connection. Connect this end of the hose to the faucet. Place the screen washer in the long hose end connection. Install the hand shower on this end of the hose. Rest the hand shower in the holder.

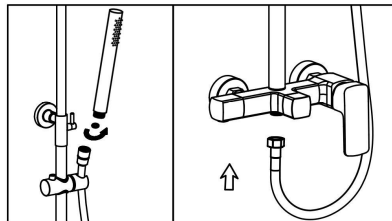

## CLEANING CARE

In order to keep the appearance of product clean, bright and good performance, please take care of the product as follows;

1. Rinse with water only and dry with soft cotton cloth;
2. Use mild liquid and colorless glass cleaner to remove surface dirt and scale film, or use polish without abrasive effect;
3. Do not use abrasive detergent, polish, emery cloth, paper towel or scraper, etc;
4. Do not use acid cleaner, or cleaner and soap with insoluble gran etc;
5. In the process of use, mud may accumulate in the bubbler and make the water flow slow. The bubbler can be unscrewed, rinsed with water, and then installed back in place.



Please feel free to contact us if you have any questions. We will help to solve the issue together with you. OUR EMAIL: [services@rbrohant.com](mailto:services@rbrohant.com)



**AQUA  
GALLERY**