

LDC469

USER MANUAL
LED RECESSED SPOTLIGHT

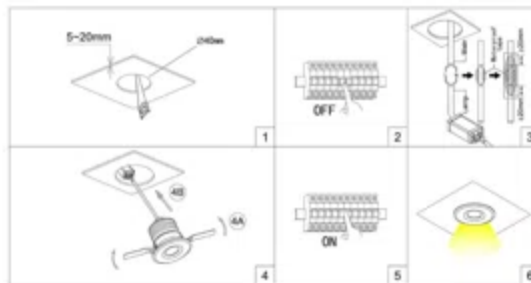

- 01 MAKE HOLE PATTERN
- 02 SWITCH OFF MAIN
- 03 CONNECT POWER-SUPPLY TO THE MAIN
- 04 HOLD SPRINGS
- 05 PUT LAMP INTO CEILING
- 06 SWITCH ON THE MAIN AND LIGHT ON



LDC469
(20x40mm)
LED-3W
open Ø40mm

Lamp: CREE XPE LED
Color: 2700K/3000K/4000K/6000K
Color rendering: Ra80
Input: 100V-240V AC
Current: Constant 600mA
Frequency: 50/60Hz
Watt: 3W
Life span: 20,000hrs
Operating temp: -20°C~+40°C
IP65
Dimmable: NO

Cautions: a Installed by qualified electrician
b Use only power supply supplied
by manufacturer for products guarantee