

INSTALLATION INSTRUCTION

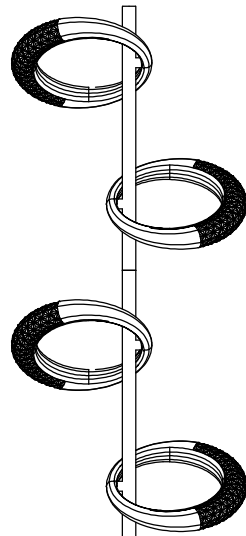

You can use this foot pedal to control the light switch

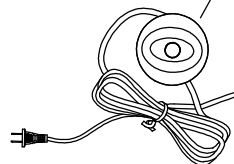

Connection terminal
(In Put Voltage 110-265V)

Installation instructions for Metal mount

This job will go easier with two people, because the light needs support during assembly and it helps having somebody to read the directions.

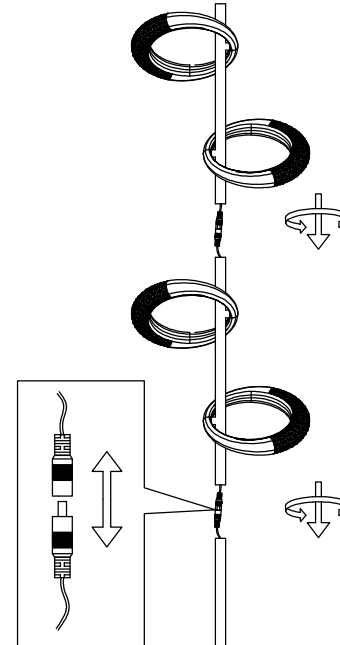

Tighten the main rod in order from the bottom, the power connector is as shown in the figure

When you unpack your package you will find these items

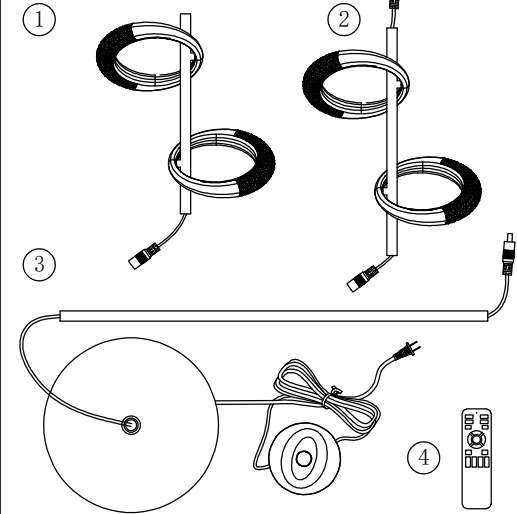

Tear off the protective film under the metal base, gently pull off the excess wire and tie it tightly with a cable tie, and finally stick the protective film on the base.

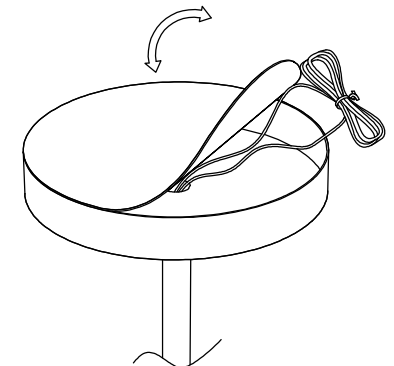

⚠ Warning!

1. Please install by professional.
2. The voltage available for 110-260V only.
3. Don't install the lighting fixture under moist condition.
4. Please switch off the power when you cleaning the lighting.
5. Keep away from acidic & corrosive material.