

Let's build the

Cohen Dining Chair

SKU 24521

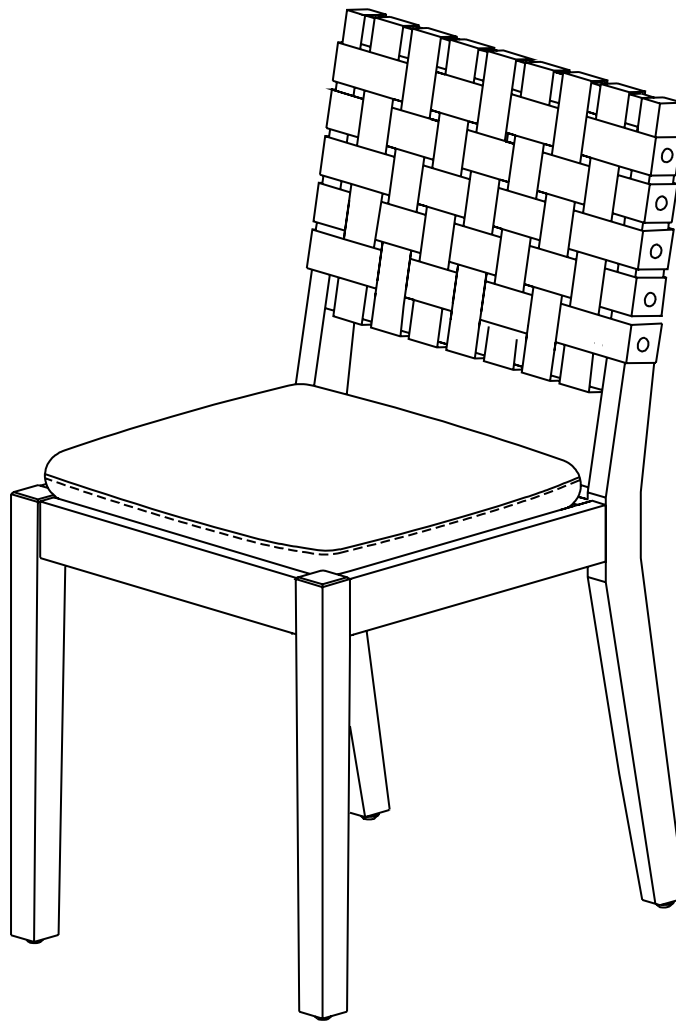

Scan me!

Inspiration
Digital Instructions
Free Lifetime Warranty

nathan james

23-1206-VN

Ok, let's get rolling

This should be easy, just follow our instructions and you will be back to Netflix in no time.

Estimated time for assembly



25:00

What you need

- Some bubbly or your preferred relaxant
- Use the packaging carton as a working surface to prevent product damage during assembly
- Phillips head screwdriver

Do not use a drill



Weight Limitation



300
lbs

Toll-free at 1-866-619-1004
Help@nathanjames.com
Nathanjames.com/help

What's included

Description		Qty
A	Chair Back Assembly	1
B	Seat Cushion w/ Frame Cover + velcro	1
C	Seat Frame	1
D	Front Legs	2
1	¼ x 1½ inch Hex Button Head Bolt	2
2	¼ x 2⅜ inch Hex Button Head Bolt	4
3	¼ x 3⅝ inch Hex Button Head Bolt	4
4	¼ inch Lock Washer	10
5	¼ inch Flat Washer	10
6	Allen Key	1
7	Plastic Nail-in Footpad (Extra)	4

Scan me!

Free Lifetime
Warranty



The goods

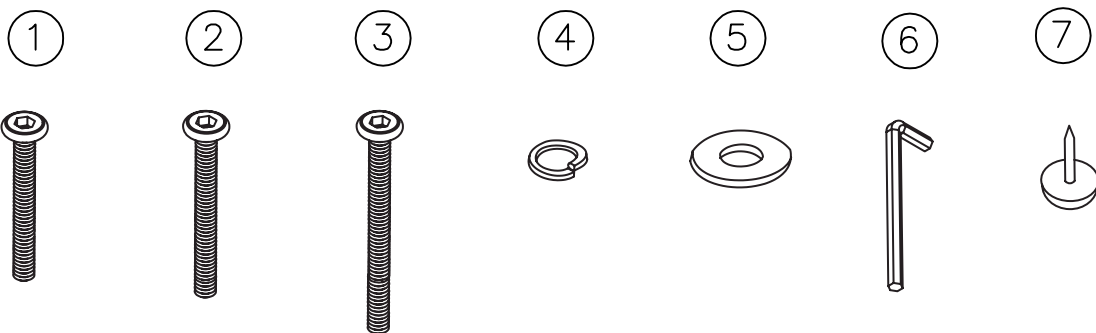
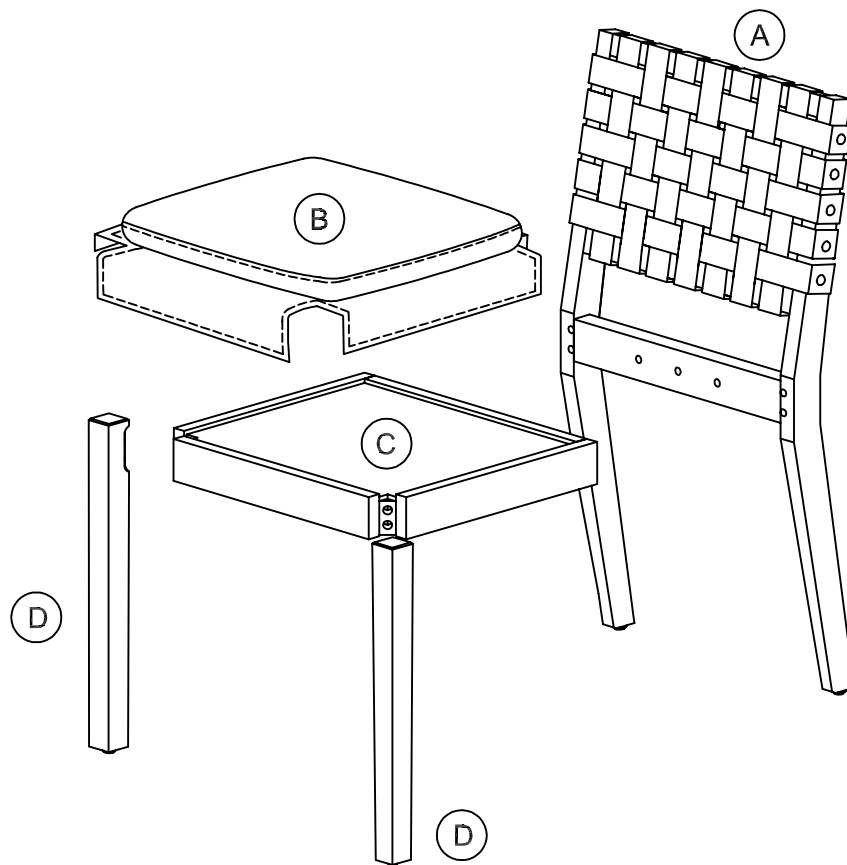

IMPORTANT

1. Do not tighten bolts / screws completely until all bolts / screws are lined up and inserted into holes.
2. Do not over tighten screws and bolts to avoid stripping.
3. Please use hand tools to assemble this product. Do not use power tools.

Step 1

Let's get this thing fired up! Attach the Seat Frame (C) to the Chair Back Assembly (A) using two sets of the Flat Washers (5), Lock Washers (4), and $\frac{1}{4} \times 1\frac{1}{2}$ inch Hex Button Head Bolts (1). Tighten using the included Allen Key (6)!

Do not overtighten hardware.
Tighten to 75% for now.

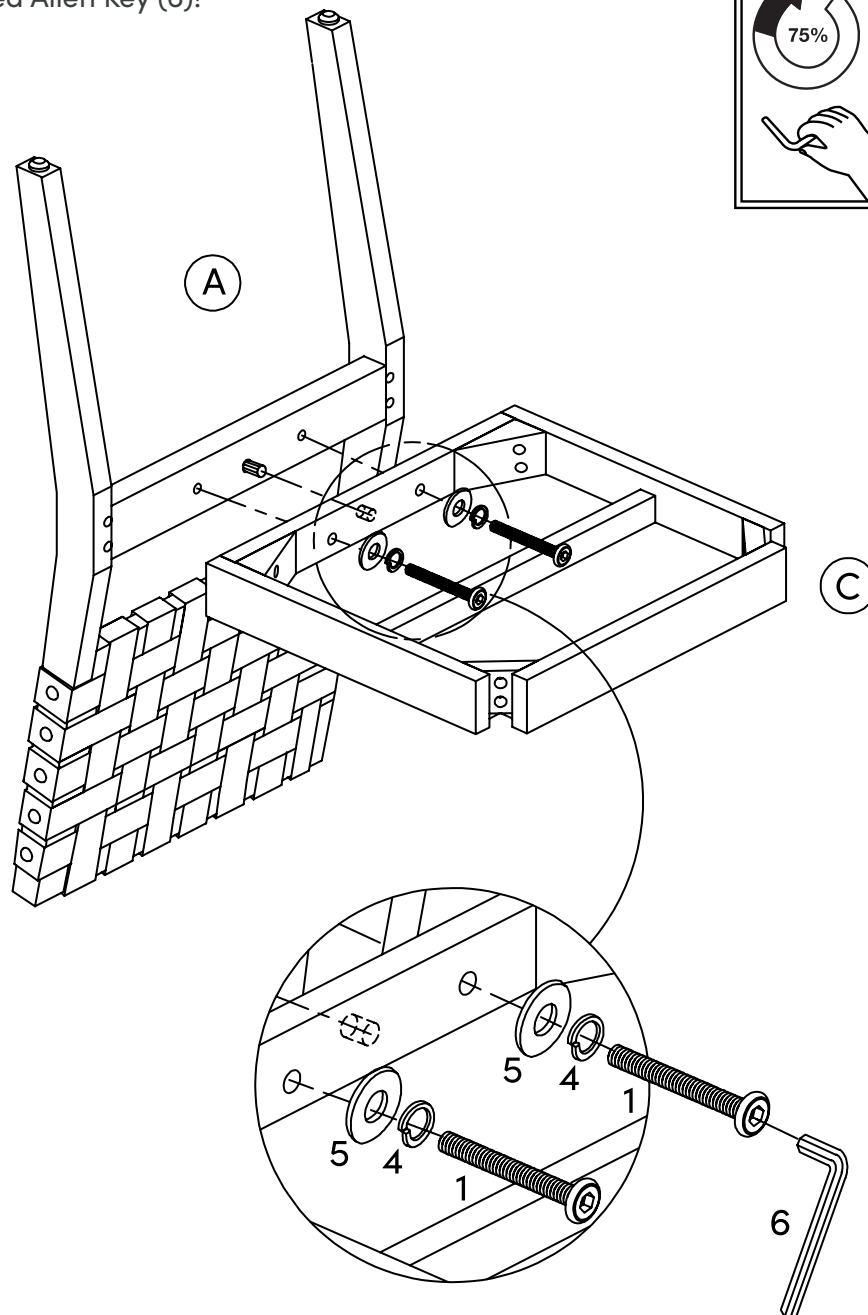
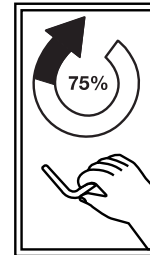

Step 2

Righty-tighty! Secure the Seat Frame (C) to the Chair Back Assembly (A) using the two sets of Flat Washers (5), Lock Washers (4), and $\frac{1}{4}$ x $3\frac{1}{8}$ inch Hex Button Head Bolts (3) in the holes pictured below.

Do not overtighten hardware.
Tighten to 75% for now.

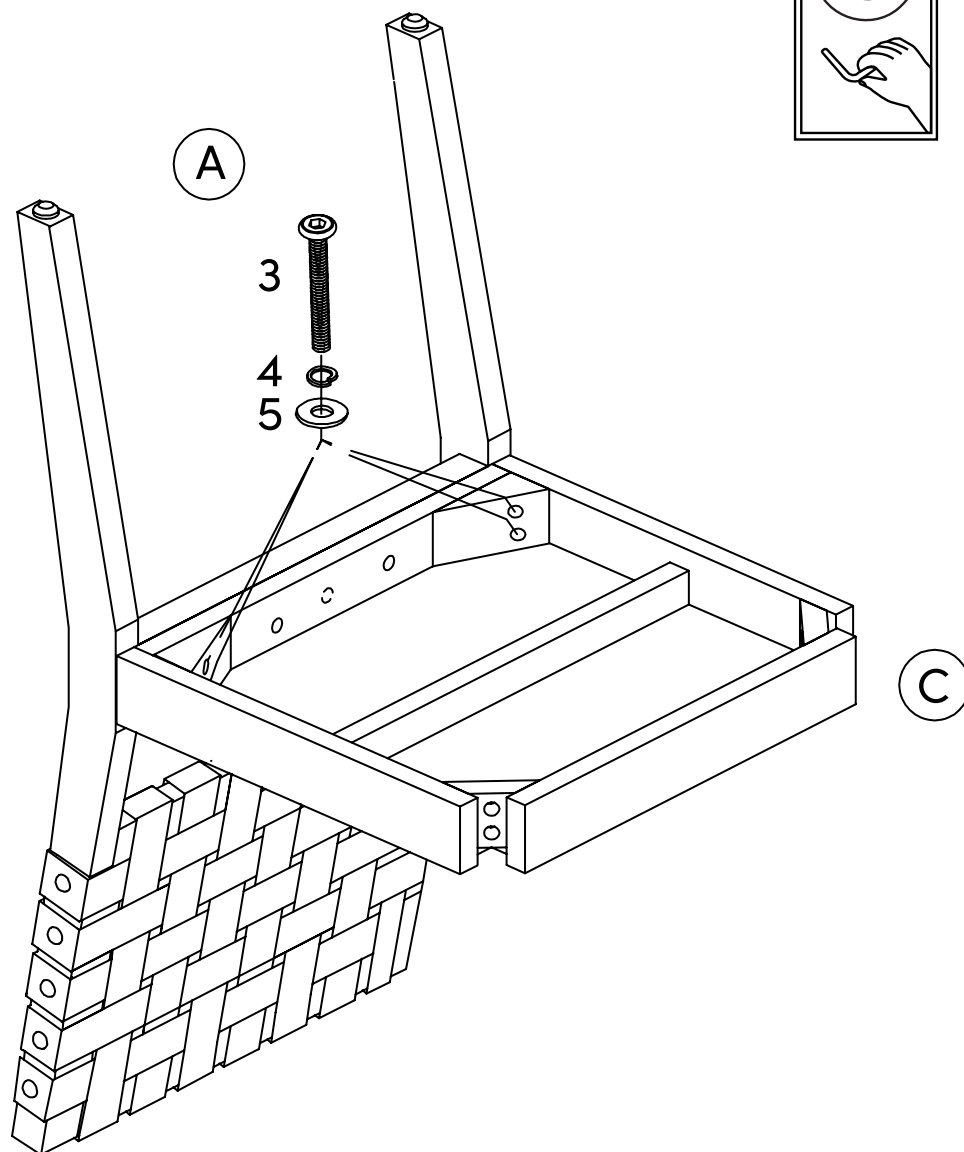
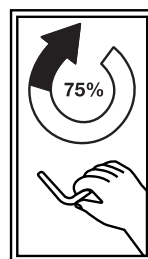

Step 3

You know what they say, never skip leg day! Attach the Front Legs (D) to the Seat Frame (C) using the Flat Washers (5), Lock Washers (4), and $\frac{1}{4}$ x $2\frac{3}{8}$ inch Hex Button Head Bolts (2).

Do not overtighten hardware.
Tighten to 75% for now.

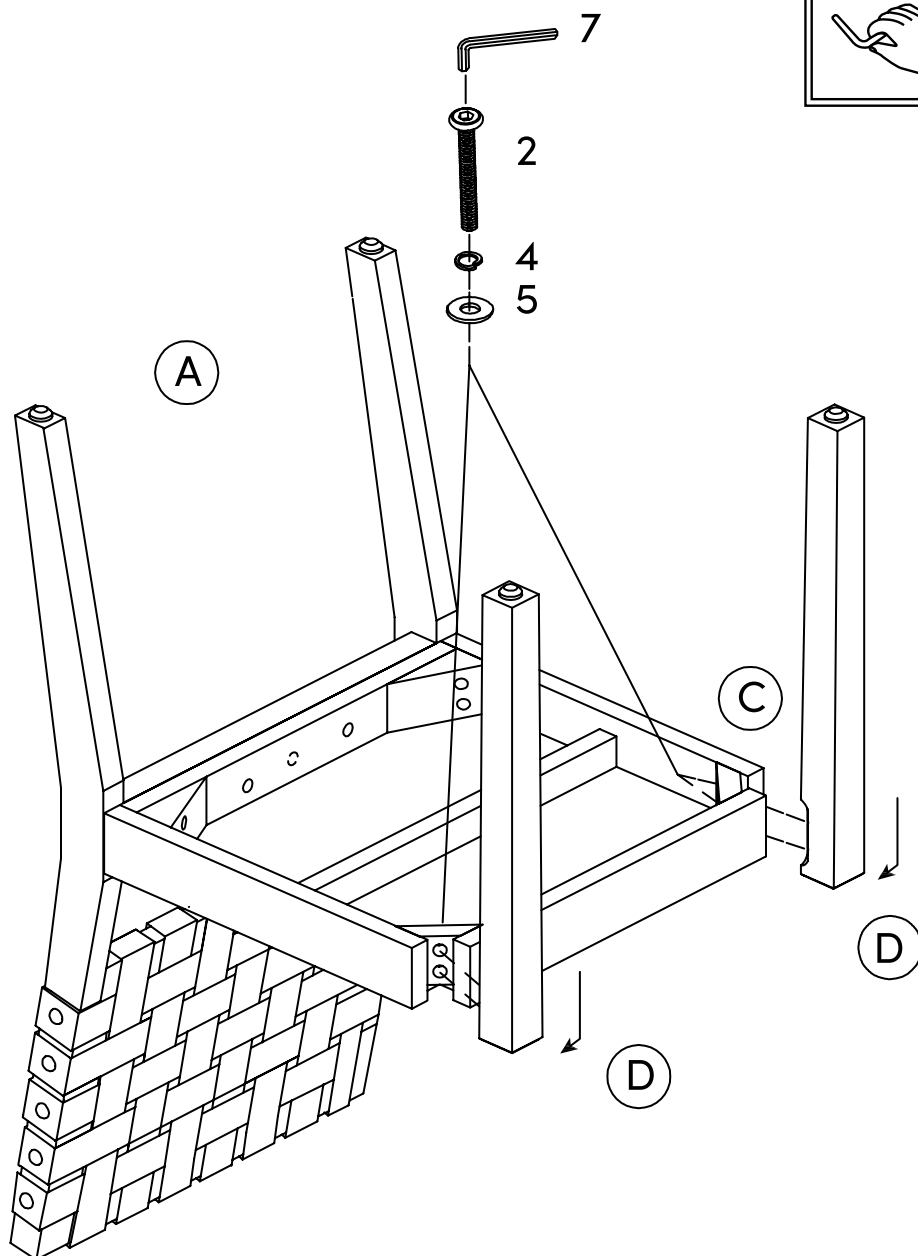
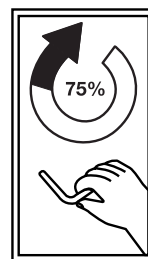

Step 4

It's all coming together! Place the Seat Cushion w/ Frame Cover + velcro (B) to the top of the Seat Frame (C) and carefully flip over to secure the velcro to the underside of the Frame.

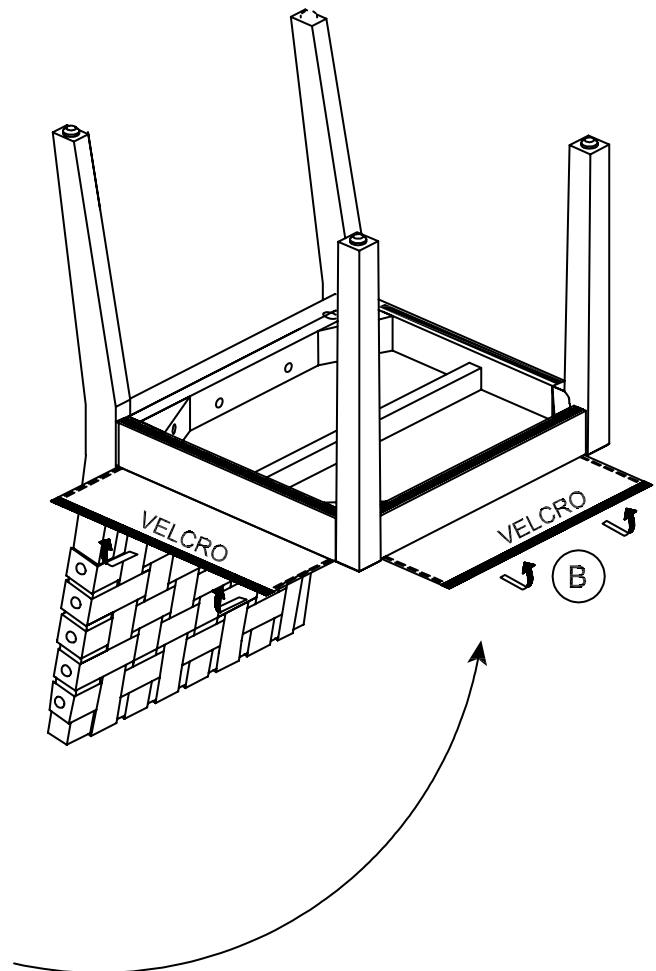
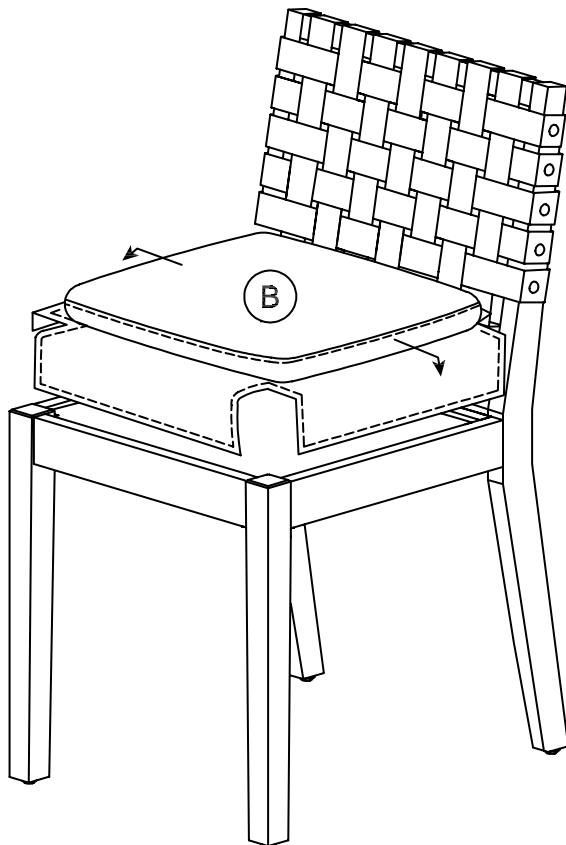

Step 5

Last but not least, tighten all screws to 100%!

Bon appétit! When does the pizza get here?

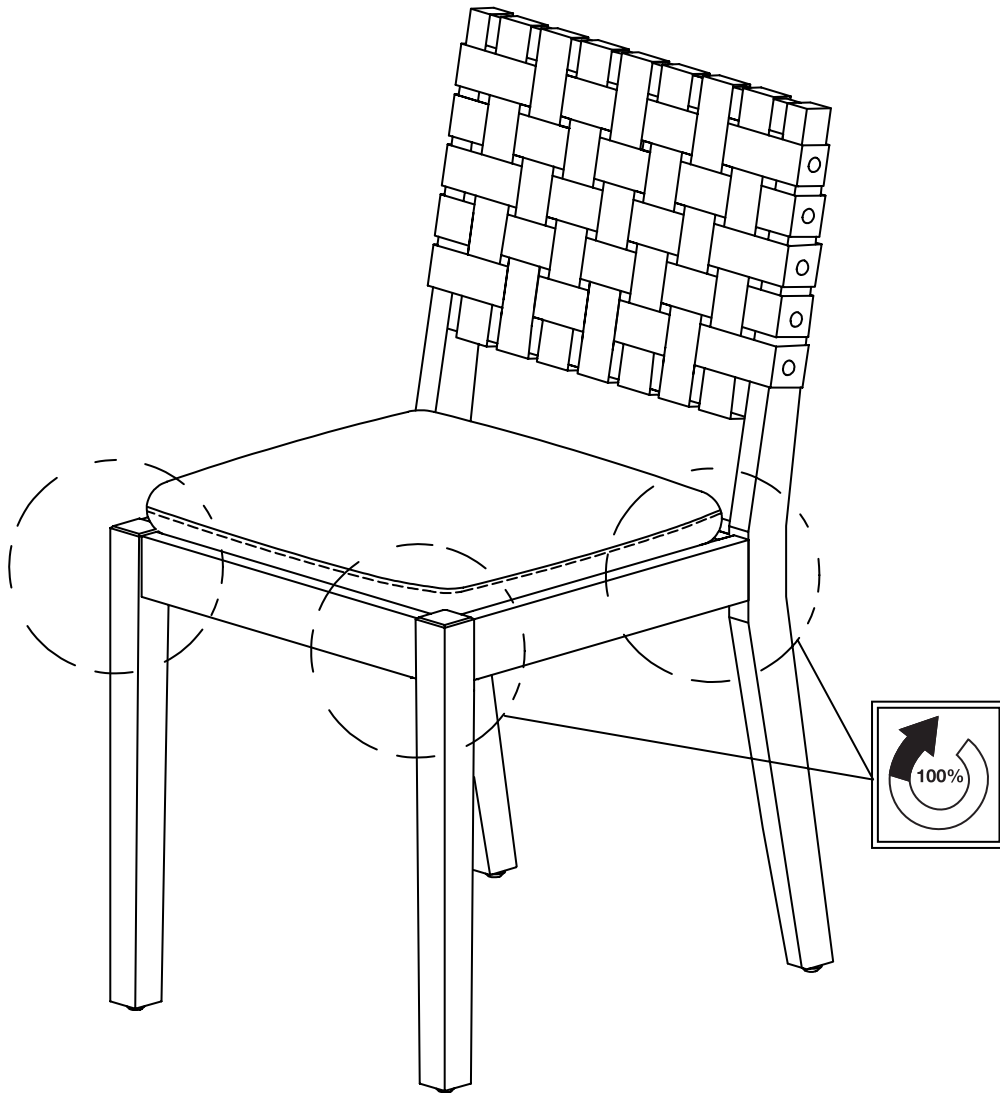

No heartburn, when we handle the return

Give us a call **1-866-619-1004** or shoot us a message at **help@nathanjames.com** we will issue you a free replacement with **zero hassle**.

Our way



Give us a call



Replacement



You

Their way



Re-package item



Schedule pick up



Track package



Replacement



You

We really don't want you to go through the hassle of re-packaging your item and sending it back, because let's be honest...nobody has time for that.

Safety first, fun later

We want your product to last as long as possible, so we recommend that you tighten the screws 2 weeks after assembly and for added safety check the tightness of all screws every 2 months.

For proper care and treatment, please check our website at NathanJames.com/products

Safe use of this product starts with you.

Use this product responsibly with the primary concern for your safety. Follow assembly instructions carefully and inspect product upon receipt and each use.

Nathan James and its parent companies cannot be held legally responsible for any injuries or death resulted from failure to follow instructions or improper use of this product.

Do not modify the structure of this product in any way.

Our products have been tested to meet specific safety measures as they were originally intended to be sold. Any modifications will present the risk of creating significant safety issues which NJ will not be responsible for.

Proper use

- | | |
|---------------|------------------------------|
| DO NOT | use for commercial purposes |
| DO NOT | frolic on dining chair |
| DO NOT | use chair as foot stool |
| DO NOT | leave spilled liquid on seat |
| DO NOT | use chair if damaged |
| DO NOT | make temporary repairs |
| DO NOT | use outdoors |

We are only in business if you're happy

For starters, thanks for being you.

☎ Toll-free at 1-866-619-1004

✉ Help@nathanjames.com

🌐 NathanJames.com/help

We do our best to ensure your furniture arrives without any problems, but occasionally mistakes happen—as humans we are imperfect beings. In the event that a part is damaged or missing, we will be more than happy to provide you with replacement part(s) for free.

Warranty

This product comes with a lifetime warranty from the date of purchase. Please use your phone to scan the QR code to register your product or visit <https://goo.gl/i9dk3q>



Did we do alright? Please spread the love!

If you are happy with your product, tell your friends and family about us or even better leave us a review online. Spreading the word gives us the opportunity to make more people happy and keep our prices low for your next purchase.

Brooklyn Burdon

Founder, Nathan James