

ASSEMBLY INSTRUCTION

RECTANGULAR LIFT-TOP COCKTAIL TABLE

- 1: Place the table top upside down on a flat and smooth surface.
- 2: Position leg into notched opening on corner of top and attach with two bolt assemblies (A, B, & C)
- 3: Repeat for two additional legs
- 4: Position shelf and attach to the three attached legs using one bolt assembly (A, B, & C) for each leg. Use of an assistant to hold the shelf securely while attaching will greatly ease assembly
- 5: Attach fourth leg to table top corner and shelf with three remaining bolt assemblies (A, B, & C)
- 6: Put casters in position.

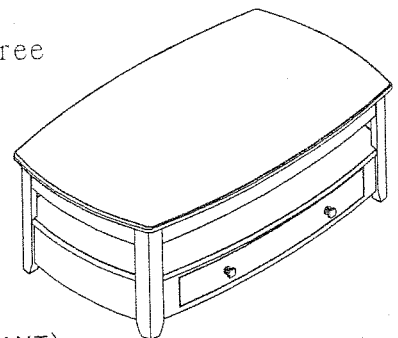

PARTS LIST:

- A: WASHER 12pcs
- B: LOCK WASHER 12pcs
- C: ALLEN BOLT ($\phi 5/16 \times 2$ ") 12pcs
- D: ALLEN WRENCH 1pc
- E: CASTER 4pcs

PLEASE NOTE (IMPORTANT):

when you assembly this bottom shelf you must keep the drawer in the top opening opposite position

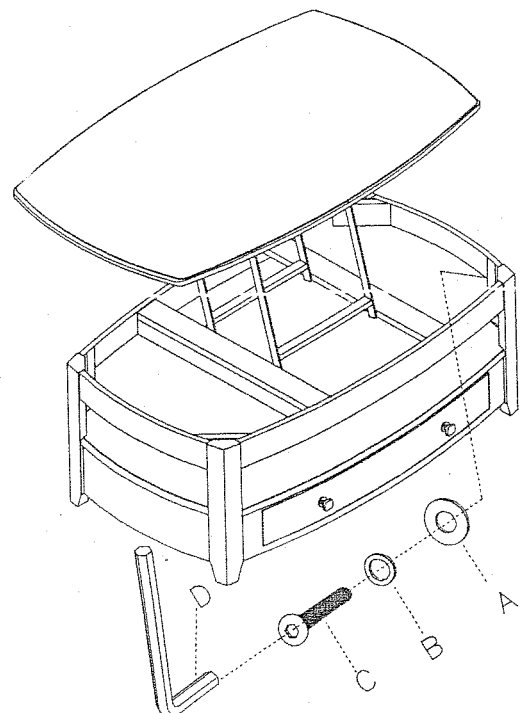
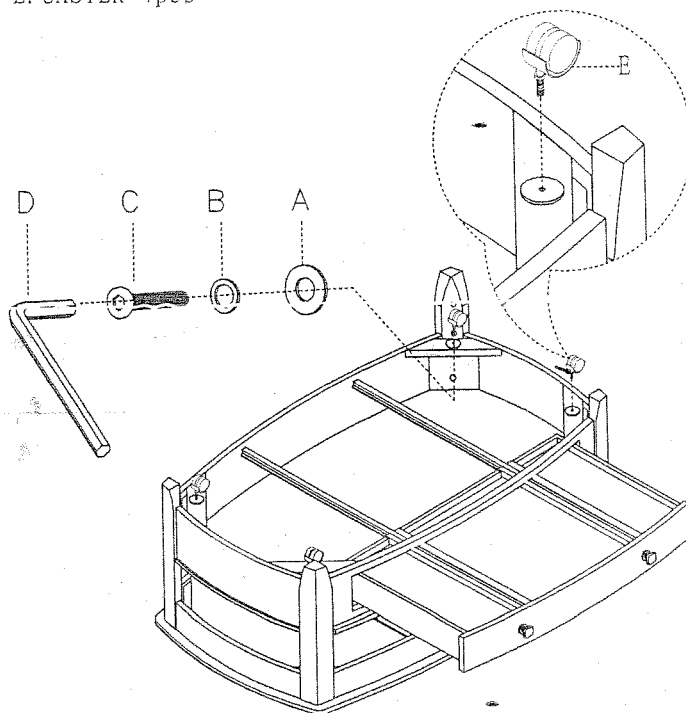

ASSEMBLY INSTRUCTION

RECTANGULAR DRAW END TOP

- 1: Place the table top upside down on a clean, non-marring surface.
- 2: Position three leg to table using the bolt assembly (A, B&C). Tighten securely using wrench (D)
- 3: Position shelf assembly as shown in sketch and attach to the three installed legs using the bolt assembly (A, B&C) tighten securely using wrench (D). Use of an assistant to hold the shelf securely while attaching will greatly ease assembly
- 4: Securely attach the final leg using the bolt assembly (A, B&C)

A: WASHER 12pcs

B: LOCK WASHER 12pcs

C: ALLEN BOLT ($\phi 5/16" \times 2"$) 12pcs

D: ALLEN WRENCH 1pc

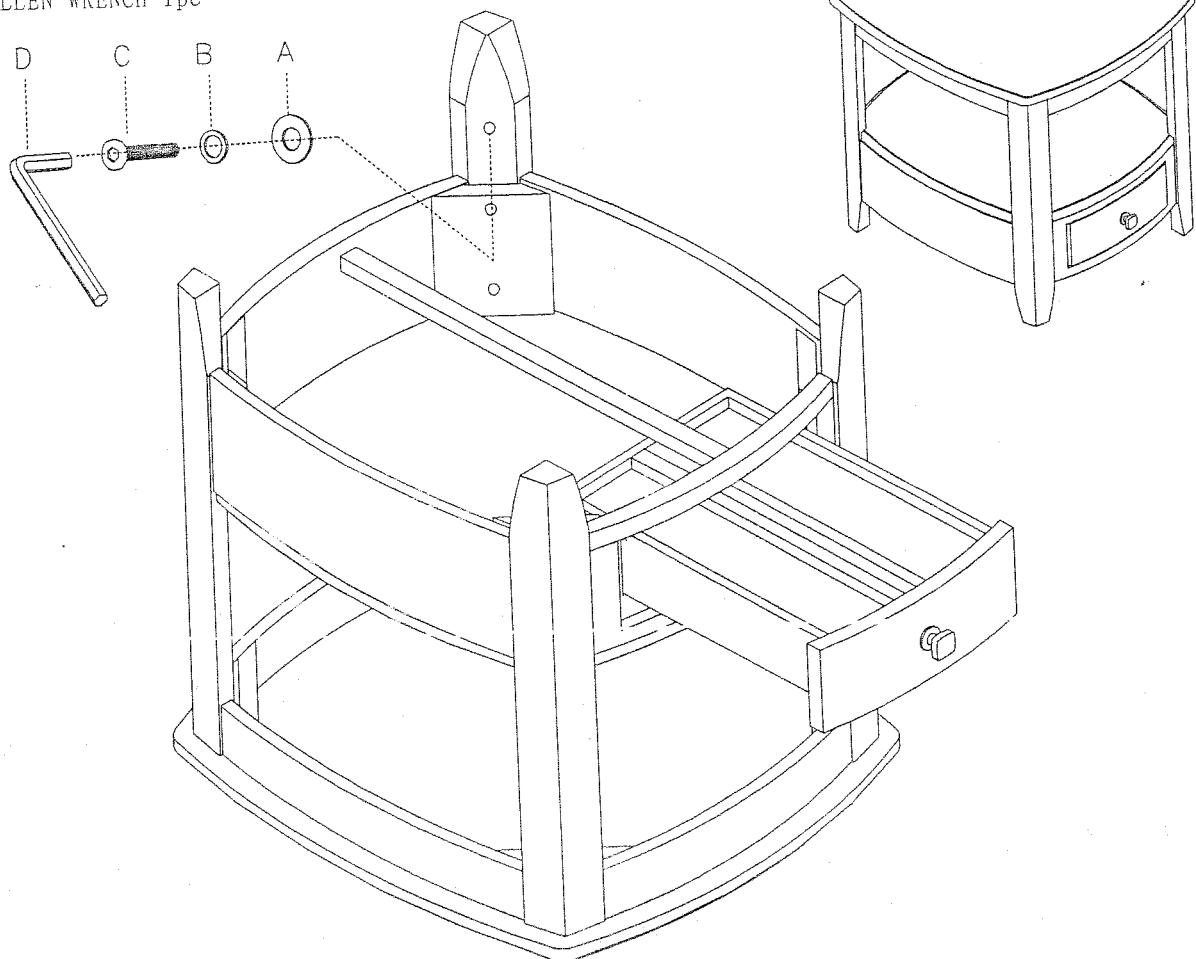

ASSEMBLY INSTRUCTION

SOFA TABLE

- 1: Place the table top upside down on a clean, non-marring surface.
- 2: Position three leg to table using the bolt assembly (A, B&C). Tighten securely using wrench (D)
- 3: Position shelf assembly as shown in sketch and attach to the three installed legs using the bolt assembly (A, B&C) tighten securely using wrench (D). Use of an assistant to hold the shelf securely while attaching will greatly ease assembly
- 4: Securely attach the final leg using the bolt assembly (A, B&C)

A: WASHER 12pcs

B: LOCK WASHER 12pcs

C: ALLEN BOLT ($\varnothing 5/16" \times 2"$) 12pcs

D: ALLEN WRENCH 1pc

