

ASSEMBLY INSTRUCTIONS

TRADITIONAL LIFT CHAIR

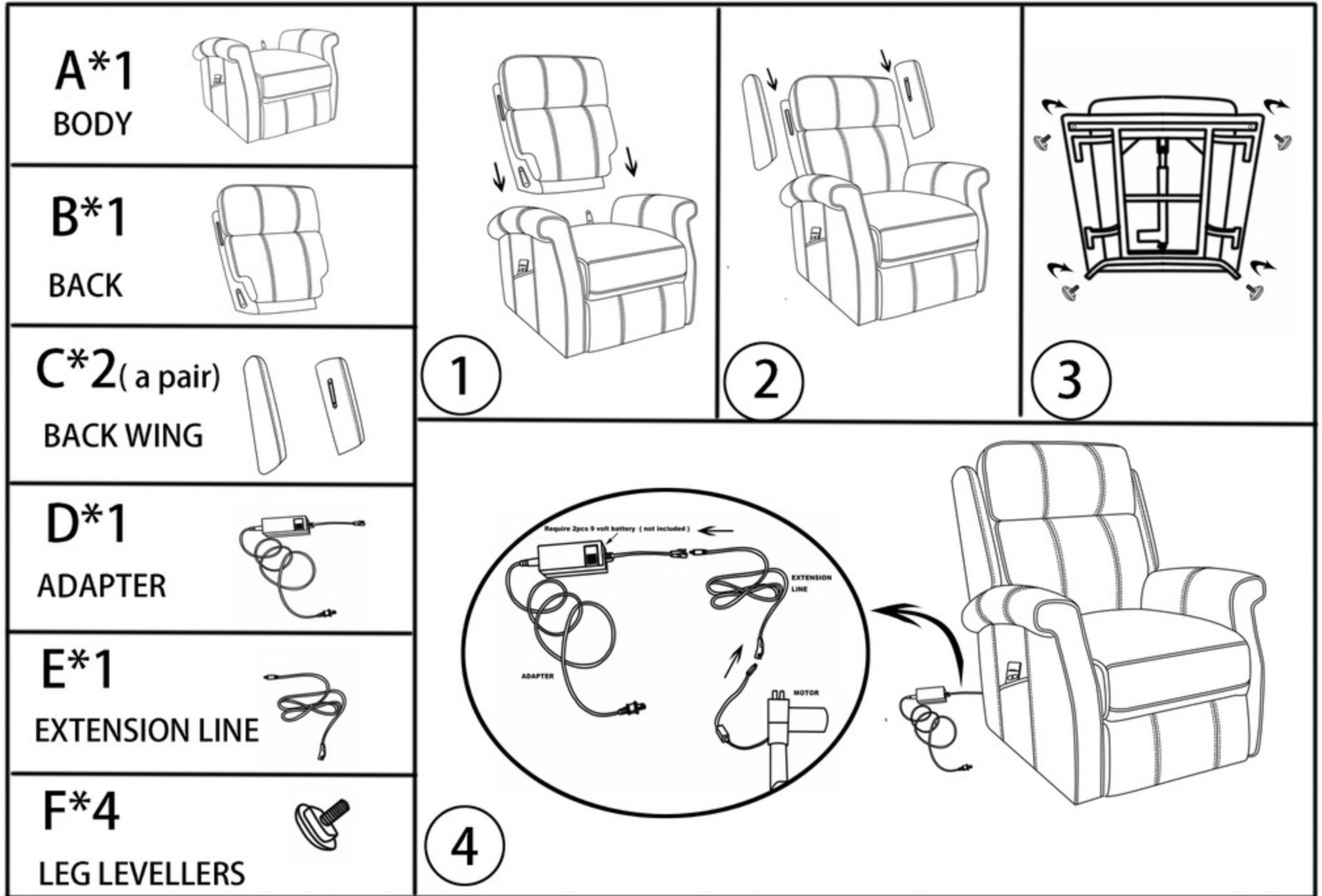

NOTE: 1: MAXIMUM WEIGHT LIMIT 350LBS

2: ADAPTOR IS ALSO A BATTERY BACKUP TO OPERATE LIFT CHAIR IN CASE OF LOSS OF ELECTRICITY, TO UTILIZE, 2 PIECES OF 9 VOLT BATTERIES ARE REQUIRED(NOT INCLUDED)