

Can we help you?

Difference

- QUALITY
- INNOVATION
- SERVICE
- VALUE



Thank you for purchasing this product. We trust that you will be completely satisfied with your product for many years to come. Products are backed by a 1-year warranty and crafted with today's styles in mind for the way you work.

Merci d'avoir acheté ce produit

Nous sommes sûr que vous serez complètement satisfait de votre meuble pendant de nombreuses années. Les produits sont garantis pendant 1 an et sont conçus dans les styles actuels tout en gardant à l'esprit votre façon de travailler.

Gracias por comprar este producto de

Confiamos que usted estará completamente satisfecho con su mueble por muchos años. Los productos de tienen 1 año de garantía y son diseñados con los estilos de hoy en mente para la manera que usted vive.

1 Year
WARRANTY

IT'S AS EASY AS 1,2,3

Assembly tips:

1. Read the instructions and become familiar with the parts.
2. Ensure this carton contains all parts, fasteners and hardware.
3. To protect floors, assemble the furniture on the carton.
4. An assistant may be helpful.
5. Use of power tools is not recommended.



Conseils d'assemblage:

1. Lisez les instructions et familiarisez-vous avec les pièces.
2. Assurez-vous que le carton contient toutes les pièces, toutes les pièces de fixation et toute la quincaillerie.
3. Pour protéger vos sols, assemblez le meuble sur le carton.
4. Il peut être utile de vous faire aider.
5. L'utilisation d'outils électriques n'est pas recommandée.

Consejos de Ensamblaje:

1. Lea las instrucciones y familiarícese con las partes.
2. Asegúrese de que esta caja contenga todas las piezas, los sujetadores y el equipo.
3. Para proteger el piso, ensamble el mueble en el carton.
4. Un asistente puede serle útil.
5. El uso de herramientas eléctricas no se recomienda.

CONSUMER SERVICE YOU CAN DEPEND ON

Questions? Operators are standing by at our TOLL-FREE help line to assist you with assembly; and, if necessary, to quickly replace damaged/missing parts. Simply have your store receipt, instruction manual, and part number/description ready when you call our TOLL-FREE help line. It's that easy.

UN SERVICE CLIENTELE SUR LEQUEL VOUS POUVEZ COMPTER
Des questions? Des opérateurs sont prêts sur notre ligne d'assistance GRATUITE pour vous aider à l'assemblage et, si nécessaire, remplacer rapidement les pièces endommagées/manquantes. Ayez simplement votre reçu de magasin, votre manuel d'instruction et le numéro de pièces/description à votre disposition lorsque vous appelez notre ligne d'assistance GRATUITE. C'est aussi simple que ça.

1 Year
WARRANTY

SERVICIO AL CONSUMIDOR CON EL QUE PUEDE CONTAR

¿Preguntas? Los operadores están listos para ayudarlo con el ensamblaje a través de una línea de ayuda GRATUITA, y en caso de ser necesario, reemplazar de inmediato las piezas dañadas o faltantes. Solamente tenga listos su recibo de compra, manual de indicaciones y número/descripción de la pieza al momento de llamarnos a la línea de ayuda

IMPORTANT SAFETY INFORMATION



WARNING

Do not load unit without properly attaching back panel. Doing so could cause instability, product collapse, and/or serious injury.

No cargue esta unidad sin el panel de atrás. Hacerlo puede causar inestabilidad, que el producto se derrumbe, y/o heridas (golpes) serias.

Ne pas charger le produit sans attacher correctement le panneau arrière. Faire ainsi peut causer l'instabilité ou l'effondrement du produit et peut vous causer des endommagements sérieux.



WARNING

Do not move unit when loaded. Doing so could cause instability, product collapse, tip over, and/or serious injury.

No mueva la unidad cuando esté cargada. Hacerlo puede causar inestabilidad, que el producto se derrumbe, que se la caiga encima y/o heridas (golpes) serias.

Ne pas déplacer l'unité lorsqu'elle est chargée. Faire ainsi peut causer l'instabilité, l'effondrement ou le renversement du meuble et/ou des endommagements sérieux.

IMPORTANT SAFETY INFORMATION



CAUTION



<p>Risk of breaking glass. Handle glass carefully during assembly. Use eye and hand protection. Improper handling can result in cuts or lacerations.</p>	<p>Riesgo de romper el vidrio. Maneje el vidrio con cuidado al ensamblar esta unidad. Use protección para sus ojos y sus manos. El manejo inapropiado del vidrio puede causarle cortaduras o laceraciones.</p>	<p>Risque de bris de verre. Faites attention lors de la manipulation du verre pendant l'assemblage. Utilisez des protections pour les yeux et les mains. Une mauvaise manipulation peut provoquer des coupures ou des lacerations.</p>
--	--	--



WARNING

<p>This product is designed and intended for use with audio components and video playing equipment only. Improper loading with television or other heavy equipment could cause instability, tip over, and/or serious injury.</p>	<p>Este producto ha sido diseñado para ser usado con componentes de audio y reproducción de video exclusivamente. El uso inapropiado con un televisor u otro equipo pesado puede causar la inestabilidad del producto, que se derrumbe, pudiendo causar serias heridas.</p>	<p>Ce produit est conçu pour et destiné à être utilisé uniquement avec des composants de lecture audio et vidéo. Le chargement inapproprié d'un téléviseur ou d'un autre équipement lourd pourrait provoquer l'instabilité, le renversement du meuble et/ou des blessures graves.</p>
--	---	---

EXPLODED VIEW

- | | | | |
|---|-----|---|-----|
| A | [1] | I | [1] |
| B | [1] | J | [1] |
| C | [1] | K | [2] |
| D | [1] | L | [1] |
| E | [1] | M | [1] |
| F | [1] | N | [1] |
| G | [1] | O | [1] |
| H | [1] | | |

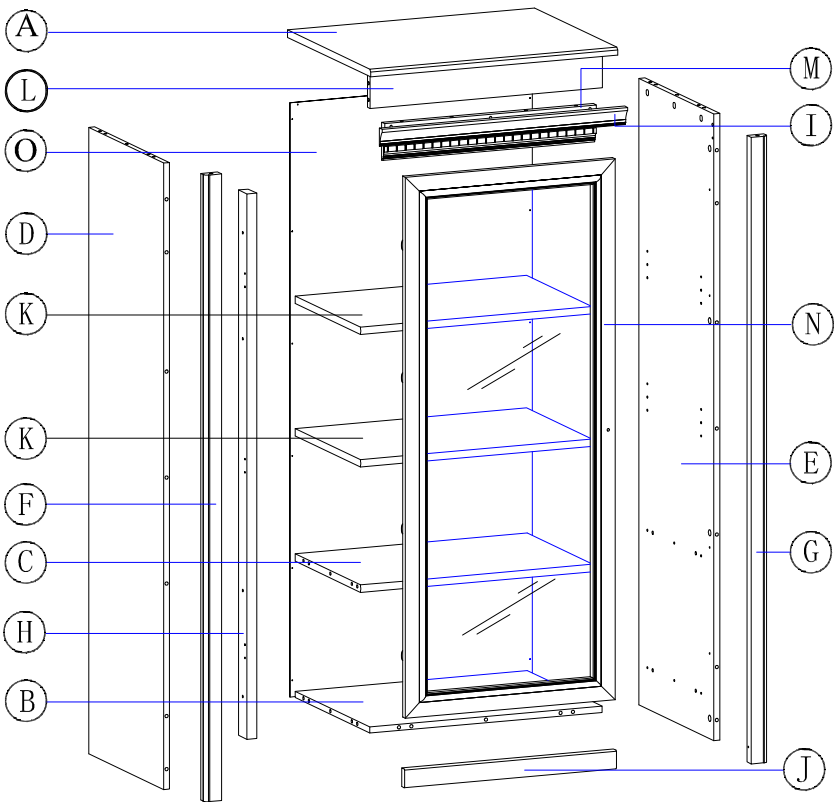
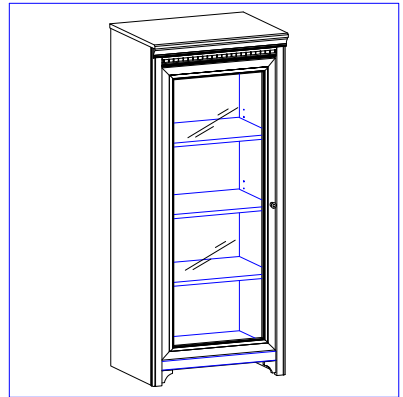

FASTENERS

Fastners are shown in actual size.

Los fijadores son demostrados en su tamaño actual.

Les attaches sont montrées dans l'échelle grandeur.

H159916

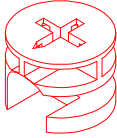

Quantity
35

H159917

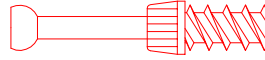

Quantity
35

H156826



#3 x 3/4"

Quantity
43

H156823

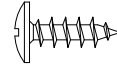

#8 x 1/2"

Quantity
2

H156874

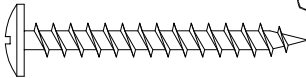

#10 x 1-1/2"

Quantity
6

H153244

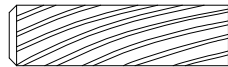

8 x 30mm

Quantity
30

H168085

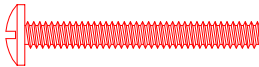

M4 x 30mm

Quantity
1

H156825



#6 x 1/2"

Quantity
1

H153242

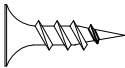

#8 x 5/8"

Quantity
12

H156851

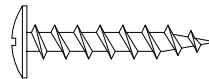

#10 x 1"

Quantity
3

HARDWARE

H153542

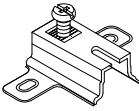

Quantity
3

H153543

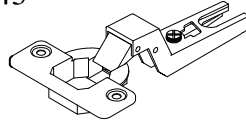

Quantity
3

H158707

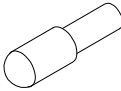

Quantity
8

H156829



Quantity
4

H156832

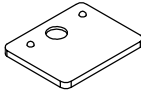

Quantity
1

H158802



Quantity
9

H146711

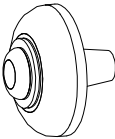

Quantity
1

H146712



Quantity
1

H158800

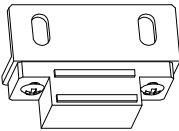

Quantity
1

H158801

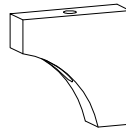

Quantity
2

Common assembly techniques.
Técnica común de ensamblaje.
Techniques communes d'assemblage.

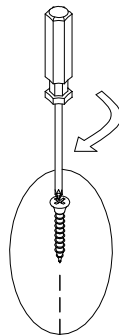
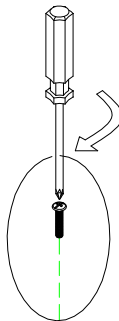
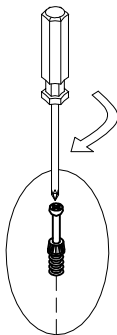
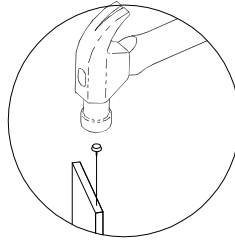
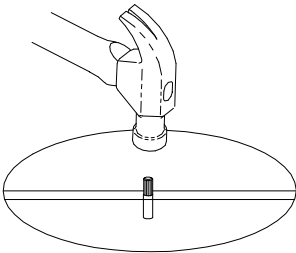
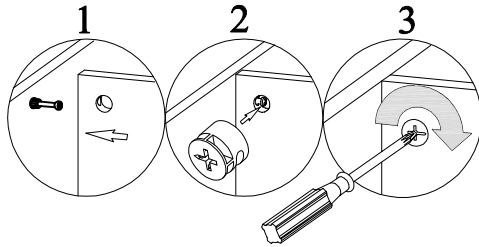

STEP 1

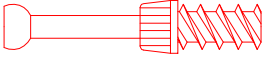
H159917  [7]

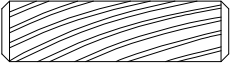
H153244  [2]

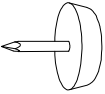
H156829  [1]

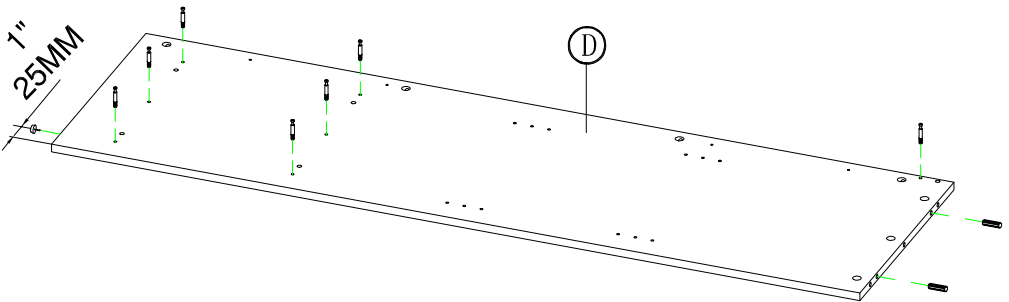

STEP 2

H153244



[14]

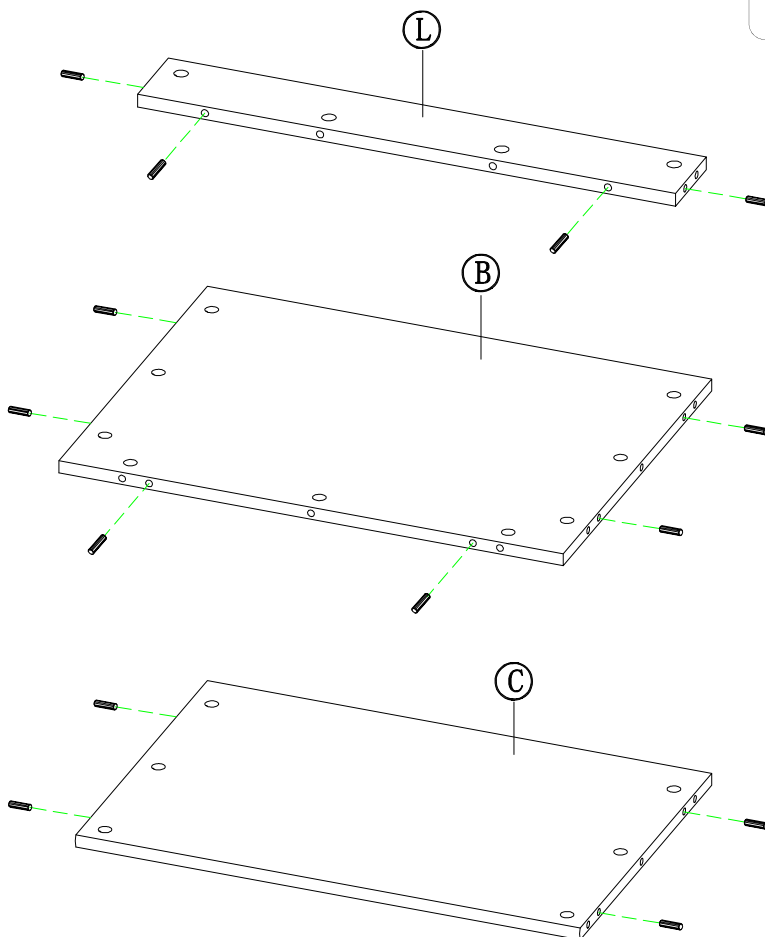

STEP 3

H159916

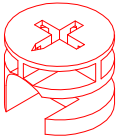

[7]

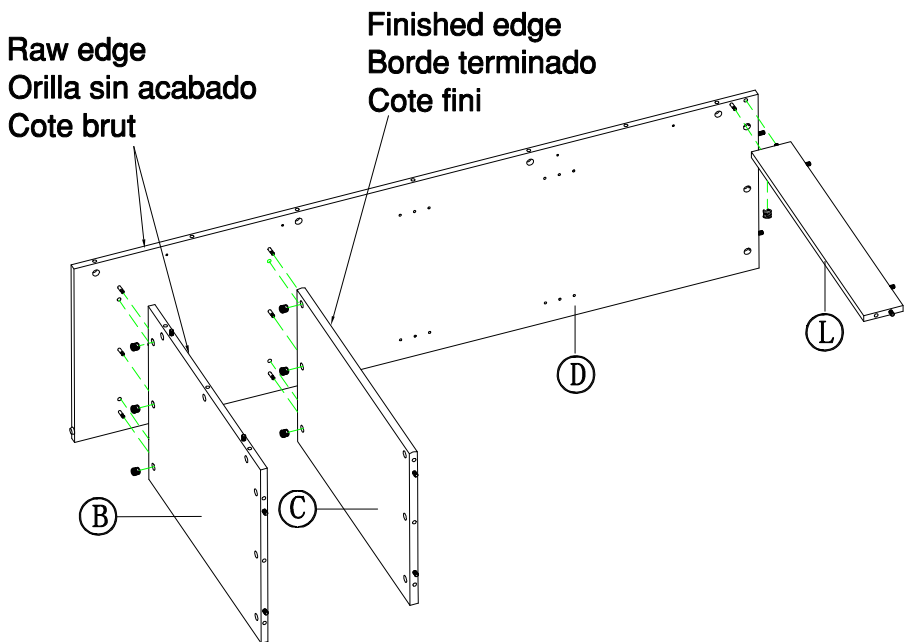

An assistant is required.
Es necesario un ayudante.
Un assistant est nécessaire.

STEP 4

H159917  [7]

H153244  [2]

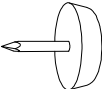
H156829  [1]

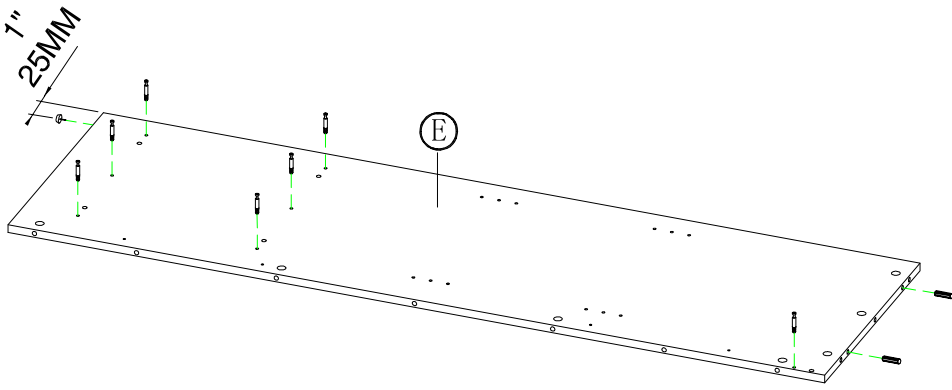

STEP 5

H159916

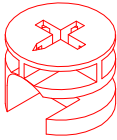

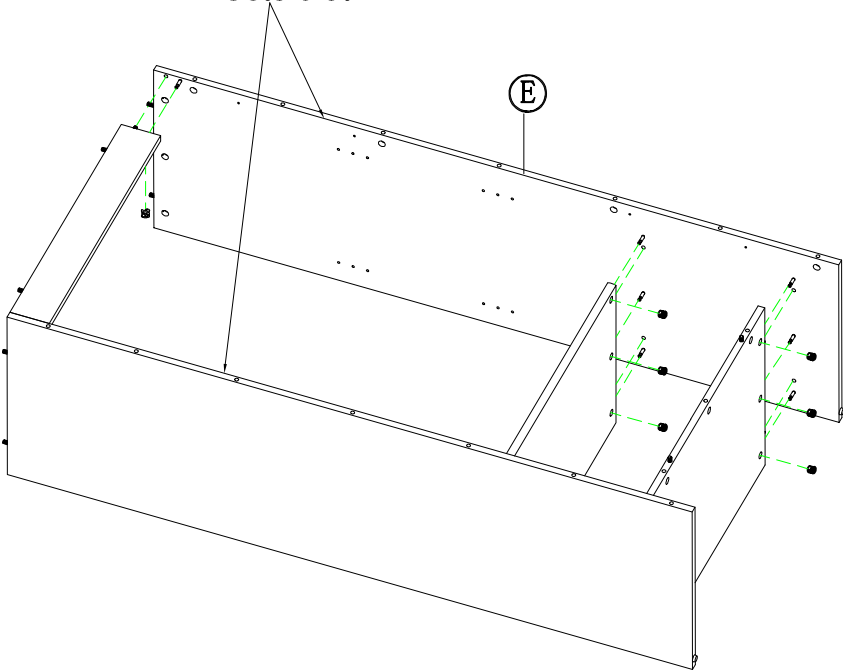

[7]

Raw edge
Orilla sin acabado
Cote brut



An assistant is required.
Es necesario un ayudante.
Un assistant est nécessaire

STEP 6

H159917  [8] H153244  [8]

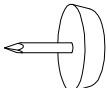
H156829  [2]

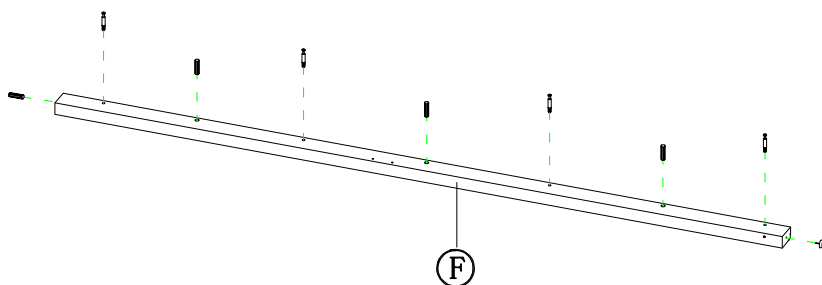
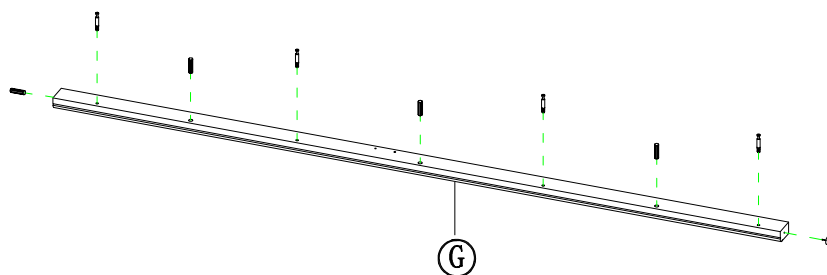

STEP 7

H159916

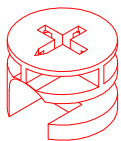

[8]

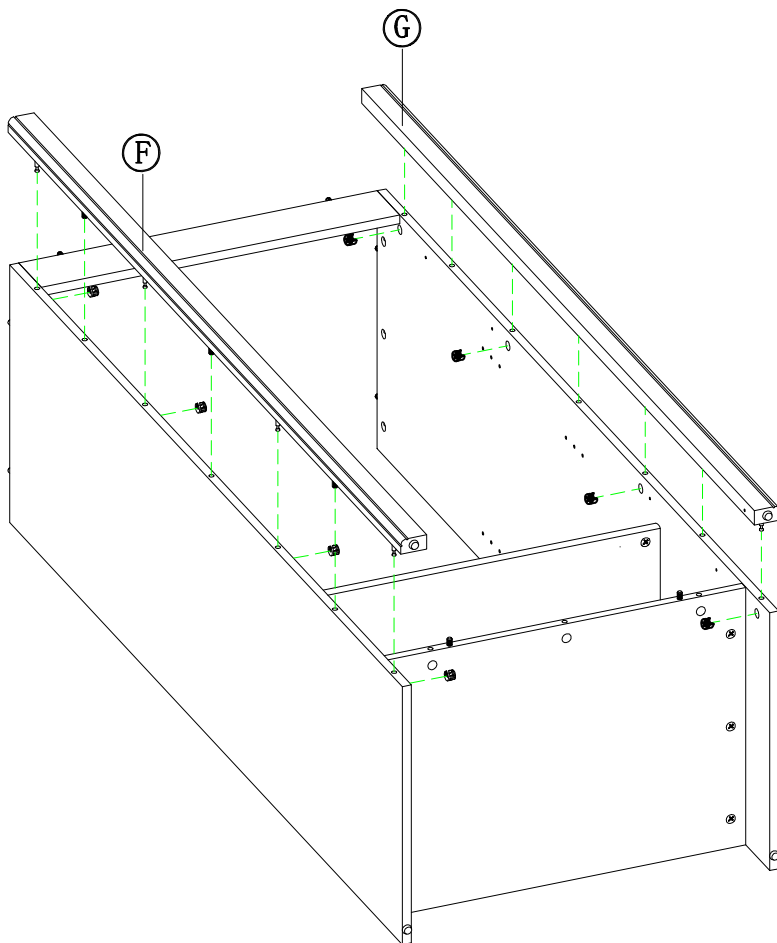

STEP 8

H159917  [10]

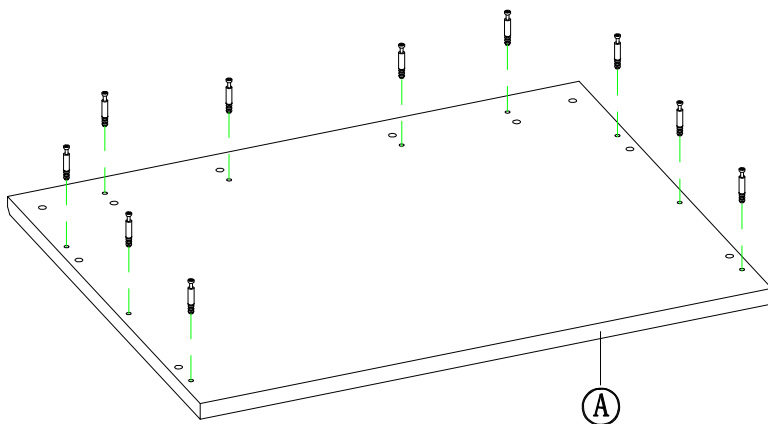

STEP 9

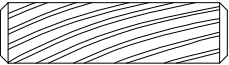
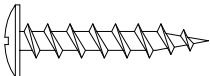
H153244  [2] H156851  [3]

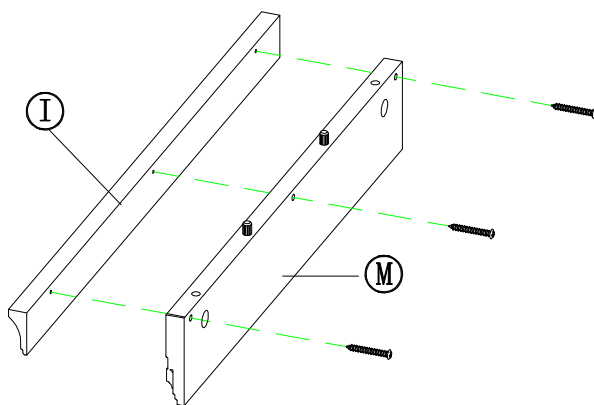
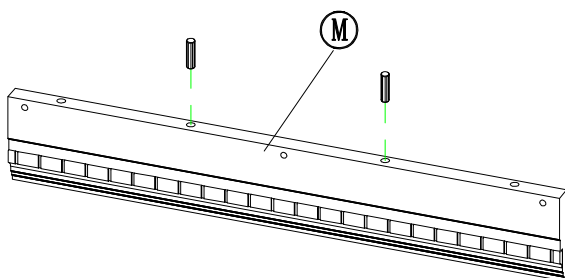

STEP 10

H159916

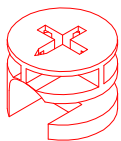

[2]

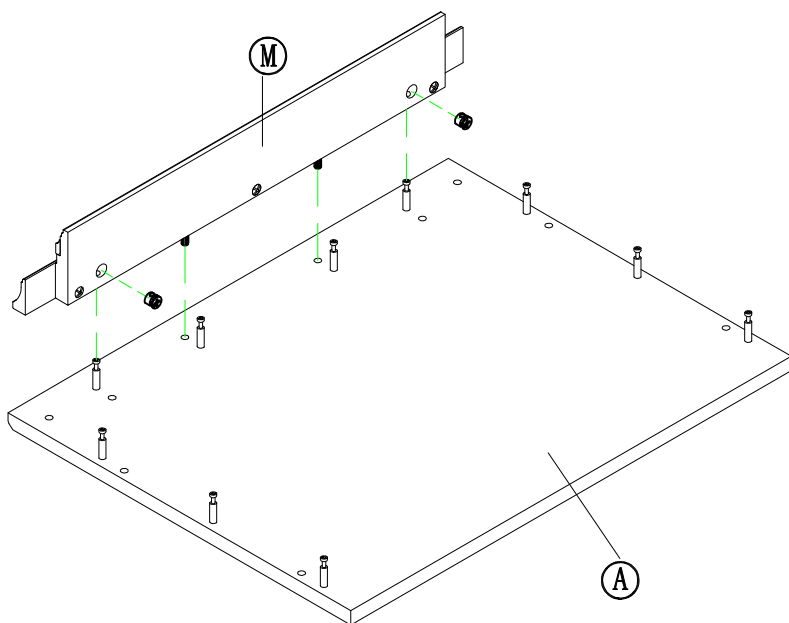

STEP 11

H159916

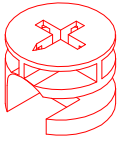

[8] H158802



[6]

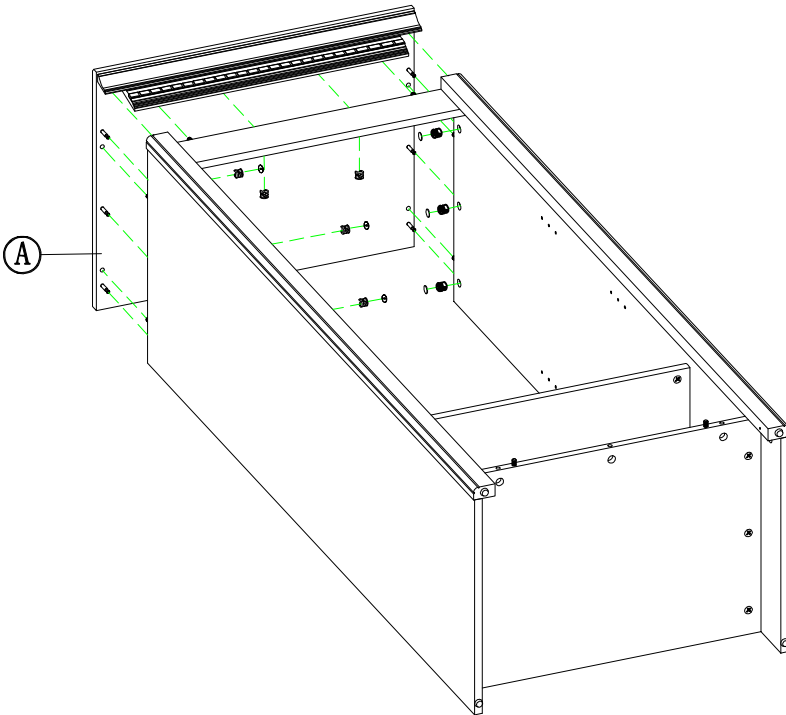

**An assistant is required.
Es necesario un ayudante.
Un assistant est nécessaire.**

STEP 12

H159917  [3]

H159916

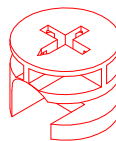

[3]

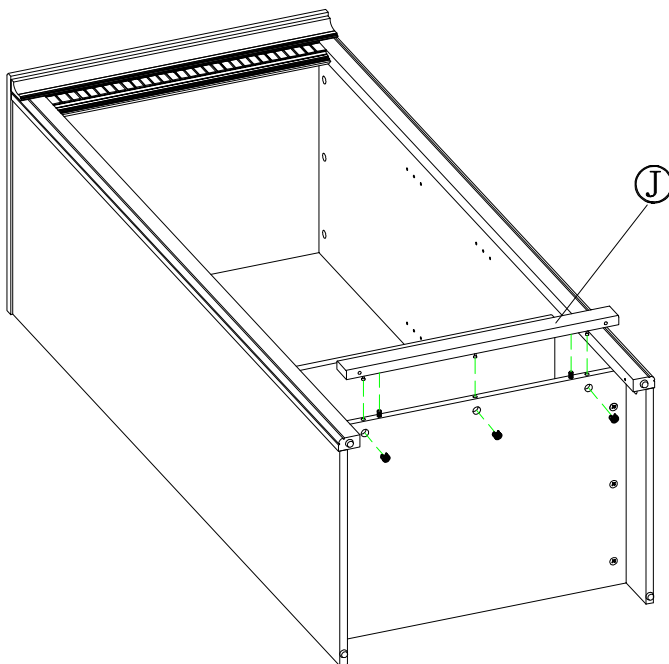
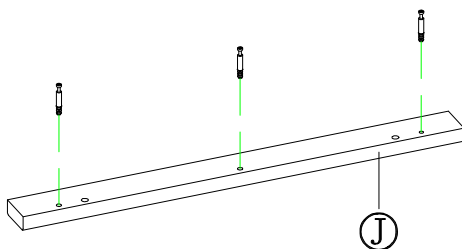

STEP 13

H153244



[2]

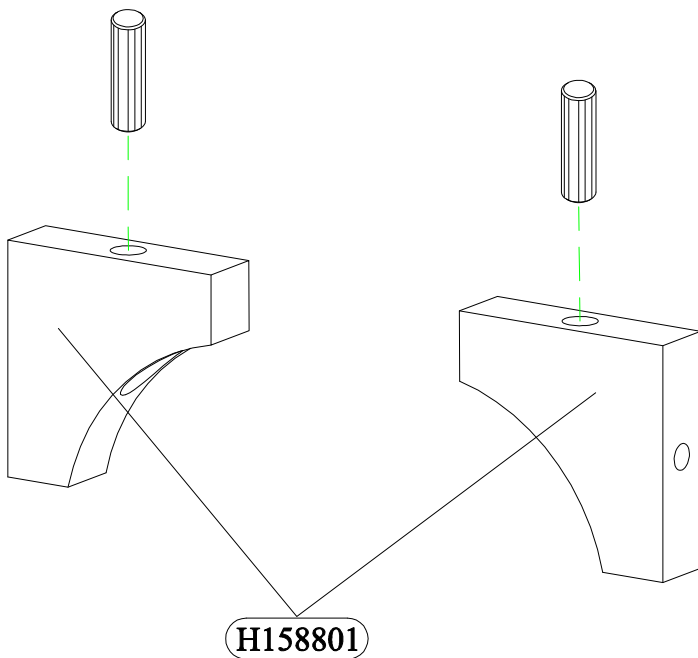

STEP 14

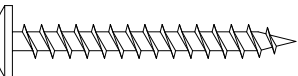
H156874  [2]

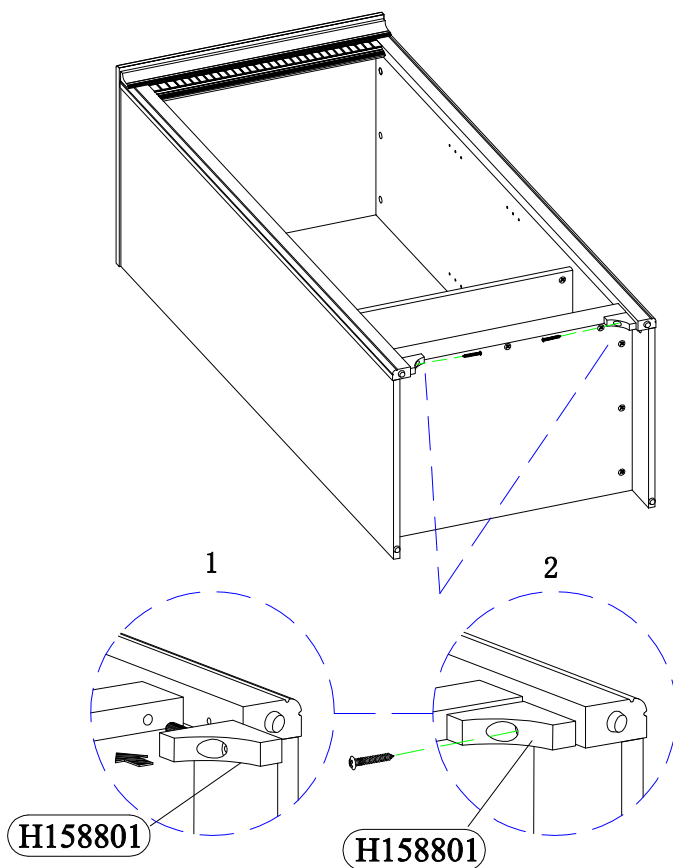

STEP 15

H153242

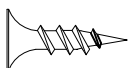

[6]

H153542

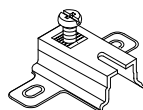

[3]

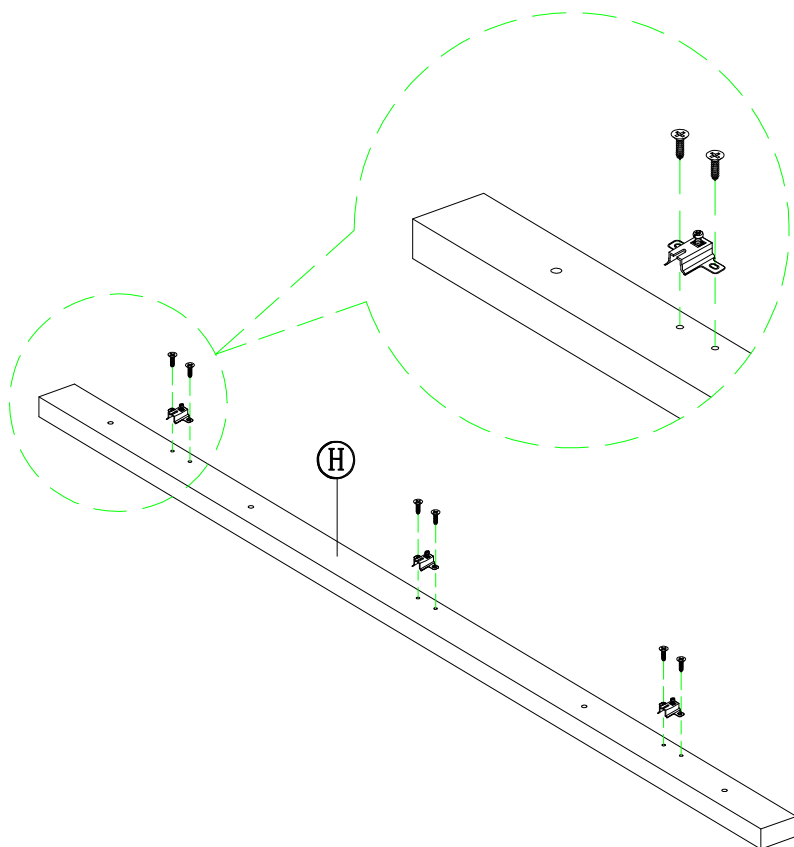

STEP 16

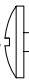
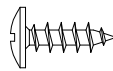
H156874  [4] H156823  [2]

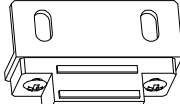
H158802  [3] H158800  [1]

Left mounting option
Opción para Mintura izquierda
Option gauche de montage

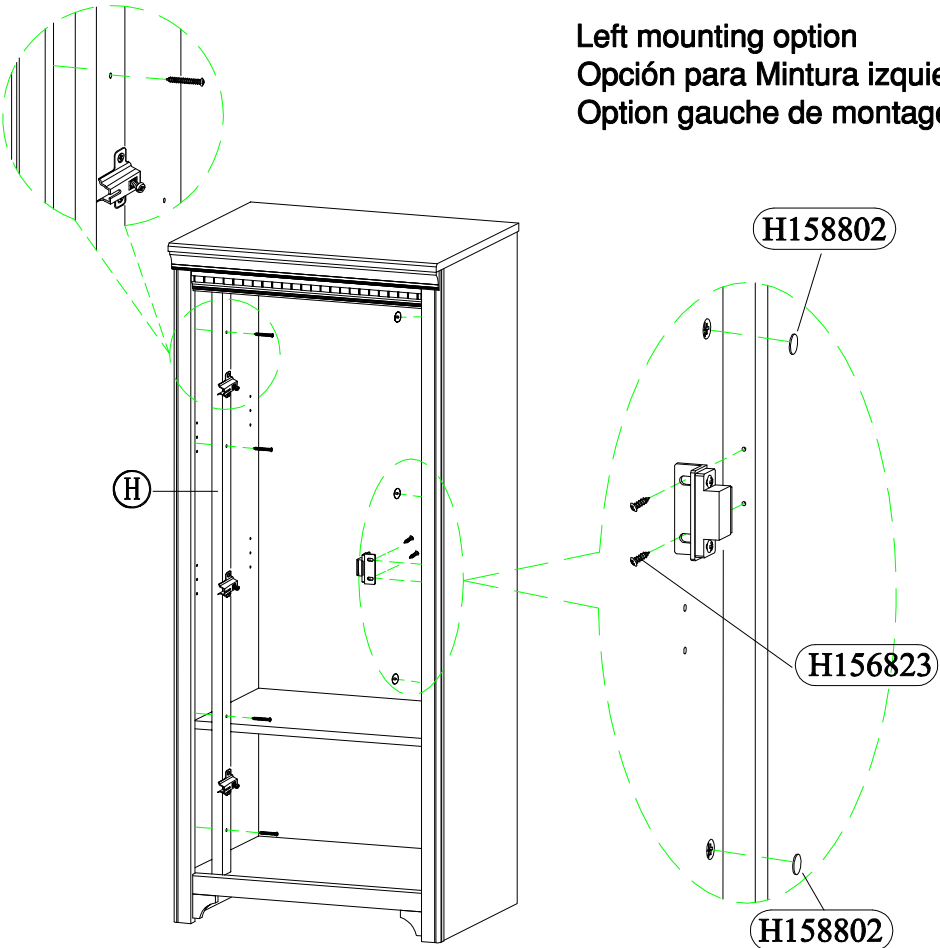

STEP 17

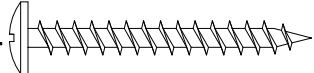
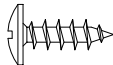
H156874  [4] H156823  [2]

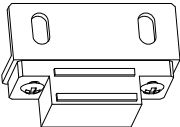
H158802  [3] H158800  [1]

Right mounting option
Opción para Montura derecha
Option droite de montage

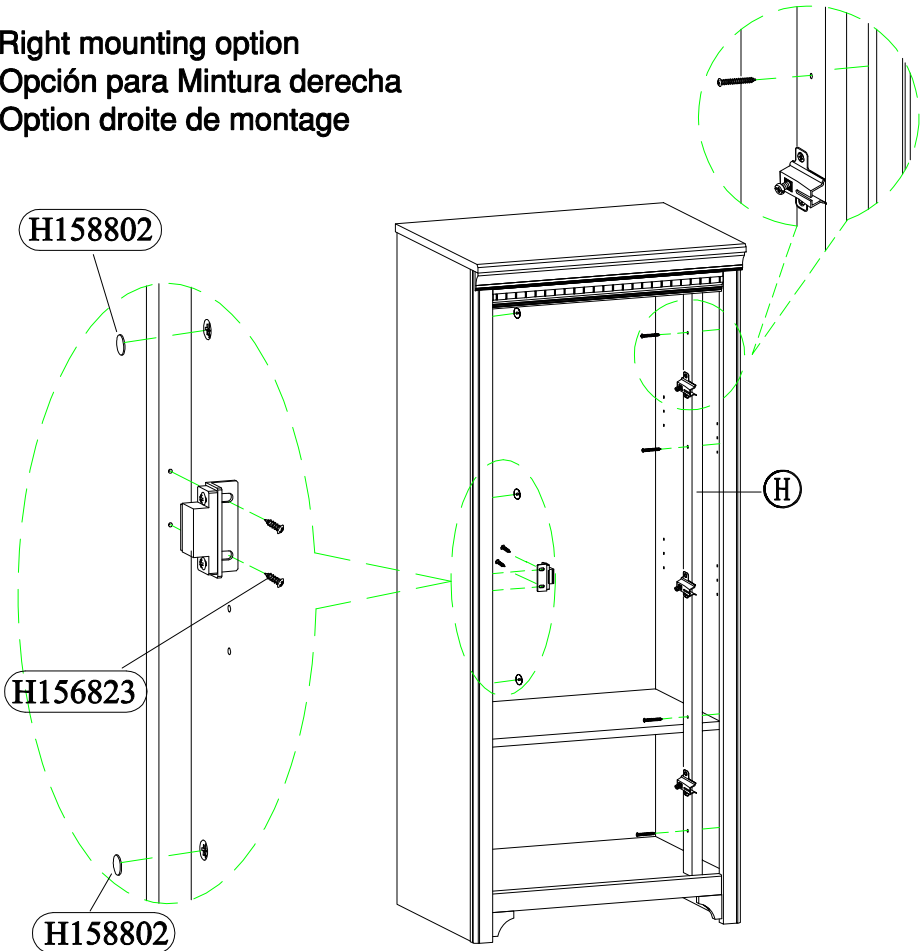



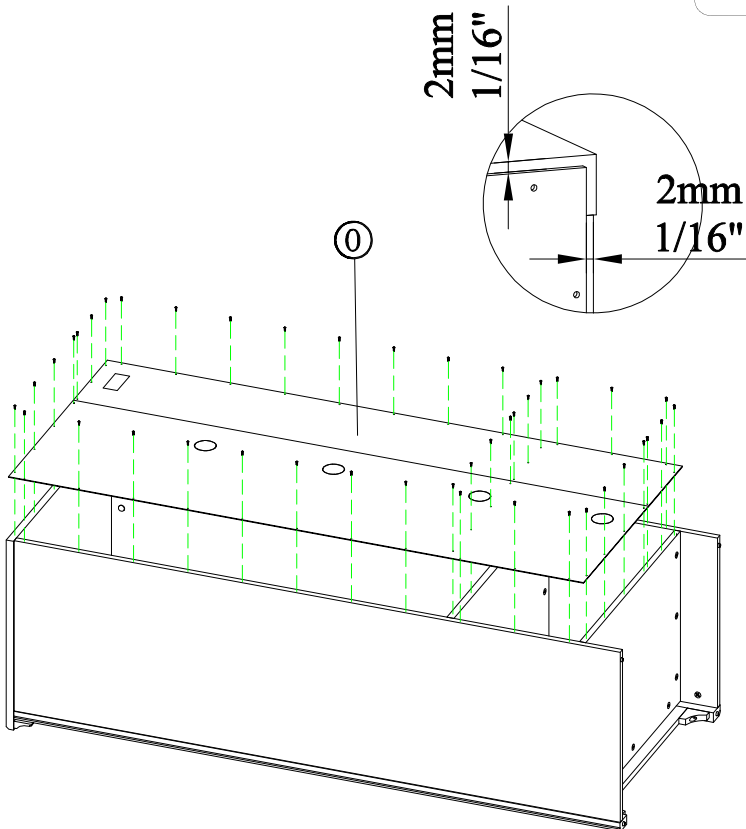

STEP 18

H156826  [43]

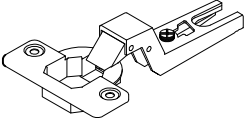
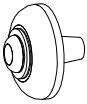

An assistant is required.
Es necesario un ayudante.
Un assistant est nécessaire.

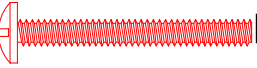
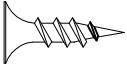
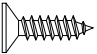
STEP 19

- | | | | | | |
|---------|---|-------|---------|--|-------|
| H153543 |  | [3] | H146711 |  | [1] |
| H156832 |  | [1] | H146712 |  | [1] |
| H168085 |  | [1] | H153242 |  | [6] |
| H156825 |  | [1] | |  | |

Left mounting option
 Opción para Mintura izquierda
 Option gauche de montage

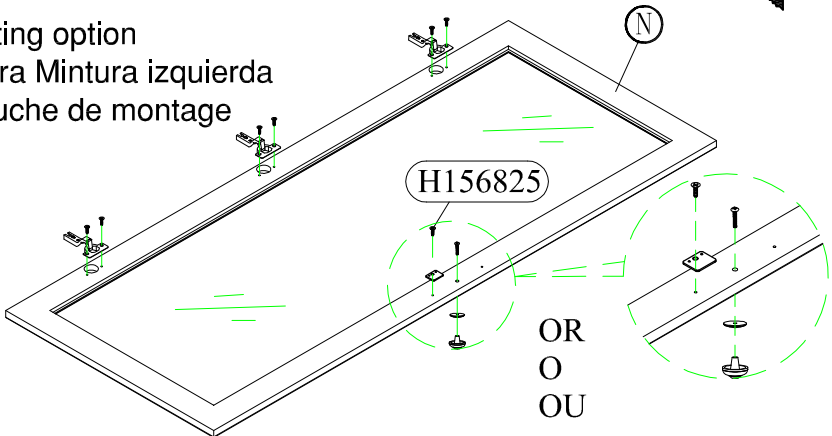

Right mounting option
 Opción para Mintura derecha
 Option droite de montage

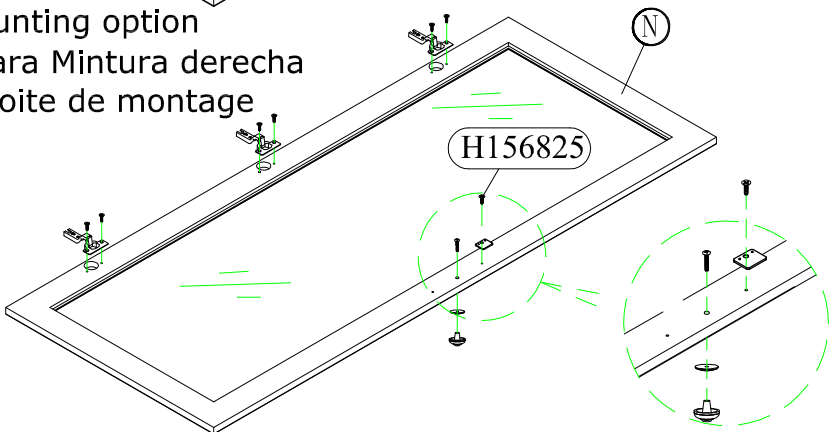

STEP 20

An assistant is required.
Es necesario un ayudante.
Un assistant est nécessaire.

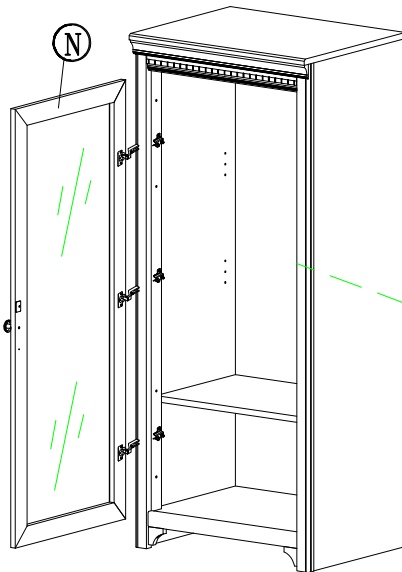
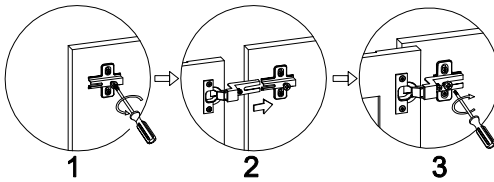

Left mounting option
Opción para Mintura izquierda
Option gauche de montage

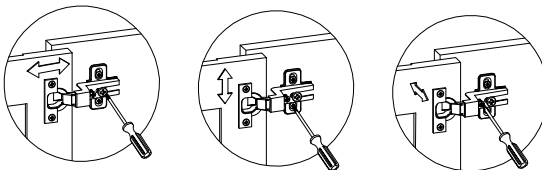

STEP 21

An assistant is required.
Es necesario un ayudante.
Un assistant est nécessaire.

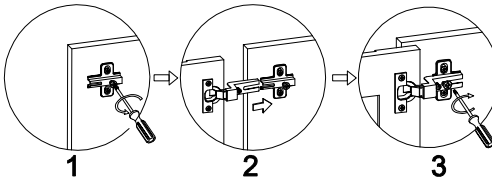

Right mounting option
Opción para Mintura derecha
Option droite de montage

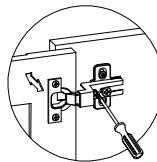
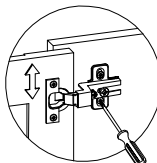
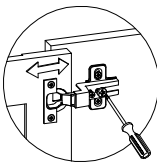
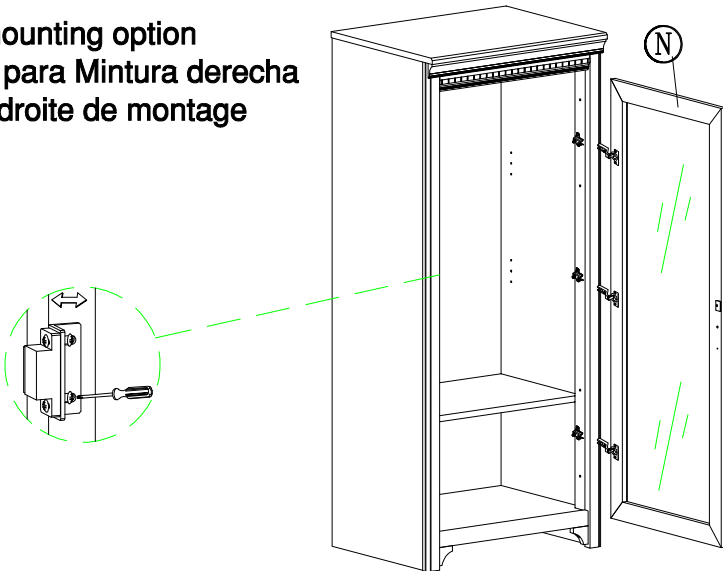

STEP 22

H158707

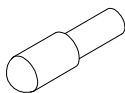

[8]

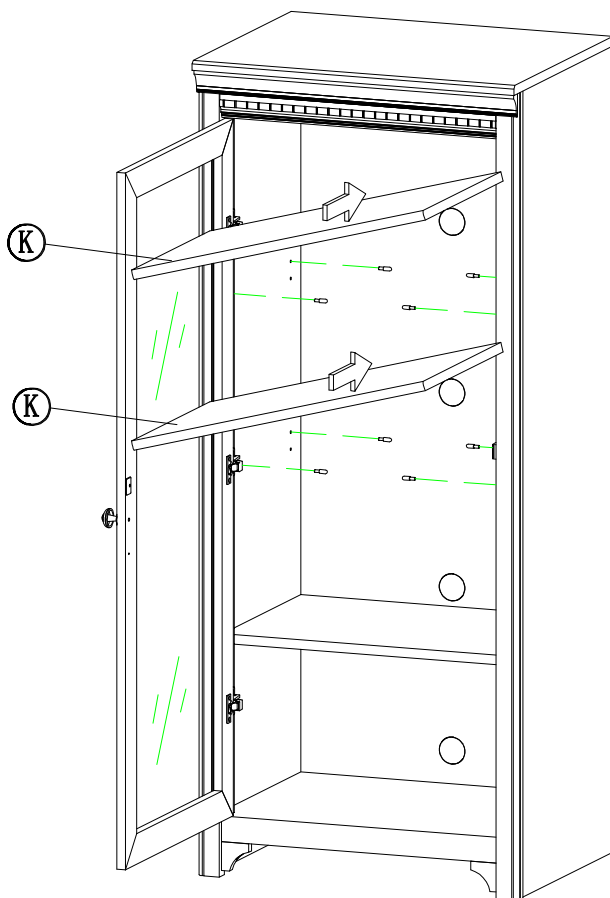

STEP 23

Maximum Weight: 50 Lbs.
Peso Máximo: 50 Libras
Poids Maximum: 22.7 kilogramme

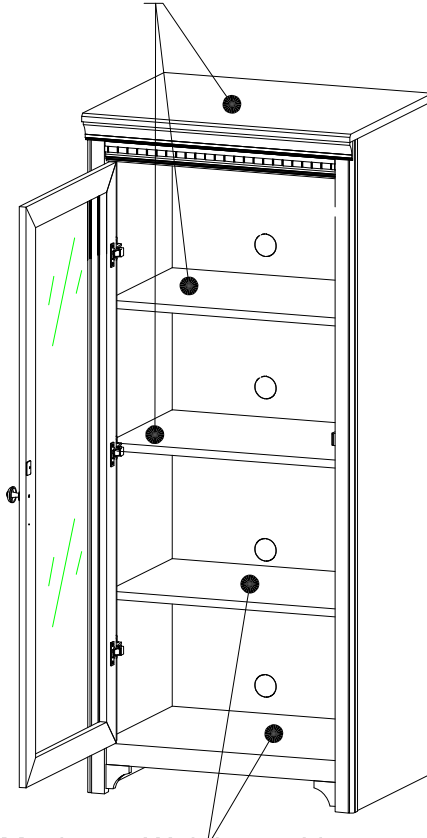

Maximum Weight: 50 Lbs.
Peso Máximo: 50 Libras
Poids Maximum: 22.7 kilogramme

WARRANTY INFORMATION

OUR WRITTEN WARRANTY TO YOU

In order to provide you with timely assistance, please thoroughly inspect your furniture for missing or defective parts immediately after opening the carton. To receive replacement or missing parts under this warranty, call our Consumer Service Department TOLL-FREE. Please have the Model, Part, and Lot Numbers found in the instruction manual available for your reference. You will also need your sales receipt or other proof of purchase. Replacement part(s) will be shipped to you at no charge with assuming all shipping and handling charges.

This product is warranted to the original purchaser at the time of purchase and for a period of six years thereafter.

We warrant to you, the original purchaser, that our furniture and all its parts and components are free of defects in material or workmanship. "Defects," as used in this warranty, is defined as any imperfection which impairs the use of the furniture product.

Our warranty is expressly limited to the replacement of furniture parts and components. For six years after the date of purchase, we will replace any parts that are defective in material or workmanship.

This warranty applies under conditions of normal use. Our products are not intended for outdoor use. This warranty does not cover: 1) defects caused by improper assembly or disassembly; 2) defects occurring after purchase due to product modification, intentional damage, accident, misuse, abuse, negligence or exposure to the elements; and 3) labor or assembly costs.

IMPLIED WARRANTIES, INCLUDING THE WARRANTY OF MERCHANTABILITY, SHALL NOT EXTEND BEYOND THE DURATION OF THE WRITTEN WARRANTY STATED ABOVE, AND IN NO EVENT SHALL WE BE LIABLE FOR INCIDENTAL OR CONSEQUENTIAL DAMAGES RESULTING FROM USE OF THE PRODUCT. Some states do not allow a limitation on how long an implied warranty lasts or the exclusion or limitation of incidental or consequential damages, so the above limitation and exclusion may not apply to you.

This warranty gives you specific legal rights. You may also have other rights that may vary from state to state.

**PLEASE RETAIN THIS FOR YOUR RECORDS / VEUILLEZ CONSERVER CECI POUR VOS ARCHIVES
POR FAVOR CONSERVE ESTE DOCUMENTO PARA SUS REGISTROS**

You may need to refer to this information in case of warranty claim for insurance purposes.

Il se peut que vous ayez besoin de ces informations en cas de réclamation de garantie pour votre assurance.

Puede necesitar referirse a esta información, en caso de algún reclamo de la garantía con fines relacionados al seguro.

Date Purchased/Date d'achat/Fecha de la Compra: _____

Store Name/Nom du magasin/Nombre de la Tienda: _____

Model #/Modèle #/Modelo #: _____

Product Description/Description du produit/Descripción del Producto: _____

Lot Code: _____