

# FreeStanding Bathtub

Product ID. 7AU6H

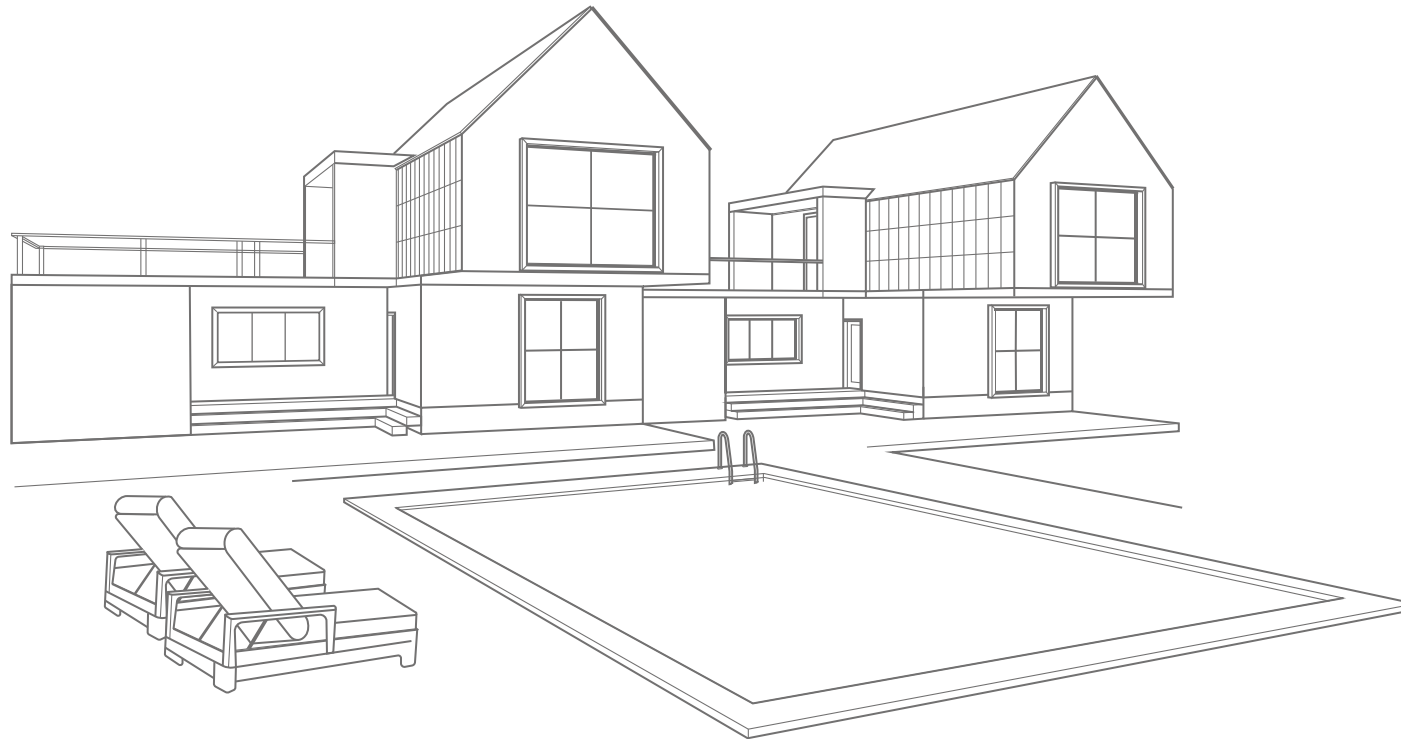

Scan for Support  
[support@garvee.com](mailto:support@garvee.com)



**GARVEE**.com

## Bathtub installation

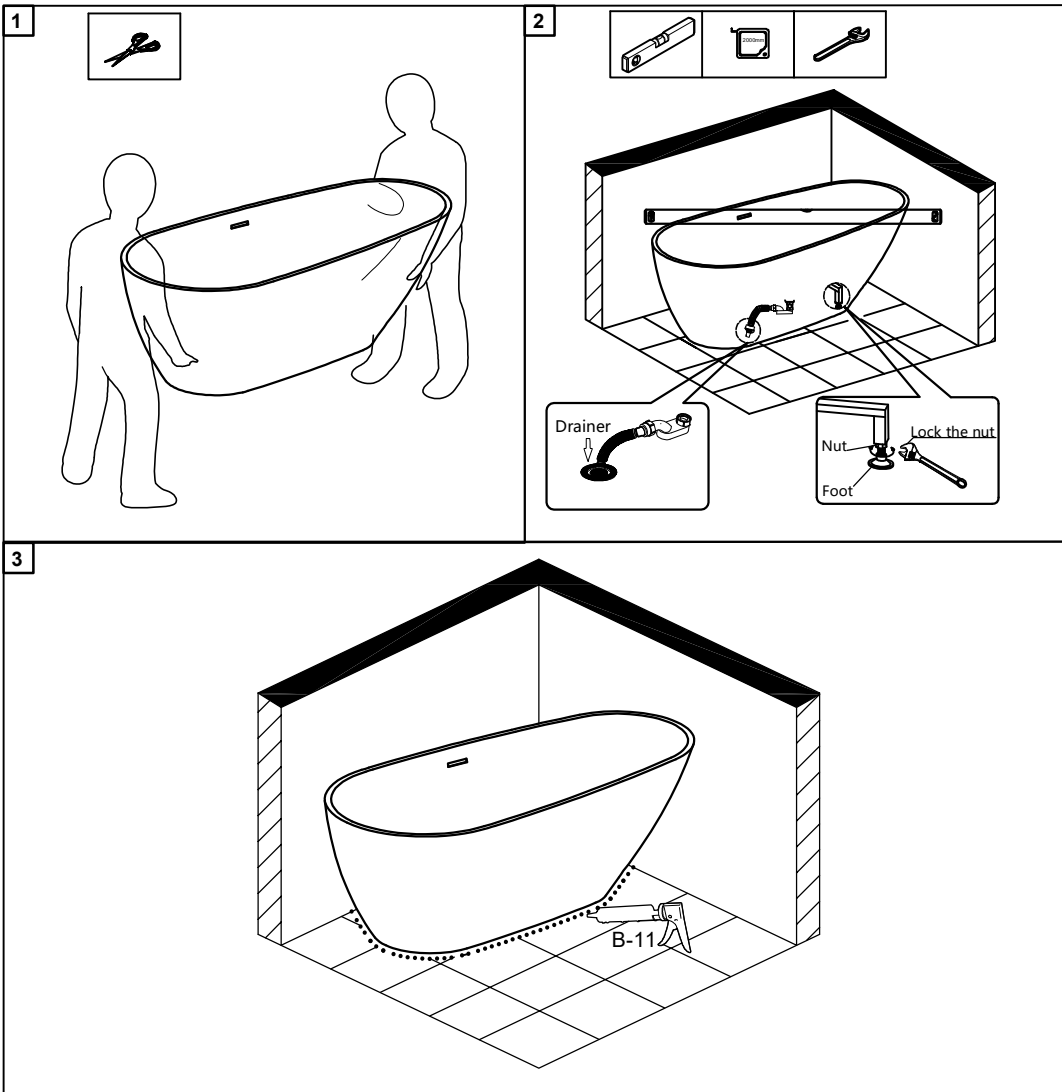

### warn



A gap must be ensured between the bathtub and the tiles, and this gap must be filled with non-alcoholic silicone



The tub can only be used after the silicone is dried for 24 hours.

Distributed by

# GARVEE

Your Next Best Partner

Support and E-Warranty

[WWW.GARVEE.COM/SUPPORT](http://WWW.GARVEE.COM/SUPPORT)

[support@garvee.com](mailto:support@garvee.com)

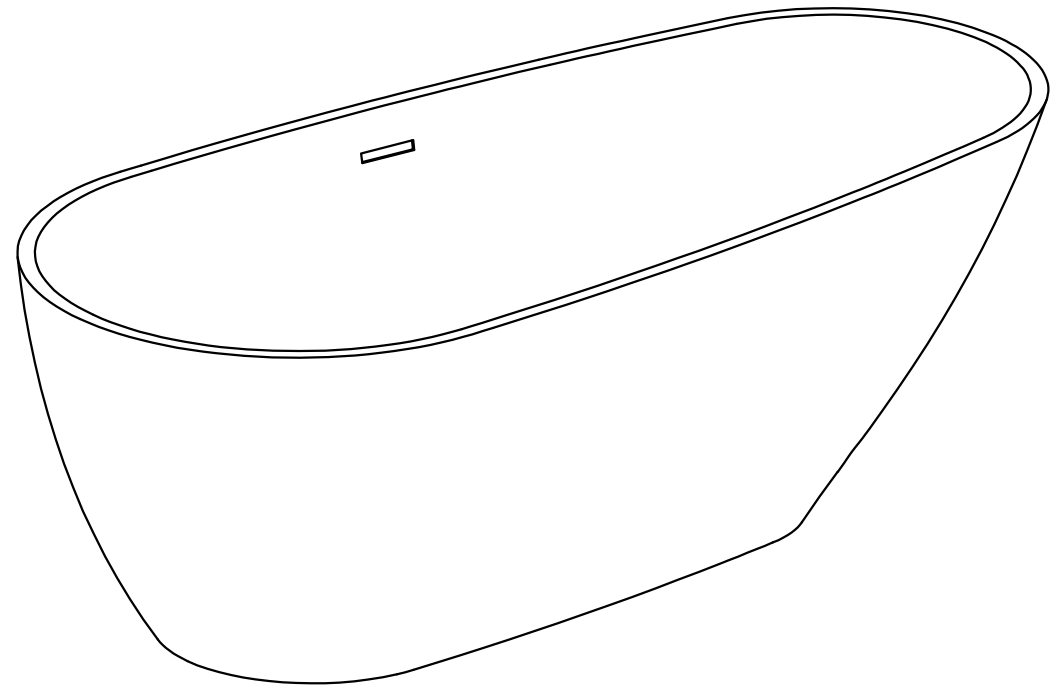

## Luxury Bathtub

Size: 1500 x 800 x 580  
1700 x 800 x 580

# Installation of instructions

## Table of Contents

- Safety Precautions ..... 2
- What's in the package ..... 4
- Dimensions..... 5
- Hydropower construction ..... 6
- Bathtub installation ..... 7

### Trouble shooting:

Missing/Mrong/Broken parts and installation issues



Seng emall with your question plc, order NO. and screenshot of order details to:  
[support@garvee.com](mailto:support@garvee.com)



Respond within 24 hours



Issue resolved

# Hydropower construction

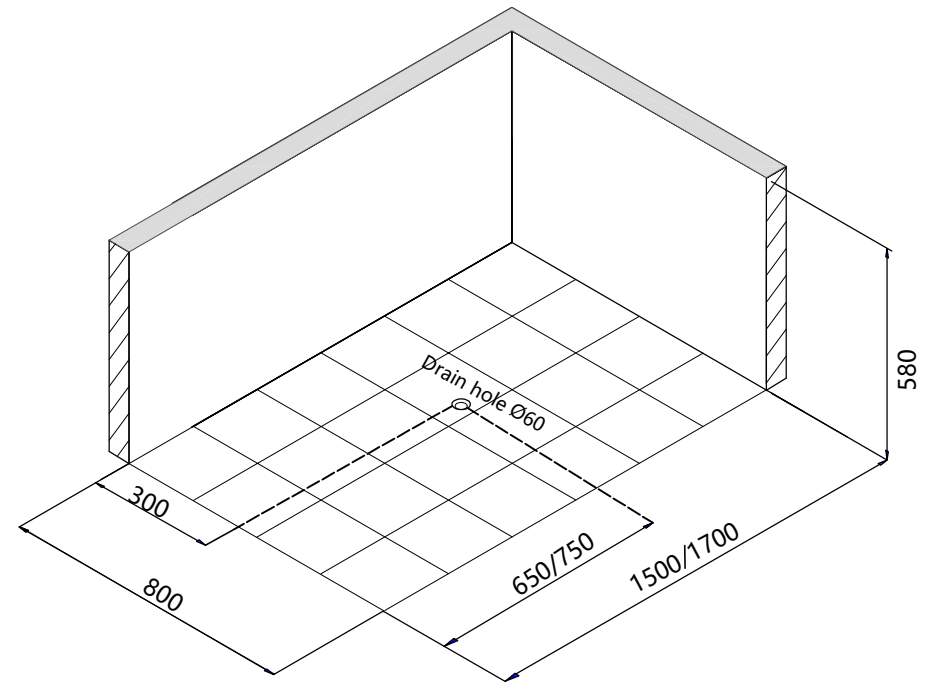

! On-site construction must be done with direct drainage.

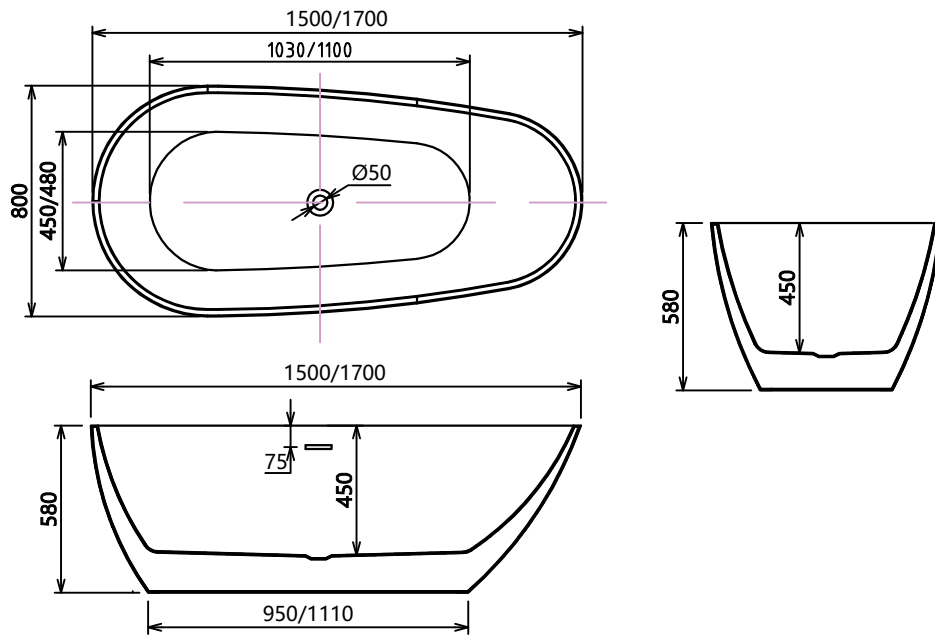

project	specification
Outer dimensions (mm)	1500mm (long) × 800mm (wide) × 580mm (high) <input type="checkbox"/> 1700mm (long) × 800mm (wide) × 580mm (high) <input type="checkbox"/>
Bath depth	450mm
Full water capacity	220L <input type="checkbox"/>
	245L <input type="checkbox"/>
weight	35kg <input type="checkbox"/>
	40kg <input type="checkbox"/>
Material	Fiberglass reinforced plastic bathtub Surface Material (Acrylic)
Drainage method	Usually drainage + overflow drainage
Drain plugs	Push-type drain plug
Drainage capacity (with return bend)	48 L/min
Overflow capacity (with return bend)	48 L/min



Please be sure to read this manual carefully before construction, and install it correctly according to the content of this installation manual.  
Be sure to follow safety warnings and precautions.





	<b>warn</b>	Indicates that there is a risk of death or serious injury to a person if used incorrectly.
	<b>note</b>	It means that if used incorrectly, there is a risk of injury to personnel or damage to goods.

- The matters to be observed are categorized by a graphic sign and the following instructions are made.

		is "prohibited" to carry out content.
		is a "mandatory" content that must be performed.

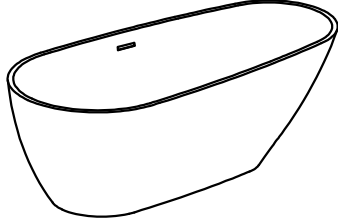
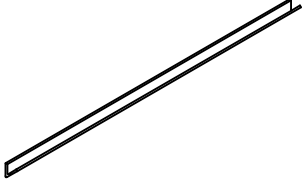
<b>warn</b>	
 <b>forbid</b>	<p><b>Please do not stand on the bathtub to work</b></p> <ul style="list-style-type: none"> <li>It is easy to slip under the feet and cause injury, or damage to the product</li> </ul> <p><b>Install only the parts that come with the product or the specified parts, and do not modify the parts</b></p> <ul style="list-style-type: none"> <li>In particular, please do not change the dimensions of the product.</li> </ul>
	<p><b>Follow the installation instructions to install correctly</b></p> <ul style="list-style-type: none"> <li>When installed incorrectly, it can lead to electric shock or fire. In addition, there is a possibility that water leakage may stain or corrode the contents of the home.</li> </ul> <p><b>Install the drainage piping correctly according to the procedures</b></p> <ul style="list-style-type: none"> <li>If the construction is not done well, there is a possibility that the contents of the home may be soiled or corroded due to water leakage.</li> </ul> <p><b>After unpacking, please clean up the useless packaging materials quickly</b></p> <ul style="list-style-type: none"> <li>Wooden frames, nails, cardboard boxes, plastic wrap, fastening straps, etc. can cause injury. In addition, children playing with packaging materials may cause accidents such as suffocation</li> </ul>
 <b>Must be complied with</b>	<p><b>The bathtub is installed on the tap water appliance for drinking water</b></p> <p><b>When installing the bathtub, please follow the installation instructions correctly in a stable place that is sufficient to bear its weight</b></p> <ul style="list-style-type: none"> <li>Otherwise, it is easy to fall and fall out of the bathtub, resulting in injury.</li> </ul>
	<p><b>During transportation and installation work, avoid working with a body weight</b></p> <ul style="list-style-type: none"> <li>Please make sure that your feet are safe and secure. The operation needs to be carried out with the cooperation of multiple people, otherwise it may lead to accidents or injuries.</li> </ul>
	<p><b>Pay attention to the local accident prevention regulations and building standards regulations, health and environmental protection regulations in force during installation.</b></p>

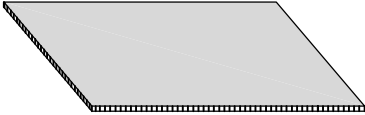
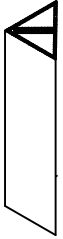
 <b>note</b>	
 <b>forbid</b>	<b>Do not place stepstools or heavy objects on the edge of the bathtub</b> • Failure to do so may result in breakage of the bathtub.
	<b>Do not drop hard or heavy objects in the bathtub or collide with the bathtub</b> • Otherwise, there is a risk that the bathtub may crack and cause injury, or that water leaks and stain or corrode the contents of the home.
	<b>Do not place heat sources nearby</b> <b>Don't smoke</b> • Failure to do so may result in injury.
	<b>Do not install the bathtub outdoors or in places that are usually exposed to sunlight (solariums, etc.)</b> • Otherwise, it may cause damage and discoloration due to freezing.
	<b>When carrying the bathtub, do not hold hoses or pipes in your hands, and do not bump into hard objects.</b>
 <b>Must be complied with</b>	<b>When opening the box, check whether the included parts and bathtub are damaged, and do not use damaged parts</b> • Replace damaged parts.
	<b>If the bathtub is installed in a place where water leakage may cause disaster, the floor must be waterproofed</b> • Otherwise, in the event of a water leak, the downstairs may be damaged.
	<b>The protective film of the bathtub is removed after the construction is completed</b>
	<b>Make sure there is enough space for the use and management of the bathtub</b>
	<b>Before installation, confirm the tightness of each part</b> • When a water leak is detected, solve the cause of the leak.

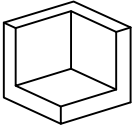
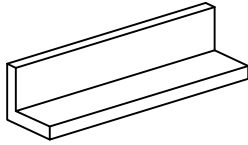
<b>What's in the package:</b>	
<p>A-1 : bathtub</p>  <p style="text-align: right;">1pcs</p>	<p>A-2 : Polyethylene foam</p>  <p style="text-align: right;">2pcs</p>
<p>A-3 : Installation instructions</p>  <p style="text-align: right;">1pcs</p>	<p>A-4 : Honeycomb cardboard</p>  <p style="text-align: right;">1pcs</p>
<p>A-5 : Triangular cardboard</p>  <p style="text-align: right;">4pcs</p>	<p>A-6 : PE packaging bags</p>  <p style="text-align: right;">1pcs</p>
<p>A-7 : Polyethylene foam corner protectors</p>  <p style="text-align: right;">4pcs</p>	<p>A-8 : Polyethylene foam wraps</p>  <p style="text-align: right;">6pcs</p>