

# COFFEE TABLE



THANK YOU FOR YOUR ORDER!  
ENCLOSED PLEASE FIND A POLISHING CLOTH FOR YOUR USE TO CLEAN THE RESIDUE FROM THE FINE OIL USED IN PRODUCTION OF THIS CHROME PRODUCT.  
PLEASE ALSO CALL US IF YOU HAVE ANY QUESTIONS.

## **ASSEMBLY INSTRUCTIONS**

---

We have designed our furniture with you, the customer in mind. Our clear, easy to follow, step by step instructions will guide you through the project from start to finish. Feel confident that this will be a fun and rewarding project. The final product will be a quality piece of furniture that will go together smoothly and give years of enjoyment.

---



Please do not return to the store

\*Special Note: We recommend the use of a hand held screwdriver to avoid the stripping of screw heads.\*

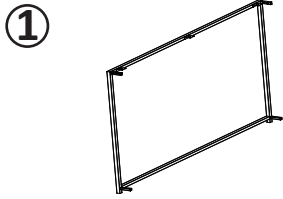

Front \ Rear(2pcs)

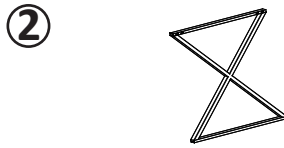

Side frame(2pcs)

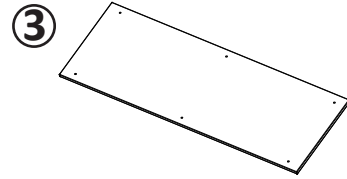
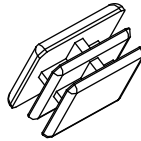

Table top (1pcs)



A Screw (22pcs)



B Plastic foot (4pcs)



C Polishing cloth (1pc)

## Step1

\*Special note screw holes in top of side frames ② should be facing in and bottom screw holes should be facing up.

1.Slide front and rear frames ① into side frames ② and fasten together using screws(A).

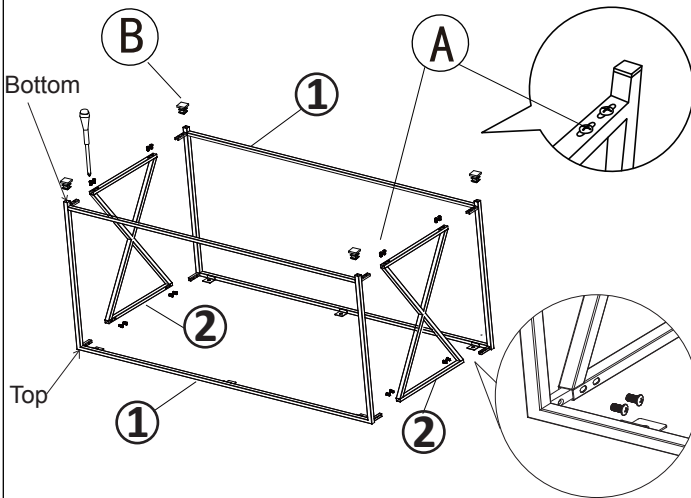

2.Carefully push plastic feet (B) into bottom corners.

## Step2

1.Carefully place table top ③ on carpet or other soft surface .

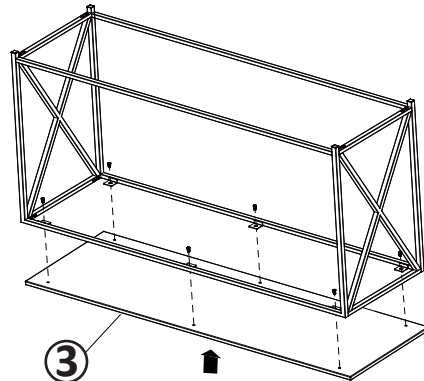

2.Fasten leg assembly to table top ③ using screws (A) as shown.

## Step3

Turn over and enjoy.

