

Safety Instructions

Made in China

- ① Always keep away from water.
- ① Do not place or store appliance where it can fall or be pulled into a tub or sink. If the appliance falls into water, DO NOT REACH INTO THE WATER.
- ① Do not use while bathing or in the shower.
- ① Close supervision is necessary when any appliance is used by or near children or people with a physical/mental disability.
- ① Do not operate this appliance if the appliance malfunctions or has been damaged in any manner. No repairs should be attempted by the consumer.
- ① Use appliance only for intended use as described in this instruction-book.
- ① Be sure mirror is not in a position where it can reflect sunlight.

Instructions for using lighted makeup mirror with touch sensor

- ① Make sure the batteries are installed correctly or the mirror is connected to power (output:5V,1A-2A) by the provided USB cable.
- ② Replace old batteries of a set at the same time.
- ③ Do not mix alkaline, standard or rechargeable batteries together.
- ④ Clean the battery compartment by blowing any debris away before battery installation.
- ⑤ When batteries begin to fail, replace brand new batteries or start to operate by USB cable.
- ⑥ Batteries contain various materials that must be recycled and disposed properly. Do not dispose in the municipal waste system.
- ⑦ Take out AA batteries and disconnect USB cable when mirror is not used for a long time.

LIGHTED MAKEUP MIRROR WITH TOUCH SENSOR

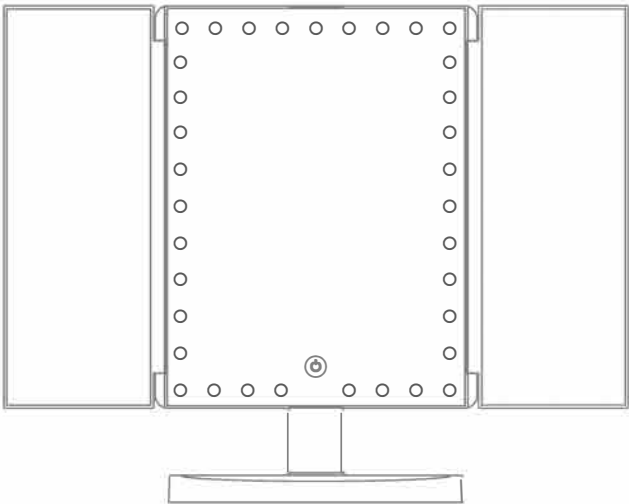

4\* AA Battery & USB Charging Operated  
For your safety and continued enjoyment of this product,  
Always read the instructions carefully before using.

Special Feature

- This lighted makeup mirror uses built-on Energy Saving LED bulbs. Replacement bulbs are not required.
- Built-in touch sensor switch
- The base with a storage function, save space at the same time let your dresser clean and tidy
- Up and down 90 degree rotation
- Surround 360 degree rotation

What's in the box



LED makeup mirror

x

①



USB Charging Cable

x

①



Product Instruction manual

x

①

How to Assemble

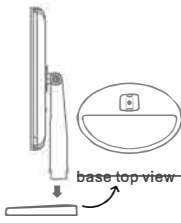

Align the base and the stand of the main mirror



Insert the main mirror stand into the base



When you hear a sound of lock, the mirror is well assembled for use

Operating Instructions

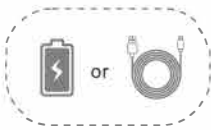

Make sure 4pcs AA batteries are installed properly or USB cable is connected correctly.



Put your fingers on the power switch on the mirror panel, the mirror will be lighted up with LED lights circle.



Get your finger off on the power switch, then touch again, the lights will be turned off.

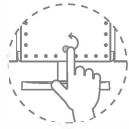

Keep your finger on the power switch, you can adjust the light brightness as per your needs.