

vanity table

**T68 L-W, T68L-B, T68L -W-L, T68L -B-L,
T68L-W-LS, T68L -B-LS**

INSTALLATION MANUAL

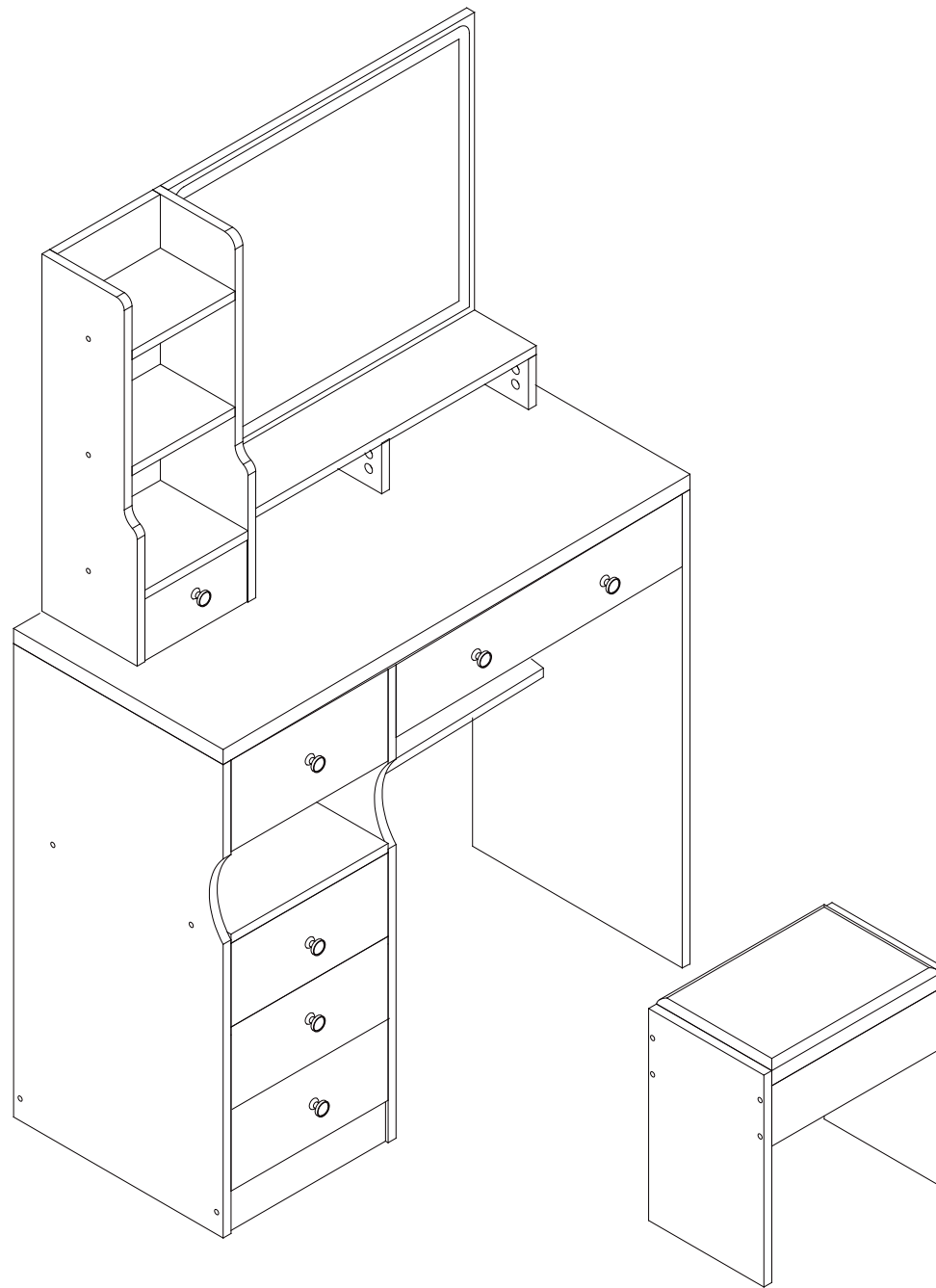

T68 is the model name, L is large size, W is white, B is black, L represents with mirror light, S represents with built-in socket and hair dryer holder. If your product model is T68L-W, T68L-B, then the product does not come with a mirror light, built-in socket, and hair dryer stand. If your product is T68-W-L or T68-B-L, it does not come with a built-in socket and hair dryer stand.

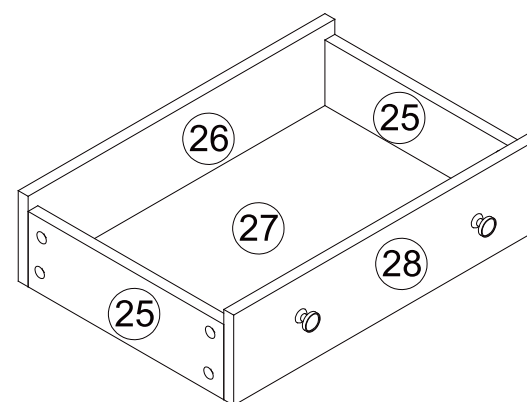
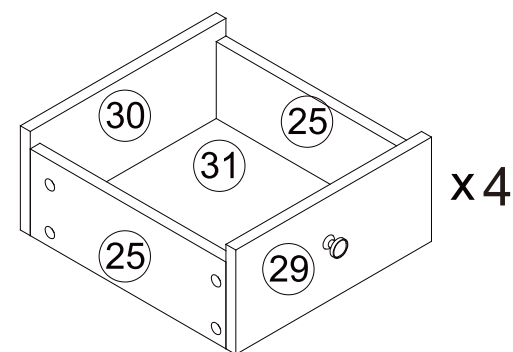
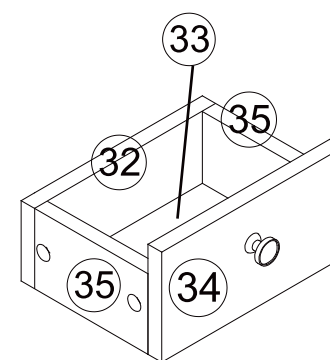
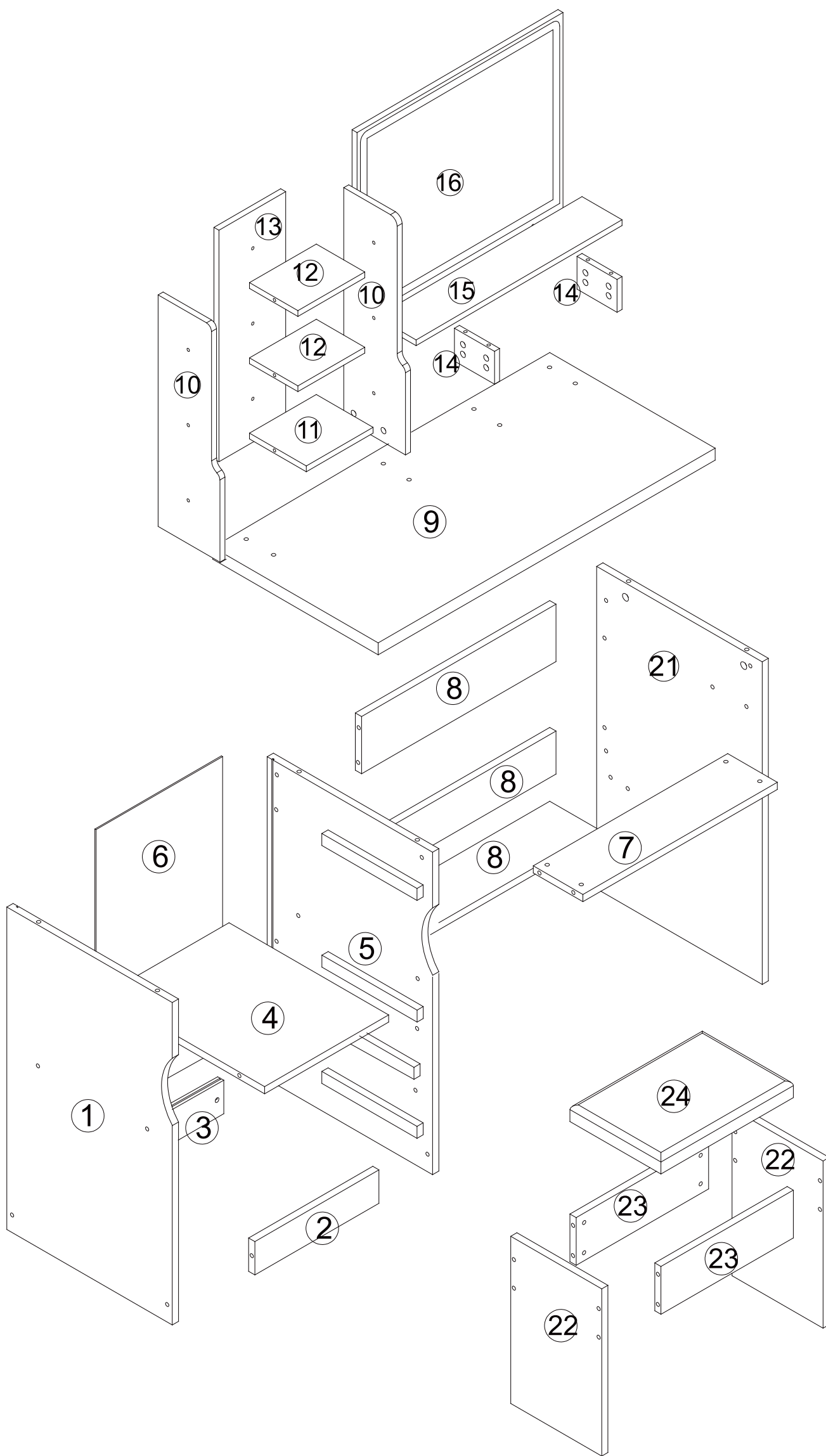

1 - x1	16 - x1	31 - x4
2 - x1		32 - x1
3 - x1		33 - x1
4 - x1		34 - x1
5 - x1	21 - x1	35 - x2
6 - x1	22 - x2	
7 - x1	23 - x2	
8 - x3	24 - x1	
9 - x1	16 - x	
10 - x2	26 - x1	
11 - x1	27 - x1	
12 - x2	28 - x1	
13 - x1	29 - x4	
14 - x2	30 - x 4	
15 - x1		

Before installation, please find a marker pen with erasable marks, distinguish each accessory based on the shape of the board and the position of the holes, and then write the corresponding numbers on the board.

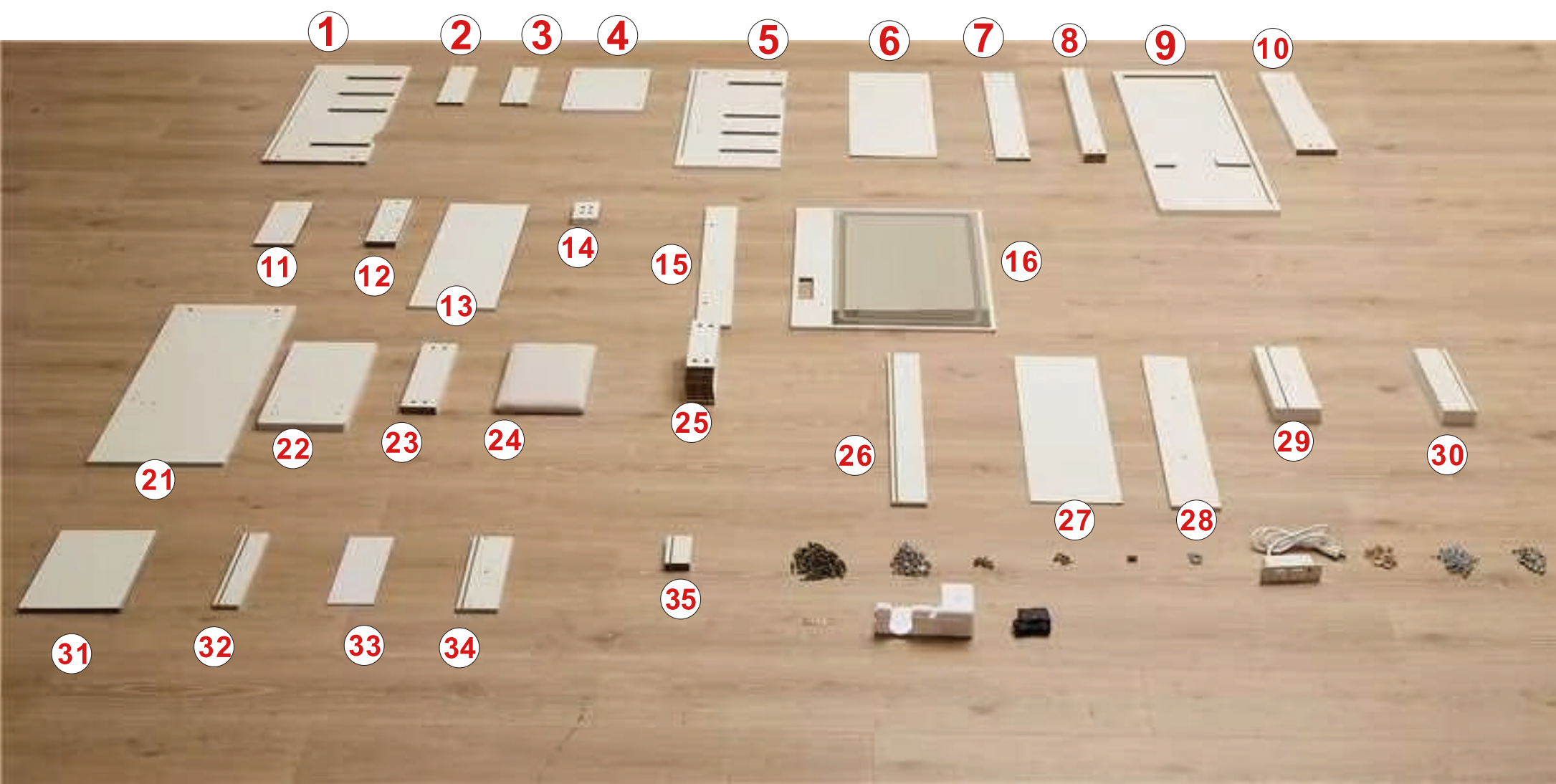

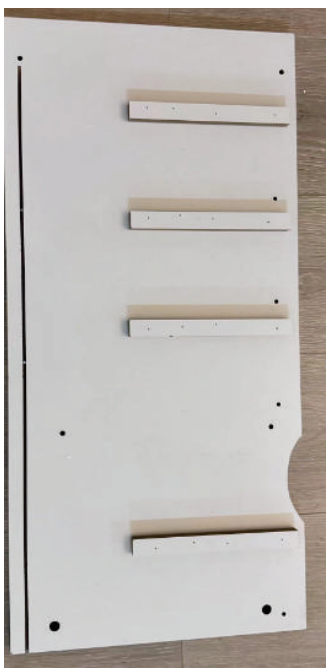

1 -x1



2 -x1



3 -x1



4 -x1



5 -x1



6 -x1



7 -x1



8 -x3



9 -x1



10 -x1



11 -x1



12 -x2



13 -x1

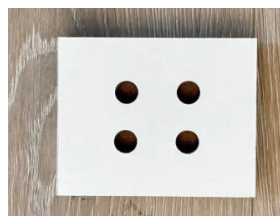

14 -x2



15 -x1

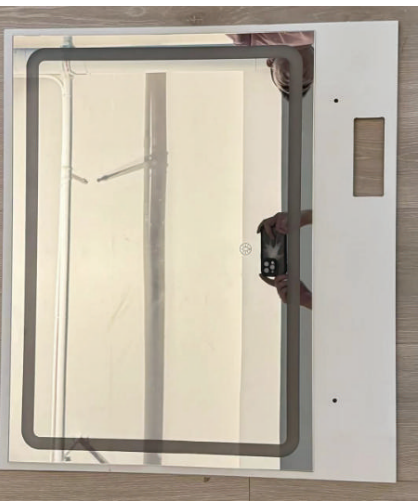

16 -x1

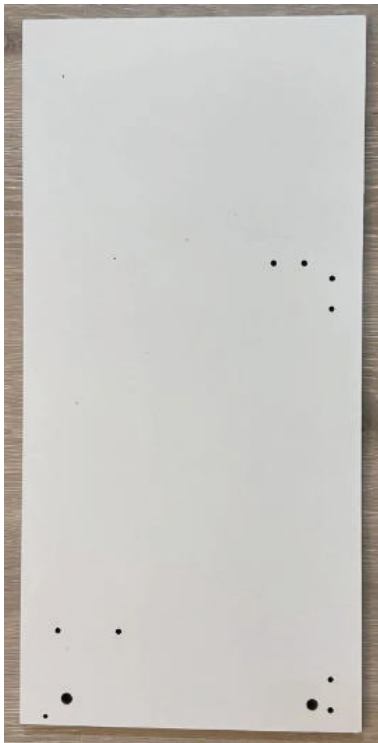

21 -x1



22 -x2



23 -x2

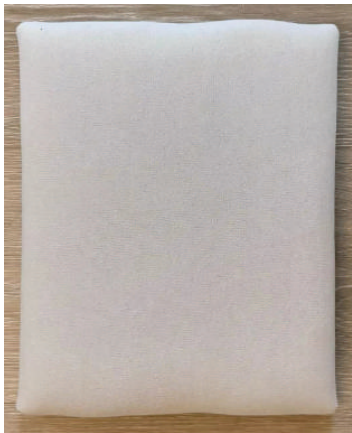

24 -x1



25 -x10



26 -x1

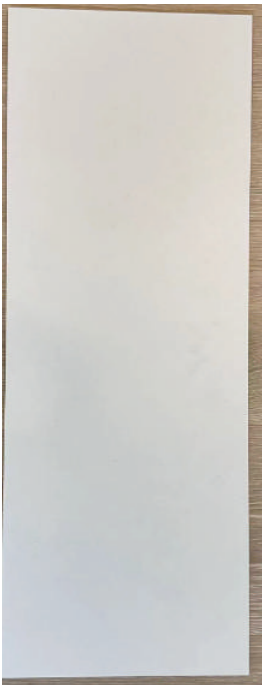

27 -x1



28 -x1

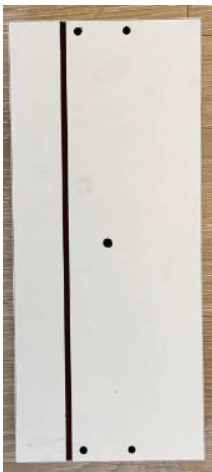

29 -x4



30 -x4

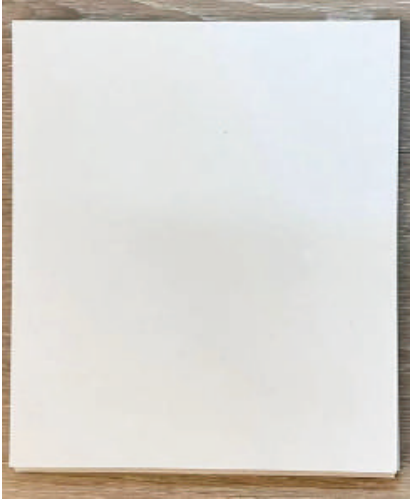

31 -x4



32 -x1



33 -x1



34 -x1



35 -x2

hardware



A	3 IN 1 SCREW	x 58
---	--------------	------

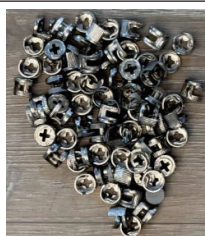

B	3 IN 1 LOCK	x 58
---	-------------	------



C	12MM SCREW	x 16
---	------------	------



D	GUIDE RAIL	x 2
---	------------	-----



E	HANDLE SCREW	x 7
---	--------------	-----



F	L PLATE	x 2
---	---------	-----



G	DRAWER POSITIONING SCREW	x 10
---	--------------------------	------



H	SOCKET	x 1
---	--------	-----

Only for LS



L	DRAWER HANDLE	x 7
---	---------------	-----



J	2 IN 1 SCREW	x 48
---	--------------	------



K	2 IN 1 LOCK	x 48
---	-------------	------



I	HAIR DRYER STAND	x 1
---	------------------	-----

Only for LS



M	16MM SCRAE	x 2
---	------------	-----

For fixing the socket



N	POWER PLUG	x 1
---	------------	-----



O	I PLATE	x 2
---	---------	-----

1. Screw installation method

When the screw is installed, please keep it in line with the board, and do not tighten it too tightly

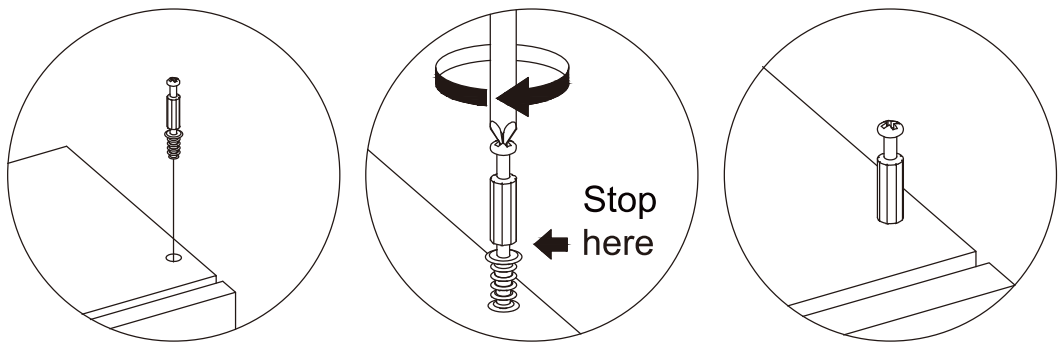

2. Check the Nut direction

This direction of the marked nut is consistent with the direction in which the screw is inserted

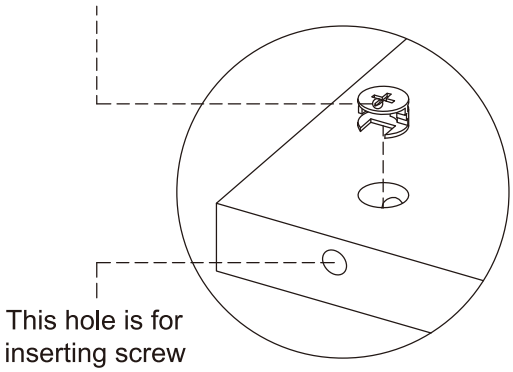

3. Installation on the board with fixing screws

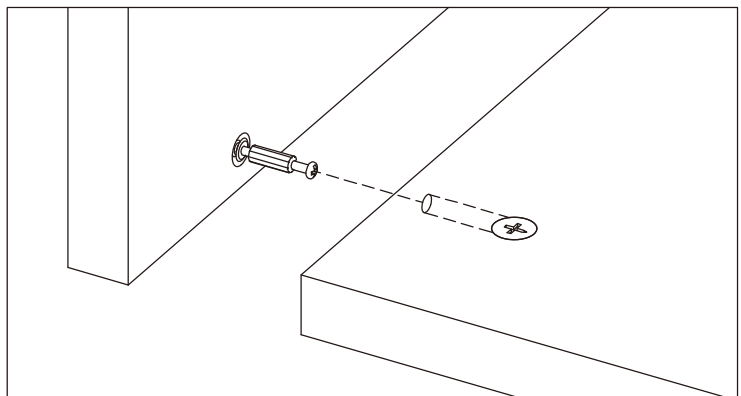

3. Rotate slowly until it stops

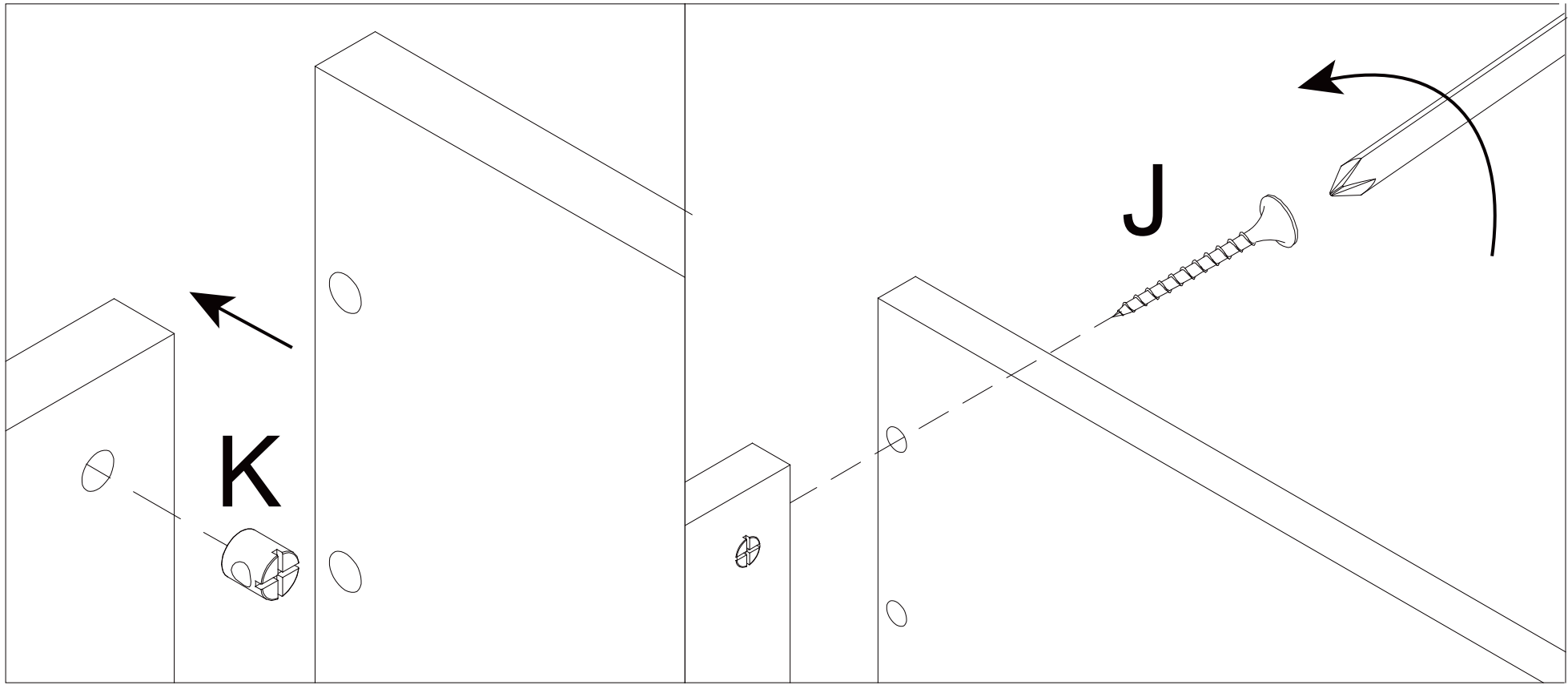
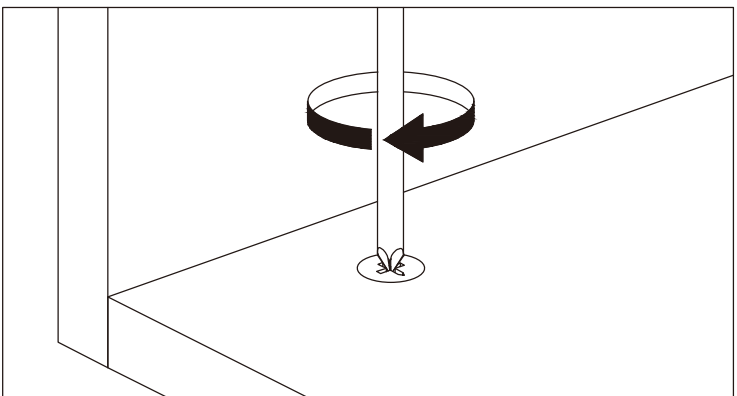

Step 01

pick up (26) x1, (27) x1, (28) x1, (25) x2 and (29) x4, (30) x4, (31) x4, (25) x8
(32) x1, (33) x1, (34) x1, (35) x2

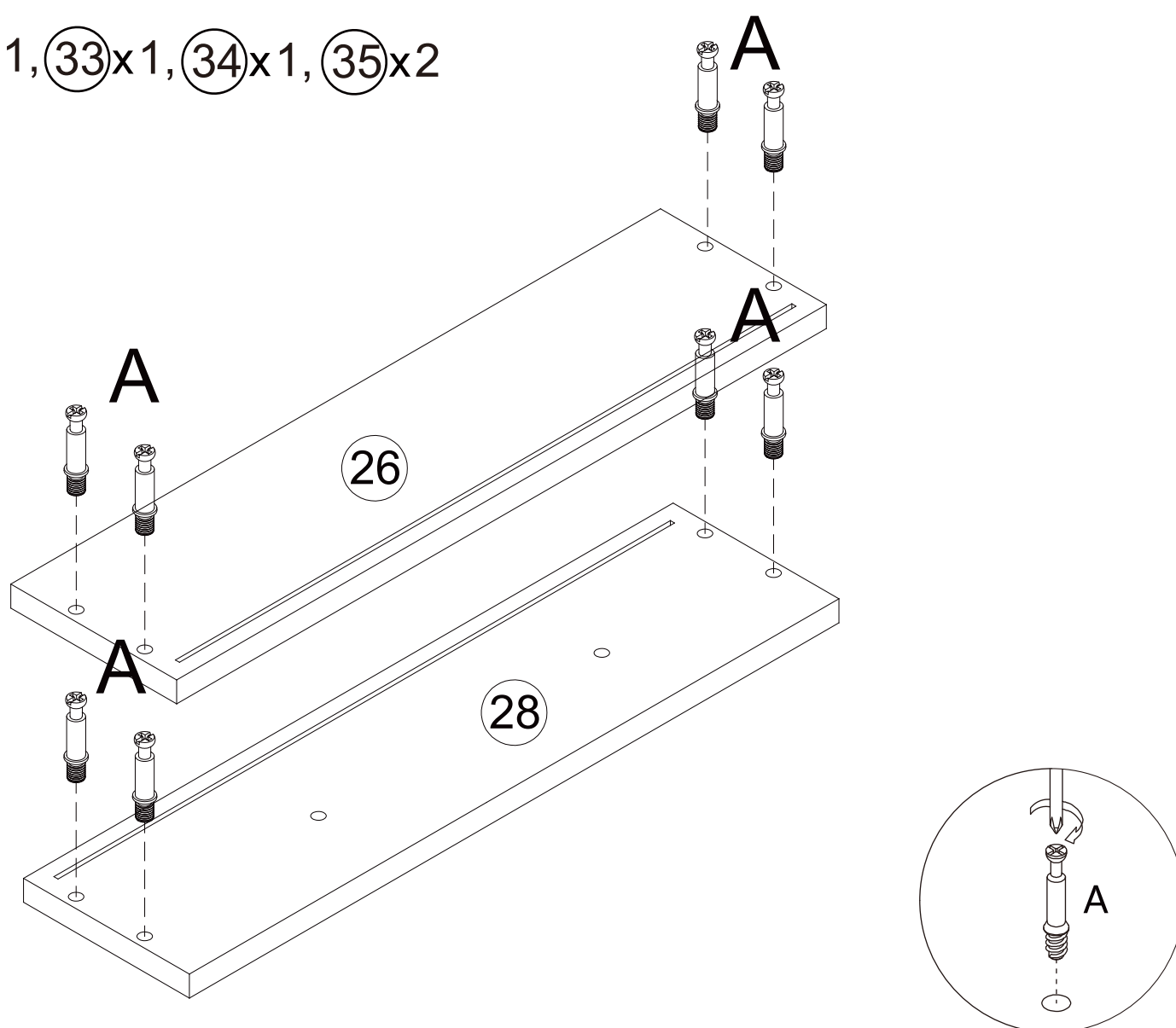

Step 02

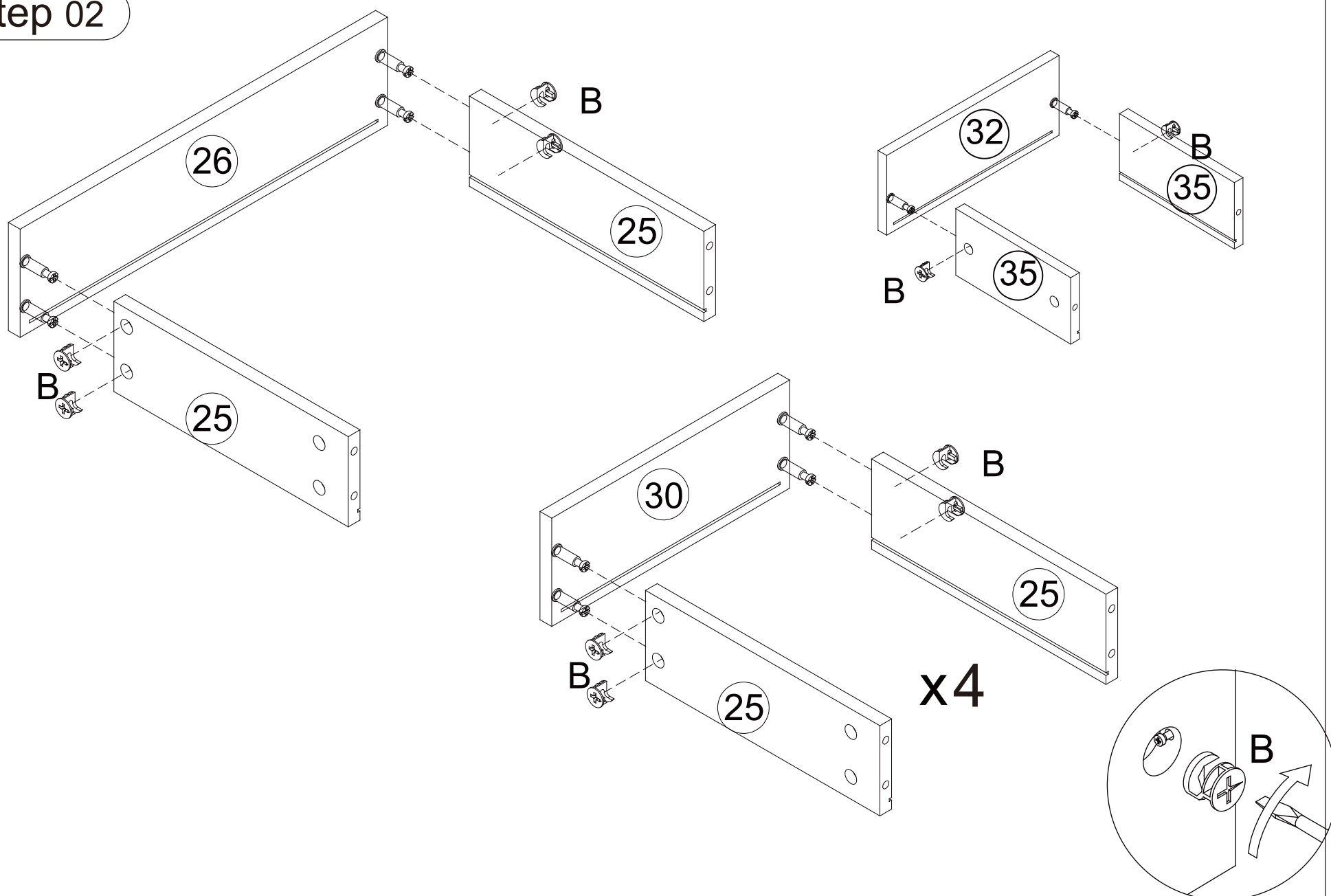

Step 03

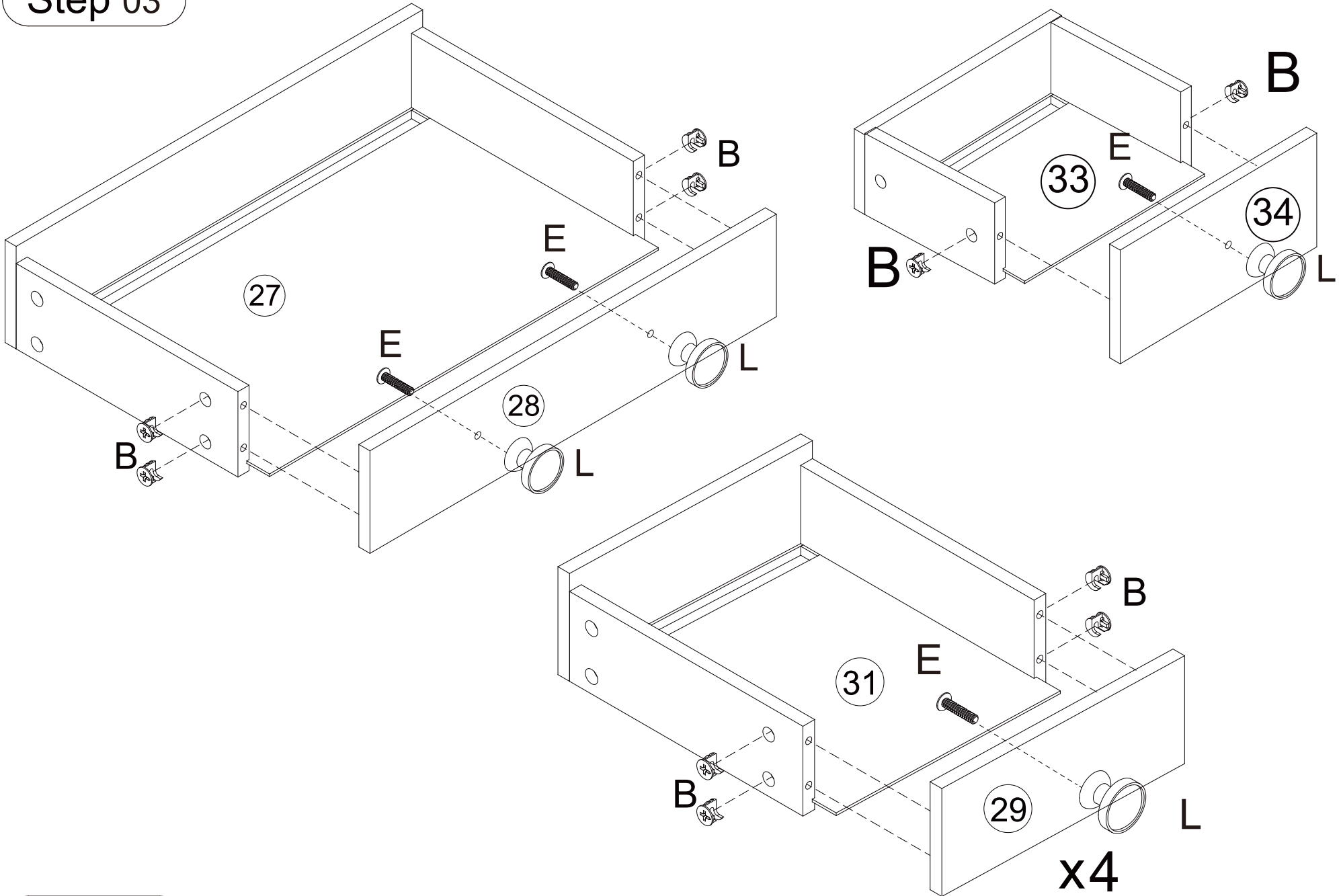

Step 04

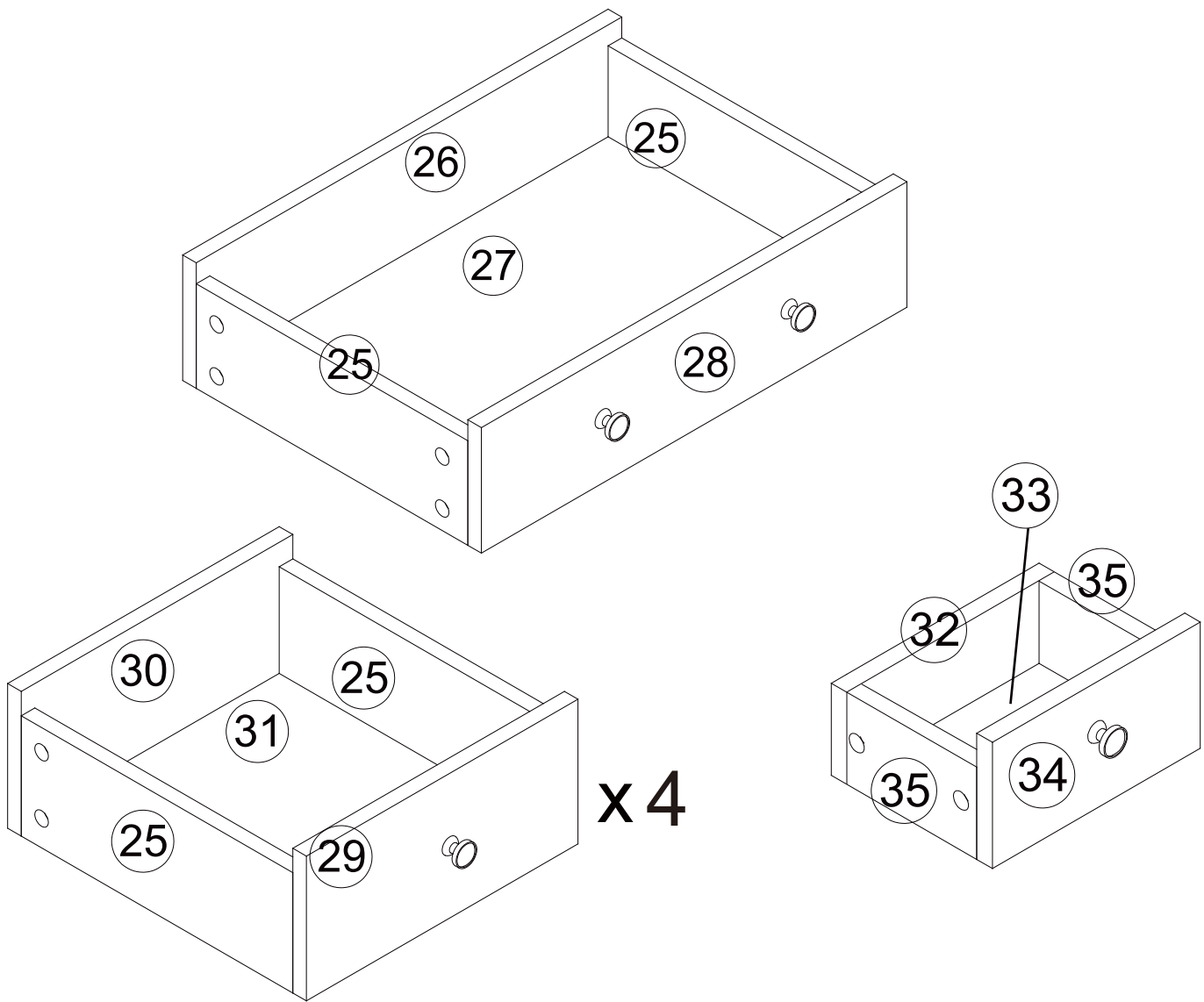

Step 05

pick up ①x1, ②x1, ③x1, ⑤x1, ⑥x1, ④x1

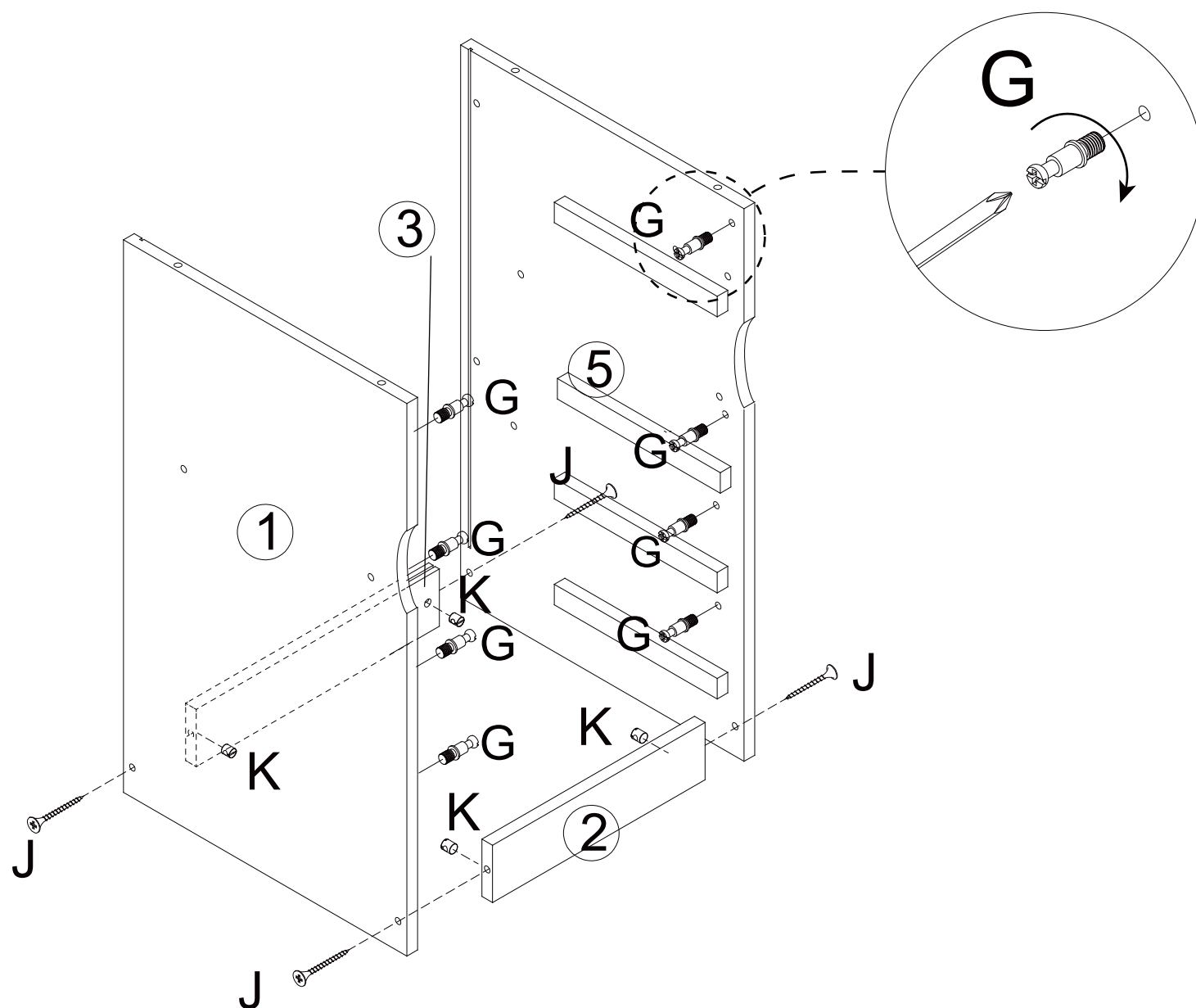

Step 06

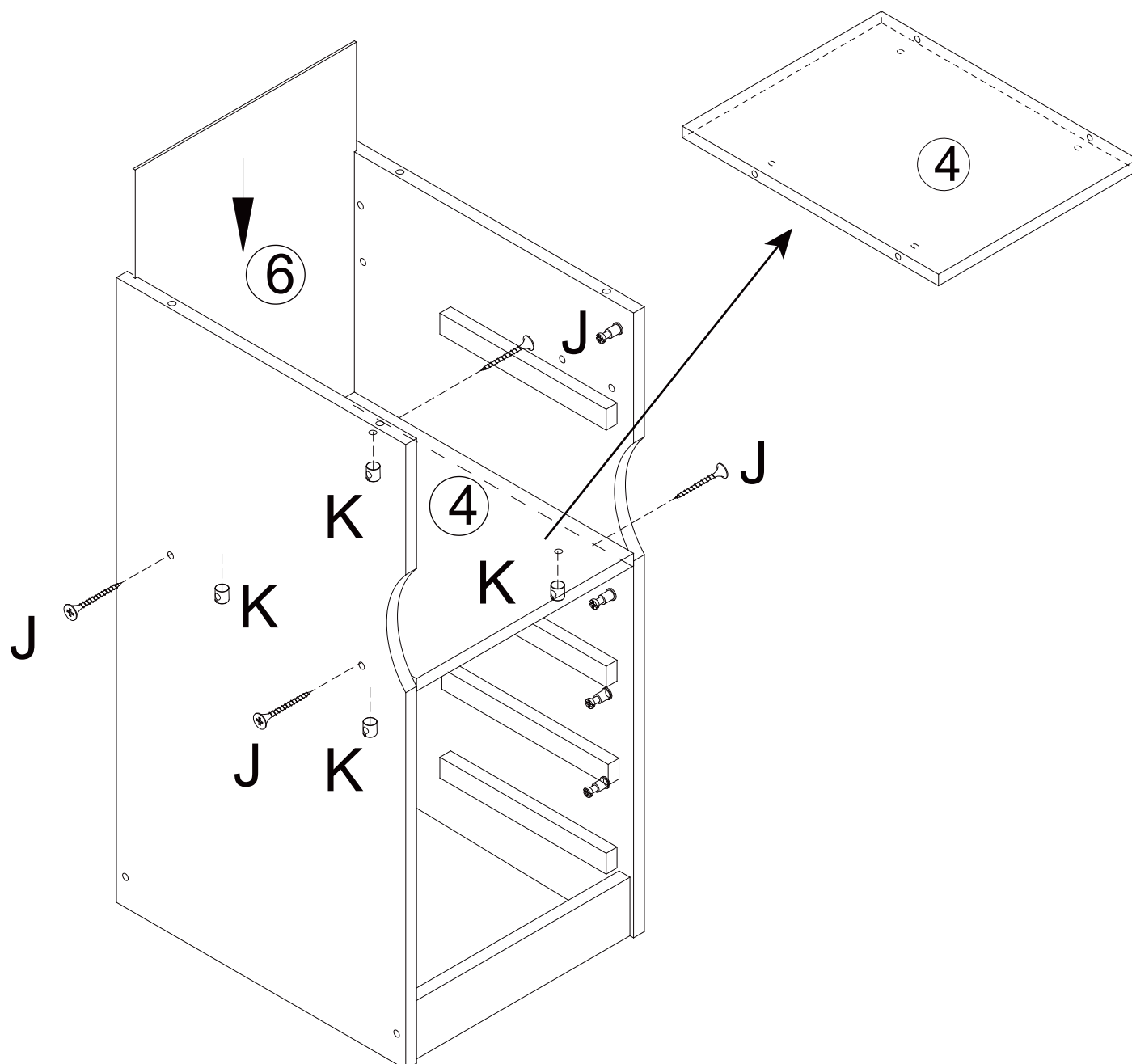

Step 07

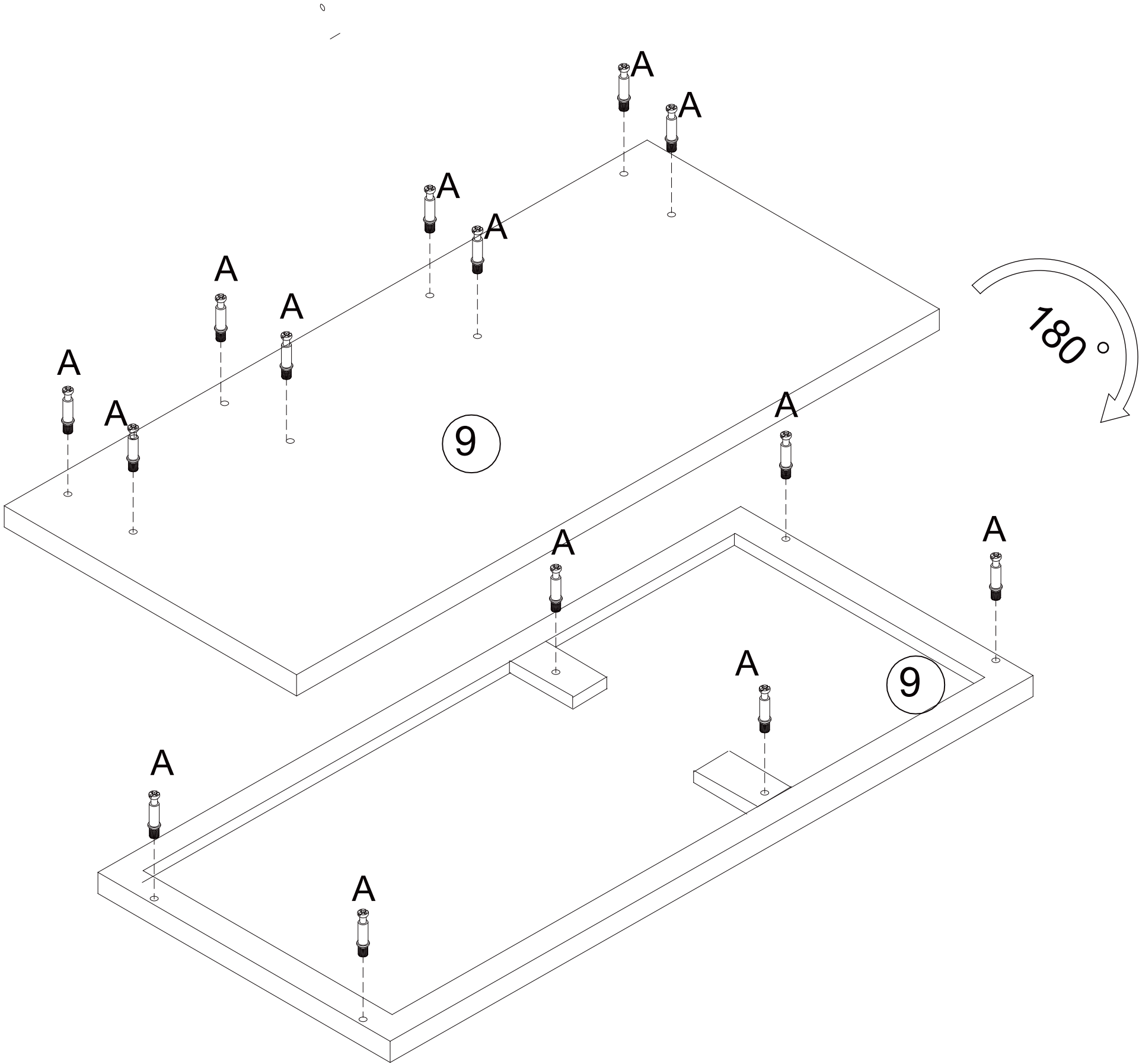

Step 10

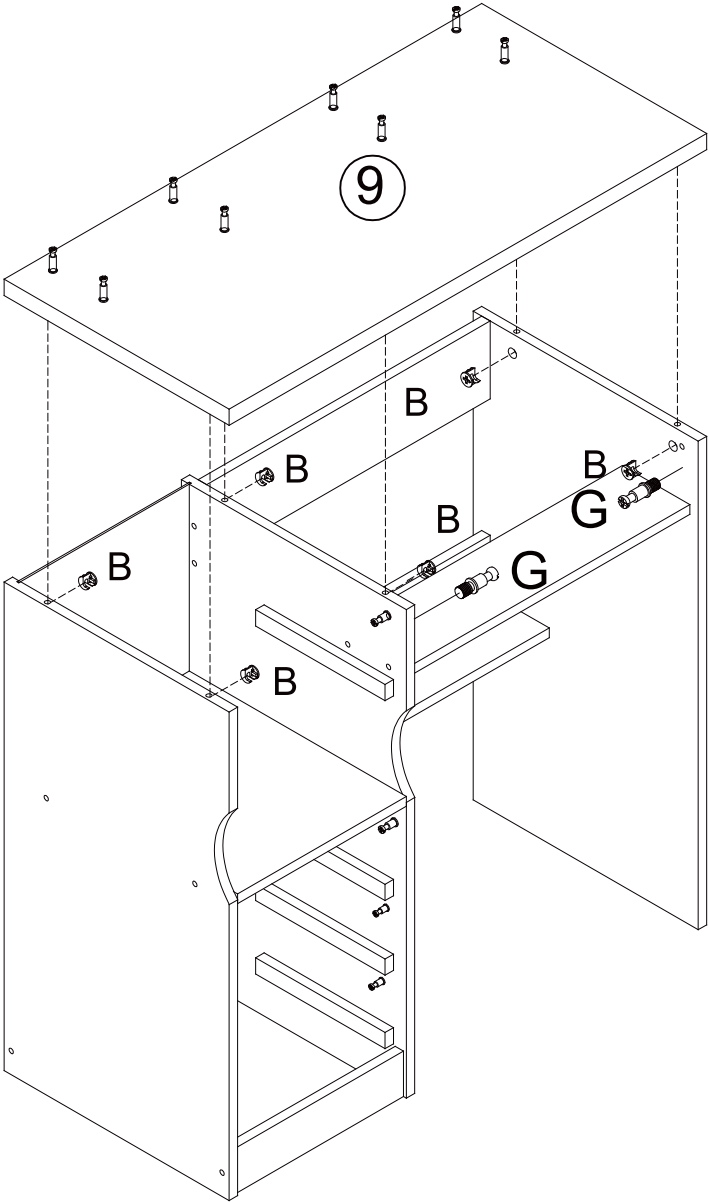

Step 11

pick up ⑩x 2, ⑪x 1, ⑫x 2, ⑬x 1

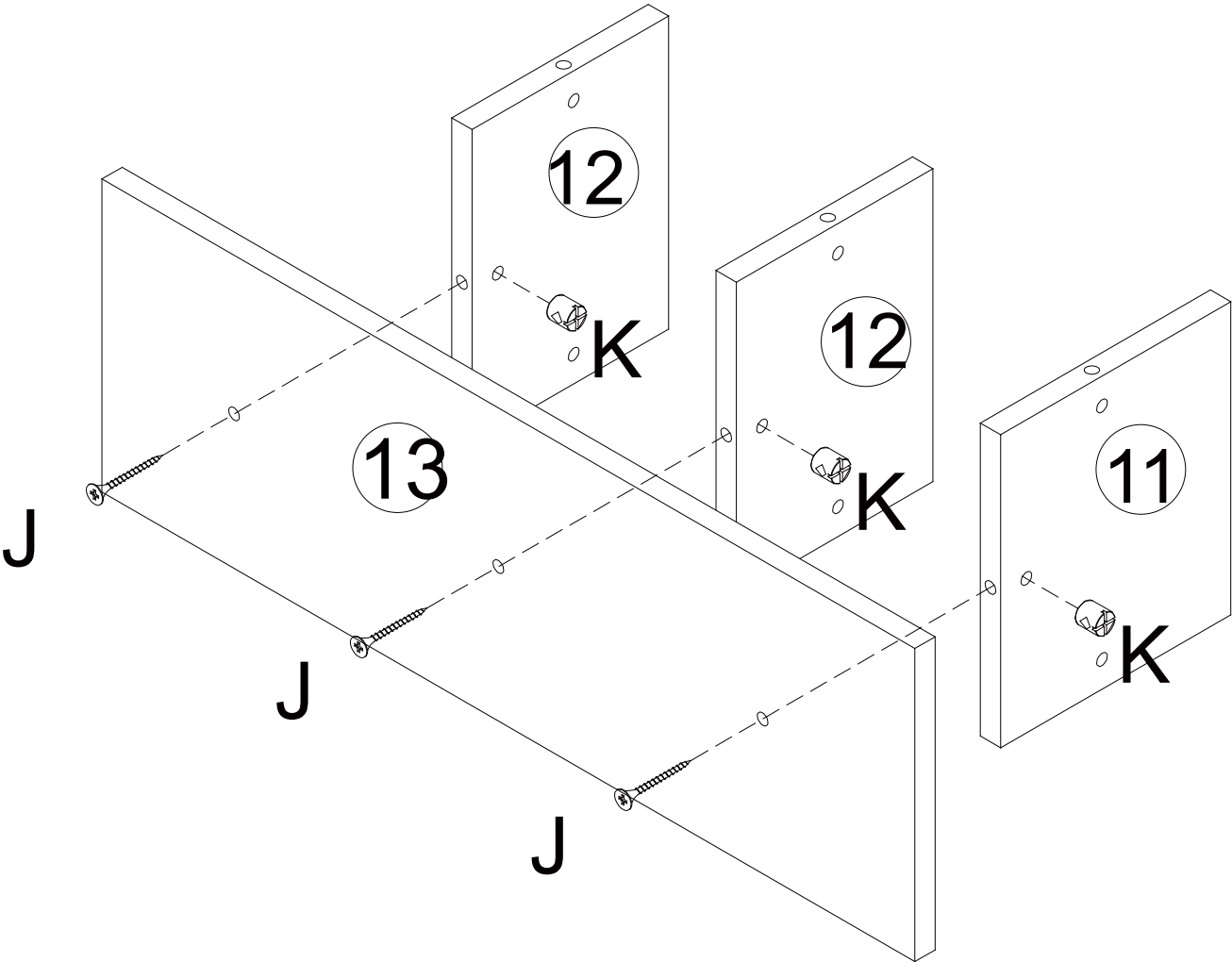

Step 12

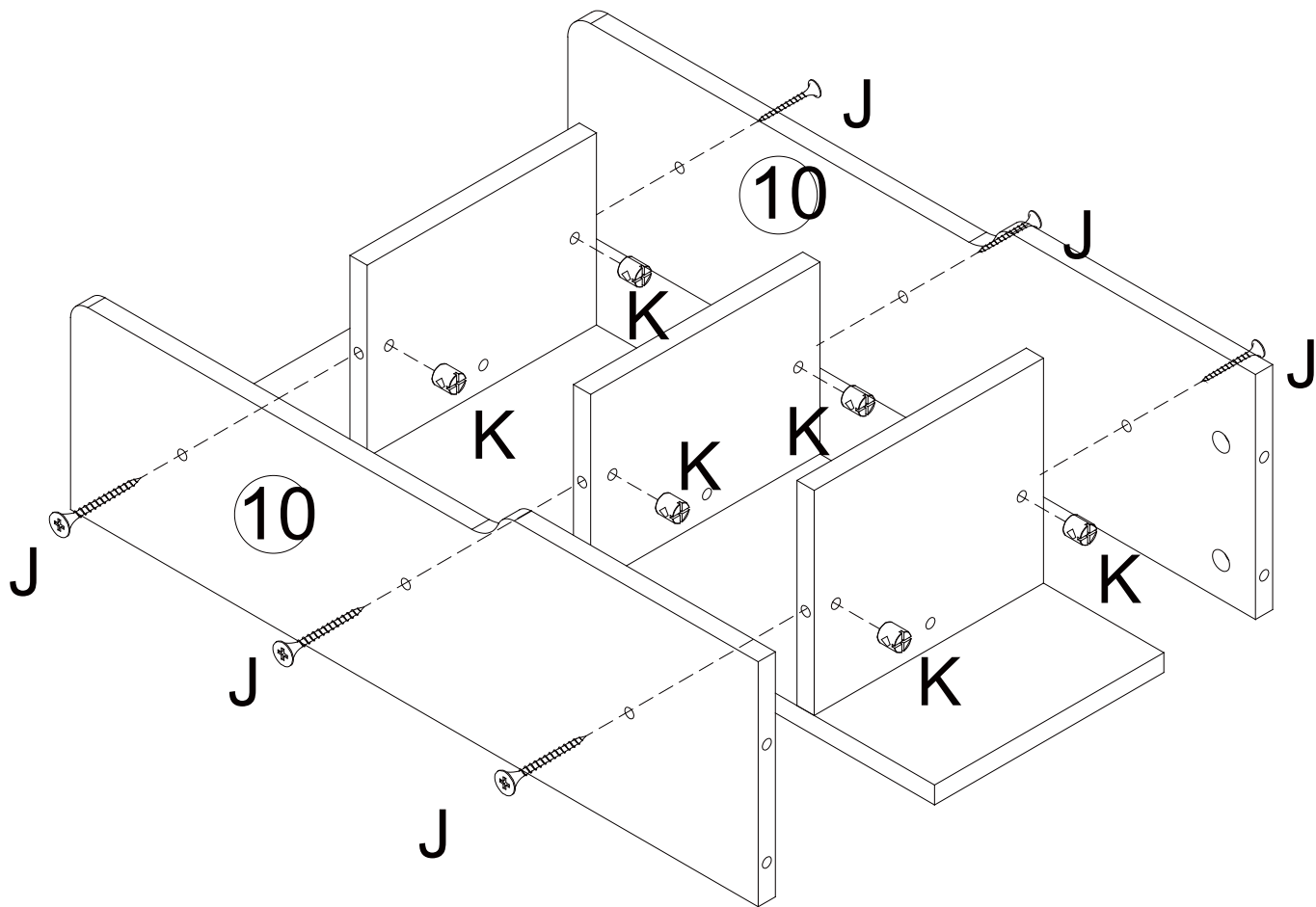

Step 13

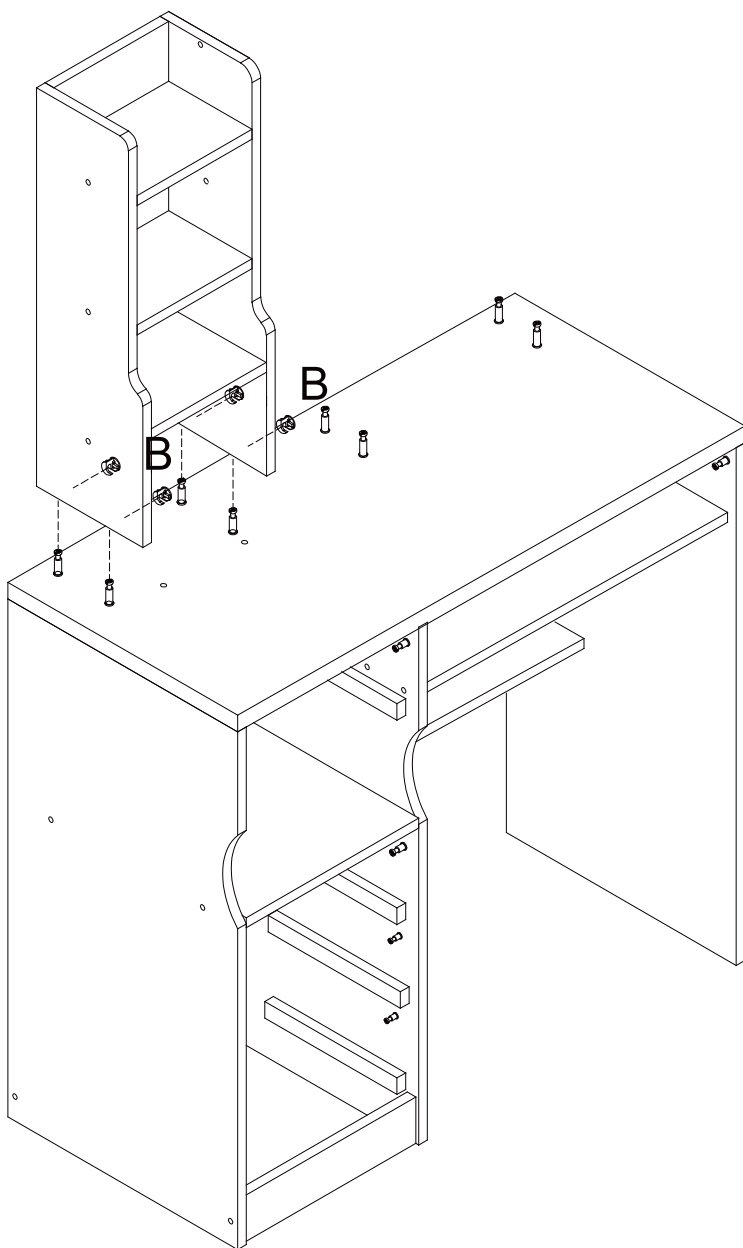

Step 14

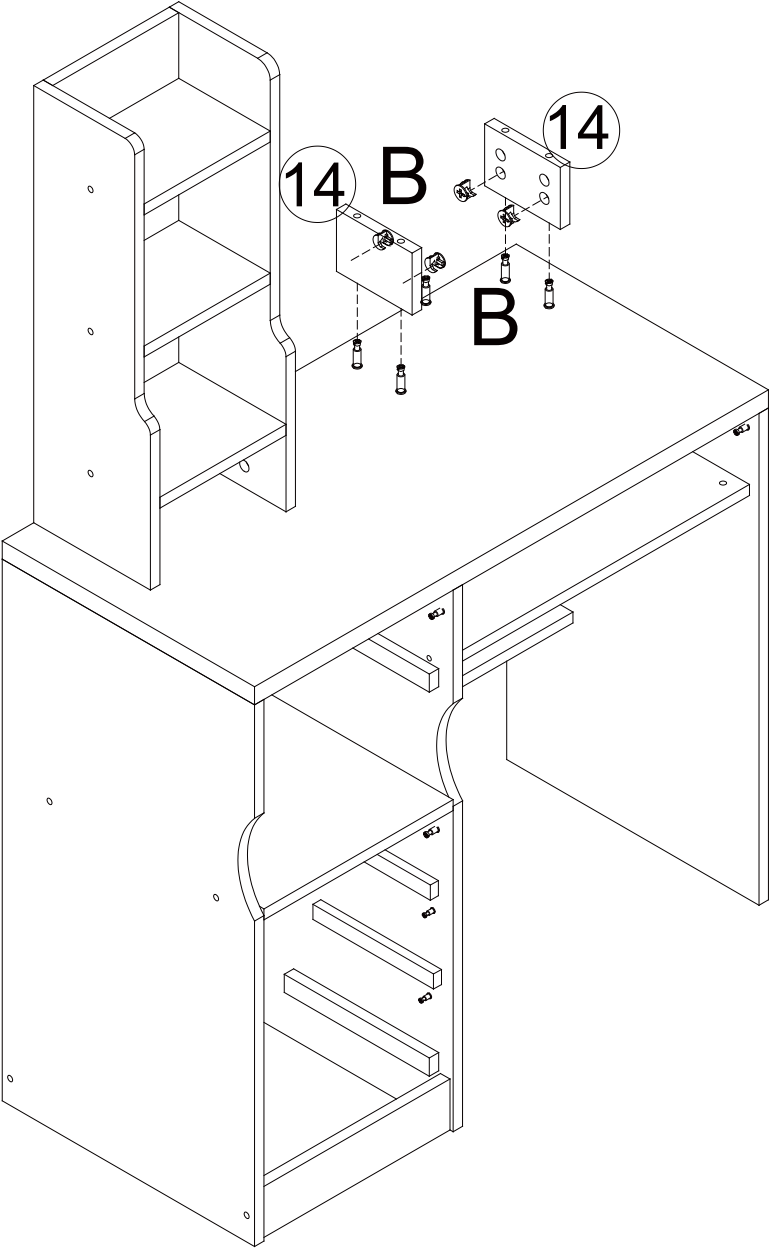

Step 15

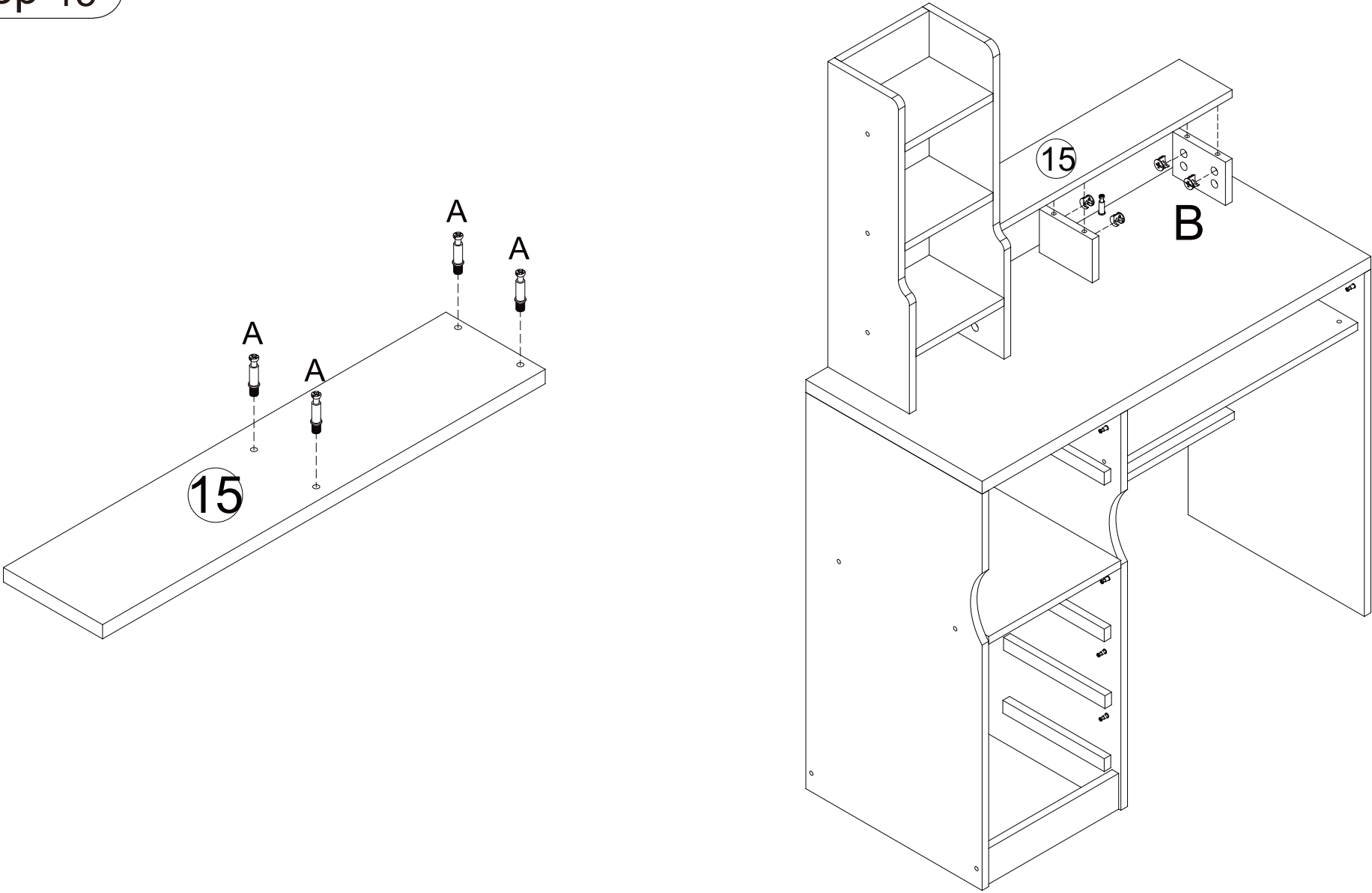

Step 16

For vanity table with light

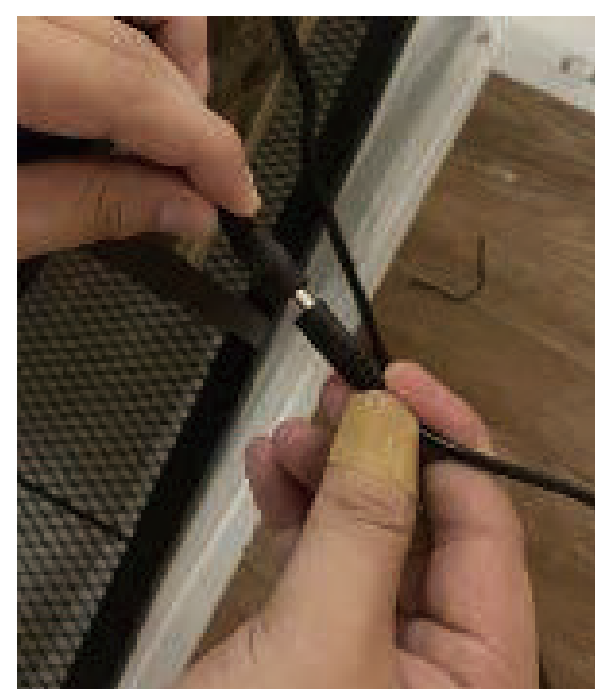
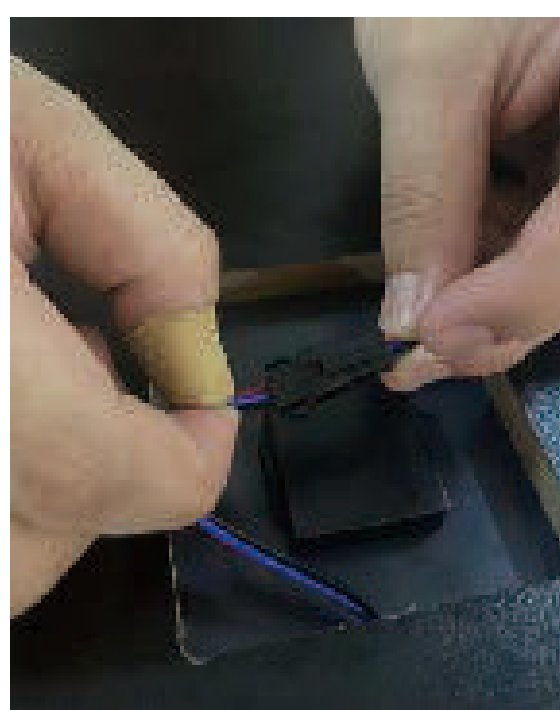
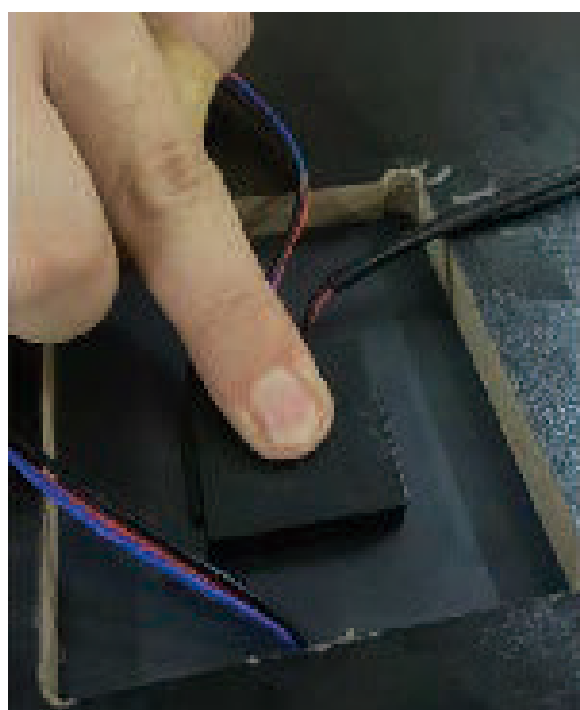
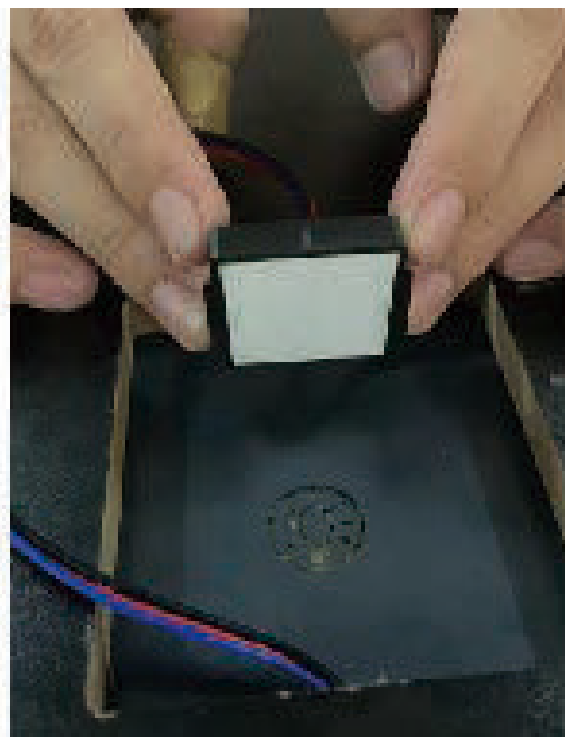
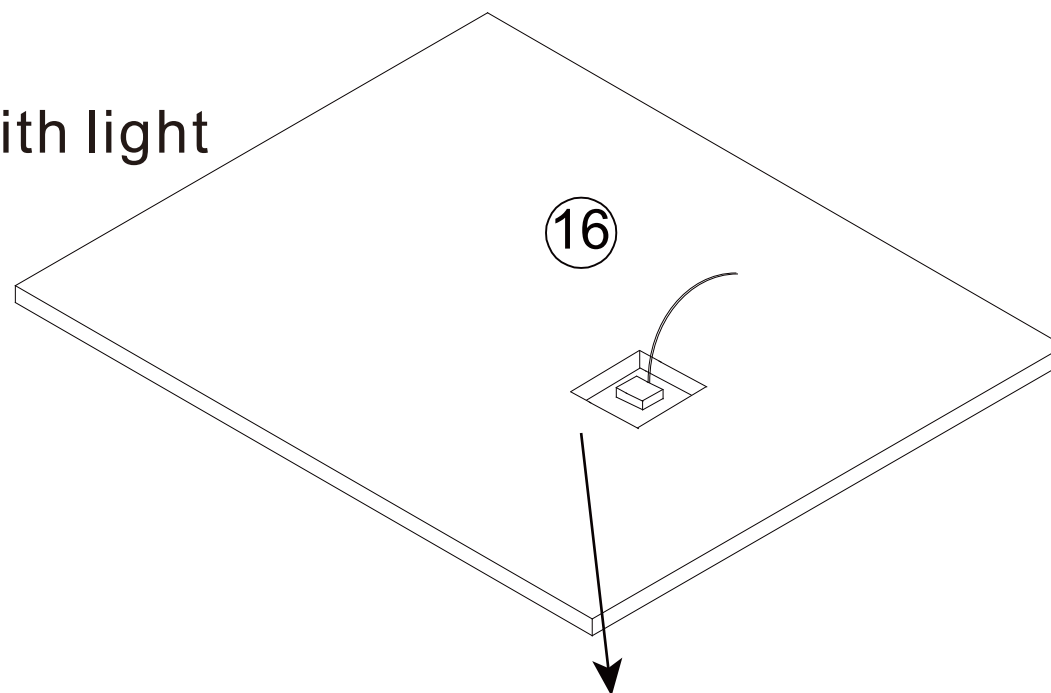

If your vanity table include a LED mirror light, please test the light in this step. Touch the switch botton on the mirror to turn on the mirror light, click the switch botton to change the color of the light, and long press the switch botton to adjust the brightness. If the switch botton is not sensitive, you can check whether the touch switch is tightly attached to the mirror back as shown in the diagram. If it is not tightly attached, please use your fingers to press the touch switch to the designated position and check if the connecting wire is OK.

Step 17

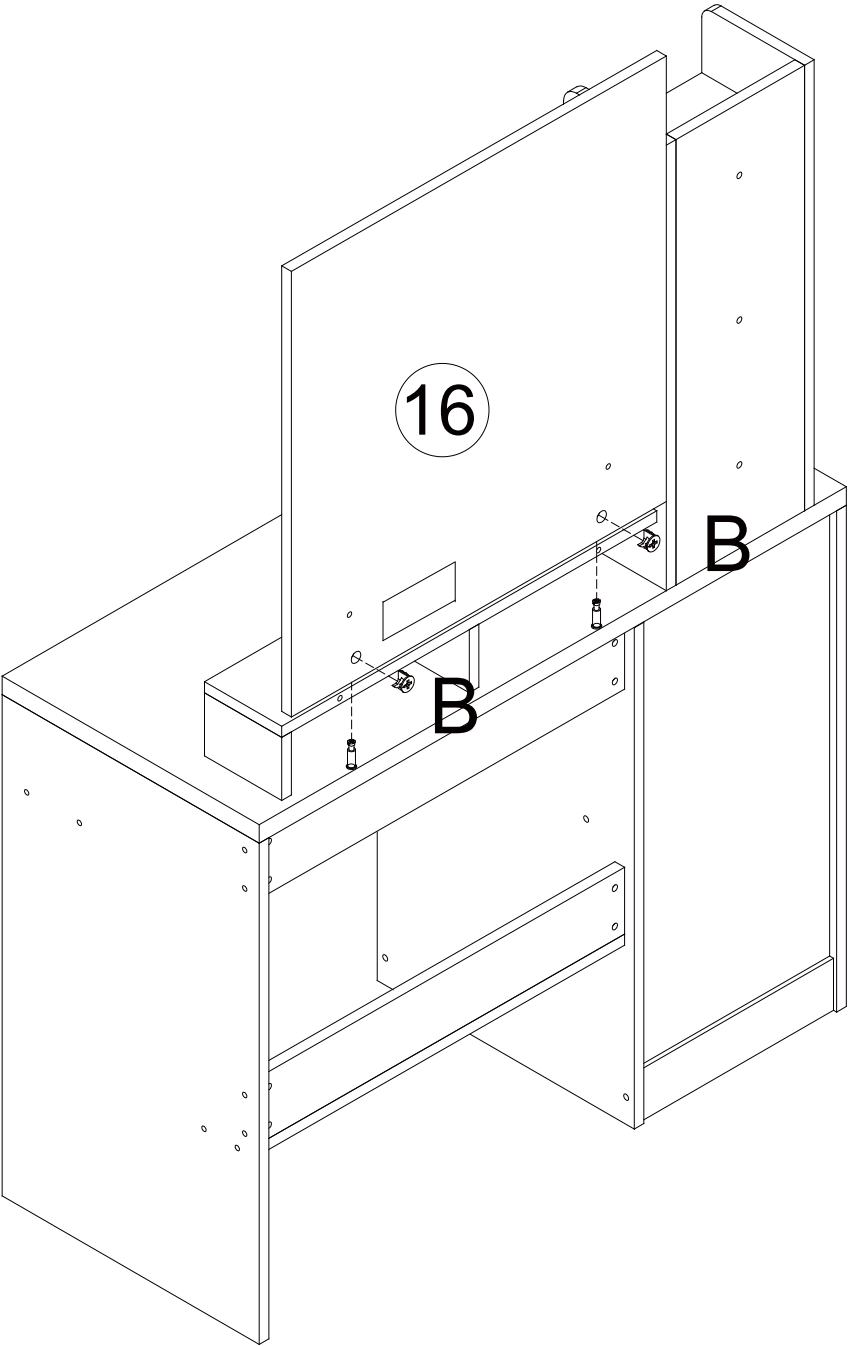

Step 18

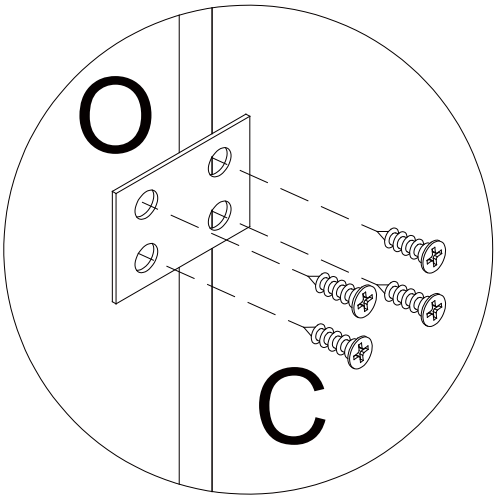
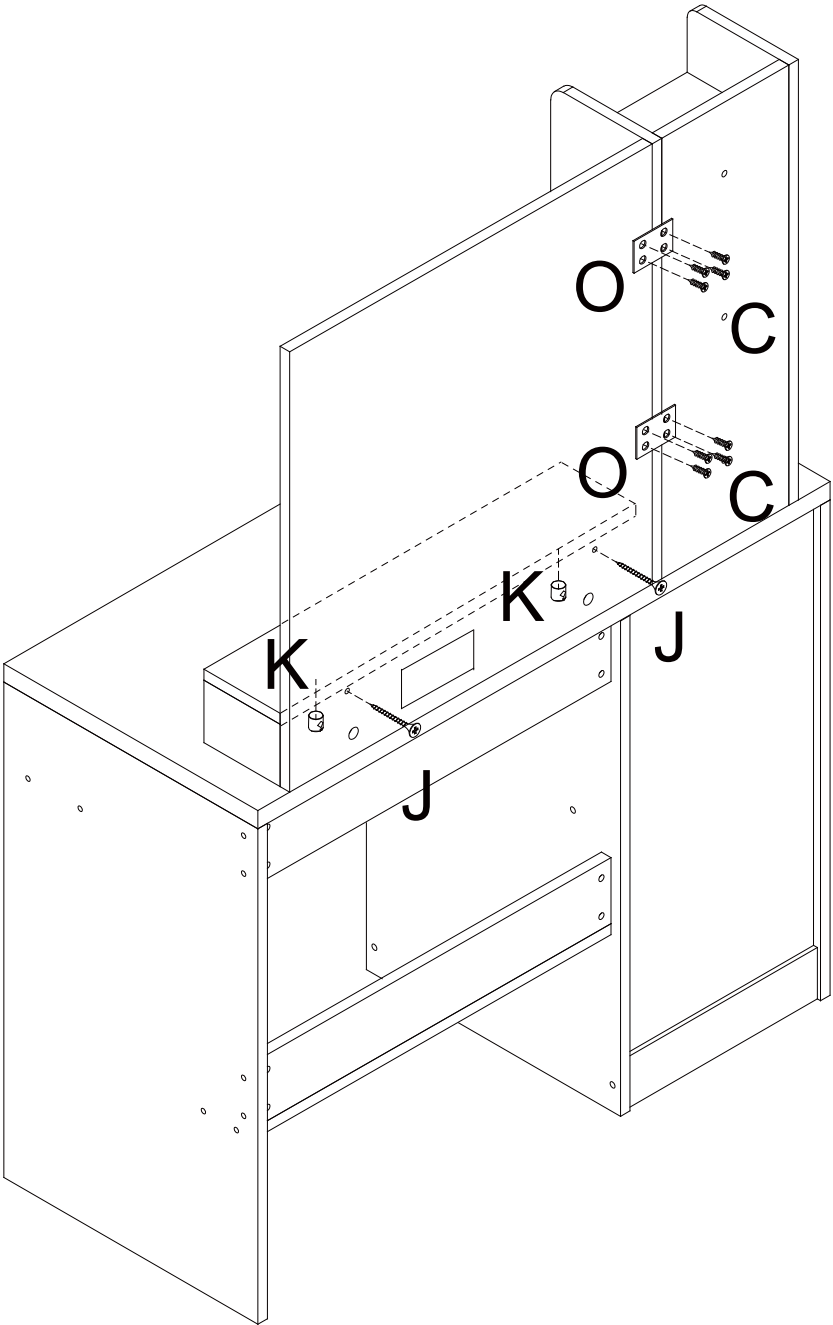

Step 19

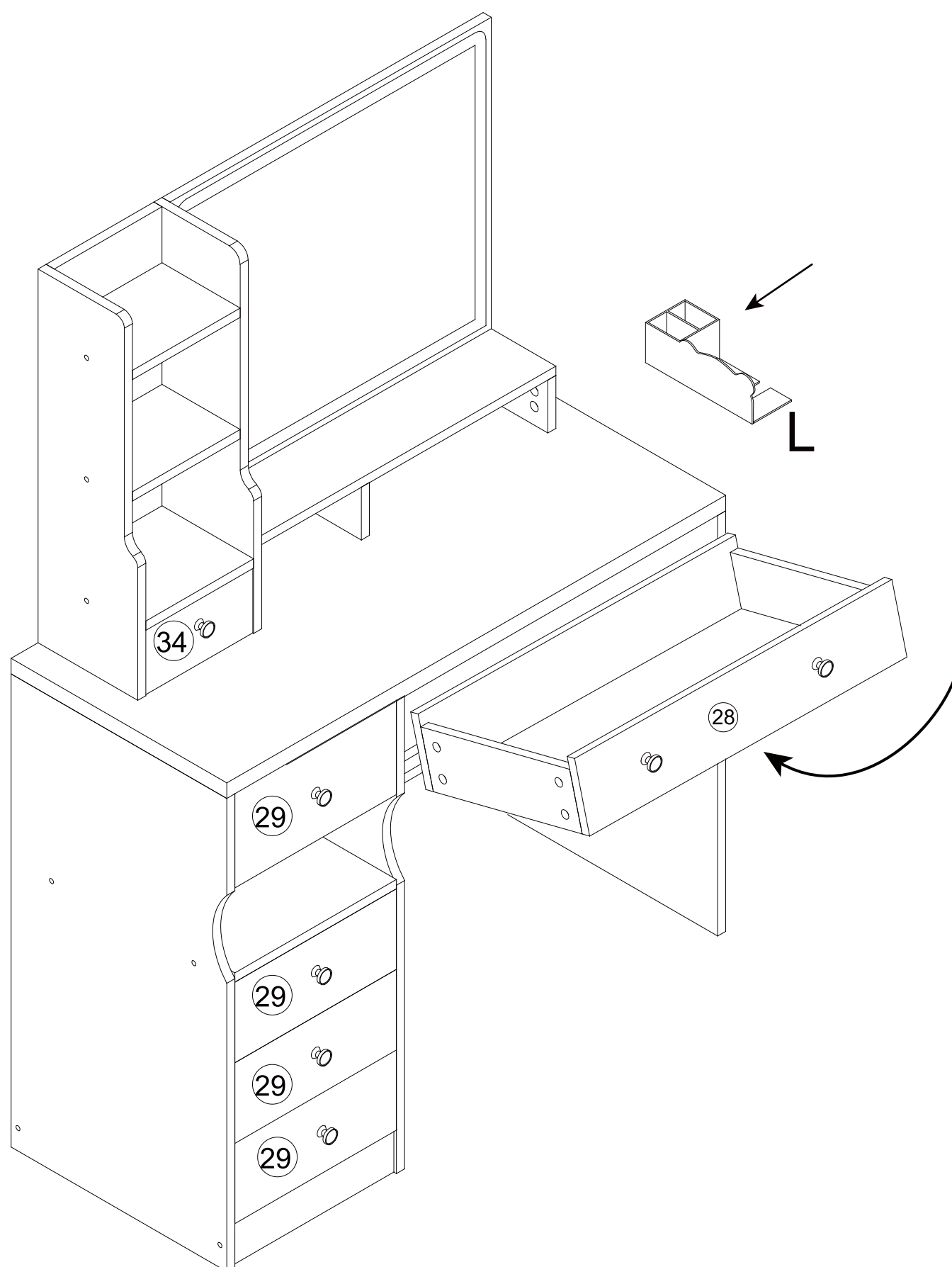

Please note that when placing the drawer in, the drawer positioning pin will block the drawer. Therefore, please follow the diagram to first insert the inner edge of the drawer using a concave method, and then push the drawer flat.

Step 20

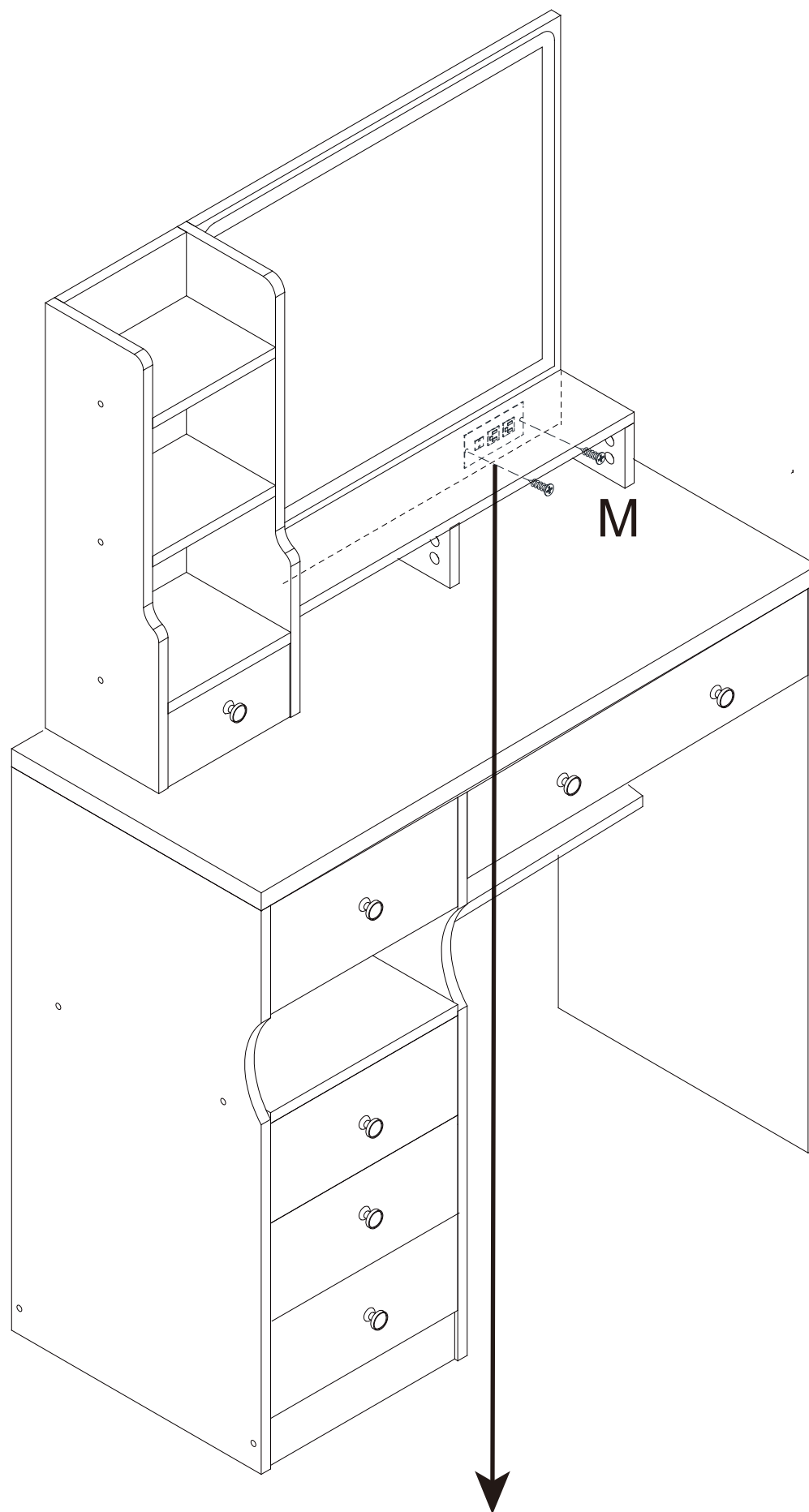

Only for vanity table with hair dryer
bracket and built-in socket

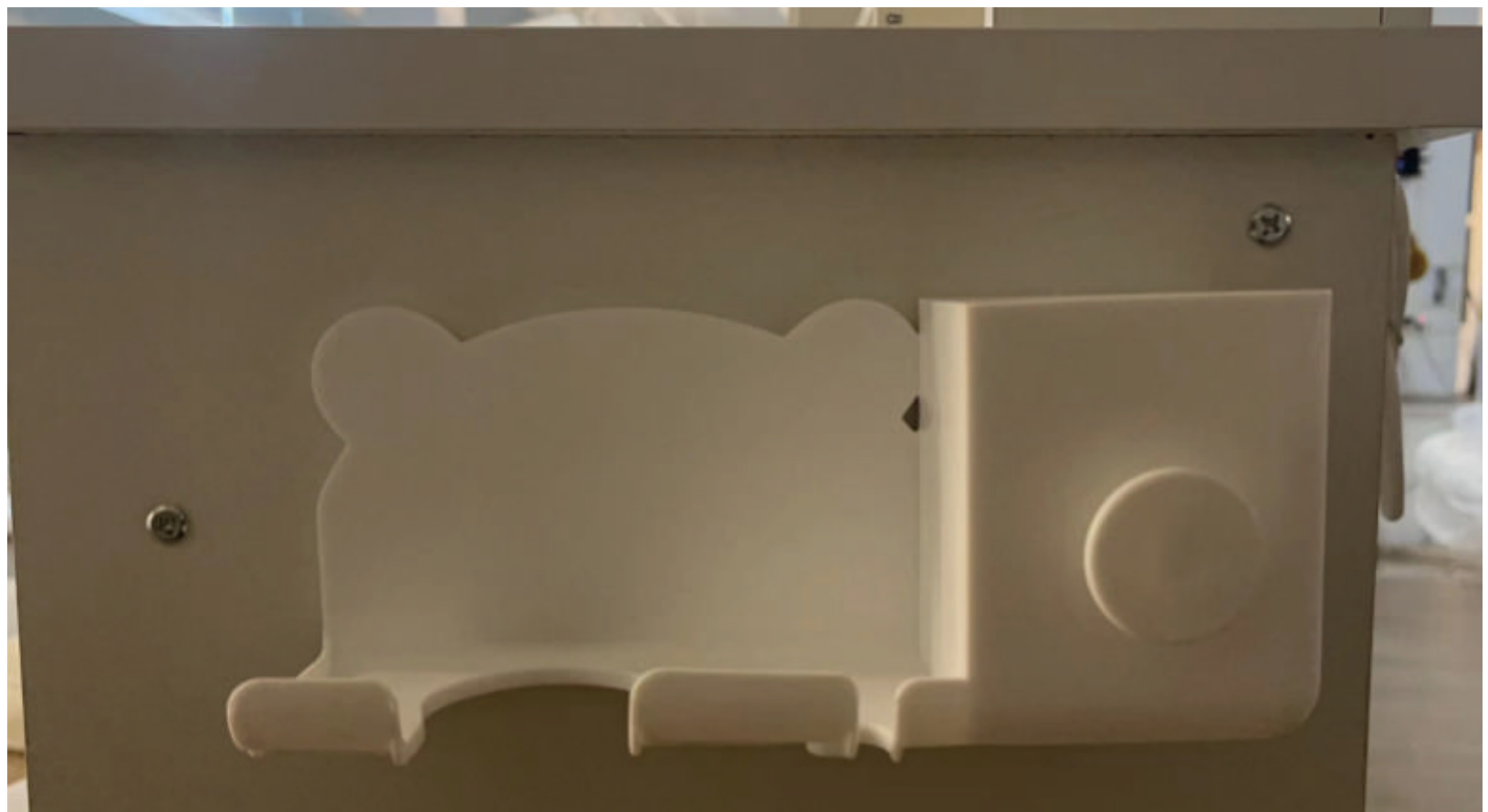

Only for vanity table with hair dryer
bracket and built-in socket

Step 21

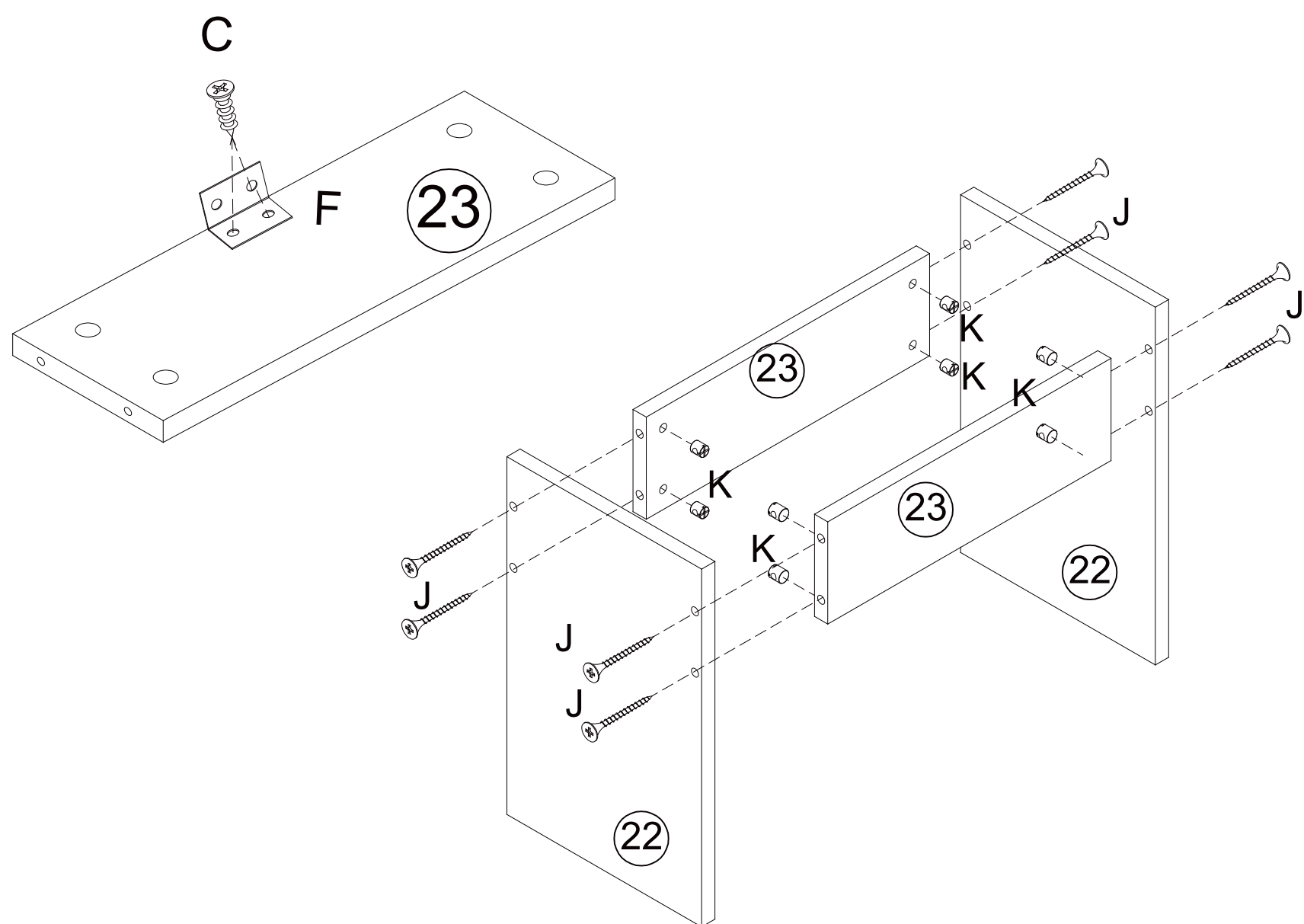

Step 22

