

ASSEMBLY INSTRUCTION

THANK YOU FOR PURCHASING THIS QUALITY PRODUCT.

BE SURE TO CHECK ALL PACKING MATERIAL CAREFULLY FOR SMALL PARTS THAT MAY HAVE COME LOOSE INSIDE THE CARTON DURING TRANSIT.

STEP 1

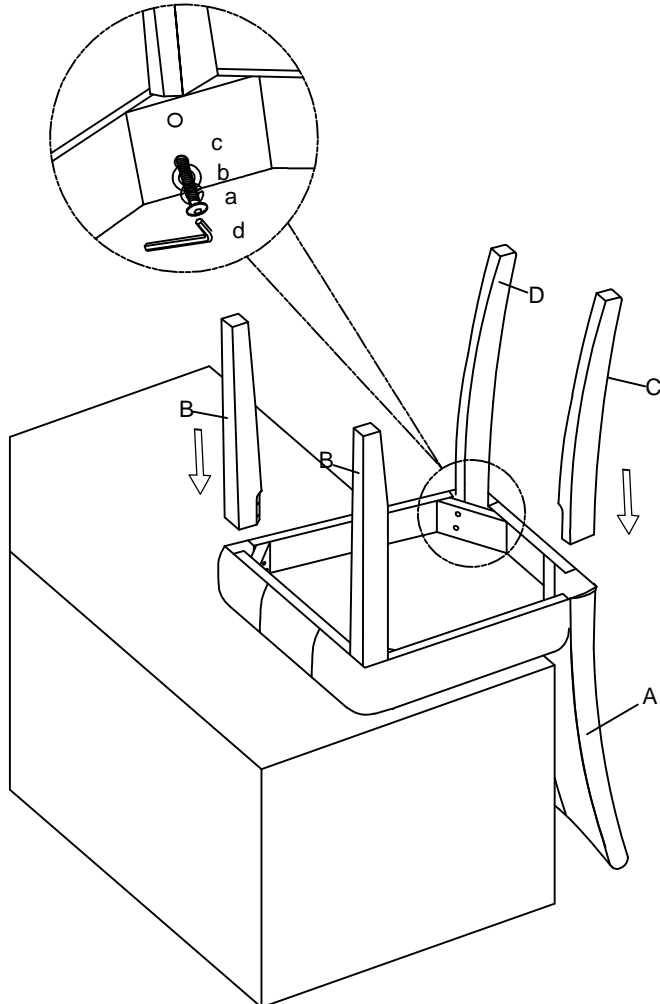

Place the Seat (A) upside down on a non-abrasive table surface. Assemble the Legs (B,C,D) to the Seat (A) using eight Bolts(a), eight Spring Washer (b) and eight Flat Washers(c), with the provided Allen Key (d) in 80% tight.

STEP 2

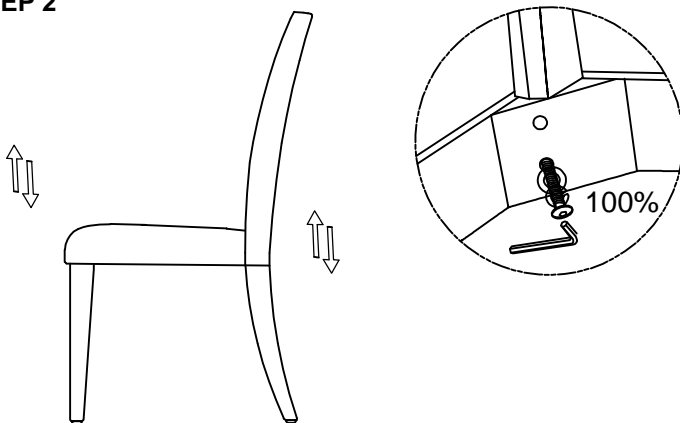

Confirm chair is level and adjust legs as needed. Then fully tighten bolts with Allen key. Place the vinyl flap to the bottom of the Seat (A) using the adhesive strips.

PART LIST

NO	DESC	SIZE (MM)	SKETCH	QTY
A	Seat	500x500x625mm		1 PC
B	Front Leg	430x40x40mm		2 PCS
C	Back Leg (L)	424x30x45mm		1 PC
D	Back Leg (R)	424x30x45mm		1 PC

HARDWARE LIST

NO	DESC	SIZE (MM)	SKETCH	QTY
a	Bolt	8x63.5mm		8PCS
b	Spring Washer	8mm		8PCS
c	Flat Washer	8x22mm		8PCS
d	Allen Key	5mm		1PC

STEP 3

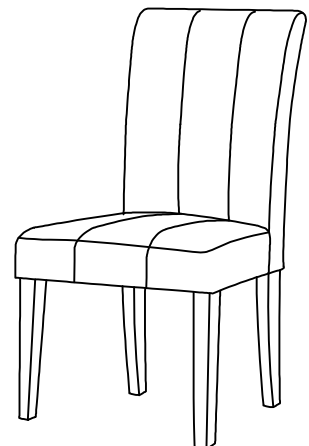

Now the chair is completely assembly.

MADE IN CHINA