



## Pivit Installation Guide

### What You Received:

- Worksurfaces
- 60" Outside Legs
- 36" Shared Center Legs
- Power/Data Trough
- Acrylic Screens
- Screen Clamps
- Hat Channels
- Mending Plates
- Power
- Wood Screws

### Tools You'll Need:

- Drill with Phillips head bit
- Allen wrench set
- Tape measure

This guide is based on a 4-pack typical. For runs longer than a 4-pack, just repeat steps as needed.



## Pivit Installation Guide

NOTE: 1st 2-pack will be assembled upside down

1. Lay your worksurfaces out and place 60" leg on one end. The outside corners of the surface should be flush with the outside corner of the leg.

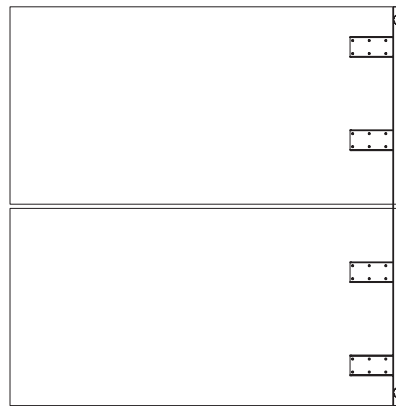

2. Mark center point of worksurface for trough placement later (step 8).

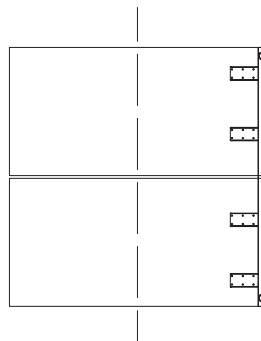

3. Attach hat channels 1/3rd of the way from the front of the worksurface.

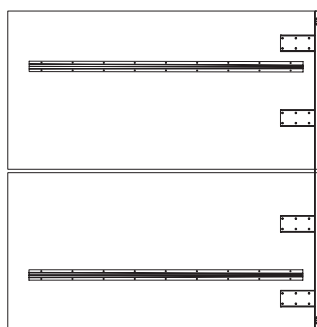



## Pivot Installation Guide

4. Attach 36" shared leg to the other end of the worksurfaces. Keep 1.5" gap consistent and center the shared leg.

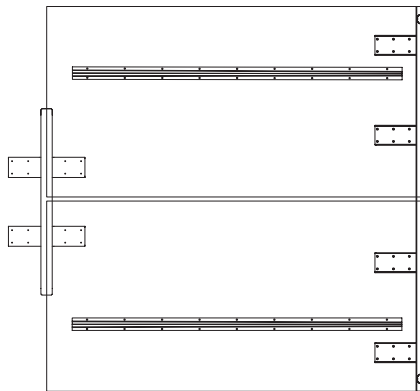

5. Flip first 2 pack right side up, and position according to floor plan.

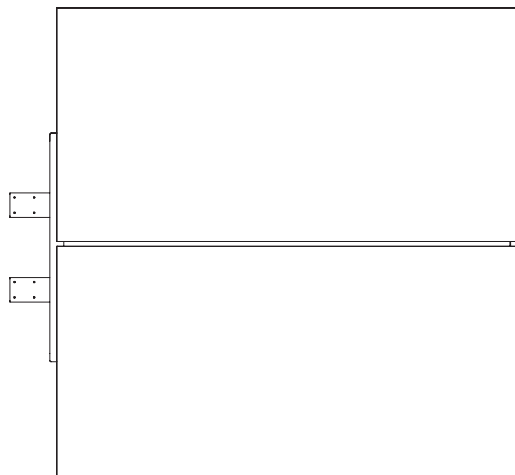



## Pivit Installation Guide

6. Attach next leg (60" if ending a run, 36" shared if continuing a run) to next two worksurfaces. Flip these over and attach to previous shared leg.

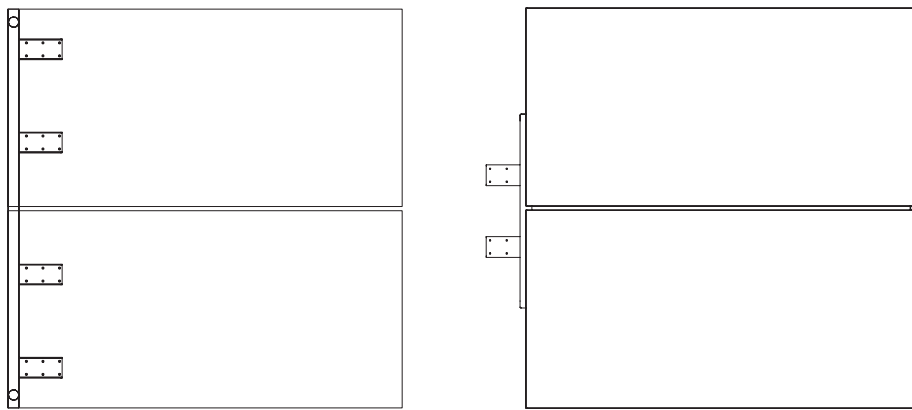

7. Attach screen clamps to the trough. Discard small pin that comes with clamp. Make sure they are secured tightly and parallel to the edge of the trough.

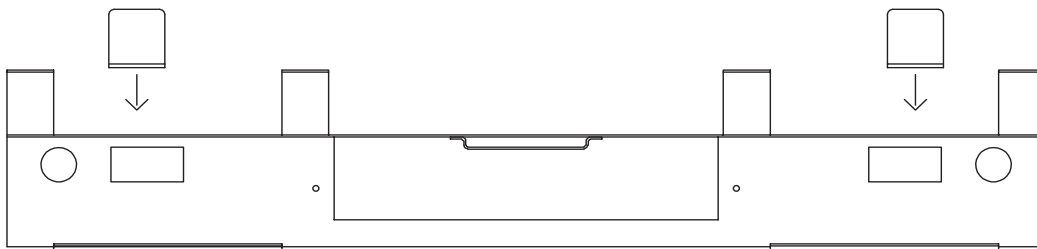



## Pivot Installation Guide

8. Center troughs on surfaces (marked center on step 2) and attach with wood screws.

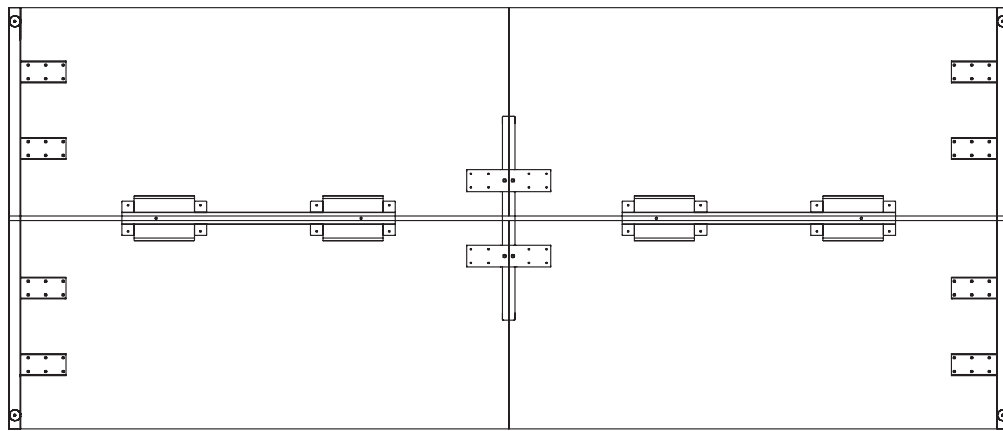

9. Attach mending plates on the outside of the shared legs, approximately 2 inches from the outside edge of the worksurface

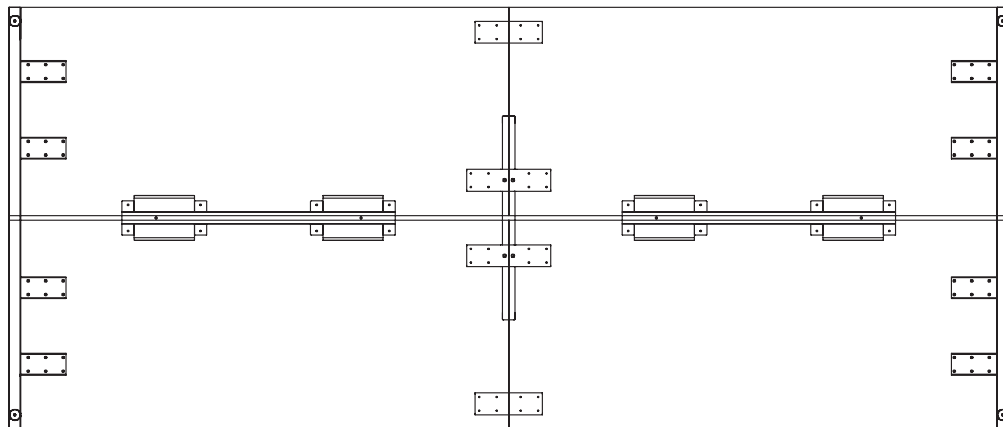



## Pivot Installation Guide

10. Remove face plates from screen clamps. Place acrylic screen notches on the clamps and secure face plates. Be sure to not over tighten screws.

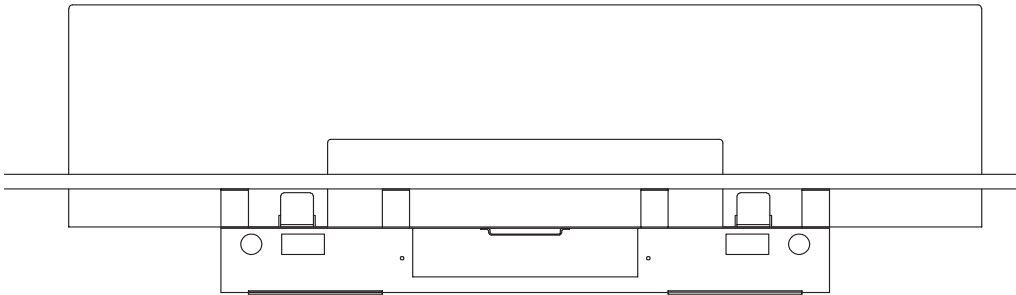

11. Attach clamp on accessories (Monitor Arms/Power)

