

GUIDE TO INSTALL A RECESSED MEDICINE CABINET

TOOLS NEEDED:



PENCIL



LEVEL



UTILITY KNIFE



KEYHOLE OR RECIPROCATING SAW



DRILL



WOOD SCREWS



WOOD SHIMS



TAPE MEASURE

STEP 1:

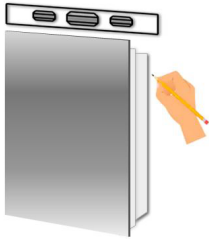

Center the cabinet at the desired location. Using a level, draw a straight outline of the back of the cabinet on the wall. Tip: Make the opening a little larger than the back of the cabinet, but smaller than the Recessed Lip of the cabinet. **Recommended Wall opening: 13 3/4" x 18"**

STEP 2:

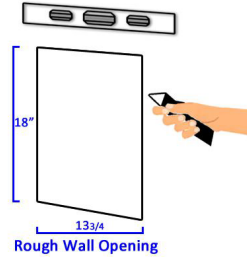

Use your utility knife to score the outline and level. After area is properly scored, cut out the area with a keyhole or reciprocating saw to remove the drywall. Shave down any excess to even out cuts.



STEP 3:

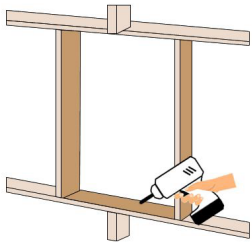

After Drywall removed, clear all obstructions. (NOTE: consult with a licensed professional for safe electrical, plumbing, or load-bearing/ structural removals.) Attach 2 x 4 blocking to wall studs to fit cabinet size. Secure with wood screws. Make sure drywall is secured to the edge of the wall studs using screws as needed.

STEP 4:

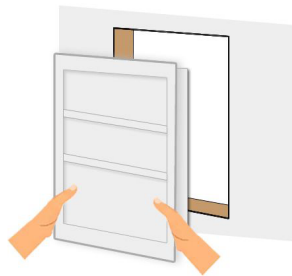

Slide Medicine Cabinet into place. Verify cabinet is level; using wood shims to adjust as needed. **Note: You can change the swing to left or right by simply rotating the entire cabinet.**

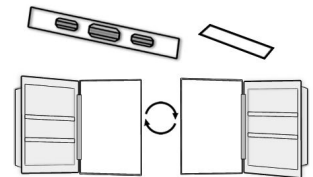

STEP 5:

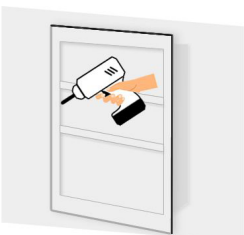

Once you have the cabinet properly positioned, screw into the wall using provided hardware.

STEP 6:



ENJOY!!!